

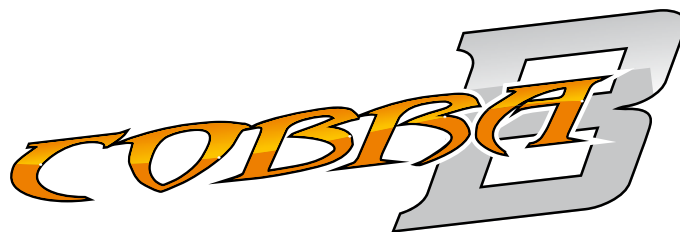

INSTRUCTION MANUAL
& REFERENCE GUIDE



The Serpent S811-B Cobra is a complete new platform for the 1/8 scale gas offroad category of racing. The Serpent S811 Cobra is designed to be a world champion, while still being easy to use, assemble, and set up. You are now part of the worldwide network of Serpent drivers, which gives you superior technical support and access to many benefits that only Serpent drivers can enjoy.

The Serpent S811-B Cobra offers state of the art specifications and leads the way in 1/8 scale gas offroad chassis design, using all the knowledge our designers have gathered from racing offroad cars for over 15 years, into this design too.

Continuously pushing the performance envelope, Serpent's engineers have added many new and innovative features that help take your Serpent S811-B Cobra into the winner's circle. Designed, tested and raced by Billy Easton, USA. World Champion.

INSTRUCTIONS

Serpent's long tradition of excellence extends to the instruction manuals, and this instruction manual is no exception. The easy-to-follow layout is richly illustrated with 3D-rendered full-color images to make your building experience quick and easy. Following the instructions will result in a well-built, high-performance race-car that will soon be able to unleash its full potential at the racetrack.

This instruction manual has been divided into sections that will logically lead you through the assembly process of your Serpent S811-B Cobra. Follow the assembly steps in the order presented to ensure that no problems occur during assembly.

Each step indicates all the fasteners, bearings and small parts used.

Bag numbers identify the kit bag(s) that contains the appropriate parts.

EXPLODED VIEWS AND PARTS LIST

The exploded views and parts lists for the Serpent S811-B Cobra are included in the back of this manual. The exploded views show all the parts of a particular assembly step along with the Serpent part number. The parts lists indicate the part number and name of each part for easy reference when ordering.

The printed instruction manual included with your Serpent S811-B Cobra kit is very complete, though due to continuous product development, more up-to-date information may be provided at our **Serpent.com** website.

All information about the Serpent S811-B Cobra is accessible from the Serpent S811-B product page which can be found on Serpent.com and can be accessed by simply typing **serpent.com/600001** into your web browsers address bar.

From the Serpent S811-B product page you will find the very latest information about your Serpent S811-B: reports by team drivers and other experts, tips and tricks, setups, image gallery and downloadable files including the latest version of the instruction manual will be made available as downloadable PDF-files.

Team Serpent



Safety

Read and take note of the 'Read this First section' before proceeding to assemble the car-kit. This car-kit is intended for persons aged 16 or older.

Customer service

Serpent has made a strong effort to make this manual as complete and clear as possible. Additional info may be published in our website:

www.serpent.com or you may ask your dealer or the Serpent distributor for advice, or email Serpent direct: info@serpent.com
The Serpent Facebook, Twitter and Youtube pages give additional means of support and communications.

Instructions, how to use

The kit includes bags, with bag numbers, which refer to the same step in the manual. Open only the indicated bag(s) per step and finish that part of the assembly. Remaining parts will be needed later on in the assembly process.

Instructions

Serpent's long tradition of excellence extends to the instruction manuals, and this instruction manual is no exception. The easy-to-follow layout is richly illustrated with 3D-rendered full-color images to make your building experience quick and easy. Following the instructions will result in a well-built, high-performance race-car that will soon be able to unleash its full potential at the racetrack.

SETUP

In certain assembly steps you need to make basic adjustments, which will give you a good initial setup for your Serpent S811-B. Fine-tuning the initial setup is an essential part of building a high-performance racecar like your S811-B.







Exploded views and partslist

The exploded views and parts lists for the Serpent S811-B are presented in the Reference Guide section in the back of this manual. The exploded views show all the parts of a particular assembly step along with the Serpent part number. The parts lists indicate the part number and name of each part for easy reference when ordering.

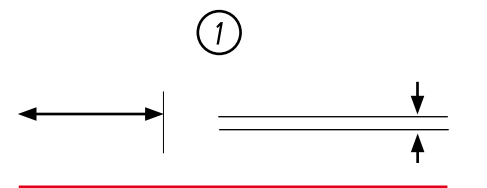
Read this first!

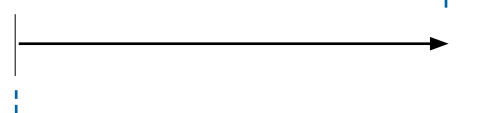
- This is a highly technical hobby product, intended to be used in a safe racing environment. This car is capable of speeds in excess of 80 km/h or 50mph. Please follow these guidelines when building and operating this model.
- Parental guidance is required when the builder/user of this car is under 16.
- Follow the building instructions. If in doubt, contact your dealer or importer.
- Be sure to use the proper tools when assembling the car. Always exercise caution when using electric tools, knives and other sharp objects.
- Be careful when using liquids like lubrication oil, fuel or glue. Do not swallow.
- Follow the manufacturer's instruction in case you experience irritation after using the product.
- Be careful when operating the car. Stay away from any rotating parts such as wheels, gears and transmission. Stay away from motor, engine and exhaust pipe system or speedo during and immediately after use, as these parts may be very hot. We advise to use protective hand gloves.
- Only operate this car in a safe environment, like a special racing track or a closed parking lot. Avoid using this car on public roads, crowded places or near infants.
- Before operating this car, always check the mechanical status of the car. Also check that the transmitter and receiver frequencies correspond and are not used by any other racer at the same time. Check that the batteries of the transmitter and receiver- are fully charged.
- After use, always check all the mechanics of the car. We advise to clean the car immediately after use, and inspect the parts for wear or fractures. Replace when necessary. Do not use water, methanol, thinner or other solvents to clean the car.
- Empty the fuel tank (depending on model) if needed and disconnect the receiver battery.
- Store the car in a dry and heated place to avoid corrosion of metal parts.
- Avoid using this car in wet conditions as the water will cause corrosion on the metal parts and bearings and these parts will cease to function properly. If driven in the wet, ensure that all the electric equipment is waterproofed and after use, that all moving parts are dried immediately.

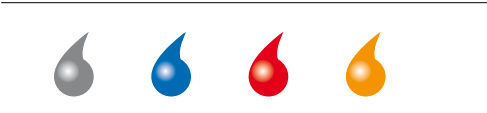
USING THE MANUAL

	Step number; the order in which you should assemble the indicated parts
	Length after assembly / Gap between two items
	Assembly path of one item into another
	Group of items (within lines) should be assembled first
	Direction the item should be moved
	Glue one item to another
	Press/Insert one item into another
	Connect one item to another
	Apply transmission grease (Grey), threadlock* (Blue), CA glue* (Red) or differential grease (Orange). (*Items not included.)
	Apply silicone oil.

A

1

CENTER
DIFF
BAG

DIFFERENTIAL CENTER

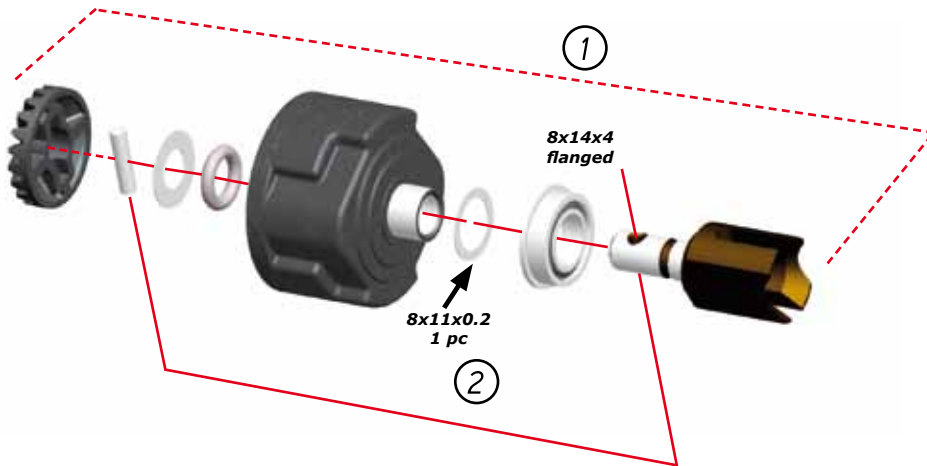

TIP



TIP

add 2mm oil before
assembling the gear



TIP



A

2

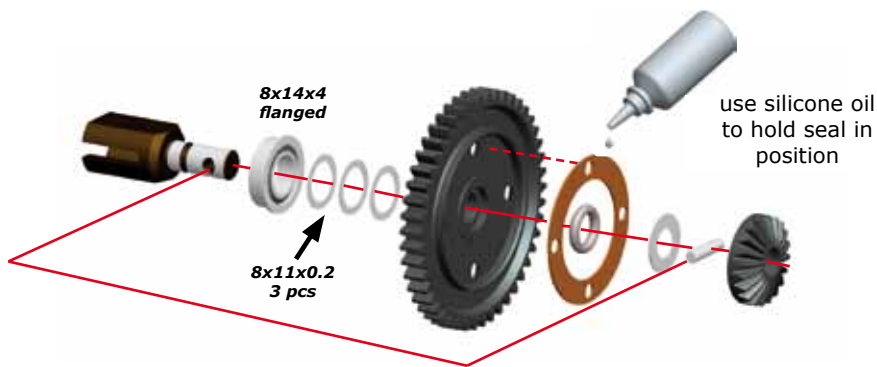

A

3

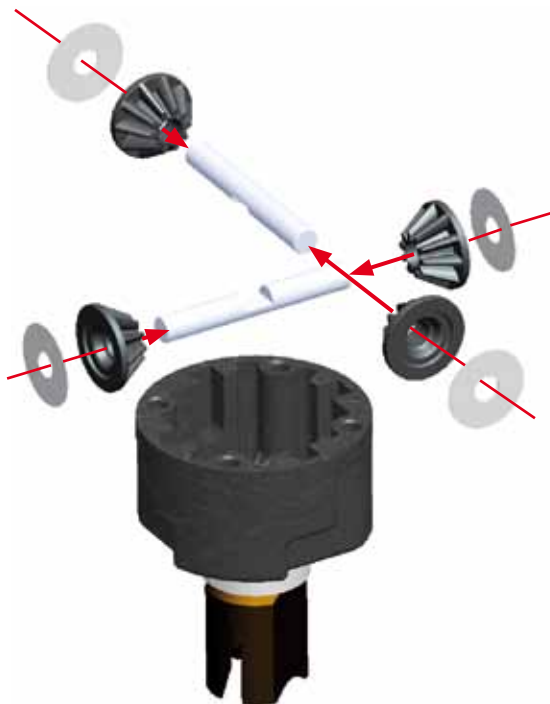

M3x12

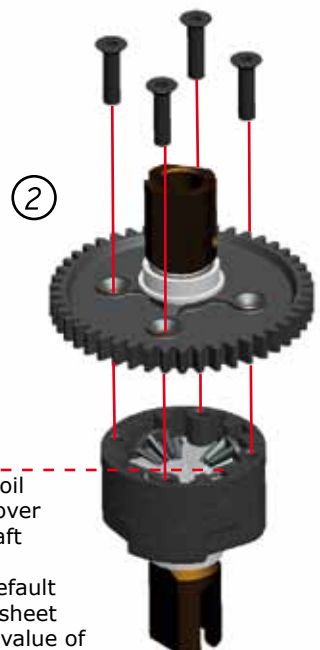

①

silicone oil
fill just over
gear shaft

check default
SET-UP sheet
for CST value of
the silicone oil

②

BLB

4

A

4

FR/RR
DIFF
BAG

DIFFERENTIAL FRONT/REAR

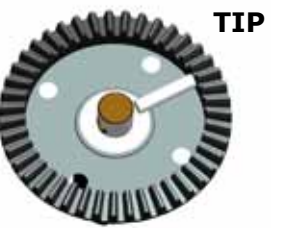
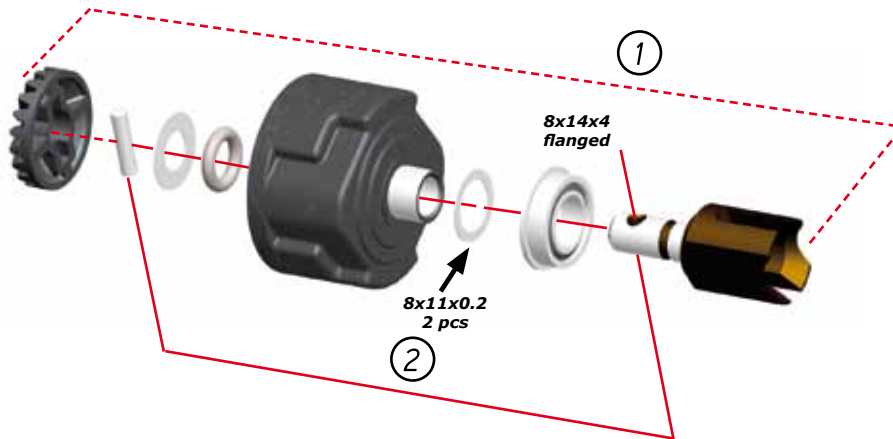

A

5

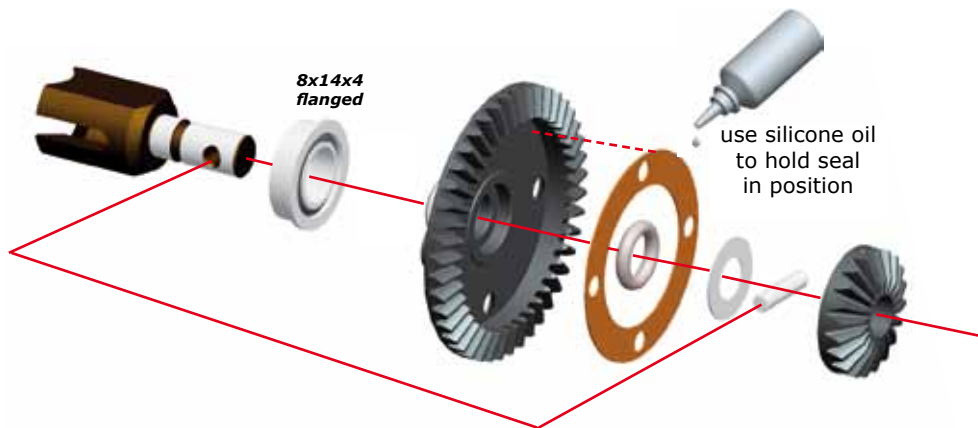

A

6

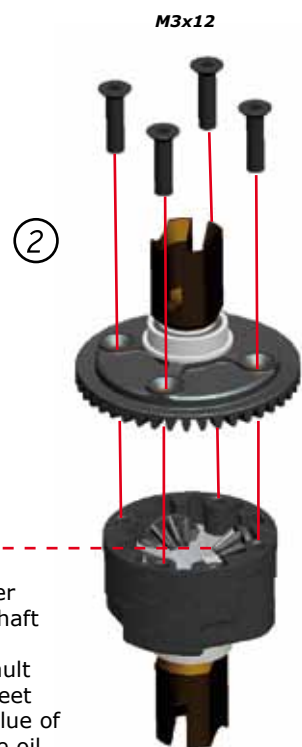

BIB

5

A

7

BAG

1

CENTER BRAKE ASSEMBLY

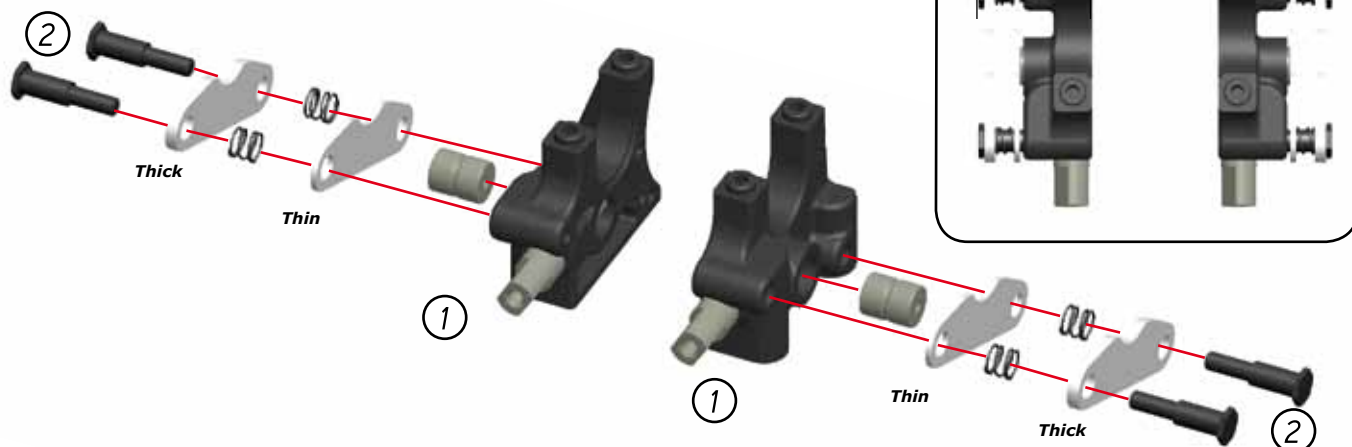

A

8

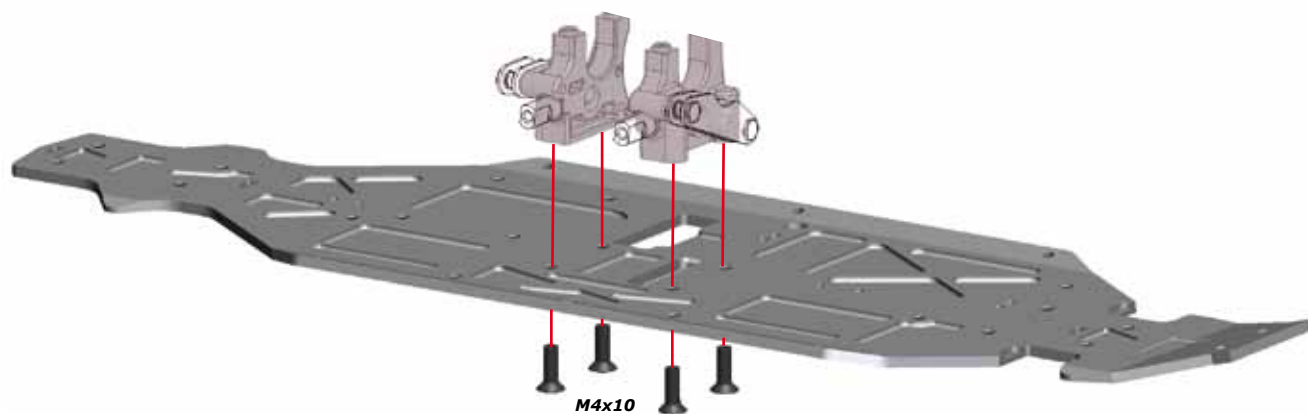

A

9

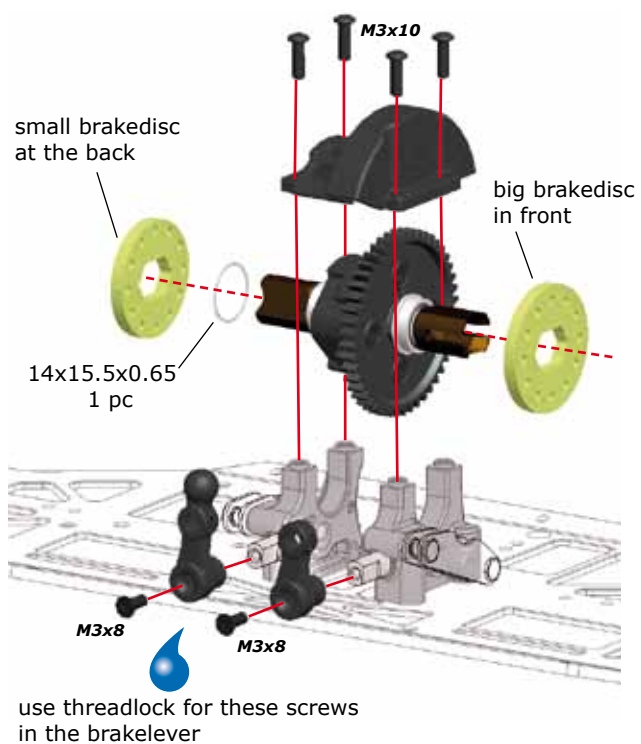

A

10

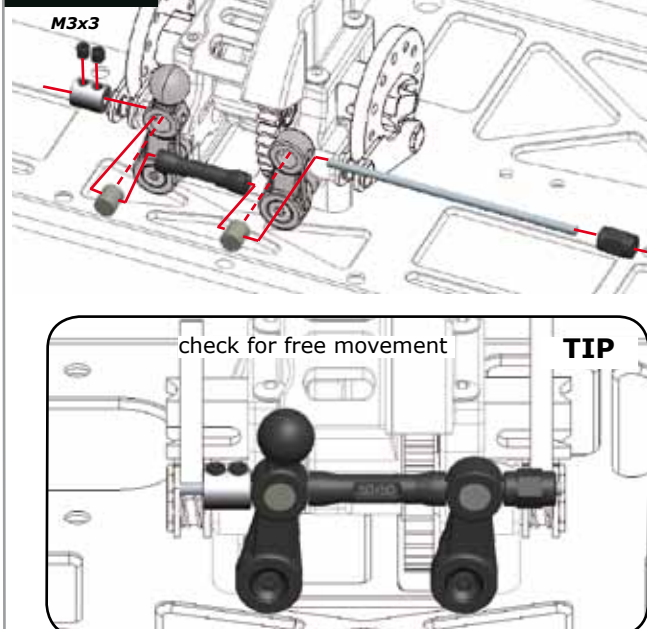

611B

6

A

11

BAG

2

REAR AXLE

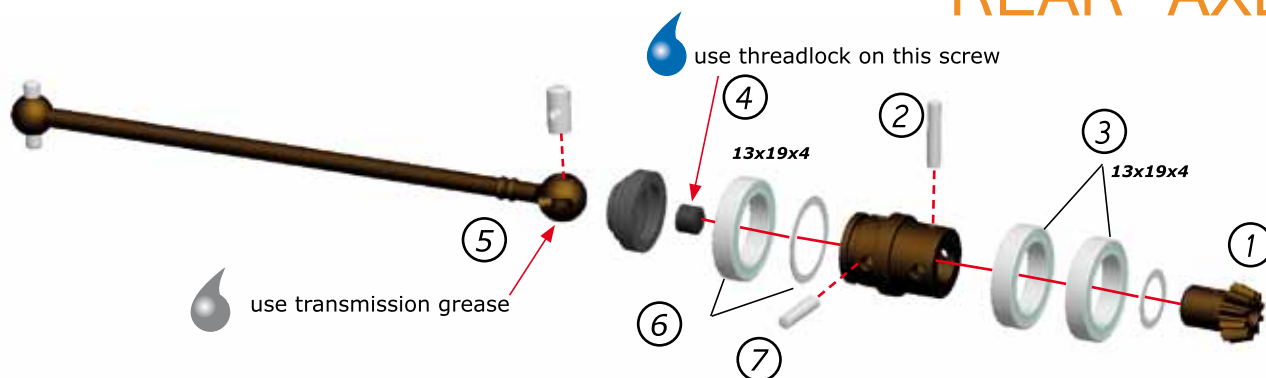

A

12

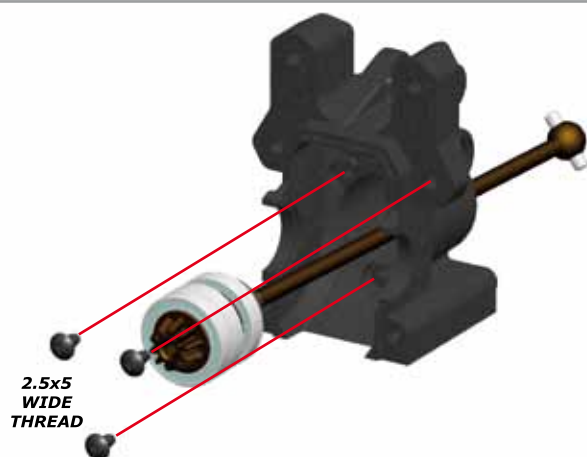

A

13

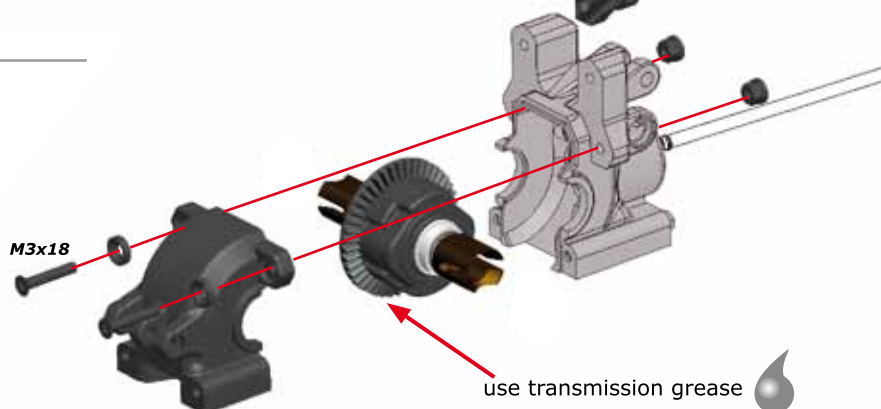
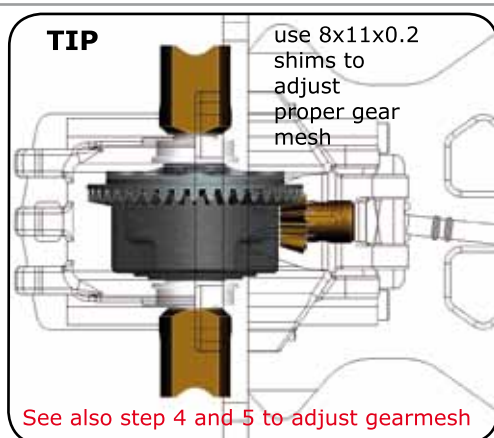

A

14

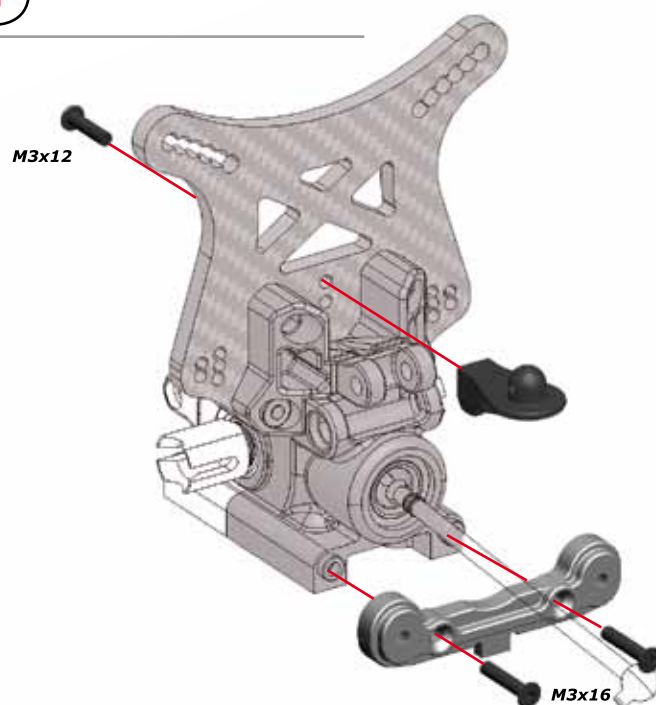

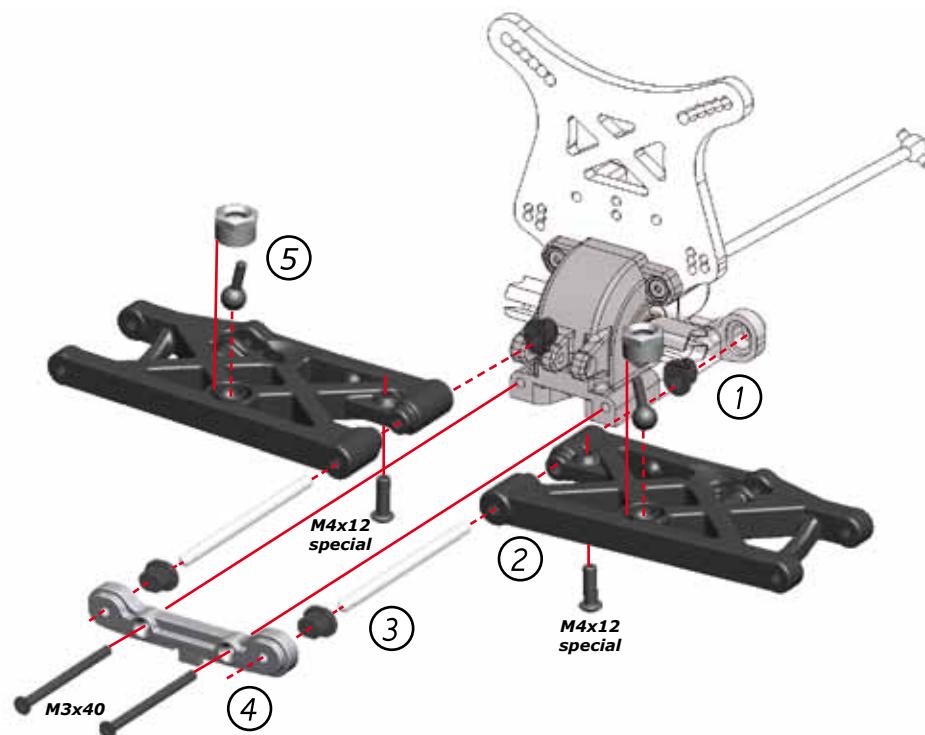

proper insert orientation in the rear bracket, left and right equal type

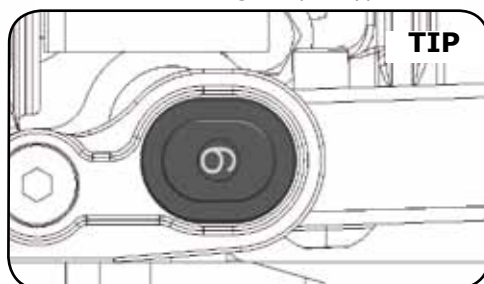

proper insert orientation in the front bracket, left and right equal type

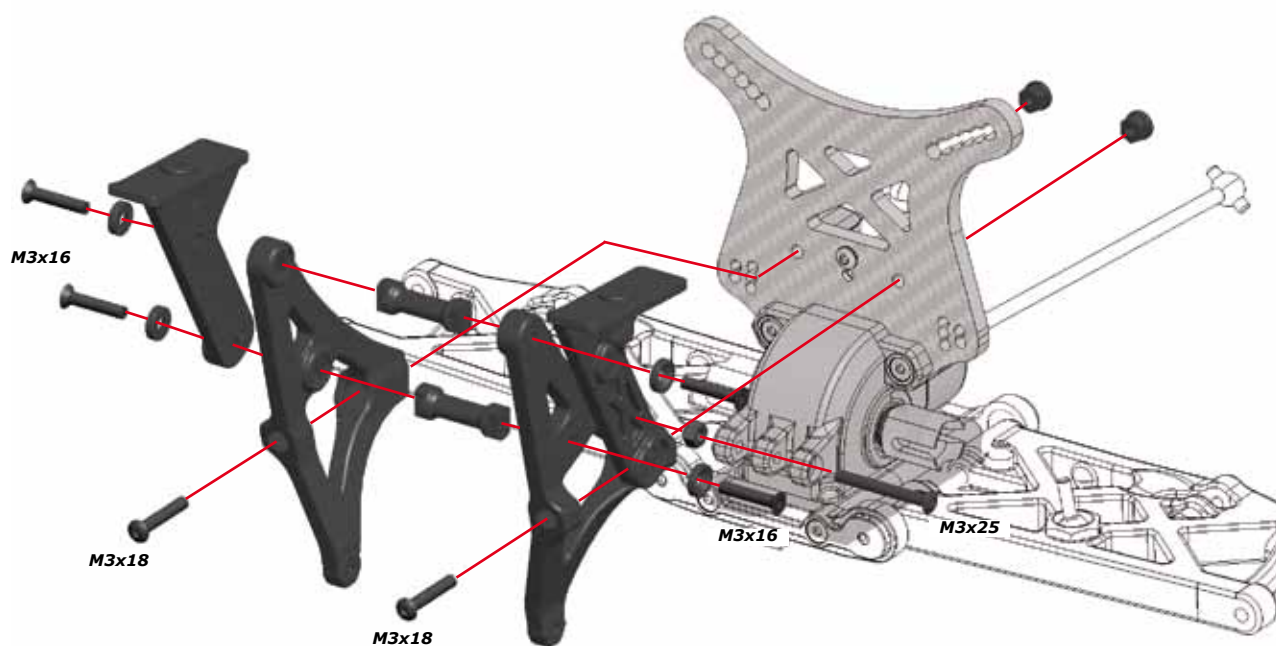
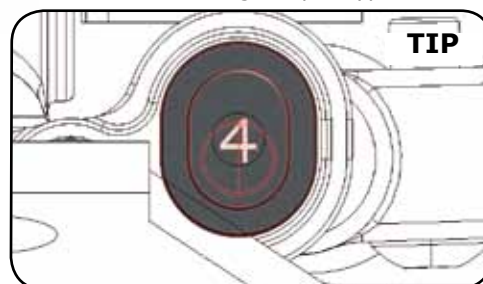

A

17

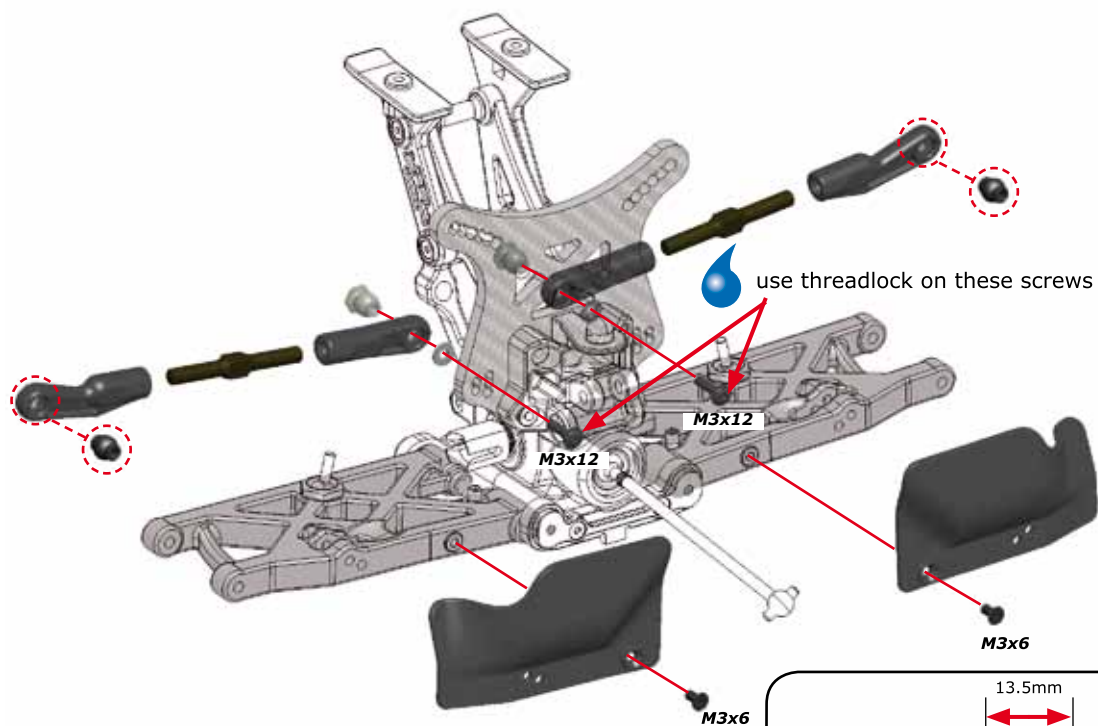

A

18A

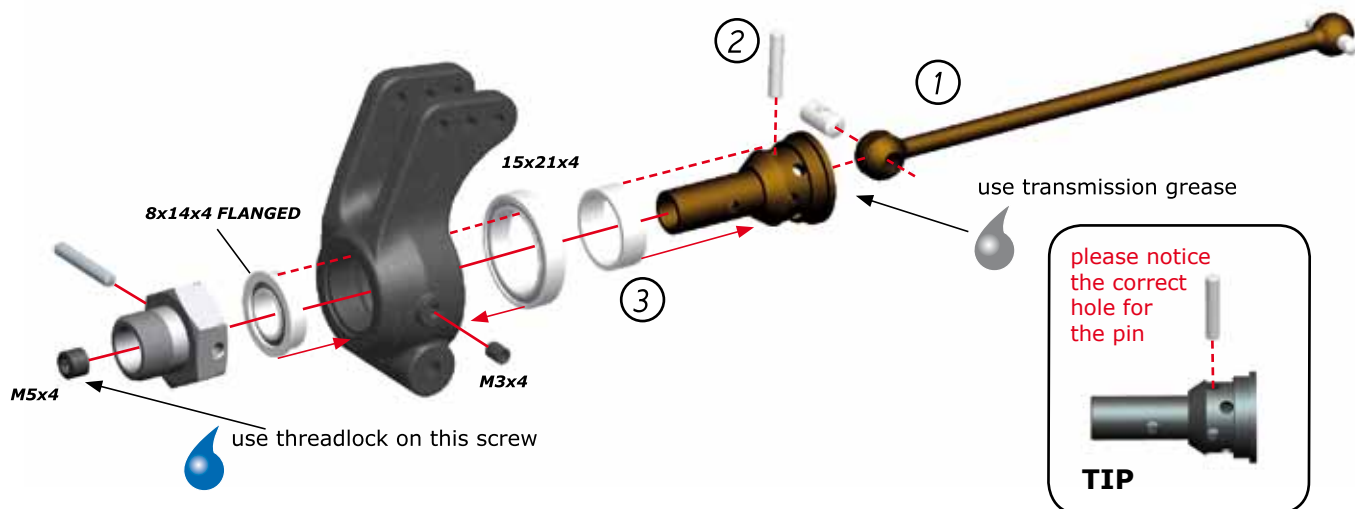
BAG
4

A

18B

BIB

9

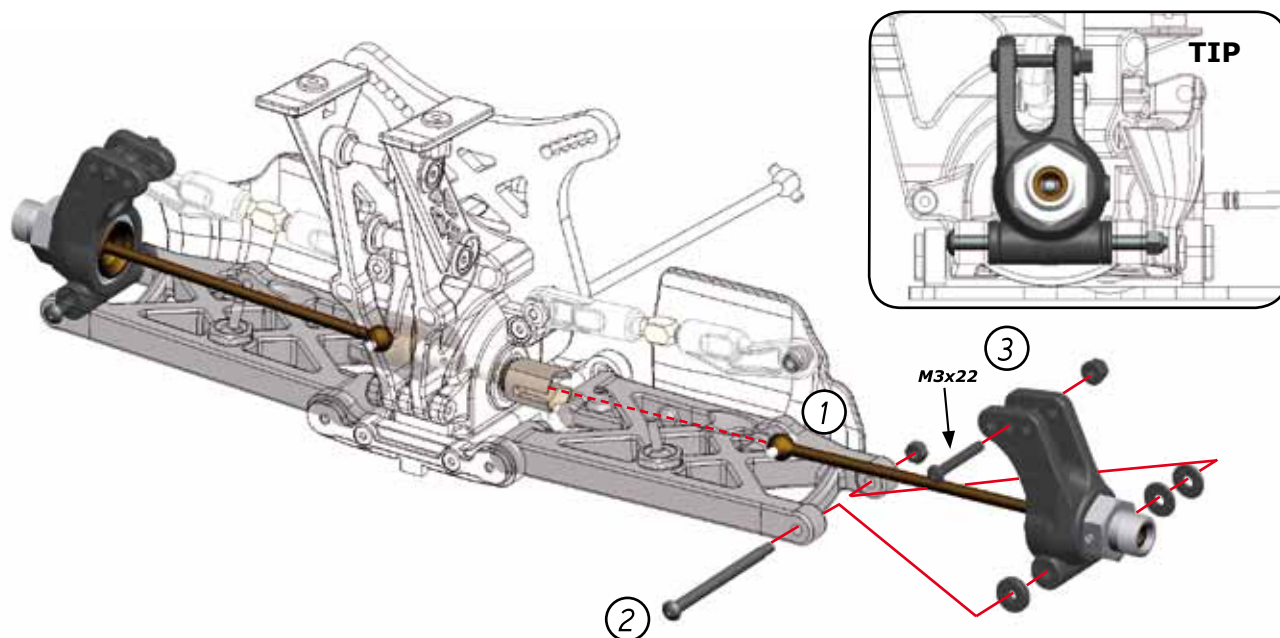

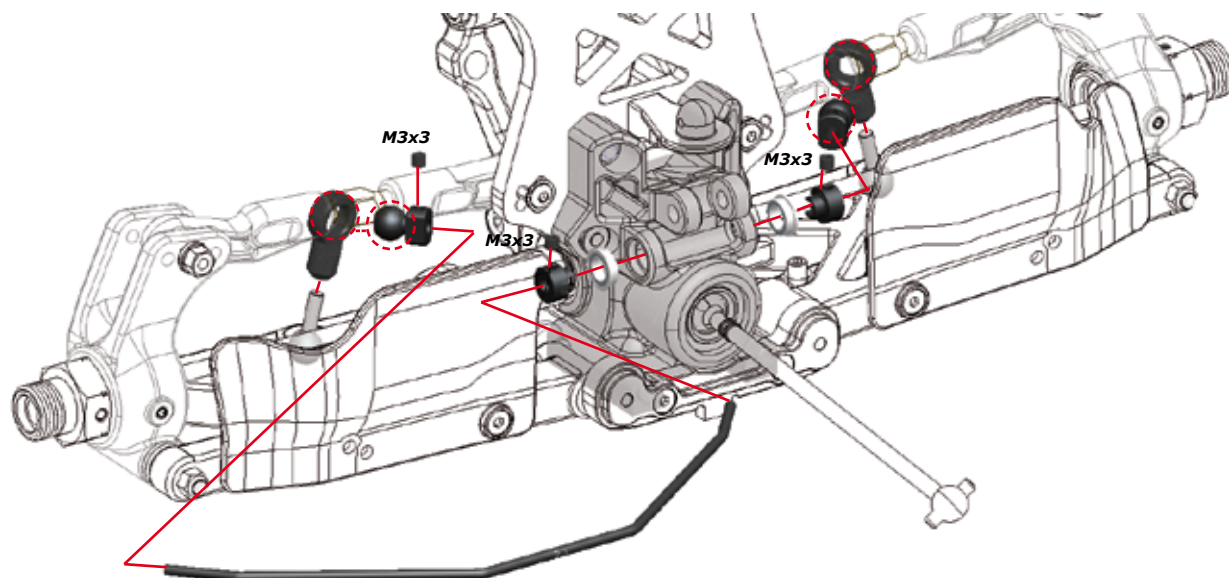
**TIP**

use threadlock on these screws

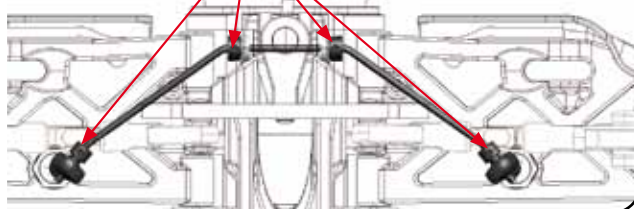
**TIP**

35mm

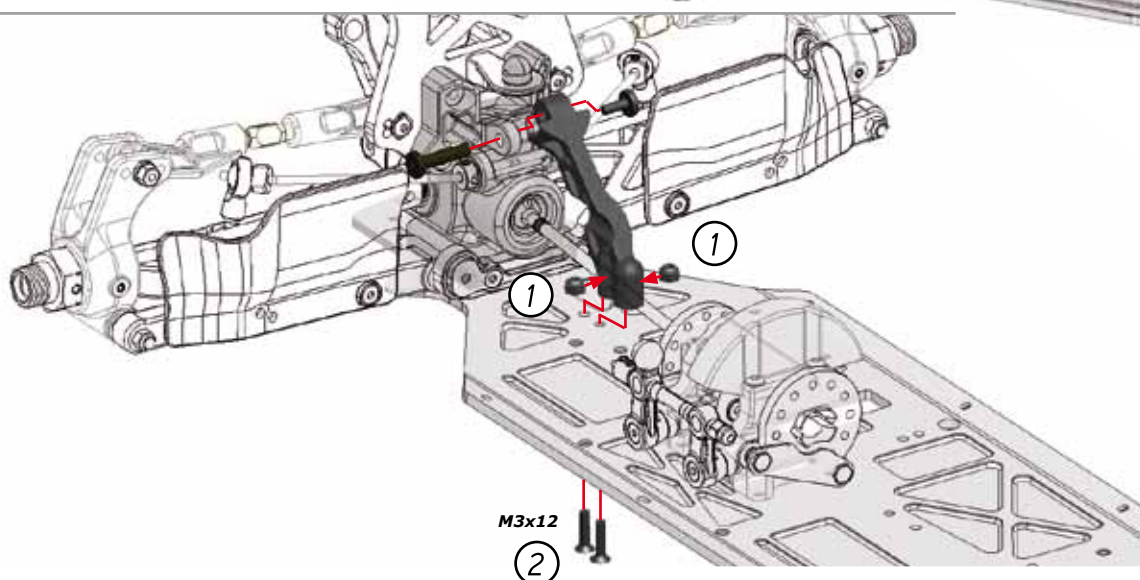
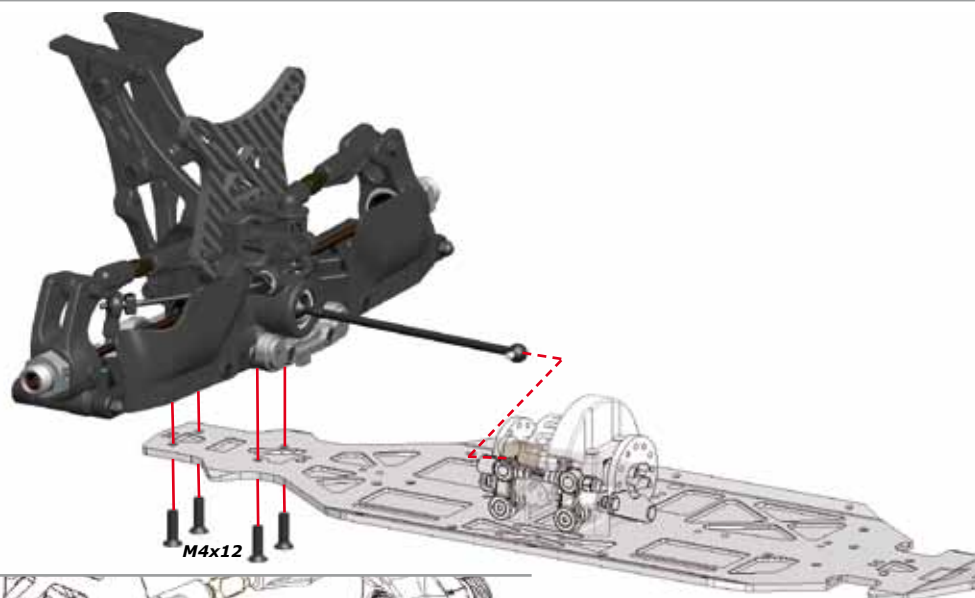
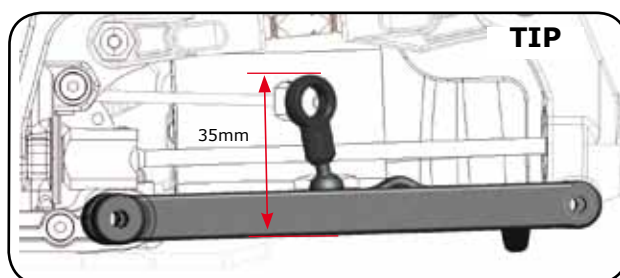

A

22

BAG

5

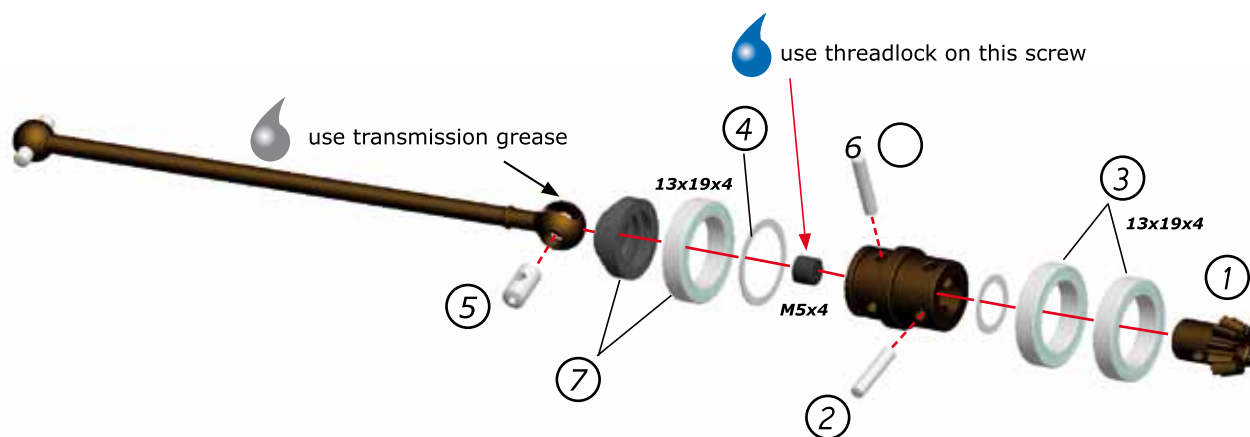

A

23

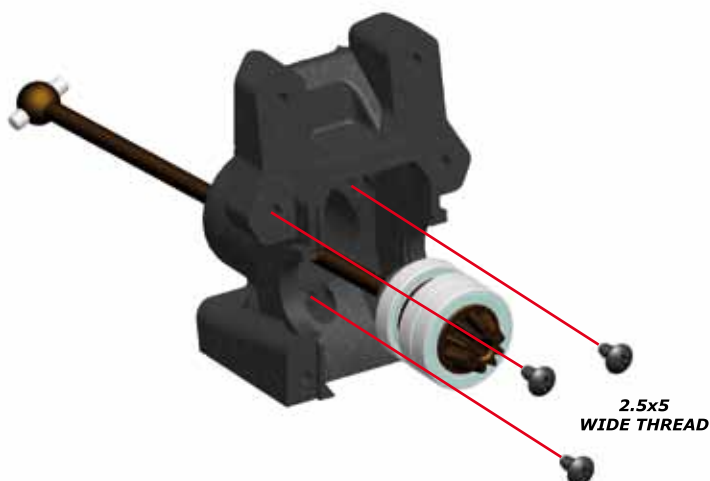
**TIP**

use 8x11x0.2
shims to
adjust
proper gear
mesh

See also step 4 and 5 to adjust gearmesh

A

24

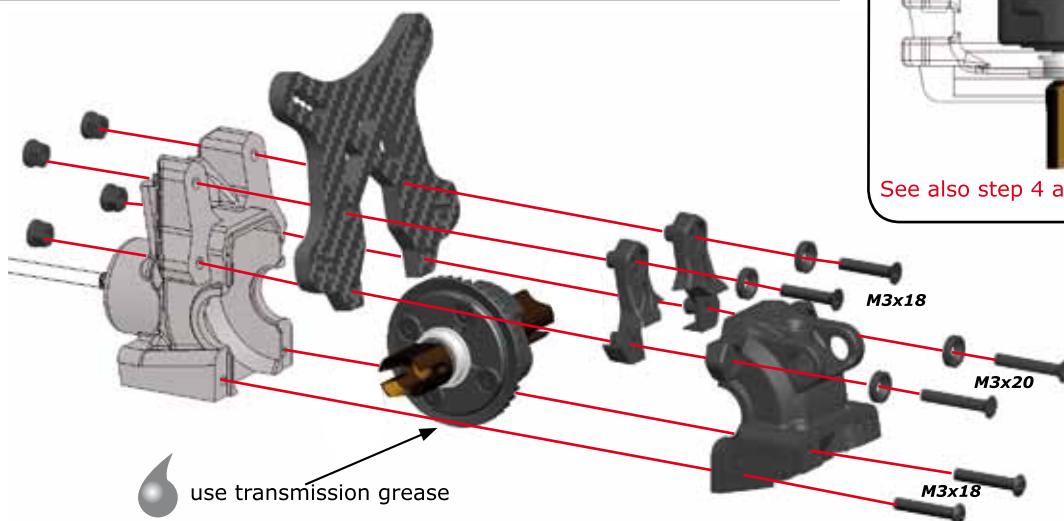

A

25

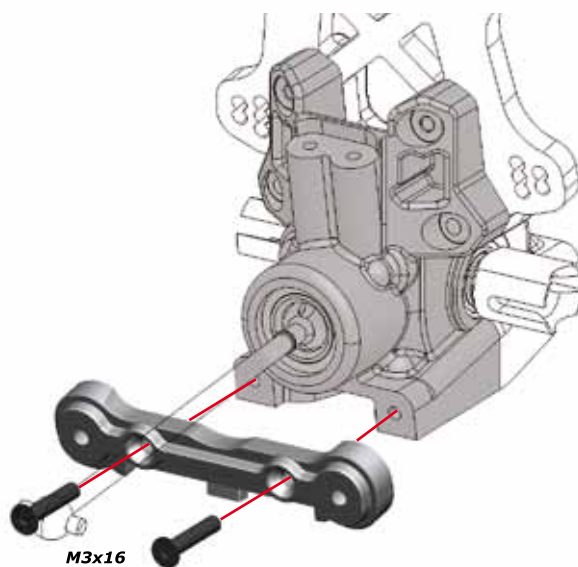

BIB

11

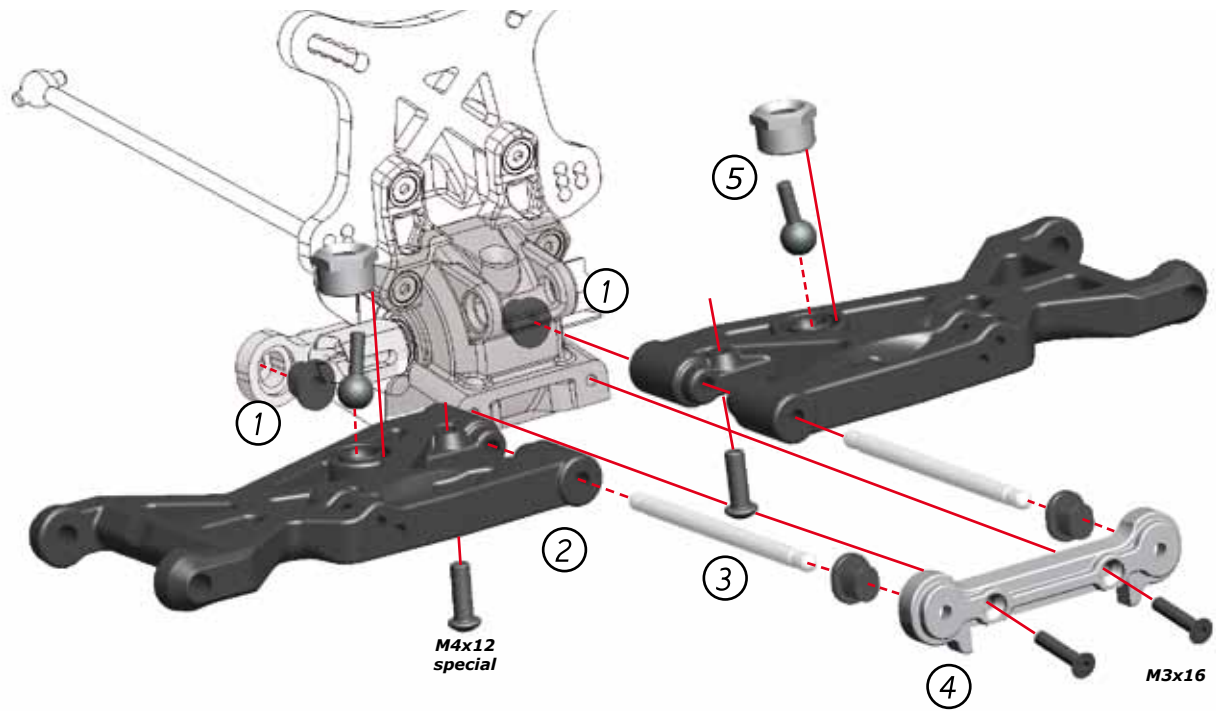

proper insert orientation
in the rear bracket

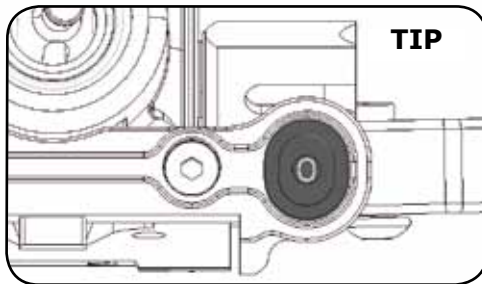

proper insert orientation
in the front bracket

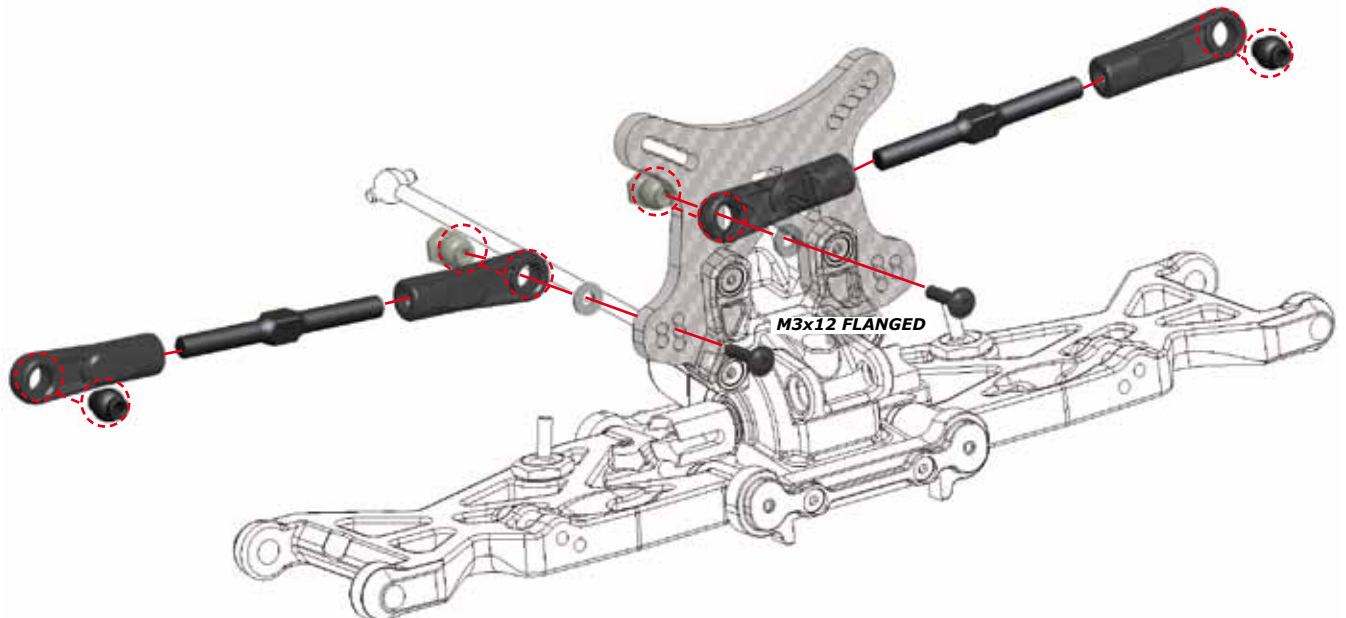
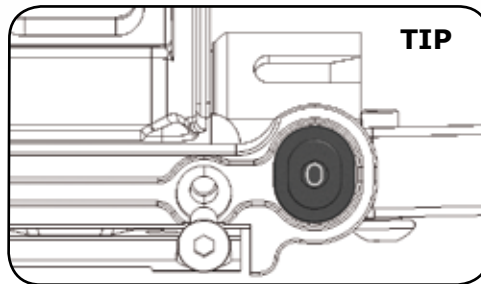

18.0MM

TIP



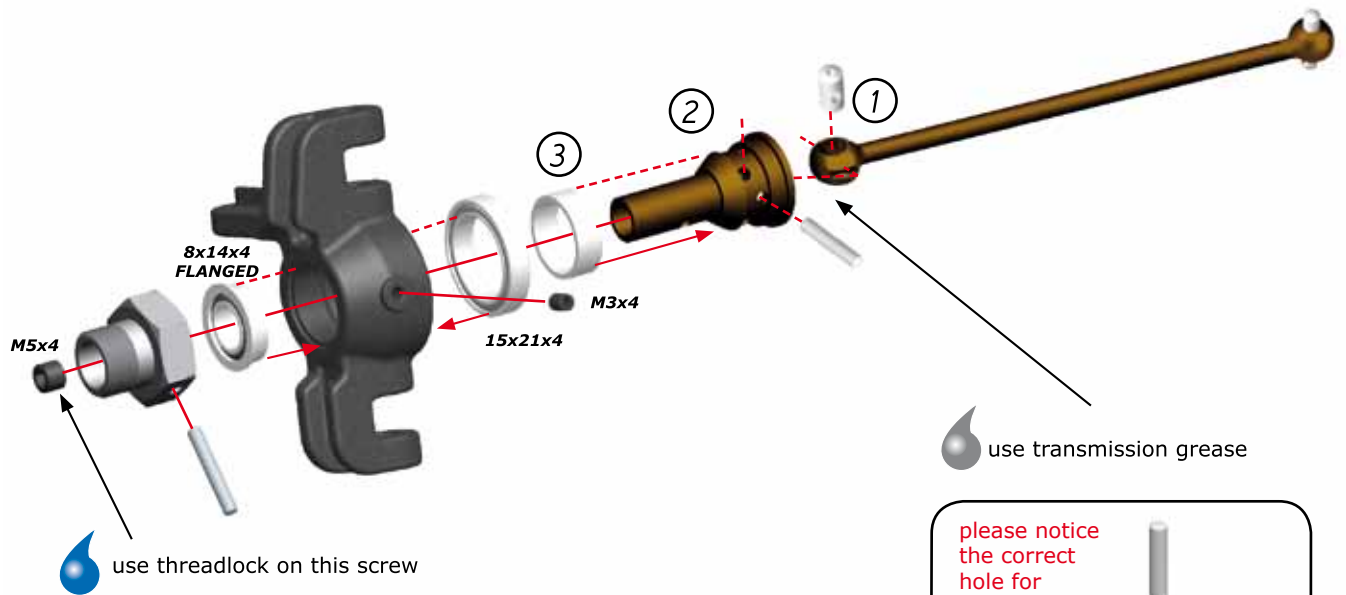

please notice
the correct
hole for
the pin

TIP

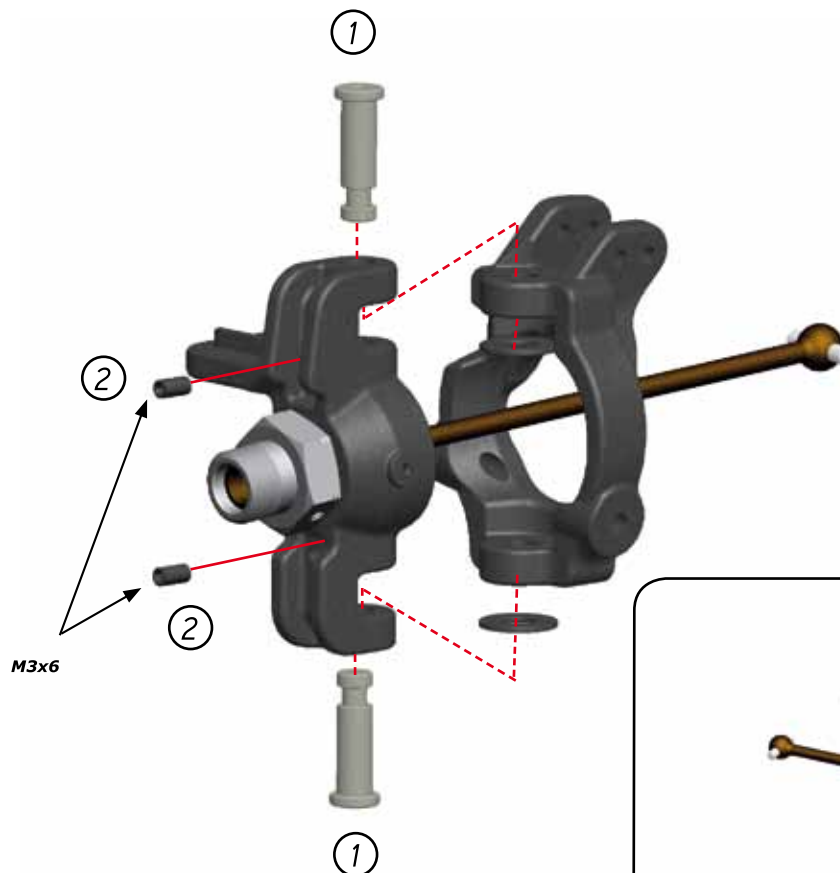

TIP

Left hand side

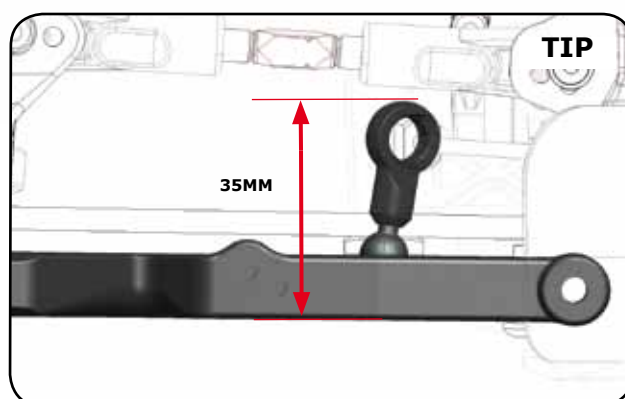
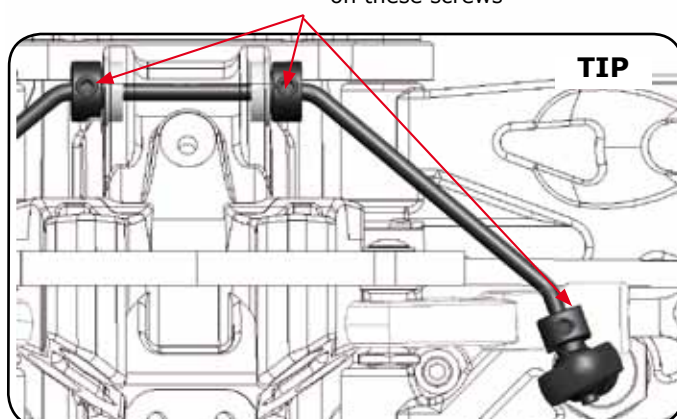
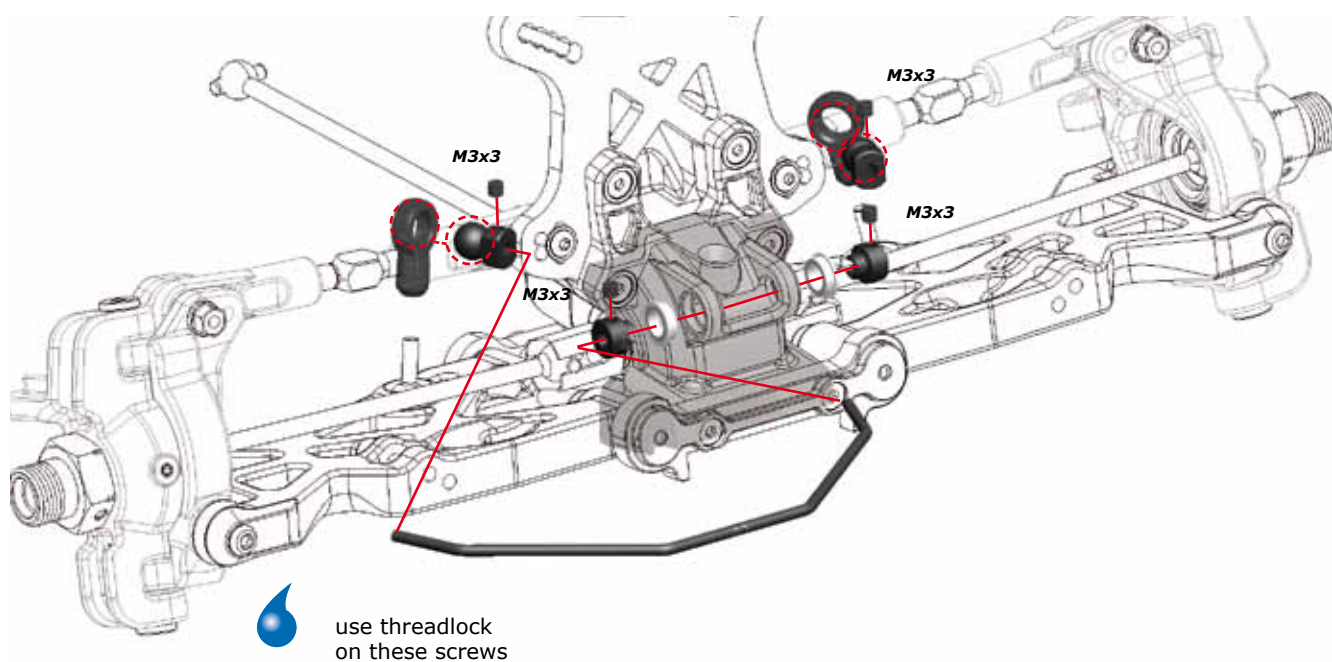
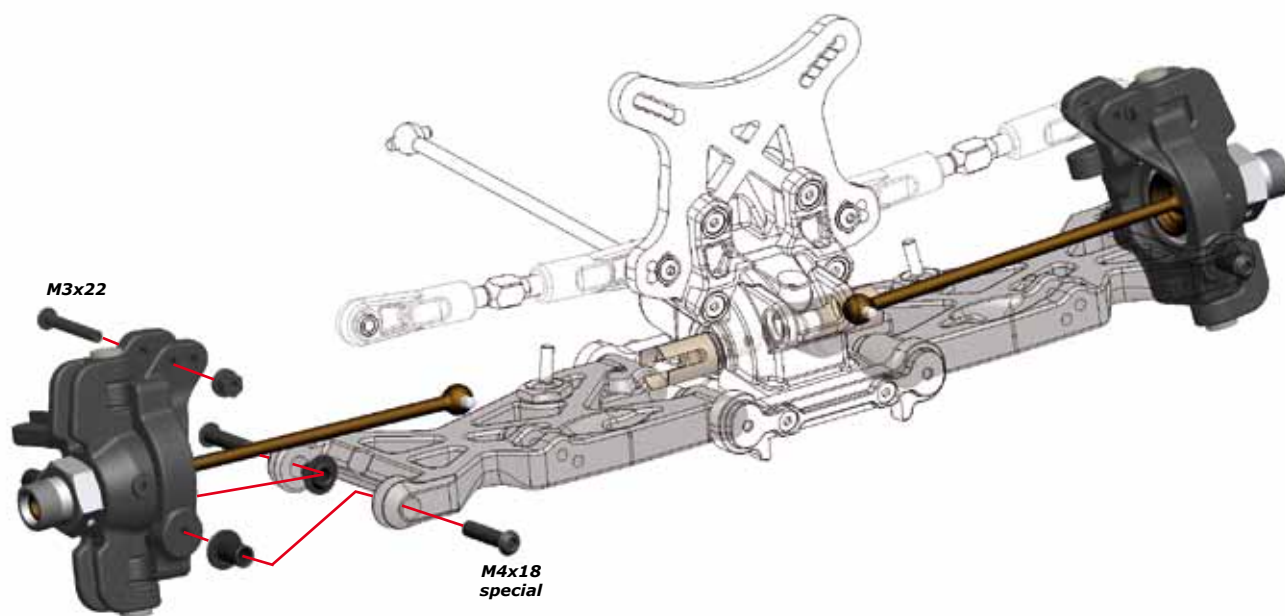

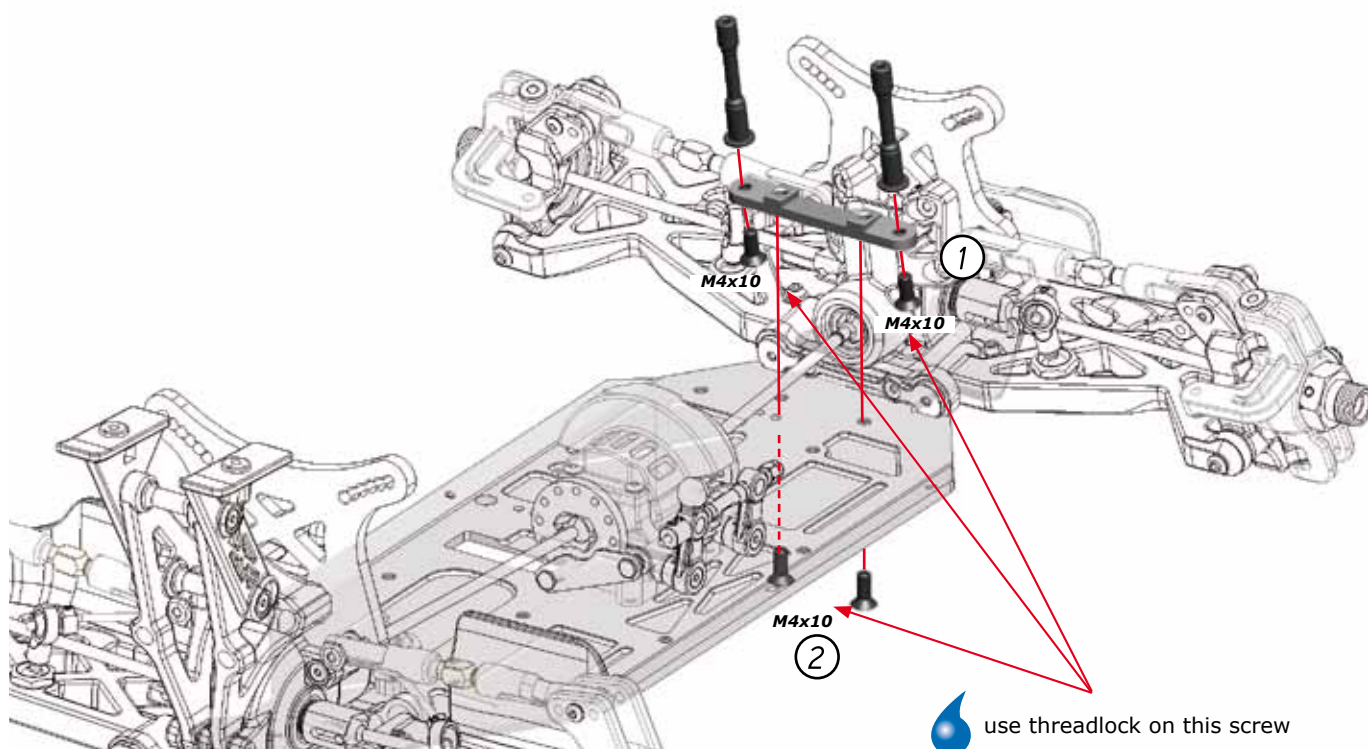
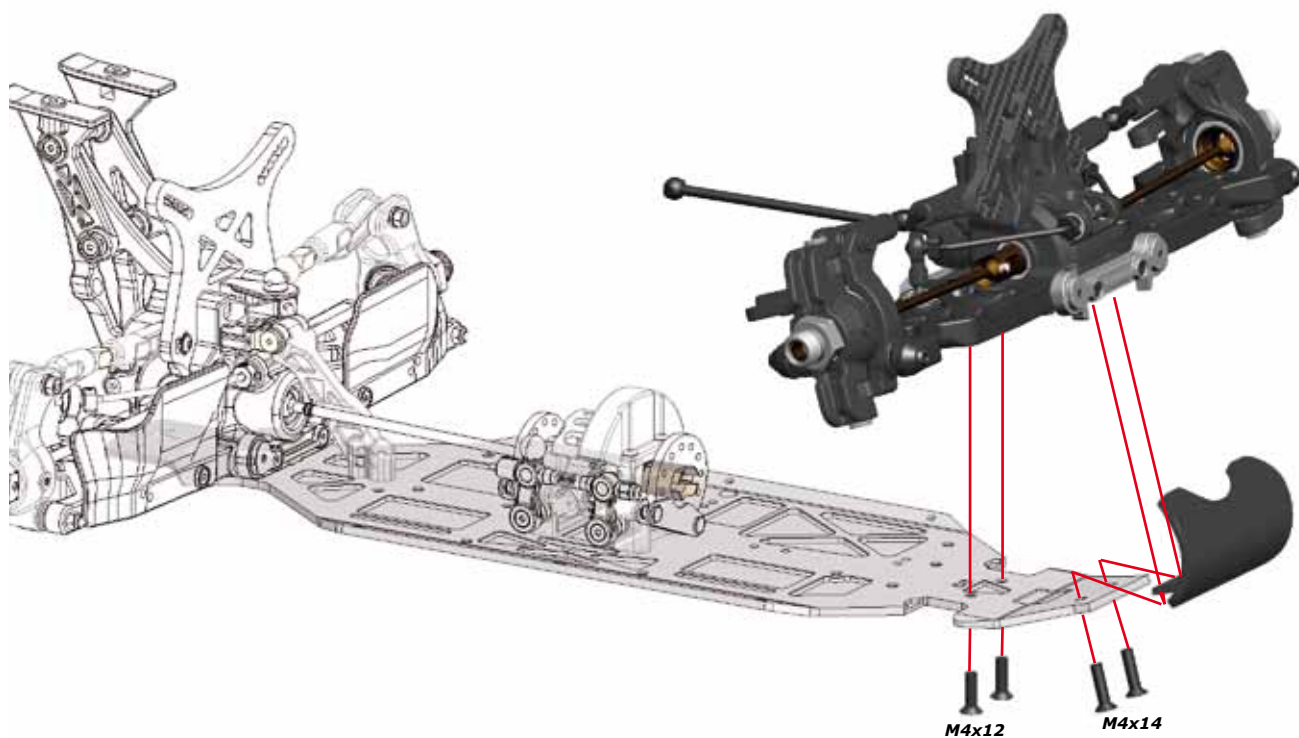

A

34

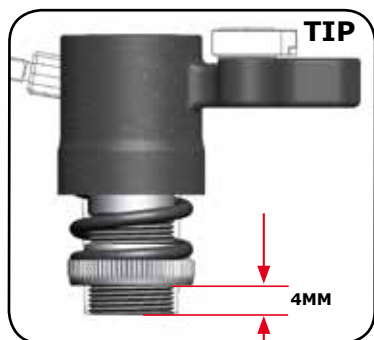

A

35

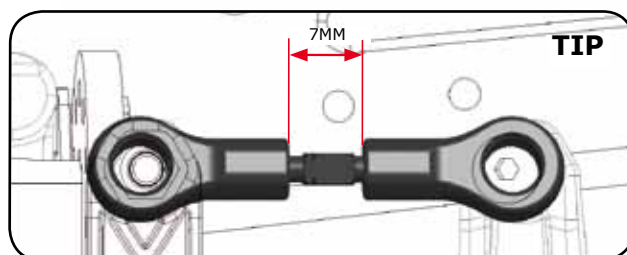
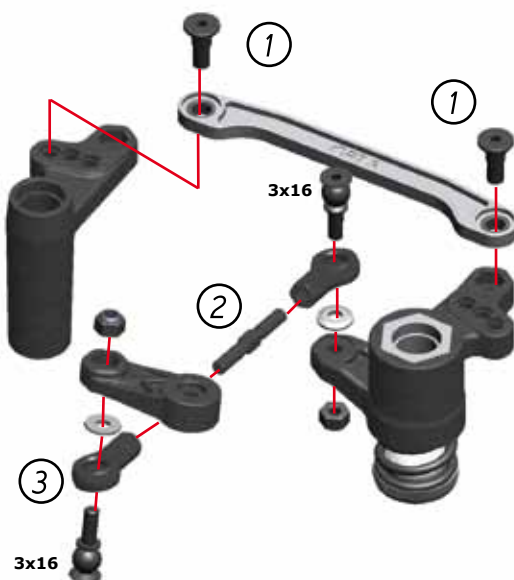

A

36

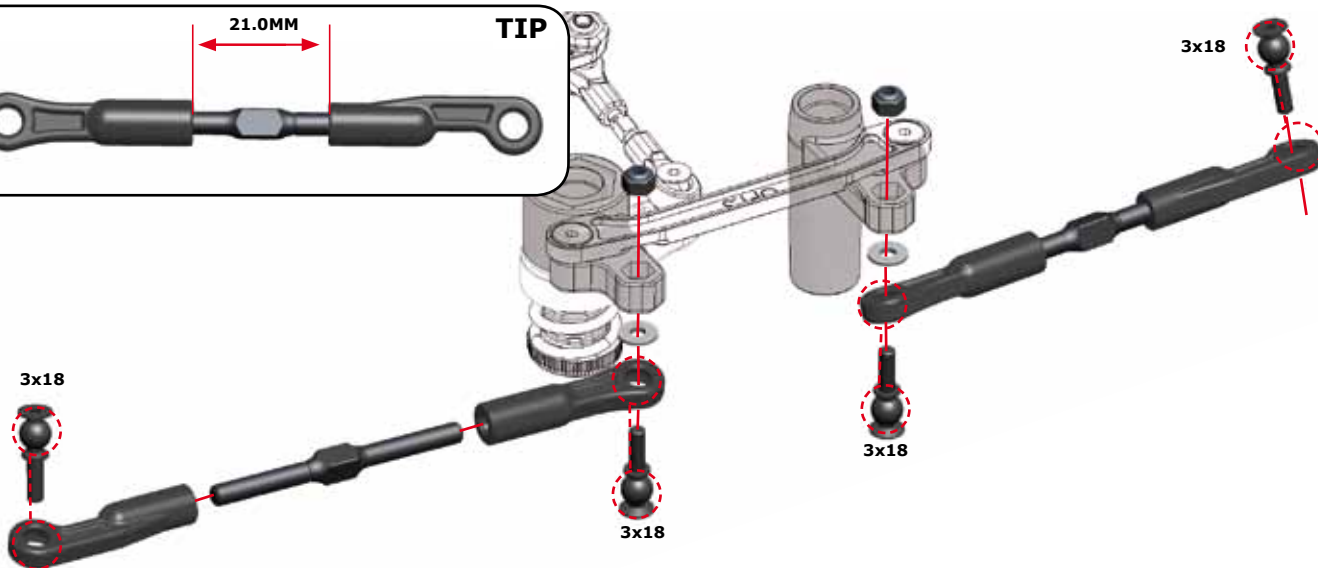
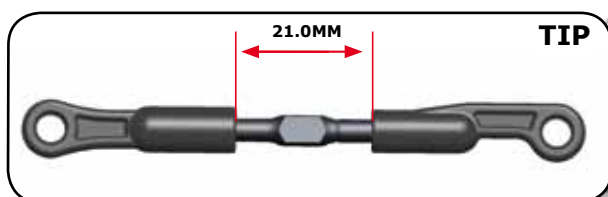

A

37

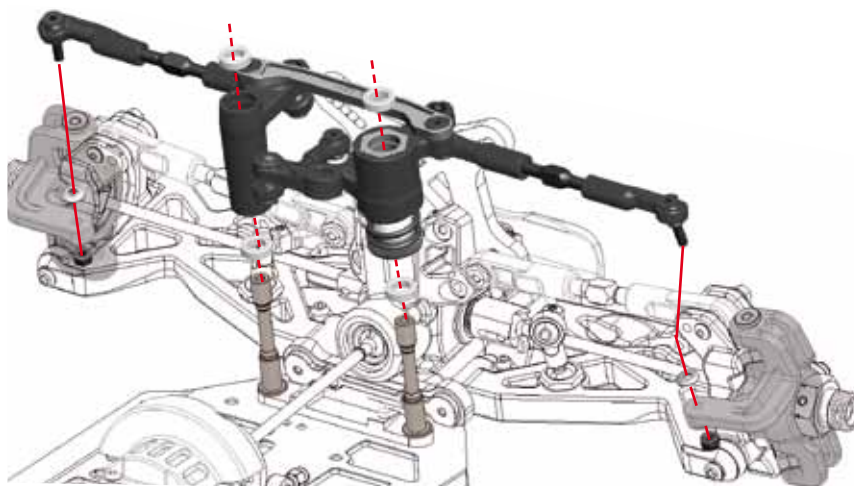

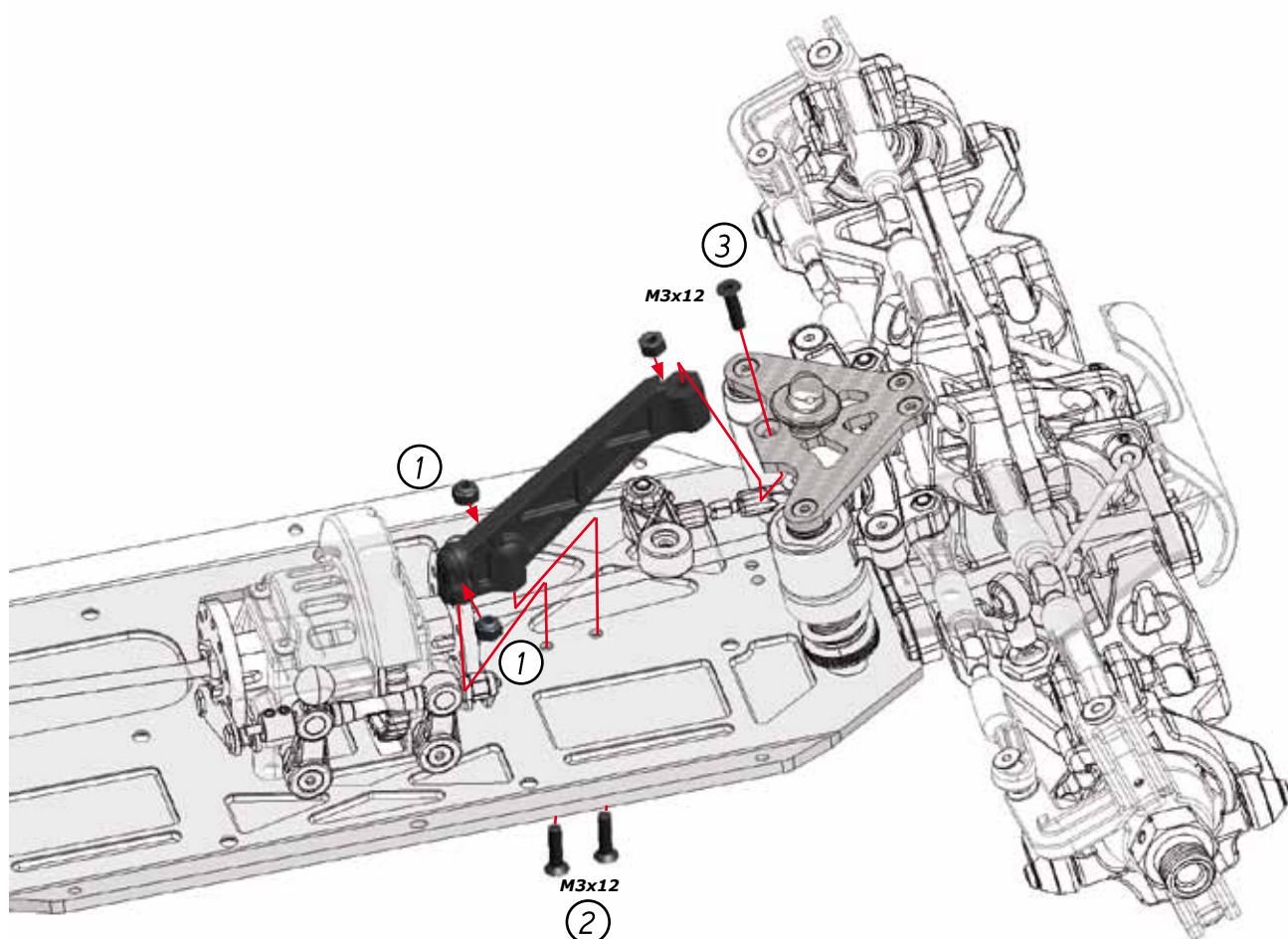
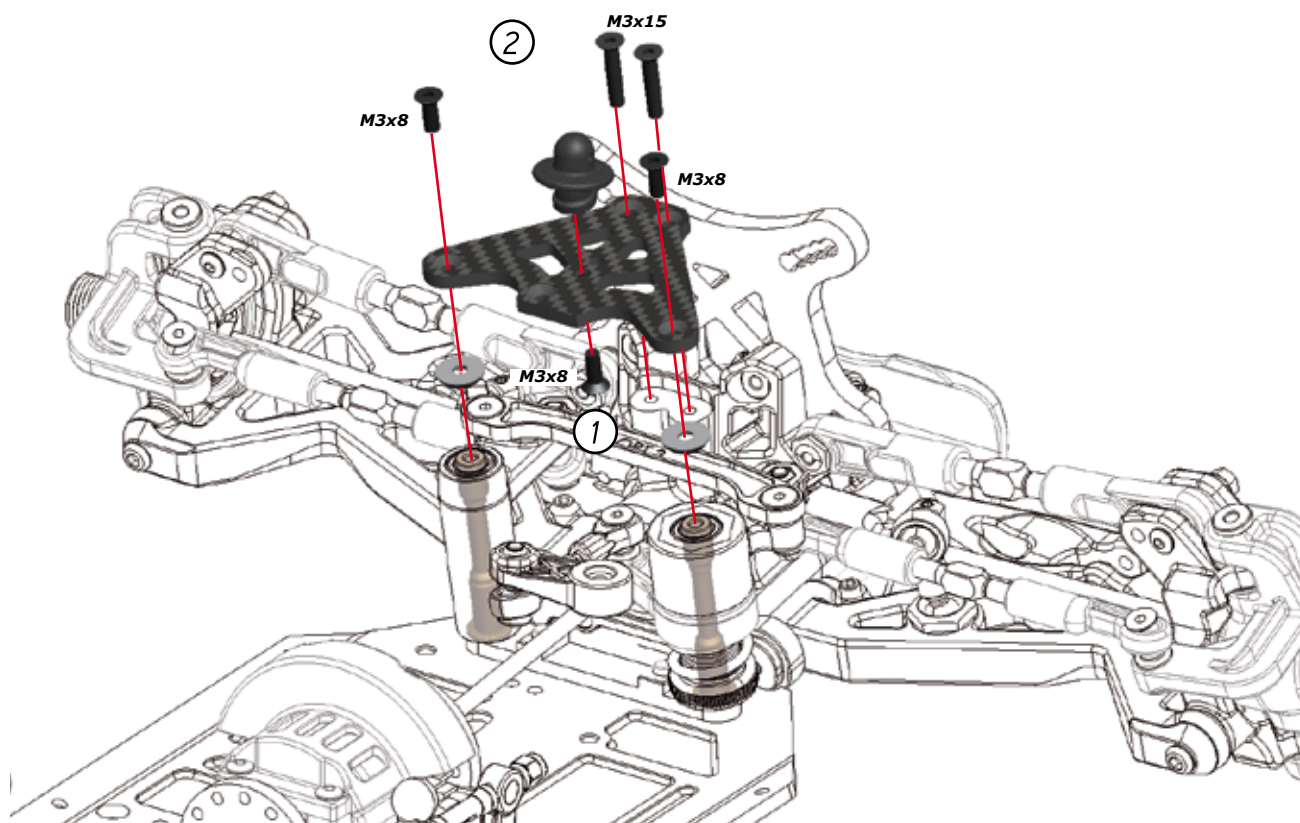

B

CLUTCH / ENGINE

1

BAG

8

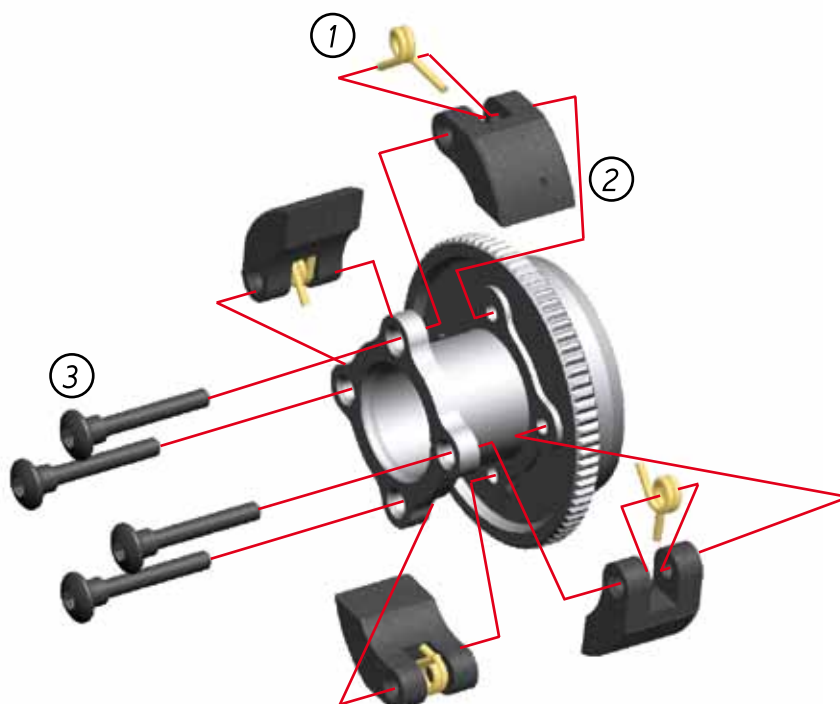

B

2

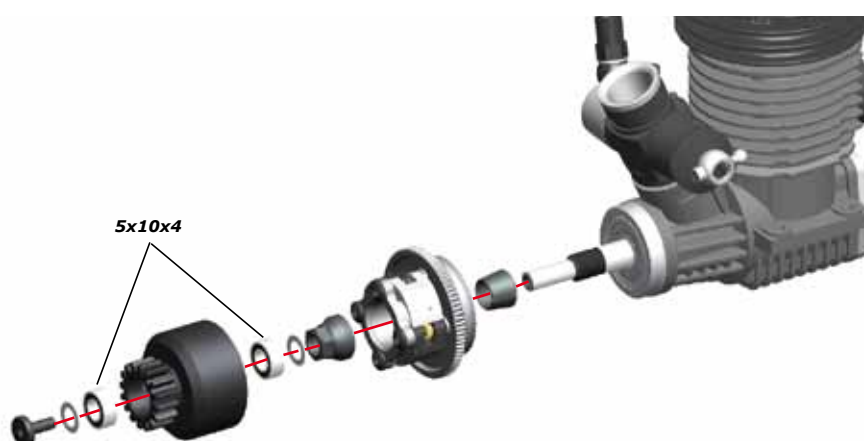

B

3

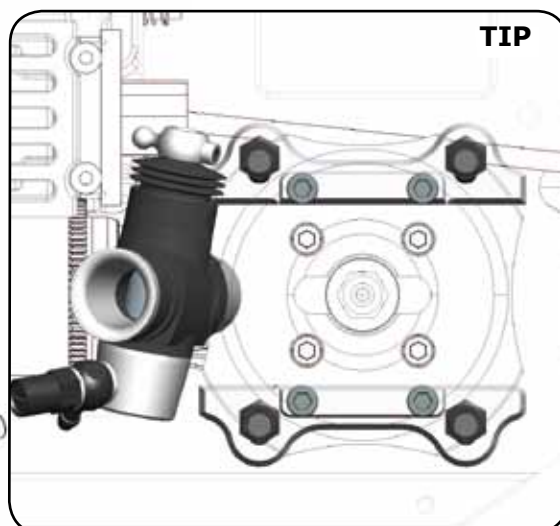
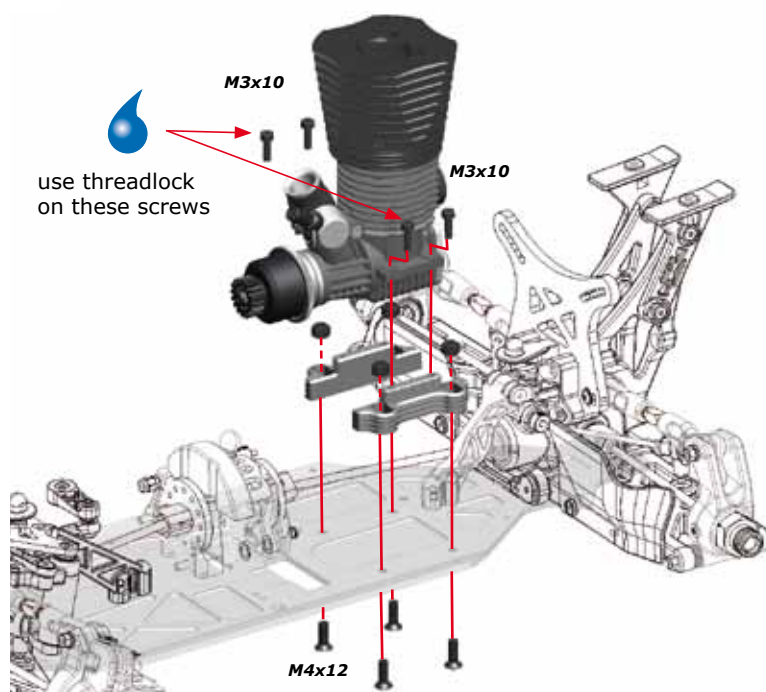

SIDE-GUARD / RADIO ASSEMBLY

C

1

BAG

9

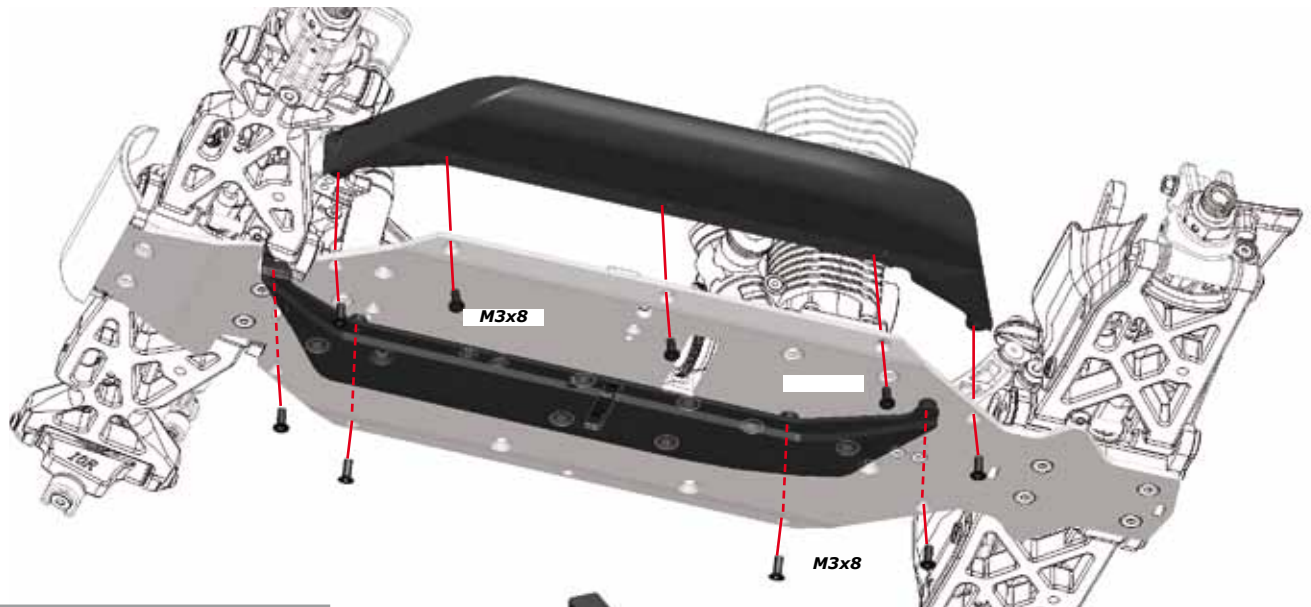

C

2

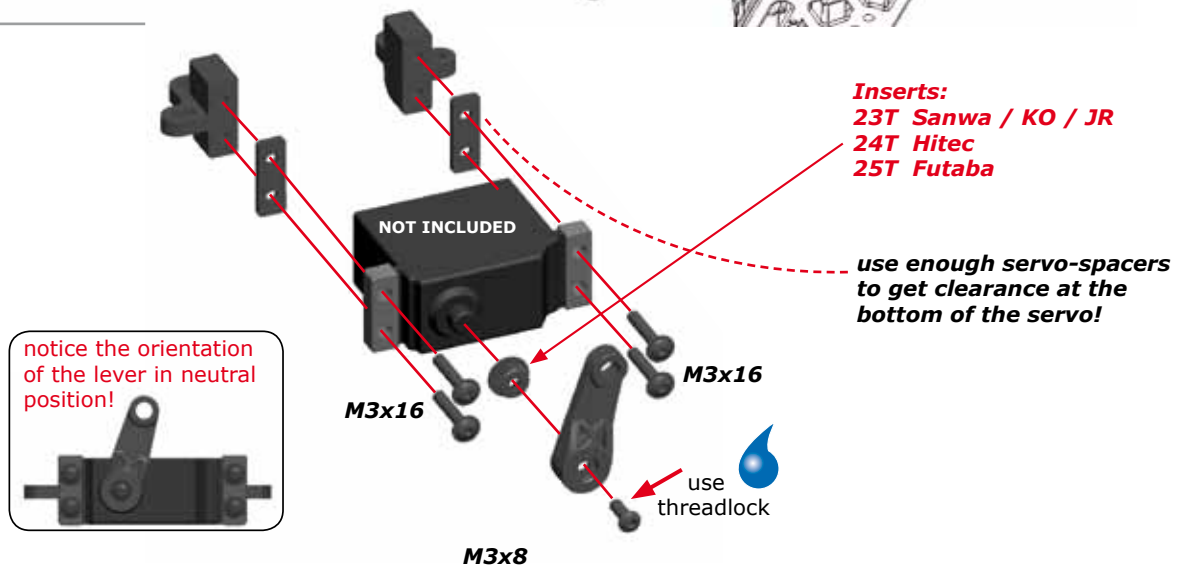

C

3

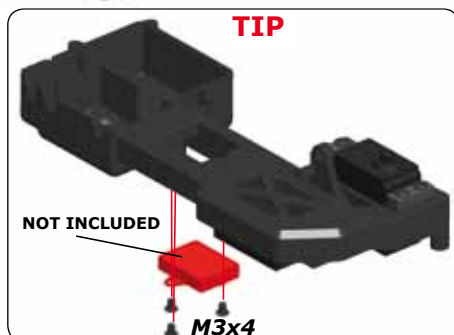
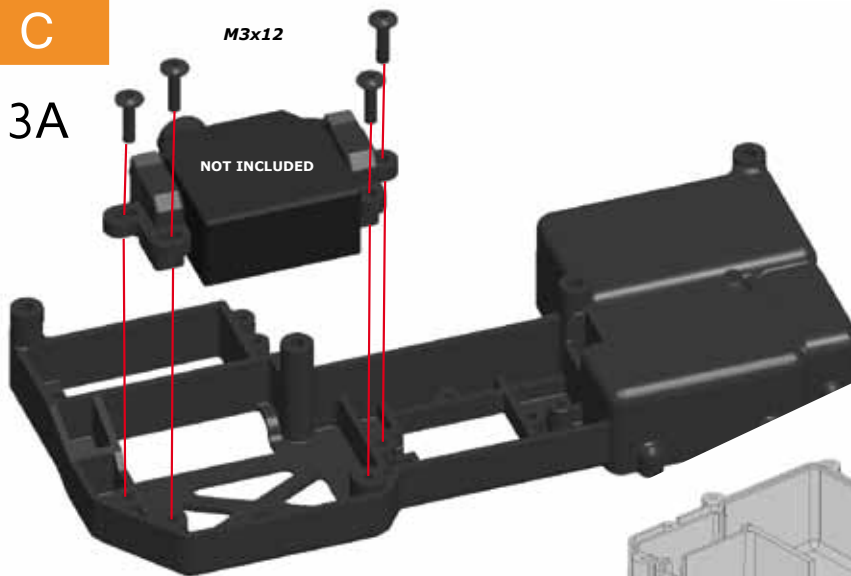

C

3B

use enough servo-spacers to get clearance at the bottom of the servo!

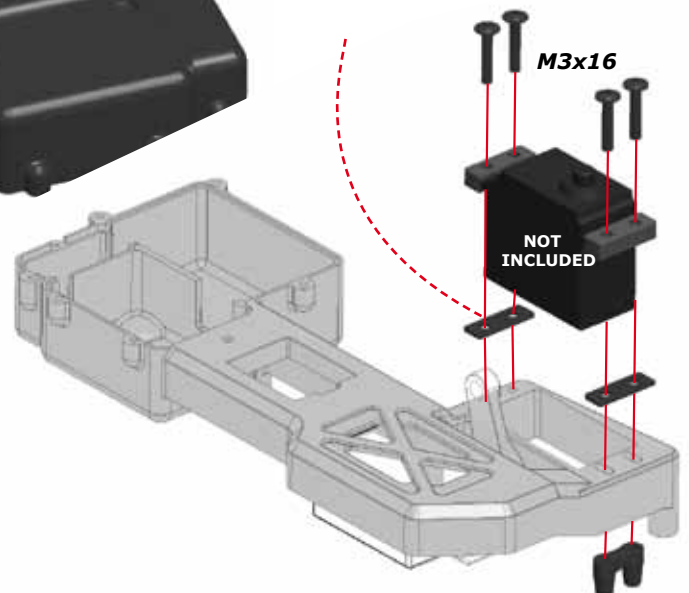

C

4

M2x10

②

①

TIP

C

5

M3x20

C

6

M3x8

M3x3

NOT INCLUDED

NOT INCLUDED

C

7

M3x3

40mm

95mm

90mm

24mm

C

8

C

8

M3x8

M4x10

TIP

B11B

20

FRONT/REAR SHOCK ASSEMBLY

D

1

**BAG
10/11**

D

2

D

3

D

4

D

5

D

6

BIB

21

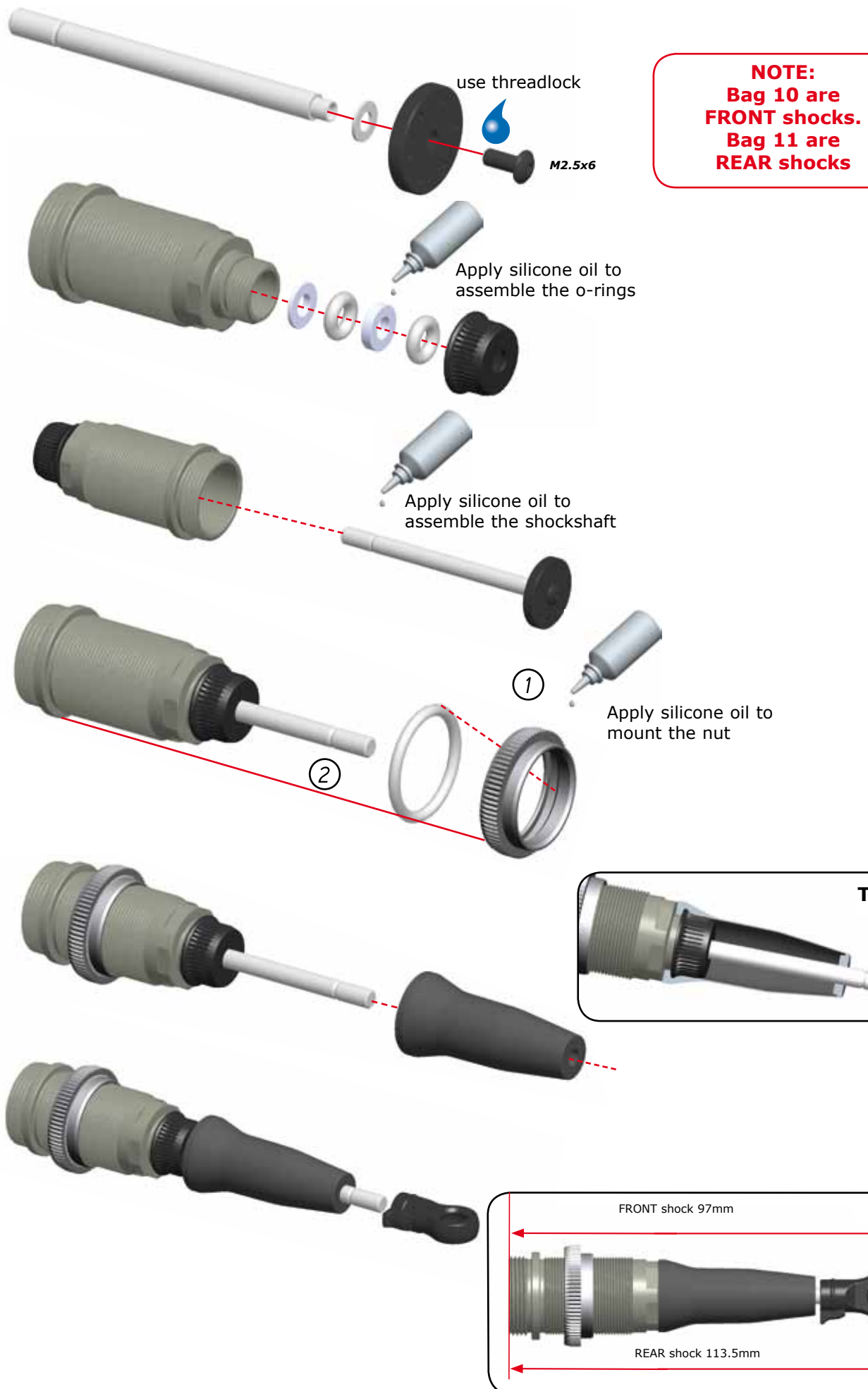



Push membrane into the shock top



- Fill up with silicone oil
- Wait for air bubbles to escape
- Close top only 3/4
- Check default SET-UP sheet for CST value of silicone oil

Close fully

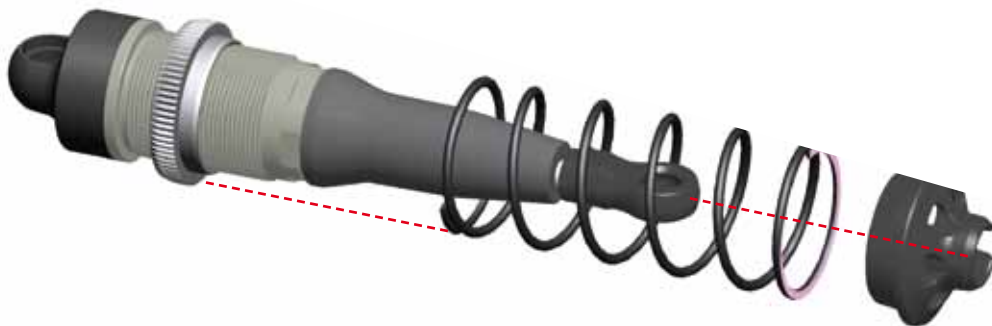

SCHOCK MOUNTING

D

10

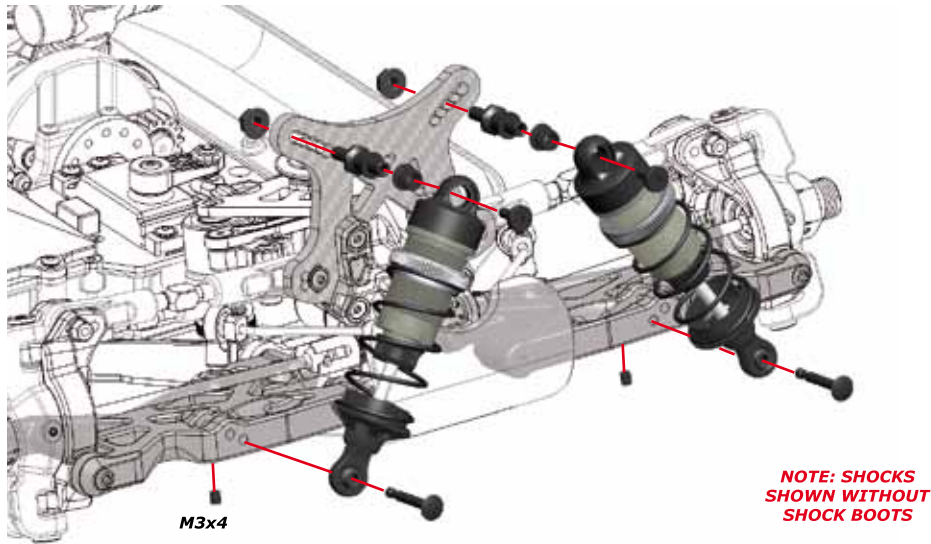

D

11

BAG

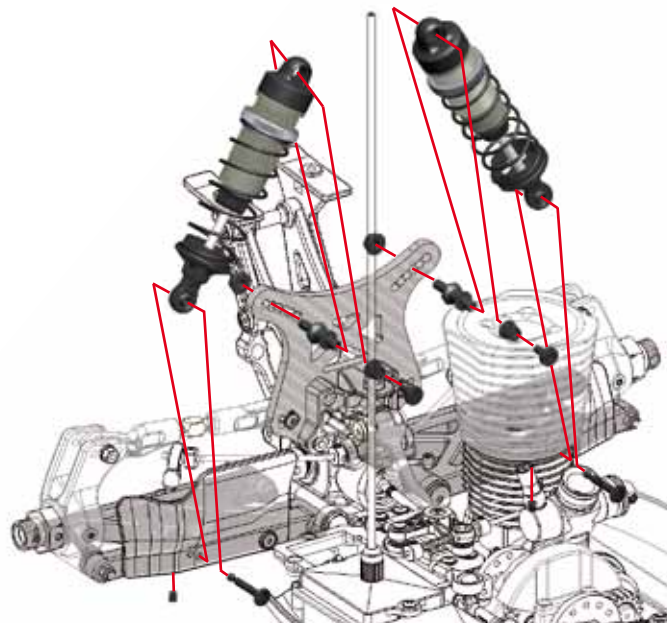

D

12

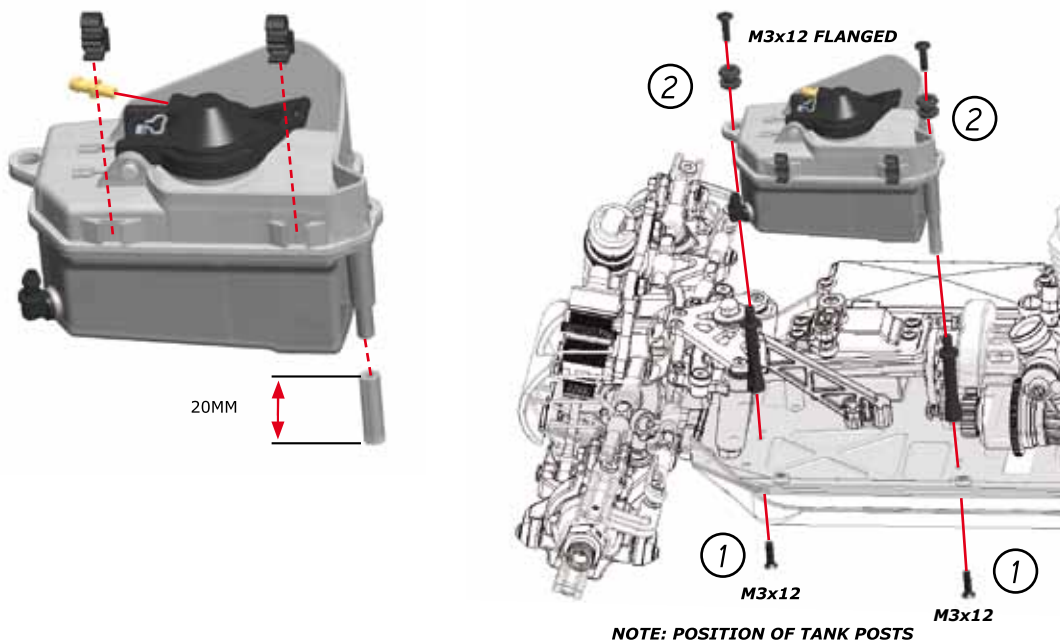

BIB

23

FINAL ASSEMBLY

E

1

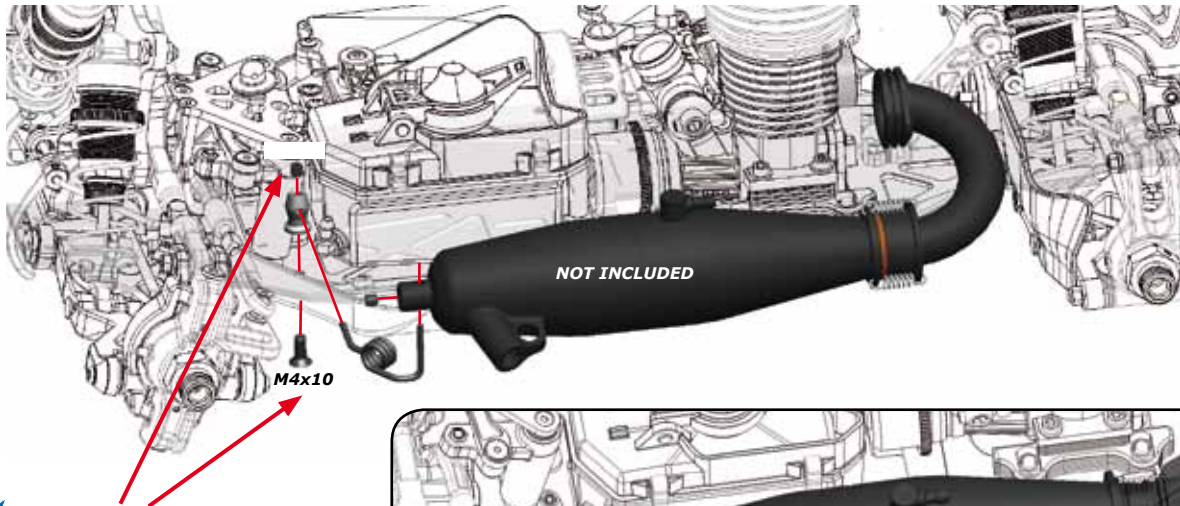

use threadlock on these screws

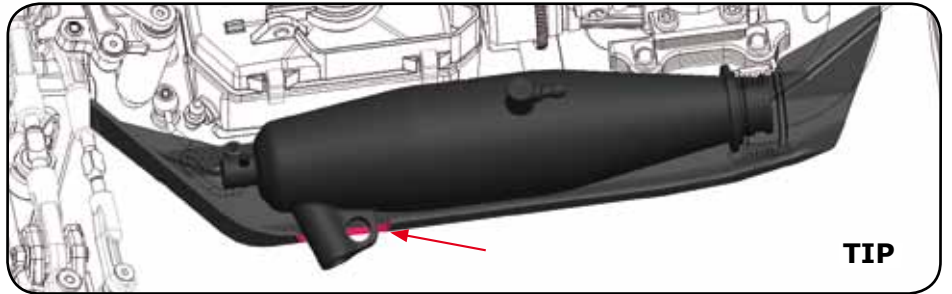

TIP

E

2

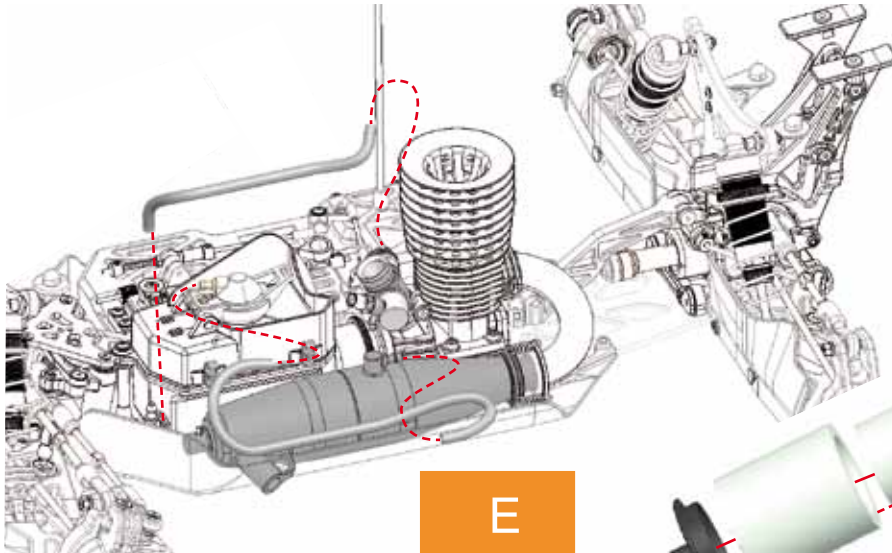

E

3

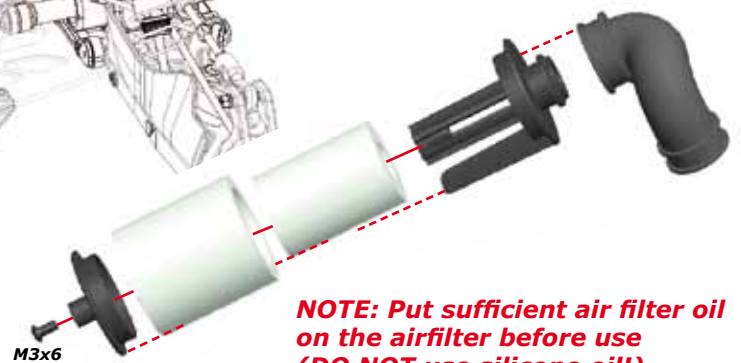

NOTE: Put sufficient air filter oil on the airfilter before use (DO NOT use silicone oil!)

E

3A

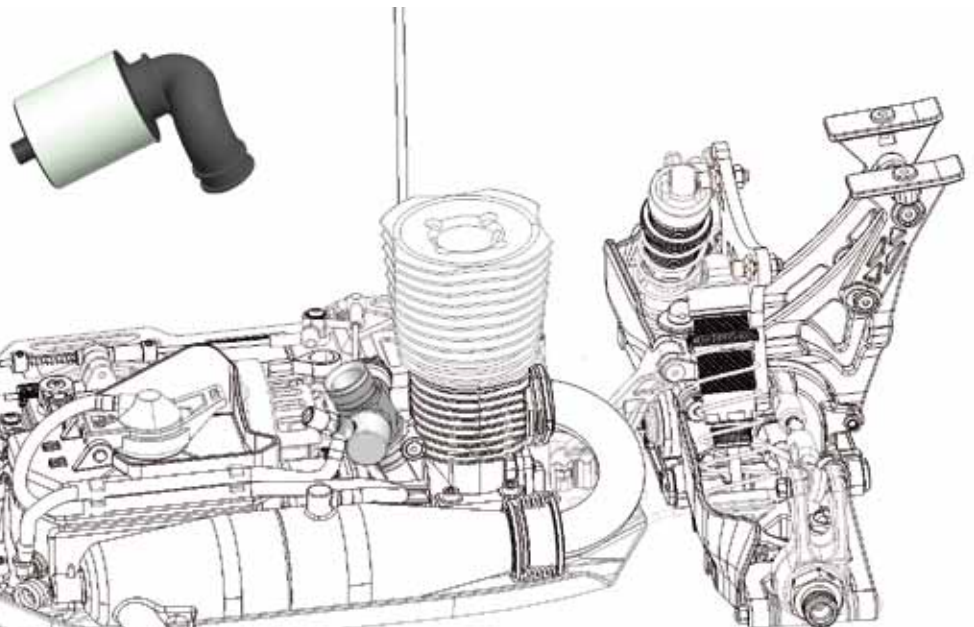

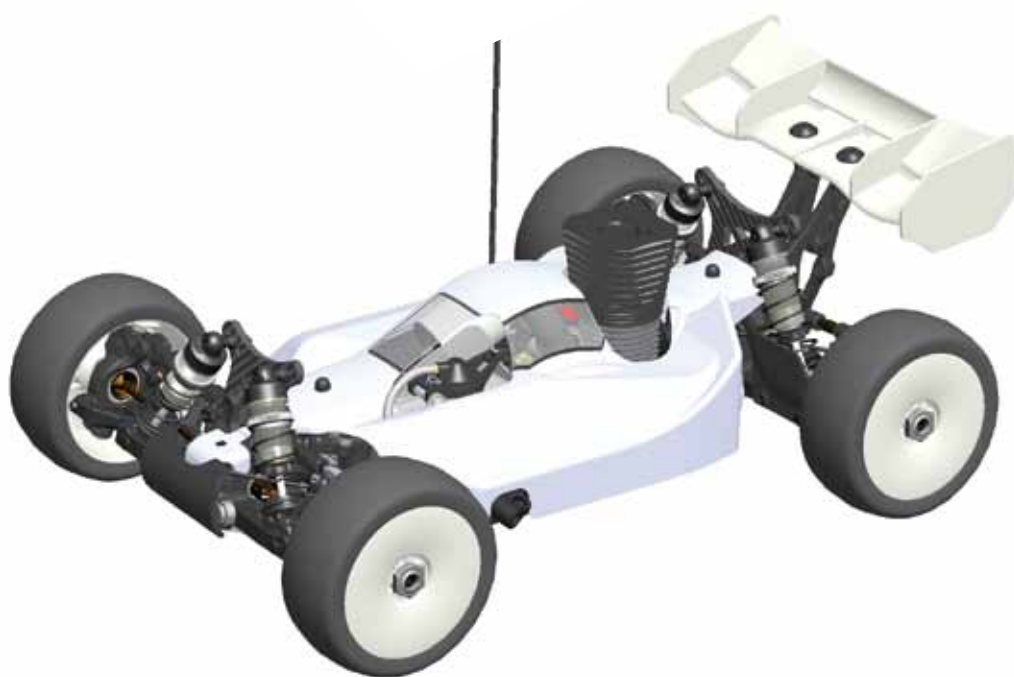
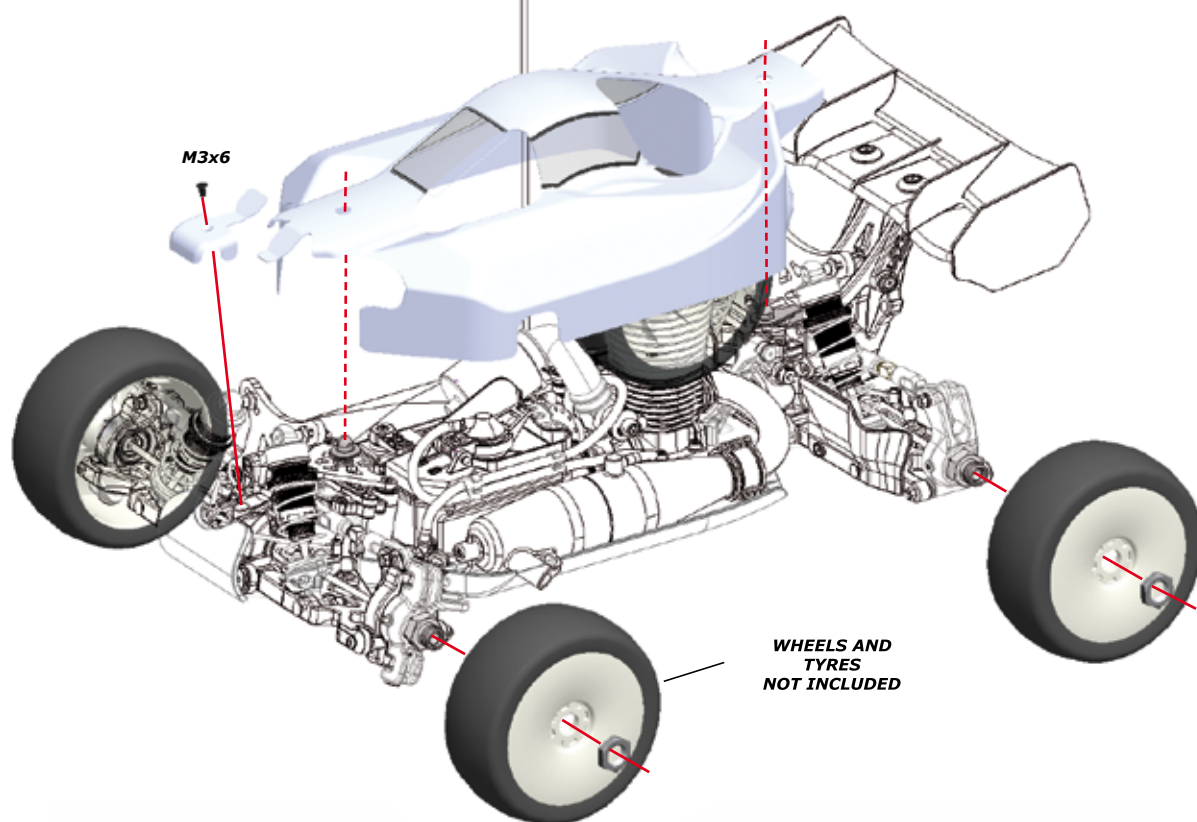
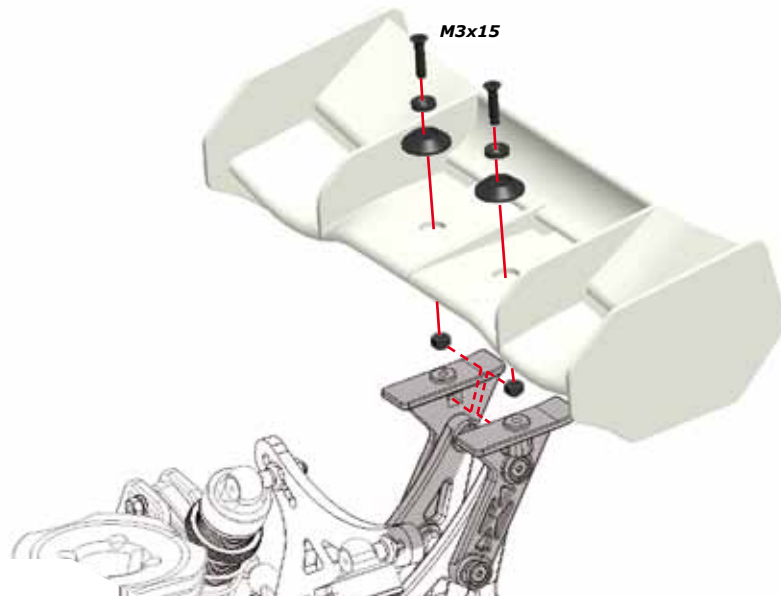

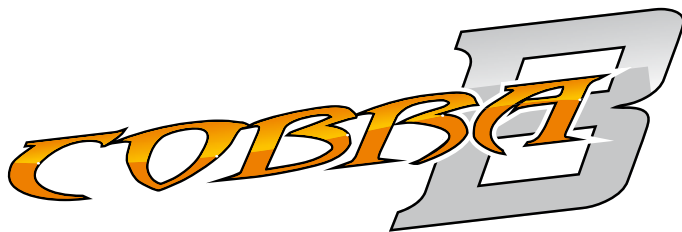

REFERENCE GUIDE AND EXPLODED VIEWS

Description

600001 Serpent 811 Cobra 1/8 4wd
Buggy EVO

Manual & Decals

600327 Manual S811 Cobra
600329 Decal sheet S811 black/white (2)
600332 Decal sheet S811 chrome (2)

Radio Installation / Battery

1606 Antenna rod black (2)
1639 Collar alu + Setscrew (4)
600121 Brake levers / adjusters
600127 Throttle / steering lever set
600131 Balljoint set (19)
600157 Collar double (2)
600207 Rod steering servo 26mm
600333 Brake / Throttle links (2)
600358 Radiobox V2 (3)
600359 Servo lever / mounts V2 (30)
600360 Throttle lever shaft (1)
600361 Throttle balls (2+1)
600362 Collar set V2 (3)
600363 Throttle rod V2 (1)
804181 Throttle spring (2)

Radio Instalation / Battery option

600272 Steering servo rod titanium
600290 Servo lever steering 23T alu
600291 Servo lever steering 24T alu
600292 Servo lever steering 25T alu
600293 Servo lever throttle 23T alu
600294 Servo lever throttle 24T alu
600295 Servo lever throttle 25T alu

Servo Saver & Steering

600105 Servosaver spring
600109 O-ring servosaver nut (4)
600128 Servo saver set nylon (3)
600131 Balljoint set (19)
600153 Topdeck front carbon
600167 Steeringrack mount
600169 Servosaver adjust nut
600170 Servosaver shaft outer
600173 Steeringrack option 3
600182 Bolt steeringrack (2)
600191 Pivotball 6mm steering (4)
600199 Servosaver post (2)
600207 Rod steering servo 26mm
600227 Pivot ball steering rod (2)
600334 Spacer steering post (2)

Servo Saver & Steering option

600171 Steeringrack option 1
600172 Steeringrack option 2
600272 Steering servo rod titanium
600278 Servo saver post alu (2)
600296 Servosaver alu coated (3)
600330 Servo saver spring hard

Fuel tank and parts

1493 Pressure nipple m3 (4)
1494 Silicone tubing 2x5x50 white
600115 Tank mounting rubber (4)
600116 O-ring tank (4)
600117 Tank cap seal silicone (2)
600123 Clip /plug set for fuel tube (6)
600142 Tank 125cc with filter
600335 Post fuel tank (2)

Shock Absorbers

600111 Shock membrane (10)
600112 O-ring shock bottom (10)
600113 O-ring shock nut (10)
600118 Shock part frame nylon (10)
600145 Shock pistons (4x4)
600158 Adjust nut shock / oring (2)
600159 Shock top alu (2)
600160 Shock body coated rear (2)
600161 Shock body coated front (2)
600179 Shock mount (2)
600180 Washer shock shaft (4)
600184 Pivotball 6.75 double (4)
600194 Shockshaft FR (2)
600195 Shockshaft RR (2)
600234 Shock cartridge stepped (4)
600235 Shock cartridge (4)
600317 Shockset fr (2)
600318 Shockset rr (2)
600319 Shock revision set (20)
600331 Shock boot (4)

Shock Absorbers option

600282 Shock bushing delrin (4)
600287 Shock spring support alu (4)
600306 Shock shaft FR TiNi coating (2)
600307 Shock shaft RR TiNi coating (2)
600347 Shock top 7075 hard anodized (2)
600349 Shock pistons conical 6 hole (4)
600350 Shock pistons conical 8 hole (4)
600351 Shock pistons conical 10 hole (4)
600357 Membrane webbed silicone (4)

Shock Springs

600245 Spring set FR pink 4.8lbs (2)
600246 Spring set FR blue 5.0lbs (2)
600247 Spring set FR purple 5.2lbs (2)
600248 Spring set FR green 5.4lbs (2)
600249 Spring set FR grey 5.6lbs (2)
600250 Spring set FR yellow 5.8lbs (2)
600251 Spring set FR white 6.0lbs (2)
600252 Spring set RR pink 2.8lbs (2)
600253 Spring set RR blue 3.0lbs (2)
600254 Spring set RR purple 3.2lbs (2)
600255 Spring set RR green 3.4lbs (2)
600256 Spring set RR grey 3.6lbs (2)
600257 Spring set RR yellow 3.8lbs (2)

600258 Spring set RR white 4,0lbs (2)
 600259 Spring set FR (7x2)
 600260 Spring set RR (7x2)

Chassis / Guards

600122 Brace front / rear nylon
 600139 Sideguard L+R
 600140 Mudguard L+R
 600141 Bumper
 600154 Chassis alu 7075 T6 anodised

Chassis / Guards Optional

600288 Chassis brace front alu
 600289 Chassis brace rear alu

Front Section

600101 Wheelaxle clip (4)
 600102 Driveshaft 98mm (2)
 600107 Wheelaxle (2)
 600108 Hingepin (2)
 600124 Bodymount FR+RR
 600126 Washer/nut nylon M3 (12+15)
 600129 Diff case front set
 600131 Balljoint set (19)
 600132 Suspension bracket inserts (30)
 600135 Wishbone front L+R
 600136 C-Hub 10 L+R
 600137 Steeringblock L+R
 600151 Shocktower front carbon
 600153 Topdeck front carbon
 600167 Steeringrack mount
 600168 Camberlink pivotball (4)
 600174 Antirollbar nut (2)
 600176 Suspension bracket alu FR RR std
 600177 Suspension bracket alu FR FR std
 600178 Shim conical M3x7.5x1 (10)
 600182 Bolt steeringrack (2)
 600183 Bushing suspensionarm (4)
 600185 Pivotball 7.5 double (4)
 600186 Track rod M4x51 (2)
 600187 Track rod M5x46 (2)
 600190 Pin steeringblock (4)
 600192 Pivotball antirollbar (2)
 600193 Pivotball threaded antirollbar (2)
 600197 Driveshaft insert (2)
 600222 Wheelnut 17mm (4)
 600223 Wheelhexagon (4)
 600224 Bolt shock (4)
 600225 Droop Screw (4)
 600241 Antiroll bar front 2.5mm
 600261 Socket Screw M3x8 (6)
 600326 Special Screw fr whisbone (4)
 600364 Gear coupler steel v2
 600381 Gear coupler rubber boot (2)
 903343 Antirollbar Spacer 3mm (2)

Front Section Optional

600240 Antiroll bar front 2.3mm
 600242 Antiroll bar front 2.7mm
 600263 Washer M3 alu (12)
 600264 Wheelaxle alu (2)
 600268 C-Hub 12 L+R
 600269 Track rod M5x46 titanium (2)
 600271 Track rod M4x51 titanium (2)
 600273 Shock mount titanium (2)
 600274 Wheelhexagon light -2mm (2)

600275 Wheelhexagon light -1mm (2)
 600276 Wheelhexagon light -0mm (2)
 600284 Shocktower FR alu light
 600297 Lightweight wheel nut 17mm (4)
 600303 C-hub 10 L+R alu
 600304 C-hub 12 L+R alu
 600305 Steering block L+R alu
 600309 Antiroll bar shaft FR
 600311 Antiroll bar wire 1.8mm (2)
 600312 Antiroll bar wire 2mm (2)
 600313 Antiroll bar wire 2.1mm (2)
 600314 Antiroll bar wire 2.3mm (2)
 600315 Antiroll bar wire 2.5mm (2)
 600316 Antiroll bar wire 2.7mm (2)
 600336 Antiroll bar front 1.8mm
 600337 Antiroll bar front 2.0mm
 600343 Bushing / spacer Steering block alu (8)

Middle Section

600100 Exhaust mounting wire (2)
 600103 Driveshaft center front
 600104 Driveshaft center rear
 600119 Center diff holder parts (3)
 600131 Balljoint set (19)
 600148 Diskbrake front fibreglass
 600149 Diskbrake rear fibreglass
 600164 Brake excenter (2)
 600165 Brake lever insert (2)
 600166 Exhaust mount alu
 600181 Bolt brake plate (4)
 600196 Gear coupler steel
 600197 Driveshaft insert (2)
 600198 Spurgear 46T
 600203 Brake plate (4)
 600208 Brake spring (4)
 600221 Engine mount (2)
 600226 Brake piston solid (2)
 600236 Airfilter boot
 600243 Airfilter + foam
 600340 Airfilter foam set inner-outer (6)
 600341 Airfilter foam set inner-outer (10)
 600364 Gear coupler steel v2
 600369 Brake plate thick (2)
 600381 Gear coupler rubber boot (2)

Middle Section Option

600279 Spur gear 44T
 600280 Spur gear 48T
 600281 Brake piston /spring (2/2/2)
 600286 Center diff holder alu (2)
 600299 Engine monomount-set alu
 600342 Mono enginemout top (2)
 600345 Brake set pro
 600346 Brake pad Pro (2)

Rear Section

600101 Wheelaxle clip (4)
 600102 Driveshaft 98mm (2)
 600107 Wheelaxle (2)
 600108 Hingepin (2)
 600124 Bodymount FR+RR
 600125 Upright L+R
 600126 Washer/nut nylon M3 (12+15)
 600130 Diff case rear set
 600131 Balljoint set (19)

600132 Suspension bracket inserts (30)
 600133 Wing mount set
 600134 Wishbone rear L+R
 600143 Wing white nylon
 600152 Shocktower rear carbon
 600155 Suspension bracket RR RR 3
 600156 Suspension bracket RR FR 2
 600168 Camberlink pivotball (4)
 600174 Antirollbar nut (2)
 600178 Shim conical M3x7.5x1 (10)
 600185 Pivotball 7.5 double (4)
 600188 Track rod M5x53 (2)
 600189 Hingepin RR outer (2)
 600192 Pivotball antirollbar (2)
 600193 Pivotball threaded antirollbar (2)
 600197 Driveshaft insert (2)
 600204 Bolt transmission brace rear (2)
 600222 Wheelnut 17mm (4)
 600223 Wheelhexagon (4)
 600224 Bolt shock (4)
 600225 Droop Screw (4)
 600237 Antiroll bar rear 2.3mm
 600261 Socket Screw M3x8 (6)
 600364 Gear coupler steel v2
 600365 Spacers 1,25mm + 2,5mm
 for wheelbase (4+2)
 600381 Gear coupler rubber boot (2)
 903343 Antirollbar Spacer 3mm (2)

Rear Section option

600238 Antiroll bar rear 2.5mm
 600239 Antiroll bar rear 2.7mm
 600264 Wheelaxle alu (2)
 600265 Suspension bracket RR FR 2.5 - 4.5
 600266 Suspension bracket RR RR HR 3
 600267 Suspension bracket RR RR LR 3
 600270 Track rod M5x53 titanium (2)
 600273 Shock mount titanium (2)
 600274 Wheelhexagon light -2mm (2)
 600275 Wheelhexagon light -1mm (2)
 600276 Wheelhexagon light -0mm (2)
 600277 Wing black nylon
 600285 Shocktower RR alu light
 600297 Lightweight wheel nut 17mm (4)
 600300 Post wingmount alu (2)
 600301 Wing washer alu (2)
 600302 Upright L+R alu
 600308 Suspension bracket RR FR 2.5 - 4.5
 600310 Antiroll bar shaft RR
 600311 Antiroll bar wire 1.8mm (2)
 600312 Antiroll bar wire 2mm (2)
 600313 Antiroll bar wire 2.1mm (2)
 600314 Antiroll bar wire 2.3mm (2)
 600315 Antiroll bar wire 2.5mm (2)
 600316 Antiroll bar wire 2.7mm (2)
 600263 Washer M3 alu (12)
 600338 Antiroll bar rear 1.8mm
 600339 Antiroll bar rear 2.0mm
 600434 Antiroll bar rear 2.4mm

Differential

600110 O-ring diff outdrive (10)
 600144 Diff housing
 600147 Diff gasket (3)
 600198 Spurgear 46T
 600200 Diff outdrive (2)

600201 Diff gear 43T
 600202 Diff gear 10T + 20T (4+2)
 600205 Shim 13x16x0.2 (10)
 600209 Diff pin 10T (2)
 600210 Diff pin outdrive (2)
 600211 Diff pinion 10T
 600212 Shim 14x15.5x0.65 (10)
 600213 Shim 6x11.75x0.2 (10)
 600214 Shim 3.5x12x0.2 (10)
 600215 Shim 8x11x0.2 (10)
 600323 Diff Fr / Rr
 600324 Diff Center 46T
 600325 Diff uni
 600354 Shim 14x15.5x 0.65 (4)
 600356 Shim 14x15.5x0.2 (10)
 600376 Diff outdrive center (2)
 600421 Oring centerdiff V2 (10)
 600425 Diff housing V2

Differential Optional

600283 Diff pin 10T alu (2)

Clutch

600163 Flywheel alu
 600206 Clutch nut (2)
 600218 Clutch bell 15T
 600228 Clutch shoe carbon (4)
 600230 Clutch spring medium (4)
 600262 Clutch Screw (4)
 909519 shim centax 5x08x0.1(2)x0.3(1)
 600261 Socket Screw M3x8 (6)
 909519 shim centax 5x8x0.1(2)x0.3(1)

Clutch Optional

600216 Clutch bell 13T
 600217 Clutch bell 14T
 600219 Clutch bell 16T
 600220 Clutch bell 17T
 600229 Clutch spring soft (4)
 600232 Clutch spring X hard (4)
 600231 Clutch spring hard (4)
 600233 Clutch spring set (4x4)
 600298 Flywheel steel
 600244 Clutch-set alu / carbon
 600175 Clutchshoe alu (4)
 600355 Clutch shoe set Alu / Carbon (2+2)

Body

1667 Body-clip medium (10)
 600146 Body S811 Cobra + nose-cone
 600143 Wing white nylon

Body Optional

600277 Wing black nylon
 600439 Wing white low 811
 600440 Wing black low 811

Ball Bearings

1312 Ballbearing 5x8 flanged SS (2)
 1311 Ballbearing 5x8x2 (2)
 1315 Ballbearing 5x10x4 SS (2)
 1321 Ballbearing 6x10x3 SS (2)
 1337 Ballbearing 15x21x4 SS (2)
 1393 Ballbearing 13X19X4 SS (2)
 1394 Ballbearing 8x14x4 flanged SS (2)
 600322 Bearingset S811 (32)
 600435 Bearingset small S811 (14)

Fastening Materials

110100	Screw allen countersunk m3x10 (10)	110159	Screw allen countersunk M3x18 (10)
110101	Screw allen countersunk m4x8 (10)	110160	Screw allen cilinderhead M2,2x12 (10)
110102	Screw allen countersunk m4x10 (10)	110161	Screw allen cilinderhead M2x6 (10)
110103	Screw allen countersunk m4x16 (10)	110162	Setscrew allen M3x2,5 (10)
110104	Screw allen countersunk M3x8 (10)	110200	Pin 2.5x8 (10)
110105	Screw allen countersunk m4x12 (10)	110201	Pin 3x12 (10)
110106	Screw allen flanged roundhead m5x12(10)	110202	Pin 5x5 (10)
110107	Screw allen cilinderhead m3x16 (10)	110203	Pin 3x14 (10)
110108	Screw allen roundhead m3x6 (10)	110204	Pin 3x20 (10)
110109	Screw allen roundhead m3x10 (10)	110205	Pin 3x22 (10)
110110	Screw allen roundhead m3x16 (10)	110206	Pin 2.5x22 (10)
110111	Screw allen roundhead m3x14 (10)	110207	Pin 2.5x12 (10)
110112	Screw allen roundhead m3x12 (10)	110208	Pin nra 2x9.8 (4)
110113	Screw allen roundhead m4x8 (10)	110209	Pin nra 2x18 (4)
110114	Setscrew allen m3x8 (10)	110210	Pin 3x13 (10)
110115	Setscrew allen m3x4 (10)	110211	Pin 2.5x13 (10)
110116	Setscrew allen m3x3 (10)	110212	Pin 2.5x17 (10)
110117	Setscrew allen m3x12 (10)	110213	Pin 2.5x10 (10)
110118	Setscrew allen m4x4 (10)	110214	Pin 3x15 (10)
110119	Setscrew allen m4x6 (10)	110215	Pin 2x12 (10)
110120	Setscrew allen m4x10 (10)	110300	E-clip 2.3 (10)
110121	Setscrew allen m5x6 (10)	110301	E-clip 3.2 (10)
110122	Screw allen countersunk m3x6 (10)	110302	E-clip 4.0 (10)
110123	Screw philips roundhead 3.5x13 (10)	110303	E-clip 5.0 (10)
110124	Screw allen countersunk m3x8 (10)	110304	E-clip 7.0 (10)
110125	Screw allen countersunk m3x20 (10)	110305	Seeger clip 12x1.0 (10)
110126	Screw allen countersunk m2.5x12 (10)	110306	E-clip 6.0 (10)
110127	Screw allen countersunk m3x12 (10)	110400	Washer 6.0x10 (10)
110128	Screw allen roundhead m3x5 (10)	110401	Washer 3.2x7 (10)
110129	Screw allen cilinderhead m3x10 (10)	110402	Nut nylock M3 (10)
110130	Screw allen roundhead m2.5x6 (10)	110403	Nut nylock M4 (10)
110131	Screw allen roundhead m2.5x10 (10)	110404	Washer 6x8x0.3 (10)
110132	Screw allen countersunk m3x16 (10)	110405	Nut nylock M4 flanged (10)
110133	Screw philipshead countersunk 2.5x8 wide (10)		
110134	Screw philipshead countersunk 2.5x10 wide (10)		
110135	Screw allen countersunk M2.5x10(10)		
110136	Screw allen countersunk M2.5x8(10)		
110137	Setscrew allen M3x6 (10)		
110138	Screw allen countersunk M4x14 (10)		
110139	Screw allen countersunk M3x40 (10)		
110140	Screw allen roundhead M3x20 (10)		
110141	Screw allen roundhead M3x22 (10)		
110142	Screw allen roundhead M3x25 (10)		
110143	Screw allen roundhead M4x18 (10)		
110144	Screw allen roundhead M3x18 (10)		
110145	Screw allen roundhead flanged M3x12 (10)		
110146	Screw allen roundhead flanged M3x16 (10)		
110147	Screw ph roundhead widethread 2.5x5 (10)		
110148	Setscrew allen M5x4 (10)		
110149	Screw allen countersink M2x10 (10)		
110150	Screw M6x12 nylon black (2)		
110151	Screw allen cilinderhead M4x10 (10)		
110152	Screw allen cilinderhead M3x8 (10)		
110153	Screw allen roundhead M2.3x6 (10)		
110154	Setscrew allen M3x10 (10)		
110155	Setscrew allen M3x5 (10)		
110156	Screw allen countersunk M2,2x6 (10)		
110157	Screw allen countersunk M3x5 (10)		
110158	Screw allen countersunk M3x15 (10)		

Merchandising

1869	Pit-towel Serpent orange 140x60cm
1886	Decal Serpent black/white 1/10 (2)
1887	Decal Serpent black/white 1/8 (2)
1888	Decal Serpent chrome 1/10 (2)
1889	Decal Serpent chrome 1/8 (2)
1890	Serpent large promo decal 40x25
1891	Serpent medium promo decal 20x12,5(2)
1892	Serpent windowshop decal 20x12,5 (2 sided)
1998	Cap Serpent black-orange
1894	Lanyard Serpent orange
190110	Sweater hooded serpent black (s)
190111	Sweater hooded serpent black (m)
190112	Sweater hooded serpent black (l)
190113	Sweater hooded serpent black (xl)
190114	Sweater hooded serpent black (xxl)
190137	T-shirt Serpent offroad orange (S)
190138	T-shirt Serpent offroad orange (M)
190139	T-shirt Serpent offroad orange (L)
190140	T-shirt Serpent offroad orange (XL)
190141	T-shirt Serpent offroad orange (XXL)
190142	T-shirt Serpent offroad black (S)
190143	T-shirt Serpent offroad black (M)
190144	T-shirt Serpent offroad black (L)
190145	T-shirt Serpent offroad black (XL)
190146	T-shirt Serpent offroad black (XXL)

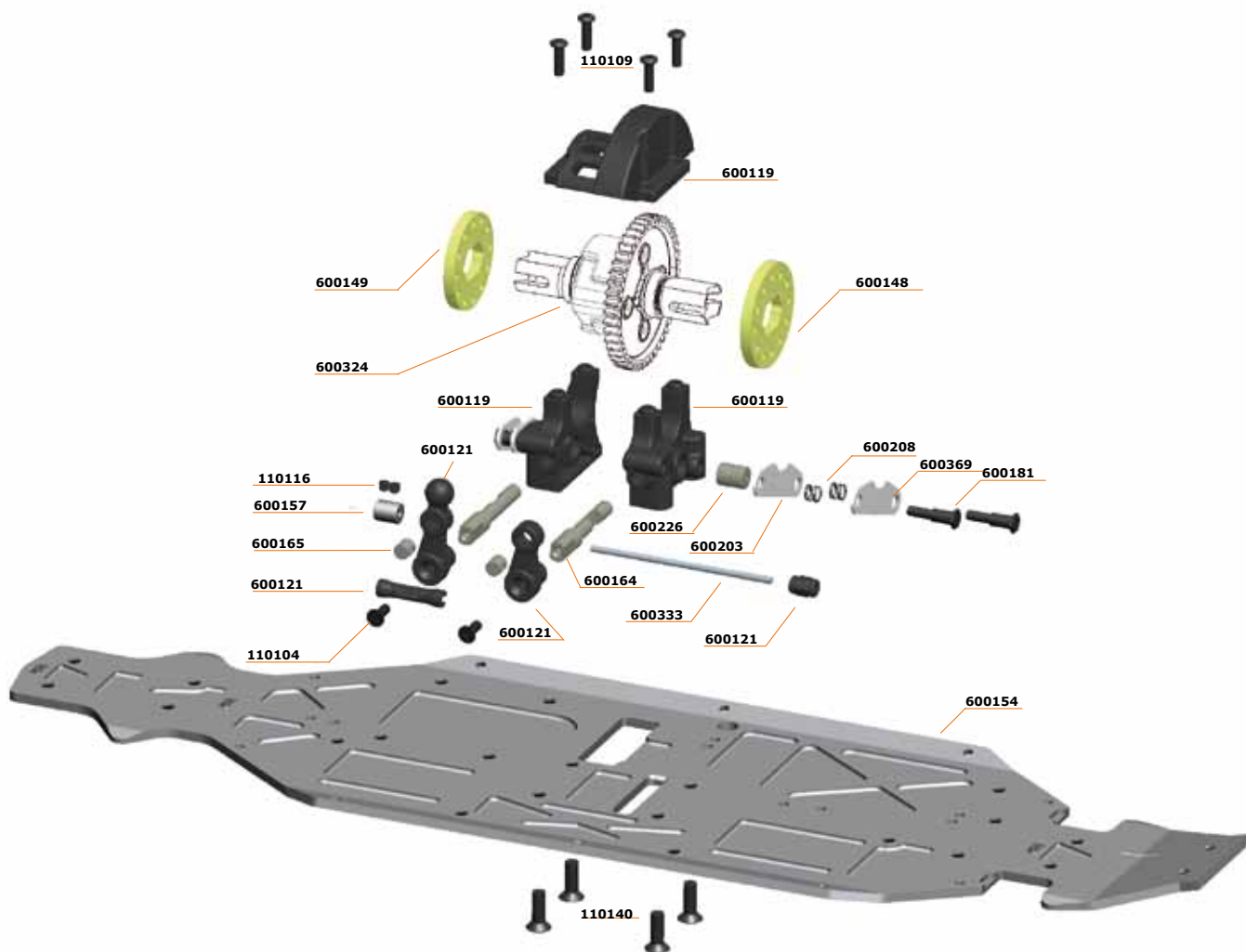
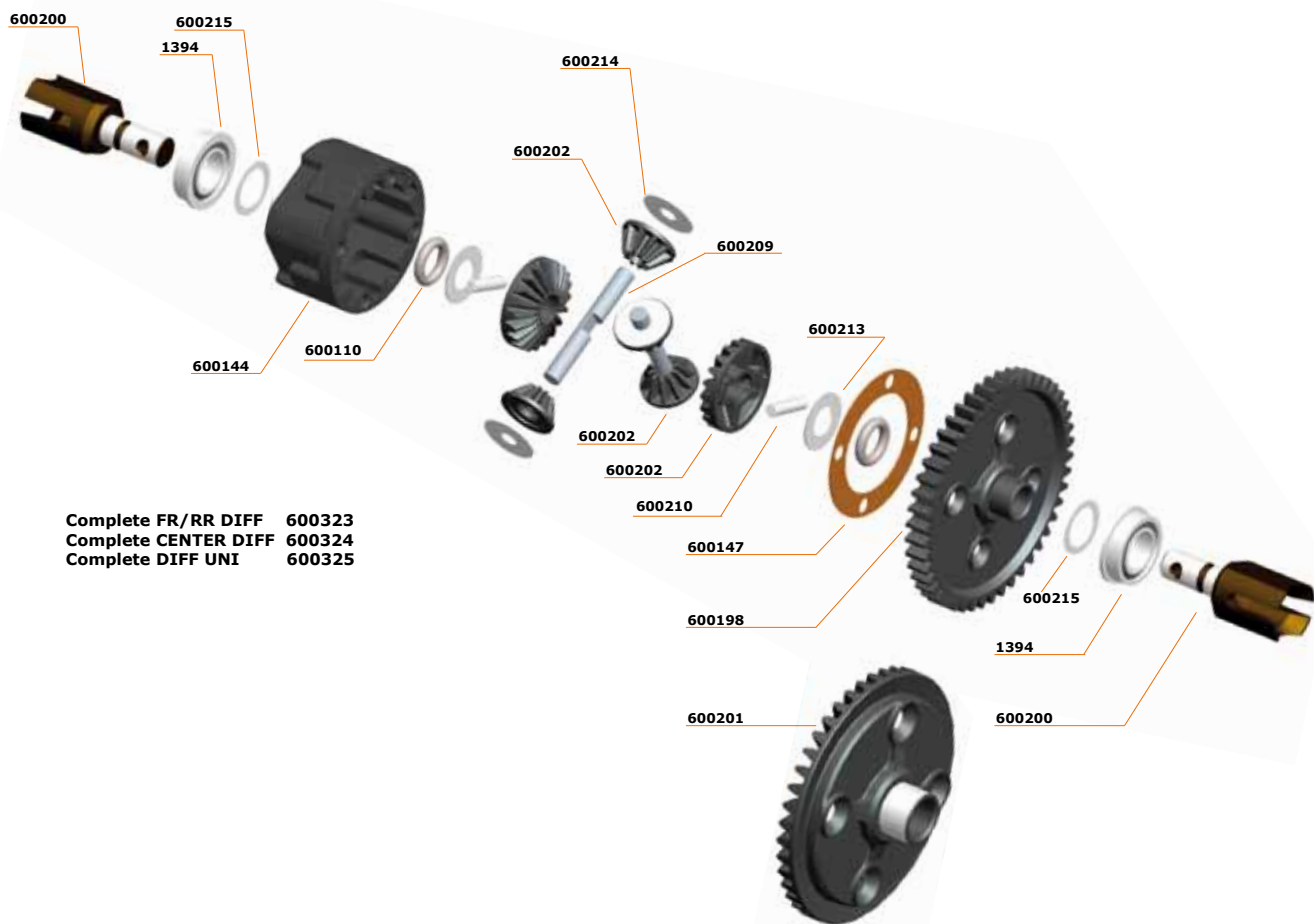





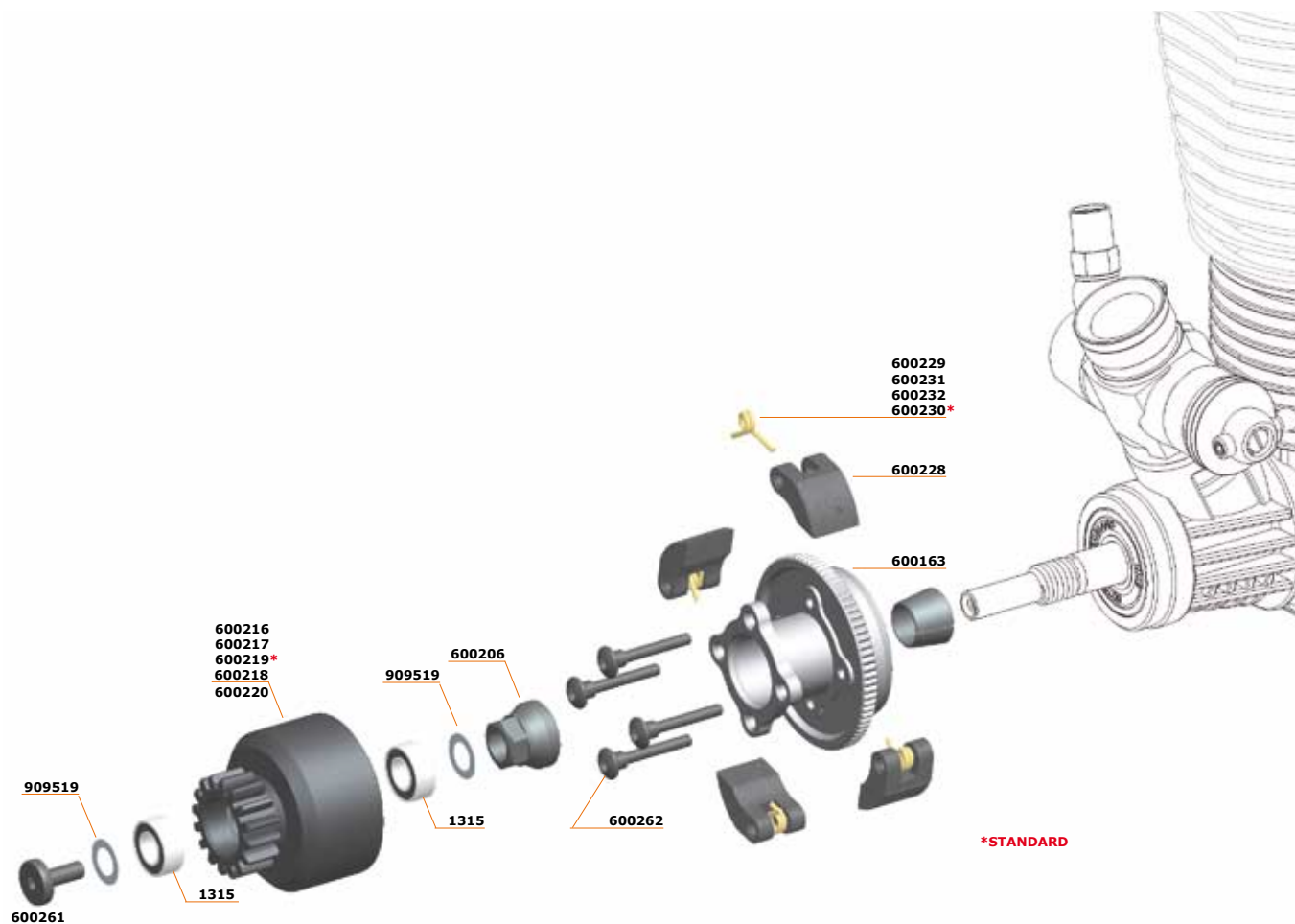
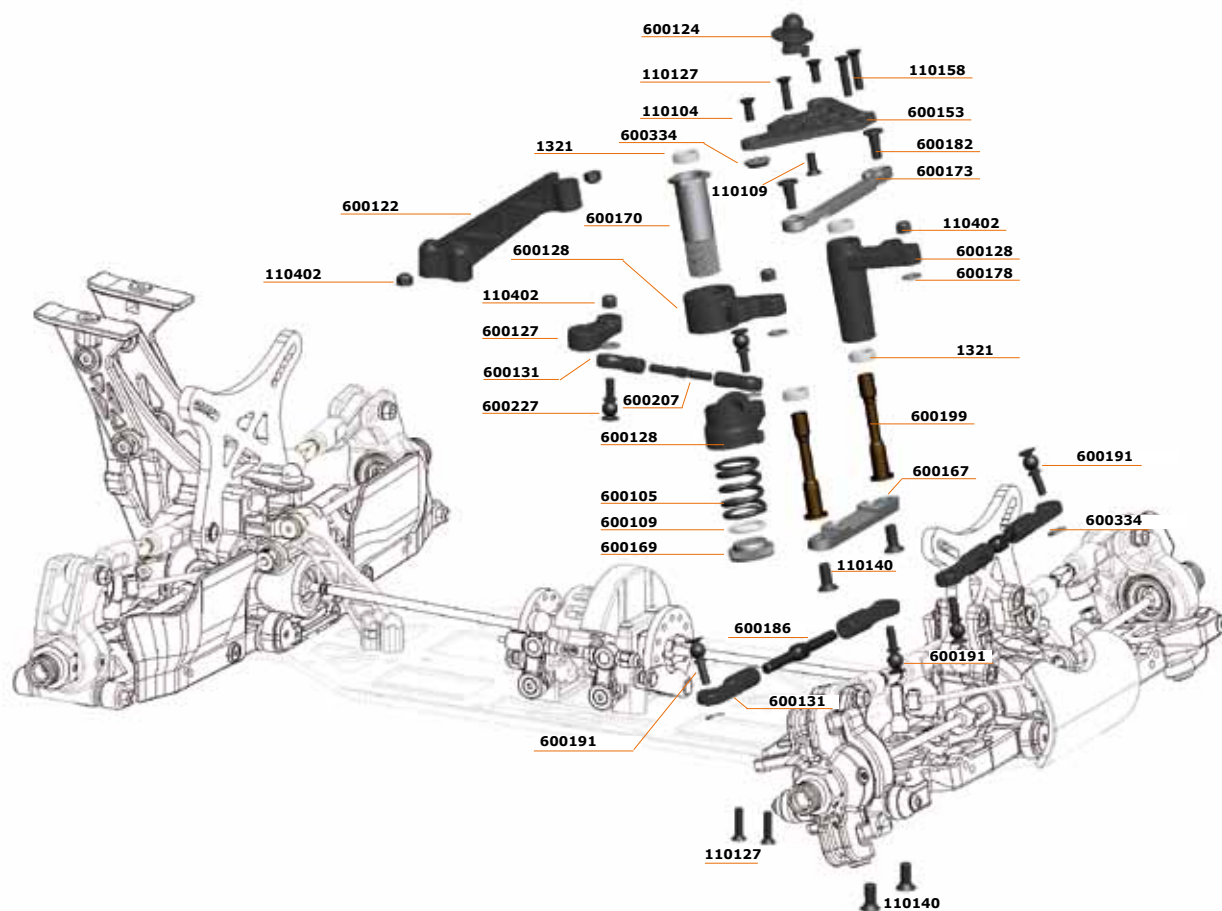

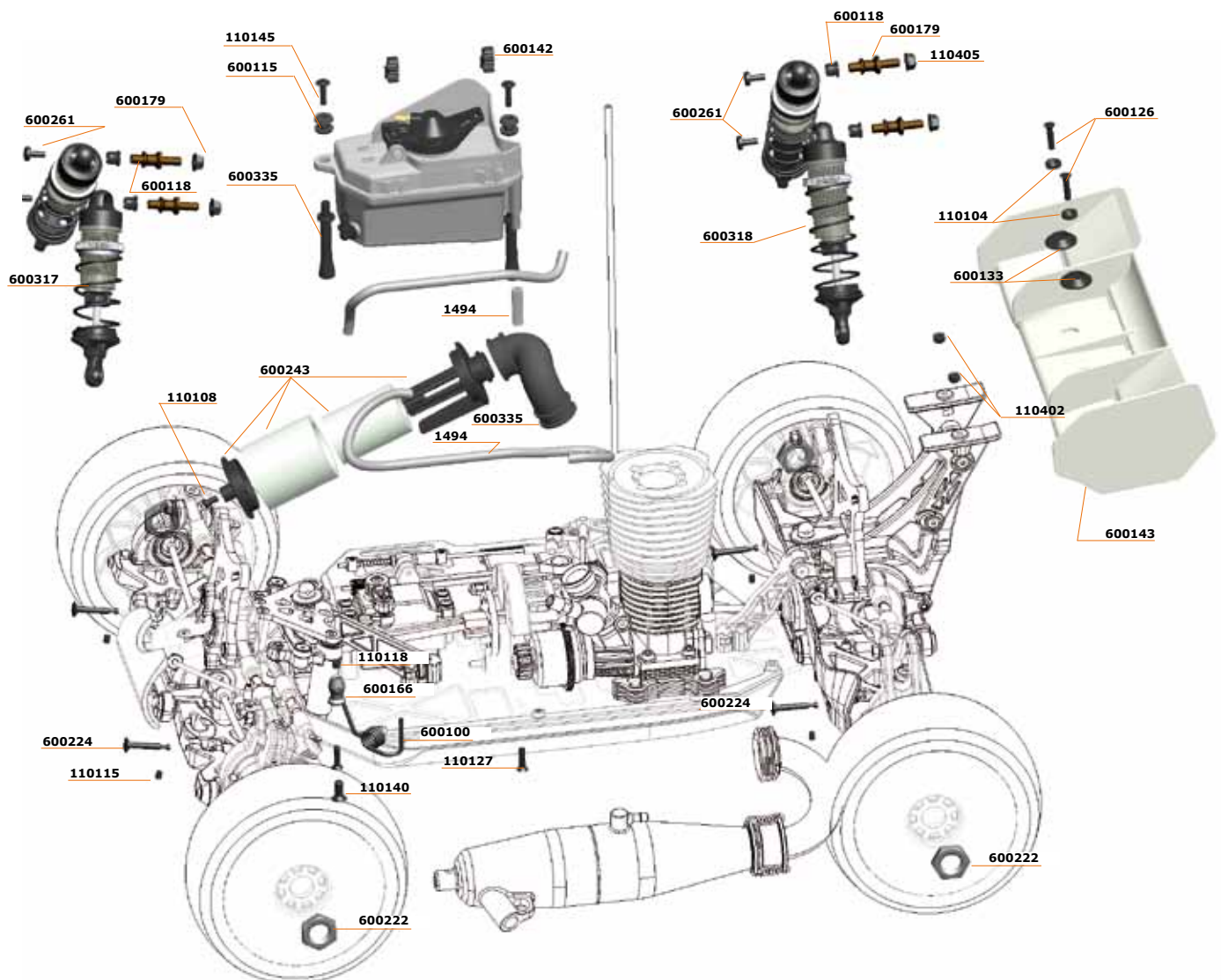
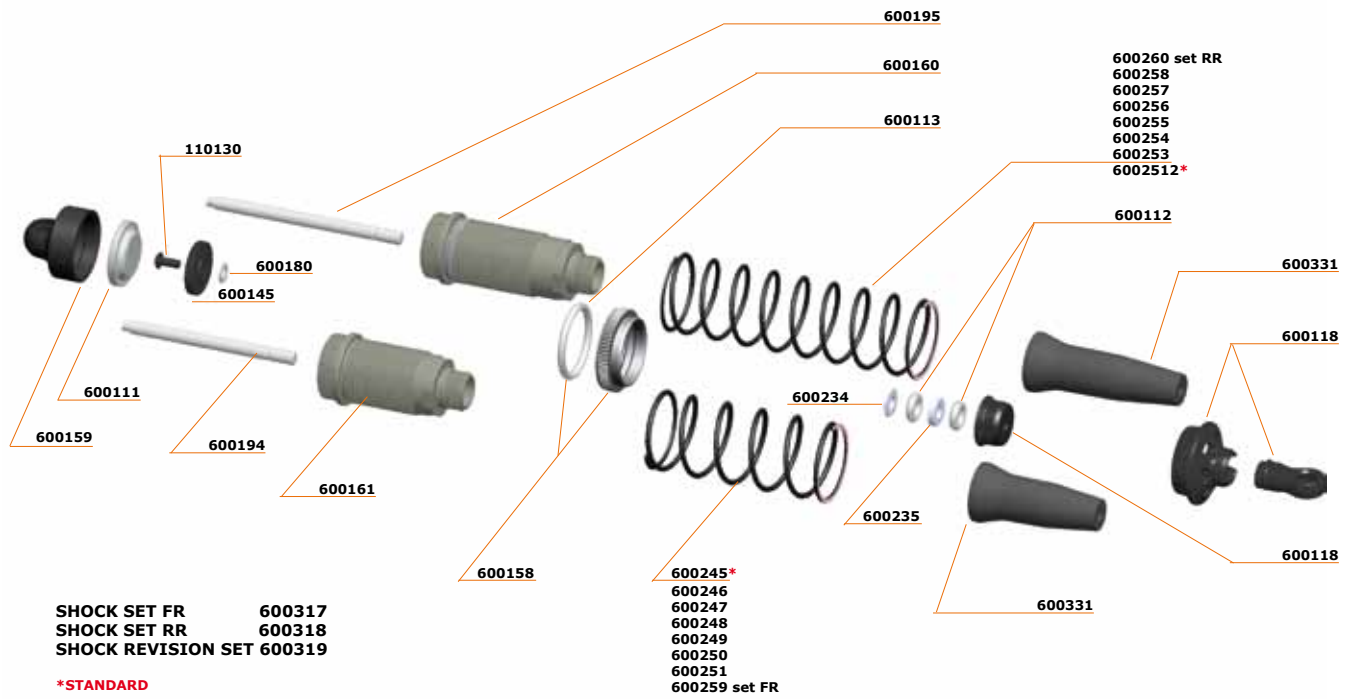

COBB

SERPENT

www.serpent.com
info@serpent.com

