



INSTRUCTION MANUAL

& REFERENCE GUIDE



INTRODUCTION

Serpent enters the small scale competition market with the S240, which like all our previous cars, has been designed to perform straight from the box. Made using top quality materials throughout, the S240 should see you in the winners circle in no time. In fact everything associated with this car is of the highest quality, from the packaging and supplied manuals, right through to the product and race support.

INSTRUCTIONS

Serpent's long tradition of excellence extends to their instruction manuals, and this instruction manual is no exception. The easy-to-follow layout is richly illustrated with 3D-rendered full-color images to make your building experience quick and easy. Following the instructions will result in a well-built, high-performance racecar that will soon be able to unleash its full potential at the racetrack.

EXPLODED VIEWS AND PARTS LIST

The exploded views and parts lists for the Serpent S240 are presented in the Reference Guide section in the back of this manual. The exploded views show all the parts of a particular assembly step along with the Serpent part number. The parts lists indicate the part number and name of each part for easy reference when ordering.

SAFETY

Included with your Serpent S240 kit is a document entitled "Read This First" that covers safety precautions for the assembly and use of this product. We strongly recommend that you thoroughly read and understand that document, and follow all the precautions.

SERPENT.COM

The printed instruction manual included with your Serpent S240 kit is very complete, though due to continuous product development, more up-to-date information may be provided at our Serpent.com website.

All information about the Serpent S240 is accessible from the Serpent S240 product page found on Serpent.com and can be accessed by simply typing **serpent.com/420001** into your web browsers address bar.

From the Serpent S240 product page you will find the very latest information about your Serpent S240: reports by team drivers and other experts, tips and tricks, setups, image gallery and downloadable files including the latest version of the instruction manual will be made available as downloadable PDF files.

CONTENTS

ASSEMBLY INSTRUCTIONS	6
REFERENCE GUIDE	21
PARTS LIST	26

USING THE MANUAL

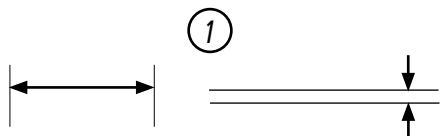

Step number; the order in which you should assemble the indicated parts

Length after assembly / Gap between two items



Assembly path of one item into another



Group of items (within lines) should be assembled first



Direction the item should be moved



Glue one item to another



Press/Insert one item into another



Connect one item to another



Apply transmission grease (Grey), threadlock* (Blue), CA glue* (Red) or differential grease (Orange). (*Items not included.)

ASSEMBLY INSTRUCTIONS

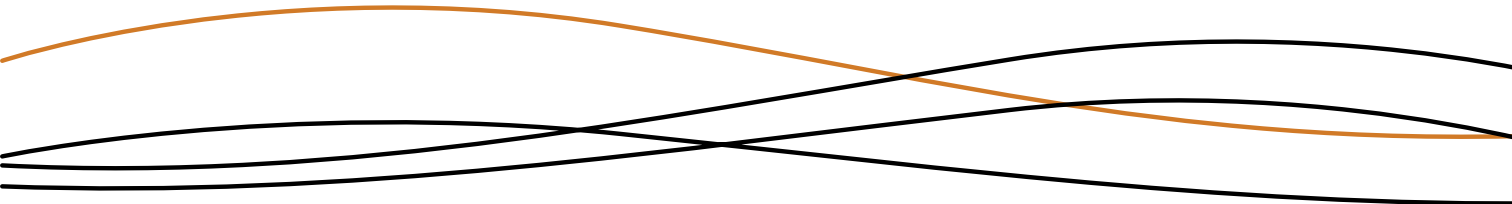

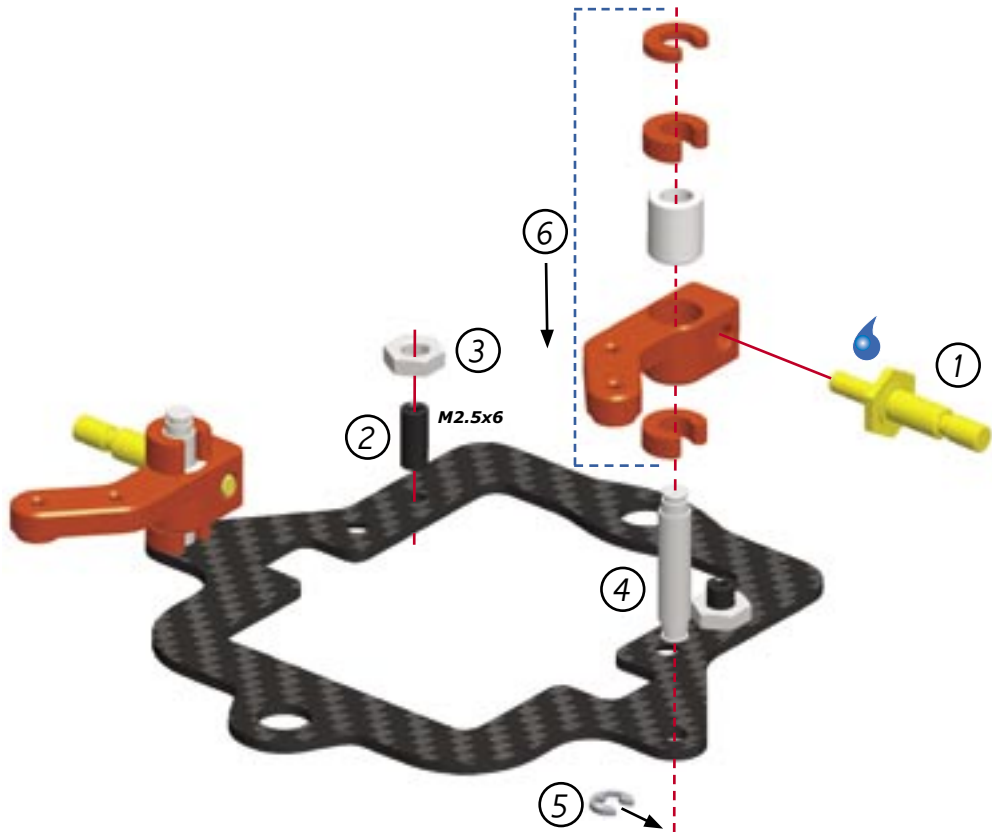

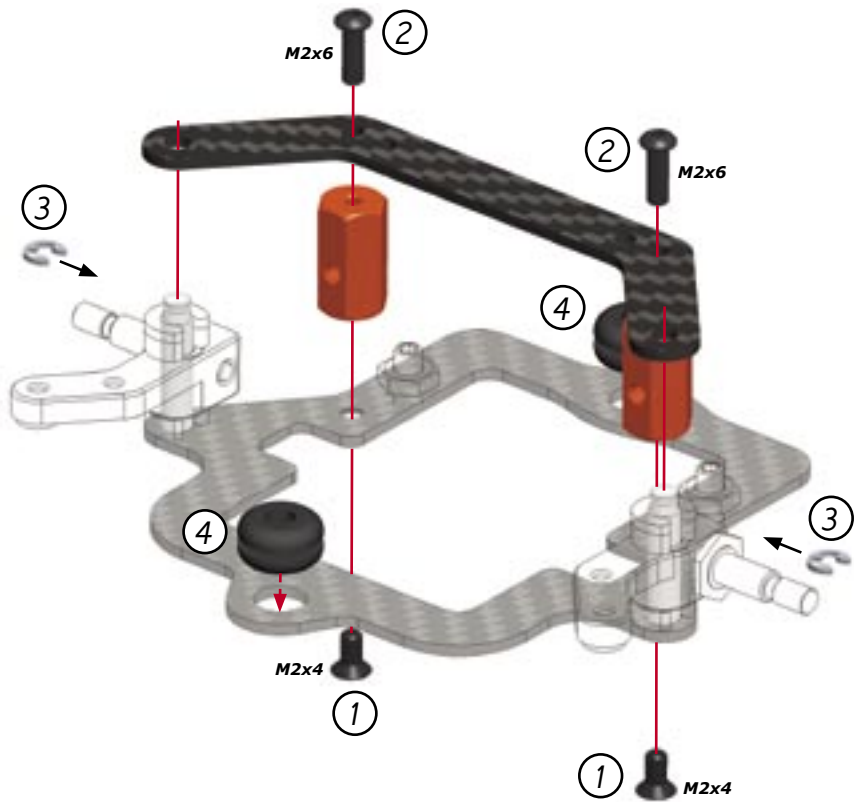

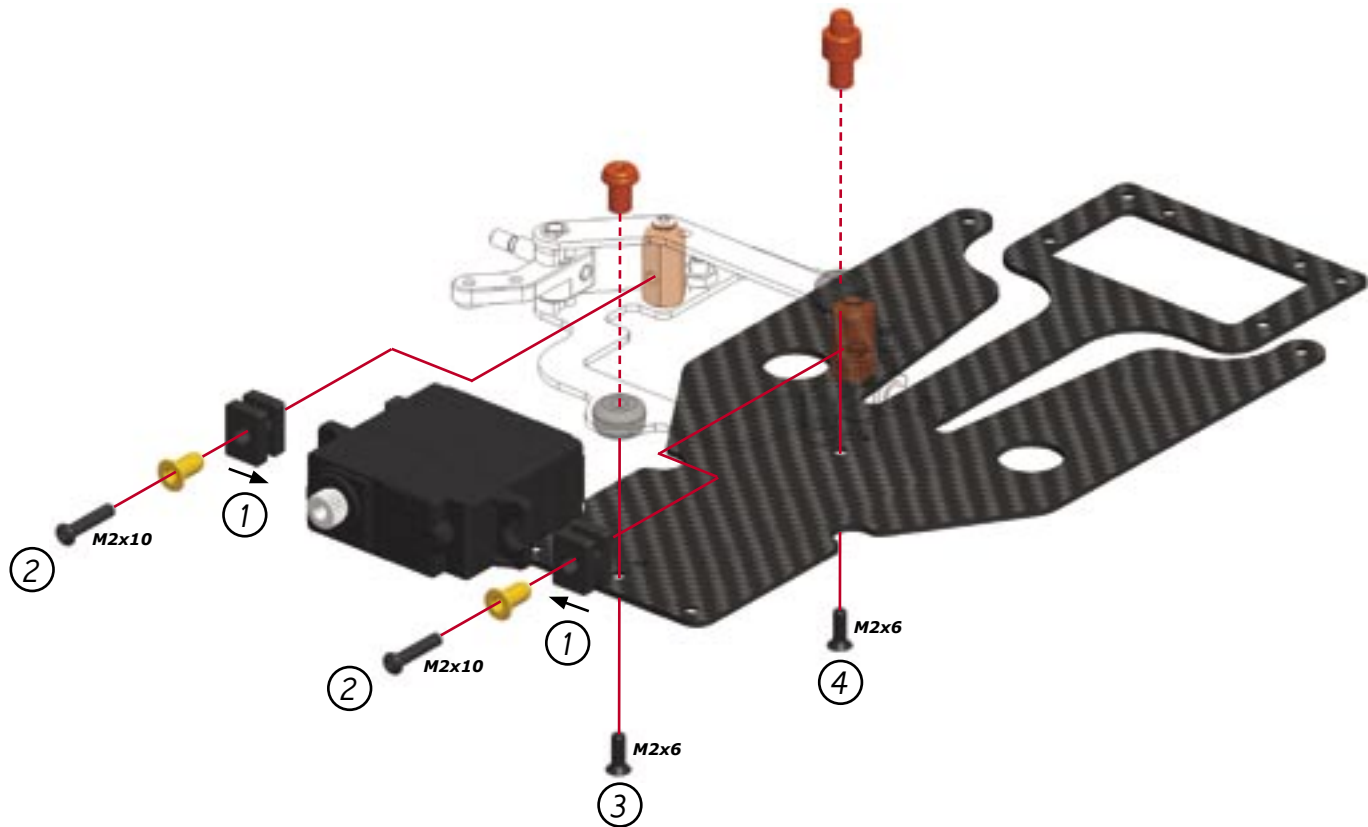

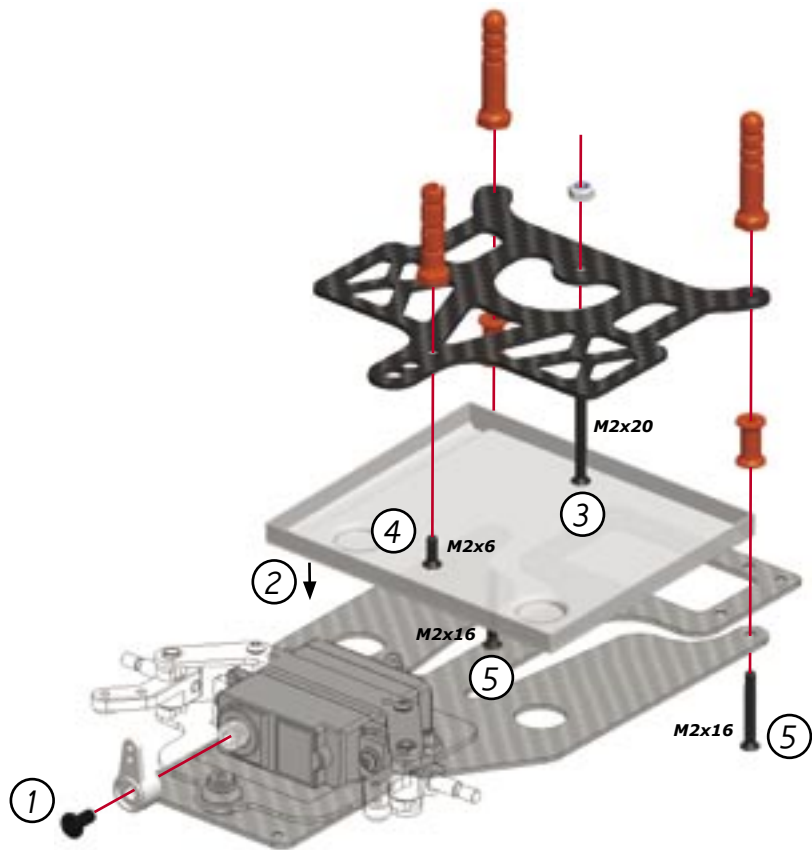

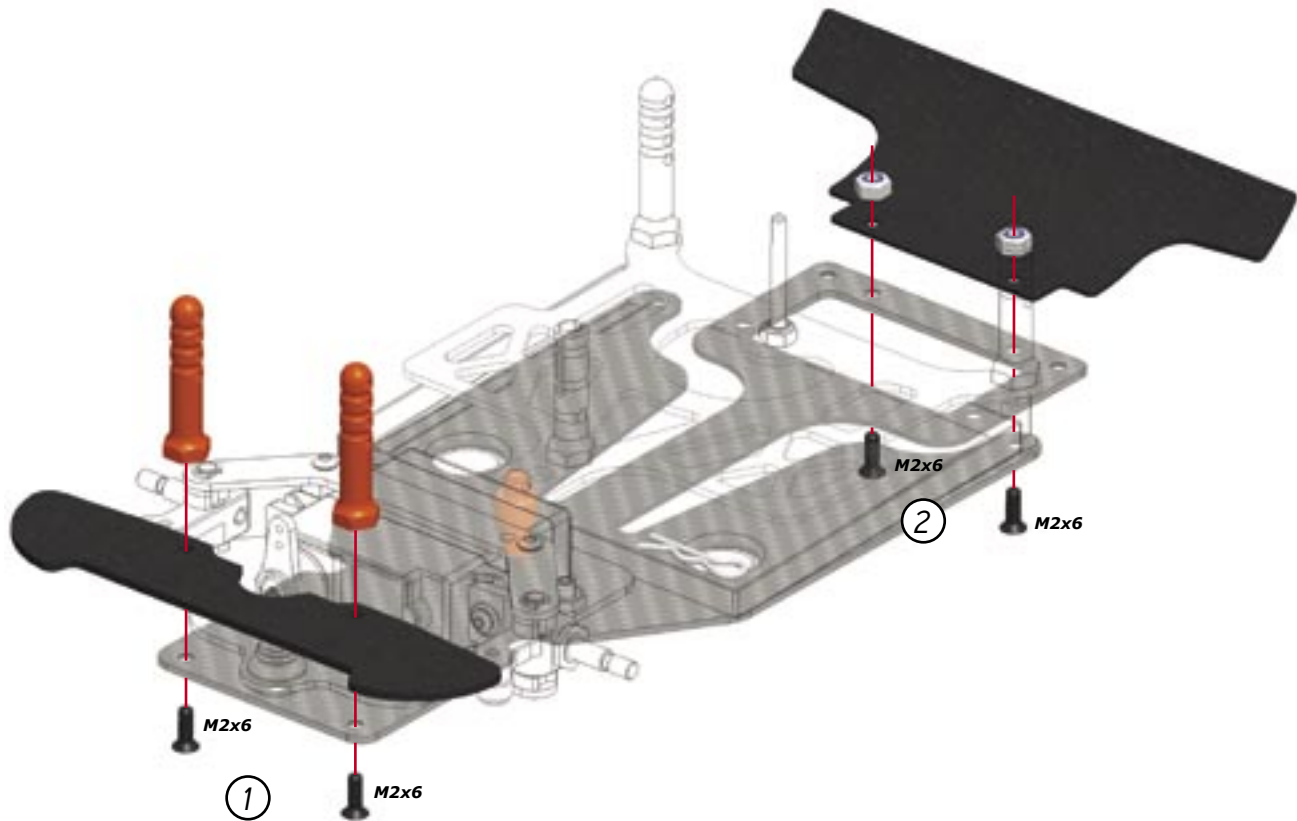

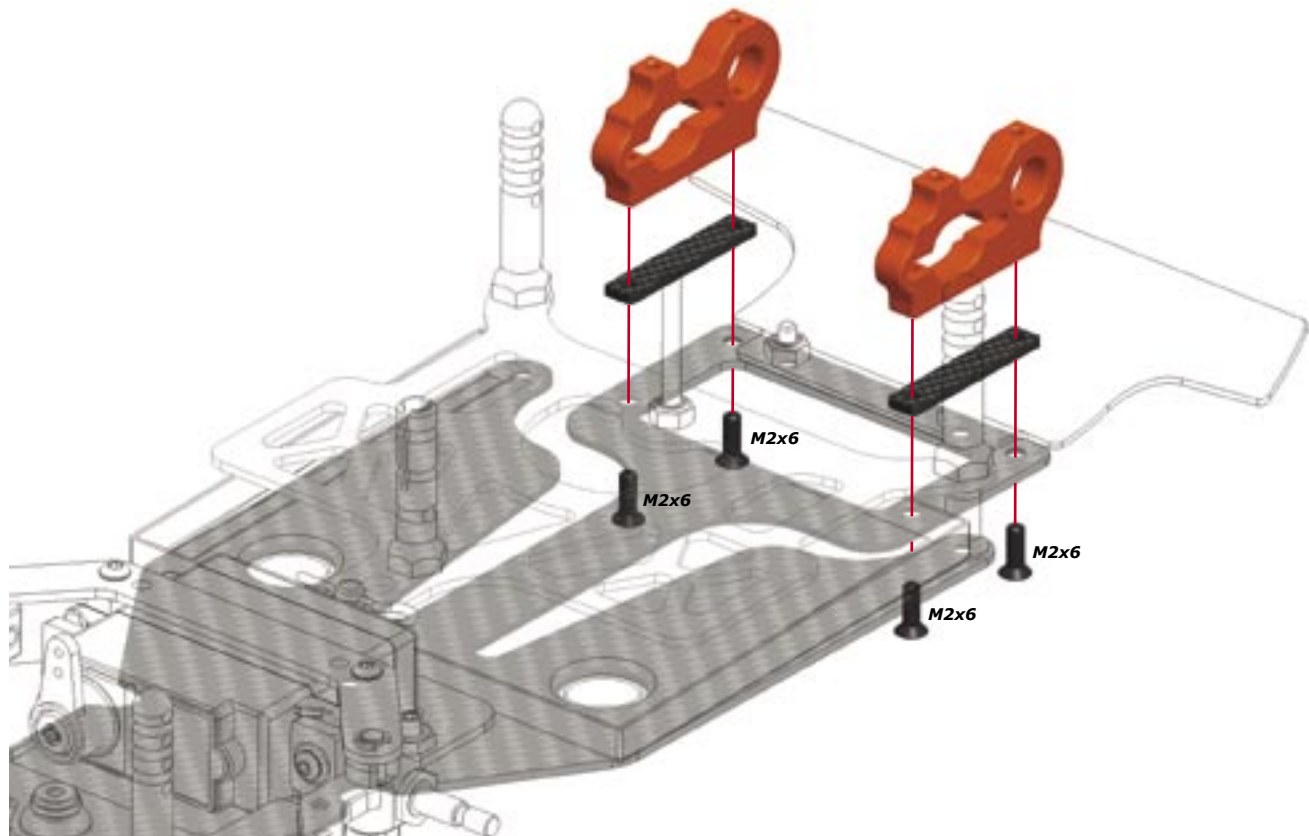

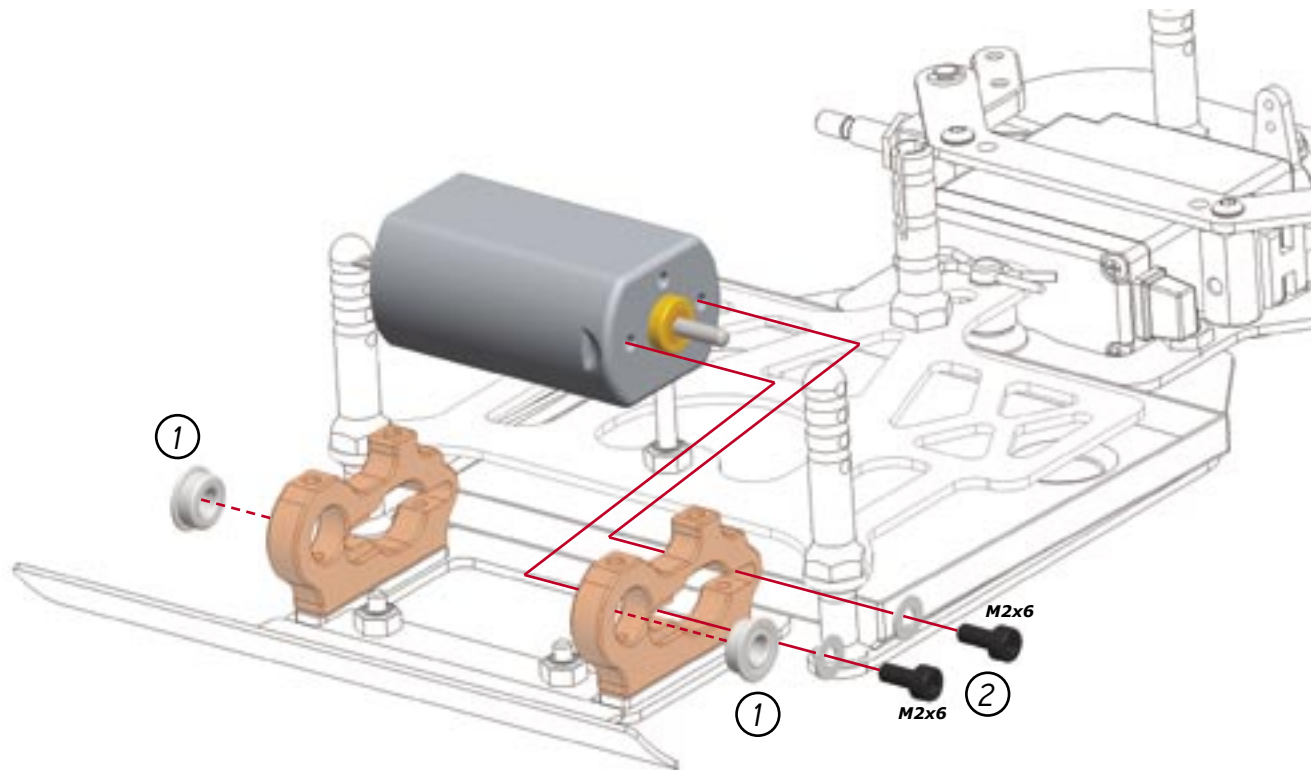

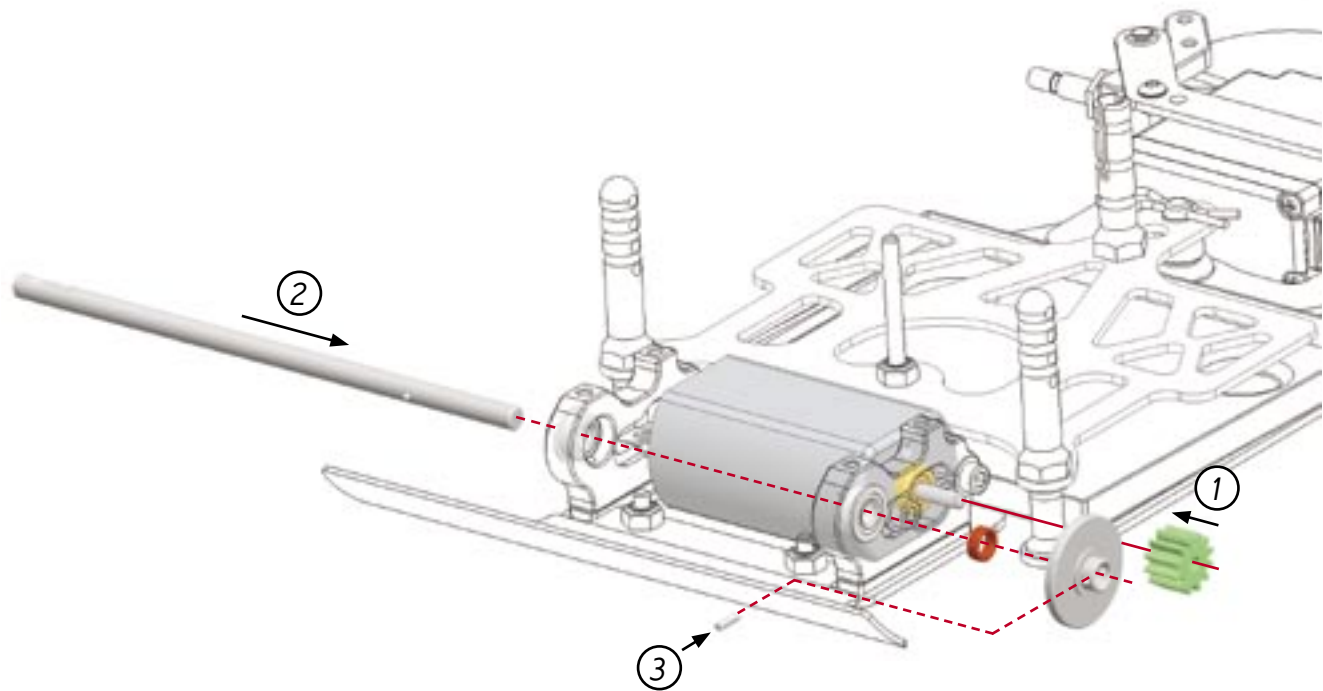

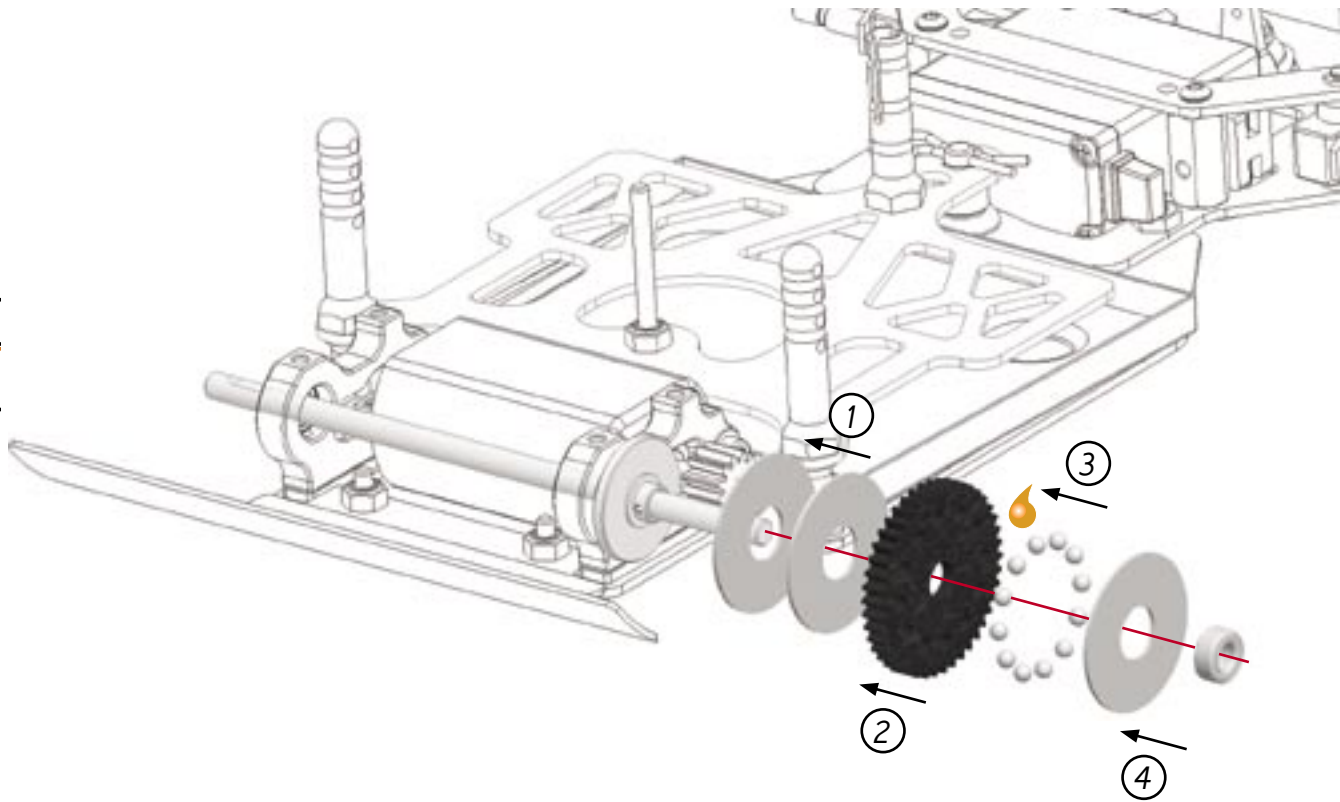

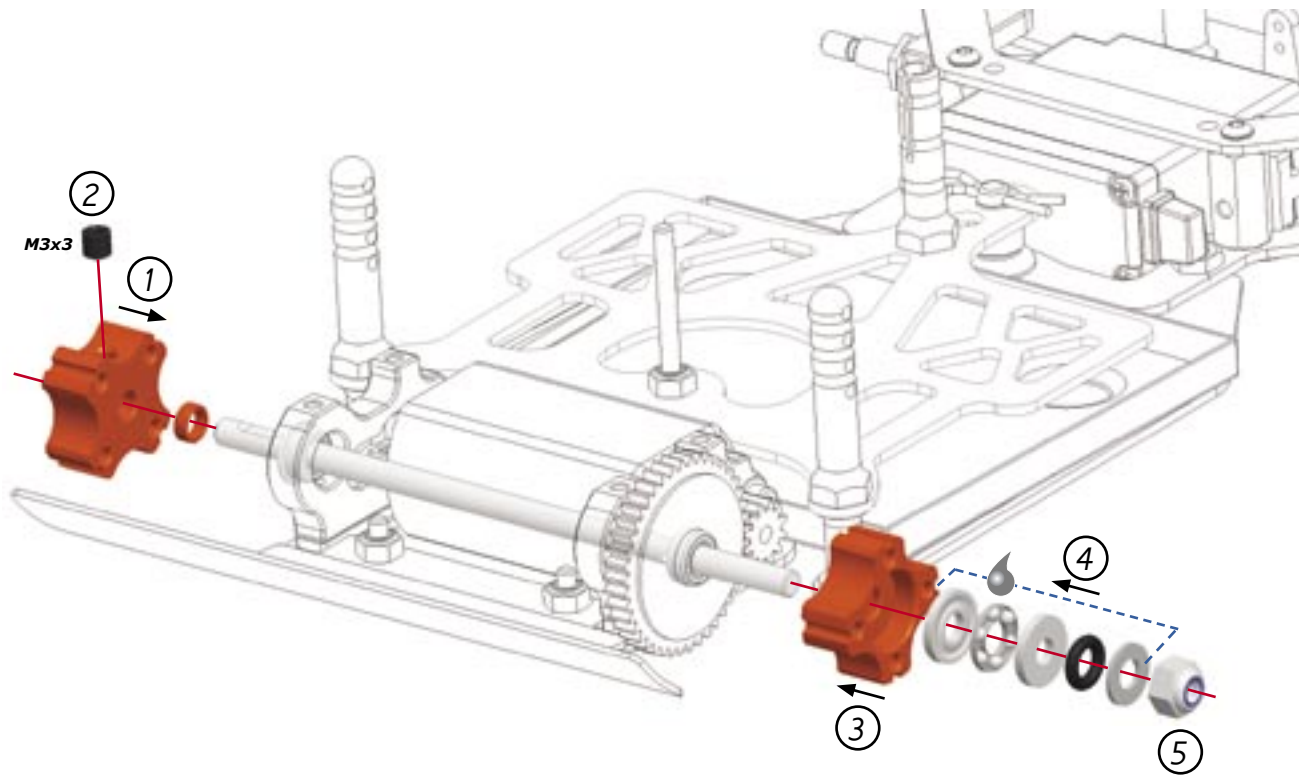

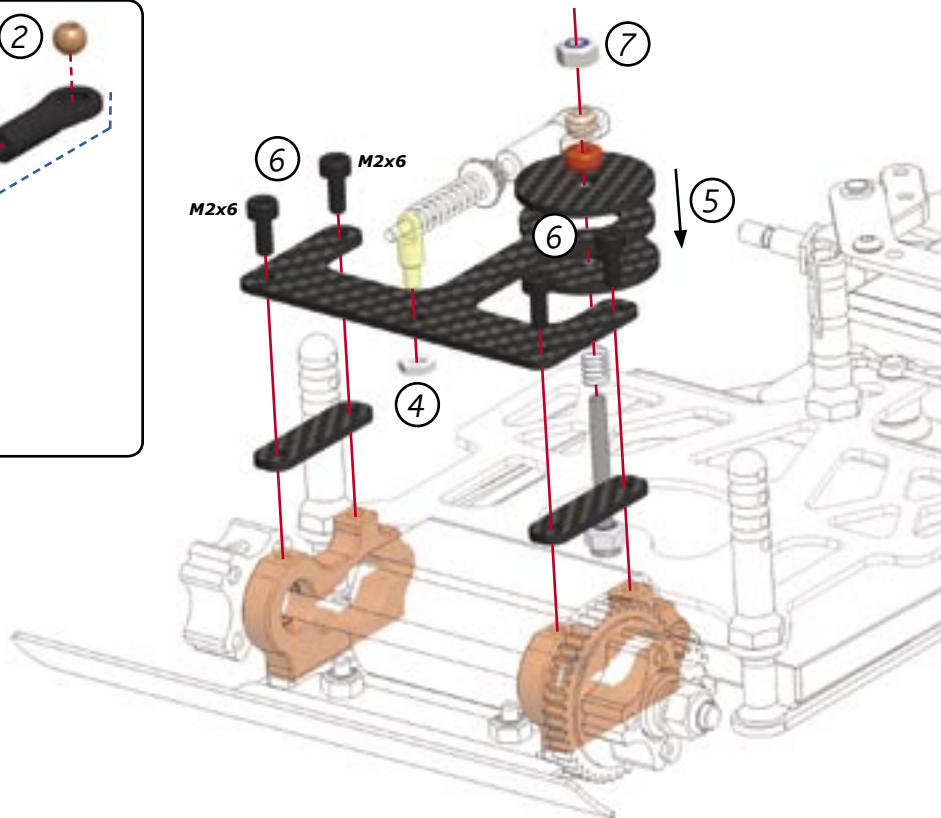
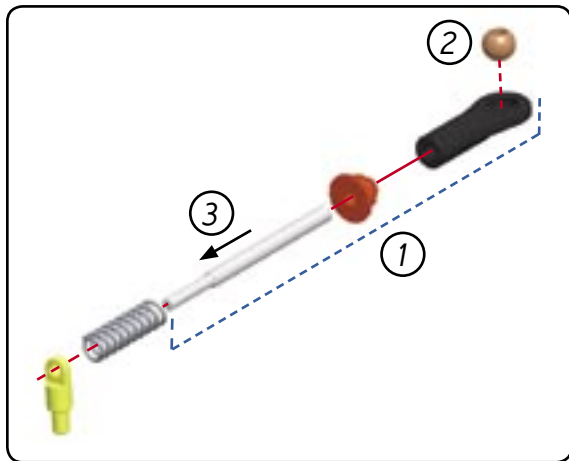

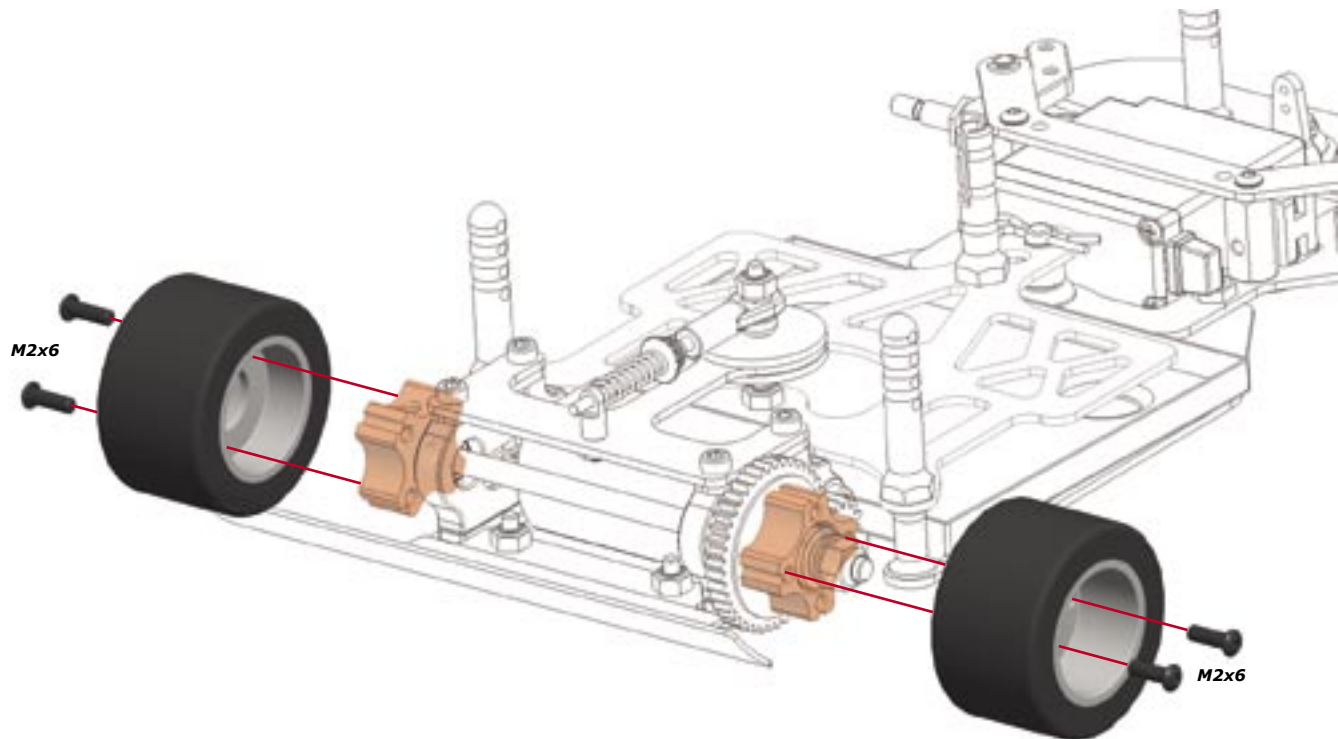

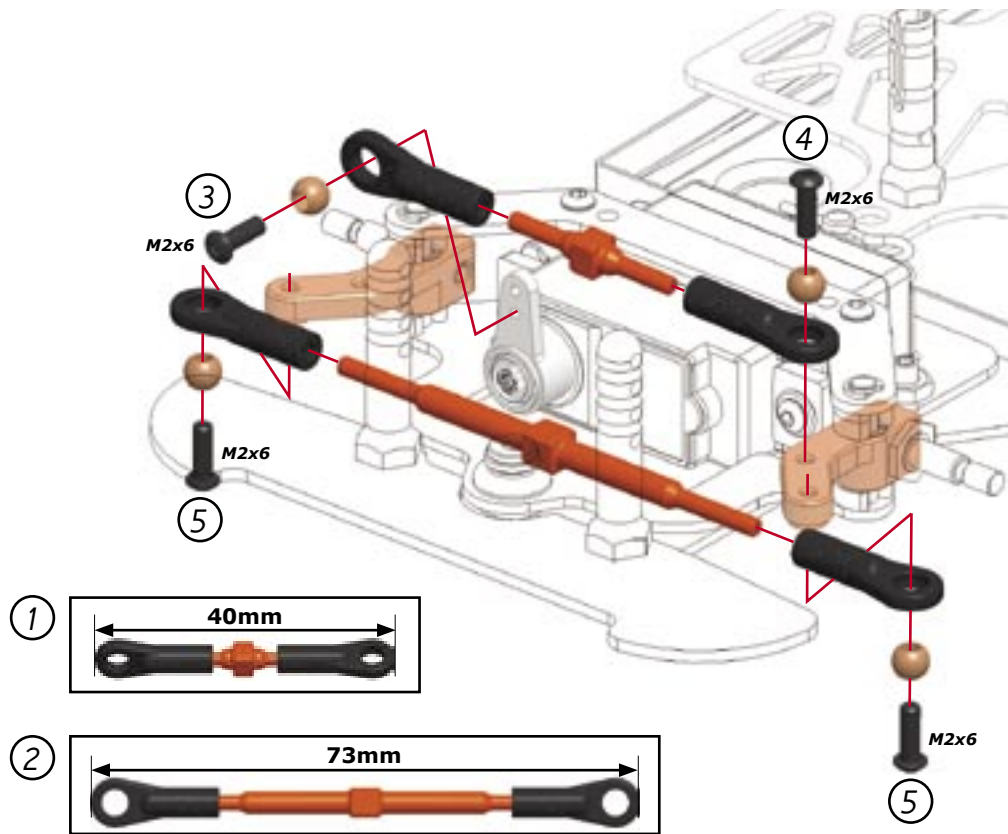

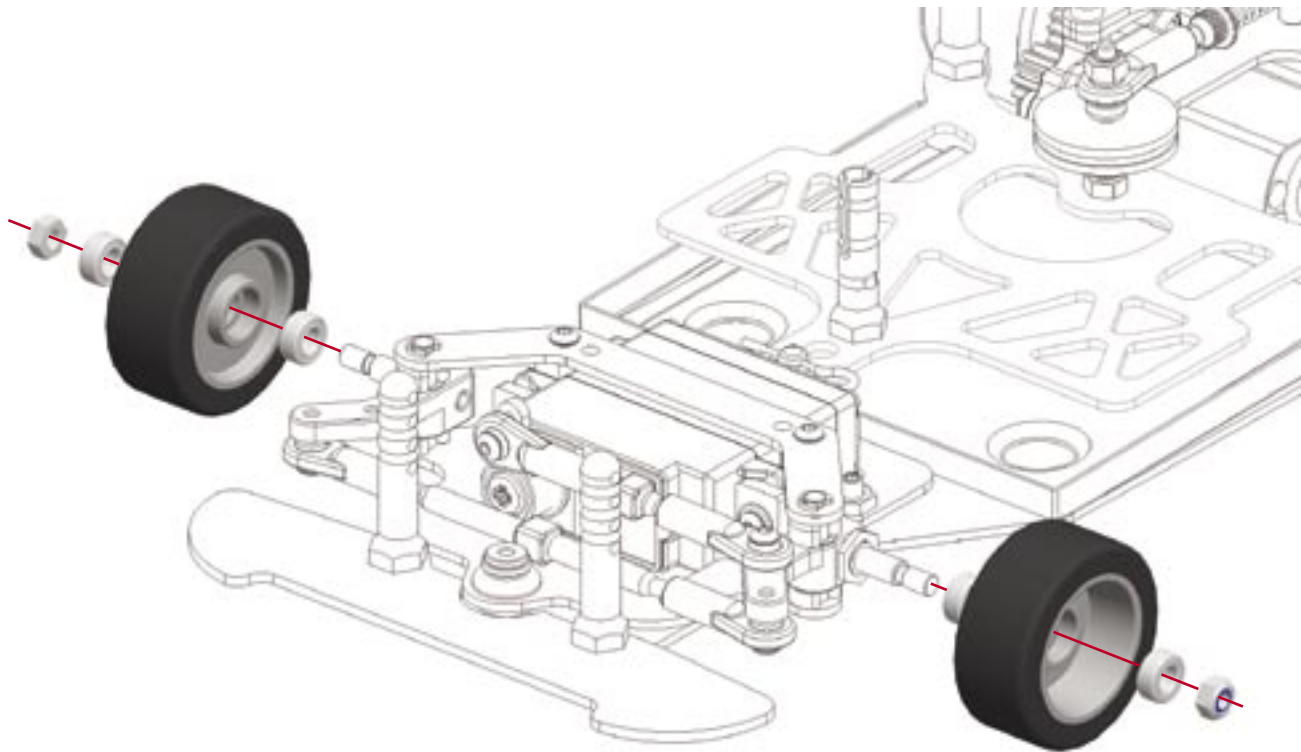

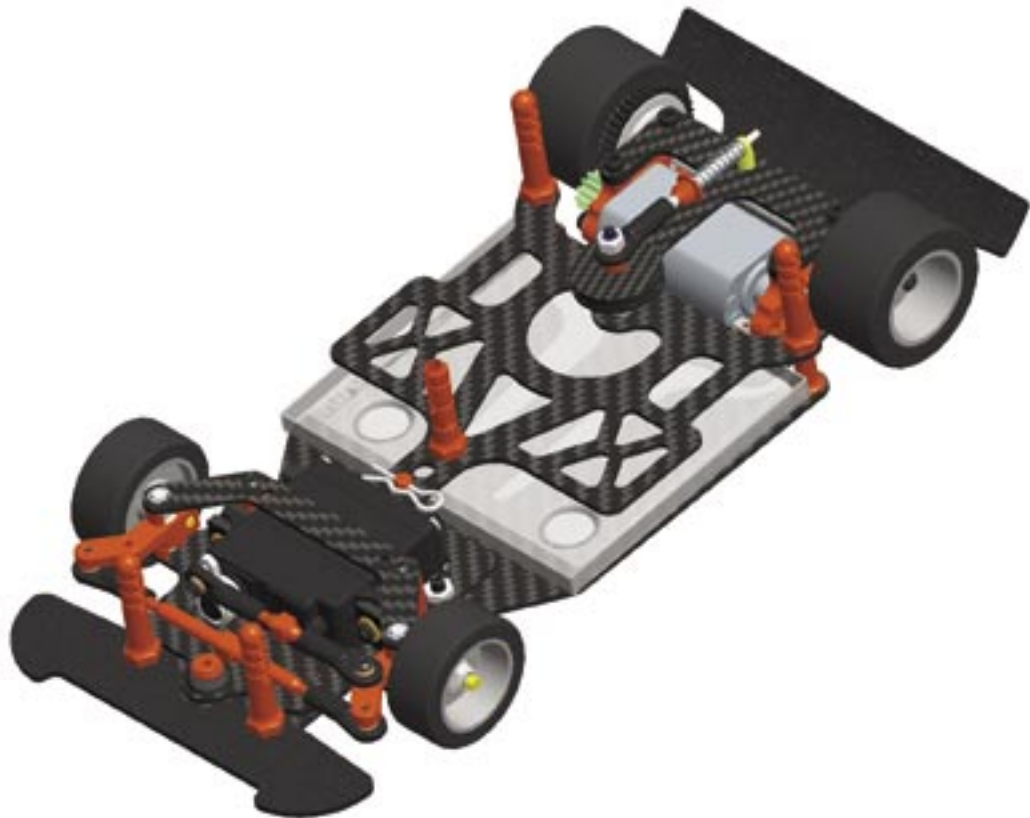

REFERENCE GUIDE

The image features three decorative wavy lines that span the width of the page. One line is orange and the other two are black. They are positioned below the title and above the main content area.

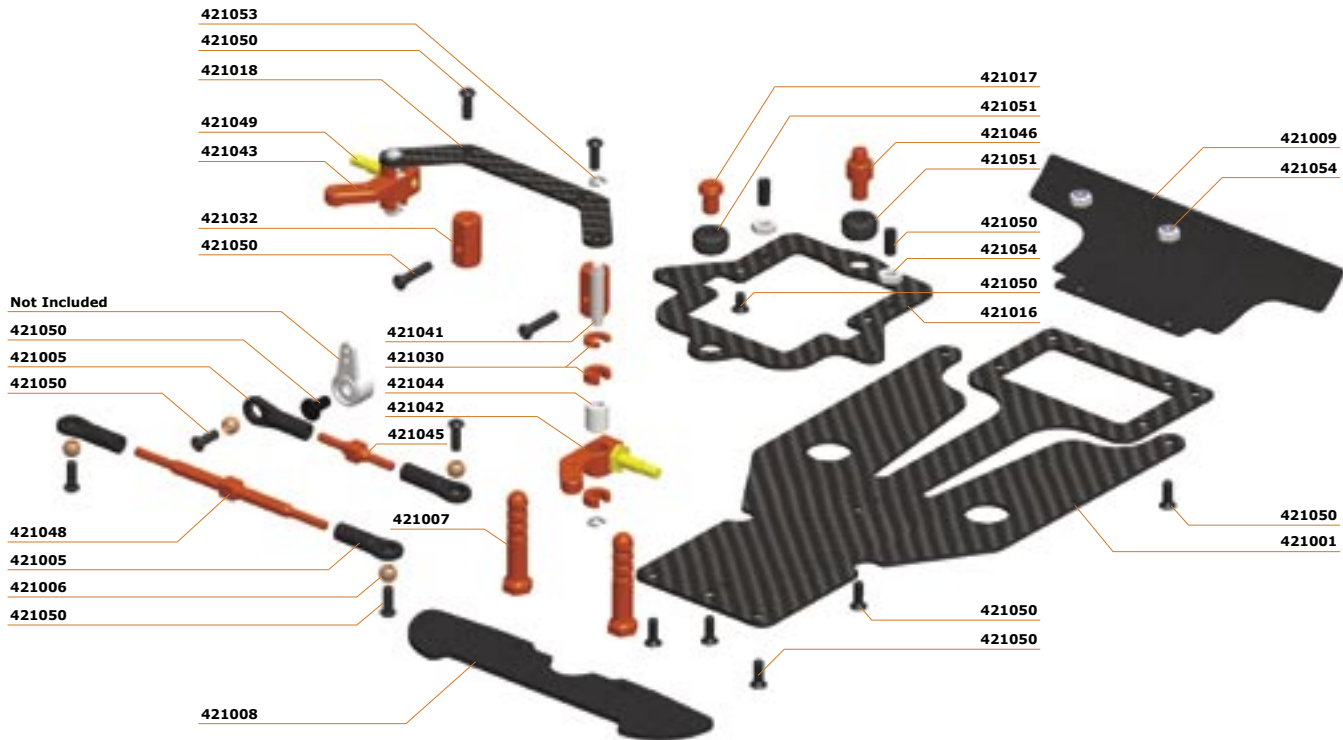

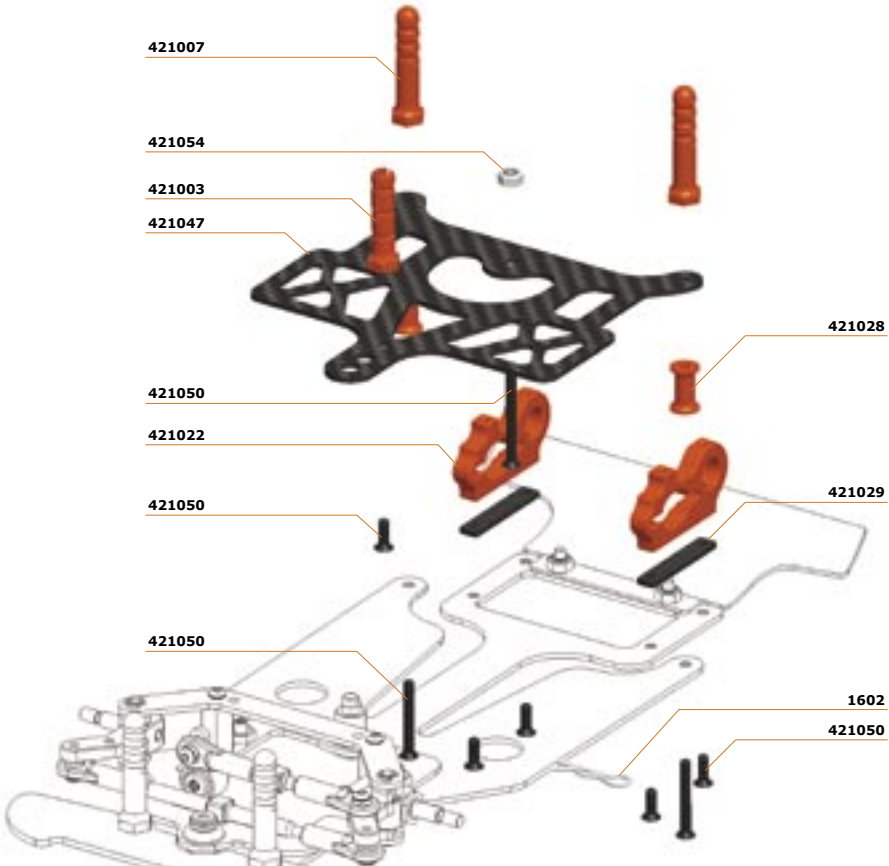

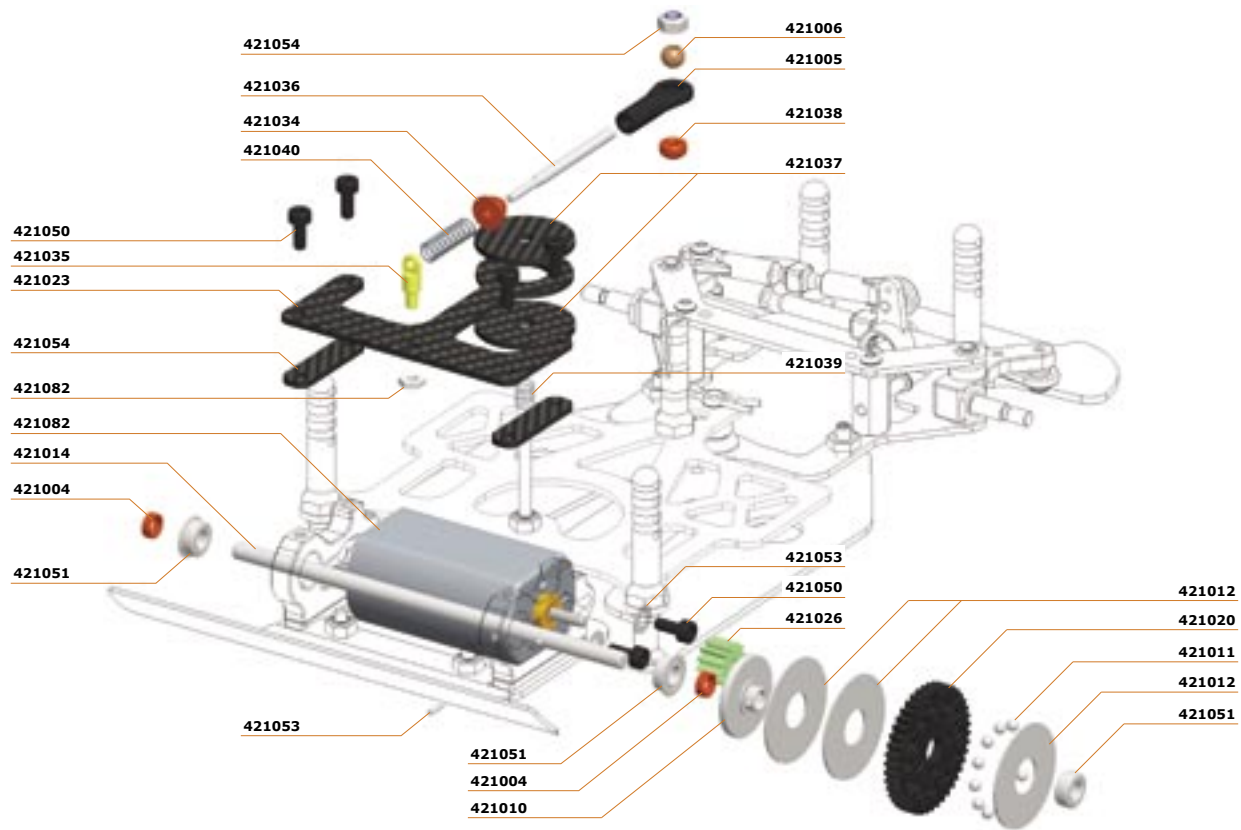

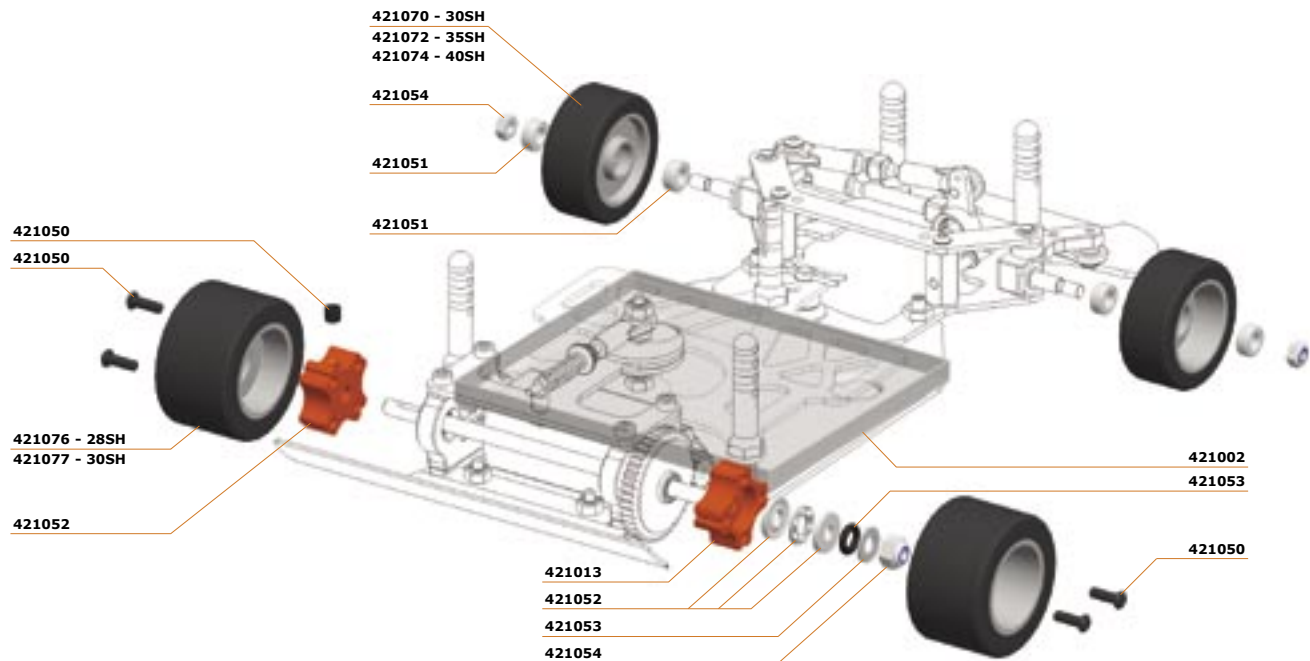

MANUALS / DECALS

- 421085 Manual / Reference guide
421086 Decal sheet S240 (2)

MAIN ASSEMBLY

- 421001 Chassis plate carbon V1
421002 Battery holder
421003 Antenna holder Alu
421004 Axle bushing (2)
421005 Ball-joint (10)
421006 Ball-joint ball (10)
421007 Body-post alu (2)
421008 Bumper front nylon
421009 Bumper rear nylon

BALL-DIFF SET

- 421010 Diff adaptor
421011 Diff balls (12)
421012 Diff plate (3)
421013 Diff wheel adaptor
421014 Diff shaft steel
421016 Plate front 58mm
421017 Suspension mount front wide
421018 Stiffener plate FR up 58mm
421019 Gear 40T
421020 Gear 42T
421021 Gear 44T
421022 Motor-mount alu (2)
421023 Motor top plate
421024 Motor top plate spacer
421027 Pinion 8T
421025 Pinion 10T
421026 Pinion 12T

RADIO PLATE

- 421028 Post radio plate alu (2)
421029 Plate ride height carbon RR (2)
421030 Spacer ride height FR 1+2mm (6)
421032 Holder servo (2)

SHOCK ABSORBER

- 421033 Shock-set
421034 Shock-adjuster alu
421035 Shock holder RR brass
421036 Shock pin
421037 Shockplate carbon (2)
421038 Shock spacer carbon
421039 Shock spring
421040 Shock spring main

STEERING ASSEMBLY

- 1602 Body clip small (10)
421041 Steering axle (2)
421042 Steering block alu L
421043 Steering block alu R
421044 Steering bushing (2)
421045 Steering-rod alu 20mm
421046 Top-plate holder
421047 Top-plate carbon
421048 Trackrod alu 54mm
421049 Wheel-adaptor alu L
421051 Grommet (2)
421052 Wheel-adaptor alu L

FASTENERS & BEARINGS

- 421050 Screw-set (17)
421051 Ball bearing-set 3x6 (2+2)
421052 Thrust bearing 3x1.4
421053 Clips-shim-set (24)
421054 Nut set (5)

TYRES / WHEELS

- 421060 Wheel FR white (2)
421061 Wheel RR white (2)
421070 Pre mounted Foam tyre FR 30sh (2)
421072 Pre mounted Foam tyre FR 35sh (2)
421074 Pre mounted Foam tyre FR 40sh (2)
421076 Pre mounted Foam tyre RR 28sh (2)
421077 Pre mounted Foam tyre RR 30sh (2)

BODIES

- 170305 Body 1/24 GT
170306 Body 1/24 GTP
170307 Body 1/24 Touring

ELECTRONICS

- 421080 Battery-pack Lipo
421081 Regulator / controller Lipo
421082 Motor standard
421083 Speed controller Lipo

OPTIONALS

- 421055 Suspension mount front narrow

TOOLS

- 150001 Tool bag Serpent
150101 Allen wrench 1.5 x 120mm
150102 Allen wrench 2.0 x 120mm
150103 Allen wrench 2.5 x 120mm
150104 Allen wrench 3.0 x 120mm
150105 Ball driver hex wrench 2.0 x 120mm
150106 Ball driver hex wrench 2.5 x 120mm
150107 Phillips screw driver 3.5 x 120mm
150108 Phillips screw driver 4.0 x 120mm
150109 Phillips screw driver 5.8 x 120mm
150110 Nut driver 4.5 x 100mm
150111 Nut driver 5.0 x 100mm
150112 Nut driver 7.0 x 100mm
150113 Flat head screw driver 3.0 x 150mm
150114 Flat head screw driver 4.0 x 150mm
150115 Flat head screw driver 5.0 x 100mm
150116 Flat head screw driver 5.8 x 100mm
150121 Reamer for lexan body with protector

OILS / LUBRICANTS

1680	One way lube 25ml
1682	Bearing oil 25ml
1683	Premium lube 25ml
1684	Oil-set 3 types (1680-82-83)
1690	Cleaning putty 200 gram

MERCHANDISING

1865	Lanyard serpent grey-silver
1868	Pit-towel serpent orange 50x70cm
1869	Pit-towel serpent orange 140x60cm
1872	Rucksack serpent (35x45cm) black
1873	Rucksack serpent (48x61cm) black
1980	Kit-bag serpent large black-orange
1982	Pit-bag Serpent medium (3 drawers)
1983	Pit-bag Serpent large (4 drawers)
1998	Cap serpent black-orange
190100	T-shirt serpent black (s)
190101	T-shirt serpent black (m)
190102	T-shirt serpent black (l)
190103	T-shirt serpent black (x)l
190104	T-shirt serpent black (xxl)
190110	Sweater serpent black (s)
190111	Sweater serpent black (m)
190112	Sweater serpent black (l)
190113	Sweater serpent black (xl)
190114	Sweater serpent black (xxl)



S40

SERPENT

Serpent Model Racing Cars BV
Spaarneweg 12E, 2142 EN, Cruquius
The Netherlands, Europe