



SET UP

DIFFERENTIAL OIL

FRONT	CENTER	REAR
5000 CST	5000 CST	5000 CST

TRANSMISSION SET UP

PINION	16 T	SPUR GEAR	46 T
--------	------	-----------	------

FINAL DRIVE RATIO	ROLLOUT	mm
-------------------	---------	----

MOTOR	TIMING
-------	--------

ROTOR	ARMATURE
-------	----------

ESC	BATTERIES
-----	-----------

BRUSHLESS	PROGRAM	PUNCH	INITIAL BRAKE	AUTO BRAKE
-----------	---------	-------	---------------	------------

BODY - WING

BODY	SERPENT
------	---------

WING	STOCK
------	-------

SHOCKS

FRONT	SPRING	REAR
C= 4.8 <input checked="" type="checkbox"/>	PINK	C= 2.8 <input type="checkbox"/>
C= 5.0 <input type="checkbox"/>	BLUE	C= 3.0 <input type="checkbox"/>
C= 5.2 <input type="checkbox"/>	PURPLE	C= 3.2 <input type="checkbox"/>
C= 5.4 <input type="checkbox"/>	GREEN	C= 3.4 <input type="checkbox"/>
C= 5.6 <input type="checkbox"/>	GREY	C= 3.6 <input type="checkbox"/>
C= 5.8 <input type="checkbox"/>	YELLOW	C= 3.8 <input type="checkbox"/>
C= 6.0 <input type="checkbox"/>	WHITE	C= 4.0 <input checked="" type="checkbox"/>
C= <input type="checkbox"/>	OTHER	C= <input type="checkbox"/>
300	OIL/CST	300
	REBOUND %	
<input type="radio"/> OPEN	PISTON	<input type="radio"/> CLOSED
	HOLES SIZE	
<input type="checkbox"/>	1.1MM	<input type="checkbox"/>
<input type="checkbox"/>	1.2MM	<input type="checkbox"/>
<input checked="" type="checkbox"/>	1.3MM	<input checked="" type="checkbox"/>
<input type="checkbox"/>	1.4 MM	<input type="checkbox"/>
<input type="checkbox"/>	OTHER	<input type="checkbox"/>
KIT		KIT

TYRES

BRAND	
TYPE	
INSERT	
WHEELS	

COMMENTS

NAME TRACK

TRACK SIZE

☐ OPEN☐ MEDIUM☐ TIGHT

TRACK TRACTION

☐ HIGH☐ MEDIUM☐ LOW

TRACK SURFACE

☐ SMOOTH☐ MEDIUM☐ BUMPY

TRACK TYPE

☐ HARD PACKED☐ SOFT DIRT☐ CLAY☐ BLUE GROOVE☐ ASTRO TURF☐ GRASS

TRACK CONDITION

☐ DRY☐ DUSTY☐ MUD

DATE

CONTACT

TEMP. F° / °C

AIR TRACK

LAPS

BEST LAPTIME in LAP

RACE LENGTH

RACE RESULT

STEERING BLOCK

☒ PLASTIC☐ ALU

CASTER BLOCK

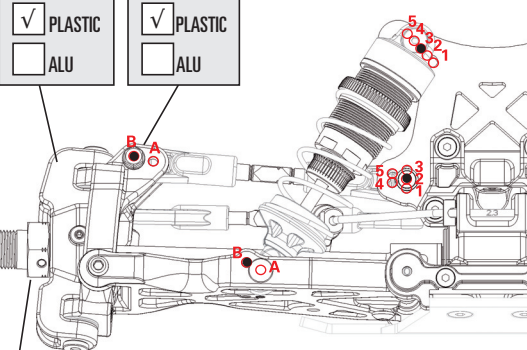
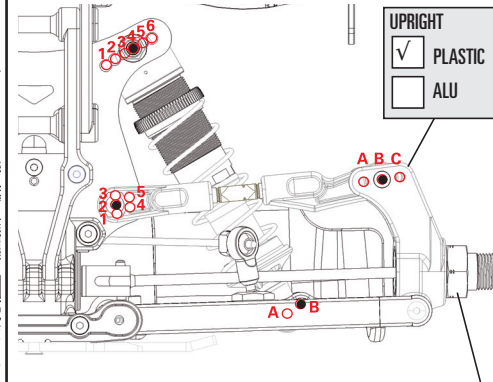
☒ PLASTIC☐ ALUHEX ADAPTER ☐ -2MM ☐ -1MM ☒ 0MMHEX ADAPTER ☐ -2MM ☐ -1MM ☒ 0MM

CASTER

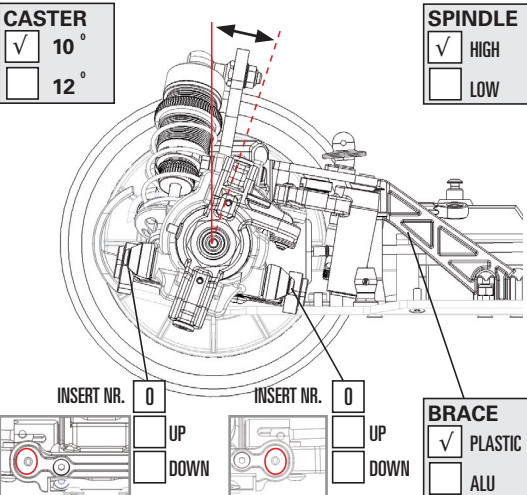
☒ 10°☐ 12°

SPINDLE

☒ HIGH☐ LOW

BRACE

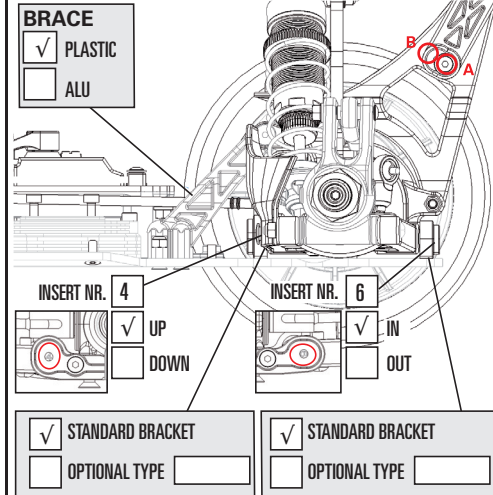
☒ PLASTIC☐ ALU

ANTI ROLLBAR

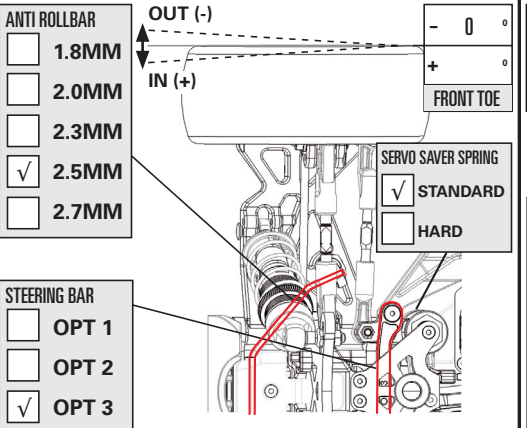
☐ 1.8MM☐ 2.0MM☐ 2.3MM☒ 2.5MM☐ 2.7MM

SERVO SAVER SPRING

☒ STANDARD☐ HARD

STEERING BAR

☐ OPT 1☐ OPT 2☒ OPT 3

WHEELBASE SHIMS

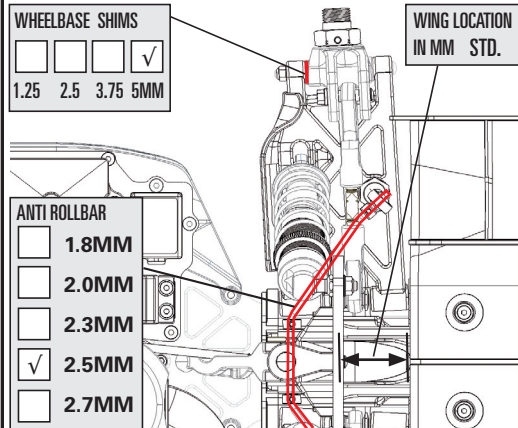
☐ 1.25☐ 2.5☐ 3.75☒ 5MM

ANTI ROLLBAR

☐ 1.8MM☐ 2.0MM☐ 2.3MM☒ 2.5MM☐ 2.7MM

FRONT CAMBER

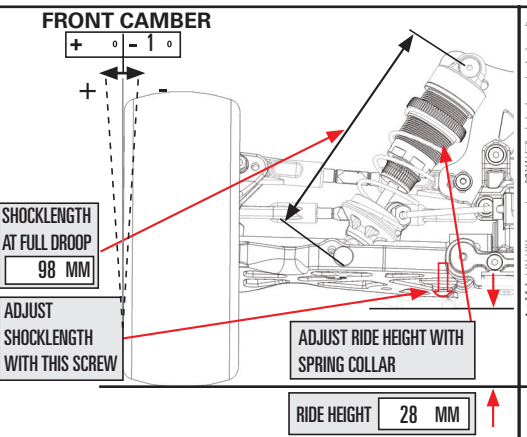
☐ + ☐ -1°

REAR CAMBER

☐ -2.5° ☐ +