



# TRUE MOTION CLUTCH

# 1/10

## INSTRUCTION MANUAL & EXPLODED VIEW

E

1

Bag  
14

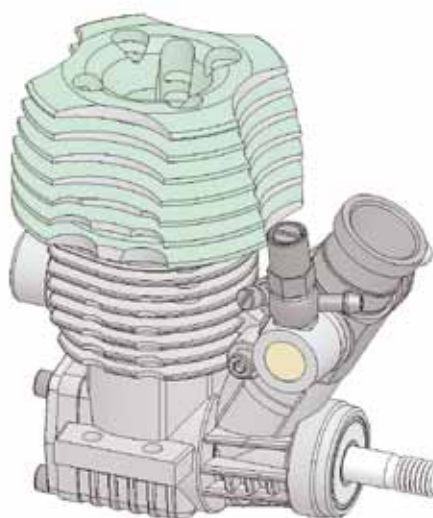

Note 1: to align the clutchgears with the 2-speed gears, it may be needed to use shim(s) 6x8x0.5mm behind the cone.

This you can only see after assembly of the clutch.

Note 2: the holes in the side of the flywheel can be used to block the flywheel (with short allen tool) through the bottom of the chassis, when the engine/clutch is mounted in the car. It's easier to tighten or loosen the pre-load on the clutch spring that way.

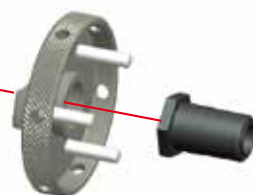

E

2

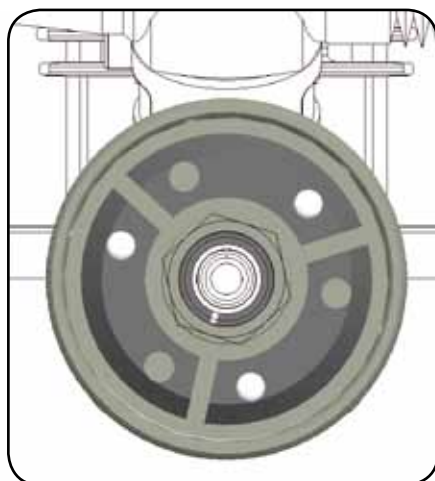
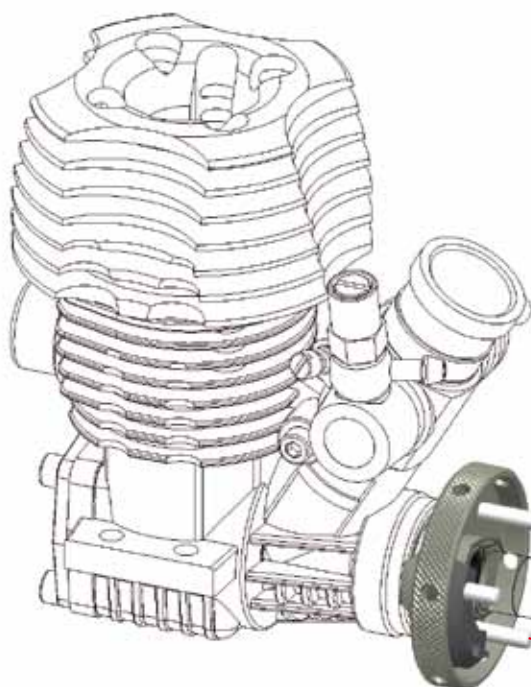

E

3

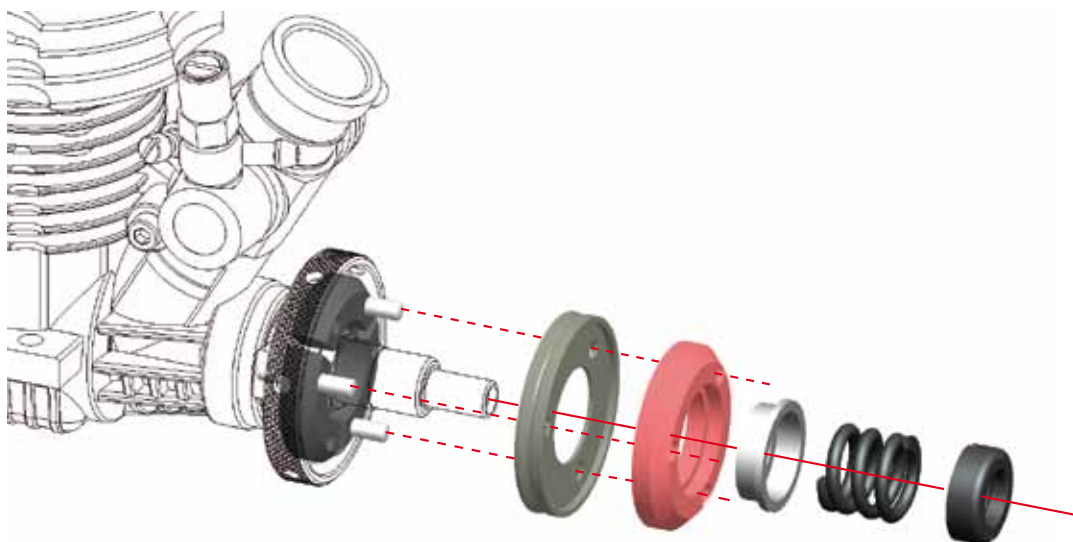

E

4

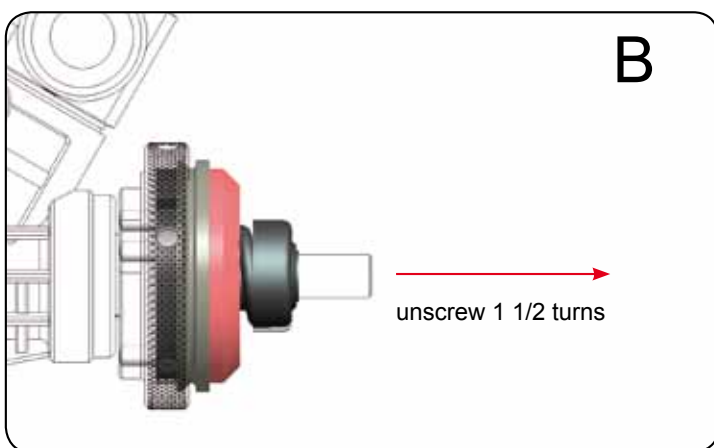
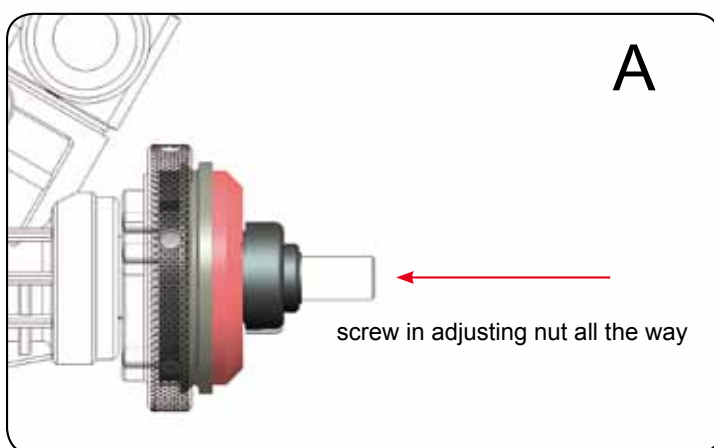

E

5

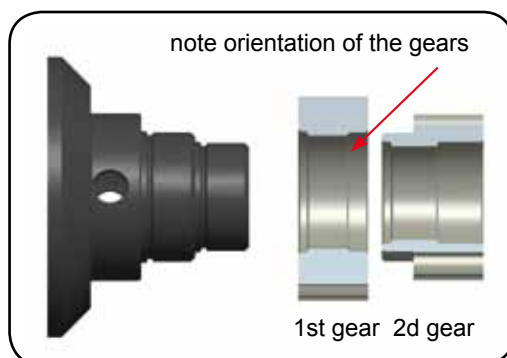
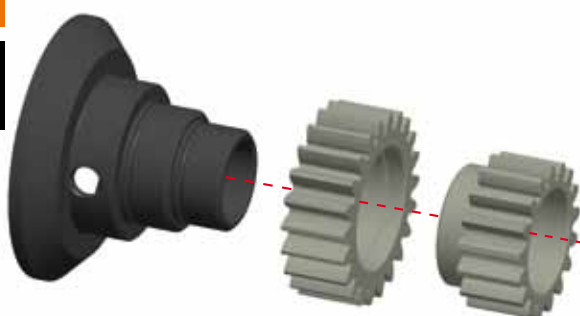

E

6

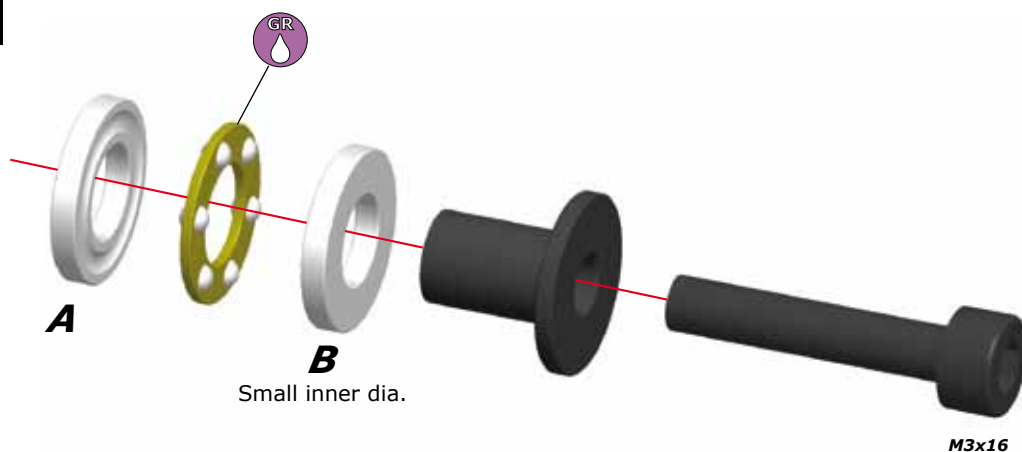
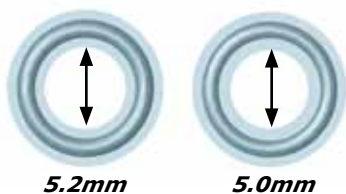
**A****B**

**IMPORTANT!** Install thrust bearing plates as shown

E

7

## SETTING THE CLUTCH GAP

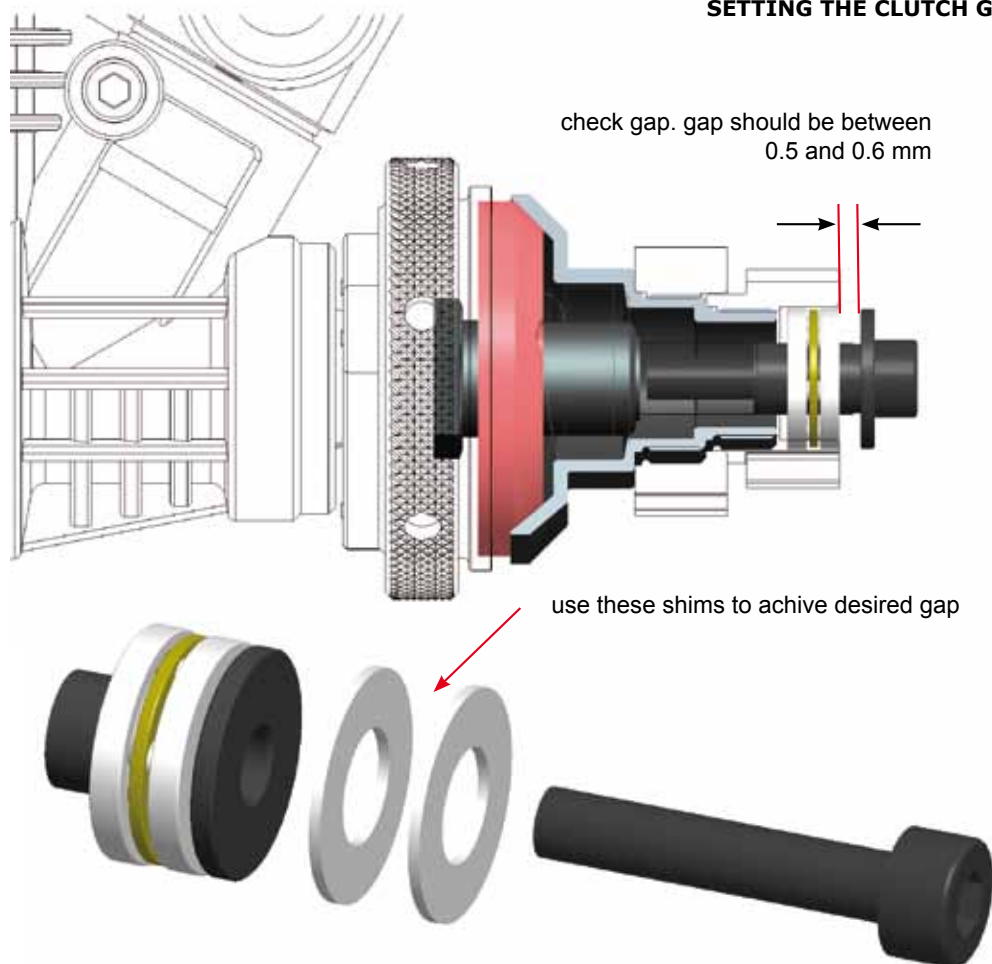

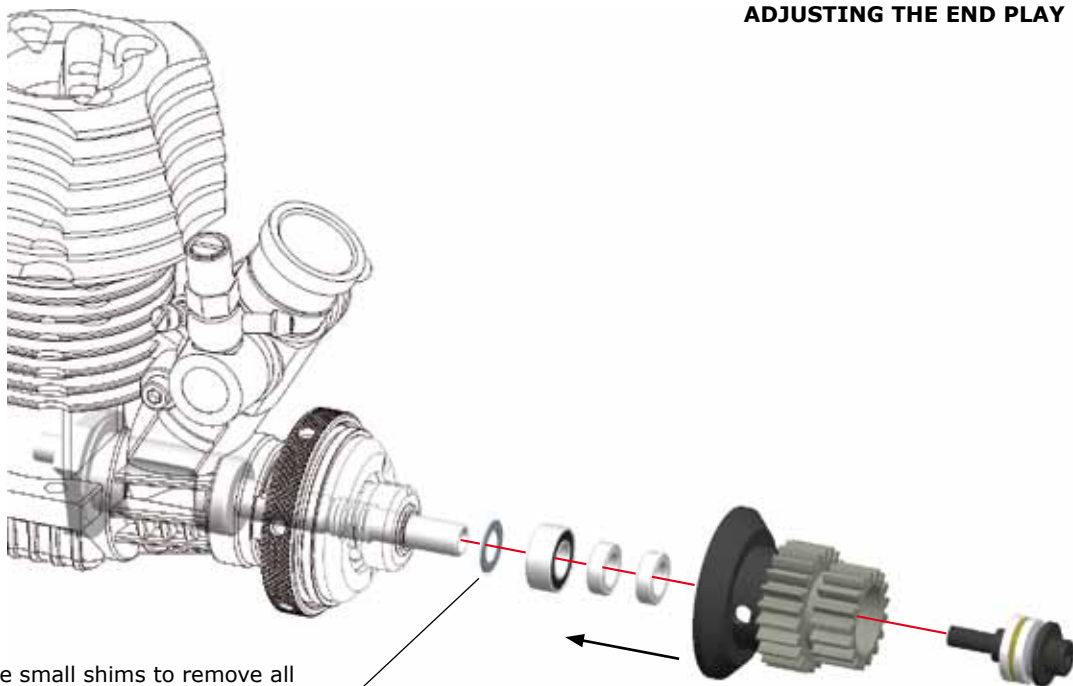

Place small shims to remove all but a small amount of end play

## Exploded view Centax True Motion Clutch 1/10

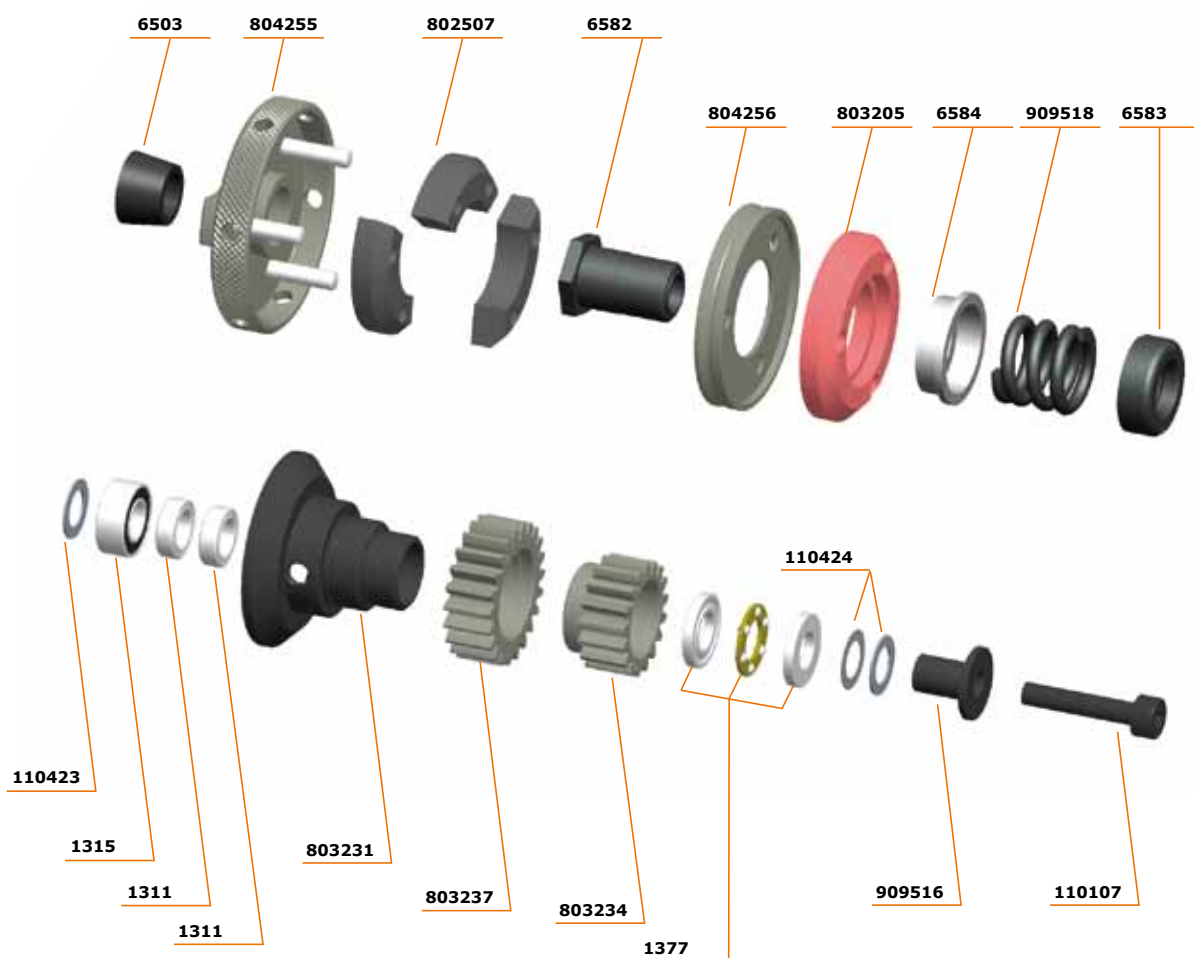

sales part-number Centax True Motion clutch 1/10 # 804250