



INSTRUCTION MANUAL
& REFERENCE GUIDE



Introduction

Serpent likes to welcome you to the fascinating world of rc car racing. You are now part of the worldwide network of Serpent drivers, which gives you access to superior technical and race support by dedicated Serpent people.

Serpent as a company has been active in racing, developing and manufacturing rc cars since 1979, and has gathered a large following of enthusiastic and dedicated rc car racers around the world.

The Serpent S411TE is developed by an expert team of racers and engineers, to offer you the pinnacle of rc racing car technology. Continuously pushing the performance envelop, Serpent's engineers have added new and innovative features that help to take your Serpent S411TE into the winners circle.

For latest information about S411TE check on: www.serpent.com/400005

Enjoy building and racing the Serpent S411TE

Team Serpent

Contents

2	Introduction / contents
3	Safety, Customer service
	Read This First
4	Using the Manual
5	Assembly Instructions
7	Rear Assembly
9	Rear Suspension
11	Differential Assembly
15	Front Assembly
22	Front Suspension
34	Shock Assembly
47	Final Assembly
48	Reference guide
49	Exploded views
57	Parts List

Safety

Read and take note of the 'Read this First section' before proceeding to assemble the car-kit. This car-kit is intended for persons aged 16 or older.

Customer service

Serpent has made a strong effort to make this manual as complete and clear as possible. Additional info may be published in our website: www.serpent.com or you may ask your dealer or the Serpent distributor for advice, or email Serpent direct: info@serpent.com. The Serpent Facebook, Twitter and Youtube pages give additional means of support and communications.

Instructions, how to use

The kit includes bags, with bag numbers, which refer to the same step in the manual. Open only the indicated bag(s) per step and finish that part of the assembly. Remaining parts will be needed later on in the assembly process.

Instructions

Serpent's long tradition of excellence extends to the instruction manuals, and this instruction manual is no exception. The easy-to-follow layout is richly illustrated with 3D-rendered full-color images to make your building experience quick and easy. Following the instructions will result in a well-built, high-performance race-car that will soon be able to unleash its full potential at the racetrack.

SETUP

In certain assembly steps you need to make basic adjustments, which will give you a good initial setup for your Serpent S411. Fine-tuning the initial setup is an essential part of building a high-performance racecar like your S411.

Exploded views and partslist

The exploded views and parts lists for the Serpent S411 are presented in the Reference Guide section in the back of this manual. The exploded views show all the parts of a particular assembly step along with the Serpent part number. The parts lists indicate the part number and name of each part for easy reference when ordering.

Read this first!

- This is a highly technical hobby product, intended to be used in a safe racing environment. This car is capable of speeds in excess of 80 km/h or 50mph. Please follow these guidelines when building and operating this model.
- Parental guidance is required when the builder/user of this car is under 16.
- Follow the building instructions. If in doubt, contact your dealer or importer.
- Be sure to use the proper tools when assembling the car. Always exercise caution when using electric tools, knives and other sharp objects.
- Be careful when using liquids like lubrication oil, fuel or glue. Do not swallow.
- Follow the manufacturer's instruction in case you experience irritation after using the product.
- Be careful when operating the car. Stay away from any rotating parts such as wheels, gears and transmission. Stay away from motor, engine and exhaust pipe system or speedo during and immediately after use, as these parts may be very hot. We advise to use protective hand gloves.
- Only operate this car in a safe environment, like a special racing track or a closed parking lot. Avoid using this car on public roads, crowded places or near infants.
- Before operating this car, always check the mechanical status of the car. Also check that the transmitter and receiver frequencies correspond and are not used by any other racer at the same time. Check that the batteries of the transmitter and receiver are fully charged.
- After use, always check all the mechanics of the car. We advise to clean the car immediately after use, and inspect the parts for wear or fractures. Replace when necessary. Do not use water, methanol, thinner or other solvents to clean the car.
- Empty the fuel tank (depending on model) if needed and disconnect the receiver battery.
- Store the car in a dry and heated place to avoid corrosion of metal parts.
- Avoid using this car in wet conditions as the water will cause corrosion on the metal parts and bearings and these parts will cease to function properly. If driven in the wet, ensure that all the electric equipment is waterproofed and after use, that all moving parts are dried immediately.

USING THE MANUAL

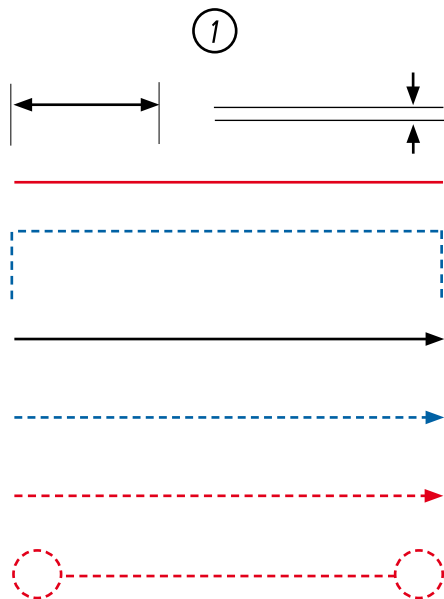

Step number;
the order in which you should assemble the indicated parts

Length after assembly / Gap between two items

Assembly path of one item into another

Group of items (within lines) should be assembled first

Direction the item should be moved

Glue one item to another

Press/Insert one item into another

Connect one item to another



Apply transmission grease*(Grey)



CA glue* (Red)



Silicon oil



threadlock* (Blue)



differential oil (Orange)

(*Items not included.)

ASSEMBLY INSTRUCTIONS

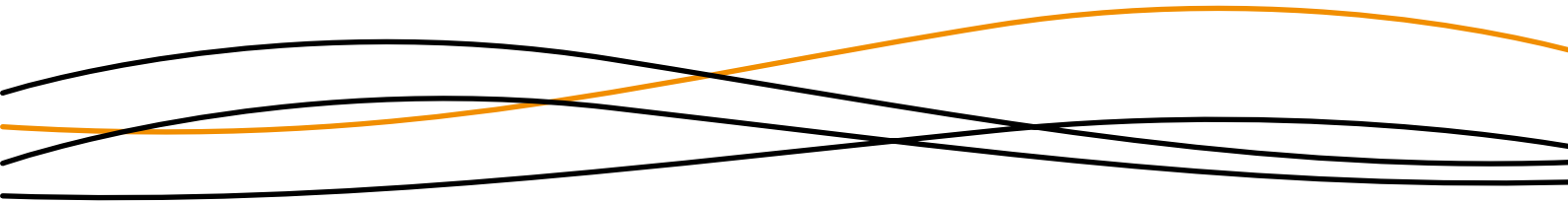

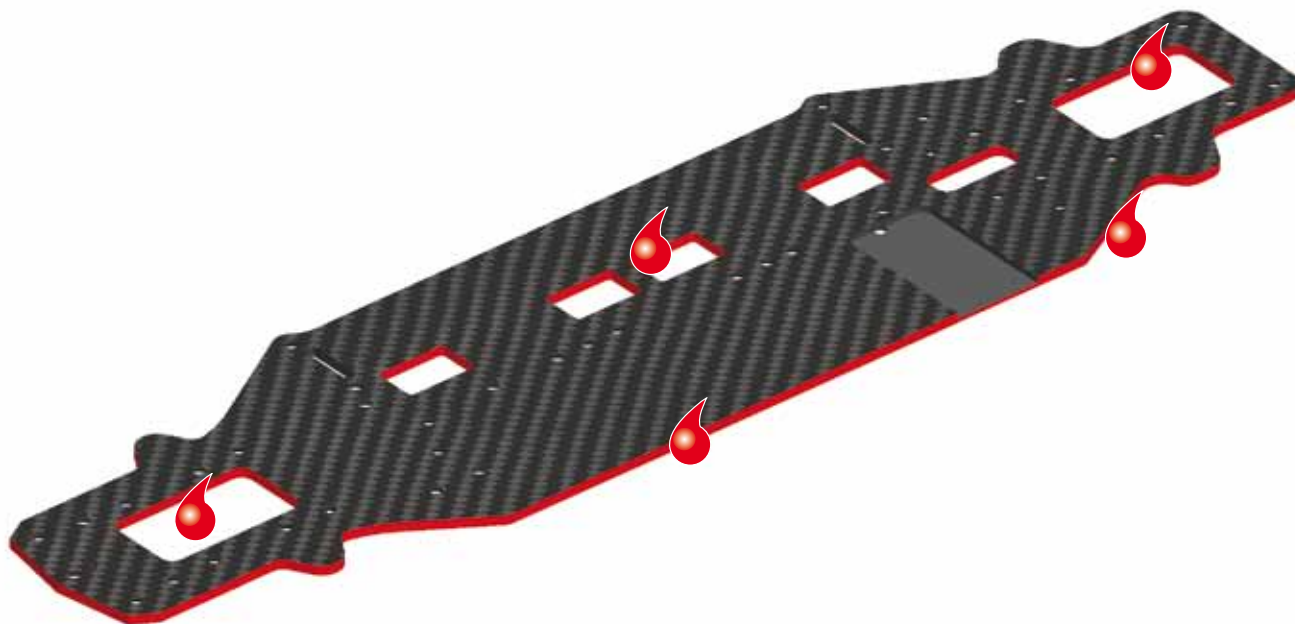

apply Cyano around the chassis (as red indicated)

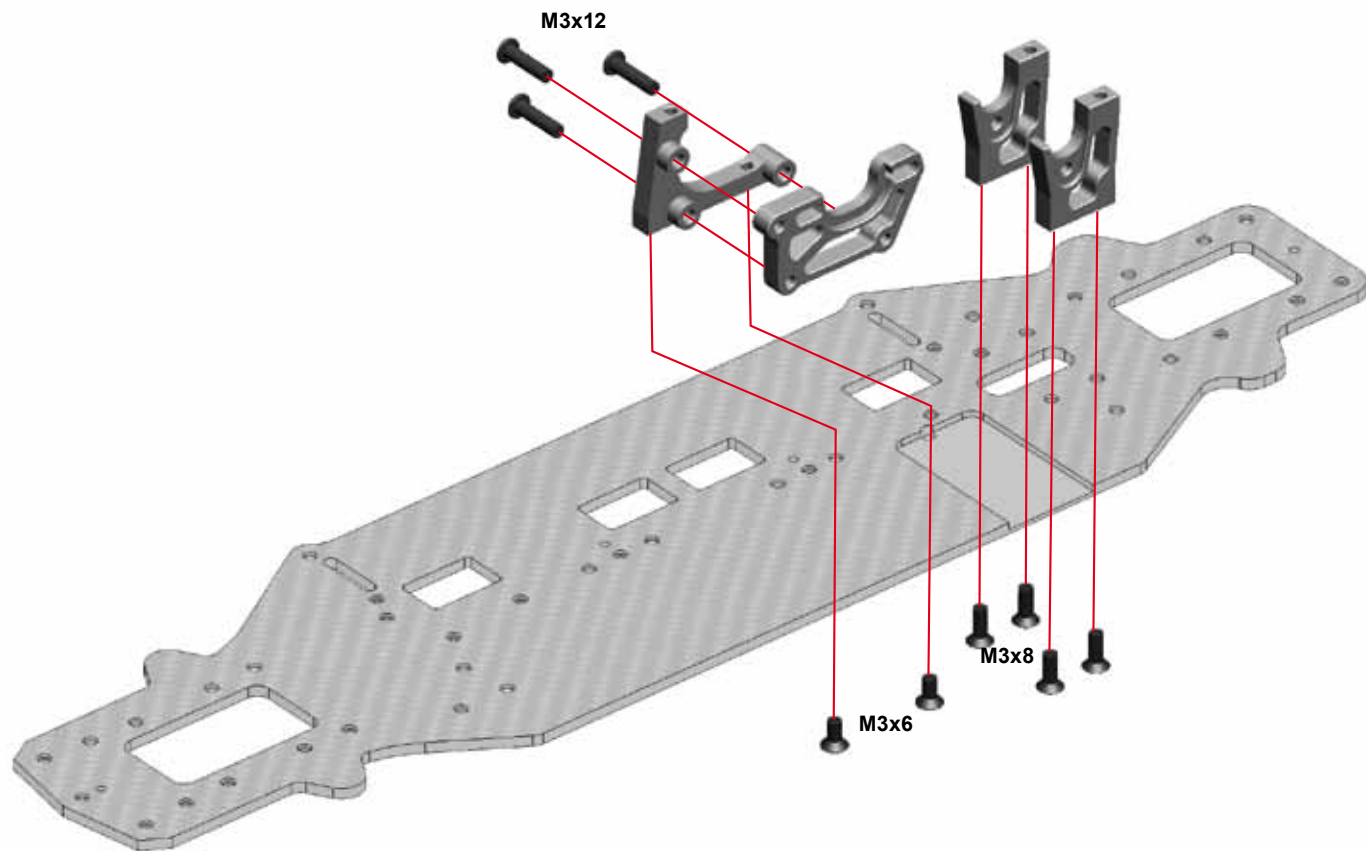

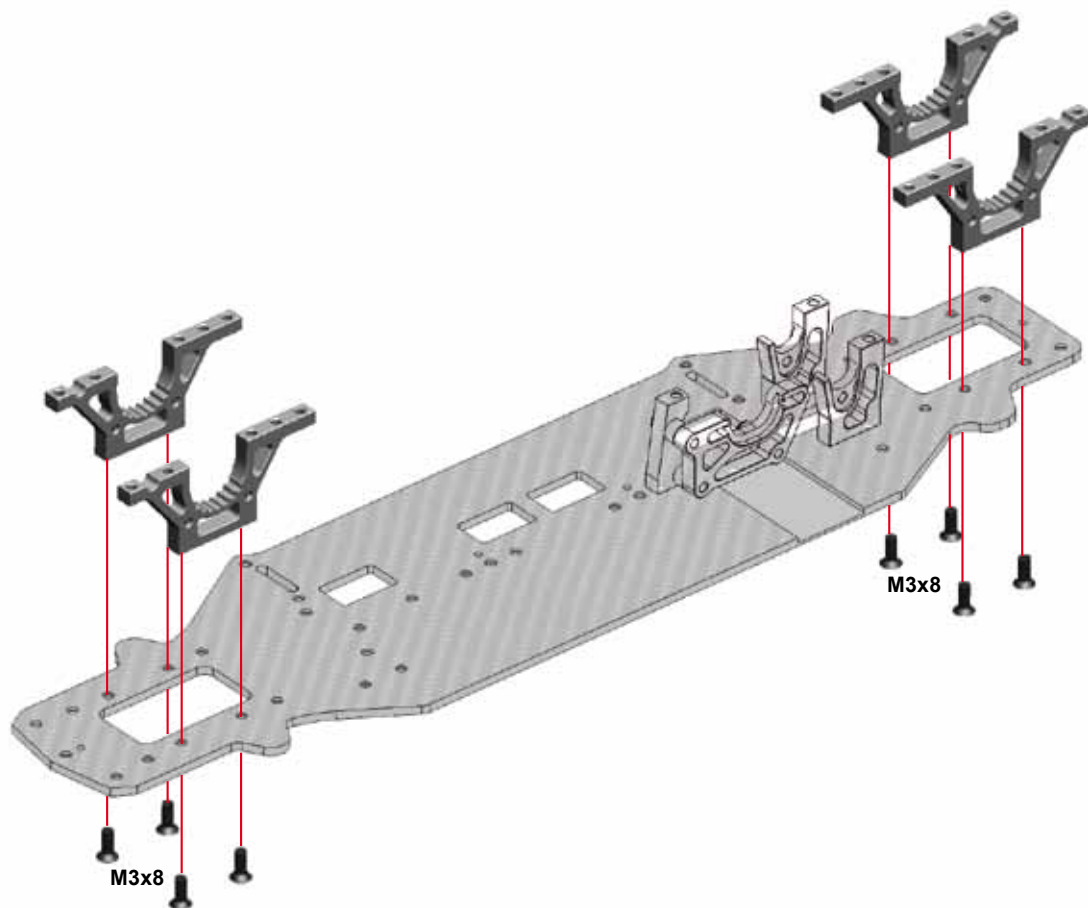

A

4

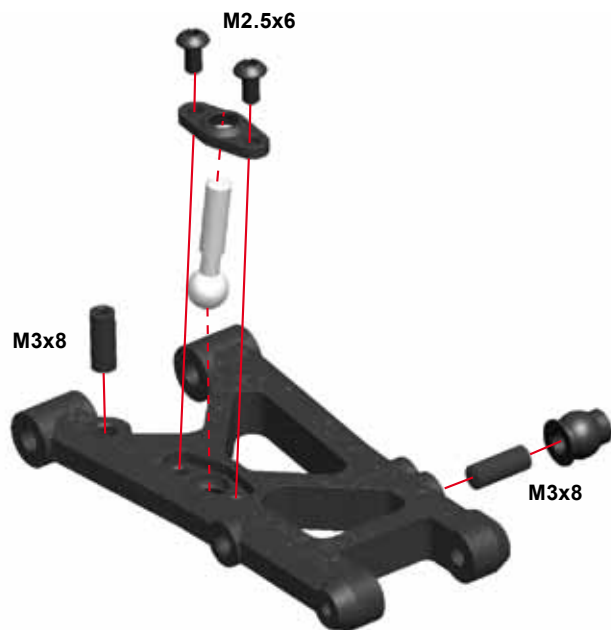

A

5

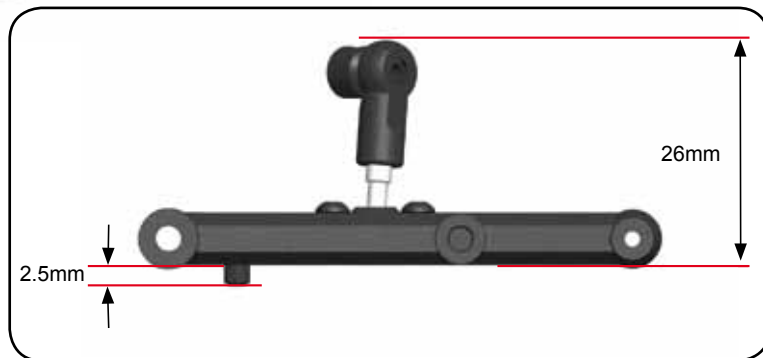

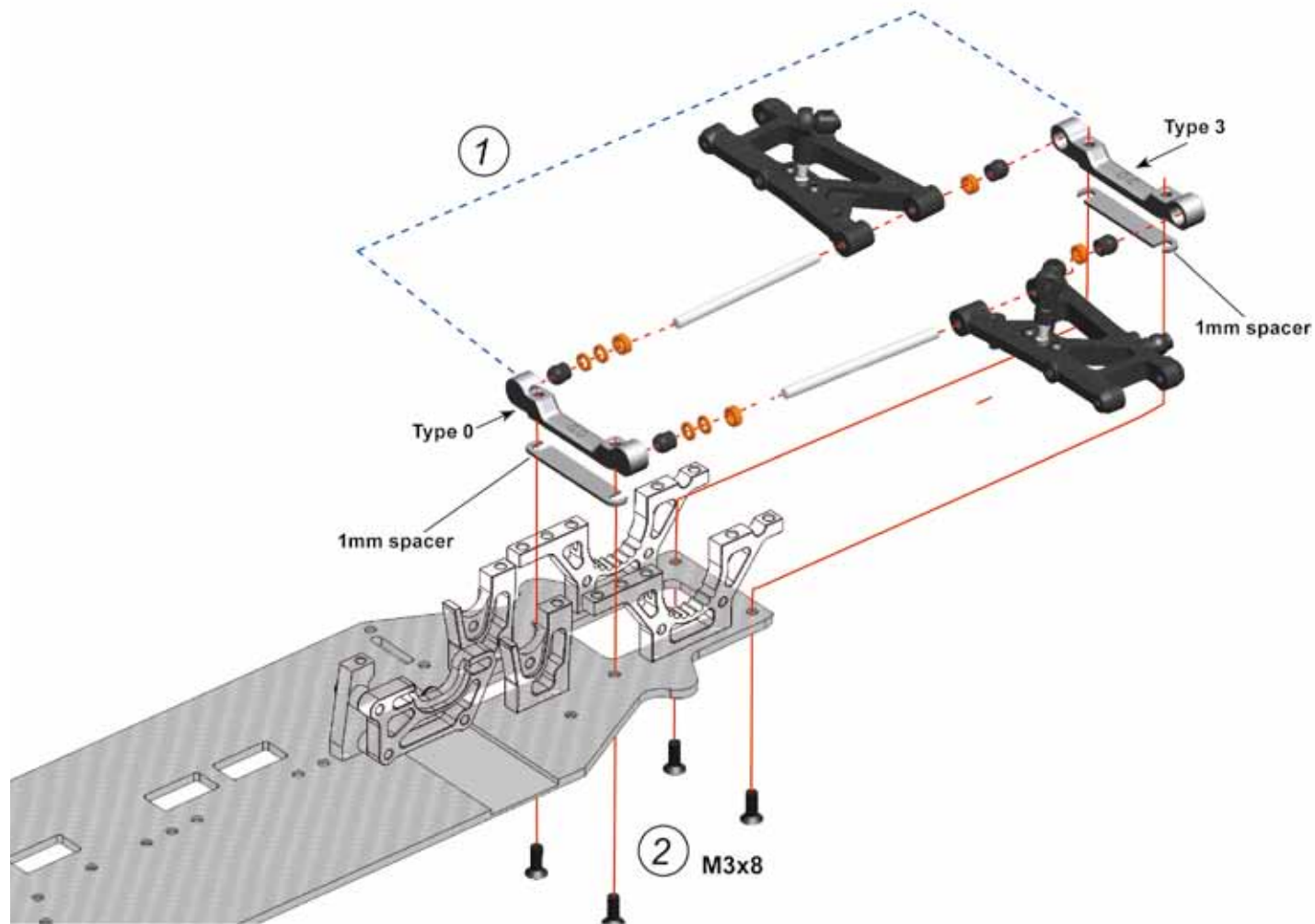

A

7

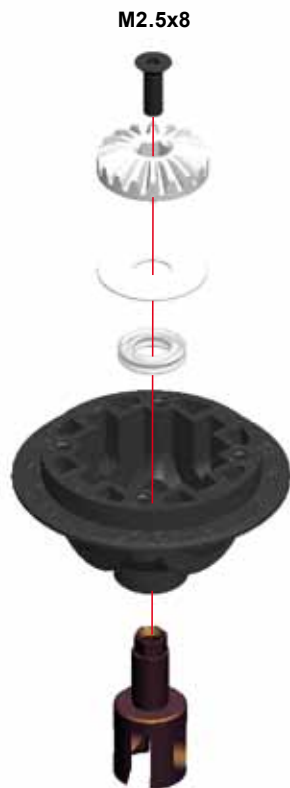

A

8

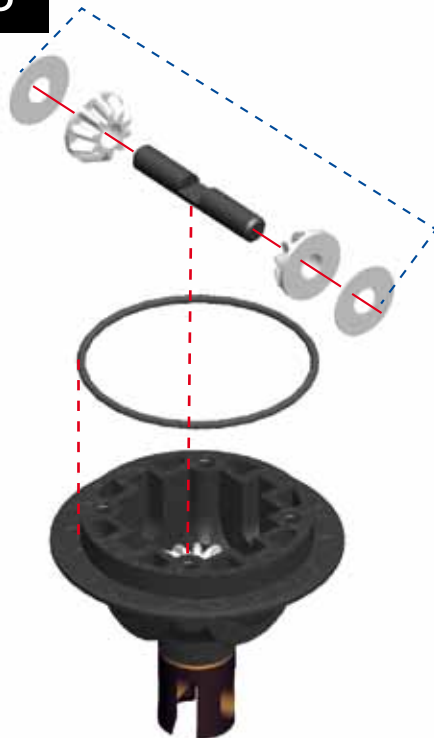

A

9

Fill up with 1200 cst silicone oil, until shaft is just covered



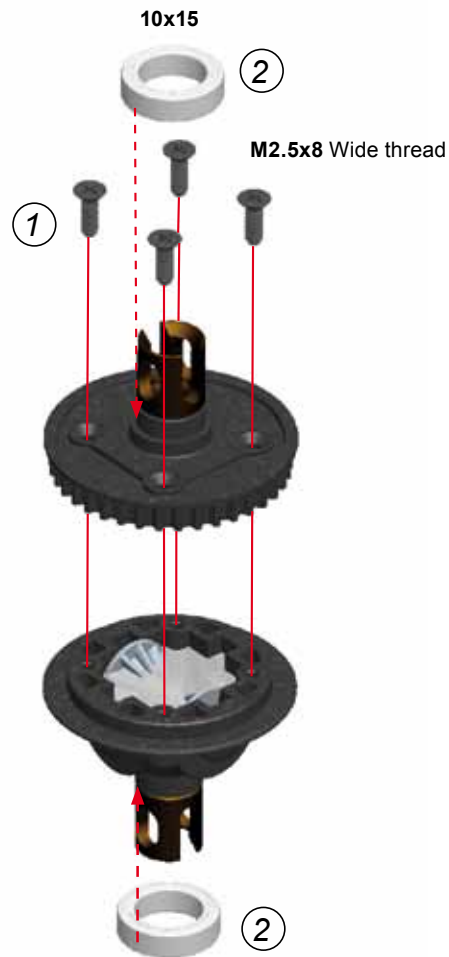
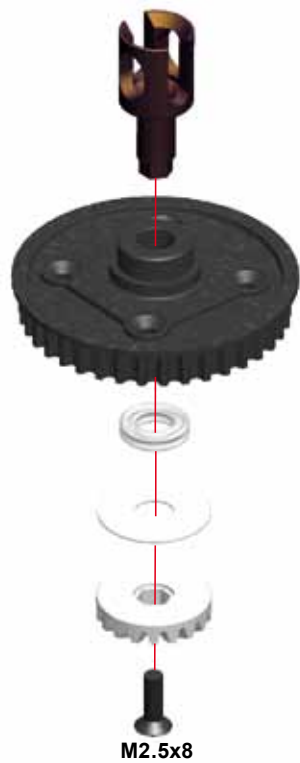

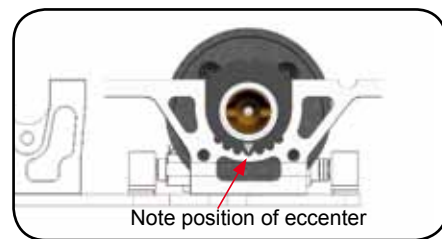
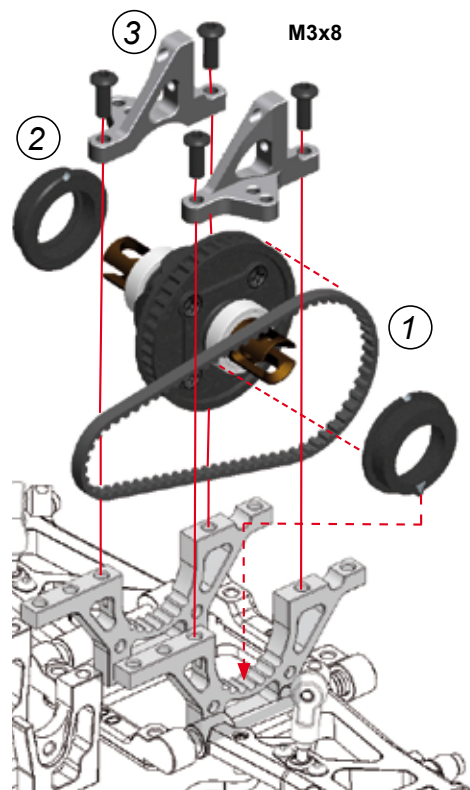

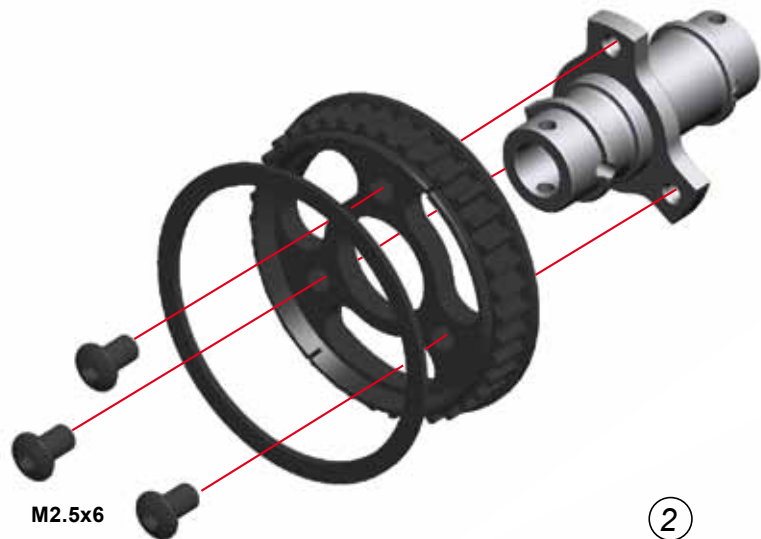

TIP
Mount the pulley-shim correctly

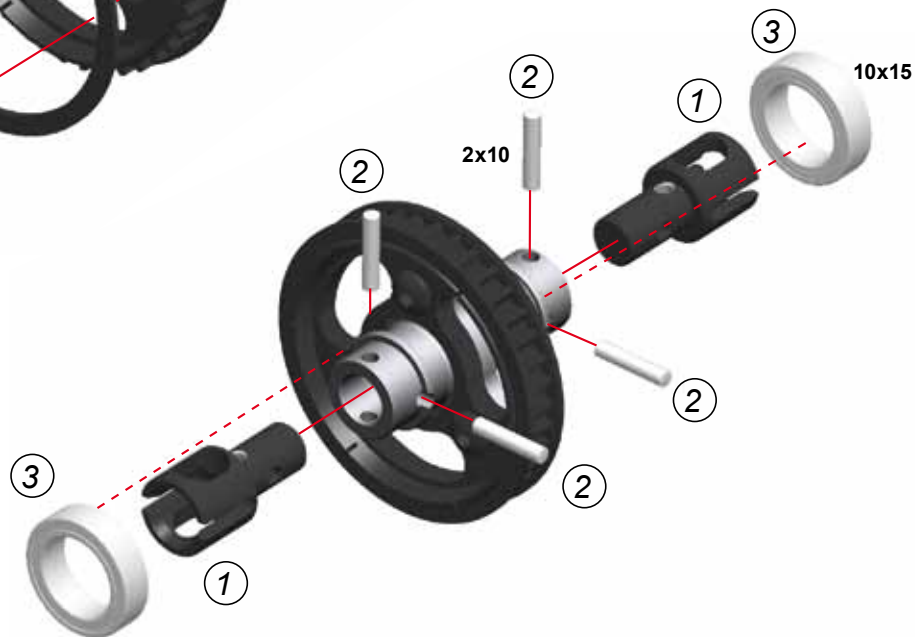

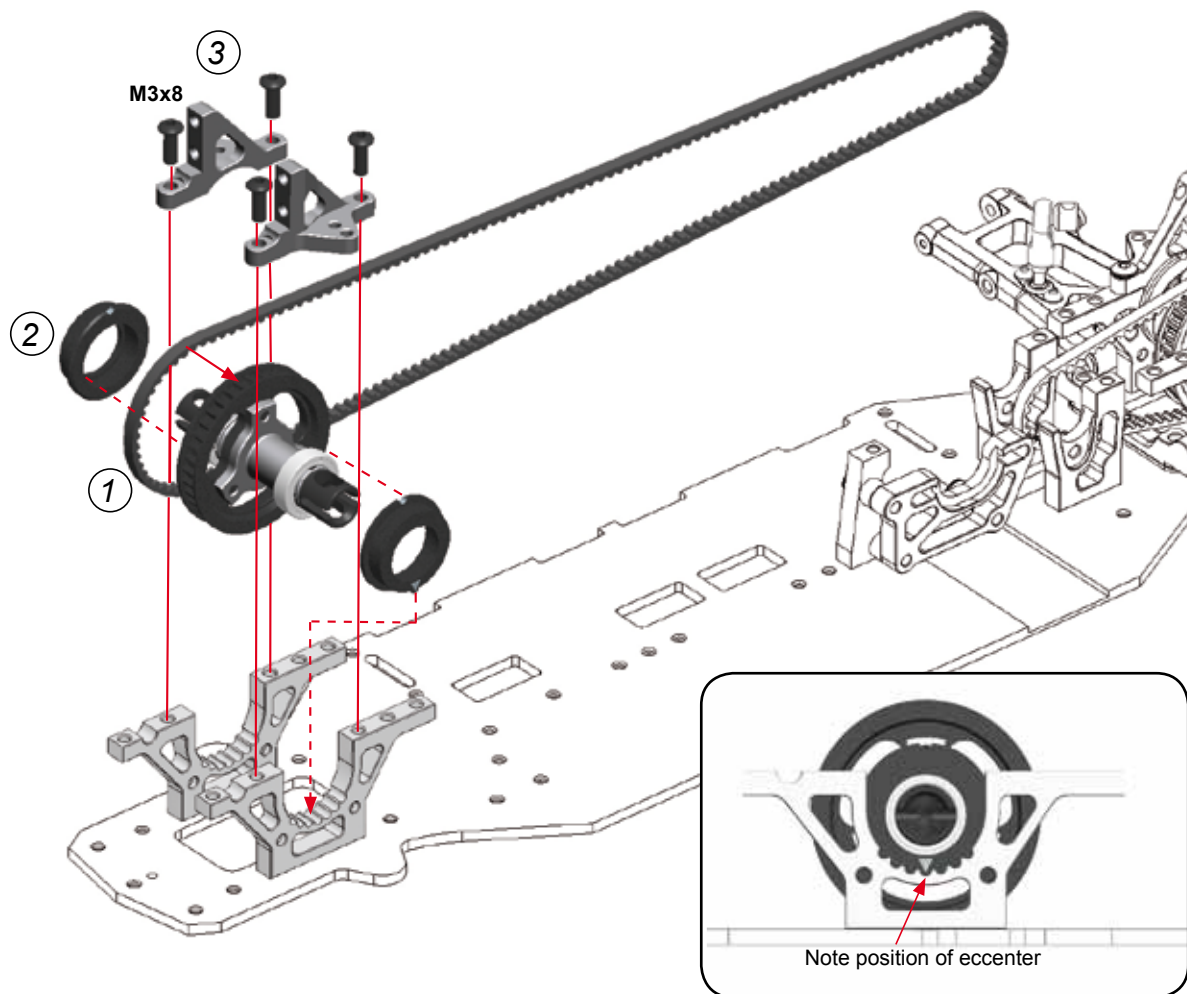

A

16

BAG

3

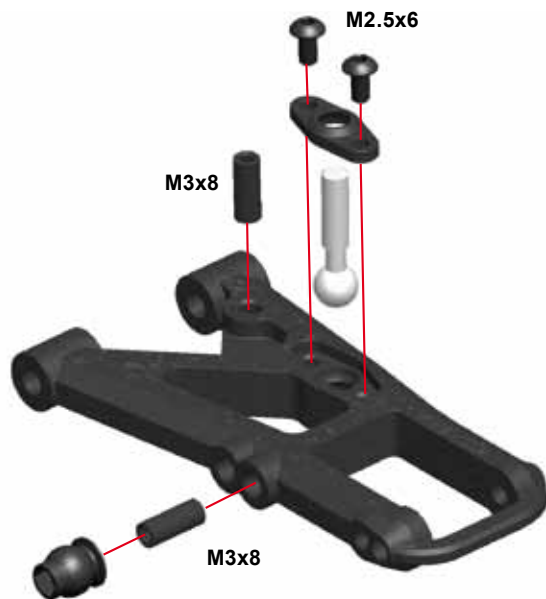

A

17

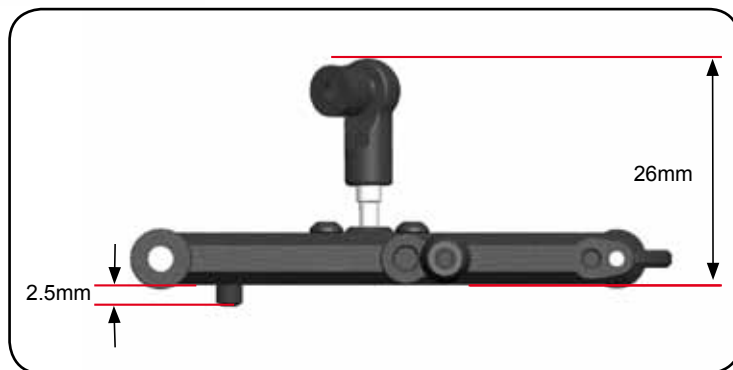

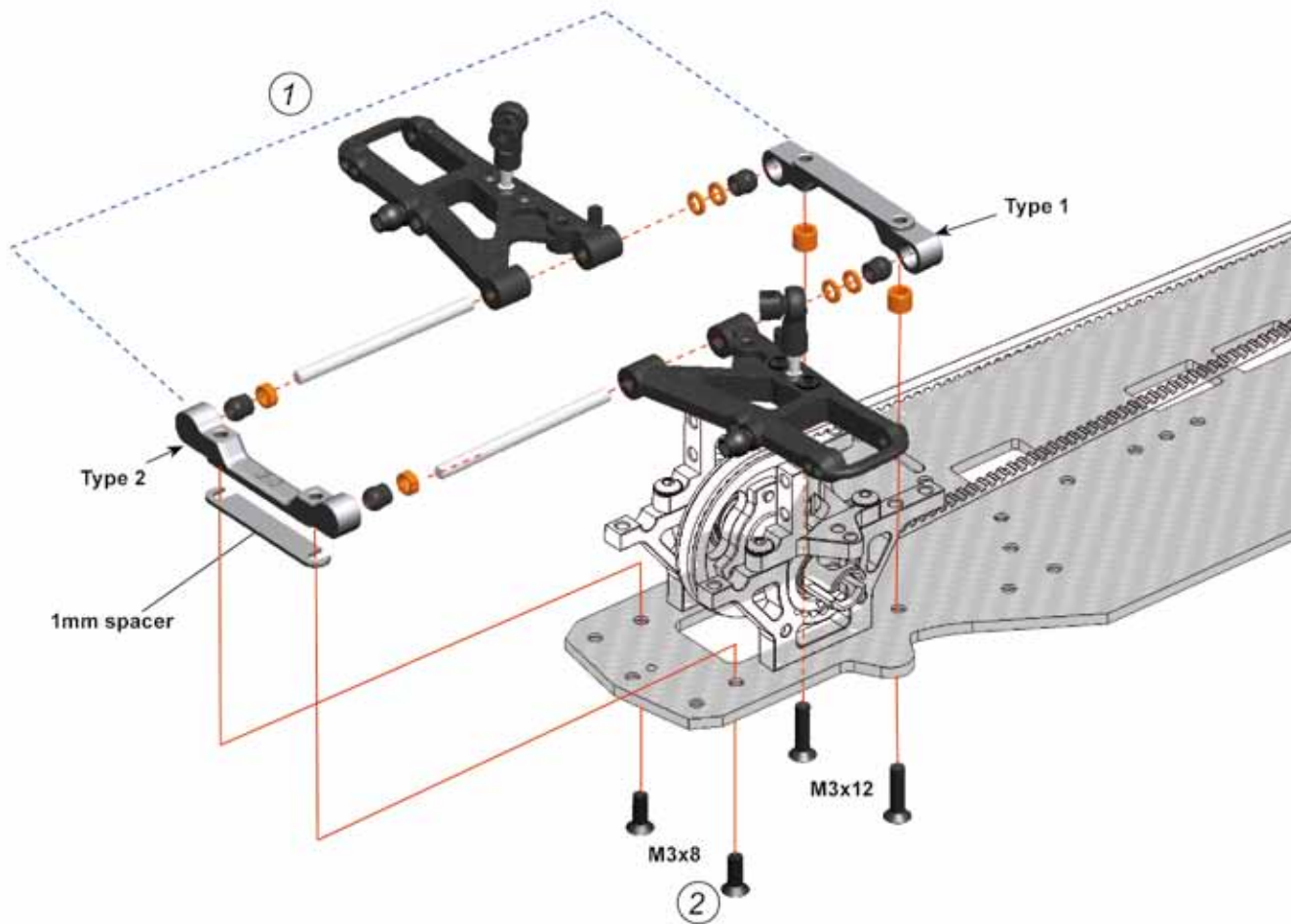

A

19

BAG

4

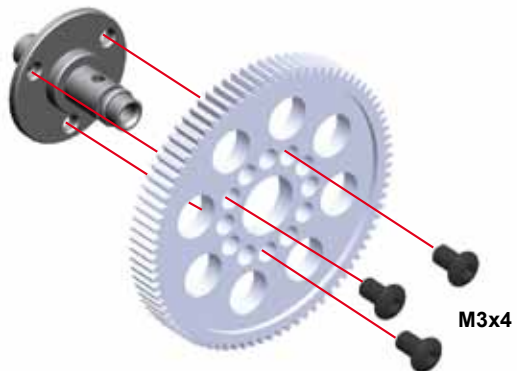

A

20

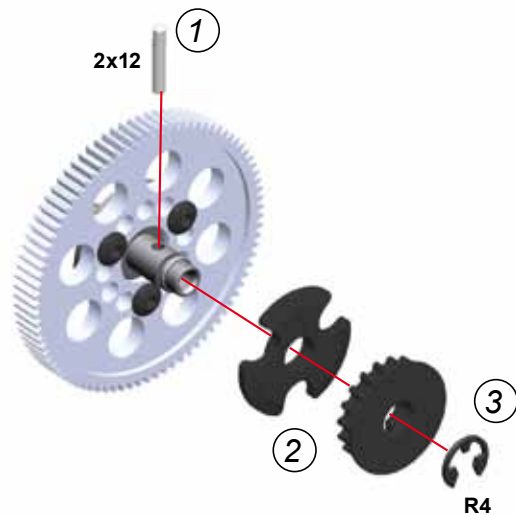

A

21

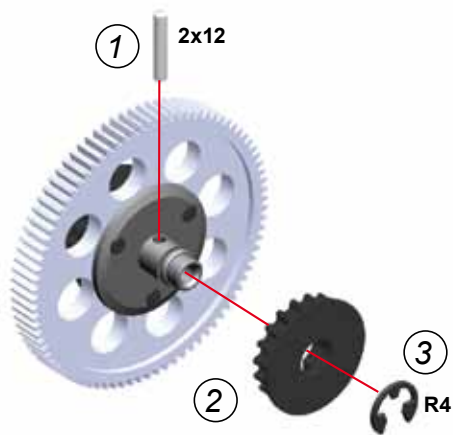

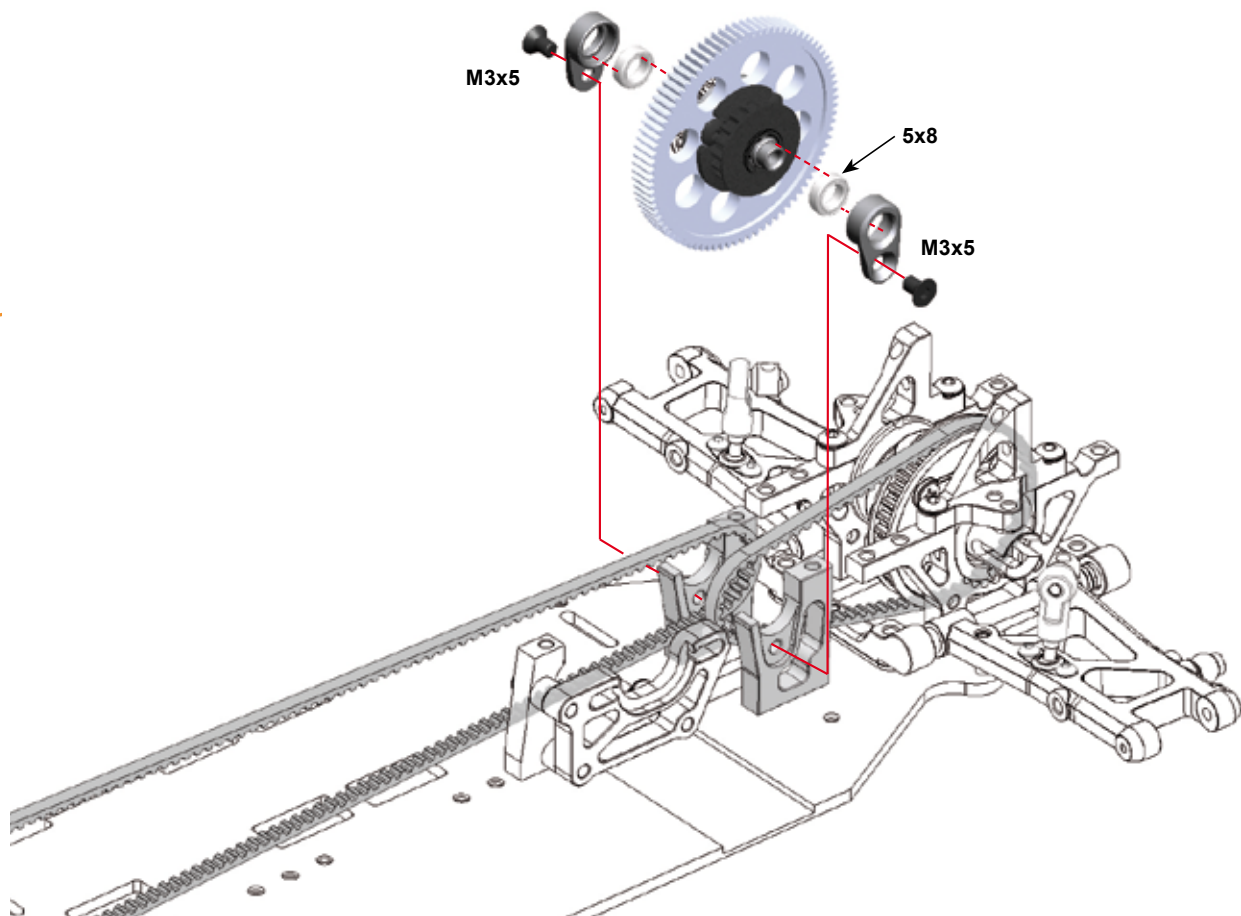

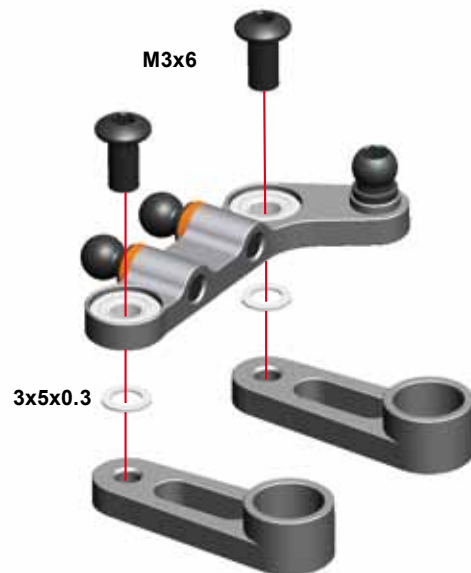
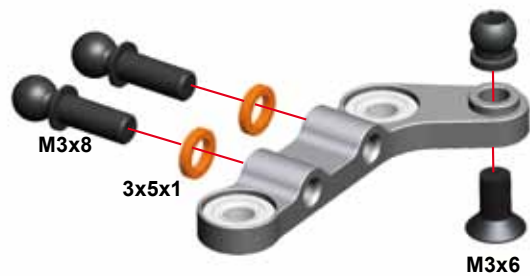

A

25

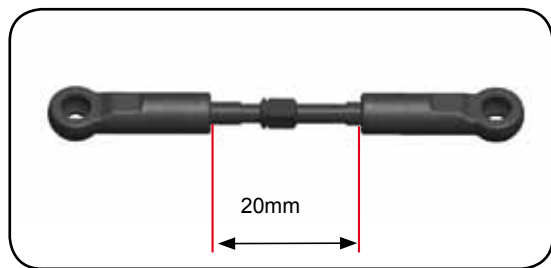

A

26



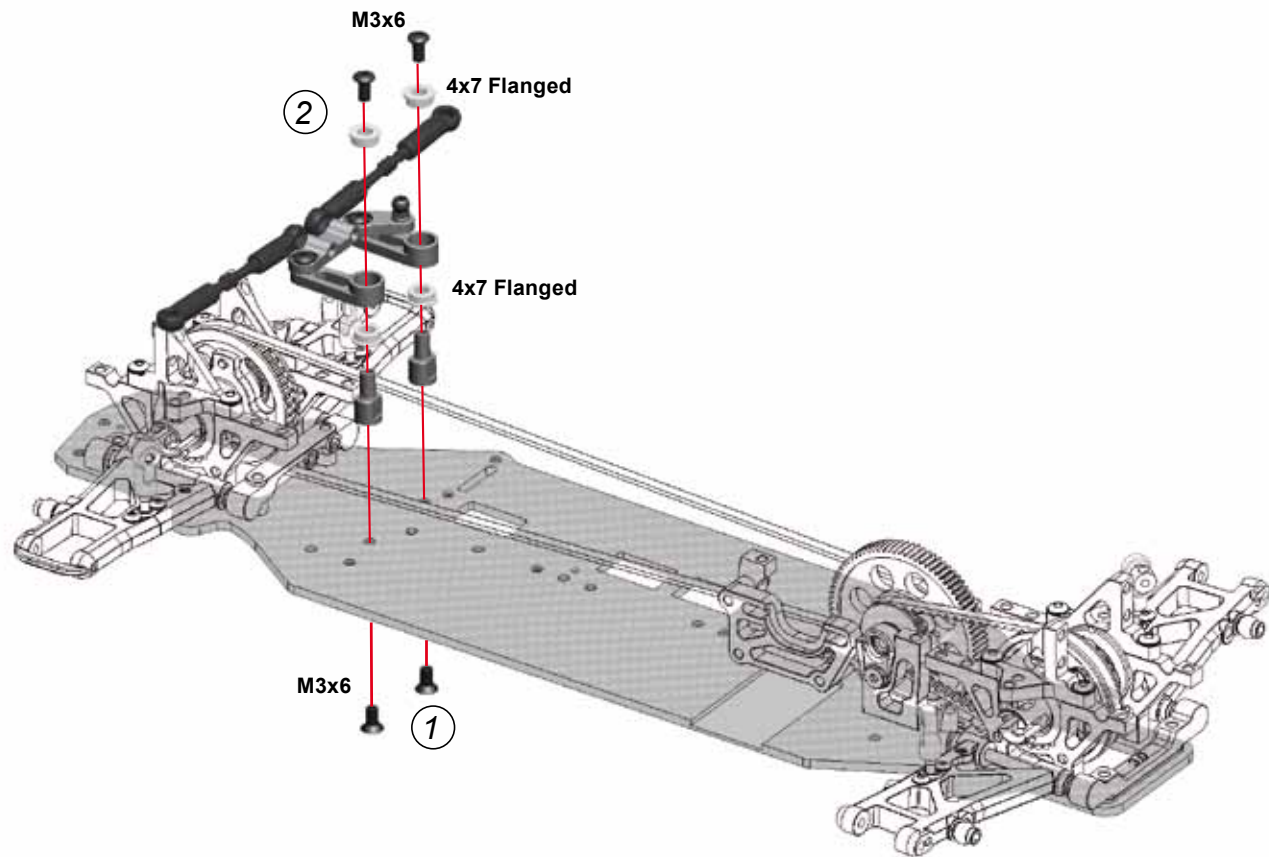

A

28

BAG

5

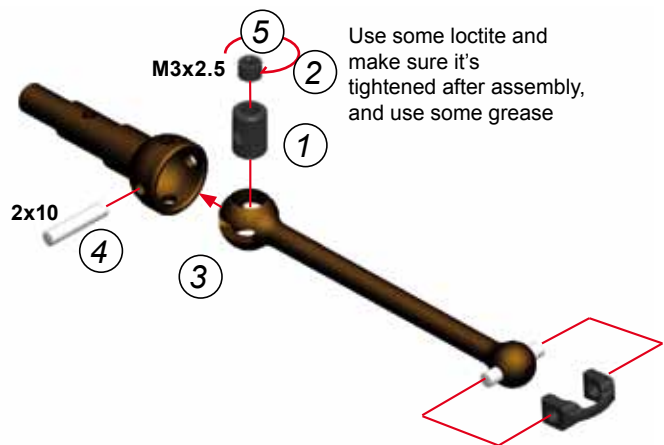

A

29

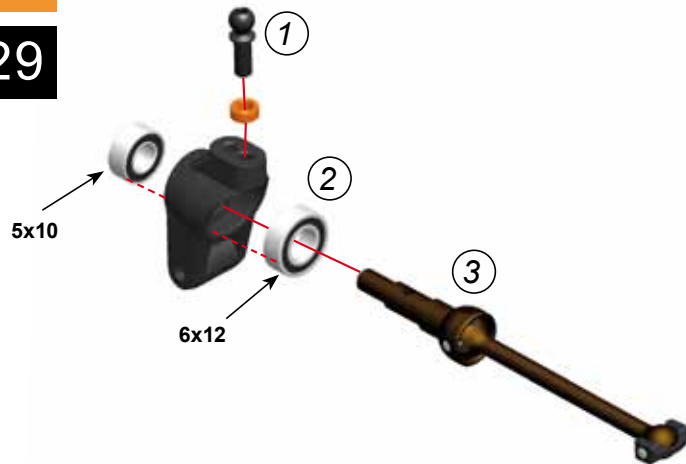

A

30

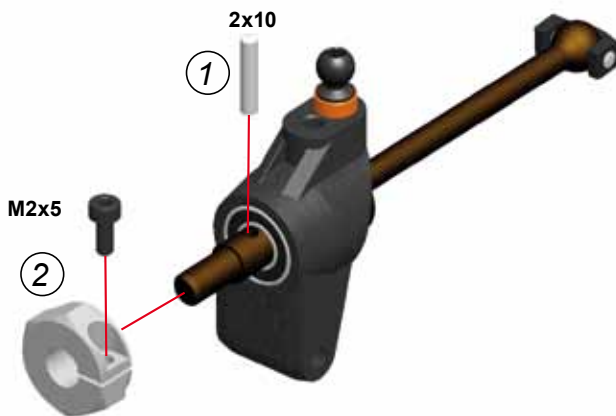

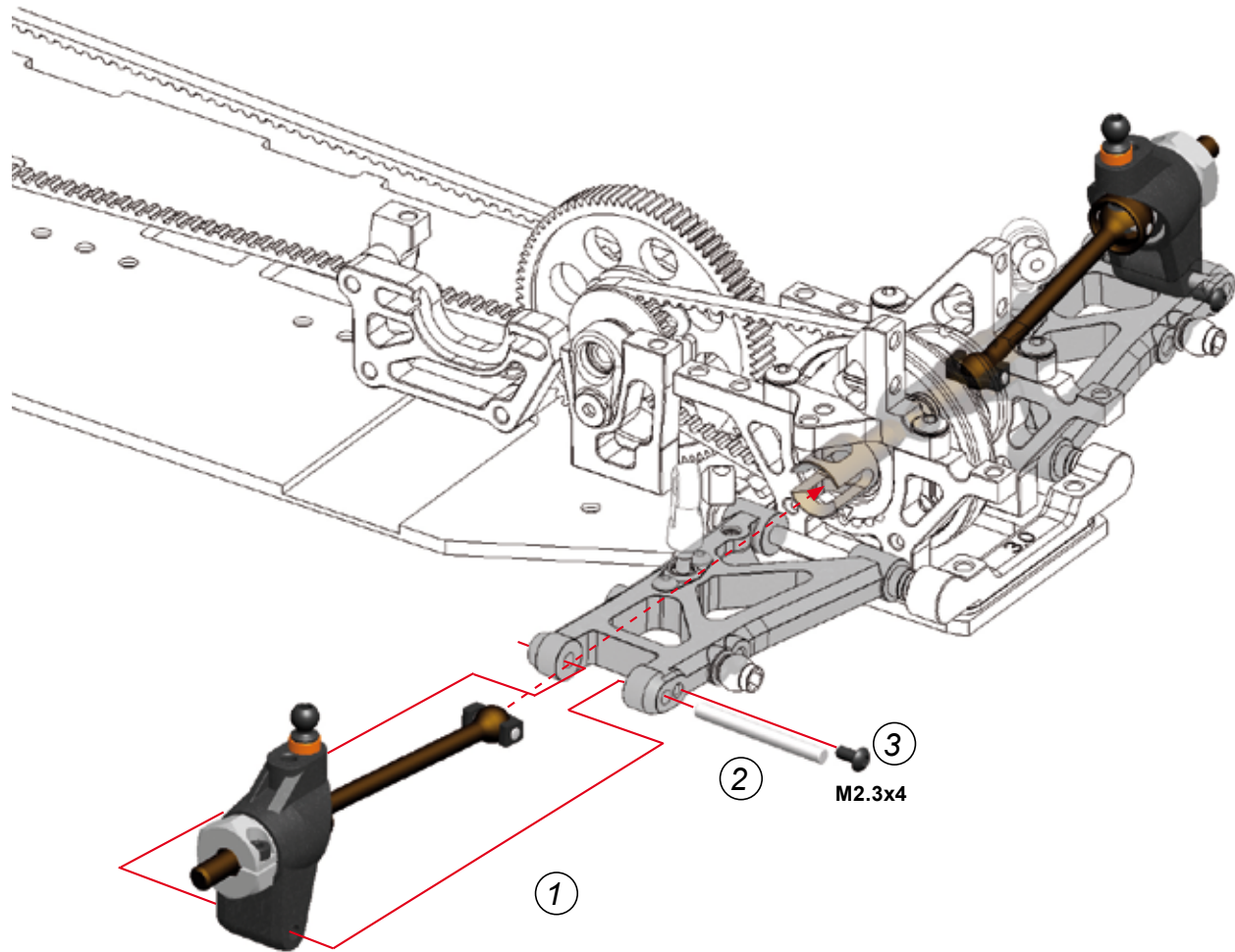

TIP

Make sure to use correct size
nylon wire-insert for anti-roll bar

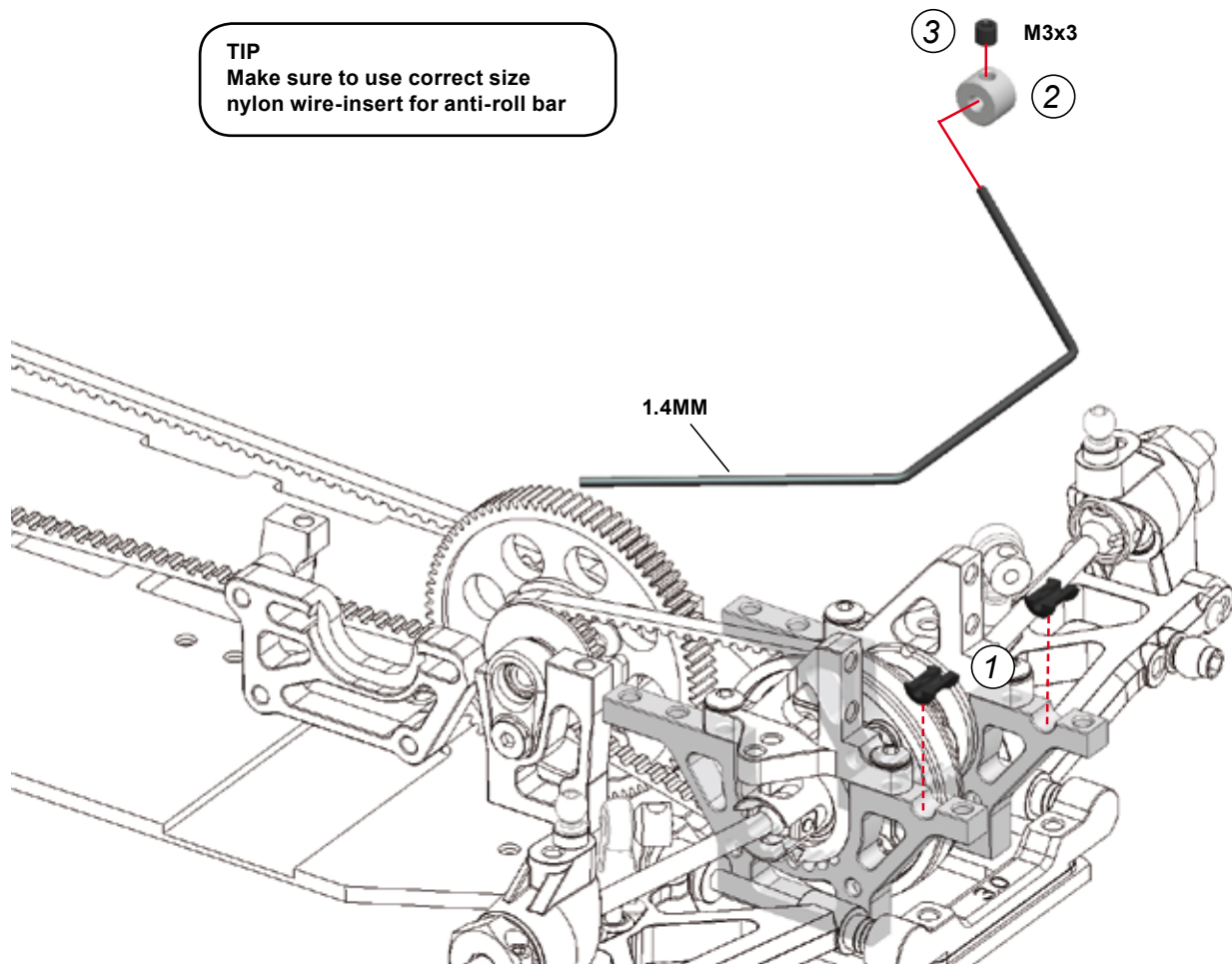

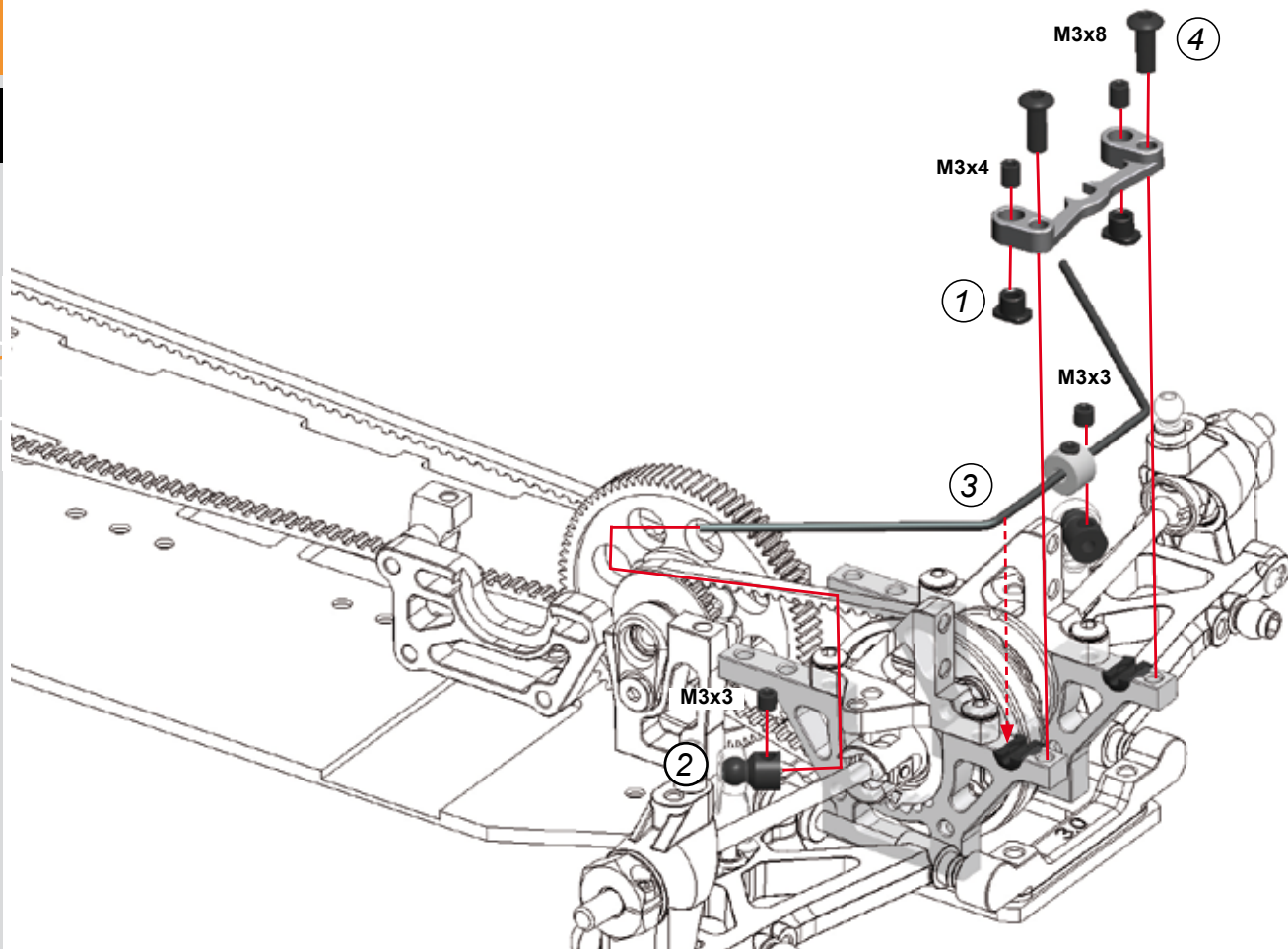

A

34



9mm

A

35

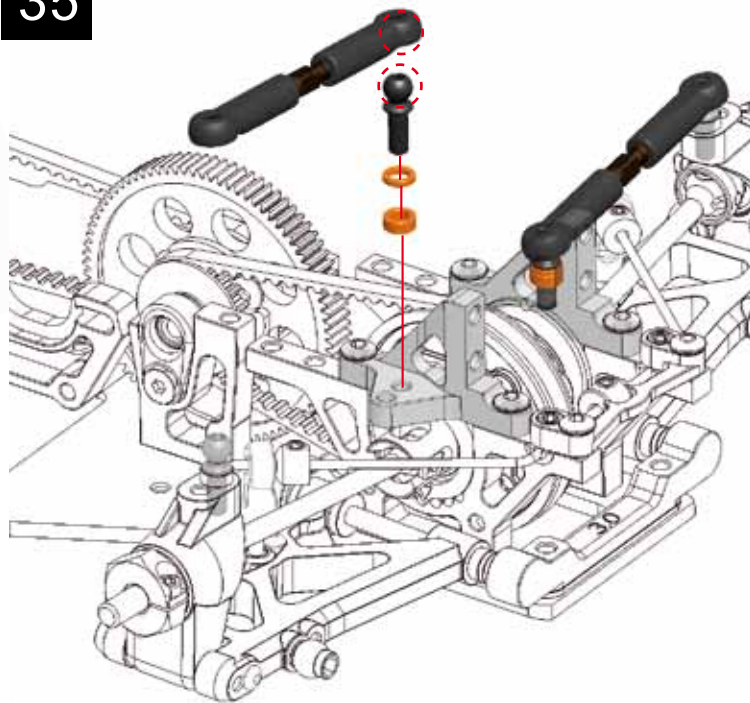

A

36

BAG

6

A

37

A

38

Team EDITORITE

28

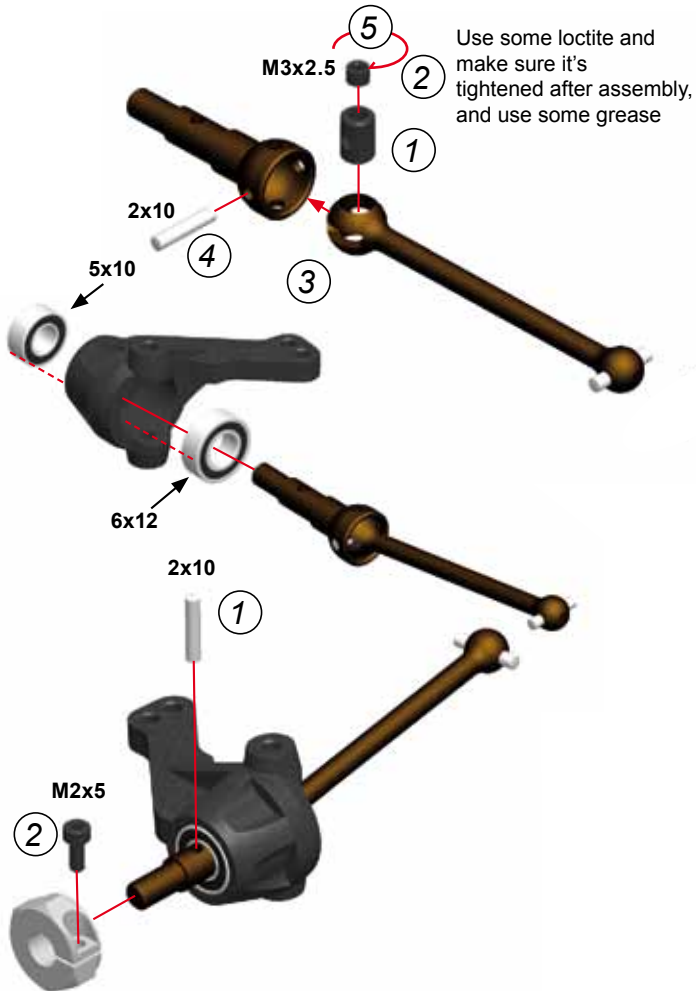

A

39

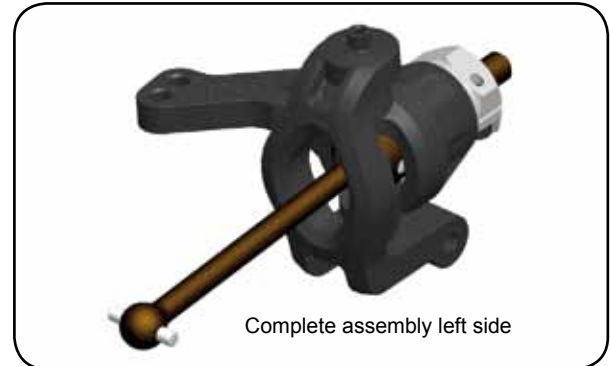
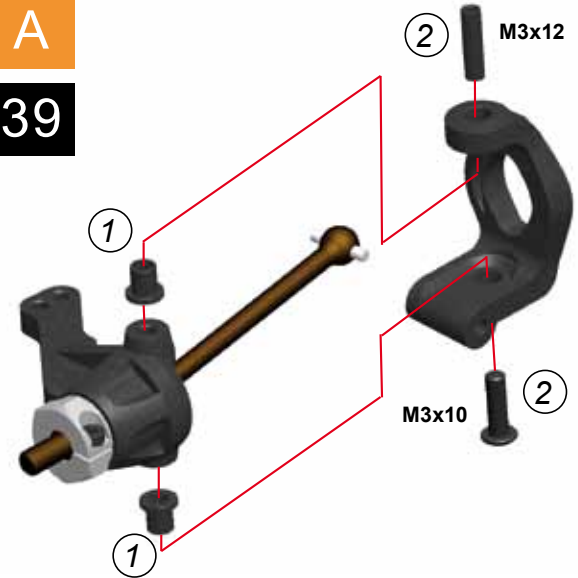

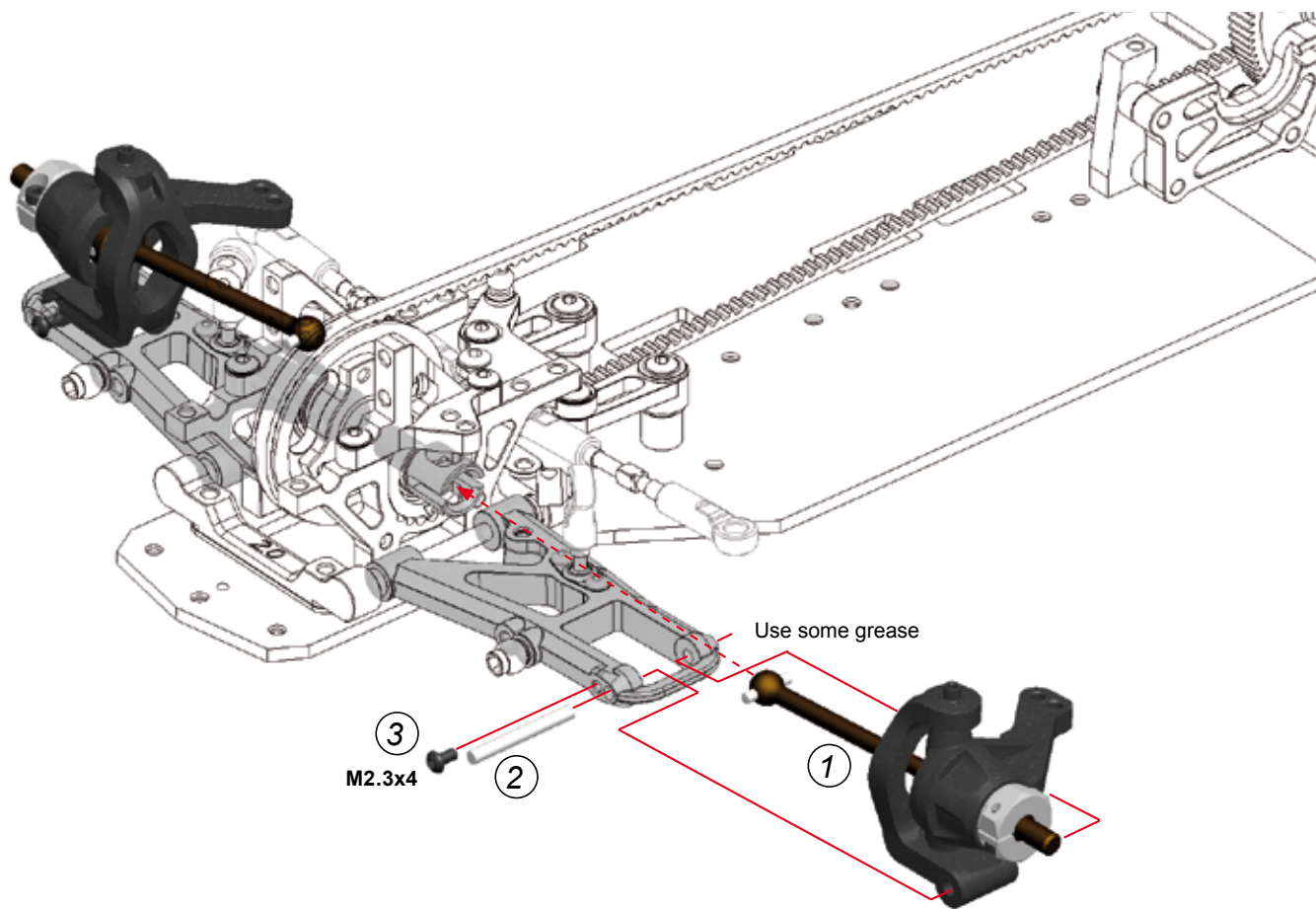

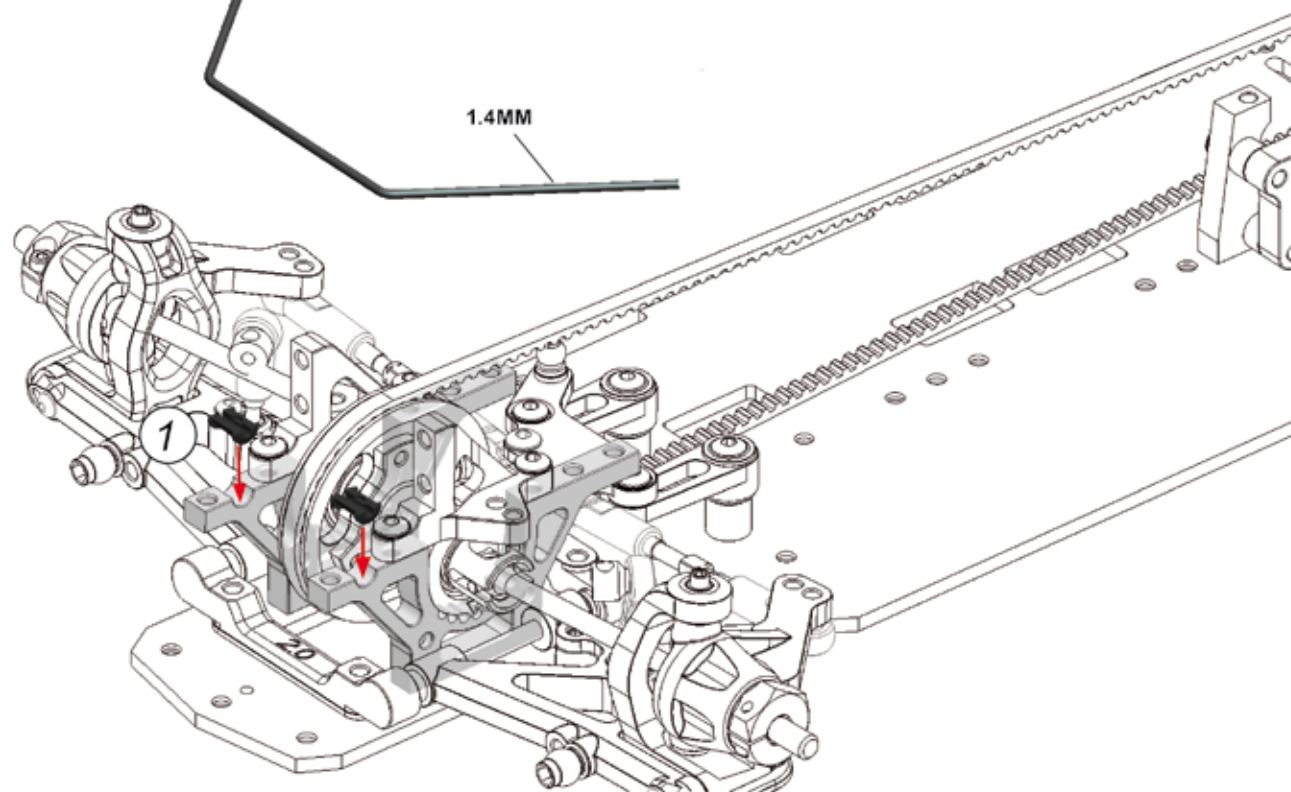

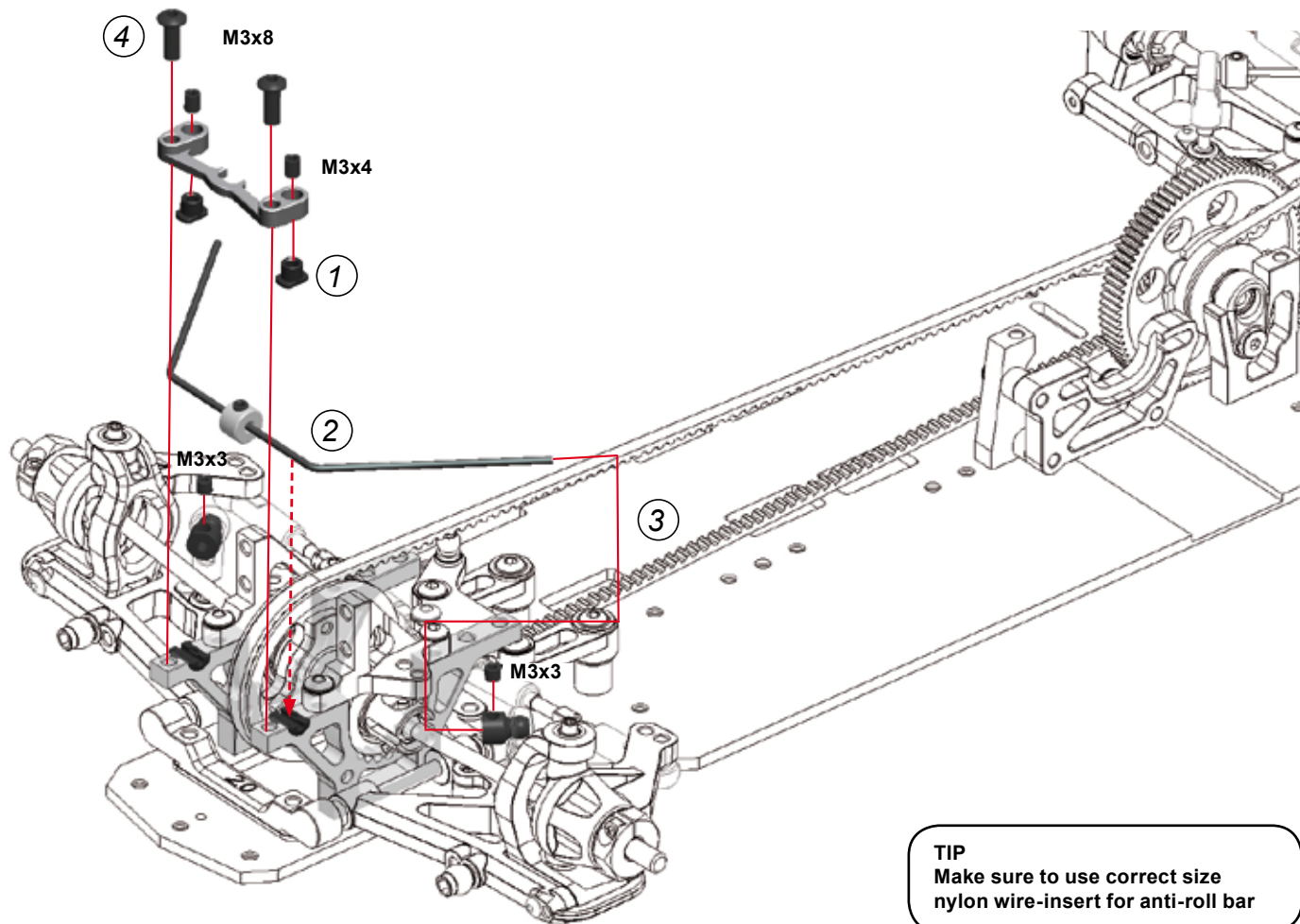

TIP
Make sure to use correct size
nylon wire-insert for anti-roll bar

A

43

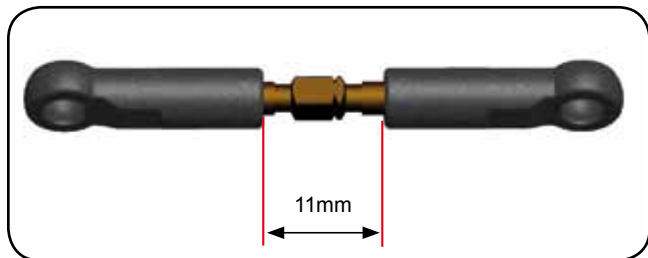

A

44

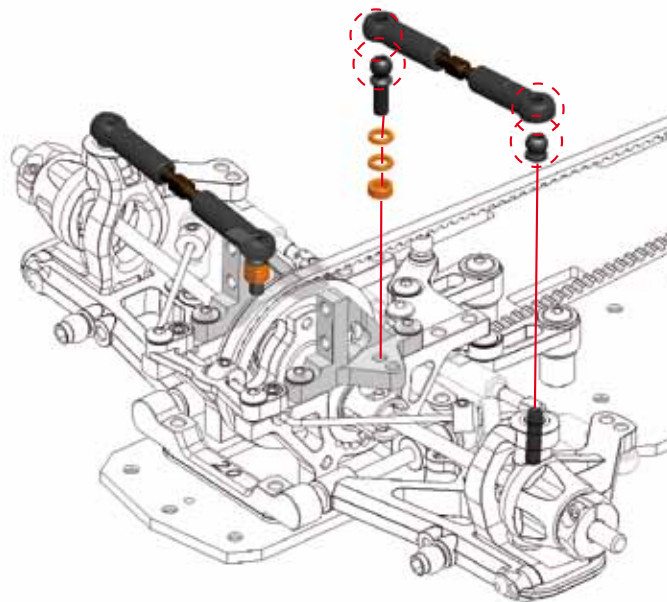

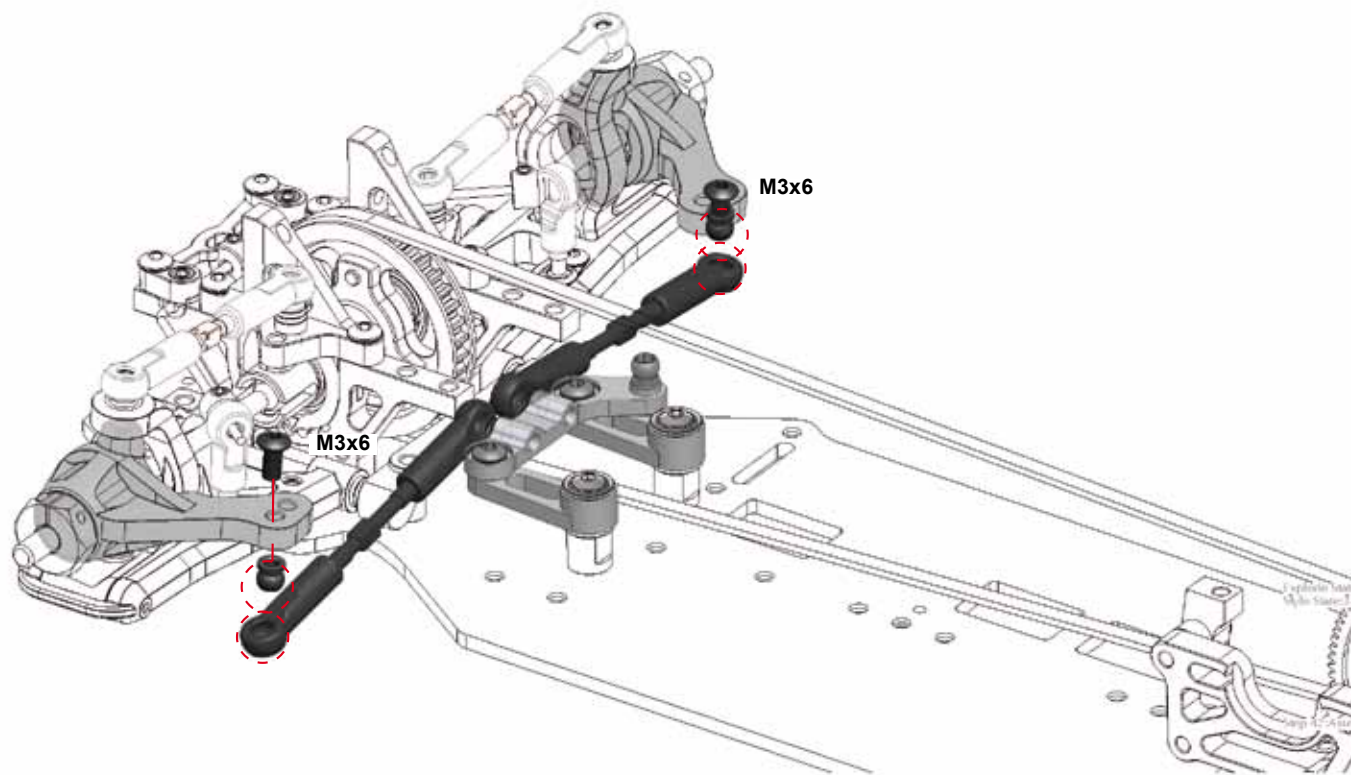

46A

use some
oil during
assembly

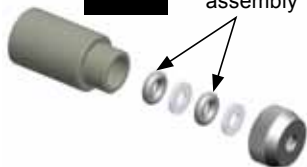

46B

use some
Locktite
to fix
the nut



46C

use some
oil during
assembly

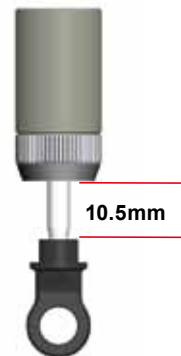
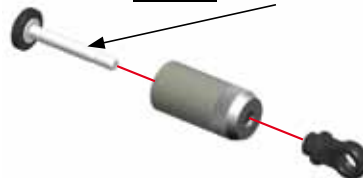

46D

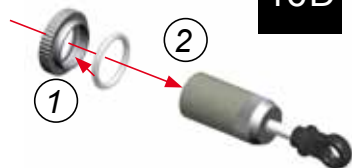

46E

assemble the top of the shock
this will press the membrane
into the shocktop



46F

remove the top
of the shock



46G



Fill the shock body
with the supplied
shock absorber oil.
Slowly move the
shockrod up and down
to let all airbubbles
escape



46H

close the top
of the shock



46 I

assemble the spring and springcup
to complete the shock
front: orange
rear: yellow



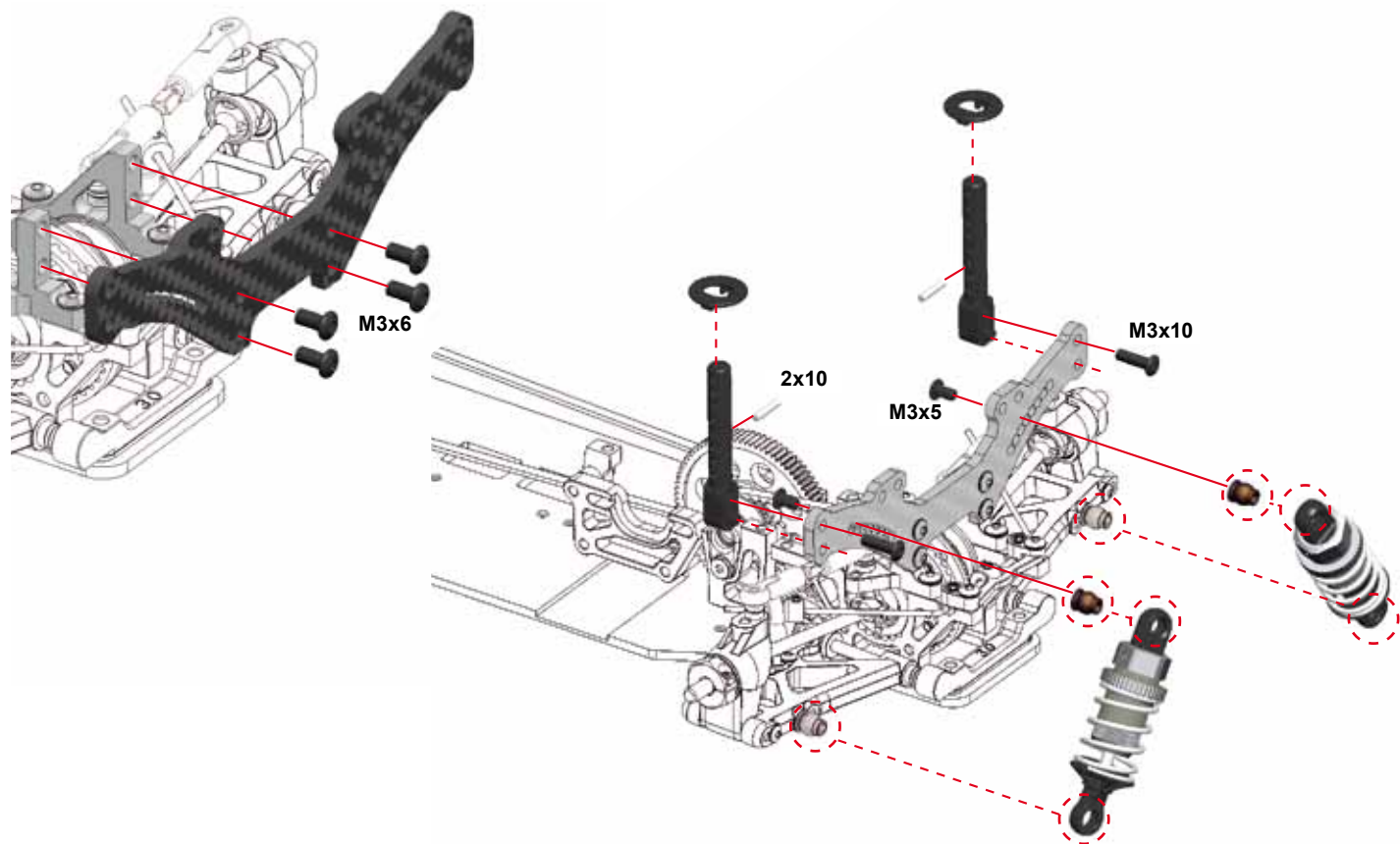

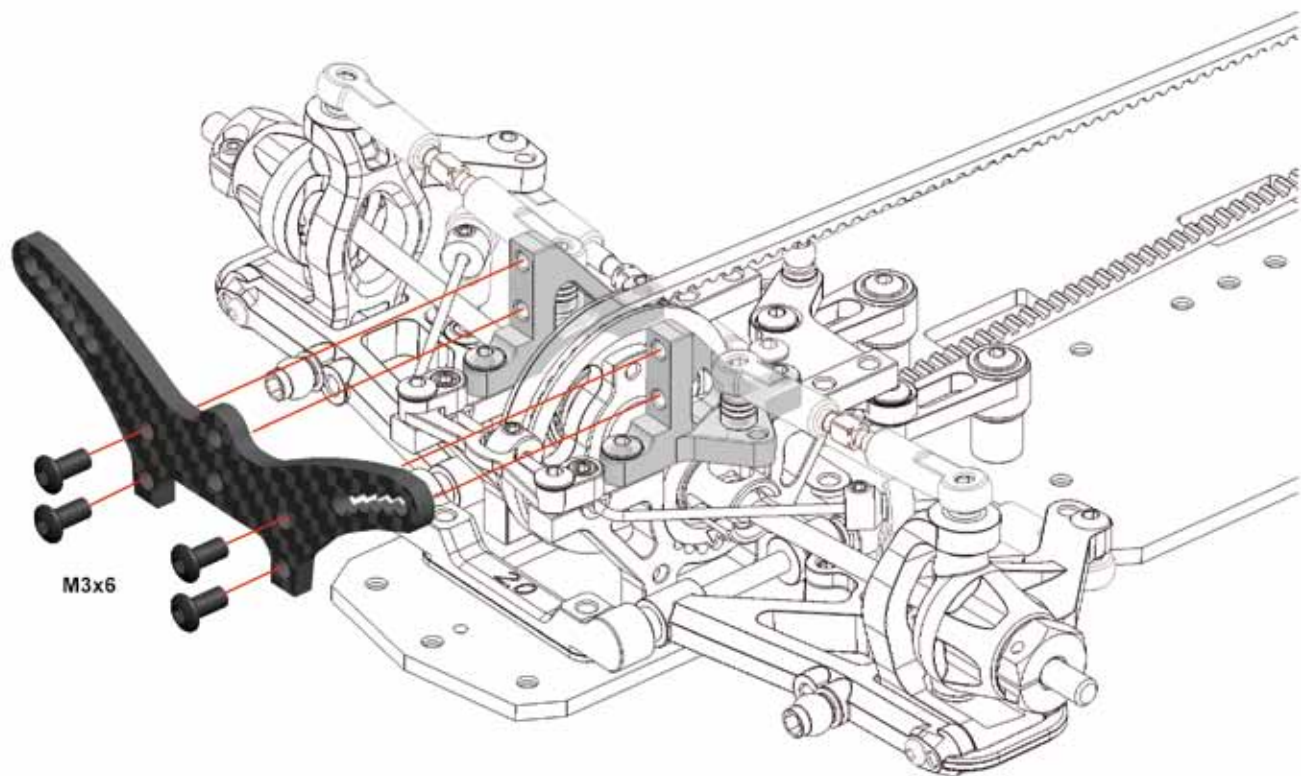

M3x6

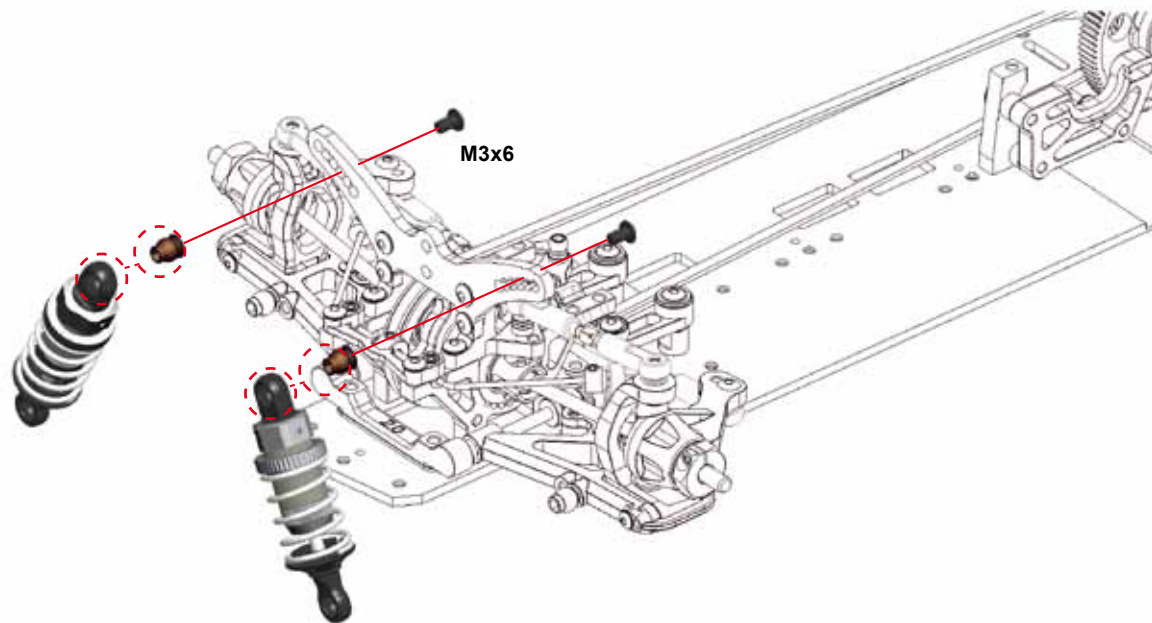

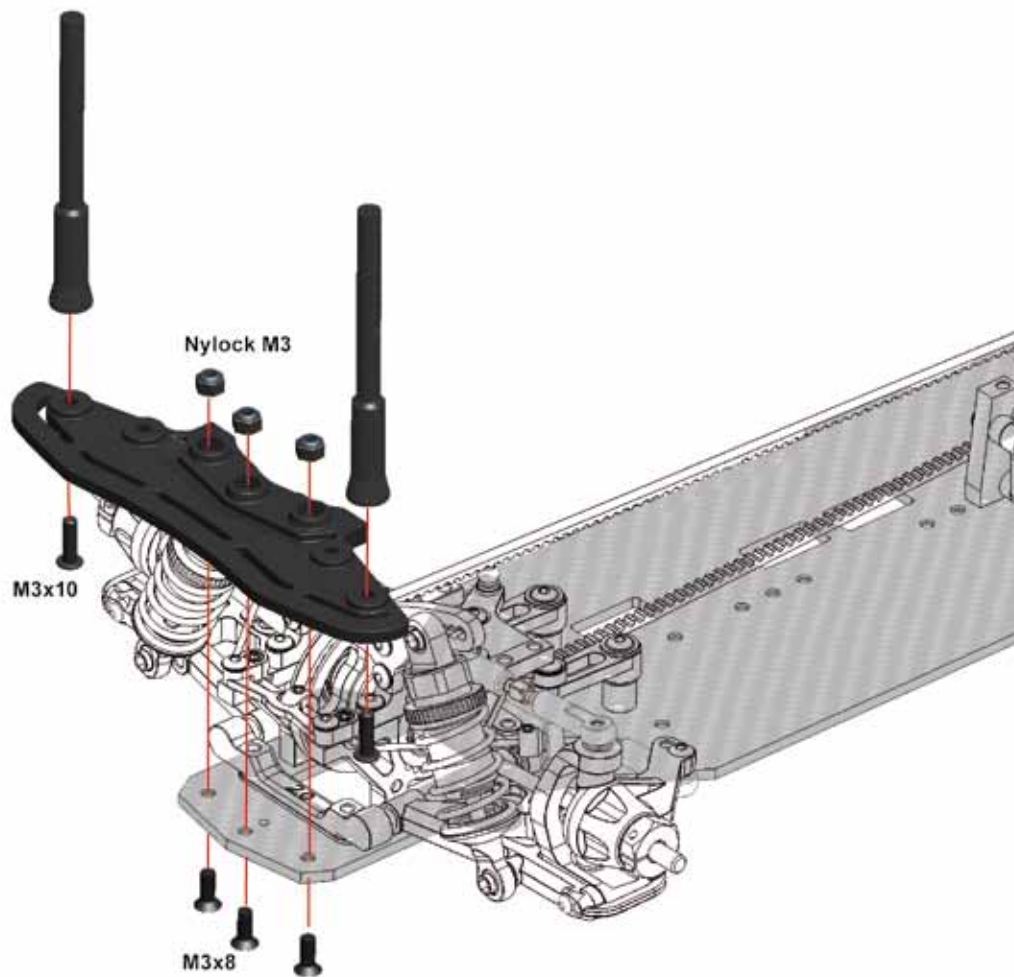

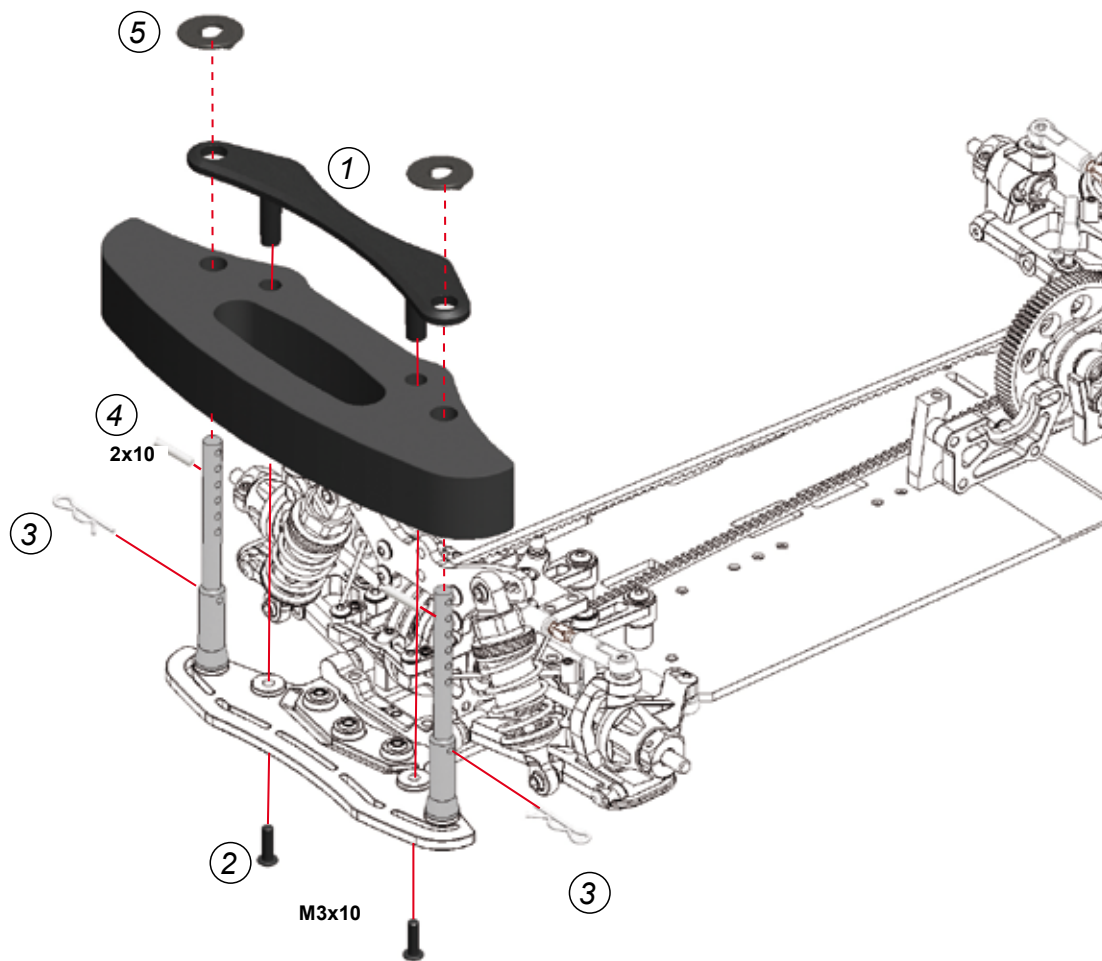



select correct servo-horn
for your brand radio,
23T, 24T or 25T

Number of shims needed depends on the
brand of servo

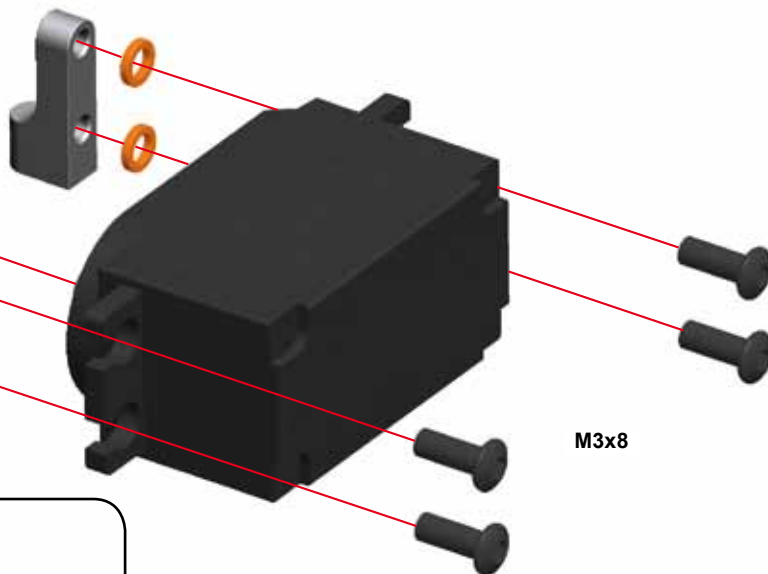

Angle of lever should be 10° left,
when in neutral position

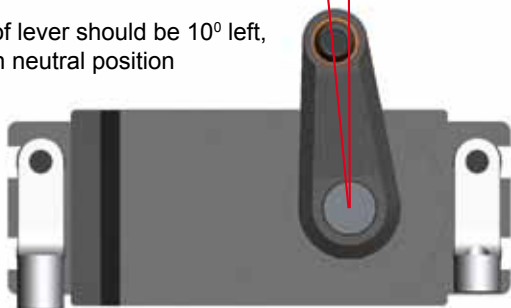

TIP: In case you prefer to use a servo-saver,
then mount it directly to the servo, instead of
the servo-horn (servo-saver is not included)

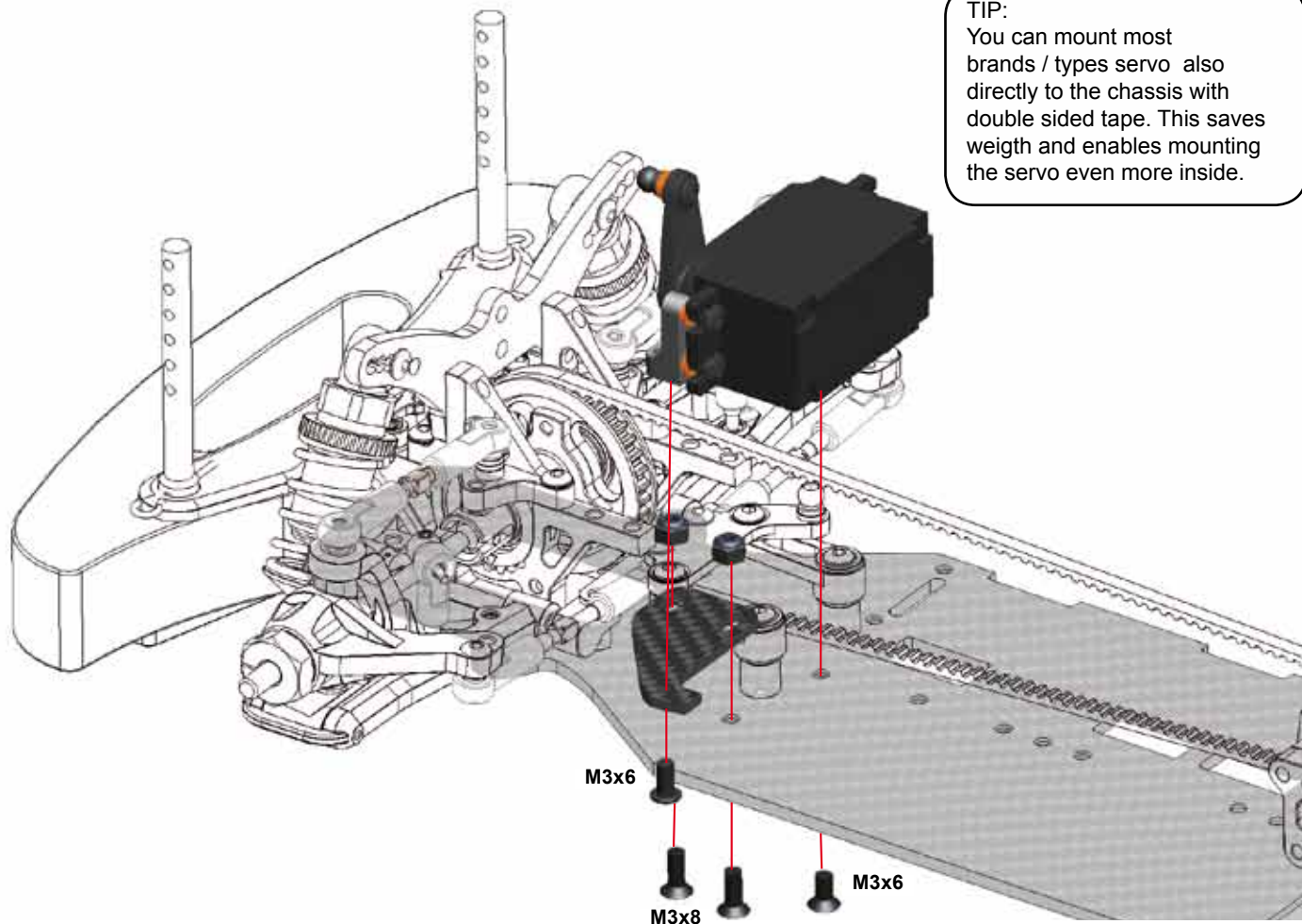

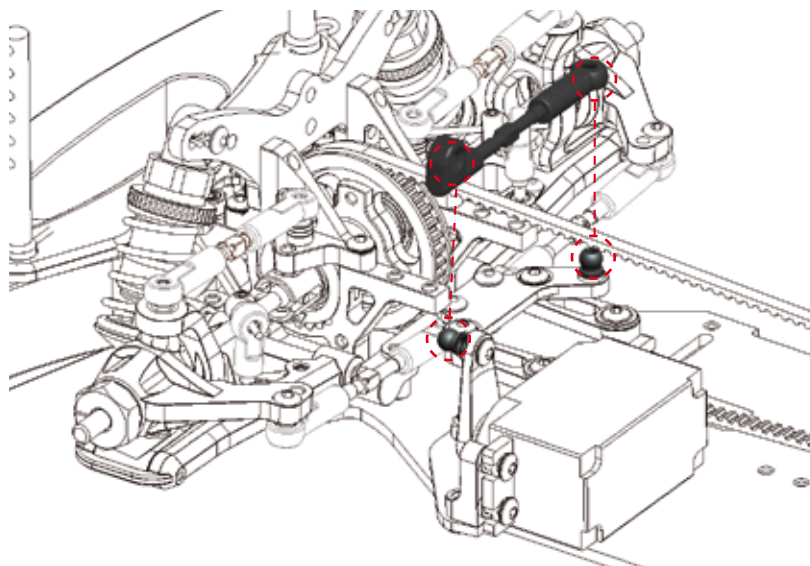
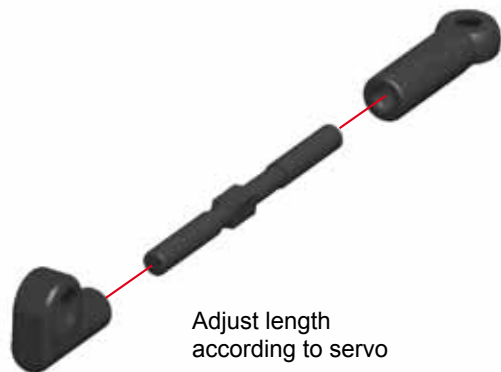

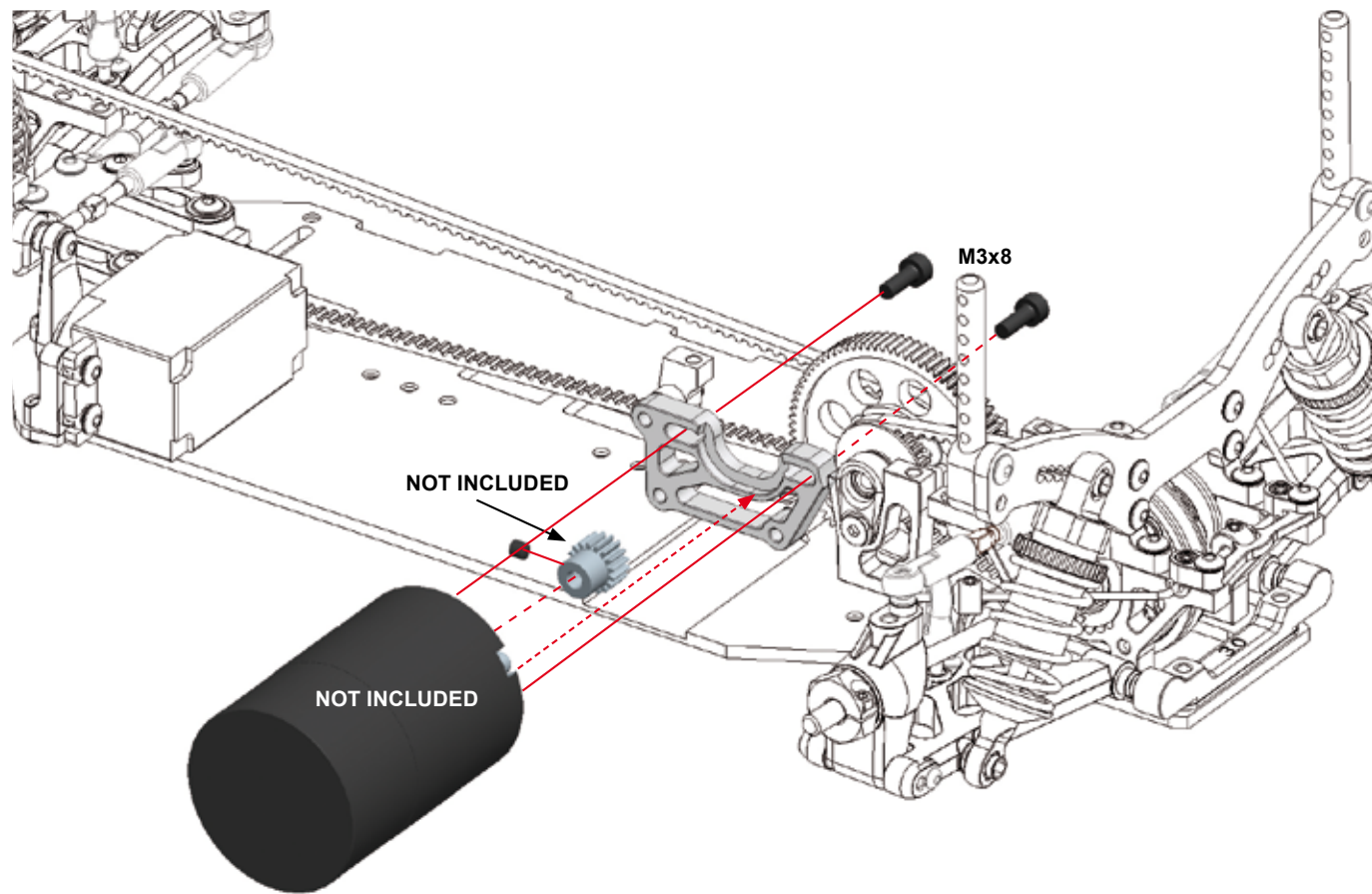

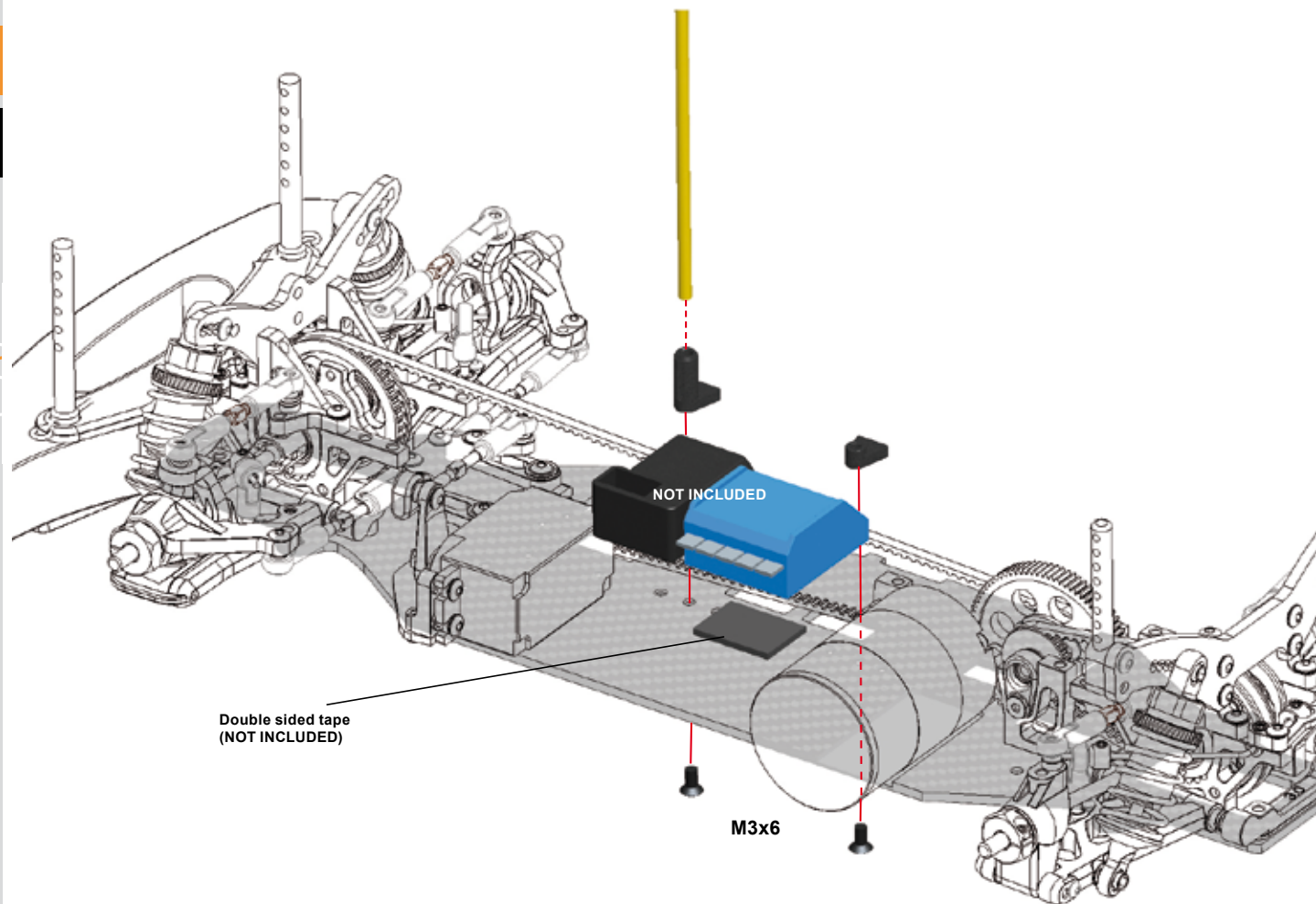

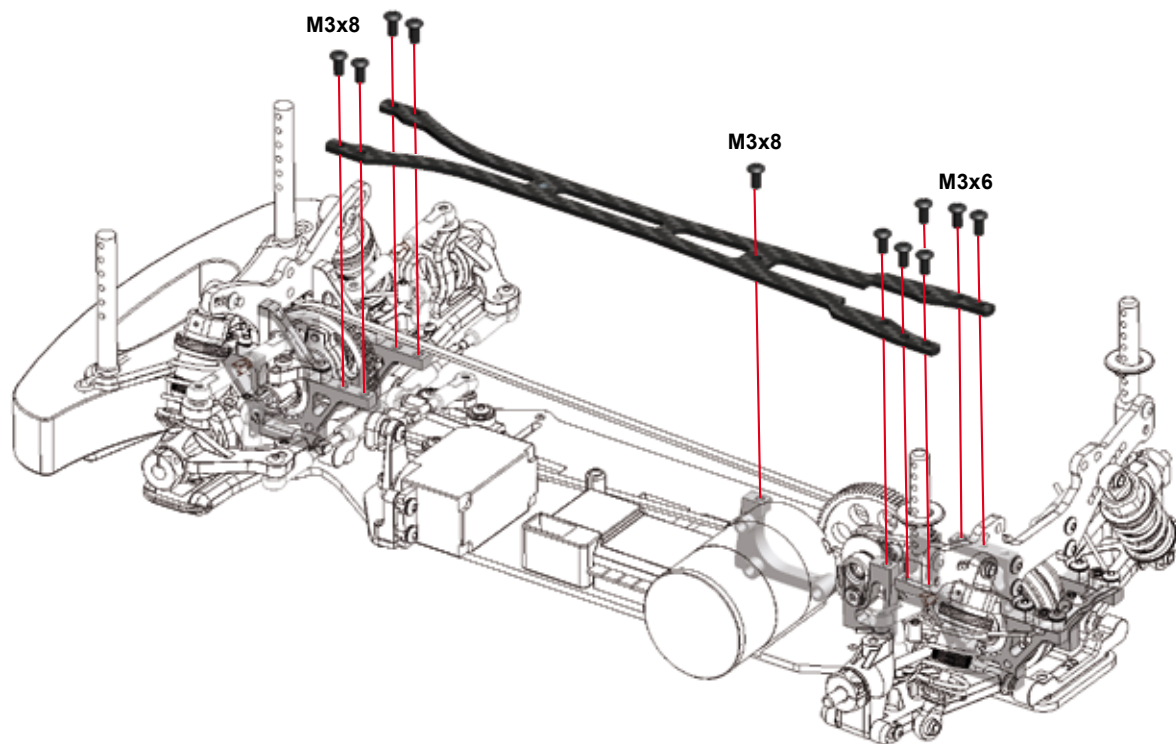

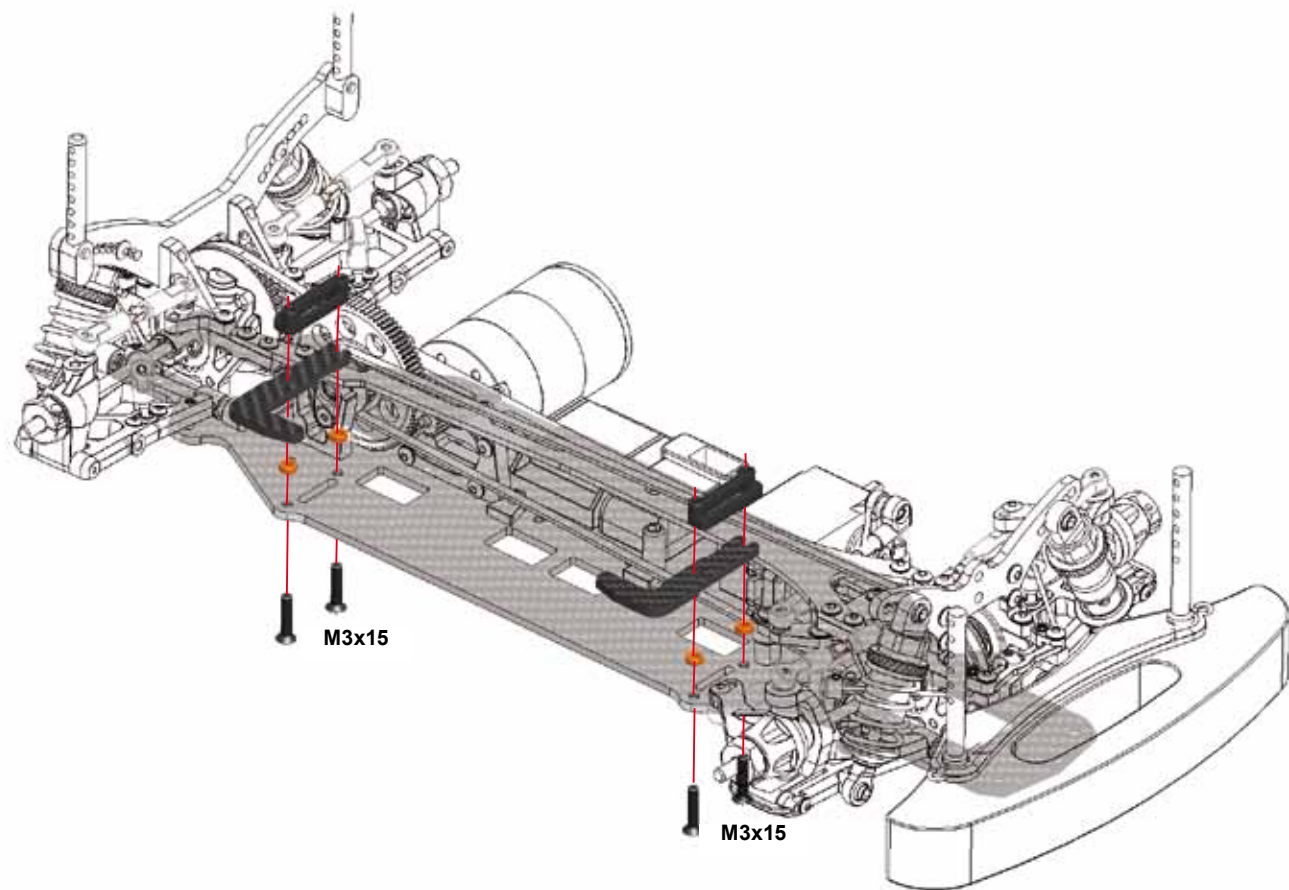

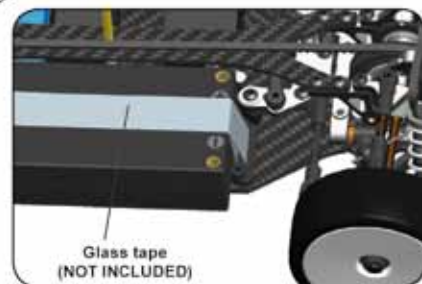
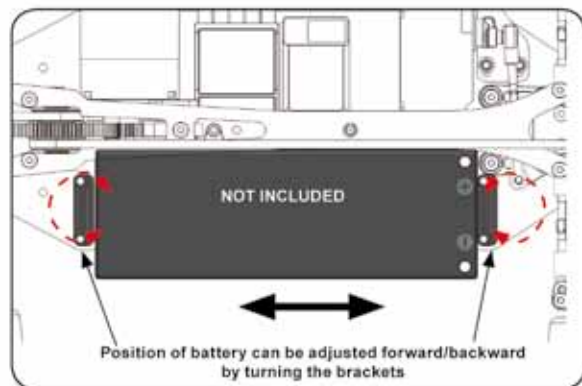
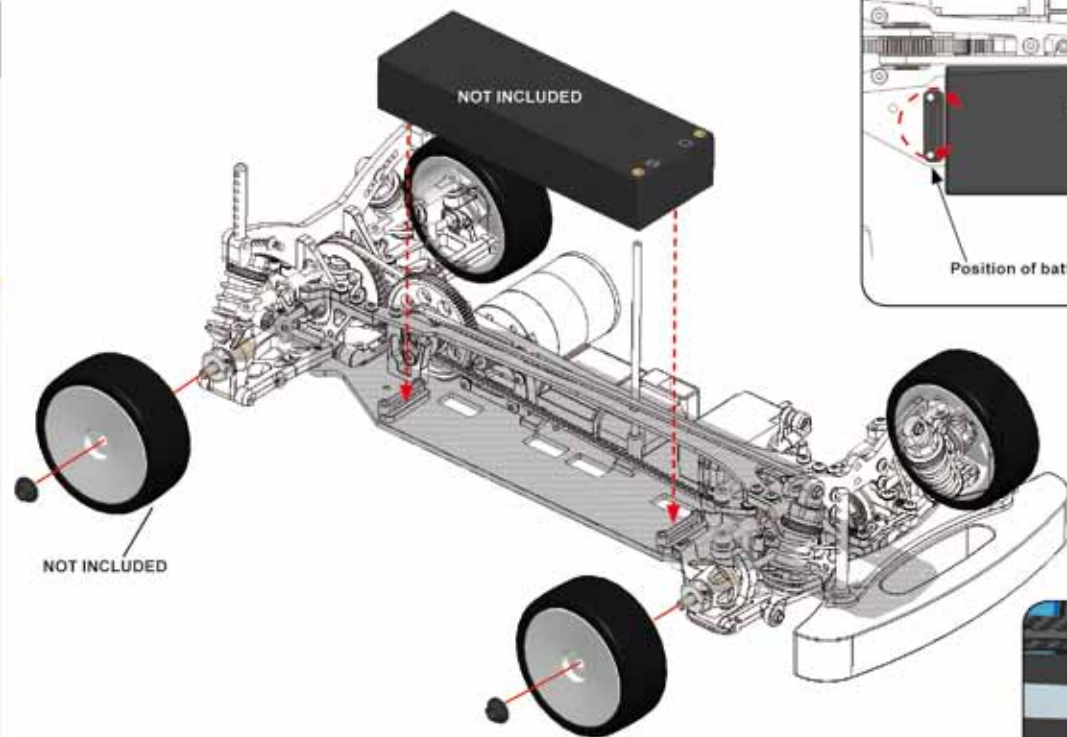

REFERENCE GUIDE

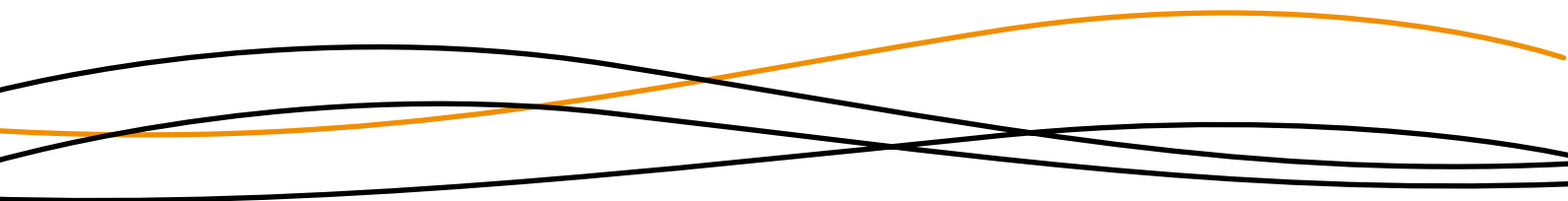

DIFFERENTIAL ASSEMBLY

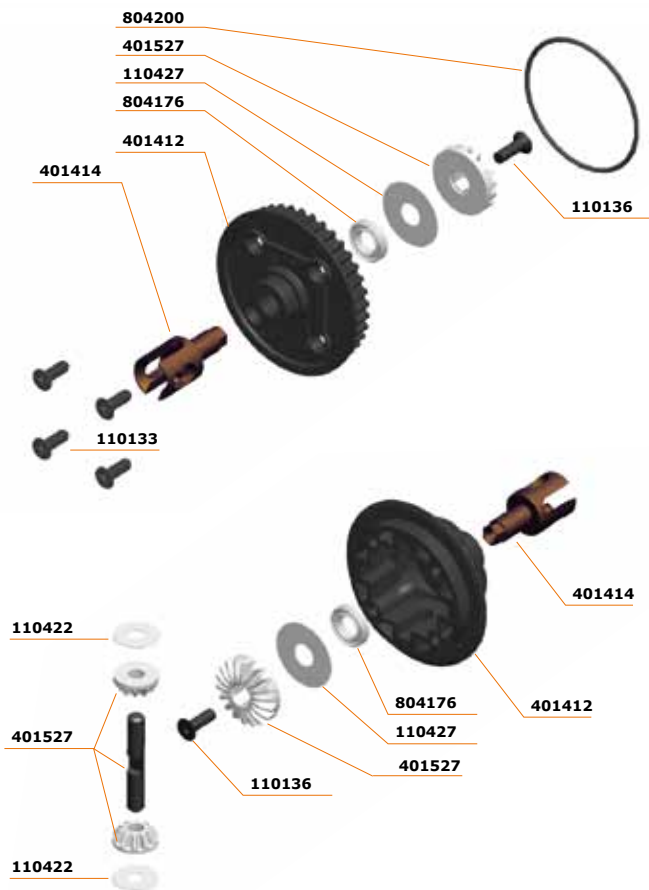

SOLID FRONT AXLE ASSEMBLY

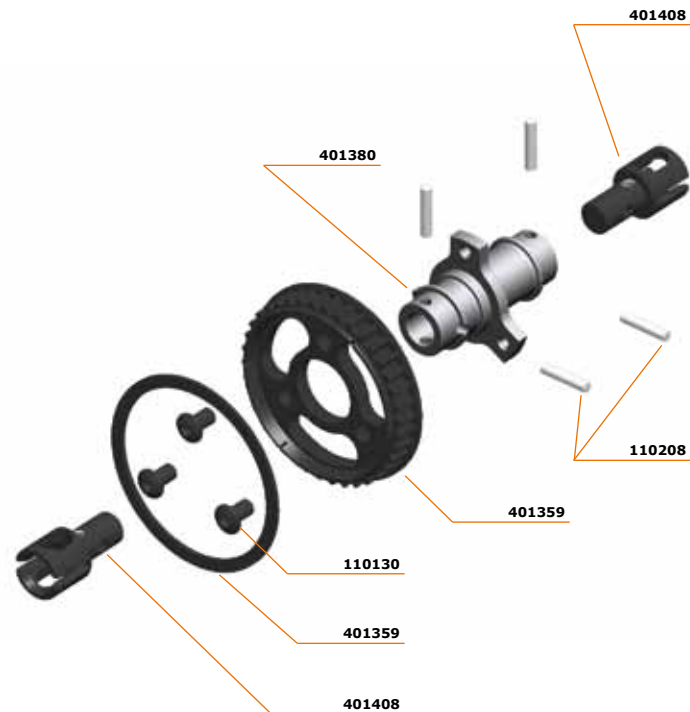

BALL DIFFERENTIAL ASSEMBLY

Optional (not included in the kit)
Ball-differential set #401436

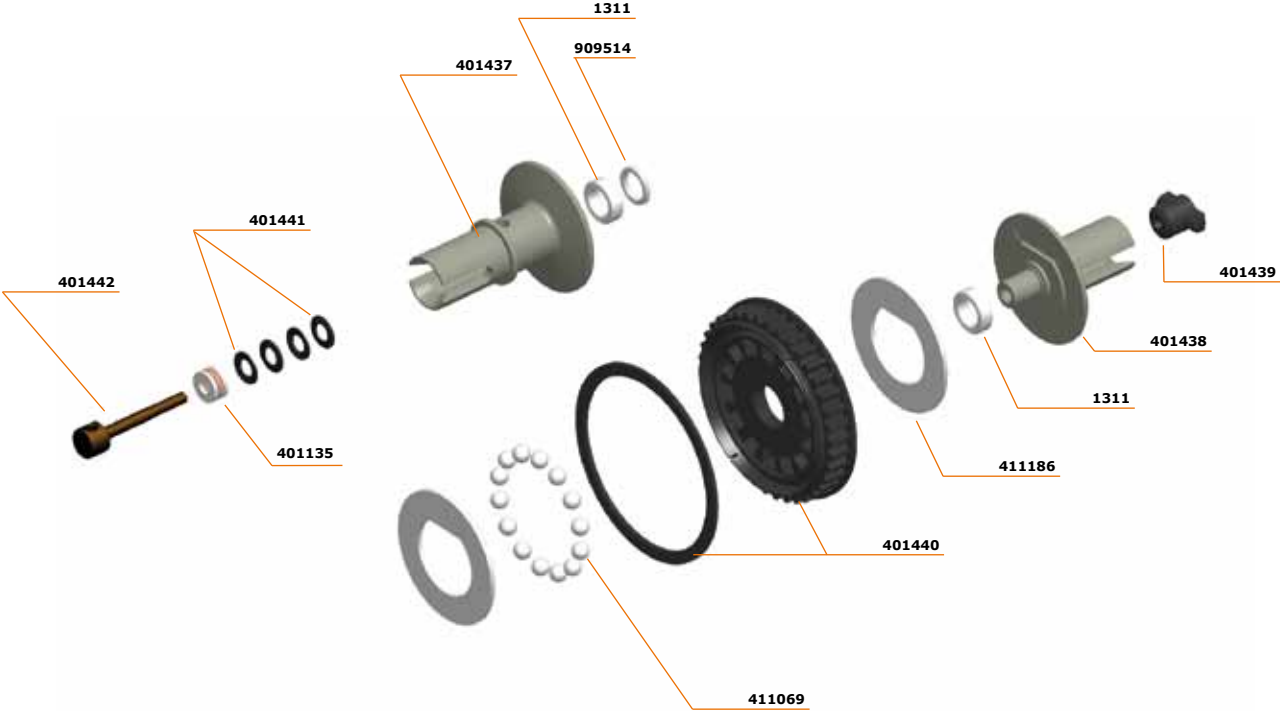

FRONT ASSEMBLY

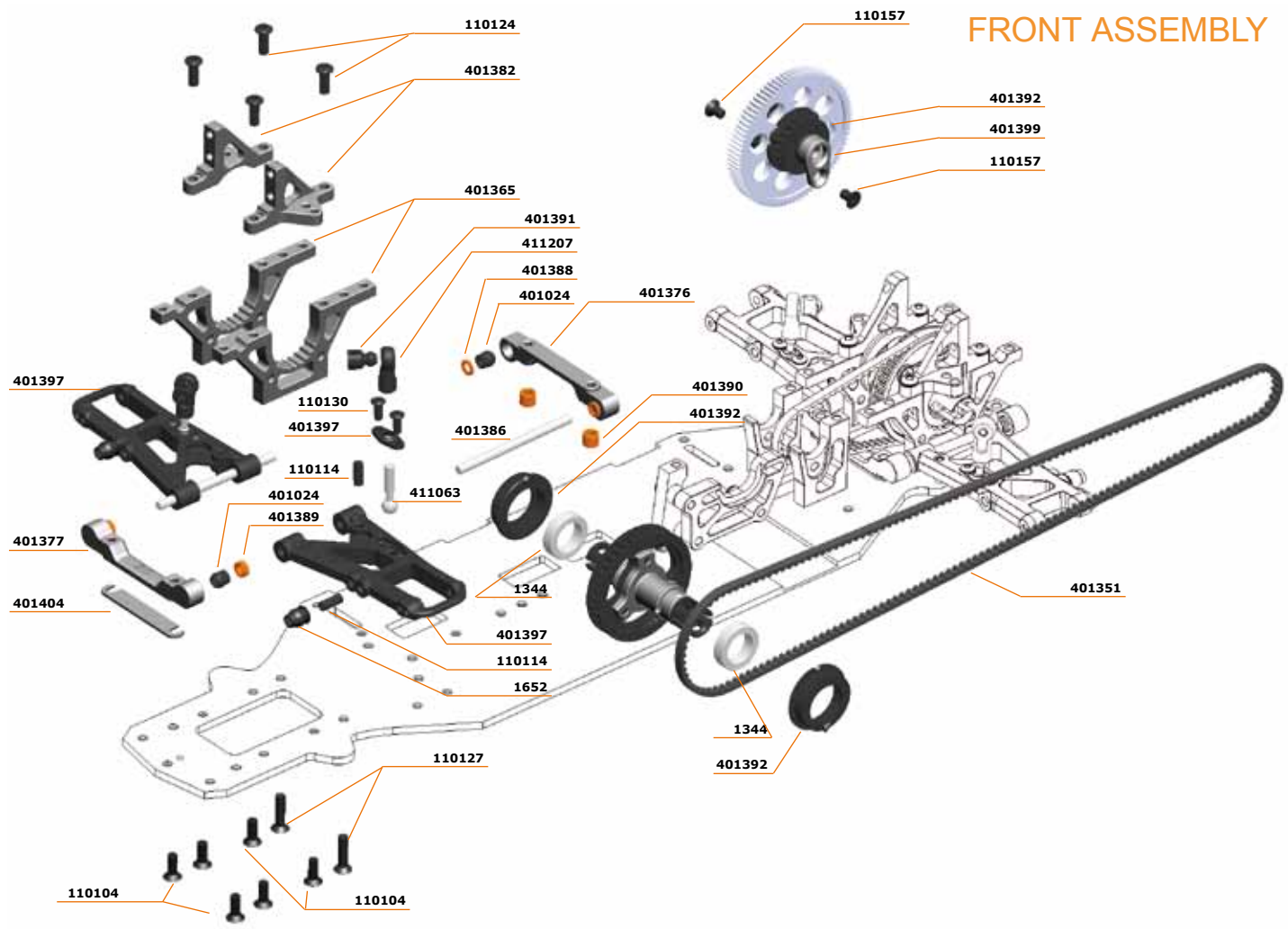

REAR ASSEMBLY

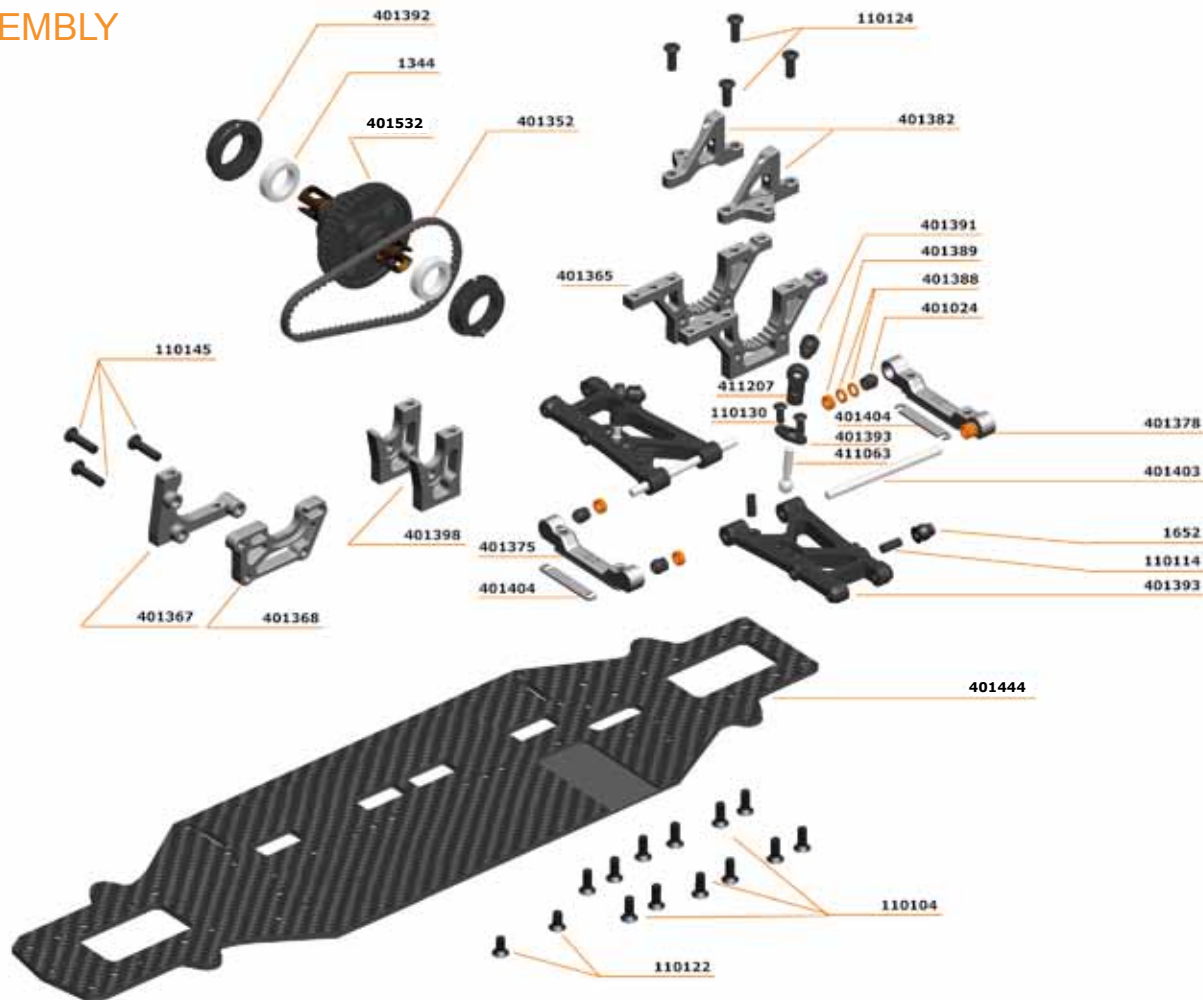

FRONT SUSPENSION ASSEMBLY

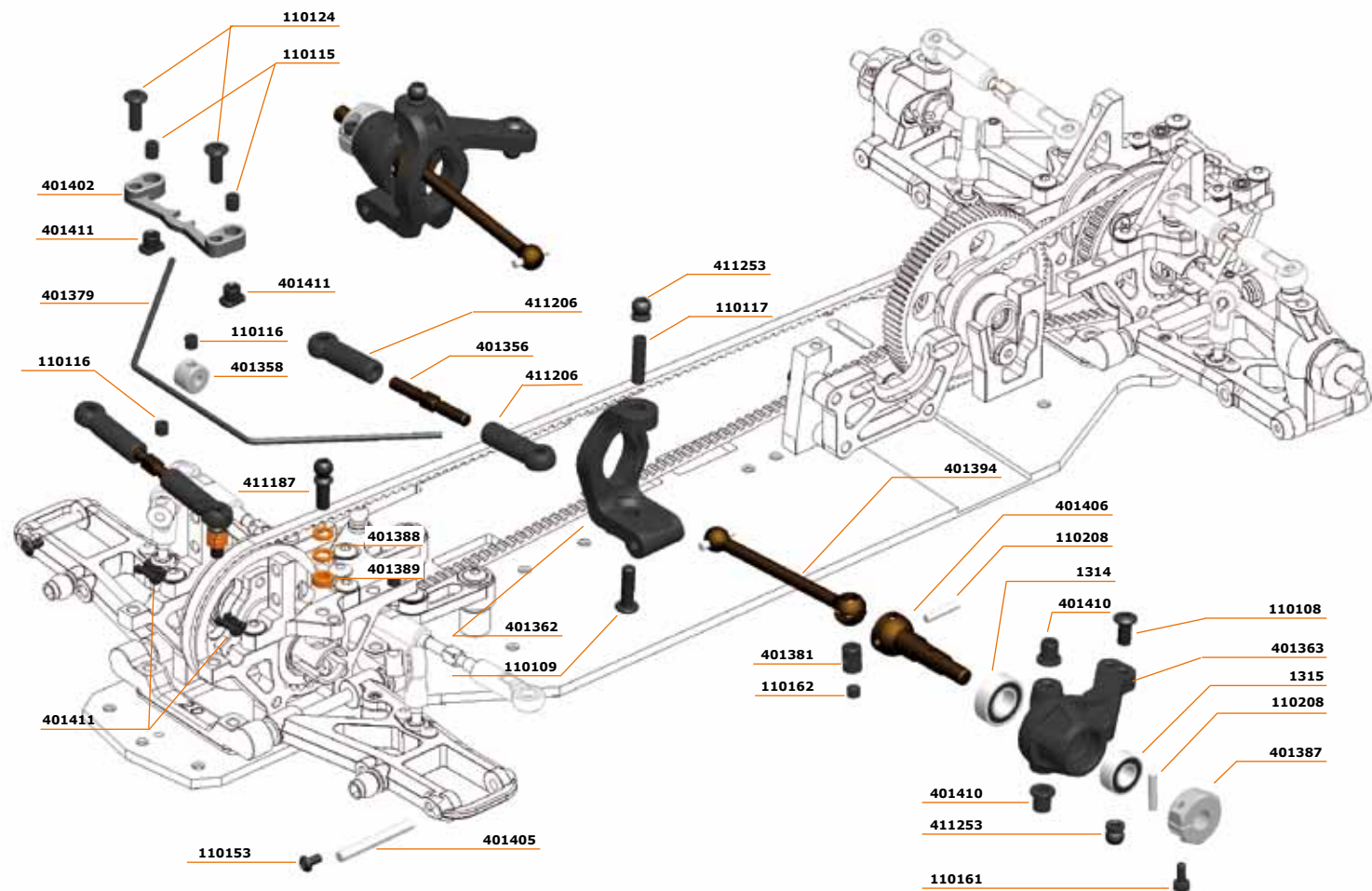

STEERING ASSEMBLY

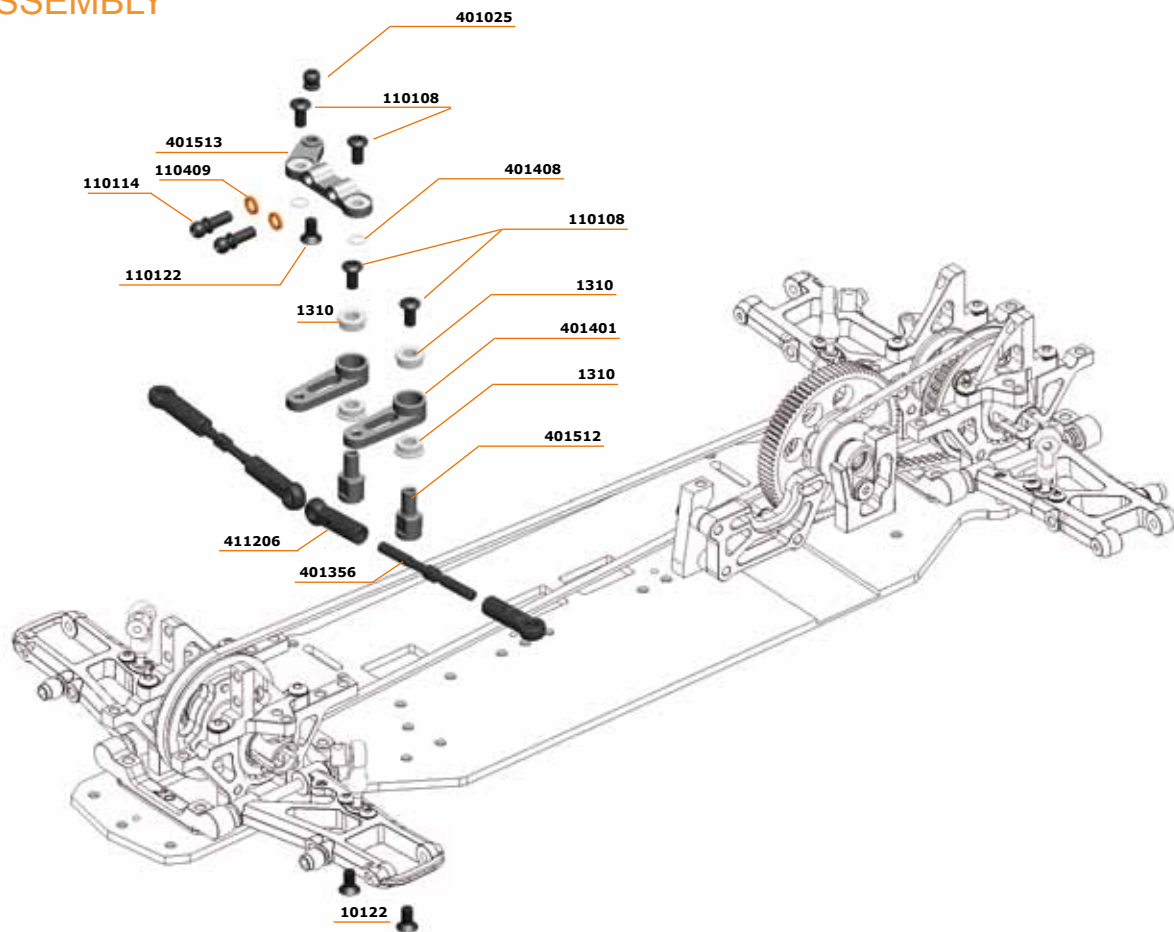

REAR SUSPENSION ASSEMBLY

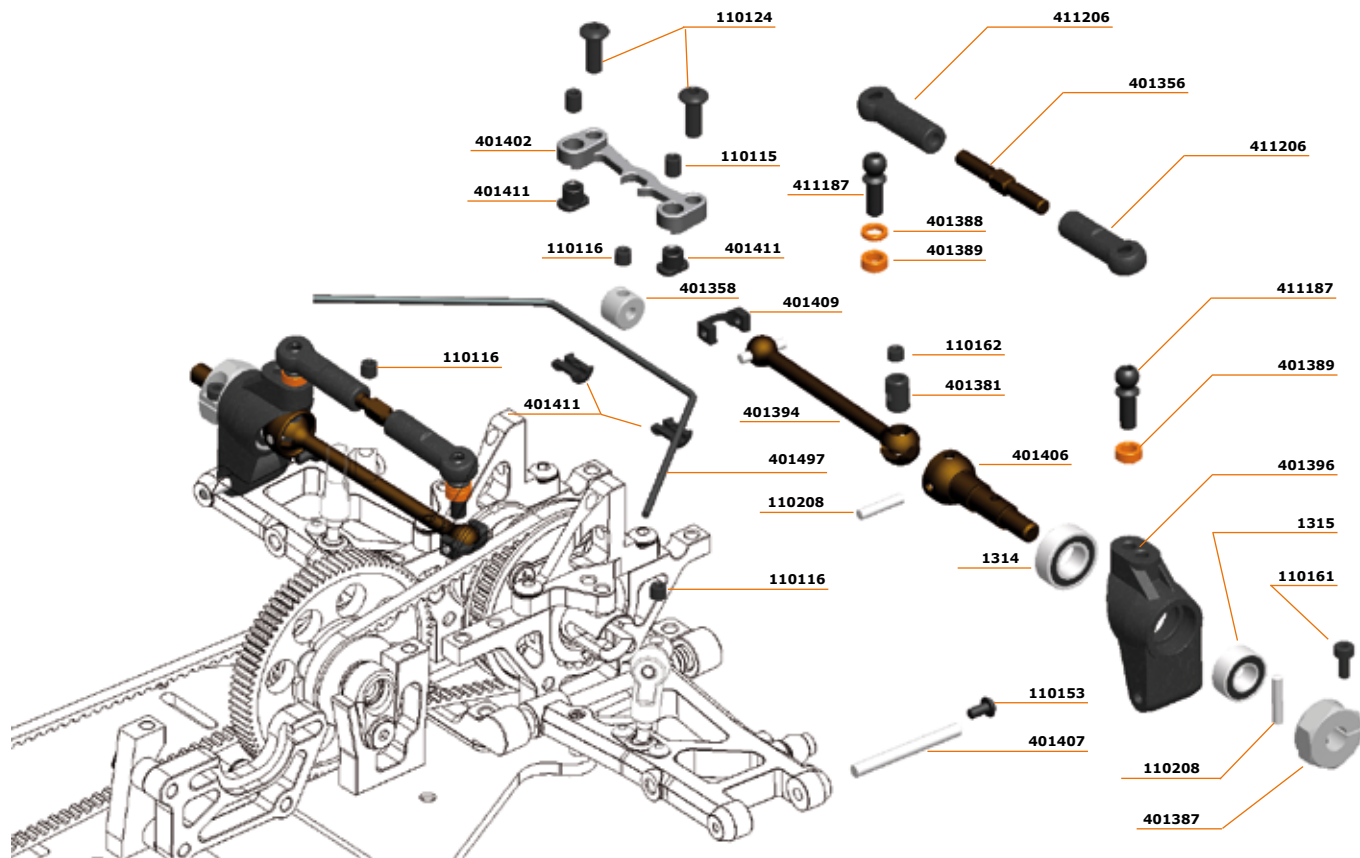

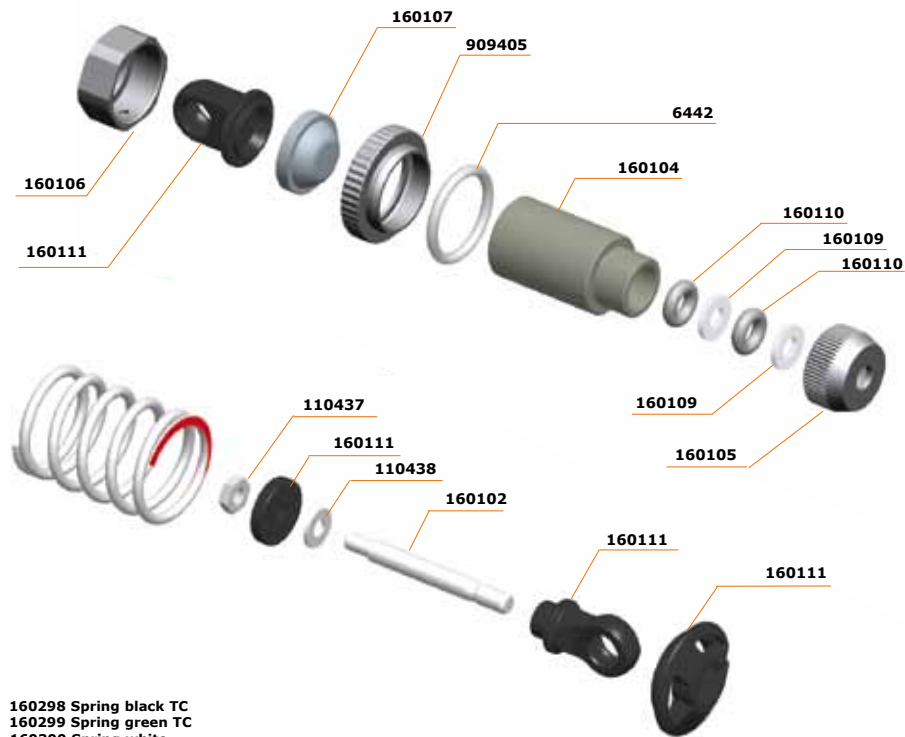

160298 Spring black TC
 160299 Spring green TC
 160300 Spring white
 160297 Spring grey TC
 160301 Spring yellow (std)
 160302 Spring orange (std)
 160303 Spring red
 160304 Spring pink
 160305 Spring blue
 160306 Spring purple
 160310 Spring-set L23 (5x2)

160100 Shockset RCM on-road (2)

TOWER/BUMPER ASSEMBLY

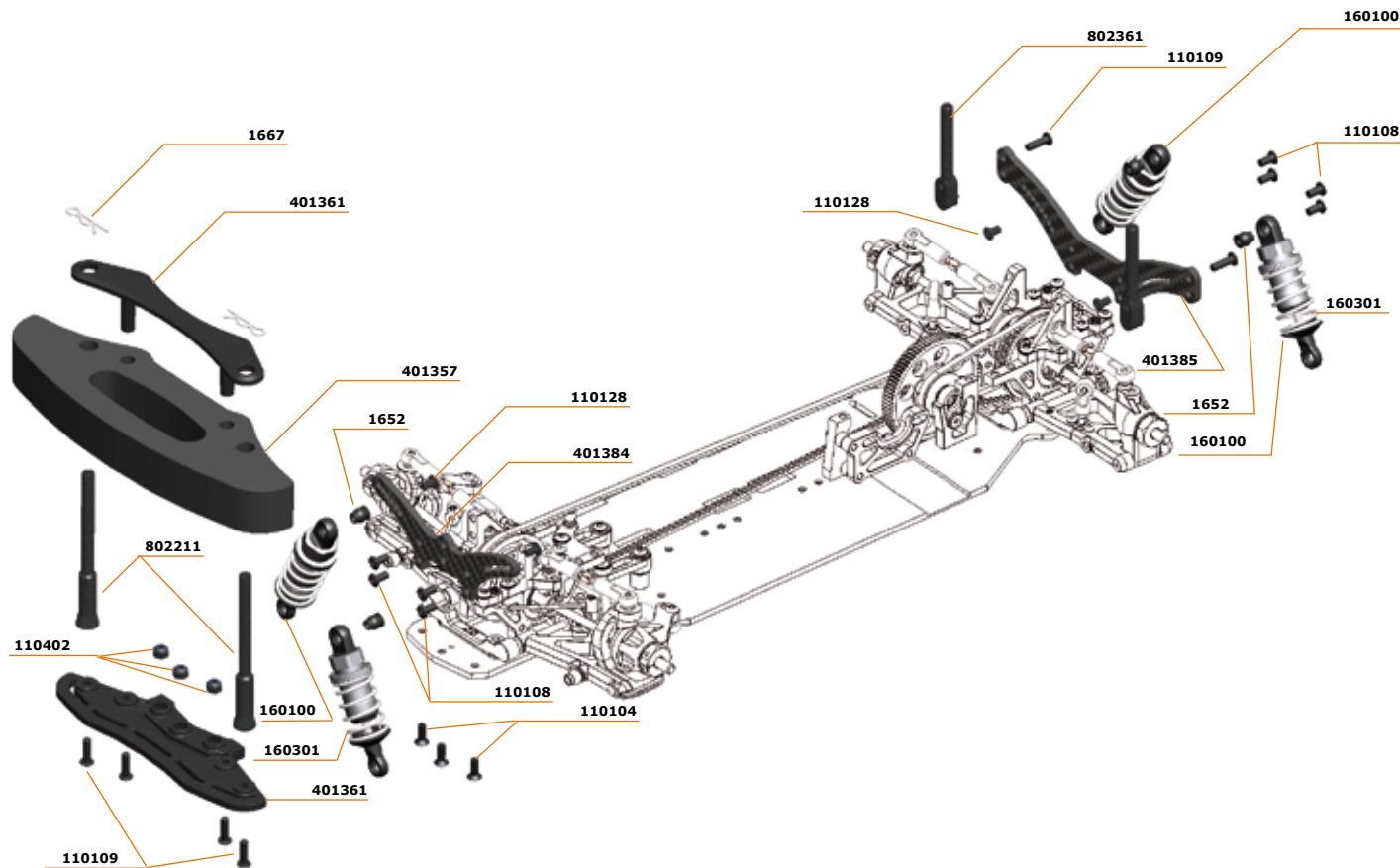

FINAL ASSEMBLY

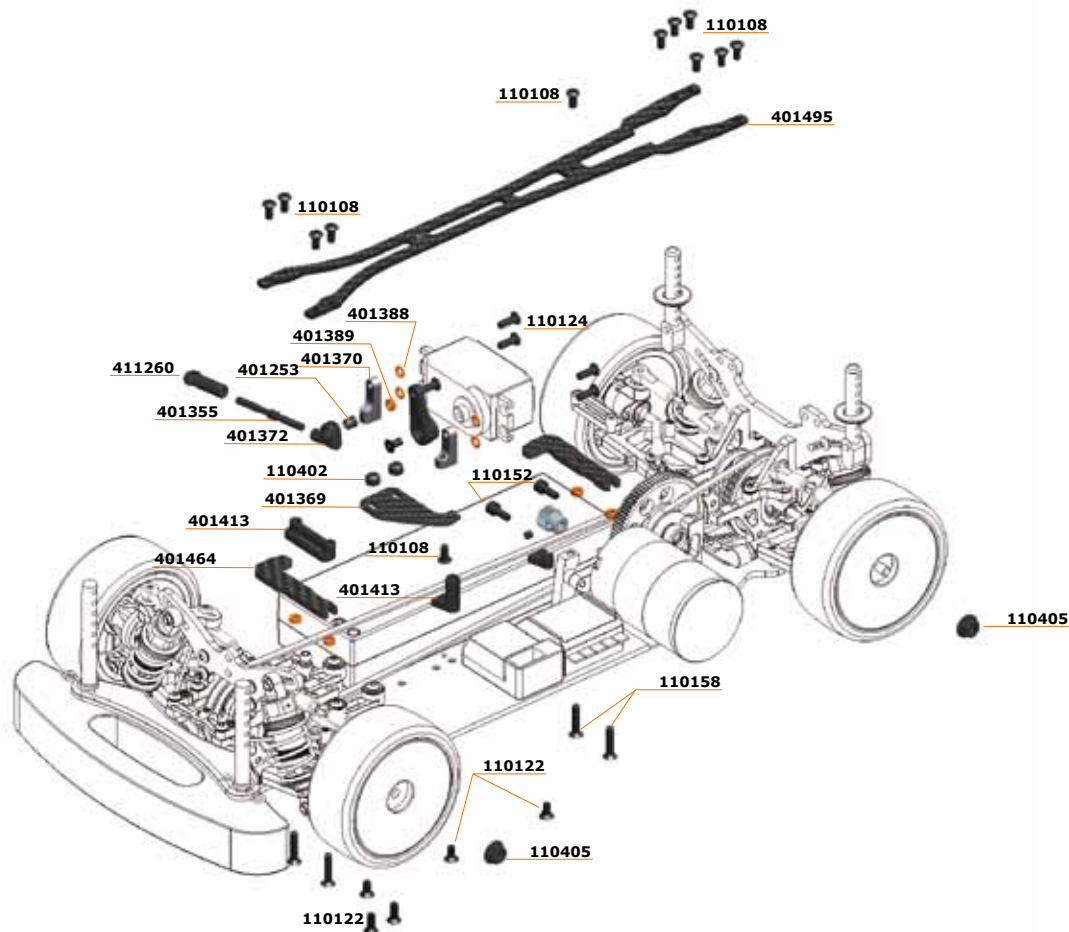

Part no Description

MANUAL, DECALS

- 401443 Manual S411 full color
401435 Decalsheet S411 black-white (2)
401456 Decalsheet S411 chrome (2)

RADIO INSTALLATION

- 401369 Servomount plate
401370 Servomount L+R
401372 Servo-lever (4)
401388 Bushing alu 3x5x1 (10)
411253 Pivotball uni 4.5mm (4)

SERVO SAVER AND STEERING

- 401355 Trackrod M3x38mm (2)
401400 Steering shaft (2)
401401 Steering lever (2)
411206 Balljoint 4.5 (4)
411253 Pivotball uni 4.5mm (4)
401465 Steeringrack V2

Optionals

- 401429 Trackrod alu (2)
401466 Steering shaft alu (2)
401395 Steeringrack alu 1

SHOCK ABSORBERS

- 6442 O-ring adj.nut (10)
160100 Shockset RCM on-road short (2)
160102 Shock RCM shaft short (2)
160104 Shock RCM body alu (2)
160105 Shock RCM bottom (2)
160106 Shock RCM top nut (2)
160107 Shock RCM membrane (4)
160109 Shock RCM bushing machined (8)
160110 Shock RCM bottom O-ring (8)
160111 Shock RCM parts frame nylon short (14)
909405 Shock adj nut alu +o-ring (4)

Optionals

- 160108 Shock RCM bushings (8)
160115 Shock RCM shaft short TiN coated (2)

- 903232 Springwasher alu light (4)
903333 X-ring RCCX shock (10)
903334 RCCX shock-set short (2)

SHOCK SPRINGS

- 160297 Spring grey short (2.6/14.8) TC (2)
160298 Spring black short (2.9/16.5) TC (2)
160299 Spring green short (3.5/19.9) TC (2)
160300 Spring white L23 (2.3/13) (2)
160301 Spring yellow L23 (2.8/16) (2)
160302 Spring oranje L23 (3.4/19.5) (2)
160303 Spring red L23 (4.1/23.5) (2)
160304 Spring pink L23 (4.0/28) (2)
160305 Spring blue L23 (5.8/33) (2)
160306 Spring purple L23 (6.8/39) (2)
160307 Spring green L23 (8/45.5) (2)
160308 Spring gray L23 (9/51.5) (2)
160309 Spring black L23 (10/57) (2)
160310 Spring-set L23 (5x2)

CHASSIS

- 401444 Chassis carbon 2.25mm
401495 Topdeck carbon 411 2mm flex
401464 Battery mount carbon F/R

Optionals

- 401354 Chassis carbon 2.5mm
401374 Topdeck carbon 2mm
401431 Topdeck carbon 2.5mm
401563 Topdeck carbon 1.75mm
401432 Chassis carbon 2mm

BODYMOUNTS FR and RR

- 802211 Bodymount adjustable front (3)
802361 Bodymount adjustable rear (2)
1667 Body-clip medium (10)

Optionals

- 804293 Body support washers
med + high (5+5)

- 804296 Body support rear (2)

FRONT SECTION

- 1652 Steel balls 5.8mm long (4)
401024 Ball 5mm (10)
401356 Camber link M3x26mm
401357 Foam bumper
401358 Stabi collar (2)
401359 Pully solid axle 38T
401361 Bumper upper/ lower
401362 C-hub 4 L+R
401363 Steeringblock L+R
401365 Bearingblock alu
401373 CVD axle set steel (2)
401376 Suspension bracket alu 1
401377 Suspension bracket alu 2
401379 Antirollbar 1.4mm
401380 Solid axle/spool
401381 CVD insert (2)
401382 Shocktower mount alu L+R
401384 Shocktower carbon front
401386 Pivot pin front inner (2)
401387 Wheelhexagon 1mm offset (2)
401388 Bushing alu 3x5x1 (10)
401389 Bushing alu 3x5x2 (10)
401390 Bushing alu 3x5x4 (2)
401391 Antirollbar ball (2)
401392 Bearing excenter (4)
401394 CVD driveshaft (2)
401459 Wishbone Fr Lw medium (2)
401402 Antirollbar mount alu
401404 Suspension spacer 1mm (2)
401405 Pivot pin front-outer (2)
401406 CVD wheelaxle (2)
401410 Bushing steeringblock (4)
401411 Antirollbar bushing (16)
411063 Pivot ball threaded upper arm (2)
411187 Pivotball with shaft (2)
411206 Balljoint 4.5 (4)

411207 Balljoint 4.5 short (2)
 411253 Pivotball uni 4.5mm (4)
 802211 Bodymount adjustable front (3)

Optionals

401375 Suspension bracket alu 0
 401378 Suspension bracket alu 3
 401397 Wishbone front lower (2)
 401415 Antirollbar 1.2mm
 401416 Antirollbar 1.6mm
 401417 Antirollbar 1.8mm
 401418 Suspension bracket alu 1.5
 401419 Suspension bracket alu 2.5
 401420 Suspension bracket alu 3.5
 401422 Steeringblock alu L+R
 401423 C-hub 2 alu L+R
 401424 C-hub 4 alu L+R
 401425 C-hub 6 alu L+R
 401426 Spacer suspension 0.5mm (2)
 401430 Camberlink alu (2)
 401428 Driveshaft adaptor delrin (2)
 401433 Weight set brass 5gr - 12gr - 20gr (2+1+1)
 401434 Bushing smaller bearing (4)
 401445 Driveshaft double cardan joint DJC (2)
 401446 Driveshaft DJC (2)
 401447 Wheelaxle DJC (2)
 401448 Coupler DJC (2)
 401449 Insert DJC (4)
 401450 Pin revision set DJC (4)
 401452 Wishbone Fr Lw hard (2)
 401455 C-hub 4 L+R hard
 401462 C-hub 4 L+R medium
 401467 Pivot pin front inner TiNi (2)
 401469 Driveshaft-set CVD alu / steel (2)
 401470 Driveshaft CVD alu (2)
 401486 Shrink tube for DJC (10)
 401490 Suspension bracket alu 0.5
 401500 Pivotball uni 4.5mm alu (4)

MIDDLE SECTION

1606 Antenna rod black (2)

401360 Pully middle 19T + spacer (3)
 401366 Middle shaft alu
 401367 Motormount bracket alu
 401368 Motormount alu
 401398 Bracket middleshaft alu
 401399 Bearingmount middleshaft alu
 401413 Battery mount (4)
Optionals
 401427 Pully 19T alu
 401433 Weight set brass 5gr - 12gr - 20gr (2+1+1)
 401451 Motormount set V2
 401463 Belt tensioner set
 401464 Battery mount carbon F/R
 401566 Battery strap velcro

REAR SECTION

1652 Steel balls 5.8mm long (4)
 401024 Ball 5mm (10)
 401353 Belt Kevlar 30S3M186 low friction
 401356 Camber link M3x26mm (2)
 401358 Stabi collar (2)
 401365 Bearingblock alu
 401373 CVD axle set steel (2)
 401375 Suspension bracket alu 0
 401378 Suspension bracket alu 3
 401381 CVD insert (2)
 401382 Shocktower mount alu L+R
 401385 Shocktower carbon rear
 401387 Wheelhexagon 1mm offset (2)
 401388 Bushing alu 3x5x1 (10)
 401389 Bushing alu 3x5x2 (10)
 401391 Antirollbar ball (2)
 401392 Bearing excenter (4)
 401393 Wishbone rear lower (2)
 401394 CVD driveshaft (2)
 401396 Upright (2)
 401403 Pivot pin rear-inner (2)
 401406 CVD wheelaxle (2)
 401407 Pivot pin rear-outer (2)

401409 Blade (16)
 401411 Antirollbar bushing (16)
 401497 Antirollbar 1.4mm rear
 401526 Geardiff revision set V2
 401532 Geardiff uni 1/10 EP
 411063 Pivot ball threaded upper arm (2)
 411187 Pivotball with shaft (2)
 411206 Balljoint 4.5 (4)
 411207 Balljoint 4.5 short (2)

Optionals

401352 Belt Kevlar 30S3M186
 401376 Suspension bracket alu 1
 401377 Suspension bracket alu 2
 401415 Antirollbar 1.2mm
 401416 Antirollbar 1.6mm
 401417 Antirollbar 1.8mm
 401421 Upright alu (2)
 401426 Spacer suspension 0.5mm (2)
 401430 Camberlink alu (2)
 401433 Weight set brass 5gr - 12gr - 20gr (2+1+1)
 401434 Bushing smaller bearing (4)
 401436 Balldiff set
 401445 Driveshaft double cardan joint DJC (2)
 401446 Driveshaft DJC (2)
 401447 Wheelaxle DJC (2)
 401448 Coupler DJC (2)
 401449 Insert DJC (4)
 401450 Pin revision set DJC (4)
 401453 Wishbone Rr Lw hard (2)
 401454 Upright hard (2)
 401460 Wishbone Rr Lw medium (2)
 401461 Upright medium (2)
 401468 Pivot pin rear inner TiNi (2)
 401469 Driveshaft-set CVD alu / steel (2)
 401470 Driveshaft CVD alu (2)
 401496 Antirollbar 1.2mm rear
 401497 Antirollbar 1.4mm rear
 401498 Antirollbar 1.6mm rear
 401499 Antirollbar 1.8mm rear

401500 Pivotball uni 4.5mm alu (4)

TRANSMISSION

401351 Belt Kevlar 30S3M510 low friction
 401353 Belt Kevlar 30S3M186 low friction
 401359 Pully solid axle 38T
 401360 Pully middle 19T + spacer (3)
 401408 Driveshaft solid axle (2)
 401414 Geardiff outdrive (2)
 401412 Geardiff housing
 401532 Geardiff uni 1/10 EP
 401526 Geardiff revision set V2
 401527 Diff gear 10T + diff axle for geardiff (2+1) V2

804176 Geardiff x-ring (4)
 804200 Diffcase O-ring 22.5x1 (10)

Optionals

401350 Belt Kevlar 30S3M510
 401352 Belt Kevlar 30S3M186
 401427 Pully 19T alu
 401428 Driveshaft adaptor delrin (2)
 401436 Balldiff set
 401437 Balldiff shaft female
 401438 Balldiff shaft male
 401439 Balldiff nut (2)
 401440 Balldiff pully 38T
 401441 Balldiff spring (4)
 401442 Balldiff screw (2)
 401457 Slipper Spool pad S411 (2)
 401533 Spool nylon 1/10 411
 401570 Geardiff 1/10 V2 shaft alu (2)

Spur Gears

120005 Spur gear 64P / 92T
 120006 Spur gear 64P / 96T
 120007 Spur gear 64P / 100T
 120008 Spur gear 64P / 104T
 120009 Spur gear 64P / 108T
 120010 Spur gear 64P / 112T
 120011 Spur gear 64P / 116T

120012 Spur gear 64P / 114T
 120013 Spur gear 64P / 106T
 120015 Spur gear 48P / 69T
 120016 Spur gear 48P / 72T
 120017 Spur gear 48P / 75T
 120018 Spur gear 48P / 78T
 120019 Spur gear 48P / 81T
 120020 Spur gear 48P / 84T
 120021 Spur gear 48P / 87T
 120022 Spur gear 48P / 86T
 120023 Spur gear 48P / 85T

Pinions

120105 Motor-pinion alu hard 64P / 18T
 120106 Motor-pinion alu hard 64P / 19T
 120107 Motor-pinion alu hard 64P / 20T
 120108 Motor-pinion alu hard 64P / 21T
 120109 Motor-pinion alu hard 64P / 22T
 120110 Motor-pinion alu hard 64P / 23T
 120111 Motor-pinion alu hard 64P / 24T
 120112 Motor-pinion alu hard 64P / 25T
 120113 Motor-pinion alu hard 64P / 26T
 120114 Motor-pinion alu hard 64P / 27T
 120115 Motor-pinion alu hard 64P / 28T
 120116 Motor-pinion alu hard 64P / 29T
 120117 Motor-pinion alu hard 64P / 30T
 120118 Motor-pinion alu hard 64P / 31T
 120119 Motor-pinion alu hard 64P / 32T
 120120 Motor-pinion alu hard 64P / 33T
 120121 Motor-pinion alu hard 64P / 34T
 120122 Motor-pinion alu hard 64P / 35T
 120123 Motor-pinion alu hard 64P / 36T
 120124 Motor-pinion alu hard 64P / 37T
 120125 Motor-pinion alu hard 64P / 38T
 120126 Motor-pinion alu hard 64P / 39T
 120127 Motor-pinion alu hard 64P / 40T
 120128 Motor-pinion alu hard 64P / 41T
 120129 Motor-pinion alu hard 64P / 42T
 120130 Motor-pinion alu hard 64P / 43T
 120131 Motor-pinion alu hard 64P / 44T

120132 Motor-pinion alu hard 64P / 45T
 120133 Motor-pinion alu hard 64P / 46T
 120134 Motor-pinion alu hard 64P / 47T
 120135 Motor-pinion alu hard 64P / 48T
 120136 Motor-pinion alu hard 64P / 49T
 120137 Motor-pinion alu hard 64P / 50T
 120138 Motor-pinion alu hard 64P / 51T
 120139 Motor-pinion alu hard 64P / 52T
 120150 Motor-pinion alu hard 48P / 12T
 120151 Motor-pinion alu hard 48P / 13T
 120152 Motor-pinion alu hard 48P / 14T
 120153 Motor-pinion alu hard 48P / 15T
 120154 Motor-pinion alu hard 48P / 16T
 120155 Motor-pinion alu hard 48P / 17T
 120156 Motor-pinion alu hard 48P / 18T
 120157 Motor-pinion alu hard 48P / 19T
 120158 Motor-pinion alu hard 48P / 20T
 120159 Motor-pinion alu hard 48P / 21T
 120160 Motor-pinion alu hard 48P / 22T
 120161 Motor-pinion alu hard 48P / 23T
 120162 Motor-pinion alu hard 48P / 24T
 120163 Motor-pinion alu hard 48P / 25T
 120164 Motor-pinion alu hard 48P / 26T
 120165 Motor-pinion alu hard 48P / 27T
 120166 Motor-pinion alu hard 48P / 28T
 120167 Motor-pinion alu hard 48P / 29T
 120168 Motor-pinion alu hard 48P / 30T
 120169 Motor-pinion alu hard 48P / 31T
 120170 Motor-pinion alu hard 48P / 32T
 120171 Motor-pinion alu hard 48P / 33T
 120172 Motor-pinion alu hard 48P / 34T
 120173 Motor-pinion alu hard 48P / 35T
 120174 Motor-pinion alu hard 48P / 36T
 120175 Motor-pinion alu hard 48P / 37T
 120176 Motor-pinion alu hard 48P / 38T
 120177 Motor-pinion alu hard 48P / 39T
 120178 Motor-pinion alu hard 48P / 40T
 120179 Motor-pinion alu hard 48P / 61T
 120180 Motor-pinion alu hard 48P / 62T
 120181 Motor-pinion alu hard 48P / 63T

Ball Bearings

1310	Ballbearing 4x7 Flanged (2)
1311	Ballbearing 5x8x2.5 (2)
1314	Ballbearing 6x12 (2)
1315	Ballbearing 5x10x4 (2)
1316	Ballbearing 5x9 (2)
1321	Ballbearing 6x10x3 (2)
1338	Ballbearing 5x8x2.5 (2)
1344	Ballbearing 10x15x4 (2)
401124	Ballbearing 3x6x2.5 (2)
401135	Trustsbearing 2,5x6x2

Universal optionals

401567	Rim 1/10 ep White (4)
401568	Rim 1/10 ep Yellow (4)
401569	Rim 1/10 ep Orange (4)
401501	Body 190mm Lex-IS efra 4030

Fastners

110100	Screw allen countersunk m3x10 (10)
110101	Screw allen countersunk m4x8 (10)
110102	Screw allen countersunk m4x10 (10)
110103	Screw allen countersunk m4x16 (10)
110104	Screw allen countersunk M3x8 (10)
110106	Screw allen flanged roundhead m5x12(10)
110108	Screw allen roundhead m3x6 (10)
110109	Screw allen roundhead m3x10 (10)
110110	Screw allen roundhead m3x16 (10)
110111	Screw allen roundhead m3x14 (10)
110112	Screw allen roundhead m3x12 (10)
110113	Screw allen roundhead m4x8 (10)
110114	Setscrew allen m3x8 (10)
110115	Setscrew allen m3x4 (10)
110116	Setscrew allen m3x3 (10)
110117	Setscrew allen m3x12 (10)
110118	Setscrew allen m4x4 (10)
110119	Setscrew allen m4x6 (10)
110120	Setscrew allen m4x10 (10)
110121	Setscrew allen m5x6 (10)
110122	Screw allen countersunk m3x6 (10)

110123	Screw philips roundhead 3.5x13 (10)
110124	Screw allen countersunk m3x8 (10)
110125	Screw allen countersunk m3x20 (10)
110126	Screw allen countersunk m2.5x12 (10)
110127	Screw allen countersunk m3x12 (10)
110128	Screw allen roundhead m3x5 (10)
110129	Screw allen cilinderhead m3x10 (10)
110130	Screw allen roundhead m2.5x6 (10)
110131	Screw allen roundhead m2.5x10 (10)
110132	Screw allen countersunk m3x16 (10)
110133	Screw philipshead countersunk 2.5x8 wide (10)
110134	Screw philipshead countersunk 2.5x10 wide (10)
110135	Screw allen countersunk M2.5x10 (10)
110136	Screw allen countersunk M2.5x8 (10)
110137	Setscrew allen M3x6 (10)
110138	Screw allen countersunk M4x14 (10)
110139	Screw allen countersunk M3x40 (10)
110140	Screw allen roundhead M3x20 (10)
110141	Screw allen roundhead M3x22 (10)
110142	Screw allen roundhead M3x25 (10)
110143	Screw allen roundhead M4x18 (10)
110144	Screw allen roundhead M3x18 (10)
110145	Screw allen roundhead flanged M3x12 (10)
110146	Screw allen roundhead flanged M3x16 (10)
110147	Screw ph roundhead widethread 2.5x5 (10)
110148	Setscrew allen M5x4 (10)
110149	Screw allen countersink M2x10 (10)
110150	Screw M6x12 nylon black (2)
110151	Screw allen cilinderhead M4x10 (10)
110152	Screw allen cilinderhead M3x8 (10)
110153	Screw allen roundhead M2.3x6 (10)
110154	Setscrew allen M3x10 (10)
110155	Setscrew allen M3x5 (10)
110156	Screw allen countersunk M2.2x6 (10)
110157	Screw allen countersunk M3x5 (10)

110158	Screw allen countersunk M3x15 (10)
110159	Screw allen countersunk M3x18 (10)
110160	Screw allen cilinderhead M2.2x12 (10)
110161	Screw allen cilinderhead M2x6 (10)
110162	Setscrew allen M3x2.5 (10)
110163	Setscrew allen M3x2 (10)
110164	Screw allen roundhead M3x4 (10)
110165	Screw allen cilinderhead M2x5 (10)
110166	Screw allen countersunk M2.5x5 (10)
110167	Screw allen roundhead flanged M3x18 (10)
110168	Screw allen roundhead flanged M3,5x10 (10)
110169	Screw allen roundhead flanged M4x10 (10)
110170	Screw allen roundhead flanged M3x28 (10)
110171	Screw ph countersunk widethread 2.5x15 (10)
110200	Pin 2.5x8 (10)
110201	Pin 3x12 (10)
110202	Pin 5x5 (10)
110203	Pin 3x14 (10)
110204	Pin 3x20 (10)
110205	Pin 3x22 (10)
110206	Pin 2.5x22 (10)
110207	Pin 2.5x12 (10)
110208	Pin nra 2x9.8 (4)
110209	Pin nra 2x18 (4)
110210	Pin 3x13 (10)
110211	Pin 2.5x13 (10)
110212	Pin 2.5x17 (10)
110213	Pin 2.5x10 (10)
110214	Pin 3x15 (10)
110215	Pin 2x12 (10)
110216	Pin 2.5x15 (10)
110217	Pin 2x9 (10)
110218	Pin 3x10 (10)
110300	E-clip 2.3 (10)
110301	E-clip 3.2 (10)

110302 E-clip 4.0 (10)
 110303 E-clip 5.0 (10)
 110304 E-clip 7.0 (10)
 110305 Seger clip 12x1.0 (10)
 110306 E-clip 6.0 (10)
 110400 Shim 6.0x10x0.2 (10)
 110401 Shim 3.2x7x0.5 (10)
 110402 Nut nylock M3 (10)
 110403 Nut nylock M4 (10)
 110404 Shim 6x8x0.3 (10)
 110405 Nut nylock M4 flanged (10)
 110406 Nut nylock M2.2 (10)
 110407 Nut M3 (10)
 110408 Shim 3x5x0.3 (10)
 110409 Shim 3x5x1 (10)
 110410 Shim 3x5x2 (10)
 110411 Shim 3x5x4 (10)
 110412 Shim 3.5x8x1 (10)
 110413 Shim 3.5x12x0.2 (10)
 110414 Shim 3x6x0.1 (10)
 110415 Shim 3x6x0.5 (10)
 110416 Shim 3x6x0.8 (10)
 110417 Shim 3x6x3 (10)
 110418 Shim 4x8x0.1 (10)
 110419 Shim 4x9.5x1 (10)
 110420 Shim 4x9.5x2 (10)
 110421 Shim 4x9.5x4 (10)
 110422 Shim 4x10x0.3 (10)
 110423 Shim 5x8x0.1 (10)
 110424 Shim 5x8x0.3 (10)
 110425 Shim 5x10x0.3 (10)
 110426 Shim 5x10x0.5 (10)
 110427 Shim 5x15x0.3 (10)
 110428 Shim 6.5x8x0.25 (10)
 110429 Shim 6x11.75x0.2 (10)
 110430 Shim 6x12x0.5 (10)
 110431 Shim 8x11x0.1 (10)
 110432 Shim 8x11x0.2 (10)
 110433 Shim 12x15x0.25 (10)
 110434 Shim 12x18x0.3 (10)

110435 Shim 13x16x0.2 (10)
 110436 Shim 3x5x3 (10)
 110437 Nut M2.5 (10)
 110438 Shim 2.5x6x0.5 (10)
 110439 Shim 3x7.5x1 (10)
 110440 Shim 2.5x5x0.4 (10)
 110441 Nut nylock M3 flanged (10)
 110442 Shim 4x8x0.6 (10)

Merchandising

1891 Serpent medium promo decal 20x12.5 (2)
 1893 Serpent decal xL (30x60cm)
 1998 Cap serpent black-orange
 1869 Pit-towel serpent orange 140x60cm
 1872 Rucksack serpent (35x45cm) black
 1873 Rucksack serpent (48x61cm) black
 1883 Banner Serpent S-logo 200x100 nylon
 190110 Sweater hooded serpent black (s)
 190111 Sweater hooded serpent black (m)
 190112 Sweater hooded serpent black (l)
 190113 Sweater hooded serpent black (xl)
 190114 Sweater hooded serpent black (xxl)
 190116 T-shirt lady black Serpent (S)
 190117 T-shirt lady black Serpent (M)
 190118 T-shirt lady black Serpent (L)
 190119 T-shirt lady black Serpent (xL)
 190121 T-shirt Serpent LTS white (S)
 190122 T-shirt Serpent LTS white (M)
 190123 T-shirt Serpent LTS white (L)
 190124 T-shirt Serpent LTS white (xL)
 190125 T-shirt Serpent LTS white (xxL)
 190127 T-shirt Serpent DTR orange (S)
 190128 T-shirt Serpent DTR orange (M)
 190129 T-shirt Serpent DTR orange (L)
 190130 T-shirt Serpent DTR orange (xL)
 190131 T-shirt Serpent DTR orange (xxL)
 190132 T-shirt Serpent DTR black (S)
 190133 T-shirt Serpent DTR black (M)
 190134 T-shirt Serpent DTR black (L)
 190135 T-shirt Serpent DTR black (xL)

190136 T-shirt Serpent DTR black (xxL)
 190150 Dress shirt Serpent black-orange (S)
 190151 Dress shirt Serpent black-orange (M)
 190152 Dress shirt Serpent black-orange (L)
 190153 Dress shirt Serpent black-orange (XL)
 190154 Dress shirt Serpent black-orange (XXL)
 190155 Dress shirt Serpent black-orange (XXXL)
 190156 Polo shirt Serpent black-orange (S)
 190157 Polo shirt Serpent black-orange (M)
 190158 Polo shirt Serpent black-orange (L)
 190159 Polo shirt Serpent black-orange (XL)
 190160 Polo shirt Serpent black-orange (XXL)
 190161 Polo shirt Serpent black-orange (XXXL)
 190167 T-shirt Serpent LTS black (S)
 190168 T-shirt Serpent LTS black (M)
 190169 T-shirt Serpent LTS black (L)
 190170 T-shirt Serpent LTS black (xL)
 190171 T-shirt Serpent LTS black (xxL)
 190172 Winter jacket Serpent (S)
 190173 Winter jacket Serpent (M)
 190174 Winter jacket Serpent (L)
 190175 Winter jacket Serpent (xL)
 190176 Winter jacket Serpent (xxL)
 190177 T-shirt Serpent LTS orange (S)
 190178 T-shirt Serpent LTS orange (M)
 190179 T-shirt Serpent LTS orange (L)
 190180 T-shirt Serpent LTS orange (xL)
 190181 T-shirt Serpent LTS orange (xxL)

S411

Team Edition **TE**



www.serpent.com - info@serpent.com



All rights reserved. Changes may occur without prior notice.
Sheet internal part-number: #400012

© Serpent #1-2012