

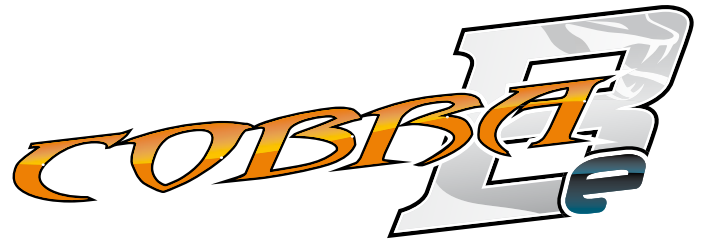

Update manual 811Be 2.0



Introduction

Serpent Cobra 811 Buggy Be 2.0 1/8 4wd

Main new features

- new wider rear end with new geometry for more rear traction and an easier handling car with wider sweetspot
- rear shock absorbers moved to the back of the shock tower
- longer rear shocks; with longer housing and shock rods for more travel
- rear wing with integrated holders for the ball-raced rear anti-roll bar
- longer rear lower arms, new higher carbon shock tower, longer rear shock, new upright
- lexan mud-guards to mount on lower rear arms
- nylon mud-scrapers mount on the rear uprights
- improved differential gears - as already in the Be version
- larger bearings in steering blocks and uprights 8x16x5 (2) and 15x21x4 (2),
- transmission using larger bearings 8x19x6 and 13x19x4 and new couplers for extra durability

This update manual shows the pages which differ from the original Cobra Be manual. It also includes the 2 main exploded views of the rear end and shocks, and a parts-list with the new items. The 2.0 set-up sheet is enclosed separate as blank and default.

More info can be found online under **www.serpent.com/600012**

Enjoy the assembly and racing!

Team Serpent

CONTENTS

3 Differential

4 Rear end

5 Rear end / Shocks

6 Exploded view rear end

7 Partlist

DIFFERENTIAL CENTER

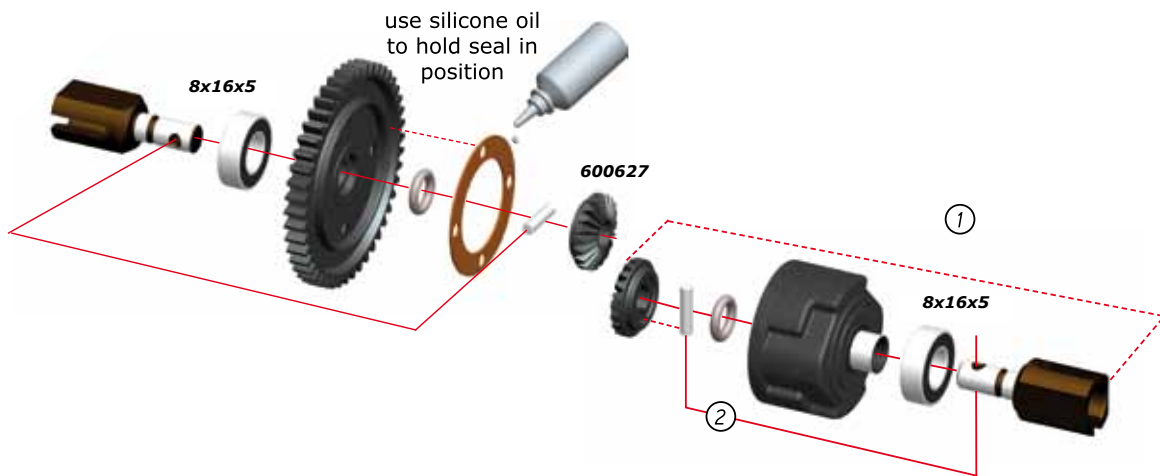

DIFFERENTIAL FRONT/REAR

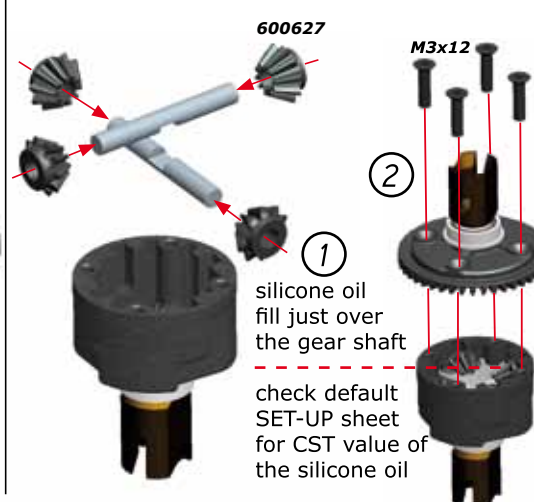
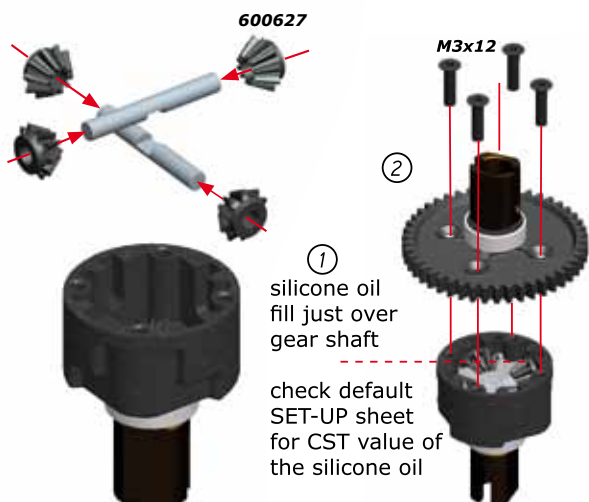
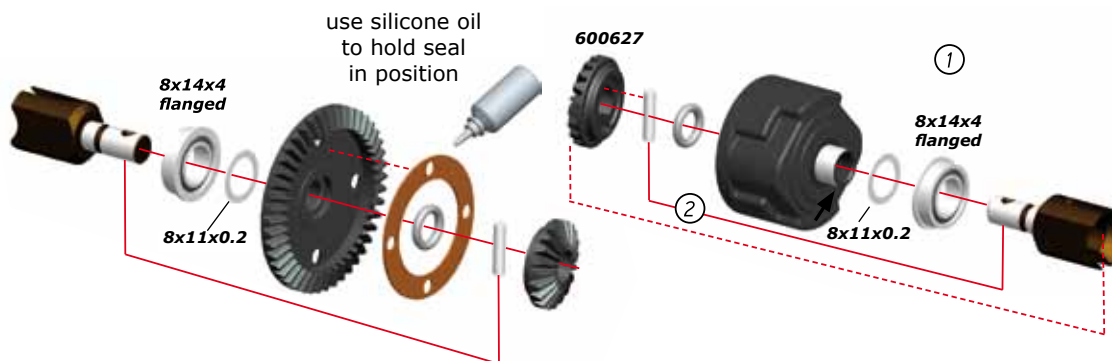

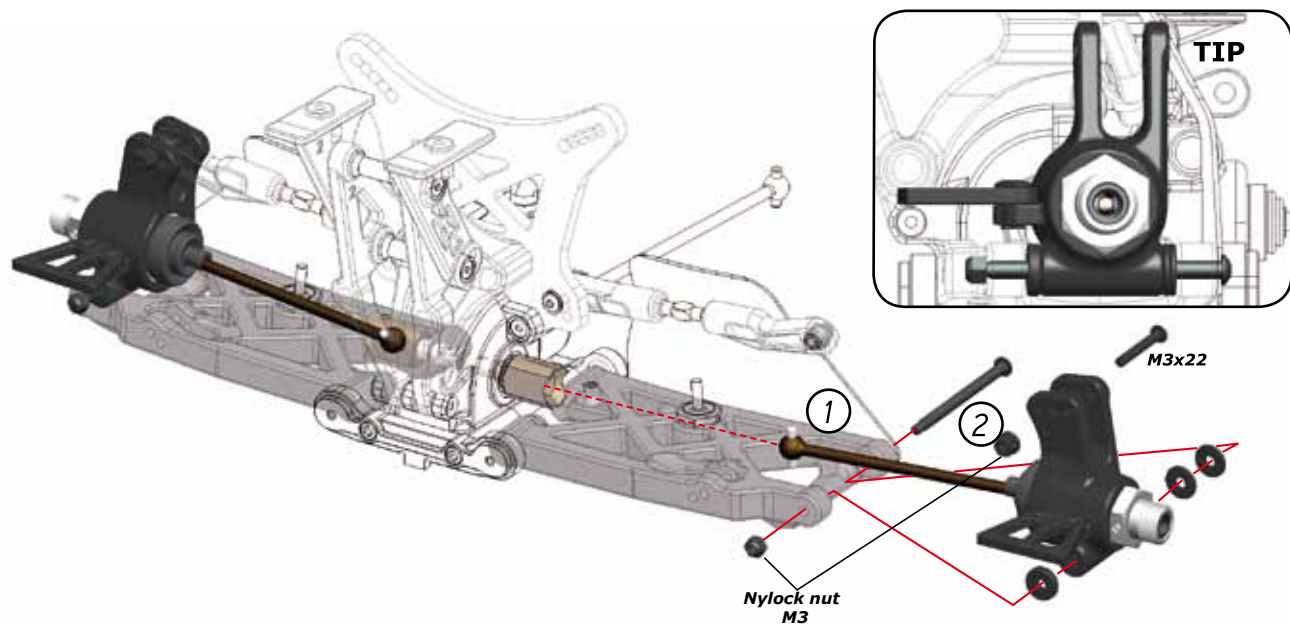
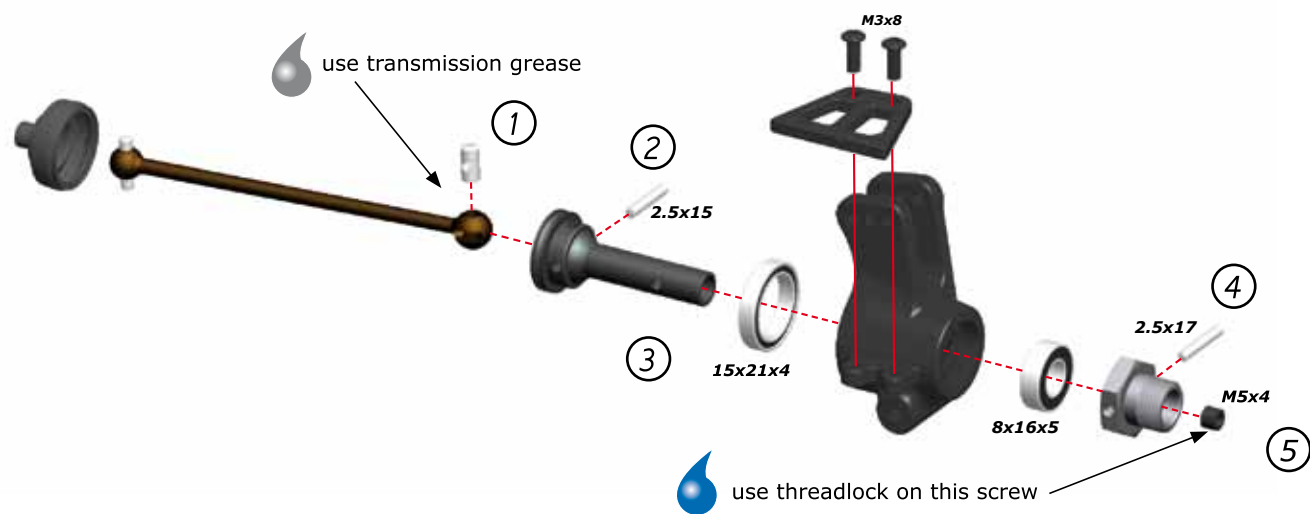
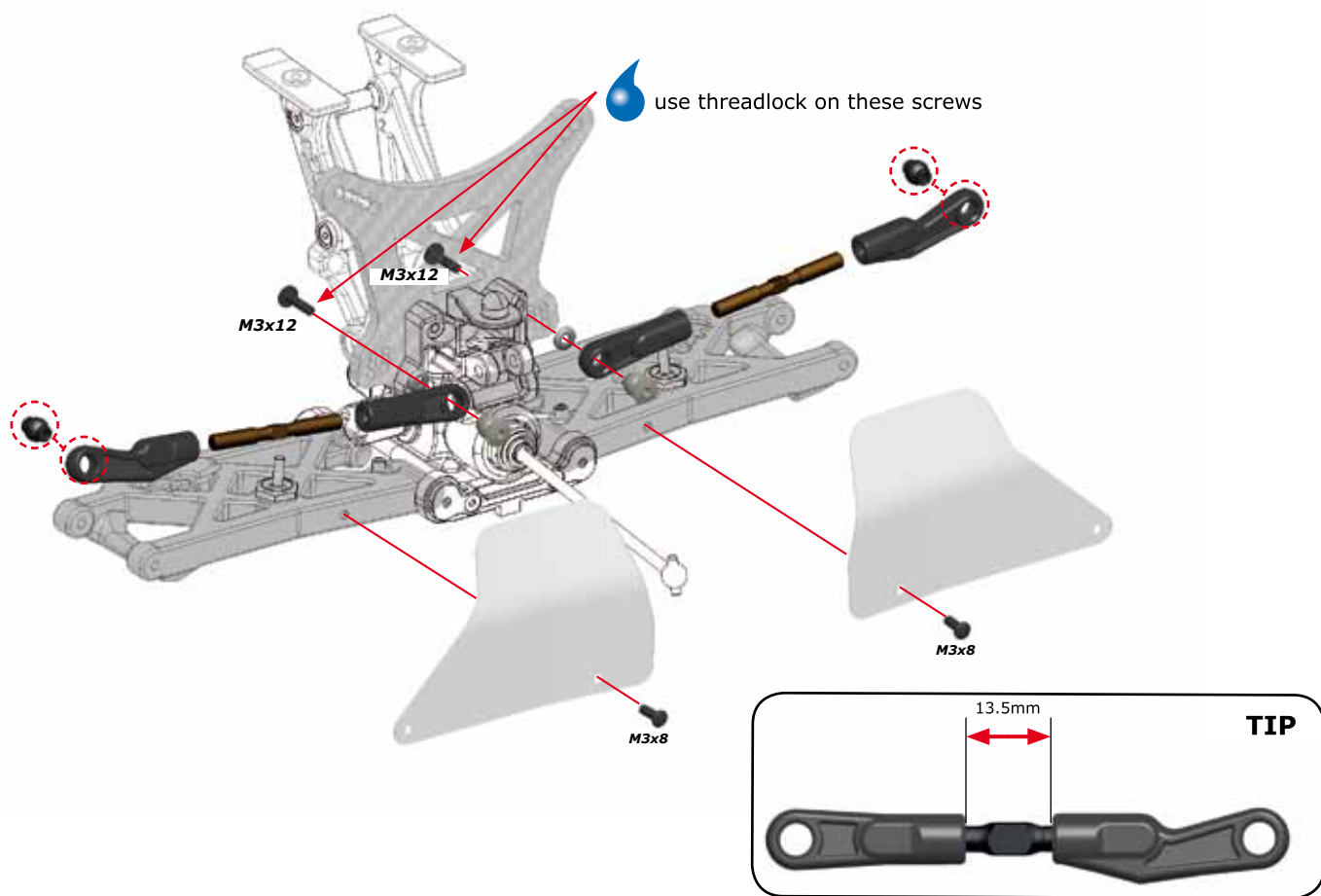

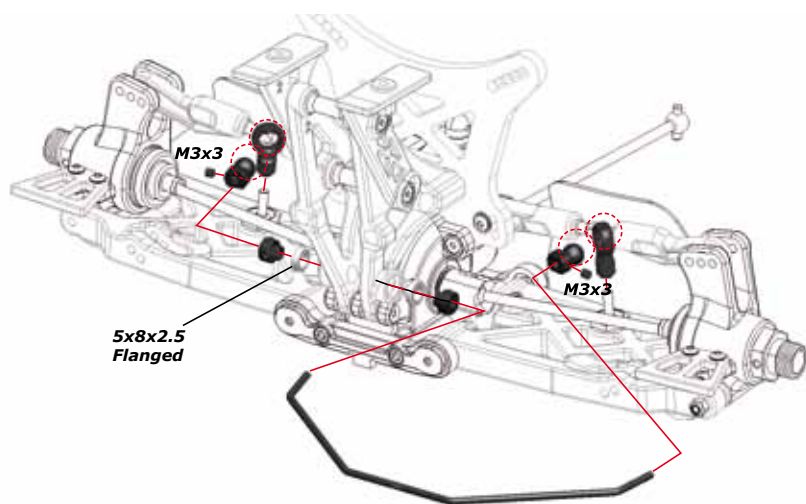
**TIP**

use threadlock on these screws

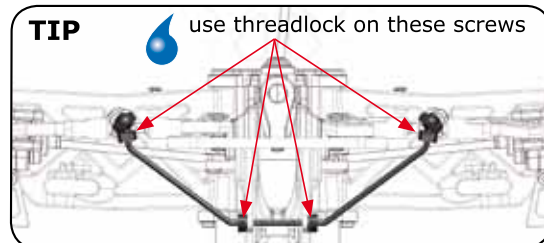
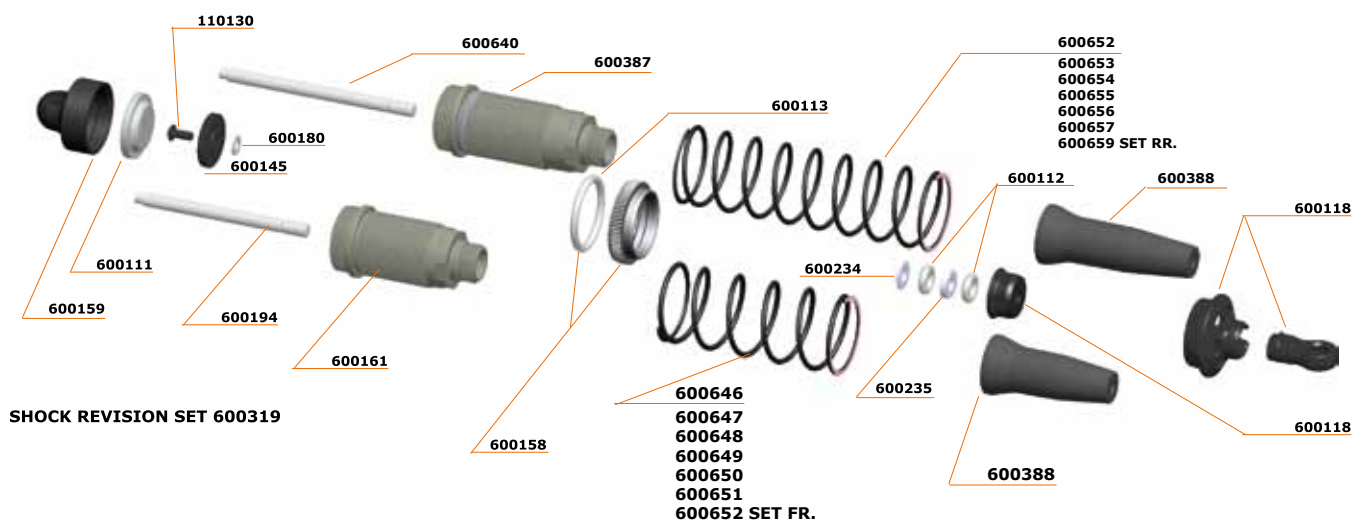
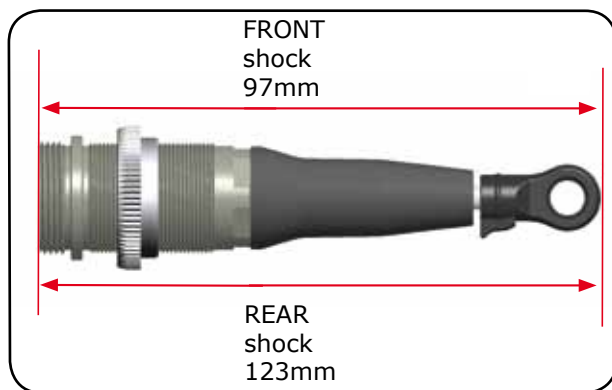
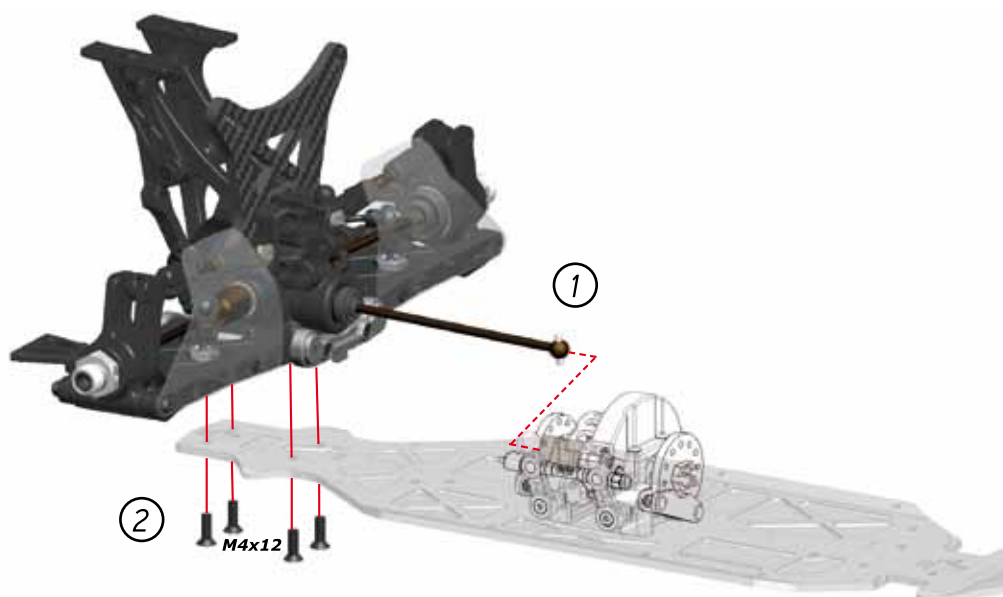
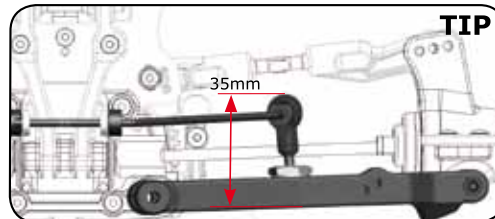
**TIP**

REAR ASSEMBLY



Part-list update

Nr	Name (kit parts)		
600633	Wishbone rear L+R 811 2.0	600650	Spring FR purple V2 (0.79N/4.5LB)(2)
600634	Upright L+R 811 2.0	600651	Spring FR green V2 (0.81N/4.65LB)(2)
600635	Driveshaft RR 811 2.0 (2)	600652	Spring RR orange V2 (0.53N/3.0LB)(2)
600636	Wheelaxle RR 811 2.0 (2)	600653	Spring RR red V2 (0.56N/3.2LB)(2)
600637	Shocktower carbon RR 811 2.0	600654	Spring RR pink V2 (0.58N/3.3LB)(2)
600638	Wheel scraper RR L+R 811 2.0	600655	Spring RR blue V2 (0.60N/3.4LB)(2)
600639	Mud guard L+R 811 2.0	600656	Spring RR purple V2 (0.61N/3.5LB)(2)
600640	Shock shaft RR 811 2.0 (2)	600657	Spring RR green V2 (0.63N/3.6LB)(2)
600641	Hex adaptor -2mm (2)	600658	Spring set FR V2 (6x2)
600387	Shock body coated rear truggy (2)	600659	Spring set RR V2 (6x2)
optionals		600660	Wheelaxle RR 811 2.0 alu (2)
600646	Spring FR orange V2 (0.66N/3.8LB)(2)	600661	Upright L+R 811 2.0 alu
600647	Spring FR red V2 (0.70N/4.0LB) (2)	600663	C-hub 16 L+R alu
600648	Spring FR pink V2 (0.73N/4.15LB)(2)	600664	S811-E Body Avenger
600649	Spring FR blue V2 (0.75N/4.3LB)(2)	600665	C-hub 14 L+R alu



2.0
COBBLE



www.serpent.com
info@serpent.com



Art.nr.: #82353-1