



# 2.0 COBBLE

## SET UP

### DIFFERENTIAL OIL

FRONT	CENTER	REAR
7000 CST	10000 CST	5000 CST

### TRANSMISSION SET UP

PINION	15	T	SPUR GEAR	2	T
FINAL DRIVE RATIO			ROLLOUT		mm
MOTOR			TIMING		
ROTOR			ARMATURE		
ESC			BATTERIES		
BRUSHLESS	PROGRAM	PUNCH	INITIAL BRAKE	AUTO BRAKE	

### BODY - WING

BODY	
WING	

### SHOCKS

FRONT	SPRING	REAR
<input type="checkbox"/>	Orange	<input type="checkbox"/>
<input type="checkbox"/>	Red	<input type="checkbox"/>
<input type="checkbox"/>	Pink	<input type="checkbox"/>
<input checked="" type="checkbox"/>	Blue	<input type="checkbox"/>
<input type="checkbox"/>	Purple	<input checked="" type="checkbox"/>
<input type="checkbox"/>	Green	<input type="checkbox"/>
<input type="checkbox"/>	Other	<input type="checkbox"/>
400	OIL/CST	300
25	REBOUND %	25

☐ OPEN ☒ PISTON ☐ CLOSED

HOLES SIZE	
<input type="checkbox"/>	1.1MM
<input type="checkbox"/>	1.2MM
<input checked="" type="checkbox"/>	1.3MM
<input type="checkbox"/>	1.4 MM
<input type="checkbox"/>	OTHER

### TYRES

BRAND	Proline Block
TYPE	
INSERT	
WHEELS	
STOCK <input checked="" type="checkbox"/> BRAND	TYPE

### COMMENTS

García - Spain Nationals. June 2013

TRACK SIZE	<input checked="" type="checkbox"/> OPEN	<input checked="" type="checkbox"/> MEDIUM	<input type="checkbox"/> TIGHT
TRACK TRACTION	<input type="checkbox"/> HIGH	<input checked="" type="checkbox"/> MEDIUM	<input type="checkbox"/> LOW
TRACK SURFACE	<input type="checkbox"/> SMOOTH	<input type="checkbox"/> MEDIUM	<input checked="" type="checkbox"/> BUMPY
TRACK TYPE	<input checked="" type="checkbox"/> HARD PACKED	<input type="checkbox"/> SOFT DIRT	<input type="checkbox"/> CLAY
	<input type="checkbox"/> BLUE GROOVE	<input type="checkbox"/> ASTRO TURF	<input type="checkbox"/> GRASS
TRACK CONDITION	<input checked="" type="checkbox"/> DRY	<input type="checkbox"/> DUSTY	<input type="checkbox"/> WETT

TEMP. F° / °C

AIR TRACK

LAPS

BEST LAP TIME

QUALI RESULT

RACE RESULT

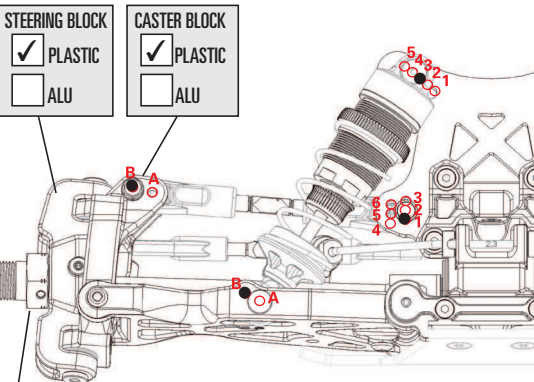

HEX ADAPTER ☒ 0mm ☐ mm

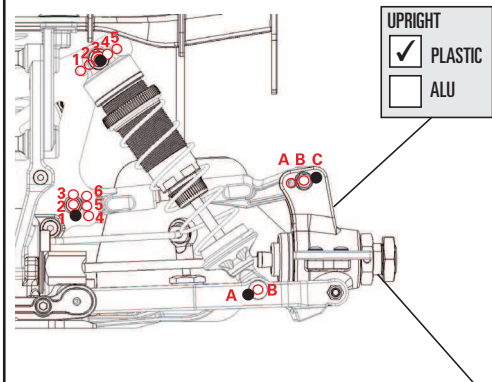

HEX ADAPTER -2mm

