

# SPYDER SRX2

## Mid-Motor Set-up Sheet

Driver:  
Siegri Tittes

Date:

Event:

Track:  
Carpet / Astro Turf

Track-Temp Air-Temp

Country/City/State:

### Track Conditions

☐ Indoor ☐ Tight ☐ Medium ☐ Smooth ☐ Hard Packed ☐ Grass ☒ Astro-turf ☐ Clay ☐ Low Bite ☒ High Bite  
☒ Outdoor ☒ Open ☐ ☒ Rough ☐ Blue Groove ☒ Carpet ☐ Multi-Surface ☐ ☐ Med Bite ☐

### Front Suspension

Sway Bar: ☐ Yes Size \_\_\_\_\_ mm ☒ No

Ride Height: 17 mm

Camber: -2 °

Toe: ☐ In ☒ Out 1 °

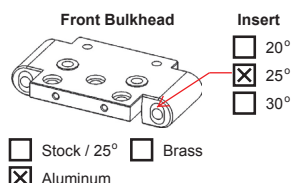

Caster Block Inserts  
☐ + ☐ 0 Deg  
☒ - ☐ 2.5 Deg ☒ 5 Deg

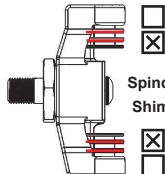
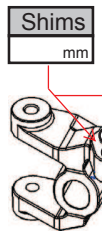

Bump Steer  
 Shims 2 mm

Steering Ackerman  
☐ Opt.1  
☒ Opt.2  
☐ Opt.3

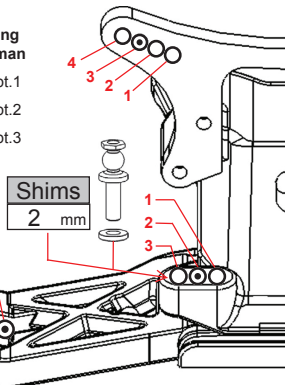

### Rear Suspension

Sway Bar: ☐ Yes Size \_\_\_\_\_ mm ☒ No

Ride Height: 18 mm

Camber: -3 °

RR-FR-Toe-Block ☒ Stock ☐ Brass

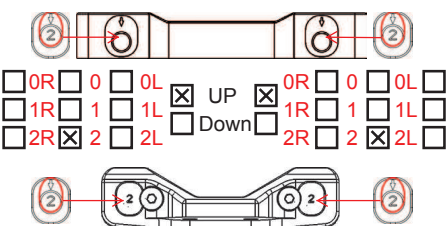

☐ 0R ☐ 0 ☐ 0L ☒ UP ☐ 0R ☐ 0 ☐ 0L  
☐ 1R ☐ 1 ☐ 1L ☒ Down ☐ 1R ☐ 1 ☐ 1L  
☐ 2R ☒ 2 ☐ 2L ☒ Down ☐ 2R ☐ 2 ☒ 2L

Toe-In: 3 °

Anti-Squat: 2 °

Outboard Toe-in: ☒ 0 deg ☐ 0.5 deg ☐ 1.0 deg ☐ 1.5 deg ☐ 2.0 deg

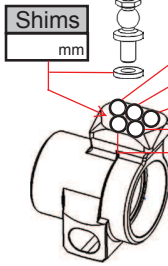

Ballast Weight  
☐ Yes ☒ No

Hex Adapter  
☐ - 0.75 mm ☒ Stock ☐ + 0.75 mm

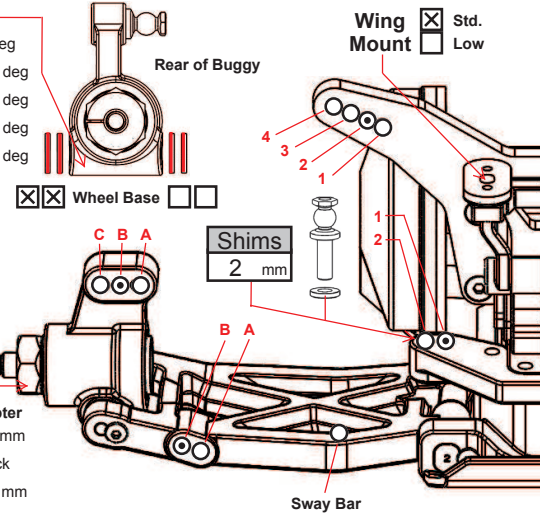

### Shocks

	Front	Rear
Shock Piston (1):	1.3 mm X 4	1.3 mm X 4
Shock Brand/Oil:	450	350
Shock Spring:	Kyosho Pink	Kyosho Yellow
Shock Limiters (2):	2.5 mm	0 mm
Shock Length (3):	_____ mm	_____ mm
Rebound (4):	_____ mm	_____ mm
Bladder / Seal (5):	_____	_____
Spring Bucket:	_____	_____

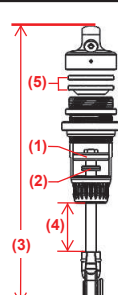

### Battery-Weight

"Weight Placement"  
 Type the weight in grams at the Location it's placed on the chassis

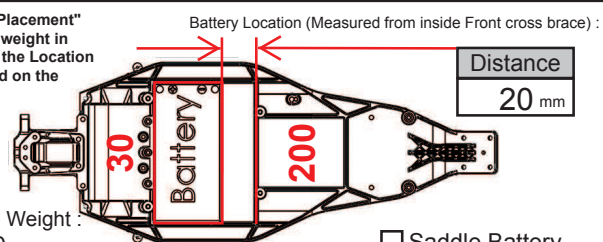

Vehicle Weight: 1740 Grams

Weight Bias - Front: 60 % Rear: 40 %

☐ Saddle Battery  
☒ Shorty Battery

### Gearing

Spur Gear (A): 78 T  
 Pinion Gear (B): 20 T  
 Gear Ratio (A/B)=C: 3.900  
 Final Drive (C\*2.43): 9.477

### Differential

Diff Height  
☐ High ☒ Med ☐ Low  
☒ Ball Differential  
☐ Gear Differential  
 Oil cst/wt: \_\_\_\_\_

### Electrics

Radio: KoPropo - EX10  
 ESC: Hobbywing V3.1  
 Motor: Reely 6.5T  
 Servo: Sanwa SRG-BL  
 Battery: MuchMore 4500

### Body-Wing

Body: JC-Finisher  
 Wing Rear: Stock  
 Wing Width: \_\_\_\_\_  
 Wing Lip: \_\_\_\_\_  
 Wing Angle: \_\_\_\_\_  
 Wing Front: \_\_\_\_\_

### Tires

	Front	Rear
Brand:	Schumacher	Schumacher
Model Name:	Cut Stagger	Mini Pin
Compound:	Yellow	Yellow
Insert Type:	NONE	PL-Blue
Wheels:	Stock	Stock
Tire Additive:	_____	_____

### Comments