



CONVERSION KIT  
INSTRUCTION MANUAL  
& REFERENCE GUIDE

STEP 1

CA Glue

To prevent the risk of the carbon fibre splitting in the event of a crash you should apply CA Glue around the chassis' edge and the front chamfer as shown in red below.

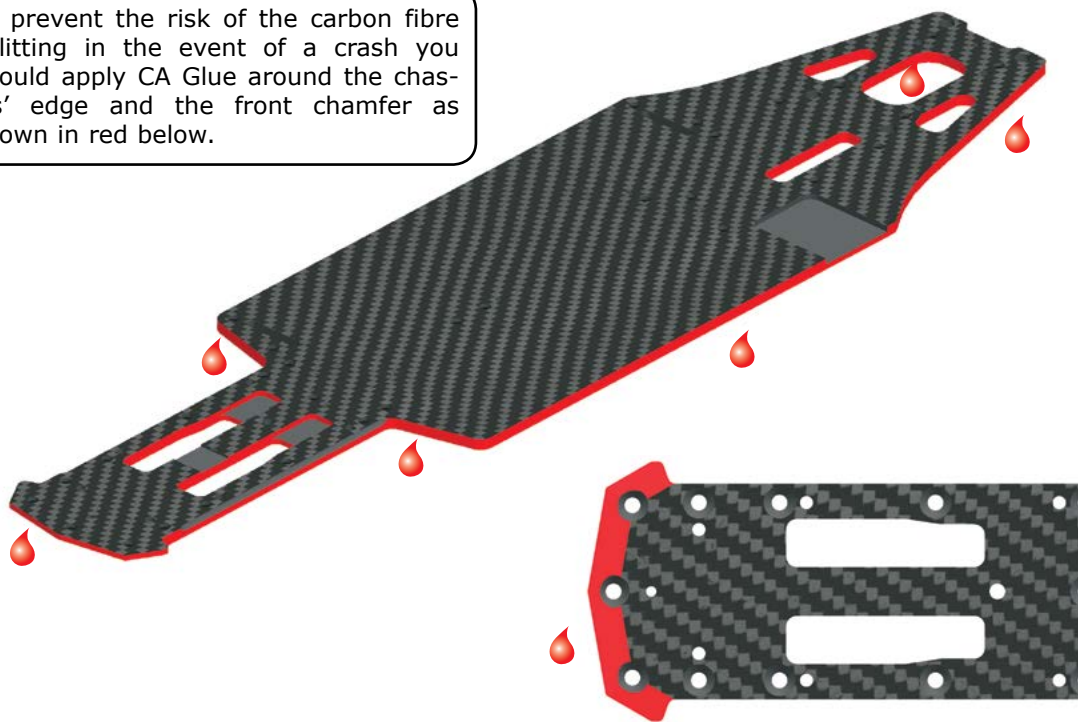

STEP 2

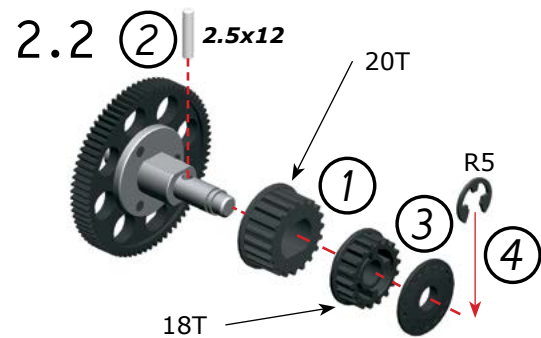
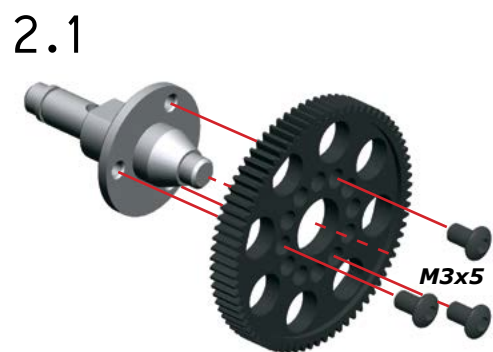

STEP 3

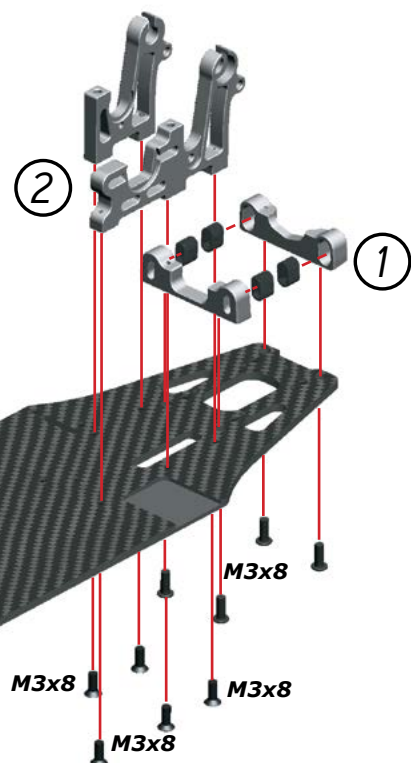

STEP 4

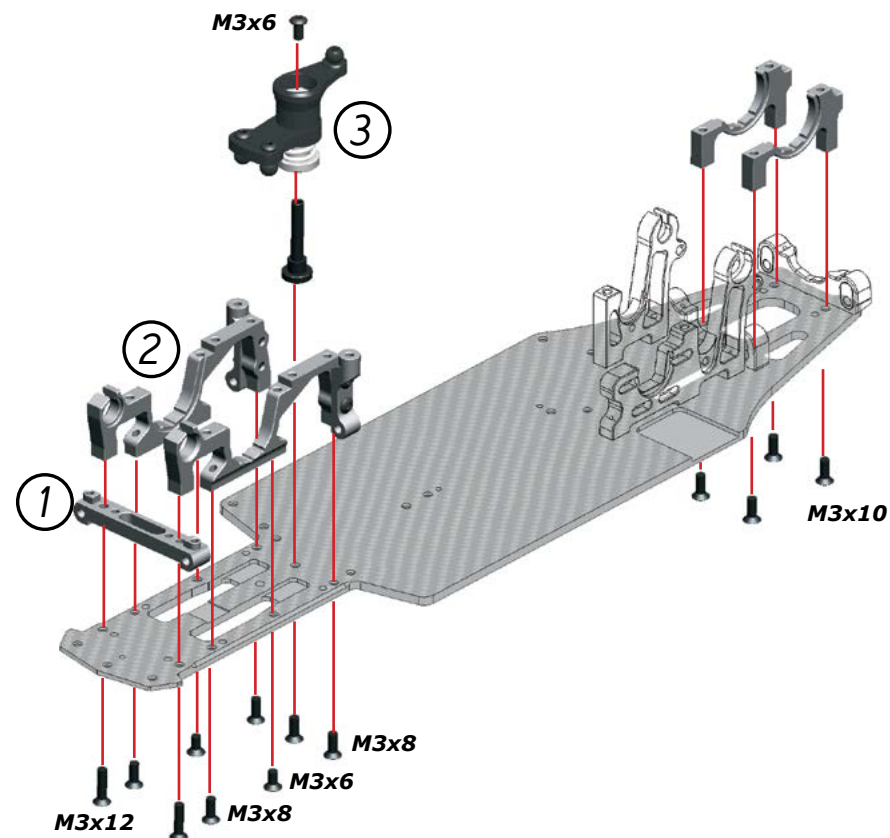

STEP 5

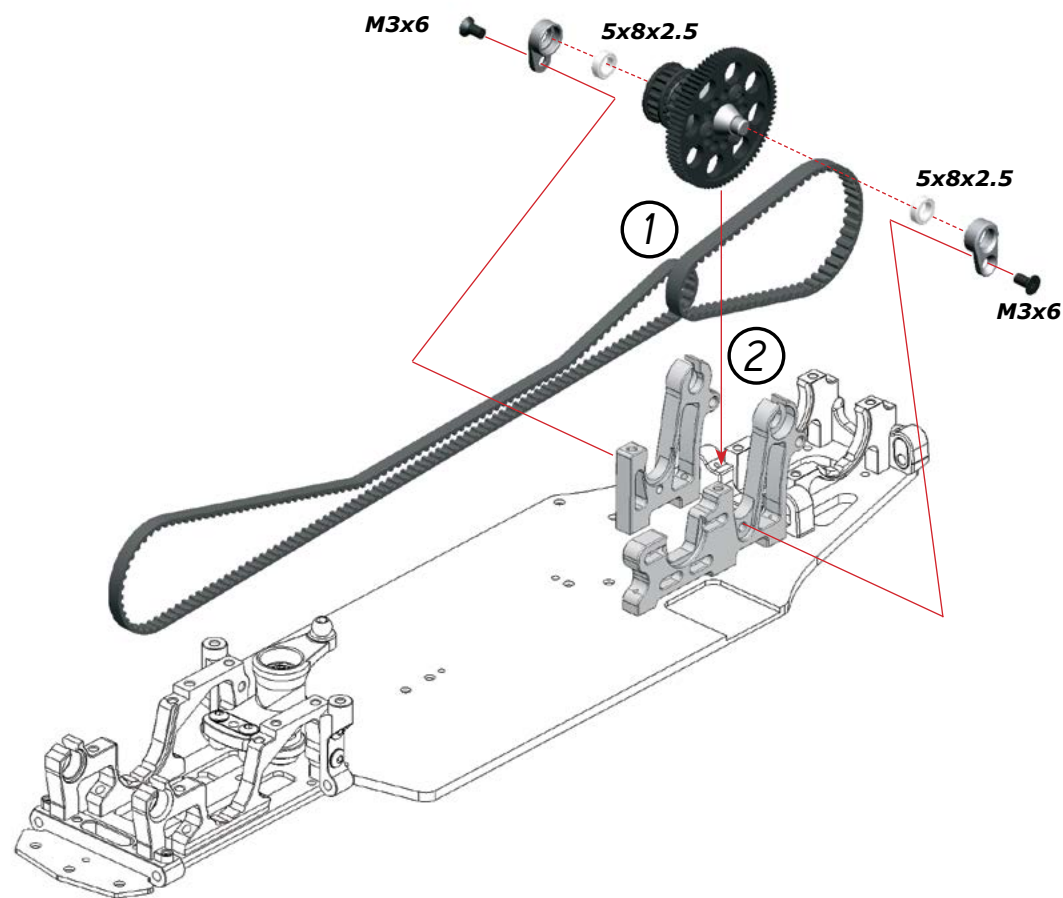

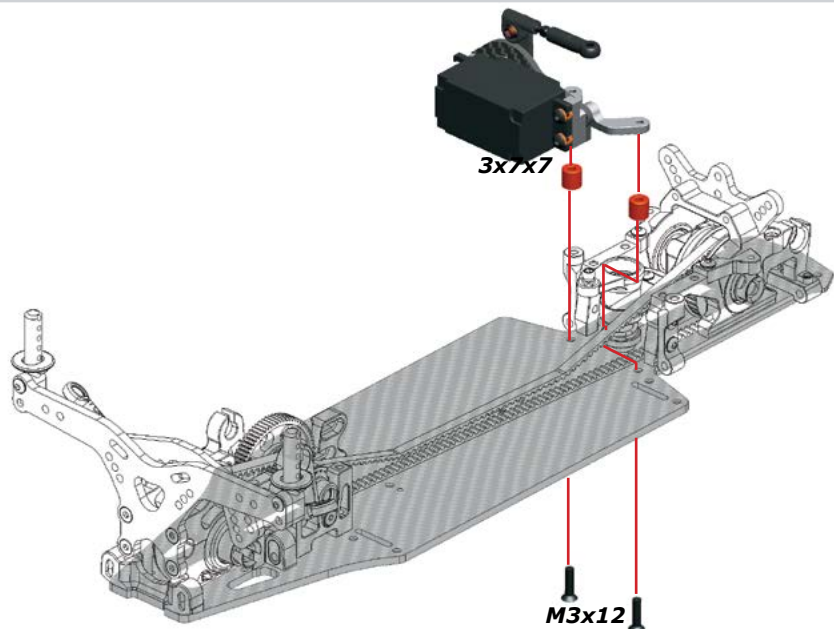
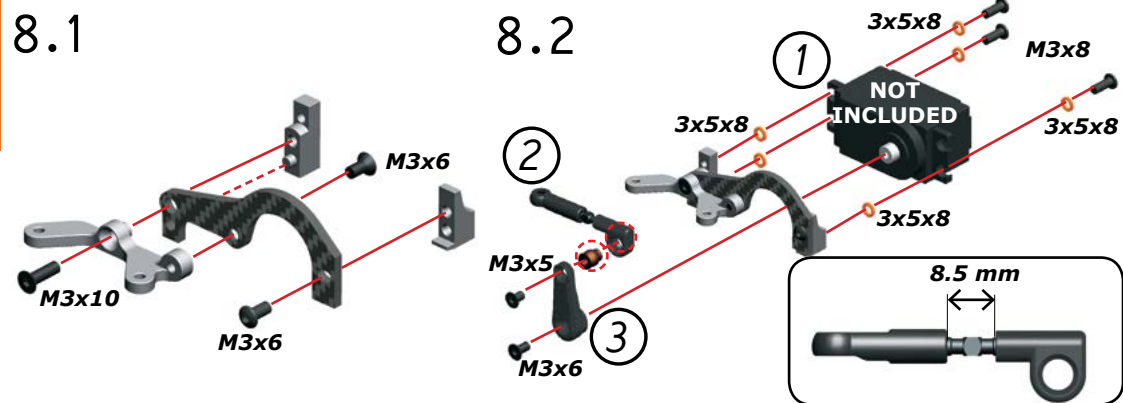
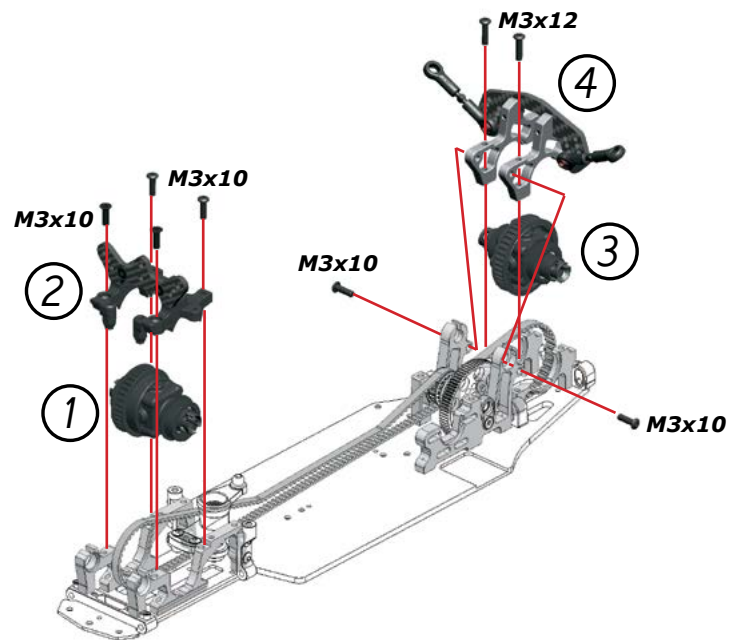

10.1

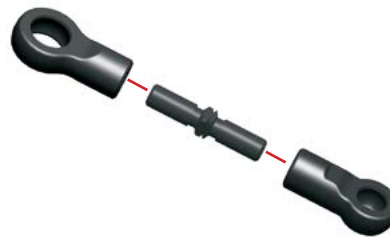

10.2

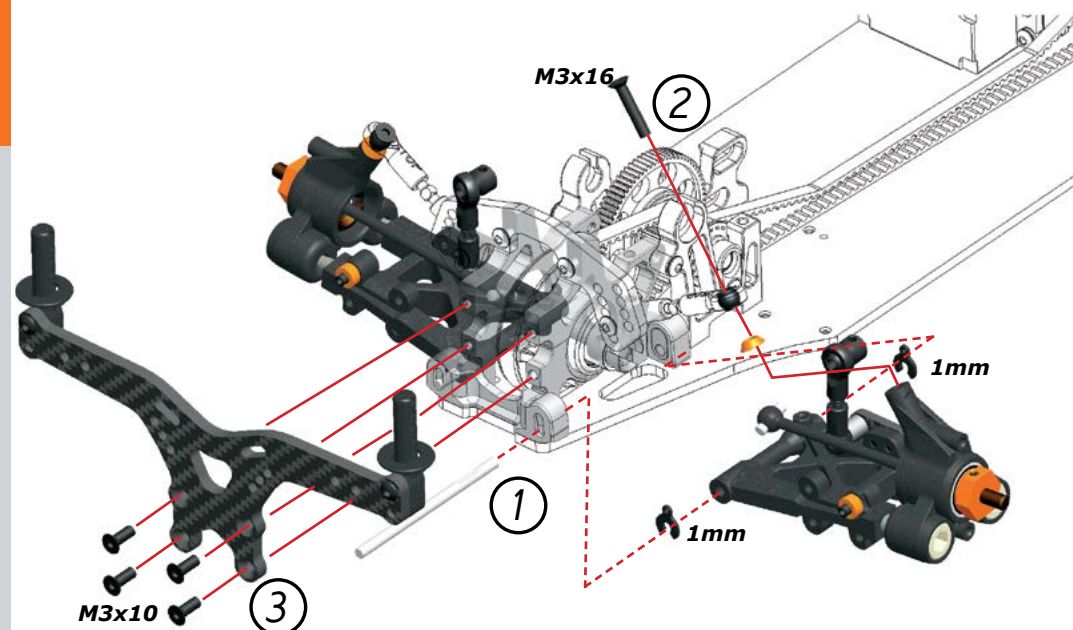
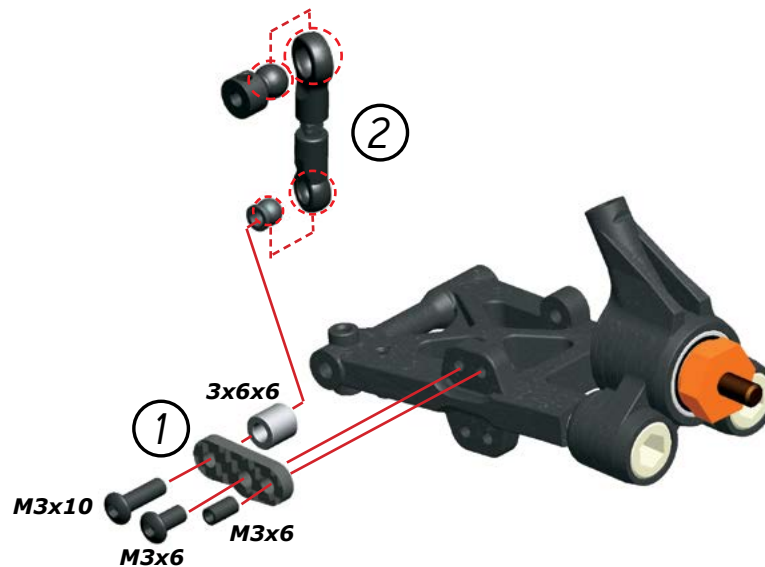
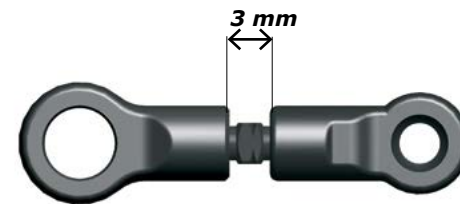



STEP  
12

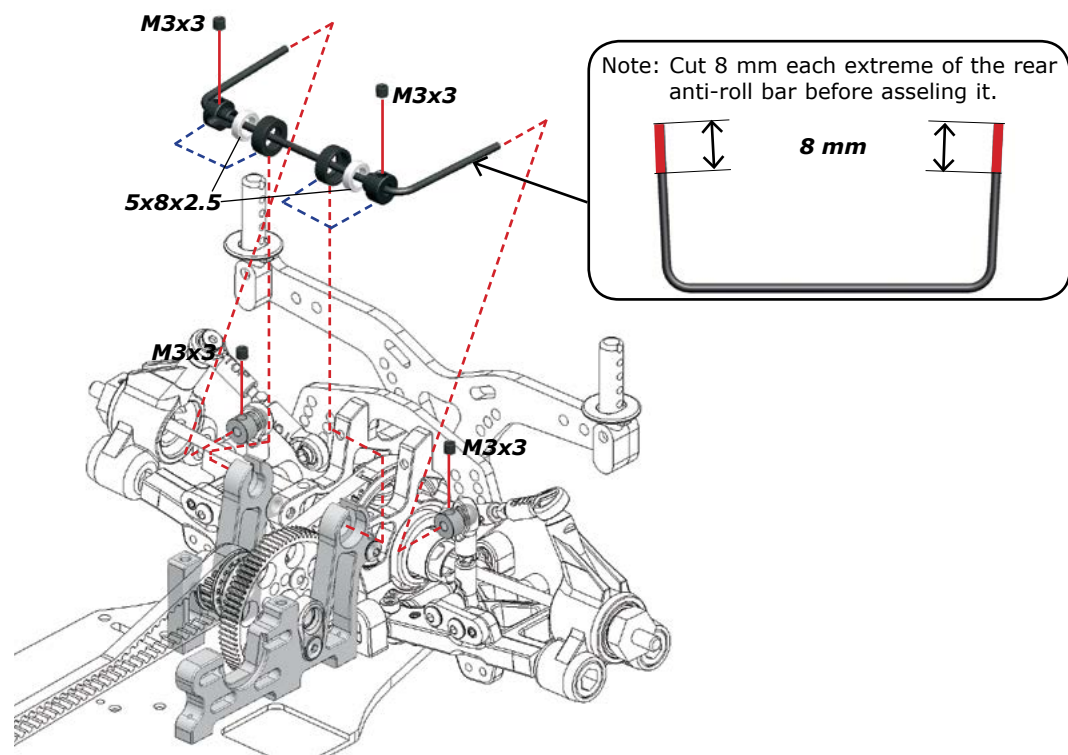

STEP  
13

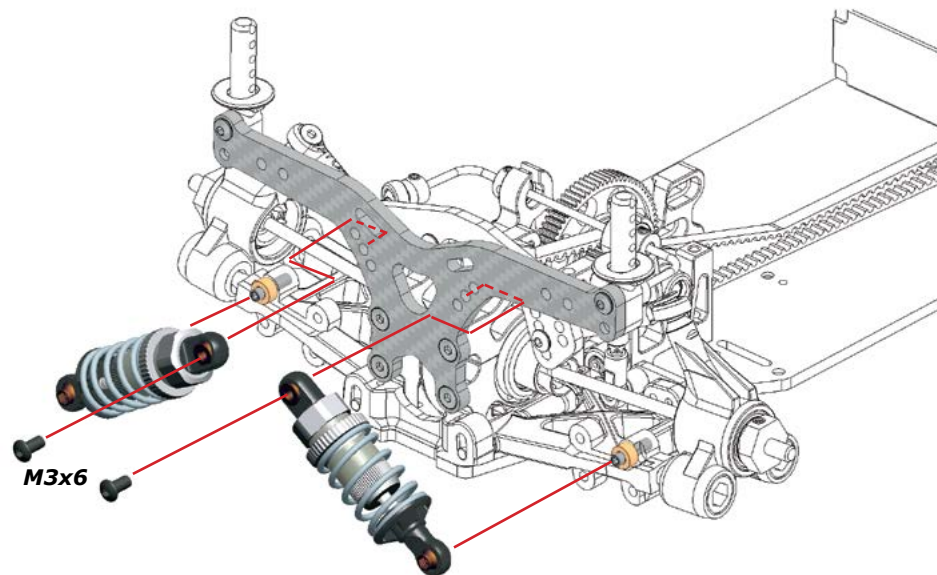

STEP  
14

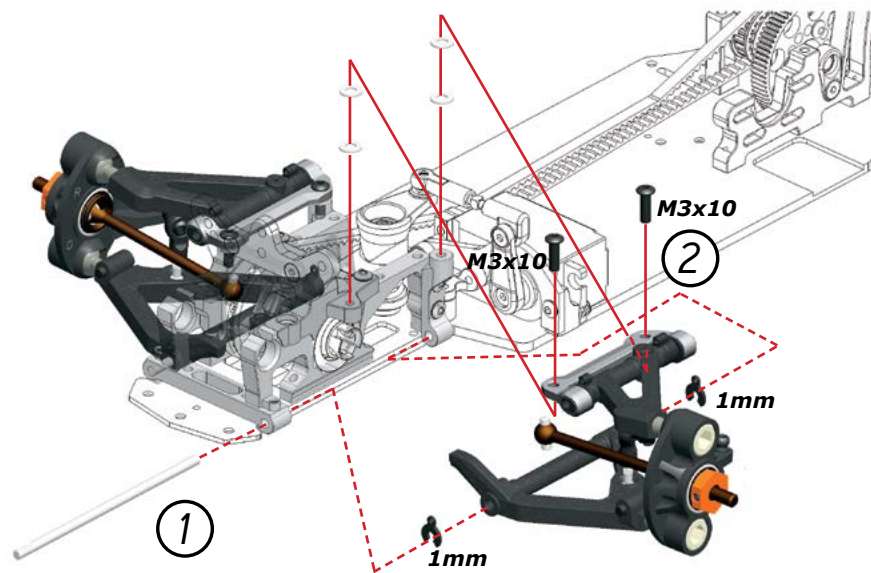

STEP  
15

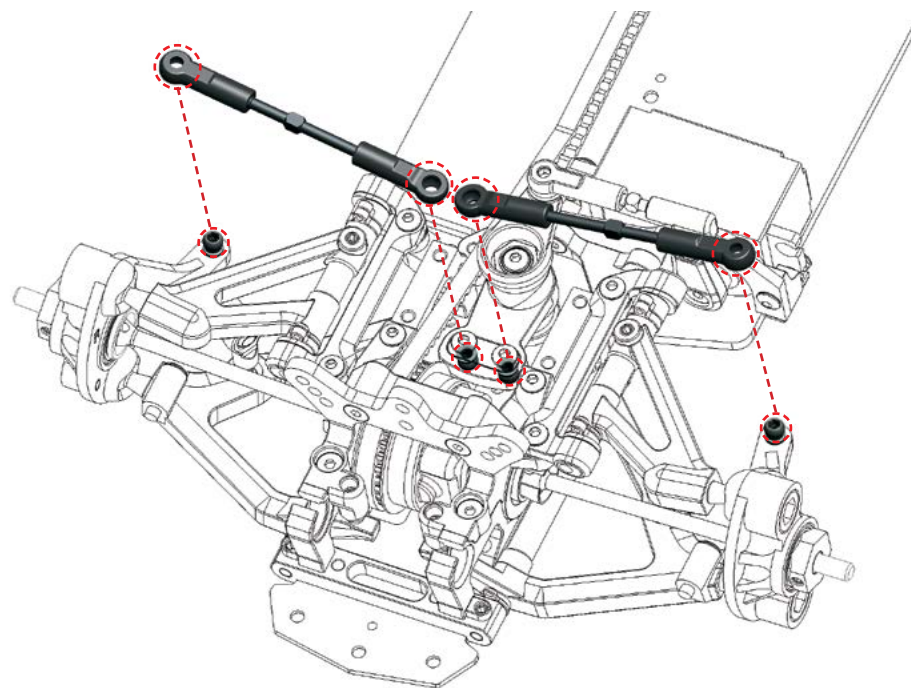

STEP  
16

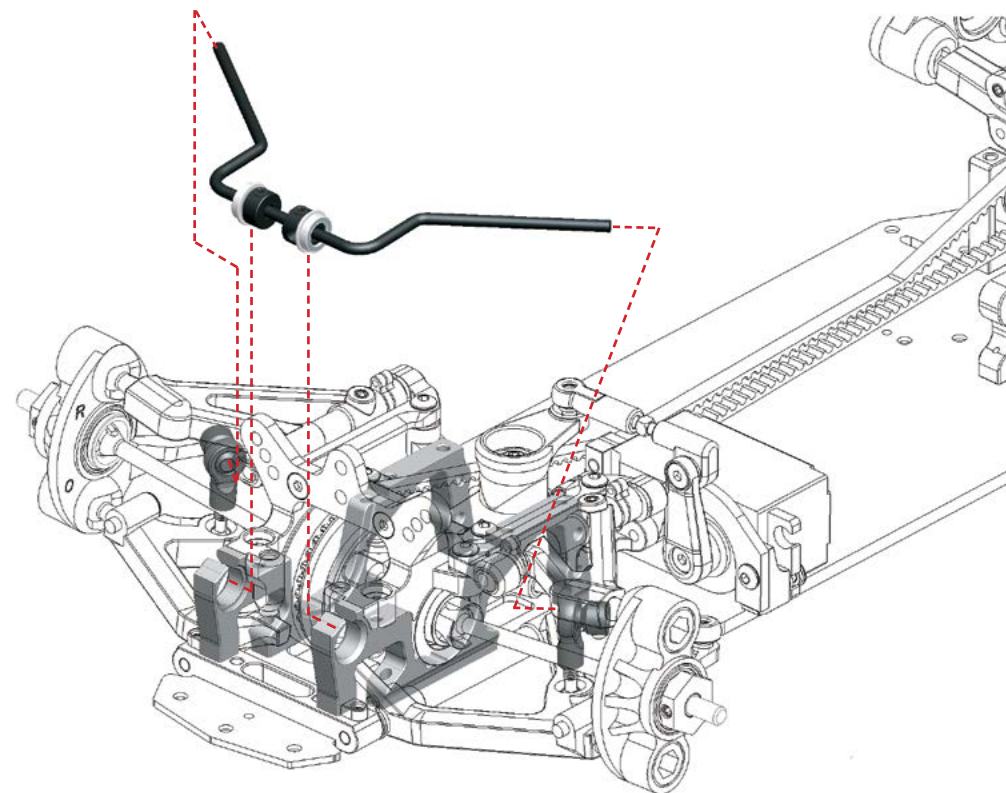

STEP  
17

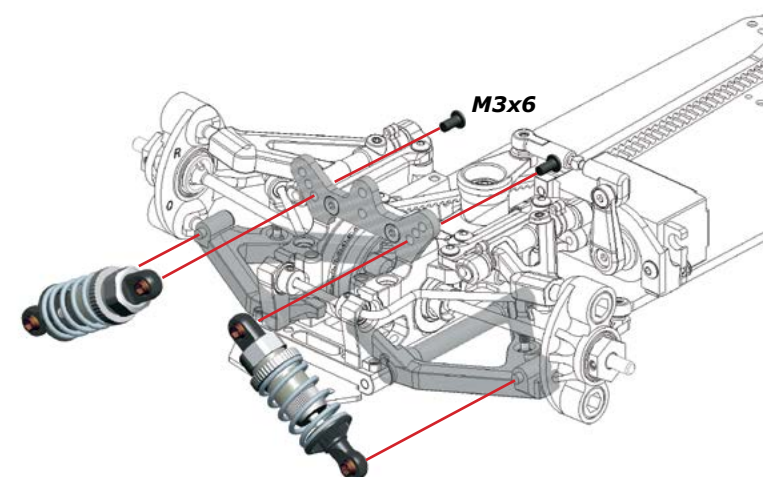



STEP  
18

20.2

20.1

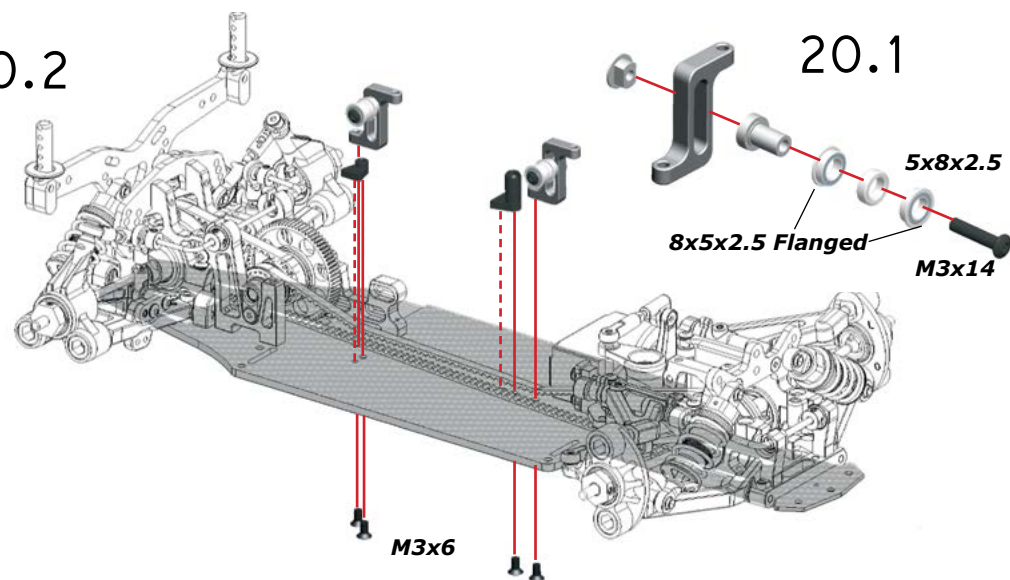

STEP  
19

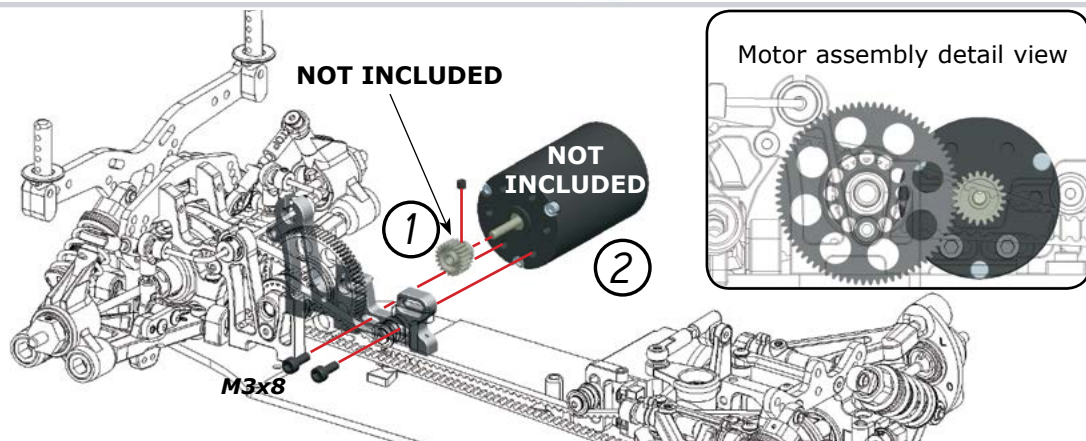

STEP  
20

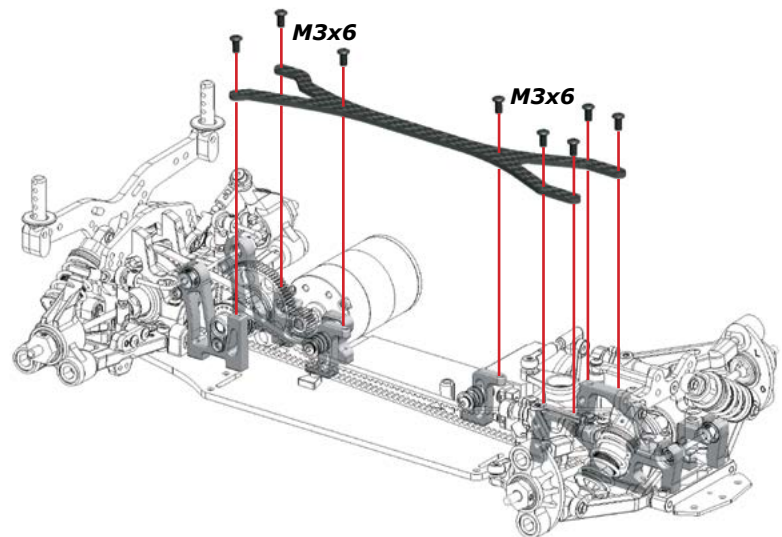

STEP  
21

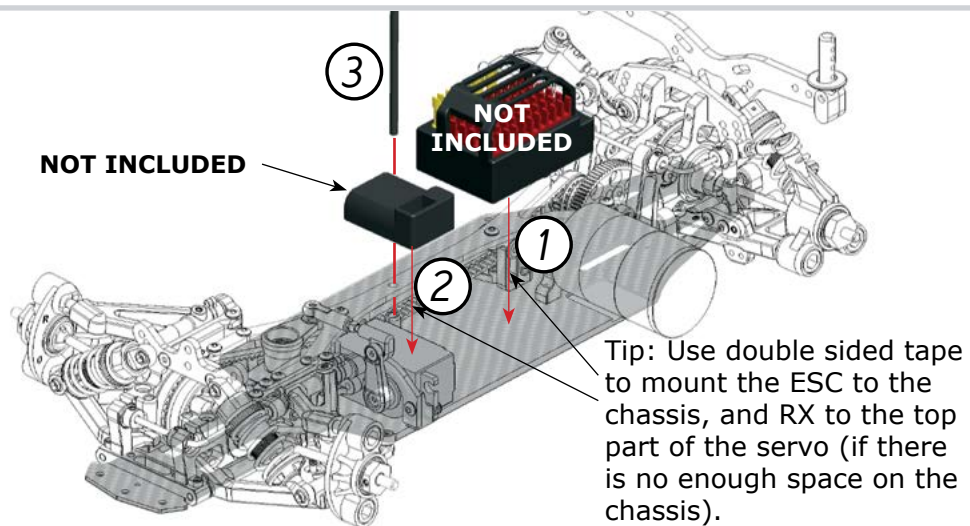

247  
ELECTRIC POWERED

Page  
8

STEP  
22

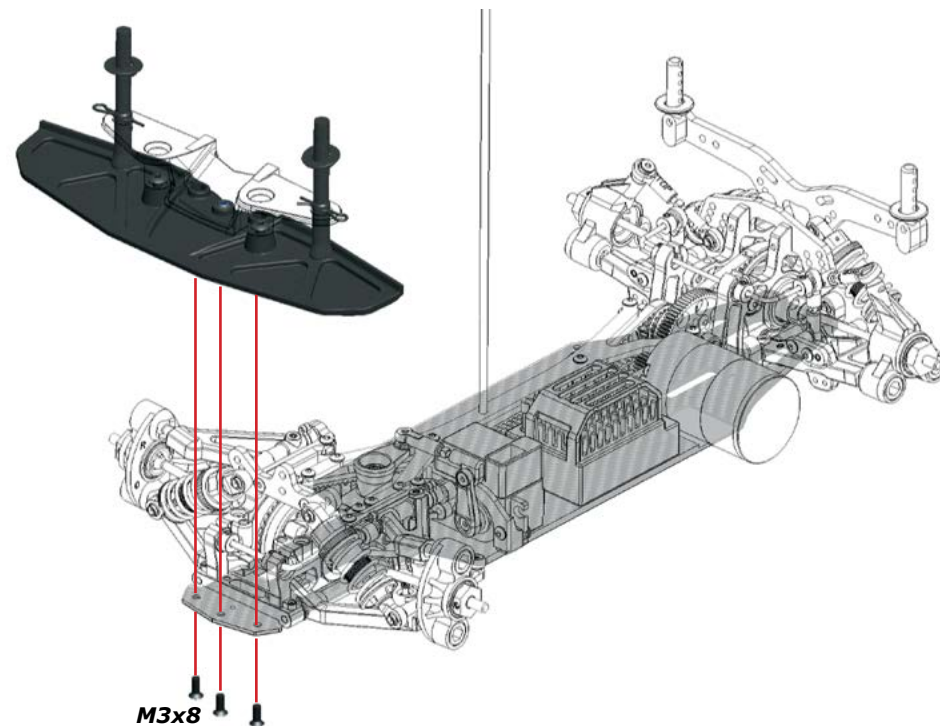

STEP  
23

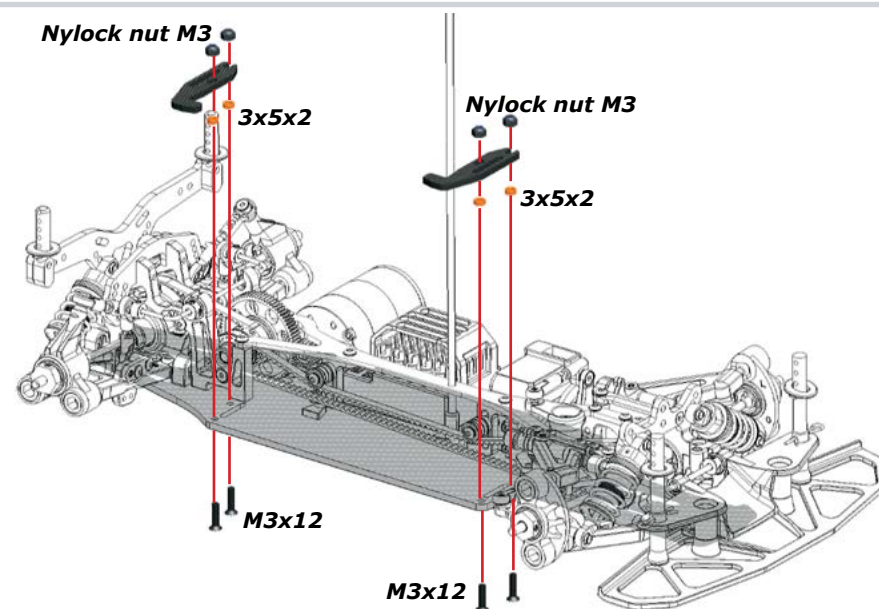

STEP  
24

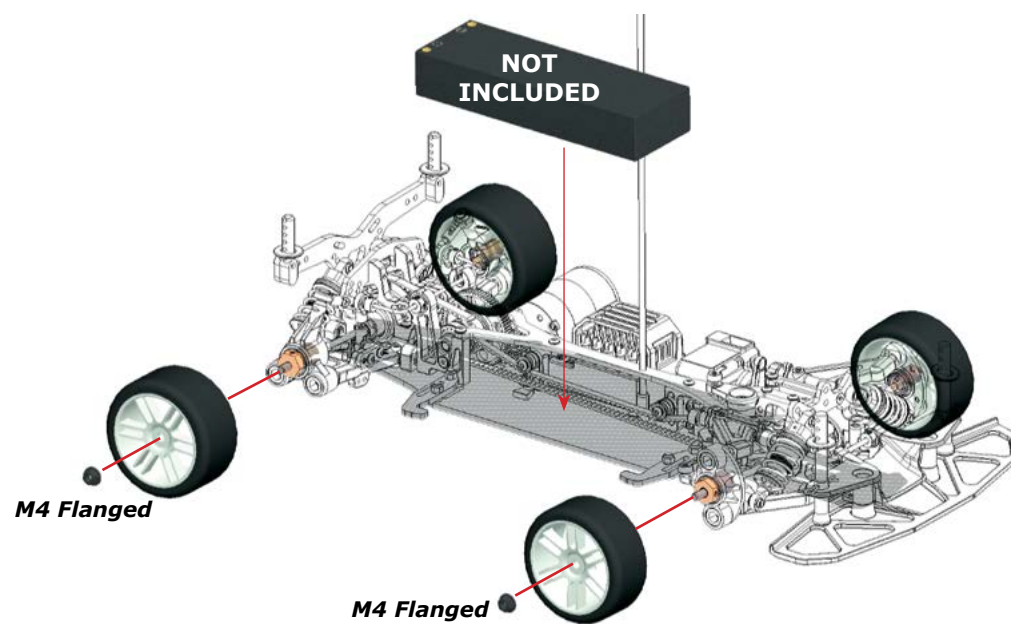

247  
ELECTRIC POWERED

Page  
9



# EXPLODED VIEW CONVERSION KIT

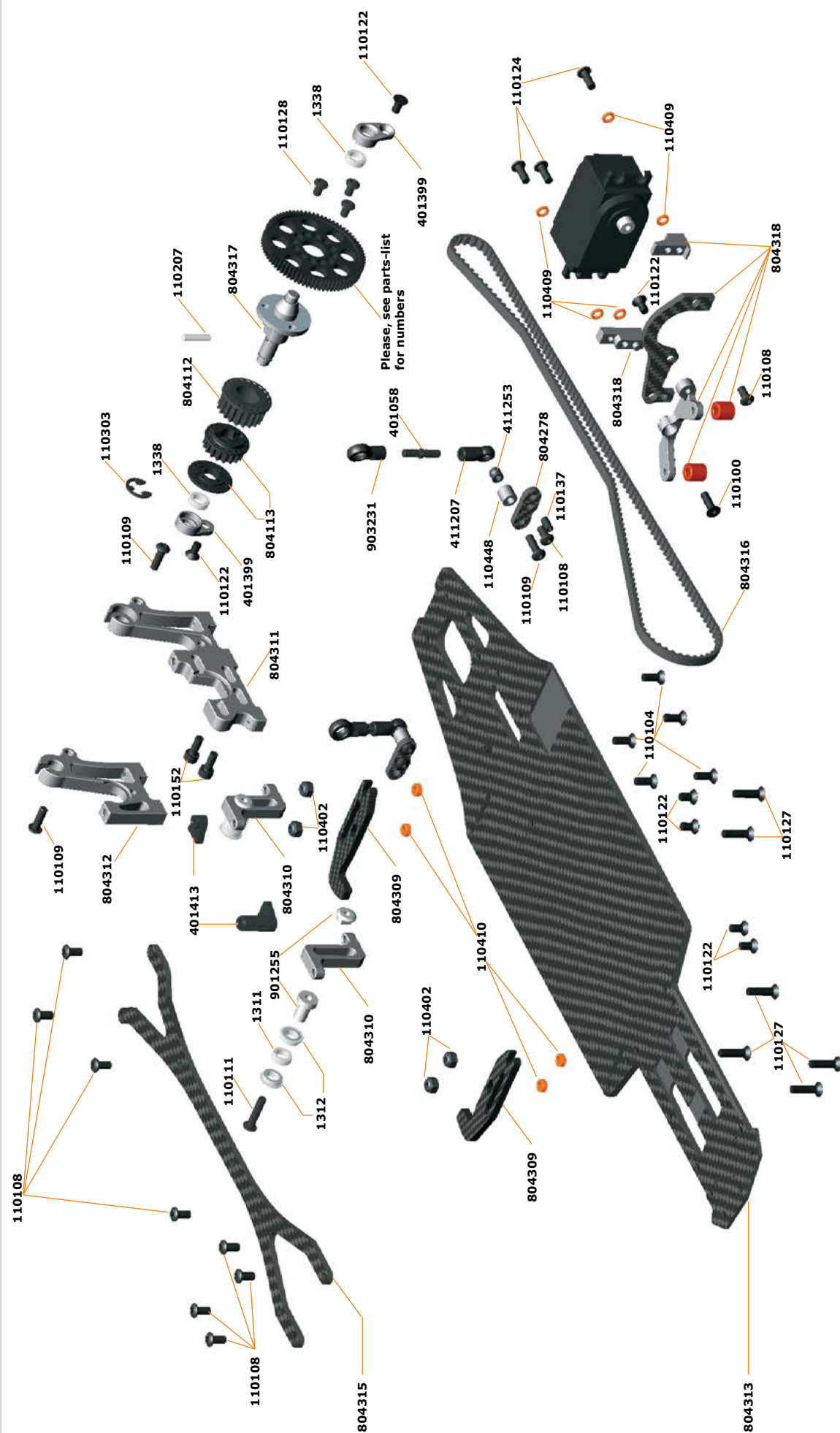

# PARTS-LIST CONVERSION KIT

Part no	Description
110448	Shim 3x6x6 (10)
401058	Rod threaded arb L/R 16mm (4)
401399	Bearingmount middleshaft alu
411157	Screw allen countersunk M3x10 (10)
411207	Balljoint 4.5 short (2)
411253	Pivotball uni 4.5mm (4)
804112	Pulley 2sp shaft 20+21T (2)
804113	Pulley middle 18+21T (2)
804278	Anti-rollbar bracket carbon RR (2)
804309	Batterymount Carbon 747E
804310	Belt tensioner bracket 747E (2)
804311	Bracket middleshaft L 747E
804312	Bracket middleshaft R 747E
804313	Chassis carbon 747E
804315	Topdeck carbon 747E
804316	Belt 40S3M516 low friction
804317	Midshaft 747E
804318	Servomount set 747E
901255	Belt tensioner shaft and nut
901255	Belt tensioner shaft and nut
903231	Ball-joints frame 14+6+2

## Spur gears

120015	Spur gear 48P / 69T
120016	Spur gear 48P / 72T
120017	Spur gear 48P / 75T

## Pinions

120155	Motor-pinion alu hard	48P / 17T
120156	Motor-pinion alu hard	48P / 18T
120157	Motor-pinion alu hard	48P / 19T
120158	Motor-pinion alu hard	48P / 20T
120159	Motor-pinion alu hard	48P / 21T
120160	Motor-pinion alu hard	48P / 22T
120161	Motor-pinion alu hard	48P / 23T
120162	Motor-pinion alu hard	48P / 24T
120163	Motor-pinion alu hard	48P / 25T
120164	Motor-pinion alu hard	48P / 26T
120165	Motor-pinion alu hard	48P / 27T

# 747<sup>e</sup>

electric powered



[www.serpent.com](http://www.serpent.com) - [info@serpent.com](mailto:info@serpent.com)



Manual / ref guide 747e conversion kit version 1