



RRS system set 411 # 401618

Team Serpent is proud to introduce the new **RRS System** for the S411 ERYX platform. The **Serpent RRS System** brings a new dimension to setup providing an active toe-in in the rear. It allows to run less static toe-in and still have a good traction coming out of the corner. The amount of toe-change over the suspension travel is fully adjustable even having the possibility of no toe-in change in droop and still have a toe-in raise under compression.

To understand fully the effects we have added a graphic at the end of this manual.

Enjoy racing!
Team Serpent

STEP
1

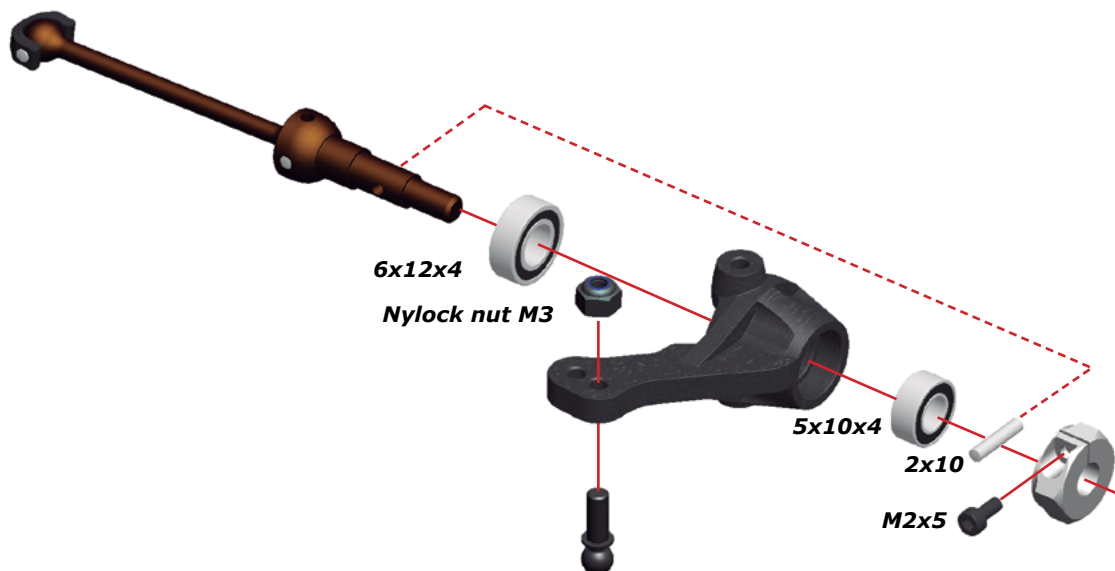

STEP
2

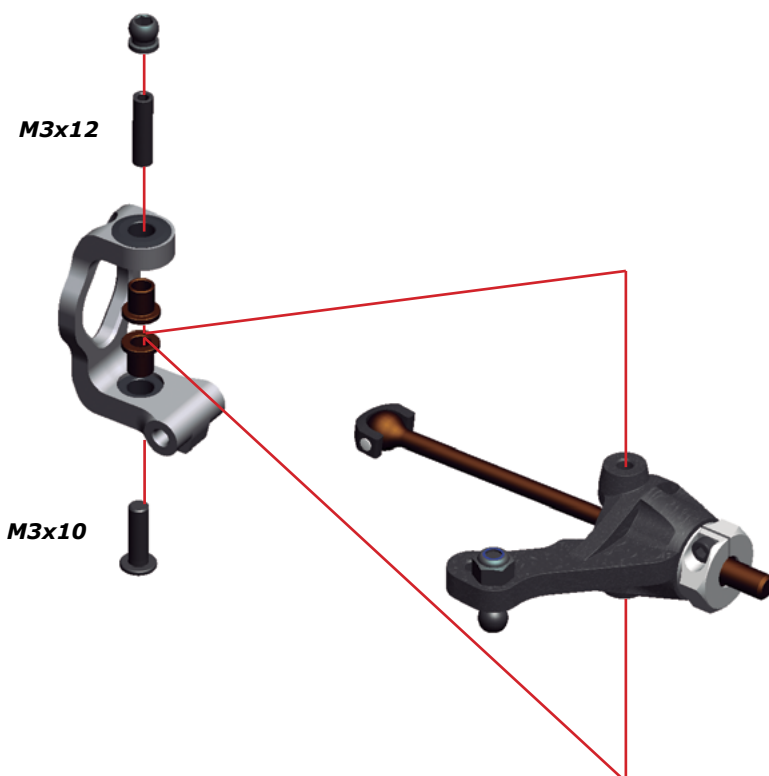

STEP
3



STEP
4

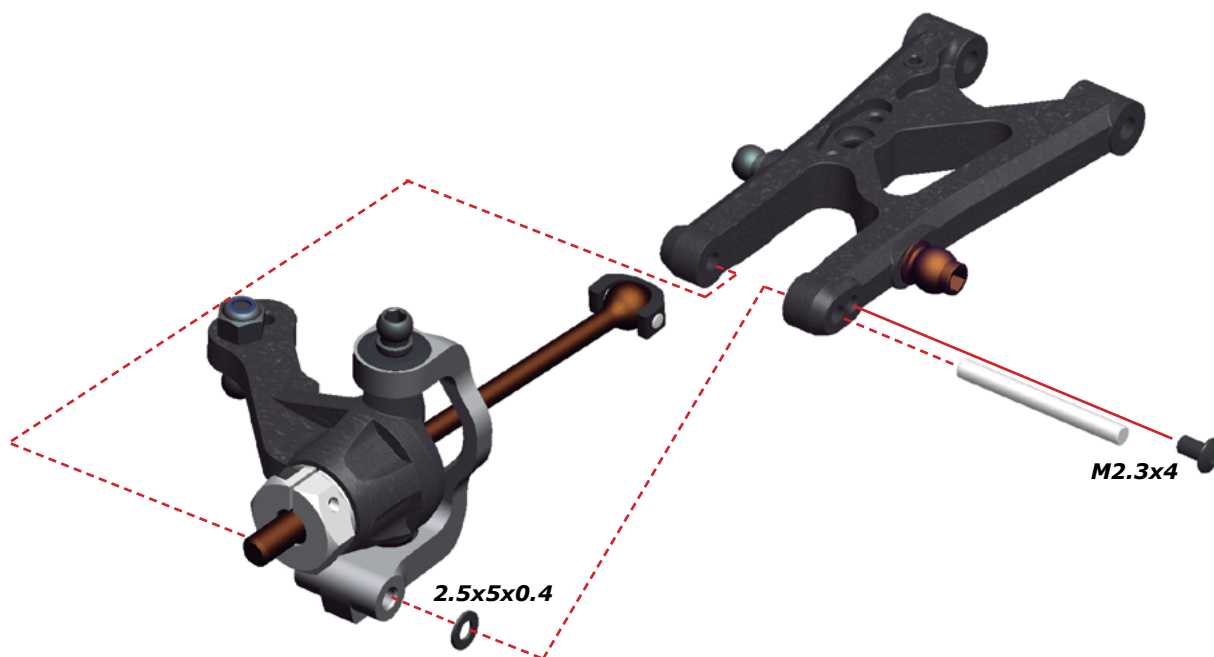

STEP
5

5.1

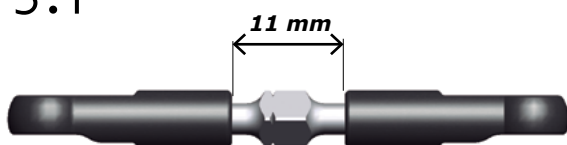

5.2



6.1

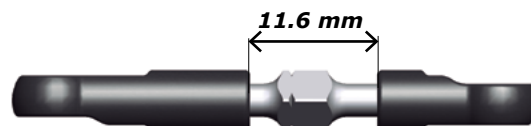
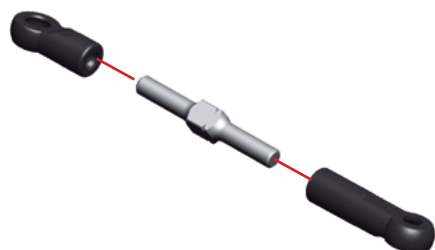

6.2

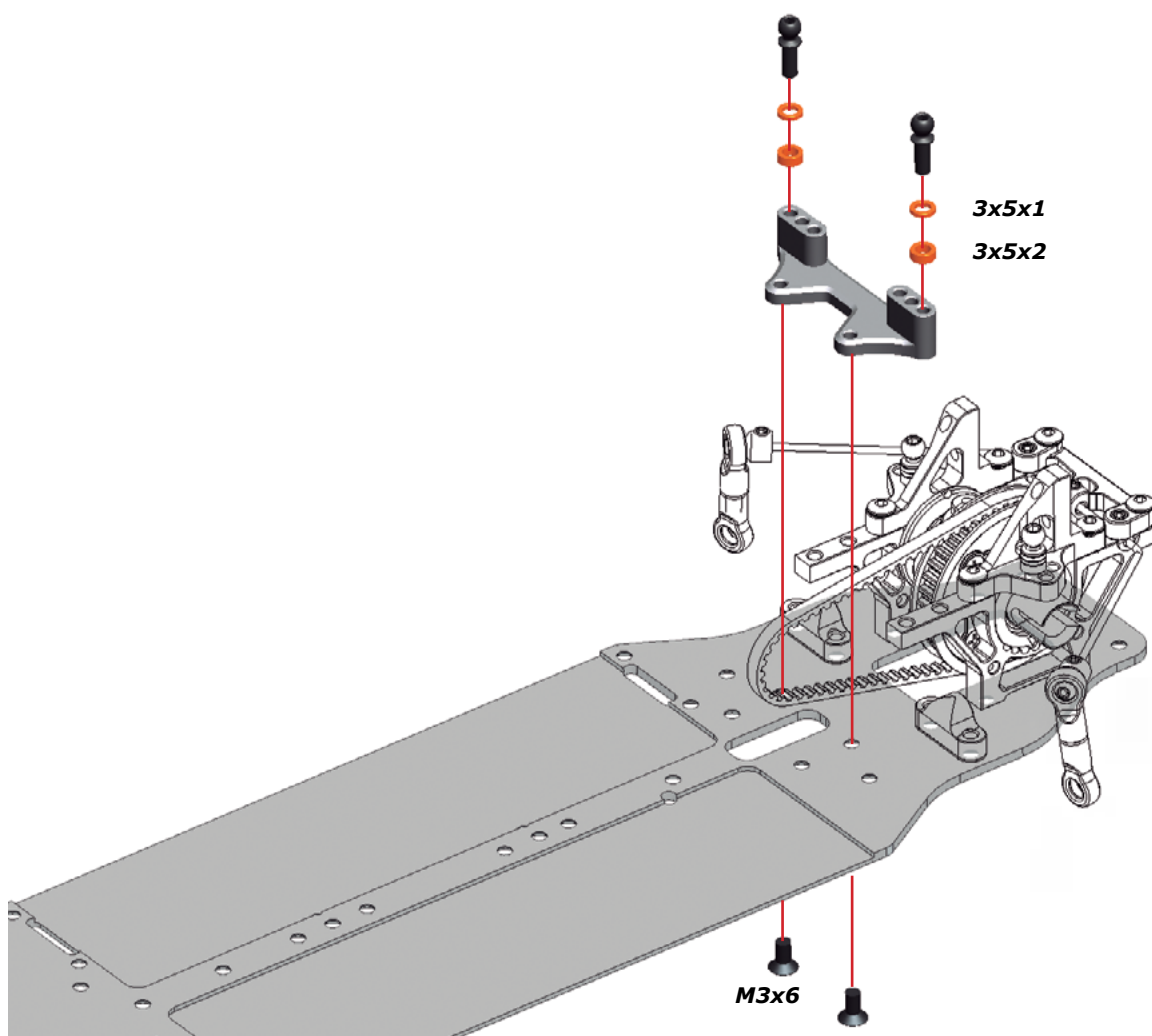
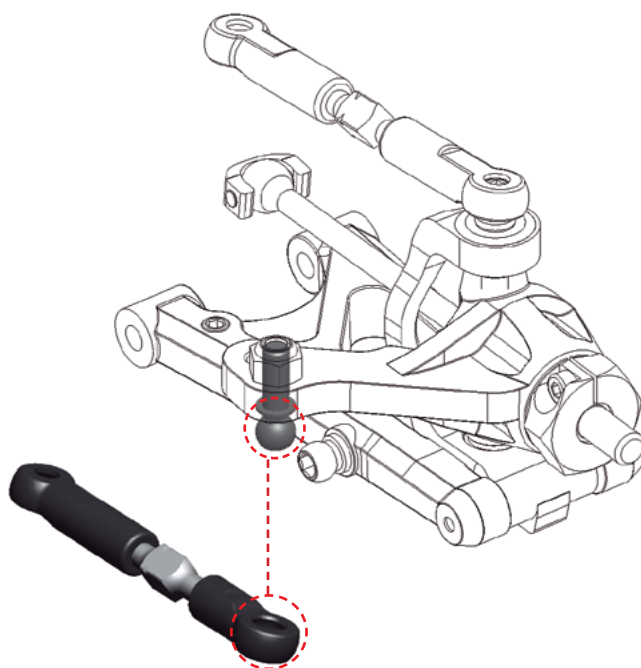

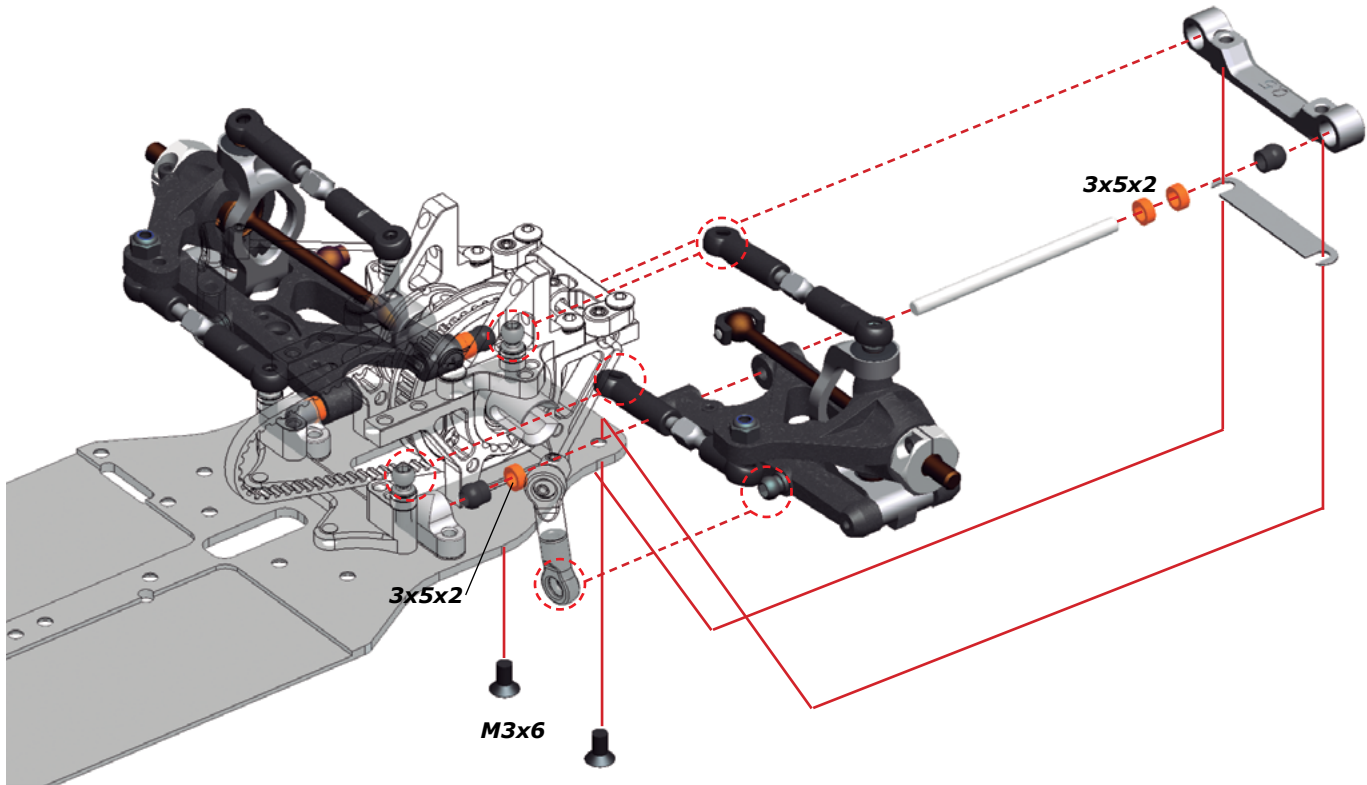

SETUP OPTION 1
 RRS BRACKET HOLE: INNER, MIDDLE AND OUTSIDE

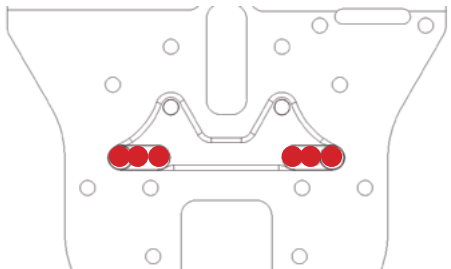

SETUP OPTION 2
 RRS BRACKET PIVOTBALL HEIGHT: mm SHIMS

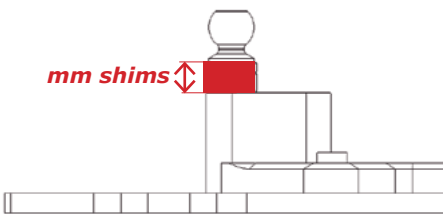

INNER HOLE

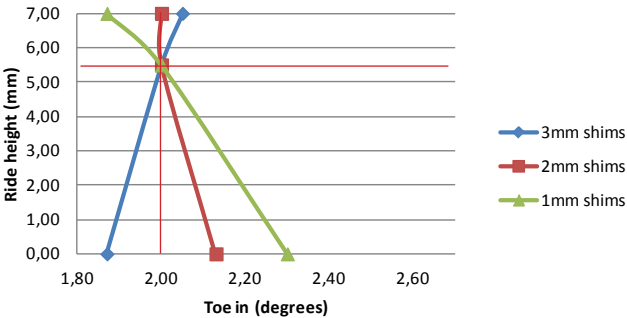

MIDDLE HOLE

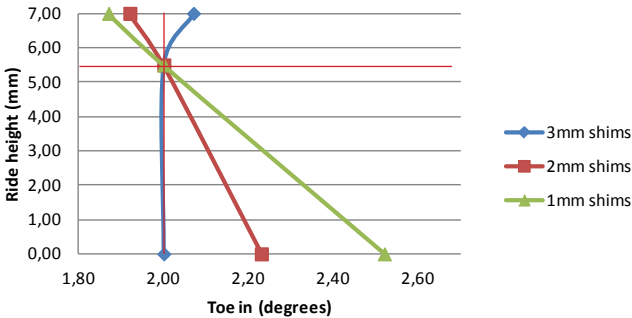

OUTSIDE HOLE

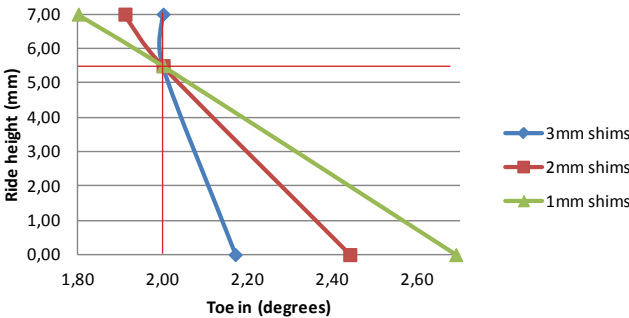

RRS system set Exploded View

