



# INSTRUCTION MANUAL

& REFERENCE GUIDE



The Serpent S811-B 2.1 Cobra is a complete new platform for the 1/8 scale gas offroad category of racing. The Serpent S811-B 2.1 Cobra is designed to be a world champion, while still being easy to use, assemble, and set up. You are now part of the worldwide network of Serpent drivers, which gives you superior technical support and access to many benefits that only Serpent drivers can enjoy.

The Serpent S811-B 2.1 Cobra offers state of the art specifications and leads the way in 1/8 scale gas offroad chassis design, using all the knowledge our designers have gathered from racing offroad cars for over 15 years, into this design too. Continuously pushing the performance envelope, Serpent's engineers have added many new and innovative features that help take your Serpent S811-B 2.1 Cobra into the winner's circle. Designed, tested and raced by Billy Easton, USA. World Champion.

## INSTRUCTIONS

Serpent's long tradition of excellence extends to the instruction manuals, and this instruction manual is no exception. The easy-to-follow layout is richly illustrated with 3D-rendered full-color images to make your building experience quick and easy. Following the instructions will result in a well-built, high-performance race-car that will soon be able to unleash its full potential at the racetrack.

This instruction manual has been divided into sections that will logically lead you through the assembly process of your Serpent S811-B 2.1 Cobra. Follow the assembly steps in the order presented to ensure that no problems occur during assembly.

Each step indicates all the fasteners, bearings and small parts used.

Bag numbers identify the kit bag(s) that contains the appropriate parts.

## EXPLODED VIEWS AND PARTS LIST

The exploded views and parts lists for the Serpent S811-B 2.1 Cobra are included in the back of this manual. The exploded views show all the parts of a particular assembly step along with the Serpent part number. The parts lists indicate the part number and name of each part for easy reference when ordering.

The printed instruction manual included with your Serpent S811-B 2.1 Cobra kit is very complete, though due to continuous product development, more up-to-date information may be provided at our **Serpent.com** website.

All information about the Serpent S811-B 2.1 Cobra is accessible from the Serpent S811-B 2.1 product page which can be found on Serpent.com and can be accessed by simply typing **serpent.com/600014** into your web browsers address bar.

From the Serpent S811-B 2.1 product page you will find the very latest information about your Serpent S811-B 2.1: reports by team drivers and other experts, tips and tricks, setups, image gallery and downloadable files including the latest version of the instruction manual will be made available as downloadable PDF-files.

*Team Serpent*



## Safety

Read and take note of the 'Read this First section' before proceeding to assemble the car-kit. This car-kit is intended for persons aged 16 or older.

## Customer service

Serpent has made a strong effort to make this manual as complete and clear as possible. Additional info may be published in our website:

[www.serpent.com](http://www.serpent.com) or you may ask your dealer or the Serpent distributor for advice, or email Serpent direct: [info@serpent.com](mailto:info@serpent.com)  
The Serpent Facebook, Twitter and Youtube pages give additional means of support and communications.

## Instructions, how to use

The kit includes bags, with bagnumbers, which refer to the same step in the manual. Open only the indicated bag(s) per step and finish that part of the assembly. Remaining parts will be needed later on in the assembly process.

## Instructions

Serpent's long tradition of excellence extends to the instruction manuals, and this instruction manual is no exception. The easy-to-follow layout is richly illustrated with 3D-rendered full-color images to make your building experience quick and easy. Following the instructions will result in a well-built, high-performance race-car that will soon be able to unleash its full potential at the racetrack.

## SETUP

In certain assembly steps you need to make basic adjustments, which will give you a good initial setup for your car. Fine-tuning the initial setup is an essential part of building a high-performance racecar.







## Exploded views and partslist

The exploded views and parts lists for the Serpent S811-B 2.0 are presented in the Reference Guide section in the back of this manual. The exploded views show all the parts of a particular assembly step along with the Serpent part number. The parts lists indicate the part number and name of each part for easy reference when ordering.

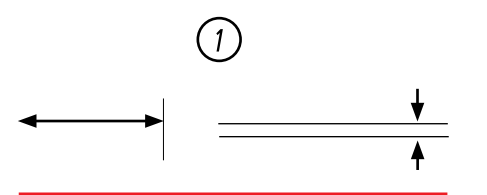
## Read this first!

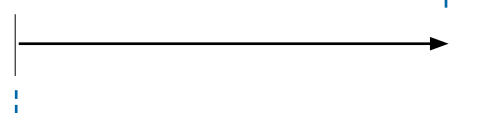
- This is a highly technical hobby product, intended to be used in a safe racing environment. This car is capable of speeds in excess of 80 km/h or 50mph. Please follow these guidelines when building and operating this model.
- Parental guidance is required when the builder/user of this car is under 16.
- Follow the building instructions. If in doubt, contact your dealer or importer.
- Be sure to use the proper tools when assembling the car. Always exercise caution when using electric tools, knives and other sharp objects.
- Be careful when using liquids like lubrication oil, fuel or glue. Do not swallow.
- Follow the manufacturer's instruction in case you experience irritation after using the product.
- Be careful when operating the car. Stay away from any rotating parts such as wheels, gears and transmission. Stay away from motor, engine and exhaust pipe system or speedo during and immediately after use, as these parts may be very hot. We advise to use protective hand gloves.
- Only operate this car in a safe environment, like a special racing track or a closed parking lot. Avoid using this car on public roads, crowded places or near infants.
- Before operating this car, always check the mechanical status of the car. Also check that the transmitter and receiver frequencies correspond and are not used by any other racer at the same time. Check that the batteries of the transmitter and receiver- are fully charged.
- After use, always check all the mechanics of the car. We advise to clean the car immediately after use, and inspect the parts for wear or fractures. Replace when necessary. Do not use water, methanol, thinner or other solvents to clean the car.
- Empty the fuel tank (depending on model) if needed and disconnect the receiver battery.
- Store the car in a dry and heated place to avoid corrosion of metal parts.
- Avoid using this car in wet conditions as the water will cause corrosion on the metal parts and bearings and these parts will cease to function properly. If driven in the wet, ensure that all the electric equipment is waterproofed and after use, that all moving parts are dried immediately.

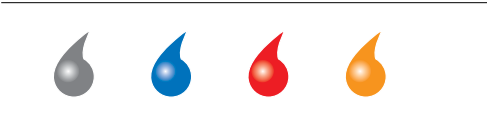
## USING THE MANUAL

	Step number; the order in which you should assemble the indicated parts
	Length after assembly / Gap between two items
	Assembly path of one item into another
	Group of items (within lines) should be assembled first
	Direction the item should be moved
	Glue one item to another
	Press/Insert one item into another
	Connect one item to another
	Apply transmission grease (Grey), threadlock* (Blue), CA glue* (Red) or differential grease (Orange). (*Items not included.)
	Apply silicone oil.

A

1

CENTER  
DIFF  
BAG

# DIFFERENTIAL CENTER

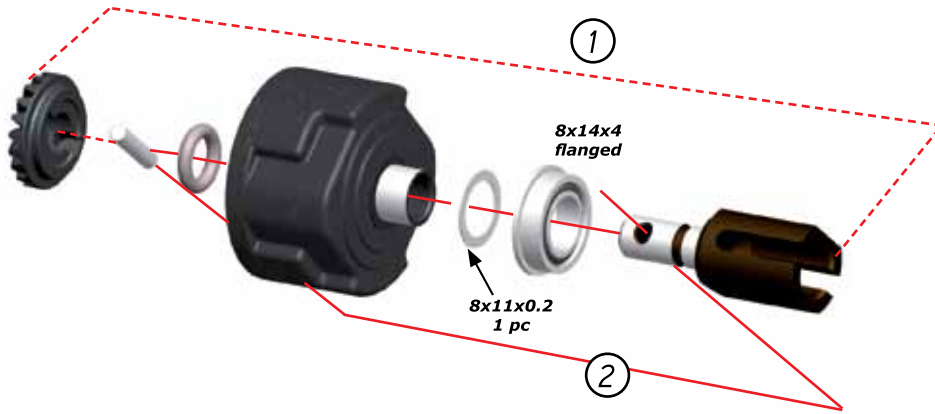

TIP



TIP

add 2mm oil before  
assembling the gear



TIP



A

2

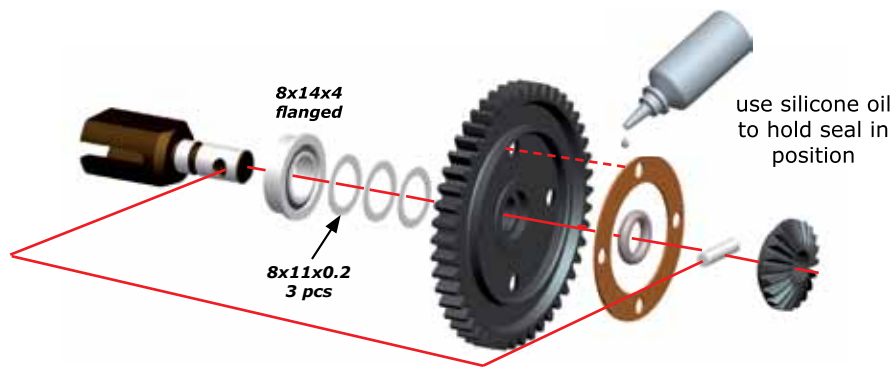

A

3



M3x12

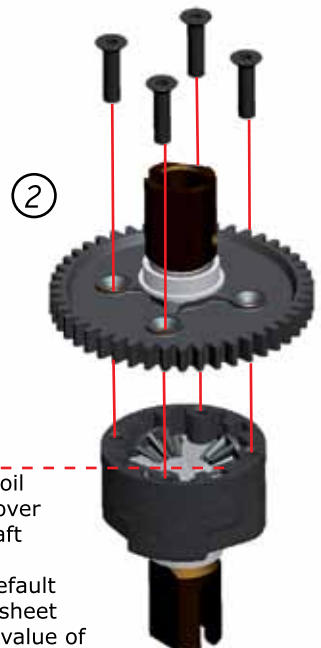

①

silicone oil  
fill just over  
gear shaft

check default  
SET-UP sheet  
for CST value of  
the silicone oil

4

A

4

FR/RR  
DIFF  
BAG

## DIFFERENTIAL FRONT/REAR

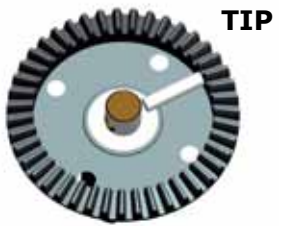
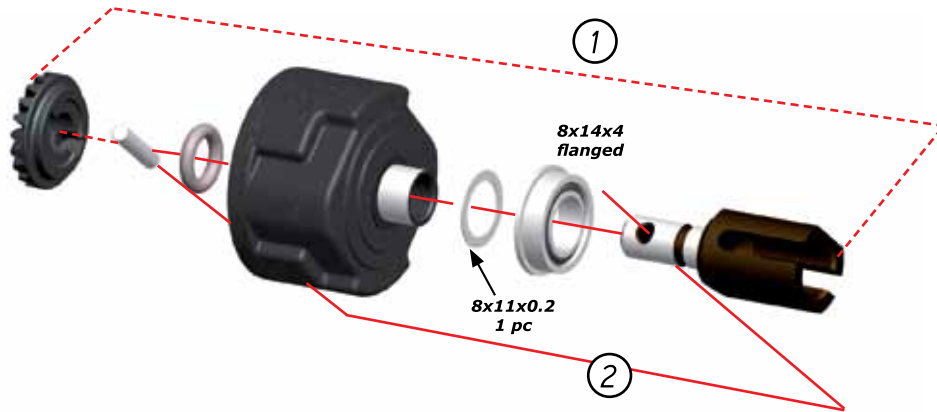

A

5

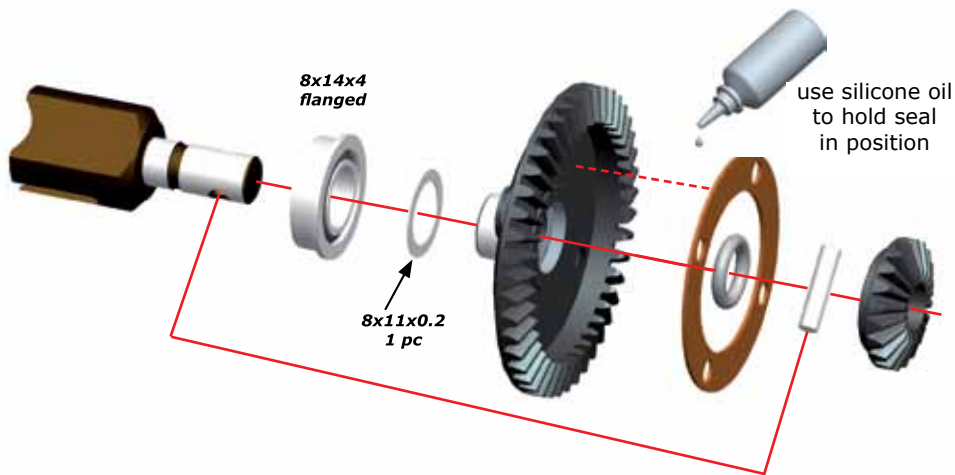

A

6

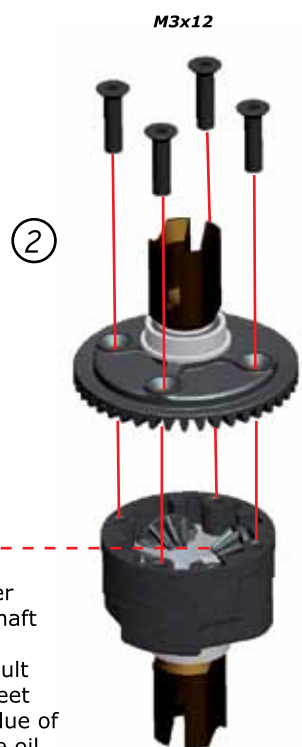

①  
silicone oil  
fill just over  
the gear shaft

check default  
SET-UP sheet  
for CST value of  
the silicone oil



A

7

BAG  
1

# CENTER BRAKE ASSEMBLY

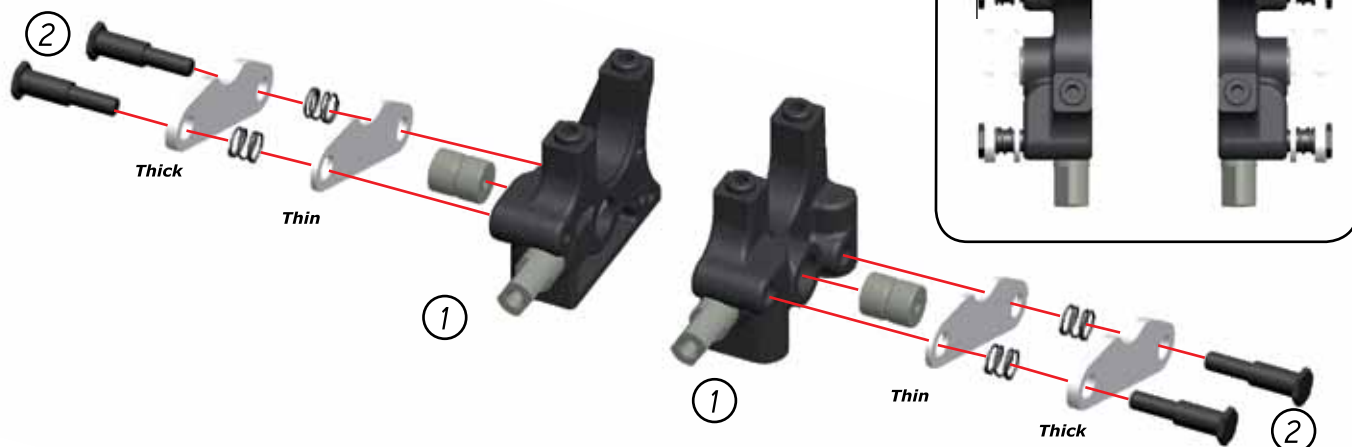

A

8

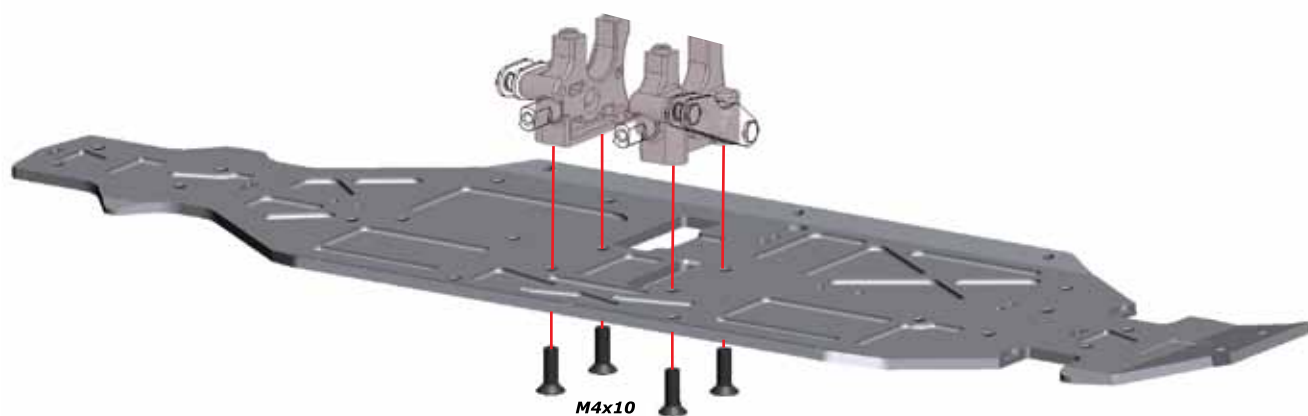

A

9

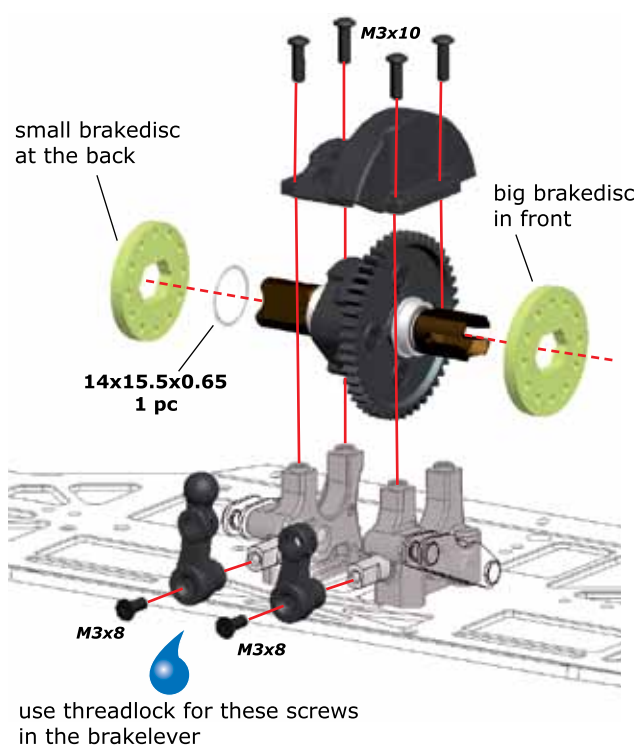

A

10

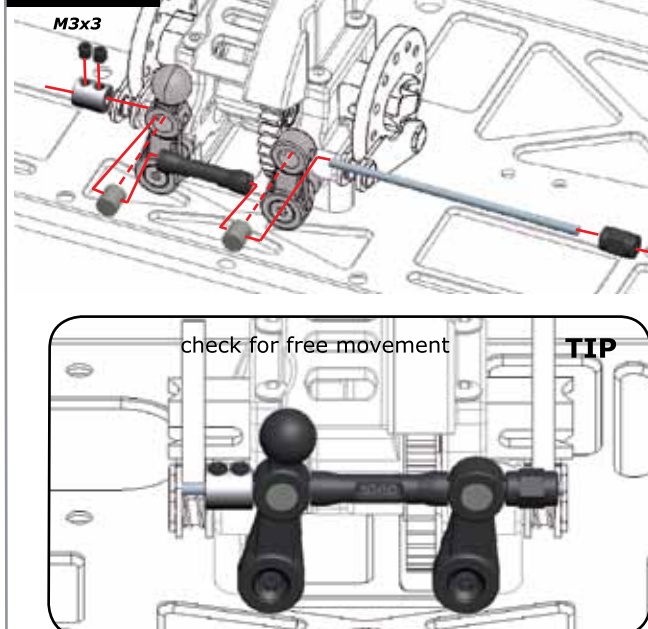

A

11

BAG  
2

# REAR AXLE

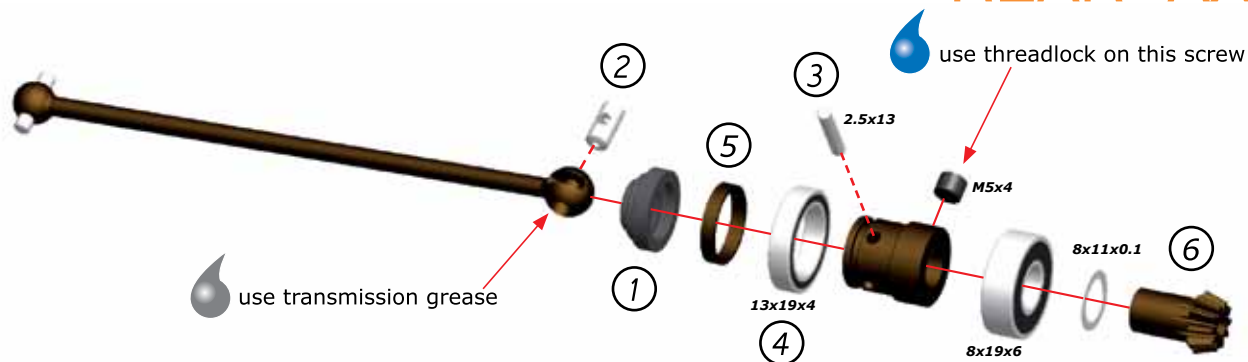

A

12



A

13

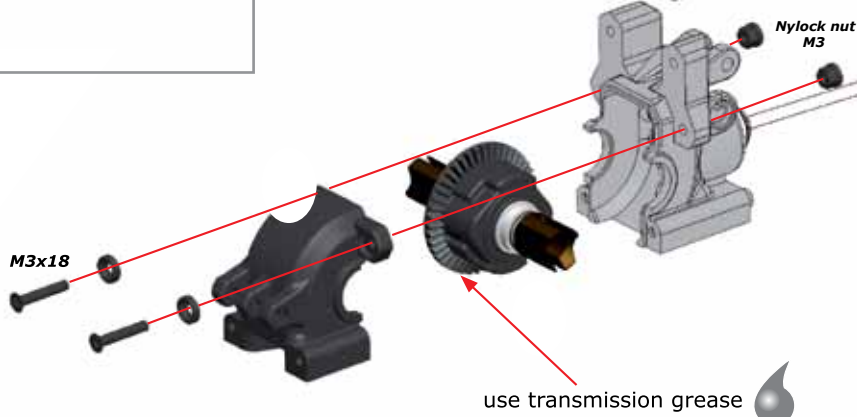
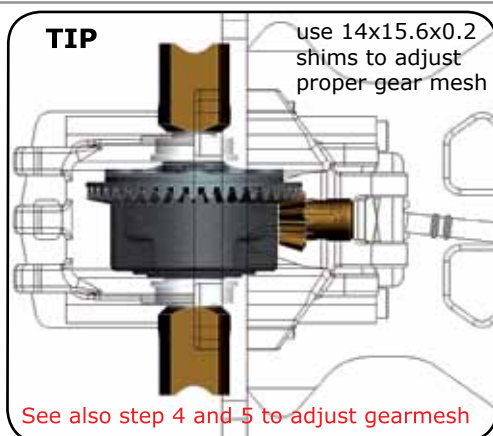

A

14

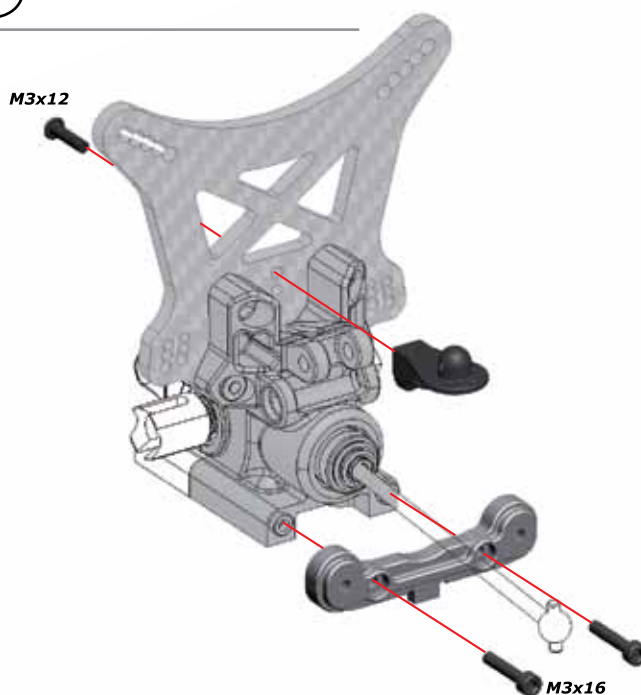

7

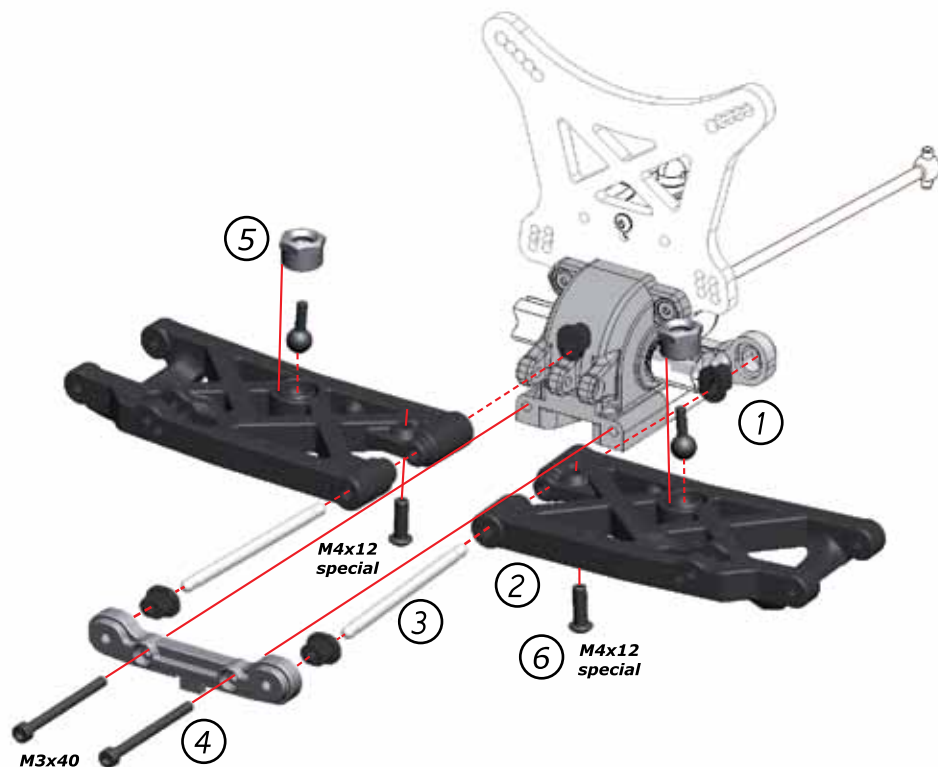

proper insert orientation in the rear bracket, left and right equal type

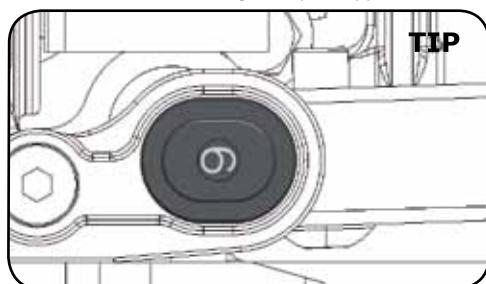

proper insert orientation in the front bracket, left and right equal type

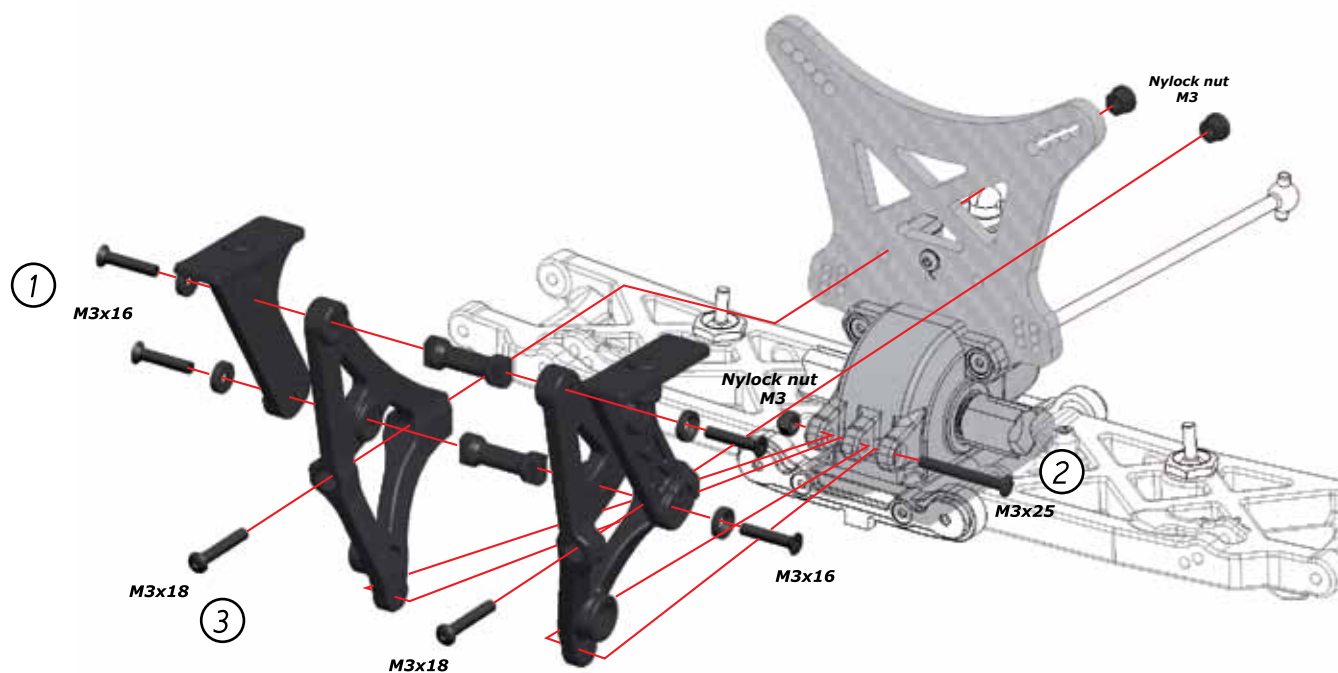
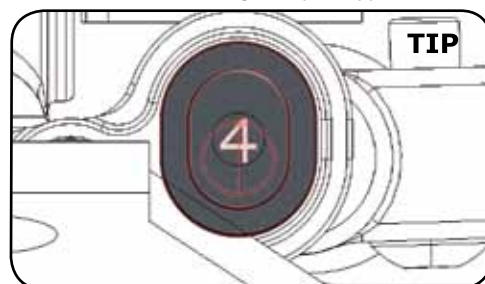



A

17

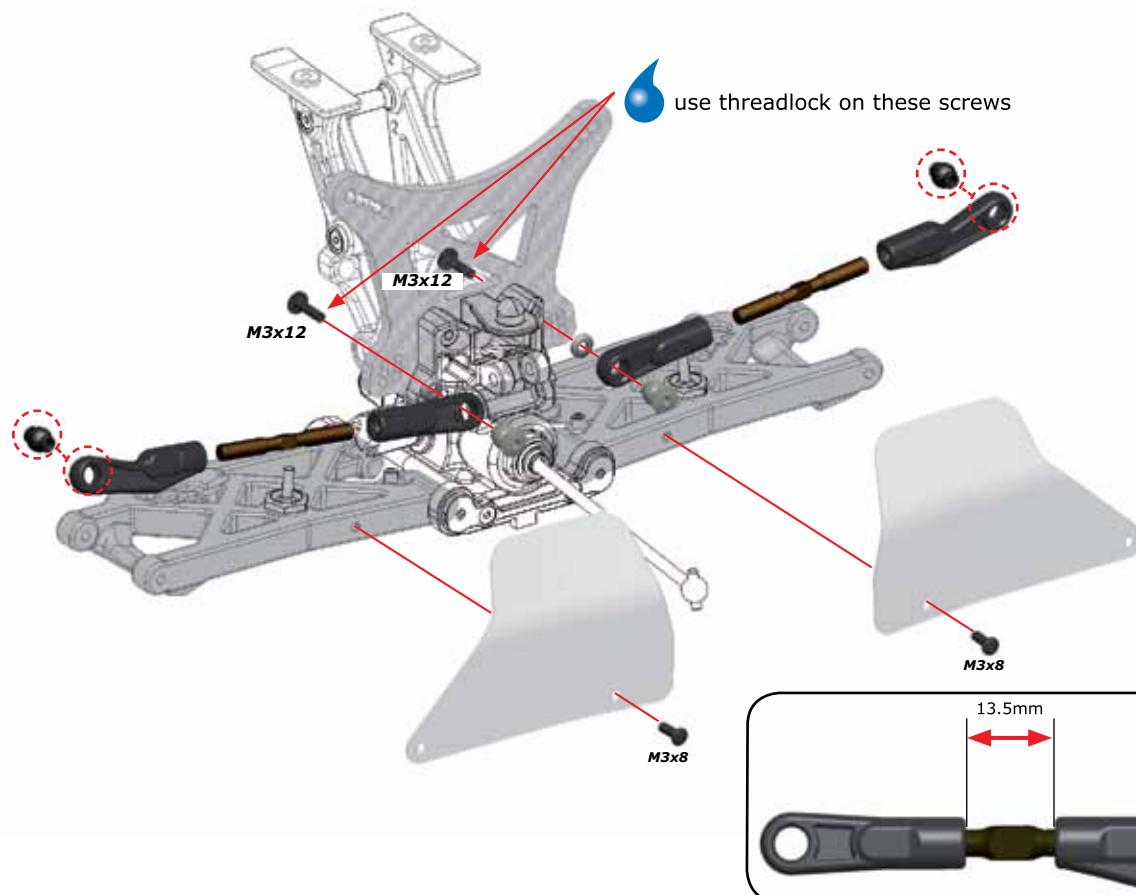

A

18A

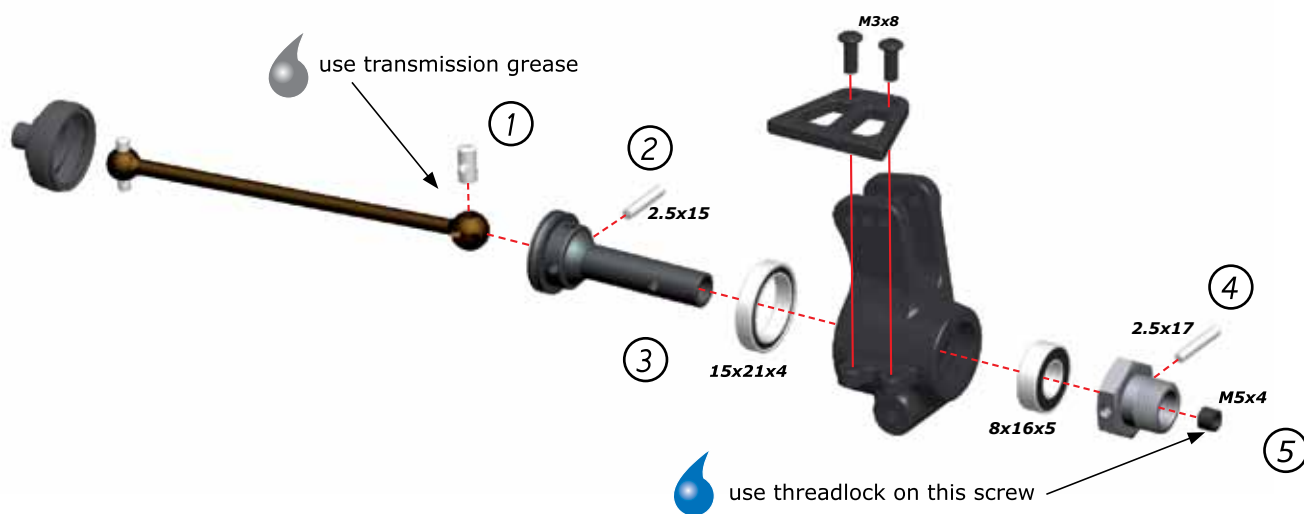
BAG  
4

A

18B

21  
COBBLE

9

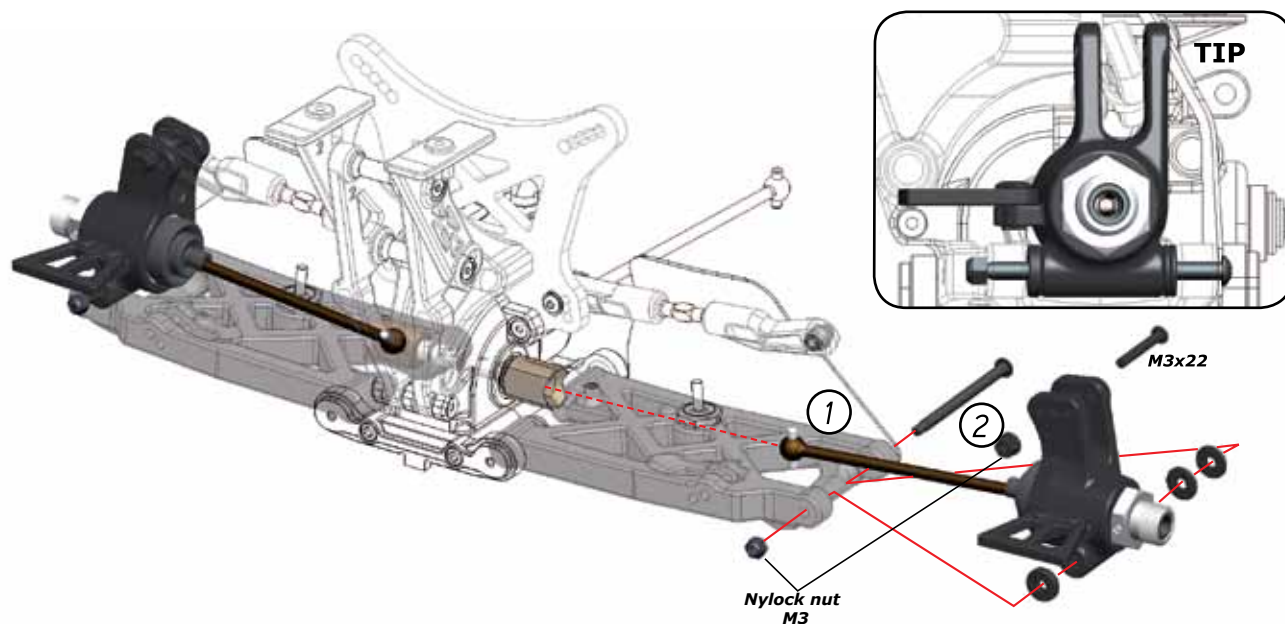

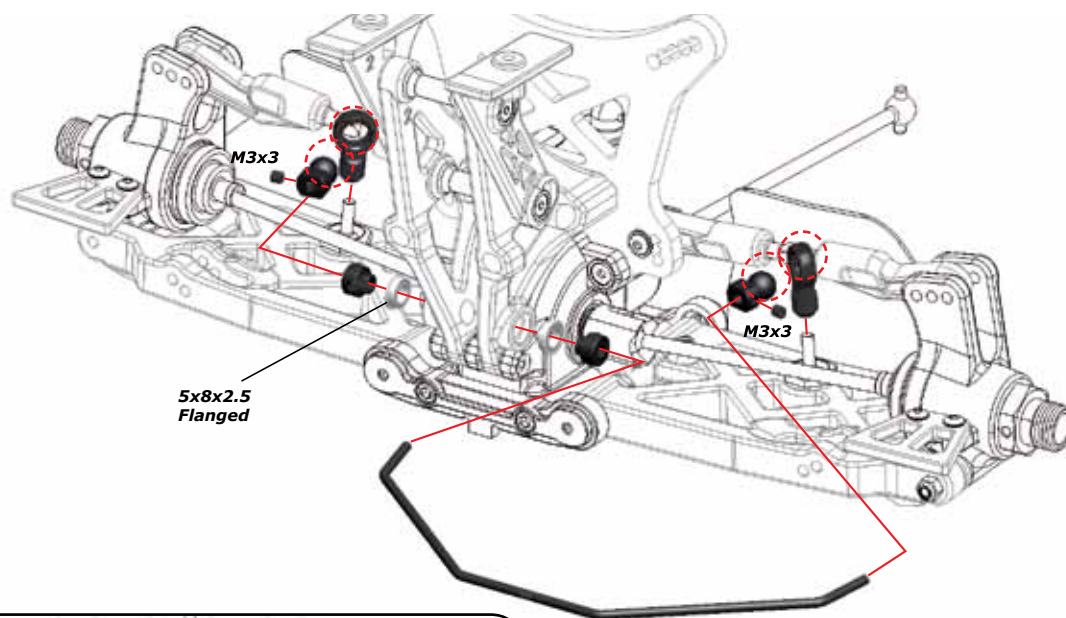
**TIP**

use threadlock on these screws

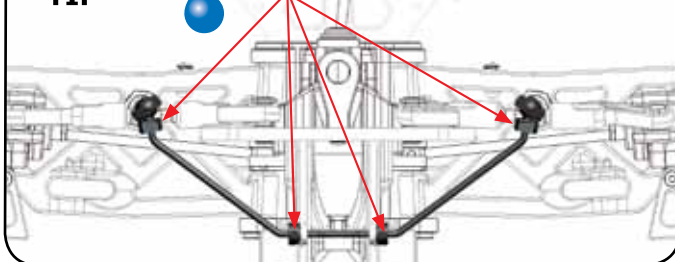
**TIP**

35mm

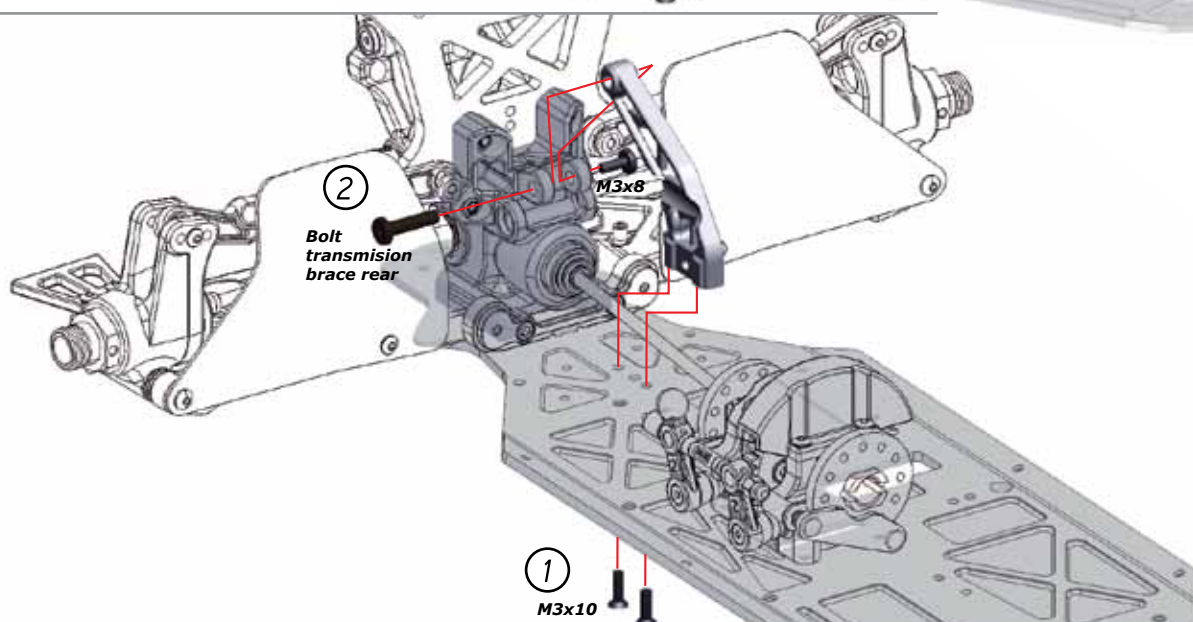
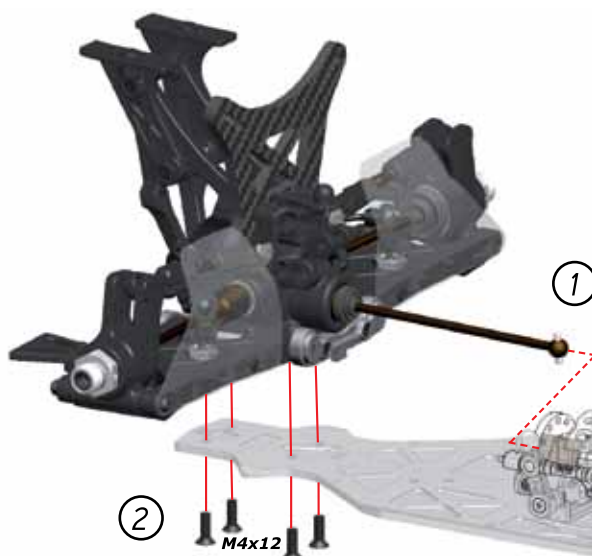
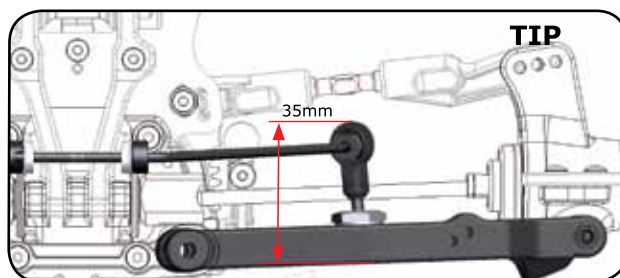

A

22

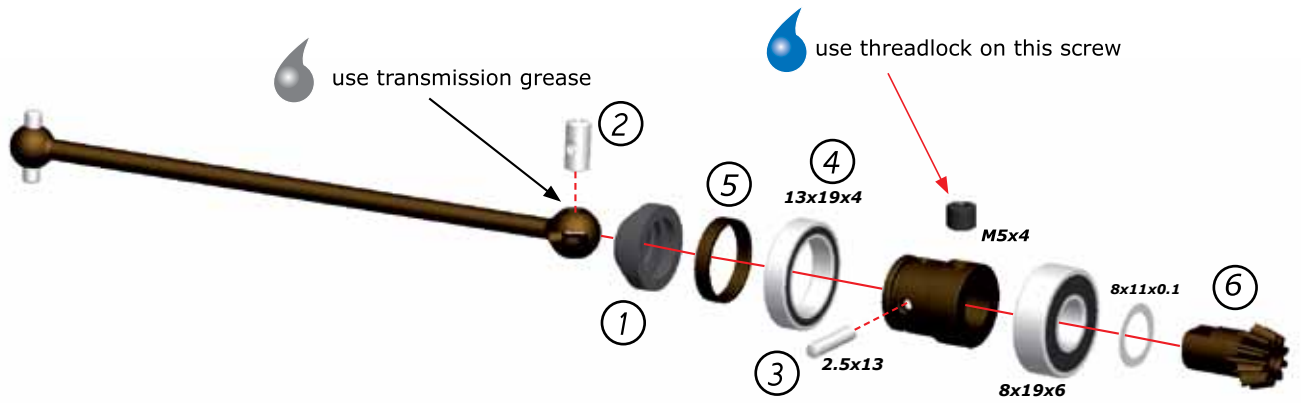
BAG  
5

A

23

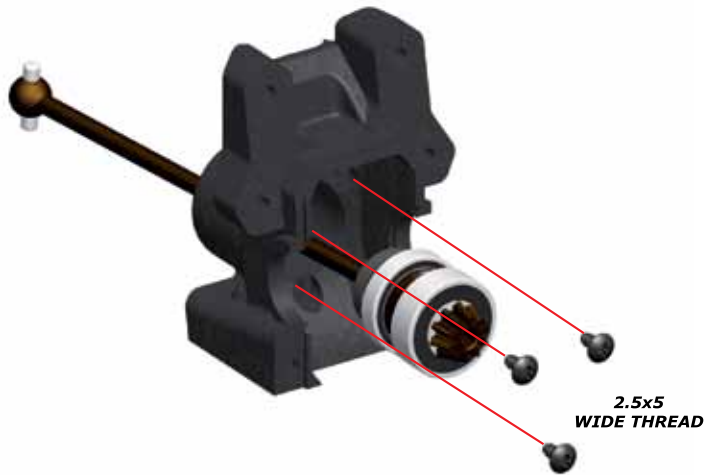
**TIP**

use 14x15.6x0.2  
shims to adjust  
proper gear mesh

See also step 4 and 5 to adjust gearmesh

A

24

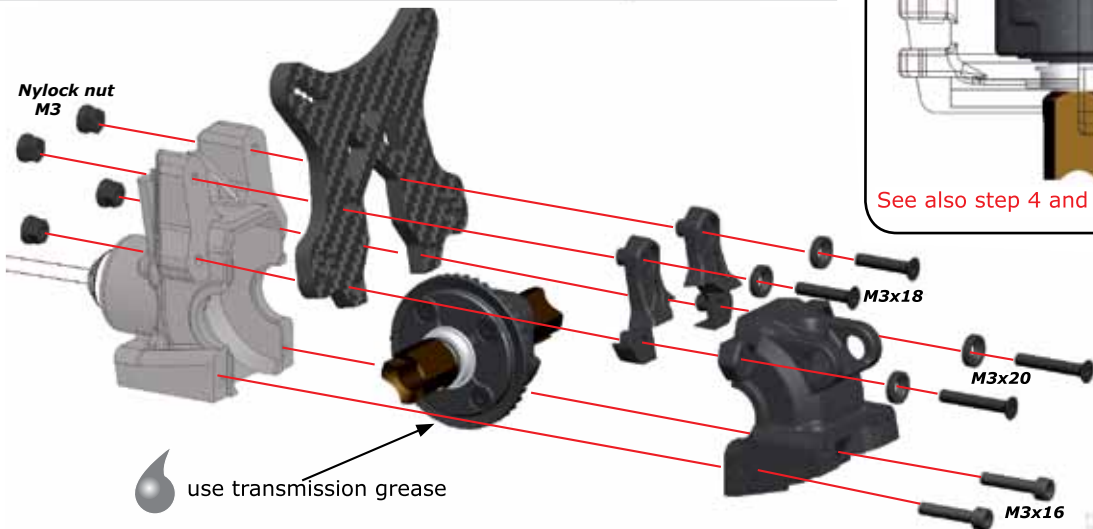

A

25

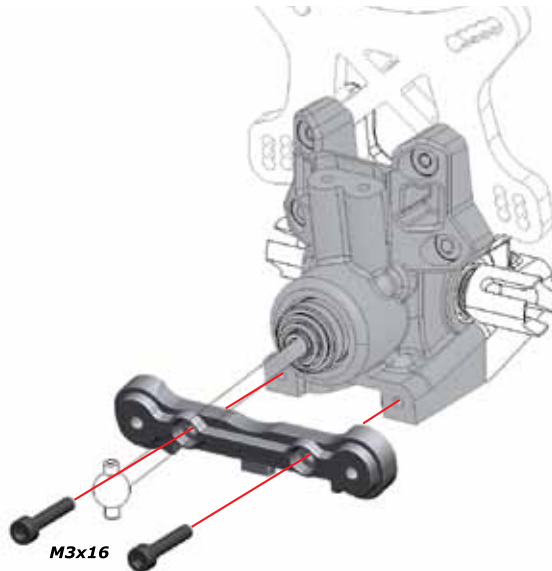



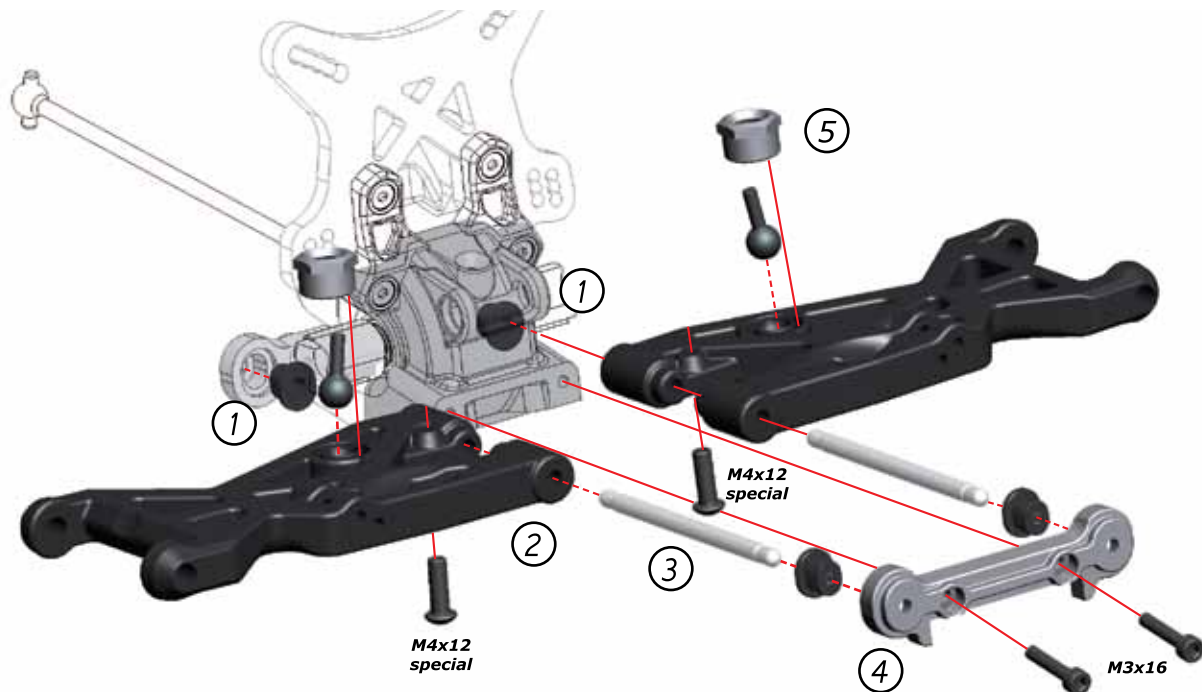

proper insert orientation  
in the rear bracket

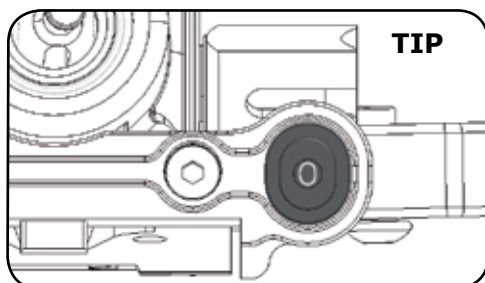

proper insert orientation  
in the front bracket

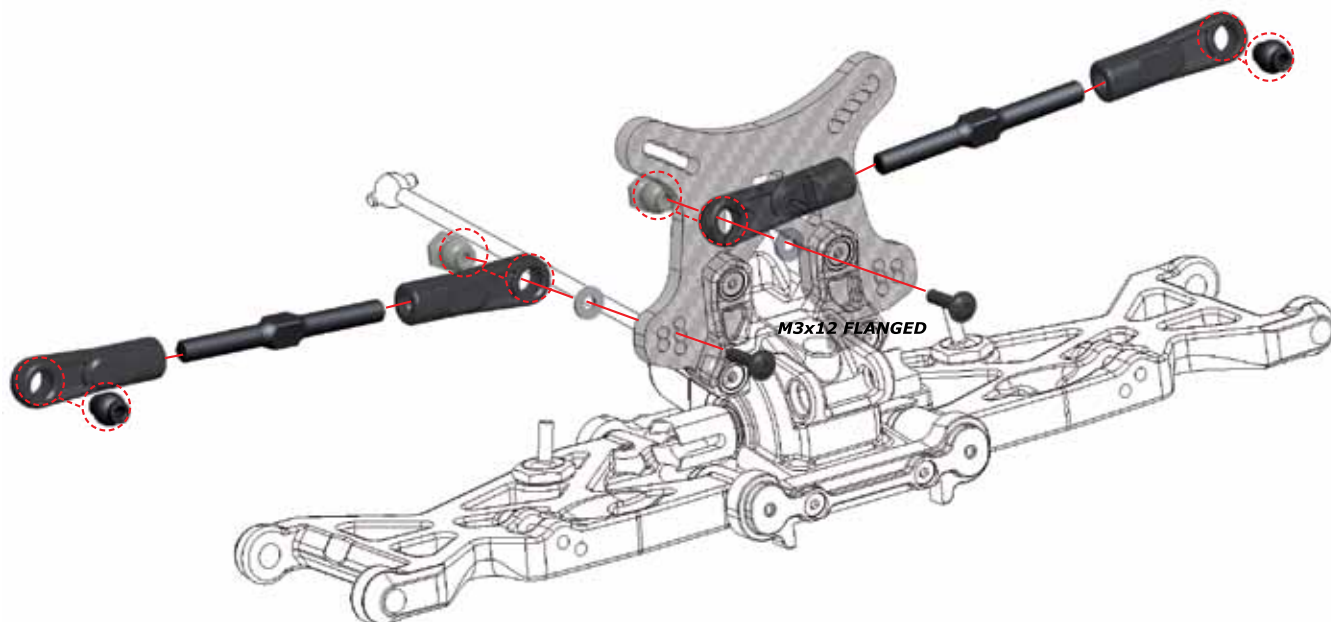
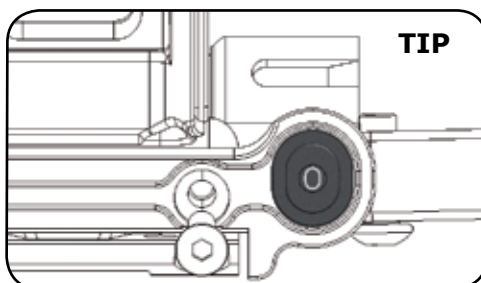

18.0MM

TIP





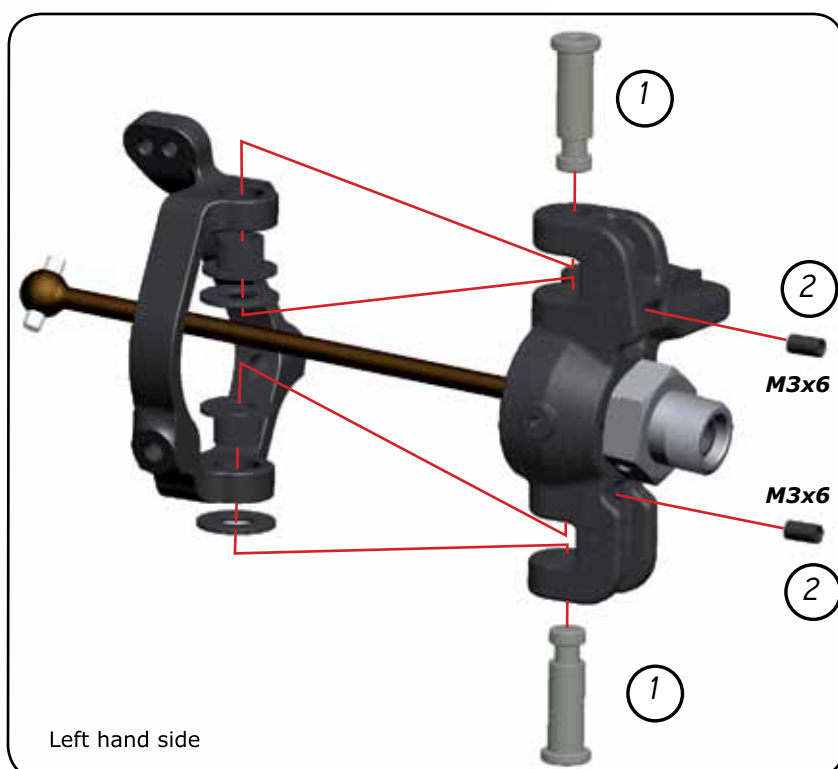
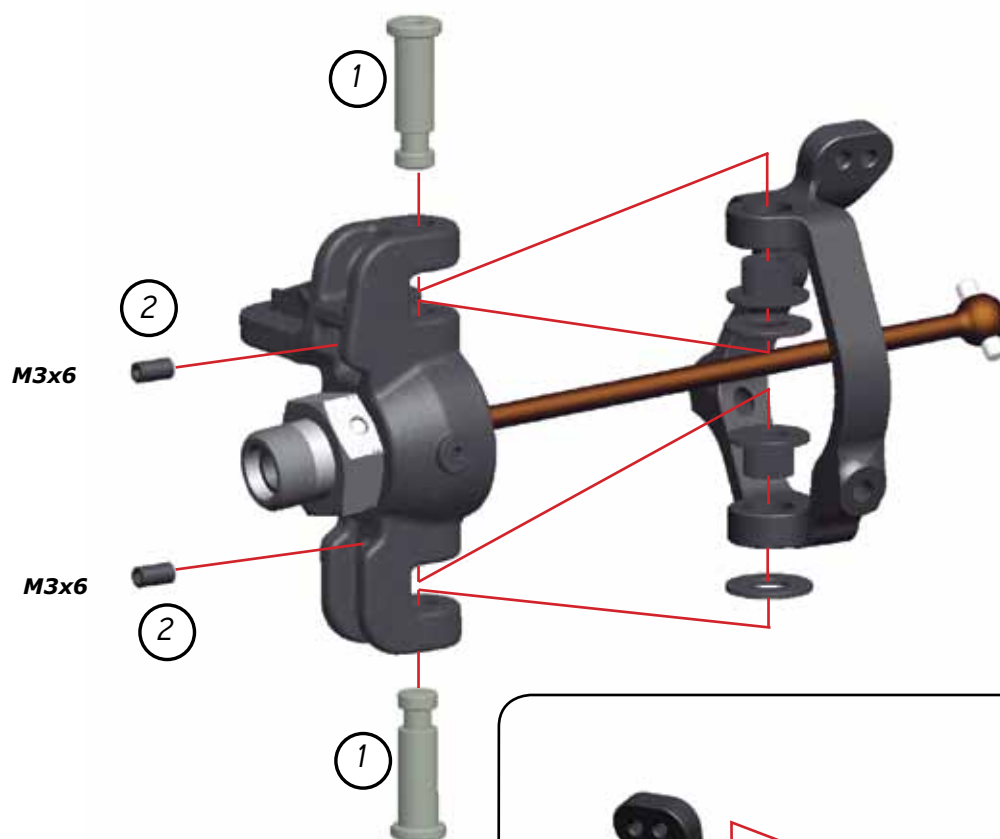
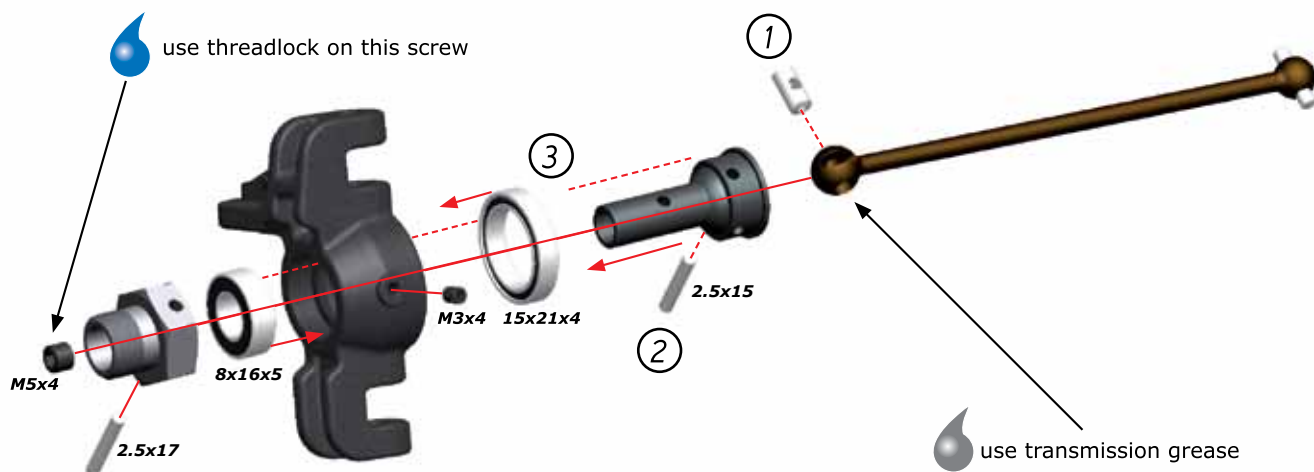

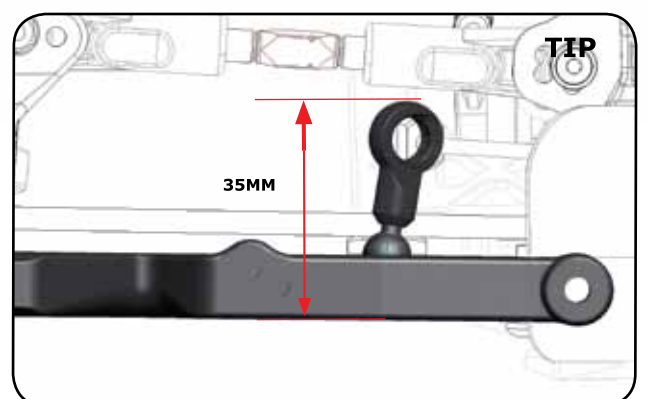
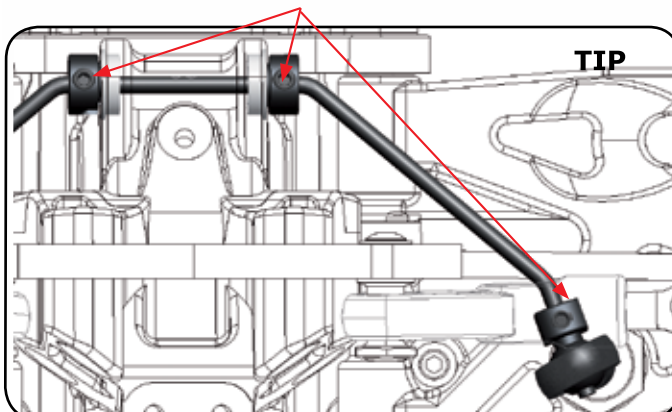
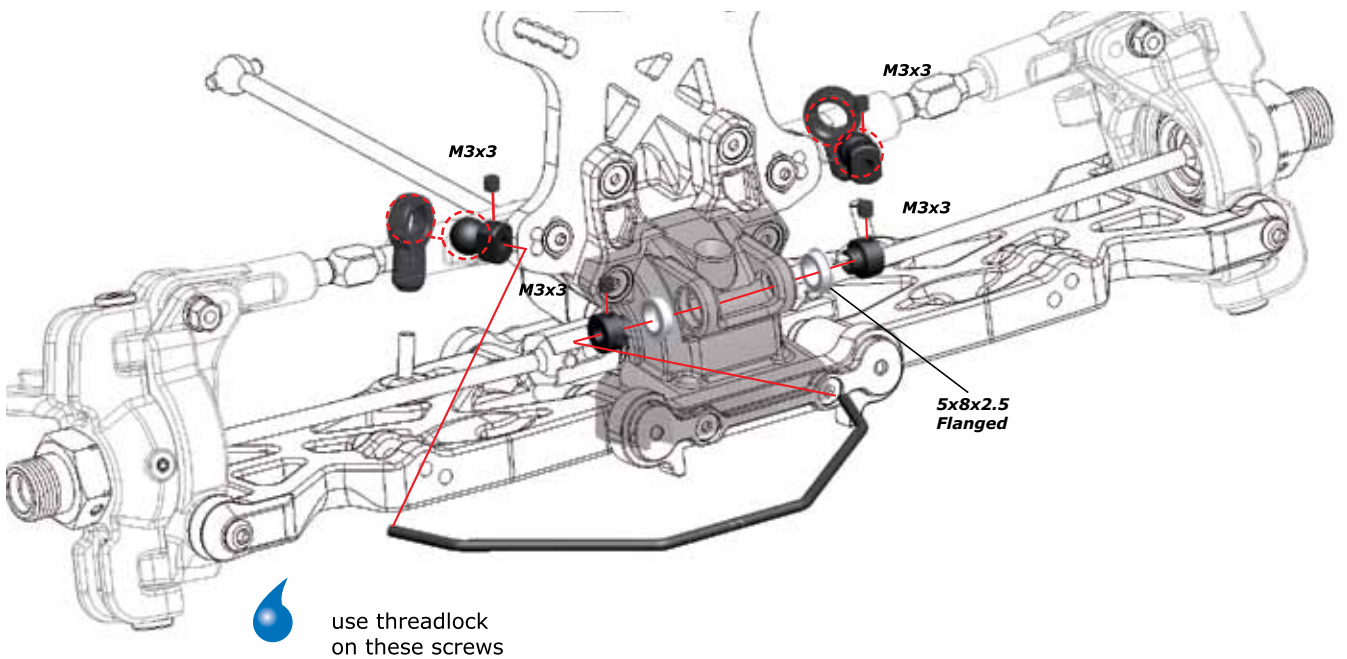
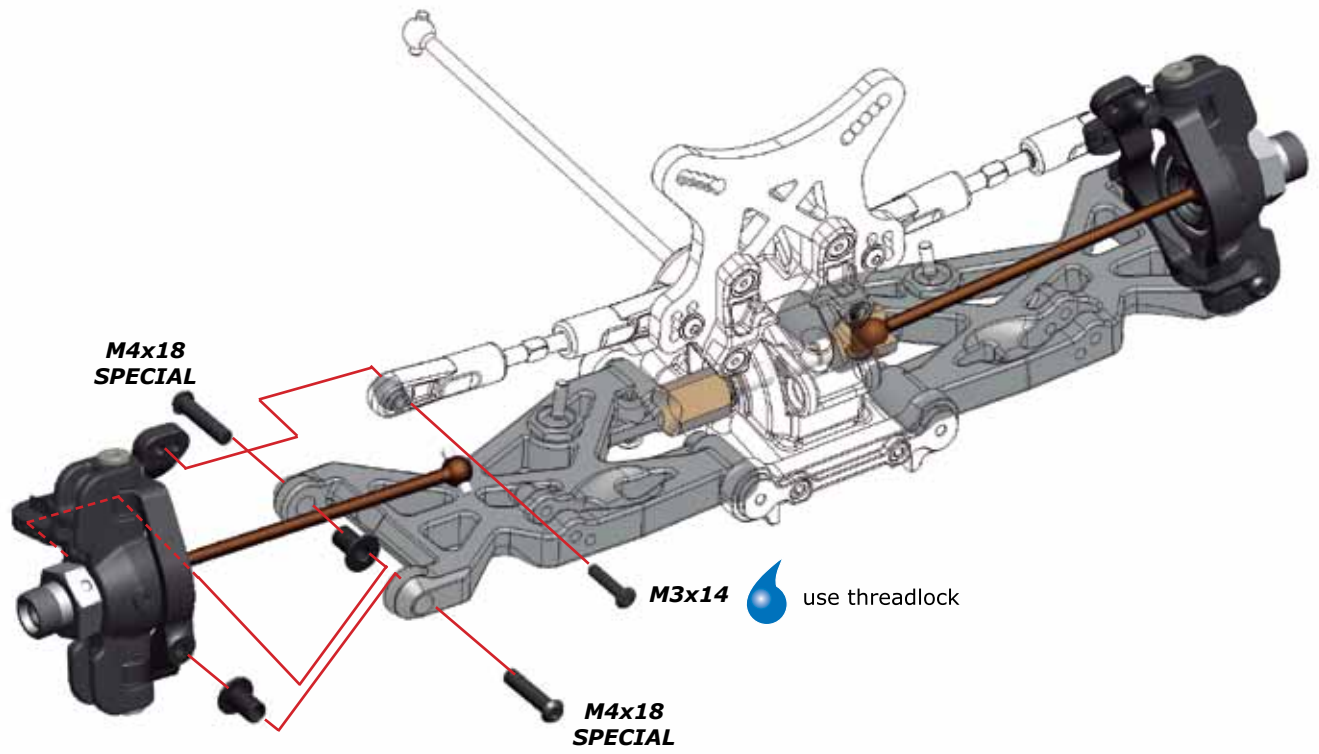

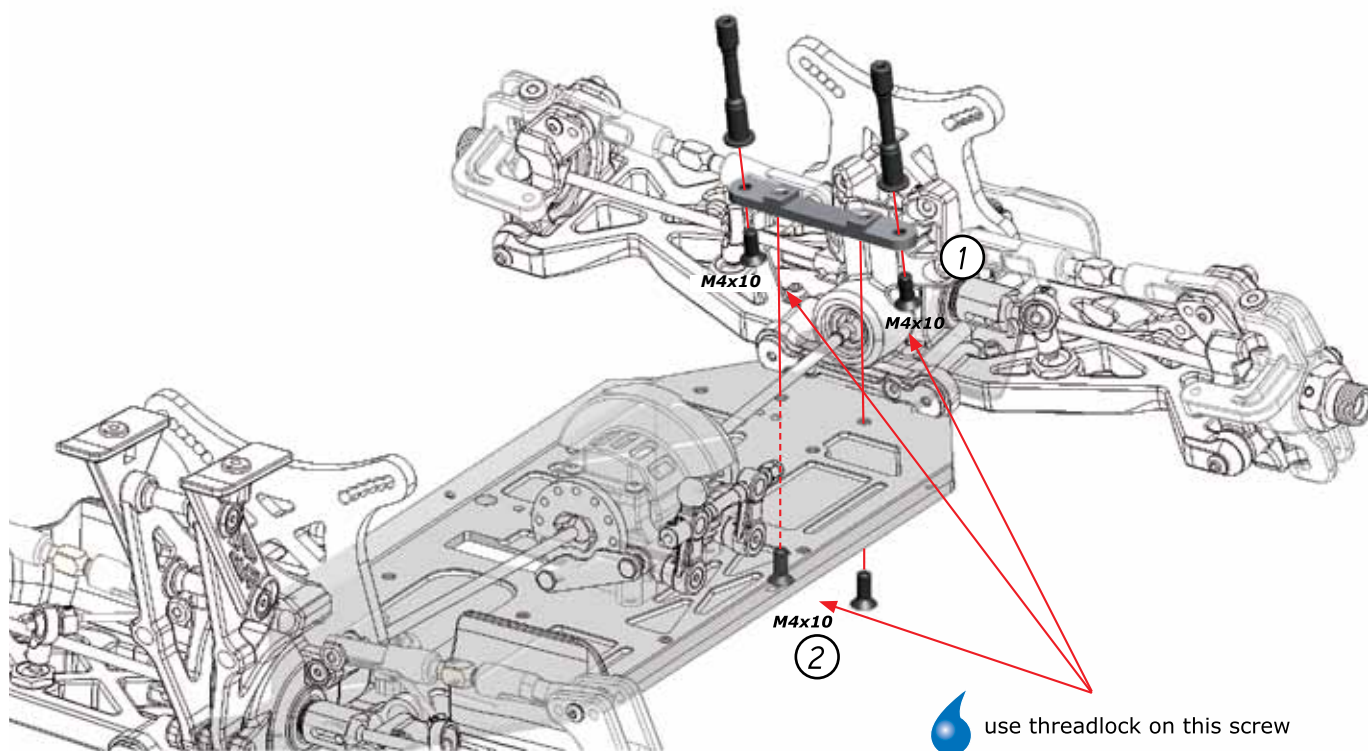
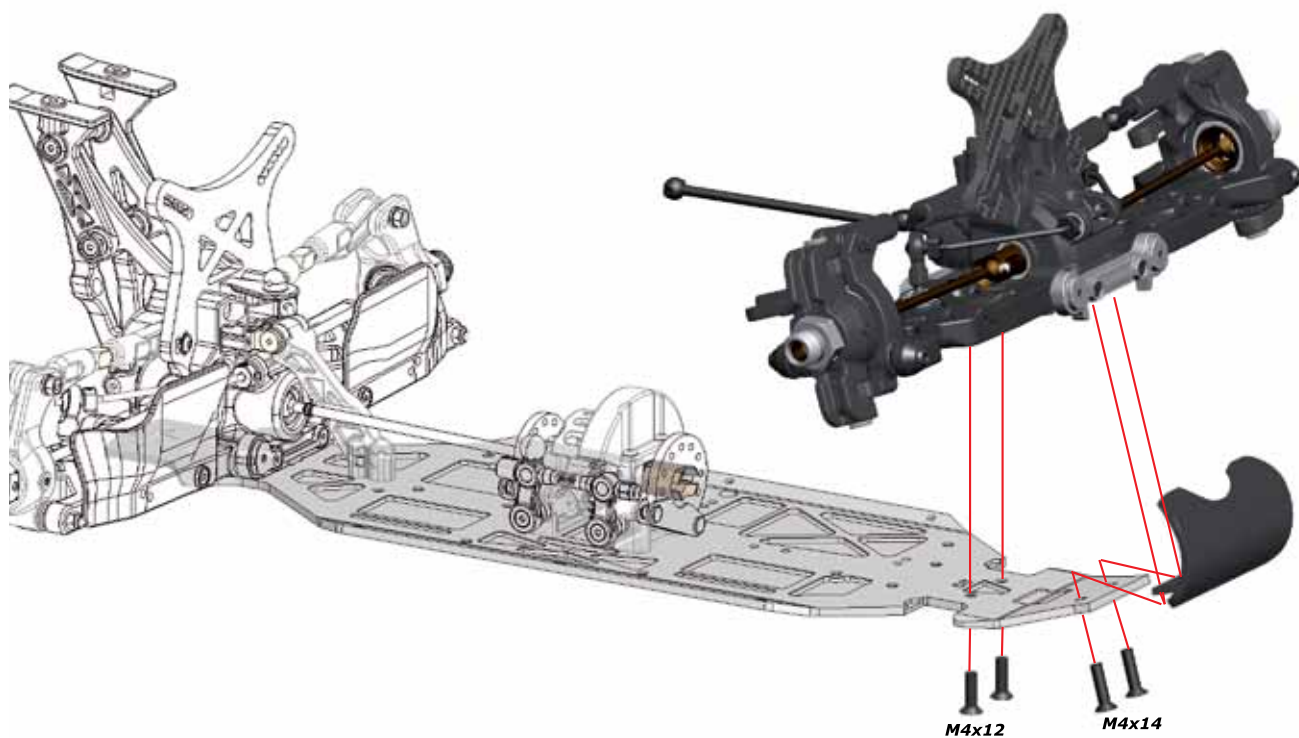



A

34

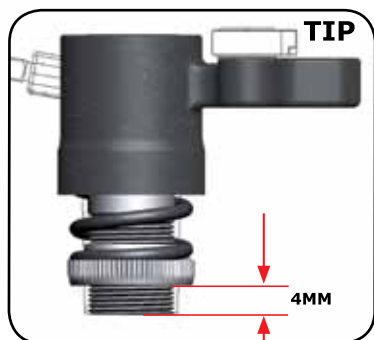

A

35

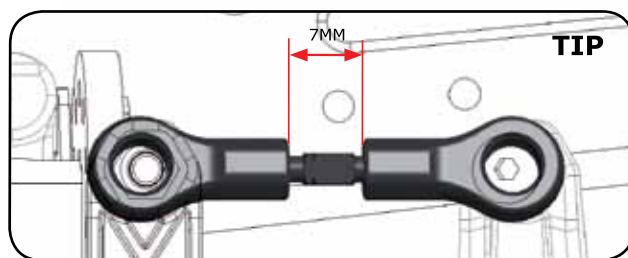

A

36

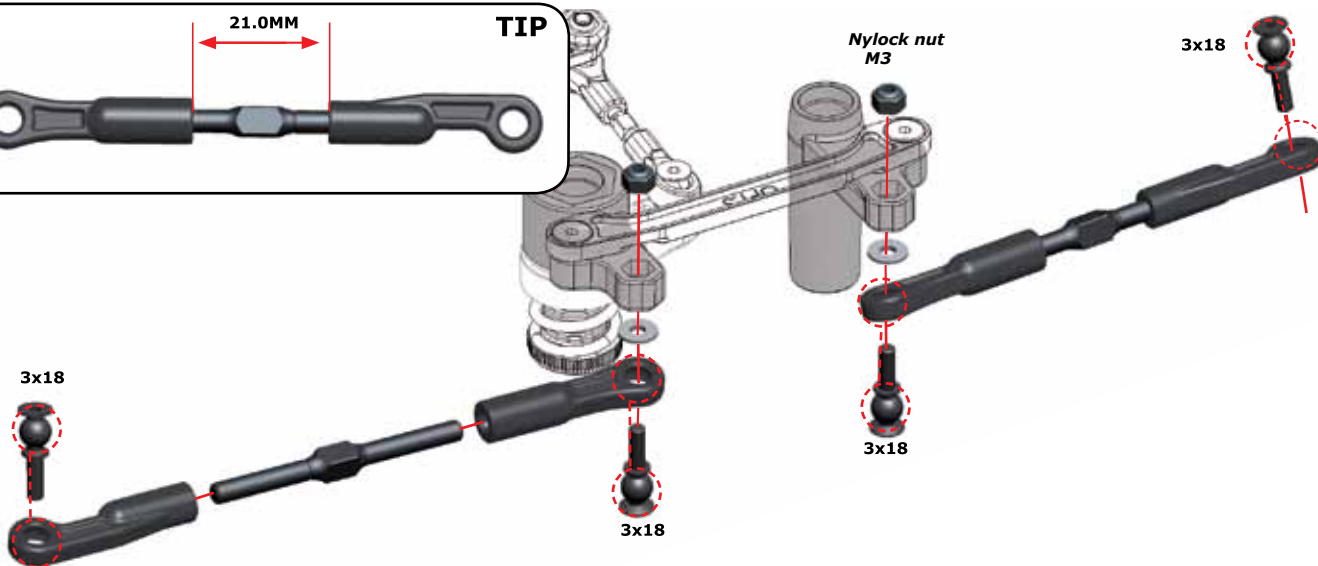
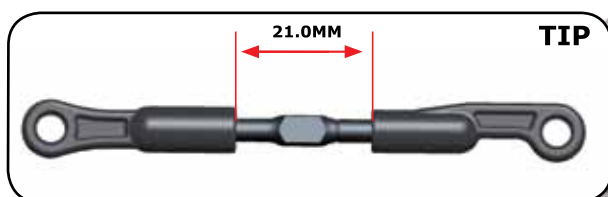

A

37

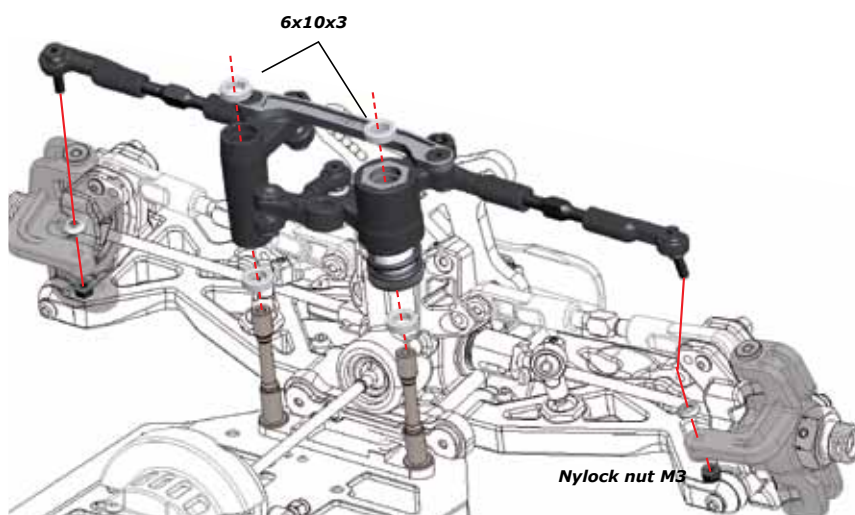



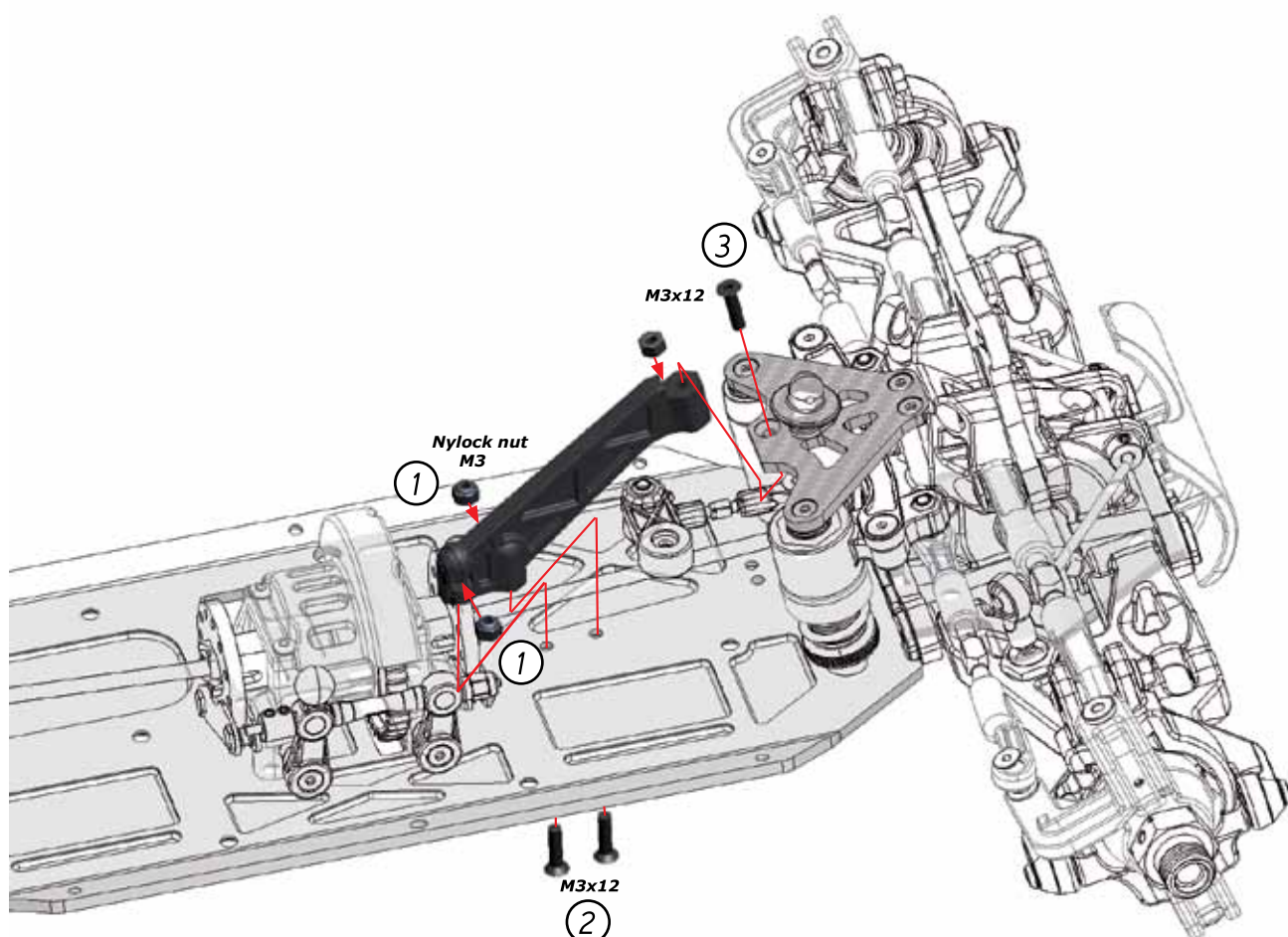
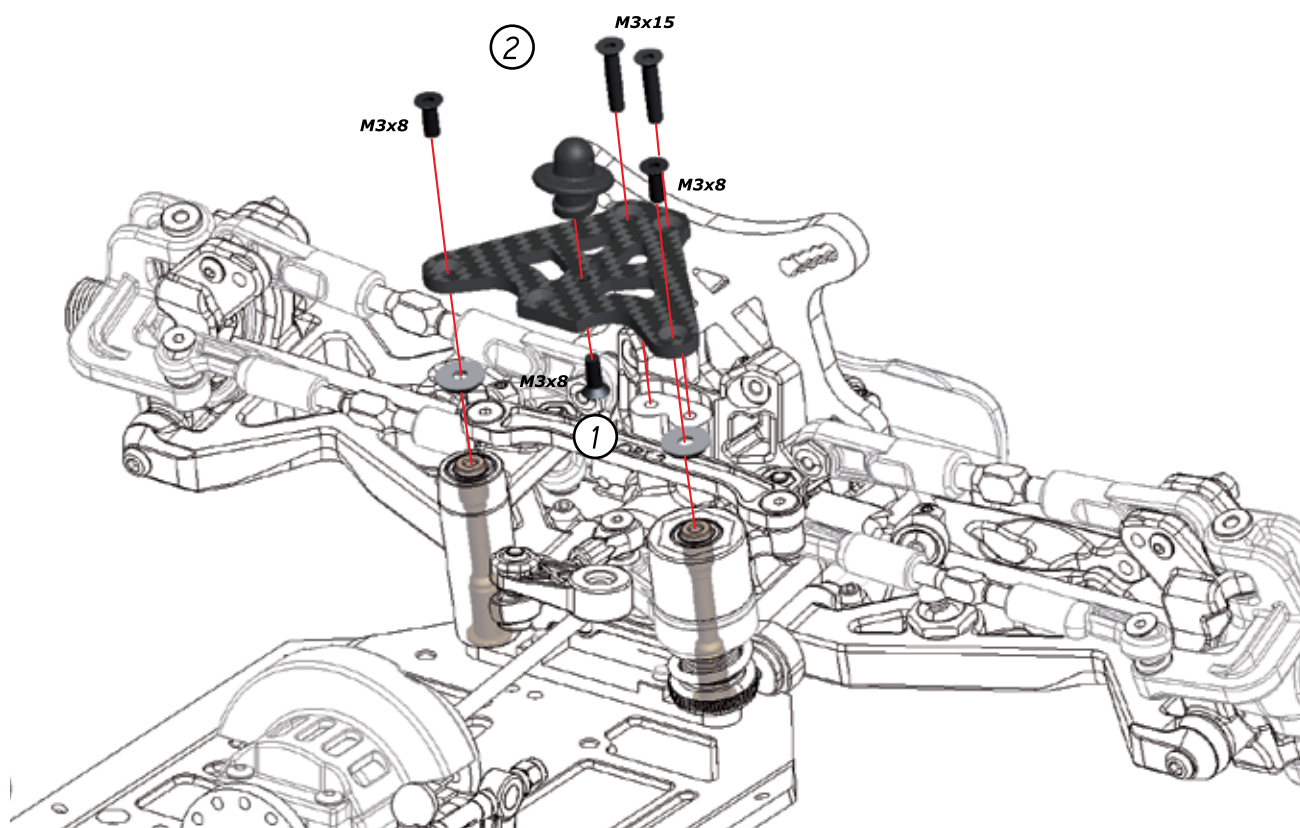

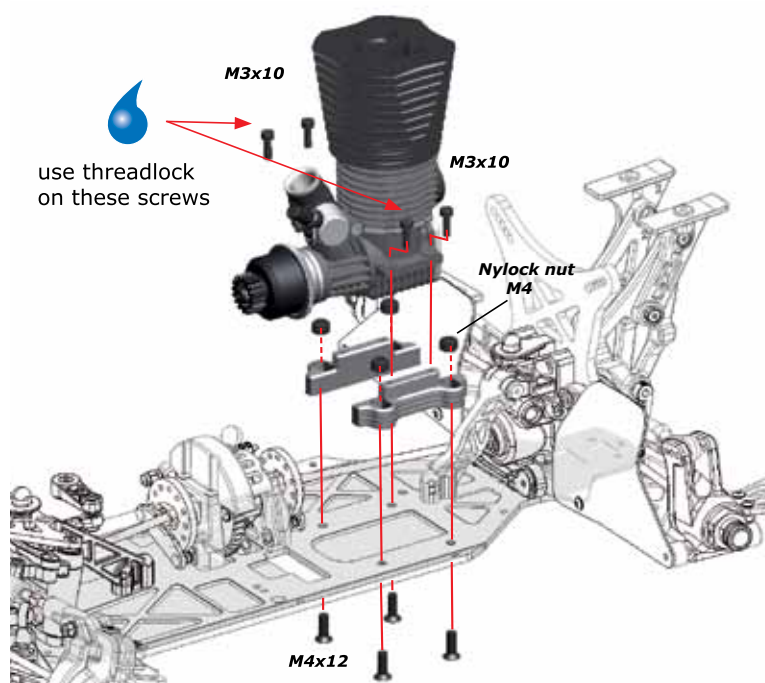
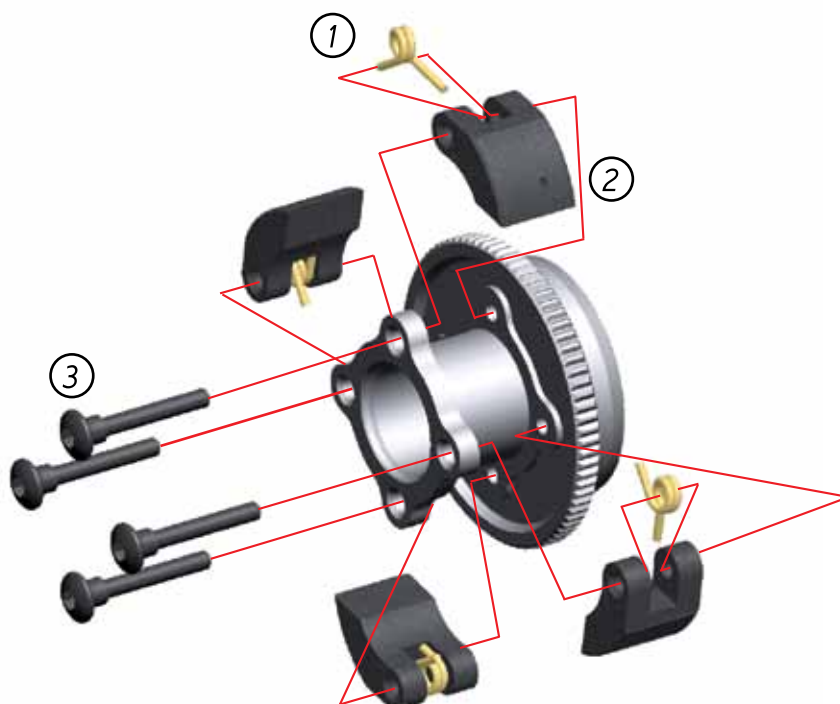

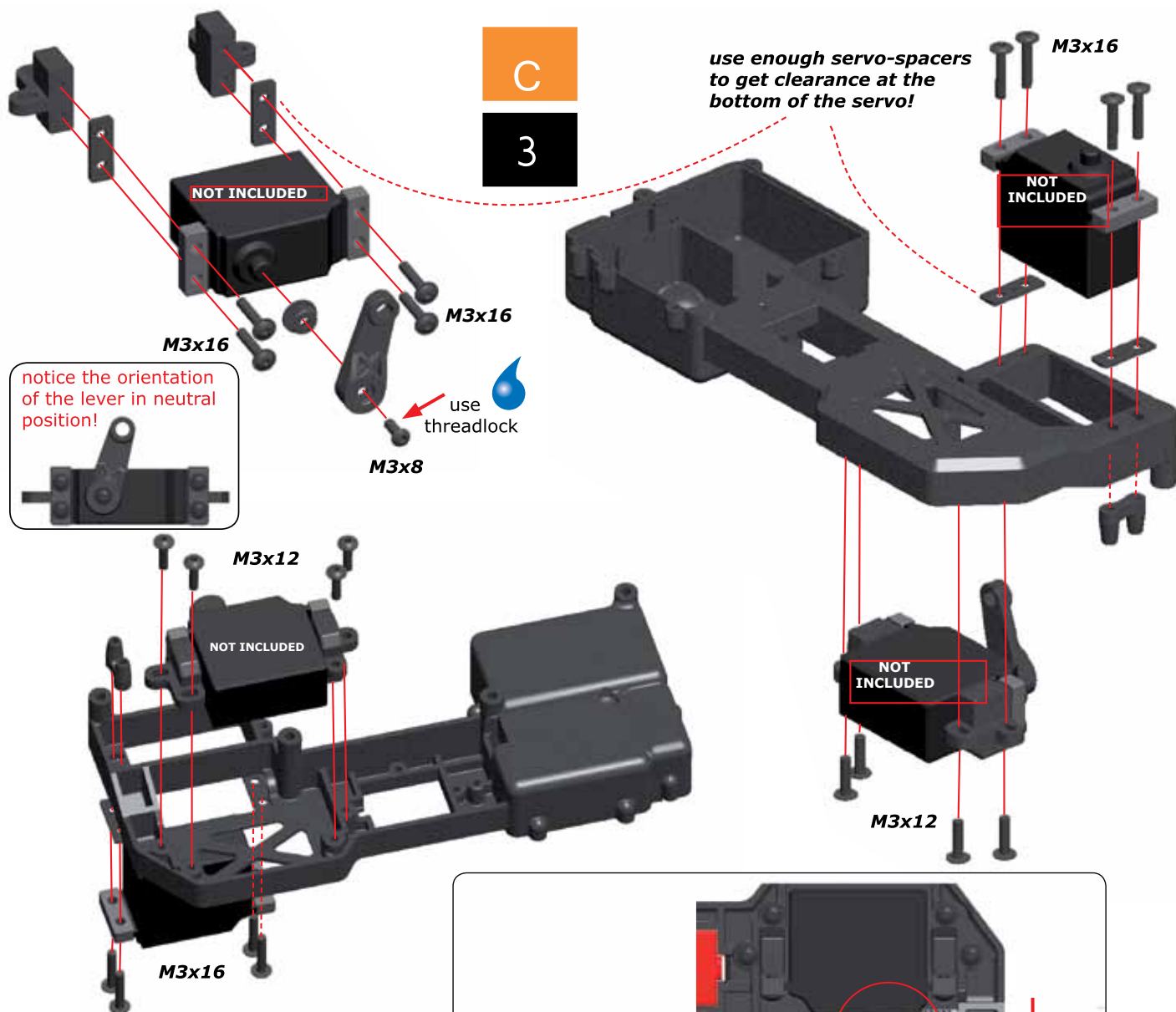
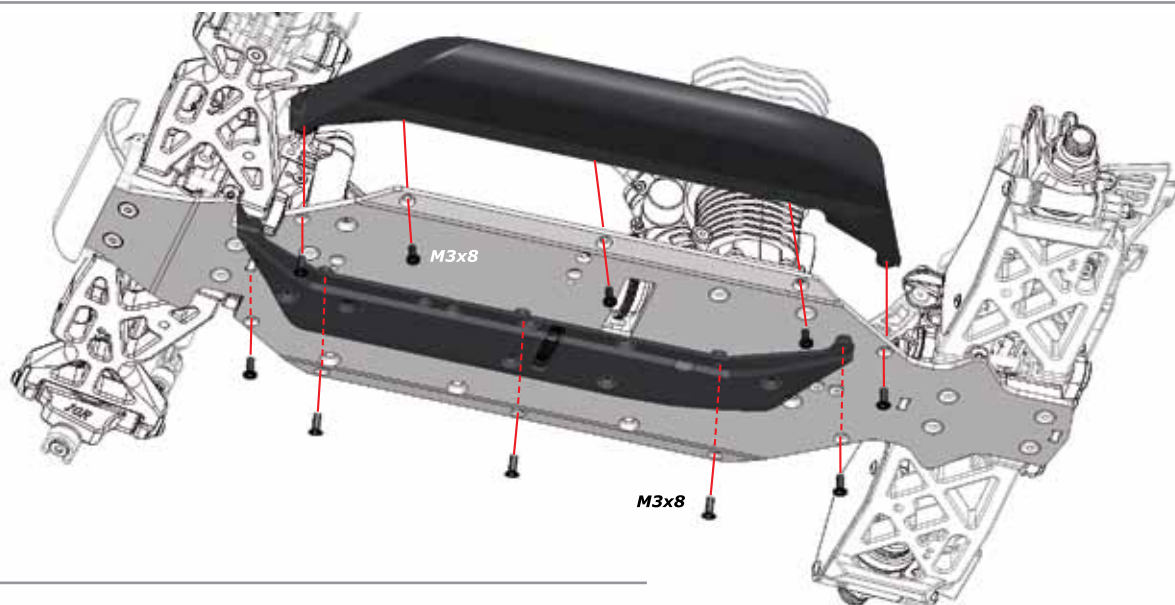

The target dimension between the end of outer edge of the servo horn and the inner wall of the radio box should be > 2.0mm to 2.5mm

**>2.0-2.5mm**



C

4

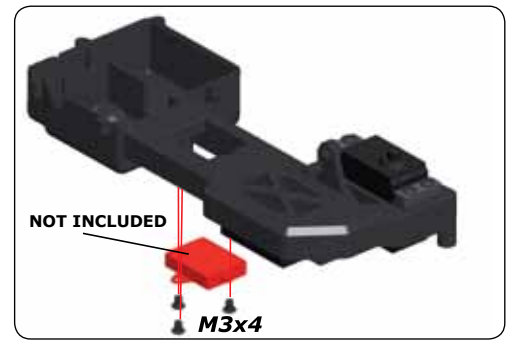

C

5

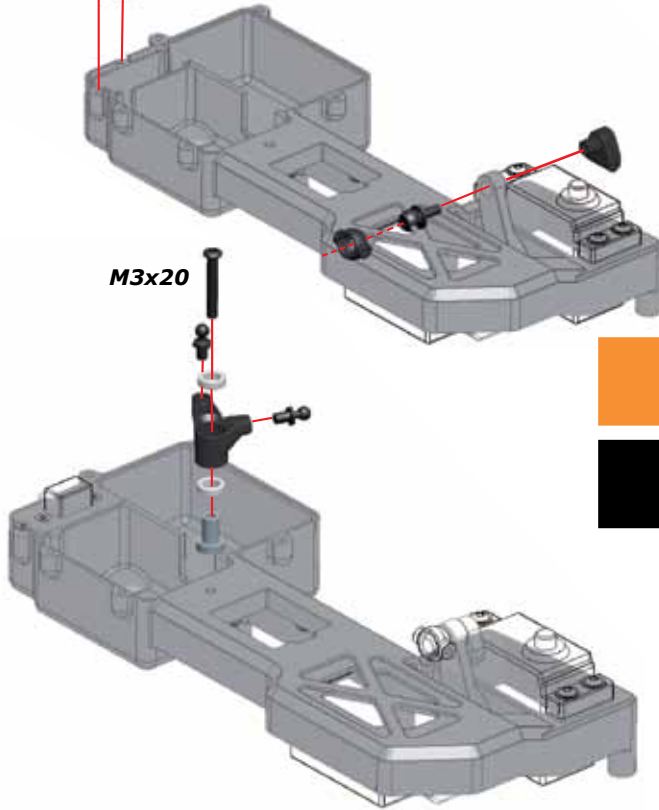

C

6

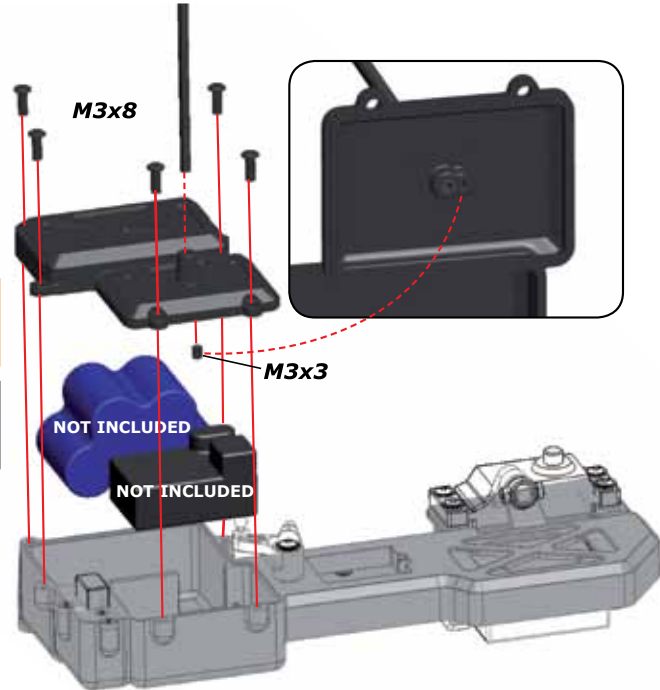

C

7

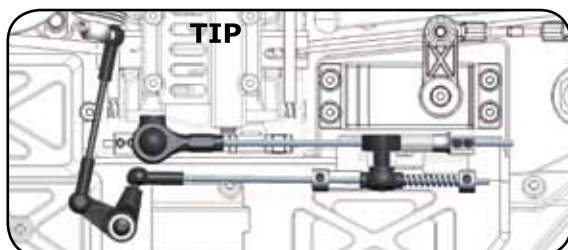
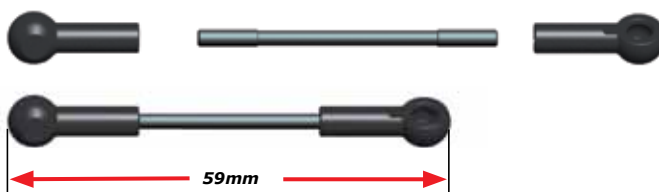
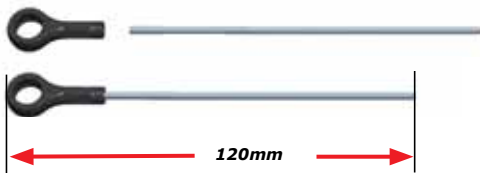
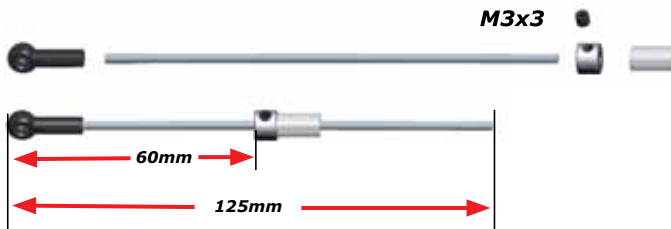

C

8

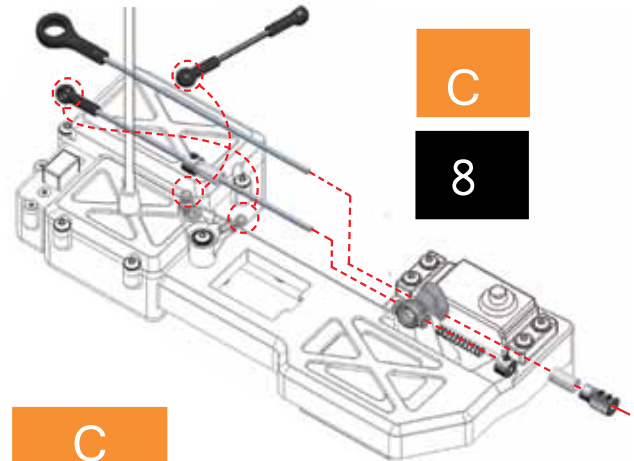

C

9

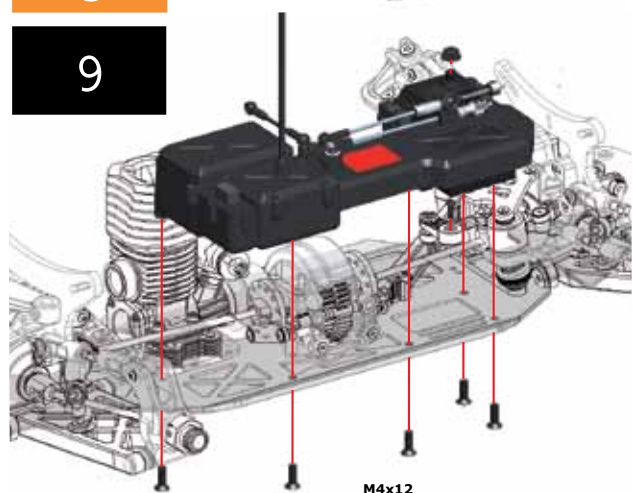



# FRONT/REAR SHOCK ASSEMBLY

D

1

BAG  
10/11

D

2

D

3

D

4

D

5

D

6

D

7

D

8

D

9

**NOTE:**  
Bag 10 are  
FRONT shocks.  
Bag 11 are  
REAR shocks



# SCHOCK MOUNTING

D

10

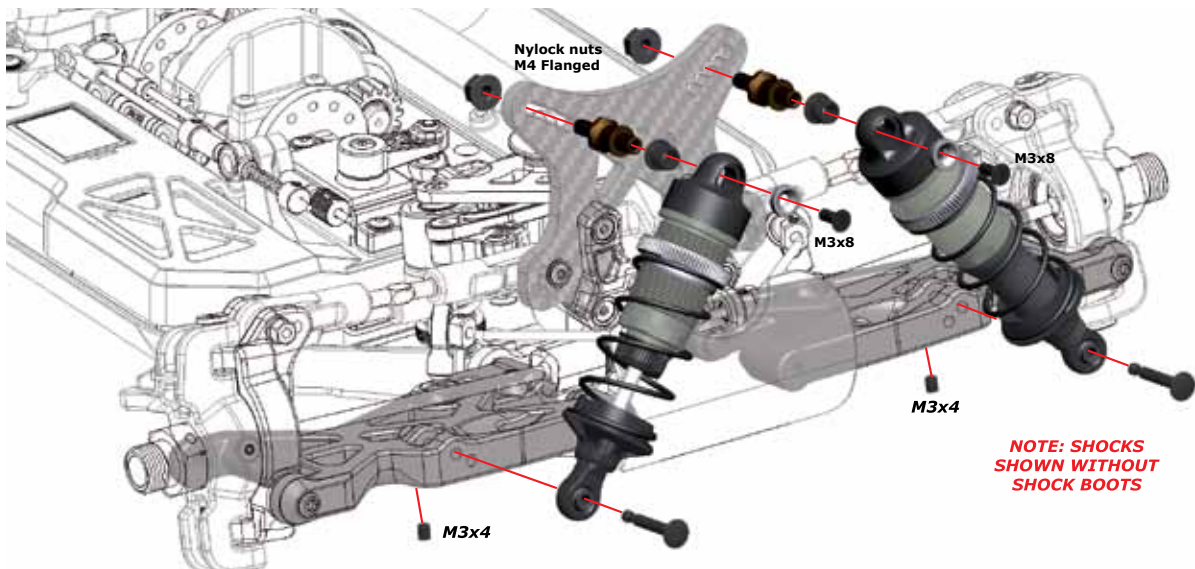

D

11

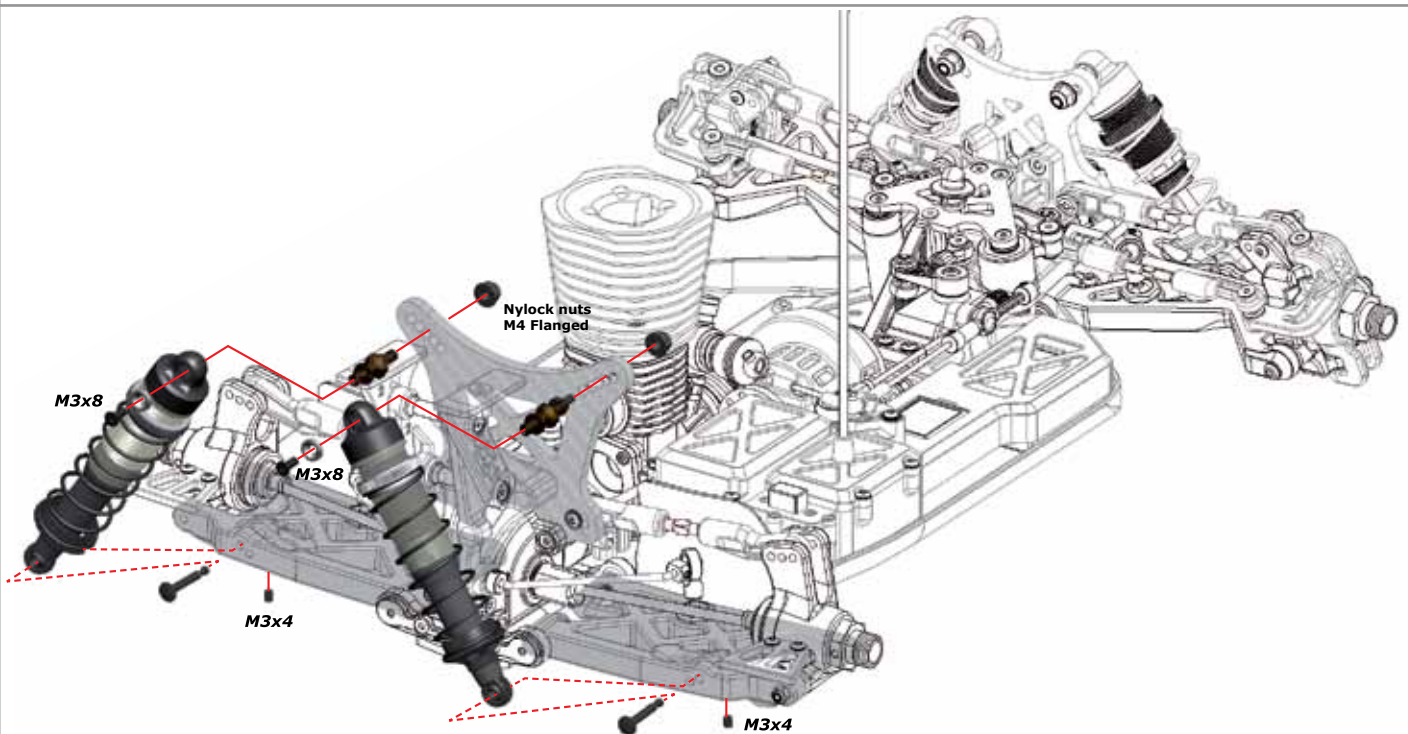

D

12

BAG  
12

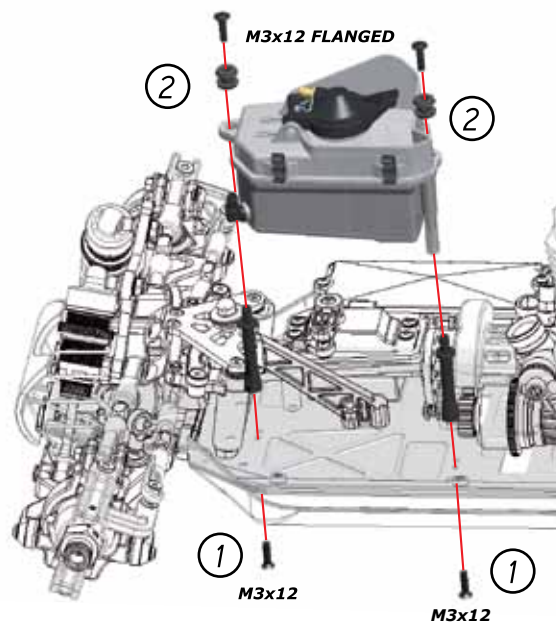

NOTE: POSITION OF TANK POSTS

22



E

1

# FINAL ASSEMBLY

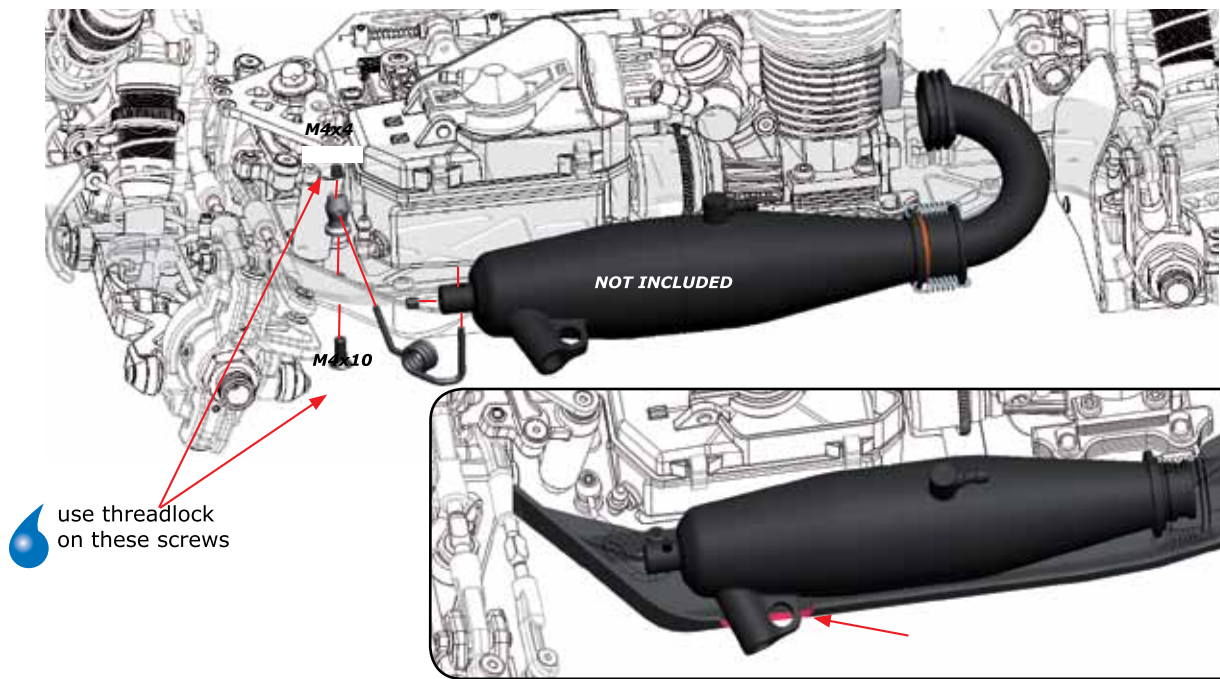

E

2

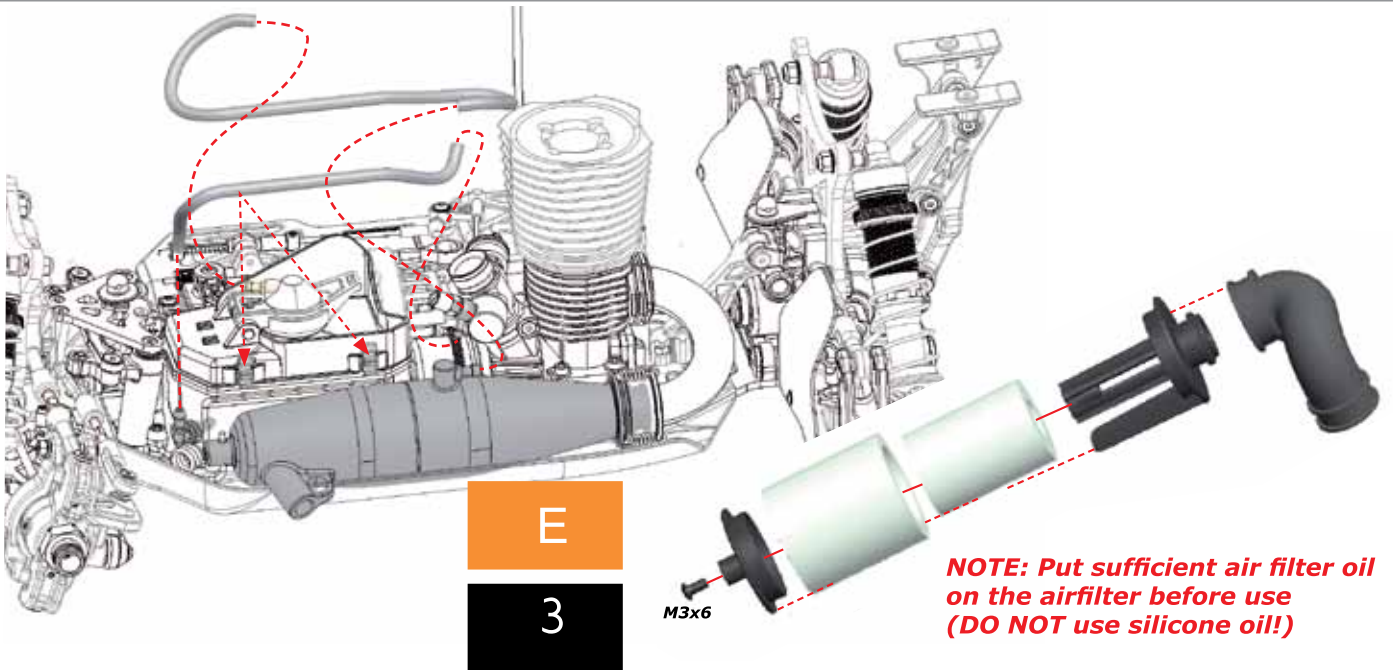

E

3

E

3A

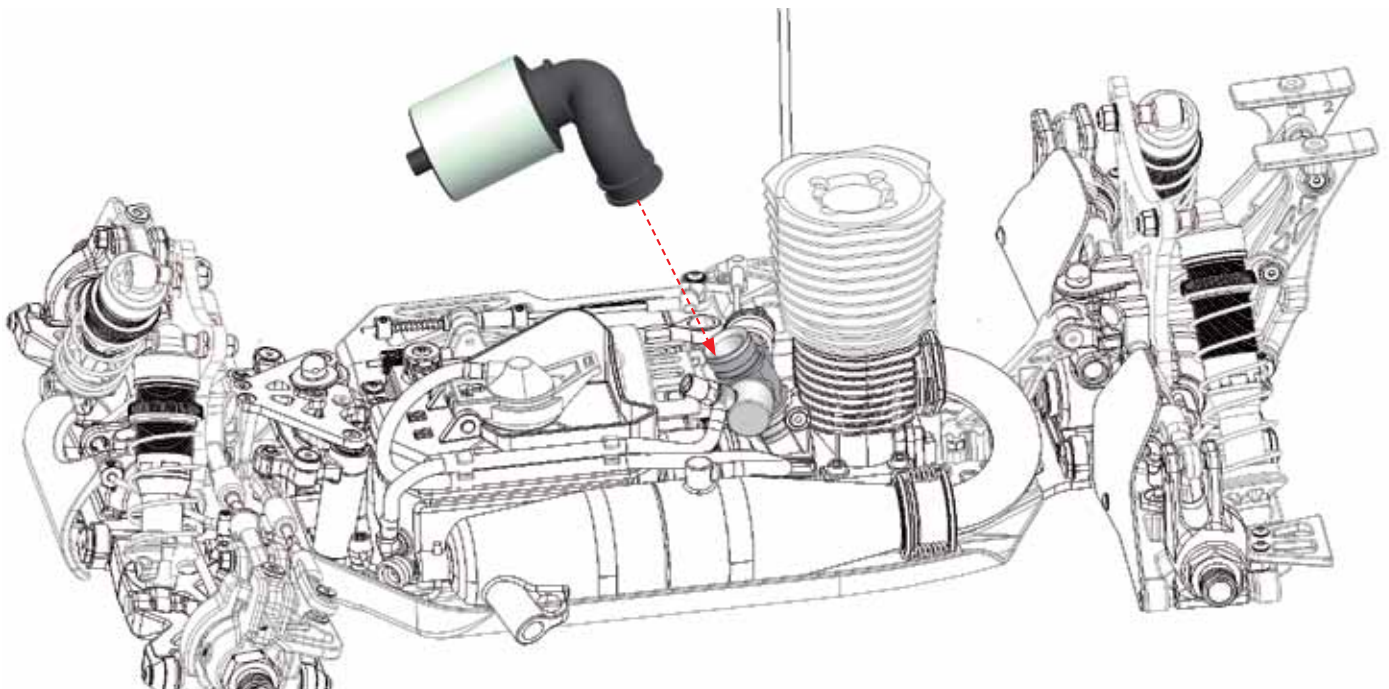

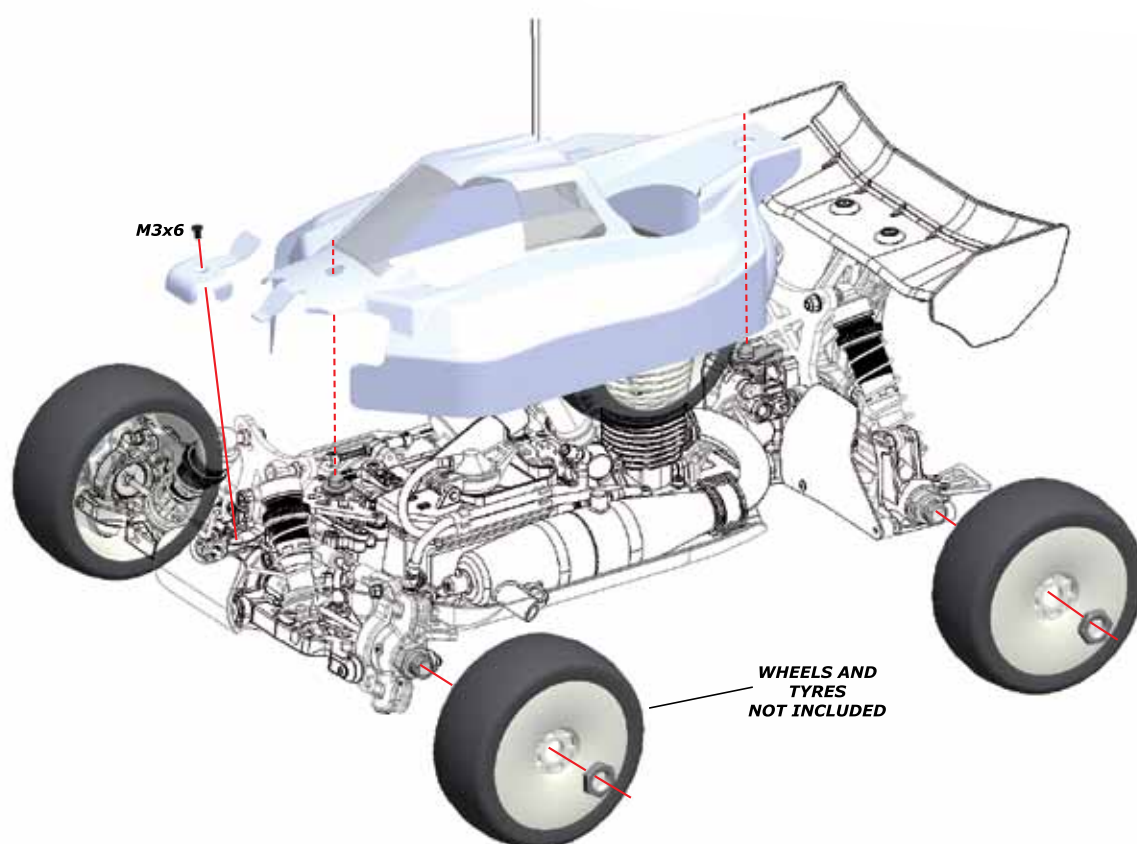
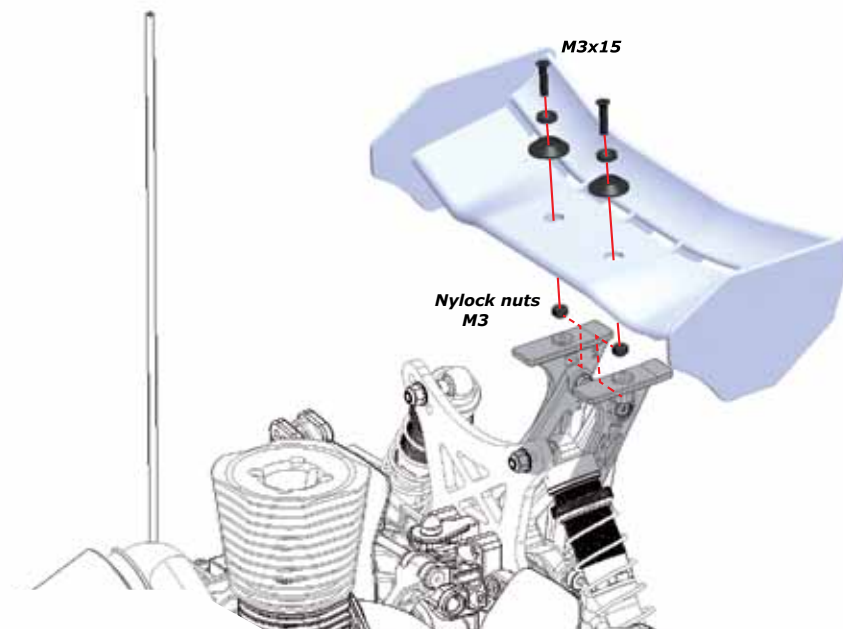





## REFERENCE GUIDE AND EXPLODED VIEWS

### Description

600014 Serpent 811 Cobra Buggy GP  
1/8 4wd 2,1

### Decals

600329 Decal sheet S811 black/white (2)  
600332 Decal sheet S811 chrome (2)

### Ball Bearings

1312 Ballbearing 5x8 flanged SS (2)  
1311 Ballbearing 5x8x2 (2)  
1315 Ballbearing 5x10x4 SS (2)  
1321 Ballbearing 6x10x3 SS (2)  
1337 Ballbearing 15x21x4 SS (2)  
1393 Ballbearing 13X19X4 SS (2)  
1394 Ballbearing 8x14x4 flanged SS (2)  
1395 Ballbearing 8x19x6 SS (2)  
1396 Ballbearing 8x16x5 SS (2)  
600616 Bearingset 811 V2 (26)  
600617 Bearingset small S811 v2 (12)

### Radio instalation / Battery

600106 Switch cover (2)  
600120 Throttle / brake slider set  
600127 Throttle / steering lever set  
600131 Balljoint set (19)  
600139 Sideguard L+R  
600333 Brake / Throttle links (3)  
600358 Radiobox V2 (3)  
600359 Servo lever / mounts V2 (30)  
600360 Throttle lever shaft (1)  
600361 Throttle balls (2+1)  
600362 Collar set V2 (3)  
600363 Throttle rod V2 (1)  
600500 Servo spacers (8)  
804181 Throttle spring (2)

### Optional

600272 Steering servo rod titanium  
600290 Servo lever steering 23T alu  
600291 Servo lever steering 24T alu  
600292 Servo lever steering 25T alu  
600293 Servo lever throttle 23T alu  
600294 Servo lever throttle 24T alu  
600295 Servo lever throttle 25T alu

### Servo Saver / Steering section

401057 rod 26mm steel (2)  
600105 Servosaver spring  
600109 O-ring servosaver nut (4)  
600122 Brace front / rear nylon  
600124 Bodymount FR+RR  
600127 Throttle / steering lever set  
600128 Servo saver set nylon (3)  
600131 Balljoint set (19)  
600153 Topdeck front carbon  
600167 Steeringrack mount  
600169 Servosaver adjust nut  
600170 Servosaver shaft outer  
600173 Steeringrack option 3

600178 Shim conical M3x7.5x1 (10)  
600182 Bolt steeringrack (2)  
600186 Track rod M4x51 (2)  
600191 Pivotball 6mm steering (4)  
600199 Servosaver post (2)  
600227 Pivot ball steering rod (2)  
600334 Spacer steering post (2)

### Optional

600171 Steeringrack option 1  
600172 Steeringrack option 2  
600272 Steering servo rod titanium  
600278 Servo saver post alu (2)  
600296 Servosaver alu coated (3)  
600330 Servo saver spring hard

### Fuel Tank and parts

1493 Pressure nipple m3 (4)  
1494 Silicone tubing 2x5x50 white  
1667 Body-clip medium (10)  
600115 Tank mounting rubber (4)  
600123 Clip /plug set for fuel tube (7)  
600126 Washer/nut nylon M3 (12+15)  
600335 Post fuel tank (2)

### Shock Absorbers

600111 Shock membrane (10)  
600112 O-ring shock bottom (10)  
600113 O-ring shock nut (10)  
600118 Shock part frame nylon (10)  
600145 Shock pistons (4x4)  
600158 Adjust nut shock / oring (2)  
600161 Shock body coated front (2)  
600179 Shock mount (2)  
600180 Washer shock shaft (4)  
600184 Pivotball 6.75 double (4)  
600194 Shockshaft FR (2)  
600224 Bolt shock (4)  
600234 Shock cartridge stepped (4)  
600235 Shock cartridge (4)  
600263 Washer M3 alu (12)  
600331 Shock boot rubber (4)  
600347 Shock top 7075 hard anodized (2)  
600387 Shock body coated rear truggy (2)  
600388 Shock boot truggy (4)  
600640 Shock shaft rr 811 2.0 (2)

### Optional

600159 Shock top alu (2)  
600282 Shock bushing delrin (4)  
600287 Shock spring support alu (4)  
600306 Shock shaft FR TiNi coating (2)  
600349 Shock pistons conical 6 hole (4)  
600350 Shock pistons conical 8 hole (4)  
600351 Shock pistons conical 10 hole (4)  
600357 Membrane webbed silicone (4)  
600488 Shock piston square 8 hole (4)  
600645 Shockrod 811 2.0 rear Tin coated (2)

### Shock Springs

600648 Spring FR pink V2 (0,73N/4,15LB) (2)  
600654 Spring RR pink V2 (0,58N/3,3LB) (2)

600646	Spring FR orange V2 (0,66N/3,8LB) (2)
600647	Spring FR red V2 (0,70N/4,0LB) (2)
600649	Spring FR blue V2 (0,75N/4,3LB) (2)
600650	Spring FR purple V2 (0,79N/4,5LB) (2)
600651	Spring FR green V2 (0,81N/4,65LB)(2)
600652	Spring RR orange V2 (0,53N/3,0LB) (2)
600653	Spring RR red V2 (0,56N/3,2LB) (2)
600655	Spring RR blue V2 (0,60N/3,4LB) (2)
600656	Spring RR purple V2 (0,61N/3,5LB) (2)
600657	Spring RR green V2 (0,63N/3,6LB) (2)
600658	Spring set FR V2 (6x2)
600659	Spring set RR V2 (6x2)

#### Chassis / Guards

600124	Bodymount FR+RR
600139	Sideguard L+R
600141	Bumper
600687	Chassis S811 Plus4

#### Optional

600154	Chassis alu 7075 T6 anodised
600288	Chassis brace front alu
600289	Chassis brace rear alu
600469	Chassis S811 hard anodized

#### Front section

600102	Driveshaft 98mm (2)
600108	Hingepin (2)
600129	Diff case front set
600131	Balljoint set (19)
600135	Wishbone front L+R
600136	C-Hub 10 L+R
600141	Bumper
600151	Shocktower front carbon
600168	Camberlink pivotball (4)
600174	Antirollbar nut (2)
600176	Suspension bracket alu FR RR
600177	Suspension bracket alu FR FR
600178	Shim conical M3x7.5x1 (10)
600183	Bushing suspensionarm (4)
600185	Pivotball 7.5 double (4)
600188	Track rod M5x53 (2)
600190	Pin steeringblock (4)
600192	Pivotball antirollbar (2)
600193	Pivotball threaded antirollbar (2)
600197	Driveshaft insert (2)
600222	Wheelnut 17mm (4)
600223	Wheelhexagon alu (4)
600225	Droop screw (4)
600263	Washer M3 alu (12)
600268	C-Hub 12 L+R
600326	Special screw FR whisbone (4)
600381	Gear coupler rubber boot (2)
600472	Gear coupler V3
600473	Gear coupler sleeve (2)
600478	Wheelaxle FR V2 (2)
600481	Steeringblock L+R V2
600495	Diff pinion 13T
600509	Driveshaft center front 811 V3
600665	C-hub 14 L+R alu
600678	Bushing delrin for 811 alu caster block (4)
903343	Antirollbar spacer 3mm (2)

#### Optional

600240	Antiroll bar front 2.3mm
600241	Antiroll bar front 2.5mm
600242	Antiroll bar front 2.7mm
600269	Track rod M5x46 titanium (2)
600271	Track rod M4x51 titanium (2)

600273	Shock mount titanium (2)
600274	Wheelhexagon light -2mm (2)
600275	Wheelhexagon light -1mm (2)
600276	Wheelhexagon light -0mm (2)
600297	Lightweight wheel nut 17mm (4)
600303	C-hub 10 L+R alu
600304	C-hub 12 L+R alu
600336	Antiroll bar front 1.8mm
600337	Antiroll bar front 2.0mm
600343	Bushing/spacer Steering block alu (8)
600484	Antirollbar spacer alu (2)
600485	Pivotball anti roll bar (2)
600486	Bushing suspension arm fr alu (4)
600487	Bolt shock titanium (4)
600490	Hingepin fr / rr TiN coated (2)
600497	Steeringblock L+R V2 alu
600611	Steeringblock Alu 0-Deg L+R
600663	C-hub 16 L+R alu
600695	Diff pinion 10T spiral

#### Middle section

600119	Center diff holder parts (3)
600121	Brake levers / adjusters
600148	Diskbrake front fibreglass
600149	Diskbrake rear fibreglass
600157	Collar double (2)
600164	Brake excenter (2)
600165	Brake lever insert (2)
600181	Bolt brake plate (4)
600203	Brake plate (4)
600208	Brake spring (4)
600226	Brake piston solid (2)
600333	Brake / Throttle links (3)
600369	Brake plate thick (2)

#### Optional

600281	Brake piston /spring (2/2/2)
600286	Center diff holder alu (2)
600299	Engine monomount-set alu
600342	Mono enginemount top (2)
600345	Brake set pro
600346	Brake pad Pro (2)

#### Rear Section

600108	Hingepin (2)
600122	Brace front / rear nylon
600124	Bodymount FR+RR
600130	Diff case rear set
600131	Balljoint set (19)
600132	Suspension bracket inserts (30)
600155	Suspension bracket RR RR 3
600156	Suspension bracket RR FR 2
600168	Camberlink pivotball (4)
600174	Antirollbar nut (2)
600178	Shim conical M3x7.5x1 (10)
600185	Pivotball 7.5 double (4)
600188	Track rod M5x53 (2)
600189	Hingepin RR outer (2)
600192	Pivotball antirollbar (2)
600193	Pivotball threaded antirollbar (2)
600197	Driveshaft insert (2)
600204	Bolt transmission brace rear (2)
600222	Wheelnut 17mm (4)
600225	Droop screw (4)
600261	Socket screw M3x8 (6)
600263	Washer M3 alu (12)
600365	Spacers 1.25mm + 2.5mm for wheelbase (4+2)
600381	Gear coupler rubber boot (2)

600441 Wing mount set low 811  
 600472 Gear coupler V3  
 600473 Gear coupler sleeve (2)  
 600475 Wheelaxle boot RR (2)  
 600495 Diff pinion 13T  
 600510 Driveshaft center rear 811 V3  
 600633 Wishbone rear L+R 811 2.0  
 600634 Upright L+R 811 2.0  
 600635 Driveshaft rr 811 2.0 (2)  
 600636 Wheelaxle rr 811 2.0 (2)  
 600637 Shocktower carbon rr 811 2.0  
 600638 Wheel scraper rr L+R 811 2.0  
 600639 Mud guard L+R 811 2.0  
 600641 Hex adaptor -2mm (2)  
 600688 Chassis brace rr alu  
 903343 Antirollbar spacer 3mm (2)

#### Optional

600237 Antiroll bar rear 2.3mm  
 600238 Antiroll bar rear 2.5mm  
 600239 Antiroll bar rear 2.7mm  
 600265 Suspension bracket RR FR 2.5 - 4.5  
 600266 Suspension bracket RR RR HR 3  
 600267 Suspension bracket RR RR LR 3  
 600270 Track rod M5x53 titanium (2)  
 600273 Shock mount titanium (2)  
 600274 Wheelhexagon light -2mm (2)  
 600275 Wheelhexagon light -1mm (2)  
 600276 Wheelhexagon light -0mm (2)  
 600277 Wing black nylon  
 600297 Lightweight wheel nut 17mm (4)  
 600300 Post wingmount alu (2)  
 600301 Wing washer alu (2)  
 600308 Suspension bracket RR FR 2.5 - 4.5  
 600338 Antiroll bar rear 1.8mm  
 600339 Antiroll bar rear 2.0mm  
 600434 Antiroll bar rear 2.4mm  
 600490 Hingepin fr / rr TiN coated (2)  
 600491 Hingepin rr outer TiN coated (2)  
 600484 Antirollbar spacer alu (2)  
 600487 Bolt shock titanium (4)  
 600485 Pivotball anti roll bar (2)  
 600644 Shocktower 811 2.0 rear alu light  
 600660 Wheelaxle rr 811 2.0 alu (2)  
 600661 Upright L+R 811 2.0 alu  
 600684 Antiroll bar rear 3.0mm  
 600695 Diff pinion 10T spiral

#### Differential

600147 Diff gasket (3)  
 600200 Diff outdrive (2)  
 600210 Diff pin outdrive (2)  
 600280 Spur gear 48T  
 600354 Shim 14x15.5x 0.65 (4)  
 600356 Shim 14x15.5x0.2 (10)  
 600376 Diff outdrive center (2)  
 600421 Oring centerdiff V2 (10)  
 600425 Diff housing V2  
 600480 Diff gear 44T  
 600495 Diff pinion 13T  
 600627 Diff gear 10T + 20T (4+2) V2

#### Optional

600198 Spurgear 46T  
 600209 Diff pin 10T (2)  
 600279 Spur gear 44T  
 600324 Diff Center 46T  
 600325 Diff universal  
 600501 Complete FR/RR 44T diff  
 600606 Spurgear 46T composite  
 600607 Spurgear 48T composite

600608 Spurgear 50T composite  
 600696 Diff gear 43T spiral

#### Clutch

600163 Flywheel alu  
 600206 Clutch nut (2)  
 600228 Clutch shoe carbon (4)  
 600230 Clutch spring medium 0.9mm (4)  
 600261 Socket screw M3x8 (6)  
 600262 Clutch screw (4)

#### Optional

600175 Clutchshoe alu (4)  
 600216 Clutch bell 13T  
 600217 Clutch bell 14T  
 600218 Clutch bell 15T  
 600219 Clutch bell 16T  
 600220 Clutch bell 17T  
 600229 Clutch spring soft (4)  
 600231 Clutch spring hard (4)  
 600232 Clutch spring X hard (4)  
 600233 Clutch spring set (4x4)  
 600244 Clutch-set alu / carbon  
 600298 Flywheel steel  
 600355 Clutch shoe set Alu / Carbon (2+2)  
 600518 Clutch bell 13T vented  
 600519 Clutch bell 14T vented  
 600520 Clutch bell 15T vented  
 600521 Clutch bell 16T vented  
 600522 Clutch bell 17T vented

#### Body / Wing

600439 Wing white low 811  
 600523 Body Avenger 1/8 Cobra GP

#### Optional

600143 Wing white nylon  
 600146 Body S811 Cobra + nose-cone  
 600277 Wing black nylon  
 600440 Wing black low 811

#### Fastners

110101 Screw allen countersunk m4x8 (10)  
 110102 Screw allen countersunk m4x10 (10)  
 110103 Screw allen countersunk m4x16 (10)  
 110104 Screw allen countersunk m3x8 (10)  
 110105 Screw allen countersunk m4x12 (10)  
 110106 Screw allen flanged roundhead m5x12 (10)  
 110107 Screw allen cilinderhead m3x16 (10)  
 110108 Screw allen roundhead m3x6 (10)  
 110109 Screw allen roundhead m3x10 (10)  
 110110 Screw allen roundhead m3x16 (10)  
 110111 Screw allen roundhead m3x14 (10)  
 110112 Screw allen roundhead m3x12 (10)  
 110113 Screw allen roundhead m4x8 (10)  
 110114 Setscrew allen m3x8 (10)  
 110115 Setscrew allen m3x4 (10)  
 110116 Setscrew allen m3x3 (10)  
 110117 Setscrew allen m3x12 (10)  
 110118 Setscrew allen m4x4 (10)  
 110119 Setscrew allen m4x6 (10)  
 110120 Setscrew allen m4x10 (10)  
 110121 Setscrew allen m5x6 (10)  
 110122 Screw allen countersunk m3x6 (10)  
 110123 Screw philips roundhead 3.5x13 (10)  
 110124 Screw allen roundhead m3x8 (10)  
 110125 Screw allen countersunk m3x20 (10)  
 110126 Screw allen countersunk m2.5x12 (10)  
 110127 Screw allen countersunk m3x12 (10)  
 110128 Screw allen roundhead m3x5 (10)

110129	Screw allen cilinderhead m3x10 (10)	110205	Pin 3x22 (10)
110130	Screw allen roundhead m2.5x6 (10)	110206	Pin 2.5x22 (10)
110131	Screw allen roundhead m2.5x10 (10)	110207	Pin 2.5x12 (10)
110132	Screw allen countersunk m3x16 (10)	110208	Pin nra 2x9.8 (4)
110133	Screw philipshead countersunk 2.5x8 wide (10)	110209	Pin nra 2x18 (4)
110134	Screw philipshead countersunk 2.5x10 wide (10)	110210	Pin 3x13 (10)
110135	Screw allen countersunk M2.5x10 (10)	110211	Pin 2.5x13 (10)
110136	Screw allen countersunk M2.5x8 (10)	110212	Pin 2.5x17 (10)
110137	Setscrew allen M3x6 (10)	110213	Pin 2.5x10 (10)
110138	Screw allen countersunk M4x14 (10)	110214	Pin 3x15 (10)
110139	Screw allen countersunk M3x40 (10)	110215	Pin 2x12 (10)
110140	Screw allen roundhead M3x20 (10)	110216	Pin 2.5x15 (10)
110141	Screw allen roundhead M3x22 (10)	110217	Pin 2x9 (10)
110142	Screw allen roundhead M3x25 (10)	110218	Pin 3x10 (10)
110143	Screw allen roundhead M4x18 (10)	110219	Pin 2x14 (10)
110144	Screw allen roundhead M3x18 (10)	110220	Pin 1.5x8 (10)
110145	Screw allen roundhead flanged M3x12 (10)	110221	Pin 1.7x7.6 (10)
110146	Screw allen roundhead flanged M3x16 (10)	110222	Pin 1.7x8.5 (10)
110147	Screw ph roundhead M2.5x5 (10)	110300	E-clip 2.3 (10)
110148	Setscrew allen M5x4 (10)	110301	E-clip 3.2 (10)
110149	Screw allen countersink M2x10 (10)	110302	E-clip 4.0 (10)
110150	Screw M6x12 nylon black (2)	110303	E-clip 5.0 (10)
110151	Screw allen cilinderhead M4x10 (10)	110304	E-clip 7.0 (10)
110152	Screw allen cilinderhead M3x8 (10)	110305	Seeger clip 12x1.0 (10)
110153	Screw allen roundhead M2.3x4(10)	110306	E-clip 6.0 (10)
110154	Setscrew allen M3x10 (10)	110307	E-clip 9.0 (10)
110155	Setscrew allen M3x5 (10)	110400	Shim 6.0x10x0.2(10)
110156	Screw allen countersunk M2.2x6 (10)	110401	Shim3.2x7x0.5 (10)
110157	Screw allen countersunk M3x5 (10)	110402	Nut nylock M3 (10)
110158	Screw allen countersunk M3x15 (10)	110403	Nut nylock M4 (10)
110159	Screw allen countersunk M3x18 (10)	110404	Shim 6x8x0.3 (10)
110160	Screw allen cilinderhead M2.2x12 (10)	110405	Nut nylock M4 flanged (10)
110161	Screw allen cilinderhead M2x6 (10)	110406	Nut nylock M2.2 (10)
110162	Setscrew allen M3x2.5 (10)	110407	Nut M3 (10)
110163	Setscrew allen M3x2 (10)	110408	Shim 3X5X0.3 (10)
110164	Screw allen roundhead M3x4 (10)	110409	Shim 3X5X1 (10)
110165	Screw allen cilinderhead M2x5 (10)	110410	Shim 3X5X2 (10)
110166	Screw allen countersunk M2.5x5 (10)	110411	Shim 3X5X4 (10)
110167	Screw allen roundhead flanged M3x18 (10)	110412	Shim 3.5X8X1 (10)
110168	Screw allen roundhead flanged M3.5x10 (10)	110413	Shim 3.5X12X0.2 (10)
110169	Screw allen roundhead flanged M4x10 (10)	110414	Shim 3X6X0.1 (10)
110170	Screw allen roundhead flanged M3x28 (10)	110415	Shim 3X6X0.5 (10)
110171	Screw ph roundhead widethread 2.5x6 (10)	110416	Shim 3X6X0.8 (10)
110172	Screw allen roundhead flanged M3X6 (10)	110417	Shim 3X6X3 (10)
110173	Screw ph countersunk widethread 2.5x12 (10)	110418	Shim 4X8X0.1 (10)
110174	Screw allen countersunk M4x6 (10)	110419	Shim 4X9.5X1 (10)
110175	Screw allen cilinderhead M3x40 (10)	110420	Shim 4X9.5X2(10)
110176	Screw allen cilinderhead M3x18 (10)	110421	Shim 4X9.5X4(10)
110177	Screw allen roundhead M4x12 (10)	110422	Shim 4X10X0.3 (10)
110178	Screw allen cilinderhead M3x14 (10)	110423	Shim 5X8X0.1 (10)
110179	Screw allen roundhead M2.5x8 (10)	110424	Shim 5X8X0.3 (10)
110180	Setscrew allen M5x10 (10)	110425	Shim 5X10X0.3 (10)
110181	Screw M5x10 + Nut nylon black (4+4)	110426	Shim 5X10X0.5 (10)
110182	Screw allen roundhead M2x4 (10)	110428	Shim 6.5X8X0.25 (10)
110183	Screw allen countersunk M3x10 (10)	110429	Shim 6X11.75X0.2 (10)
110184	Screw allen countersunk M3x14 (10)	110431	Shim 8X11X0.1 (10)
110185	Screw allen cilinderhead M3x30 (10)	110432	Shim 8X11X0.2 (10)
110186	Screw allen cilinderhead M3x35 (10)	110433	Shim 12X15X0.25 (10)
110187	Setscrew allen M3x16 (10)	110434	Shim 12X18X0.3 (10)
110188	Screw allen cilinderhead M2x10 (10)	110435	Shim 13X16X0.2 (10)
110200	Pin 2.5x8 (10)	110436	Shim 3x5x3 (10)
110201	Pin 3x12 (10)	110437	Nut M2.5 (10)
110202	Pin 5x5 (10)	110438	Shim 2.5x6x0.5 (10)
110203	Pin 3x14 (10)	110439	Shim 3x7.5x1 (10)
110204	Pin 3x20 (10)	110440	Shim 2.5x5x0.4 (10)
		110441	Nut nylock M3 flanged (10)
		110442	Shim 4x8x0.6 (10)
		110443	Shim 5x15x0.2 (10)



110444	Nut M4 nylon (10)
110445	Shim 4x10x0.2 (10)
110446	Shim 5x15x0.2 (10)
110447	Shim 3x7x7 (10)
110448	Shim 3x6x6 (10)
110449	Shim 3x6x1 (10)
110450	Nut M2 (10)
110451	Nylock nut M4 flanged alu (10)
110452	Nut M4 flanged knurled (10)
110453	Shim 3x7x3 (10)

#### Tools

190500	Pit-caddy
190501	Tool-bag
190502	Pit-bag medium. 3 drawers
190503	Fuel bottle 500ml
190504	Ballcup tool
190508	Toolset FOR OFFROAD (20pcs) with Tools bag
190509	ALLEN WRENCH 1.5 X 120MM
190510	ALLEN WRENCH 2.0 X 120MM
190511	ALLEN WRENCH 2.5 X 120MM
190512	ALLEN WRENCH 3.0 X 120MM
190513	BALL DRIVER HEX WRENCH 2.0 X 120MM
190514	BALL DRIVER HEX WRENCH 2.5 X 120MM
190515	BALL DRIVER HEX WRENCH 3.0 X 120MM
190516	Tool tip ALLEN WRENCH 1.5 X 120MM
190517	Tool tip ALLEN WRENCH 2.0 X 120MM
190518	Tool tip ALLEN WRENCH 2.5 X 120MM
190519	Tool tip ALLEN WRENCH 3.0 X 120MM
190520	Tool tip BALL DRIVER HEX WRENCH 2.0 X 120MM
190521	Tool tip BALL DRIVER HEX WRENCH 2.5 X 120MM
190522	Tool tip BALL DRIVER HEX WRENCH 3.0 X 120MM
190523	TURNBUCKLE WRENCH 3MM
190524	TURNBUCKLE WRENCH 4MM
190525	TURNBUCKLE WRENCH 5MM
190526	FLAT HEAD SCREWDRIVER 3.0 X 150MM
190527	FLAT HEAD SCREWDRIVER 4.0 X 150MM
190528	PHILLIPS SCREWDRIVER 2.0 X 45MM
190529	PHILLIPS SCREWDRIVER 3.5 X 120MM
190530	PHILLIPS SCREWDRIVER 5.8 X 120MM
190531	NUT DRIVER 5.0 X 100MM
190532	NUT DRIVER 5.5 X 100MM
190533	NUT DRIVER 7.0 X 100MM
190534	REAMER WITH END CAP FOR LEXAN BODY
190535	EXHAUST SPRING / CASTER CLIP REMOVER
190536	WRENCH-GLOWPLUG / CLUTCHNUT 10MM LONG
190537	FLYWHEEL WRENCH TOOL WHEEL NUT FOR 1/8 OFF ROAD BUGGY
190538	FLYWHEEL WRENCH
190539	NUT DRIVER 4.5 X 100MM

#### MERCHANDISING

1896	Cap serpent black-orange
190172	Winter jacket Serpent black-orange hooded (M)
190173	Winter jacket Serpent black-orange hooded (L)
190174	Winter jacket Serpent black-orange hooded (XL)
190175	Winter jacket Serpent black-orange hooded (2XL)
190176	Winter jacket Serpent black-orange hooded (3XL)
190208	Winter jacket Serpent black-orange hooded (4XL)
190156	Polo shirt Serpent black (S)
190157	Polo shirt Serpent black (M)
190158	Polo shirt Serpent black (L)
190159	Polo shirt Serpent black (XL)
190160	Polo shirt Serpent black (XXL)
190161	Polo shirt Serpent black (XXXL)
190182	T-shirt Serpent Splash white (S)
190183	T-shirt Serpent Splash white (M)
190184	T-shirt Serpent Splash white (L)
190185	T-shirt Serpent Splash white (XL)
190186	T-shirt Serpent Splash white (XXL)
190187	T-shirt Serpent Splash white (XXXL)
190188	T-shirt Serpent Splash orange (S)
190189	T-shirt Serpent Splash orange (M)
190190	T-shirt Serpent Splash orange (L)
190191	T-shirt Serpent Splash orange (XL)
190192	T-shirt Serpent Splash orange (XXL)
190193	T-shirt Serpent Splash orange (XXXL)
190194	T-shirt Serpent Splash black (S)
190195	T-shirt Serpent Splash black (M)
190196	T-shirt Serpent Splash black (L)
190197	T-shirt Serpent Splash black (XL)
190198	T-shirt Serpent Splash black (XXL)
190199	T-shirt Serpent Splash black (XXXL)
190201	Hoody sweater Serpent black-zip (S)
190202	Hoody sweater Serpent black-zip (M)
190203	Hoody sweater Serpent black-zip (L)
190204	Hoody sweater Serpent black-zip (XL)
190205	Hoody sweater Serpent black-zip (2XL)
190206	Hoody sweater Serpent black-zip (3XL)
190207	Hoody sweater Serpent black-zip (4XL)
190215	T-shirt Serpent WC edition black (S)
190216	T-shirt Serpent WC edition black (M)
190217	T-shirt Serpent WC edition black (L)
190218	T-shirt Serpent WC edition black (XL)
190219	T-shirt Serpent WC edition black (XXL)
190220	T-shirt Serpent WC edition black (XXXL)

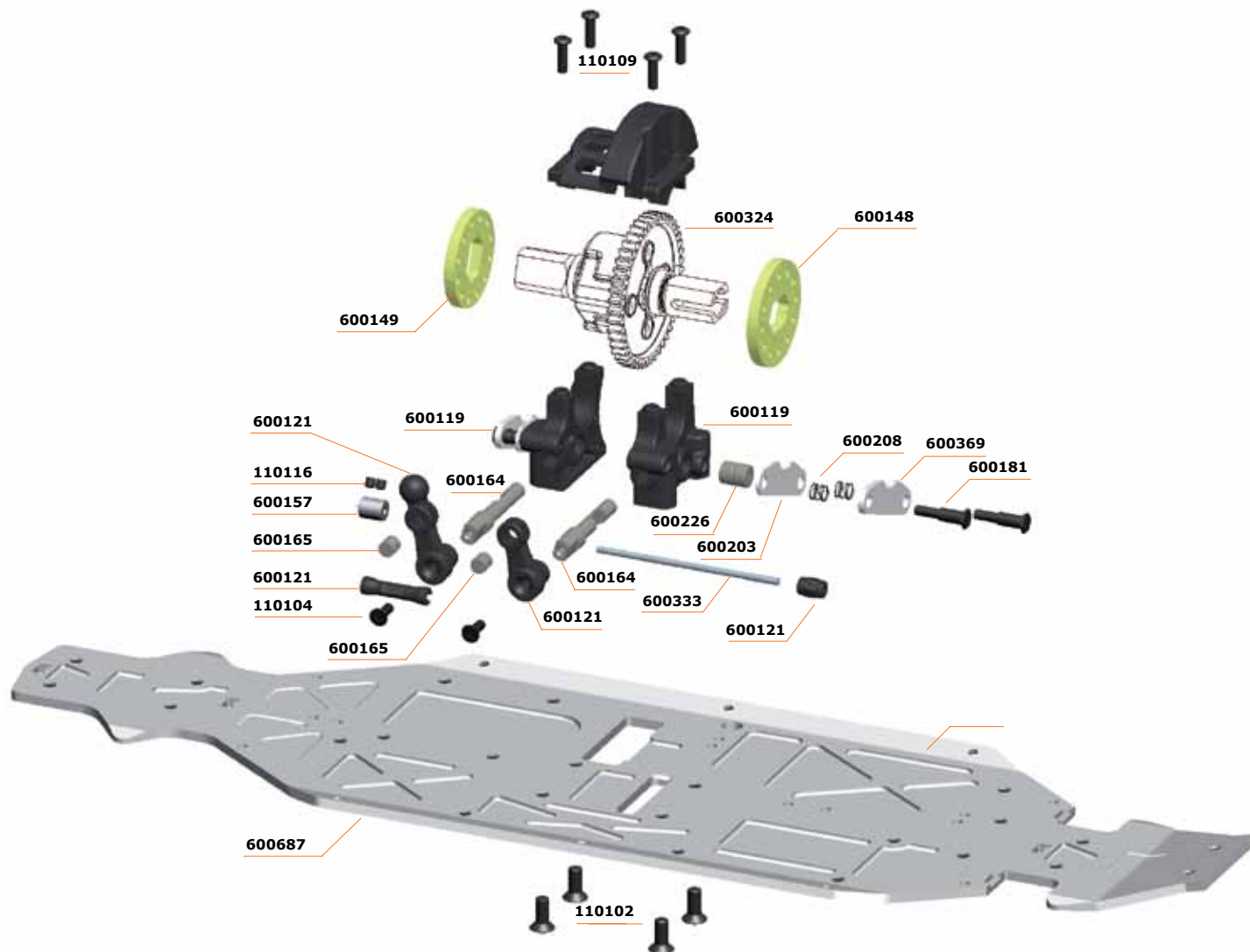







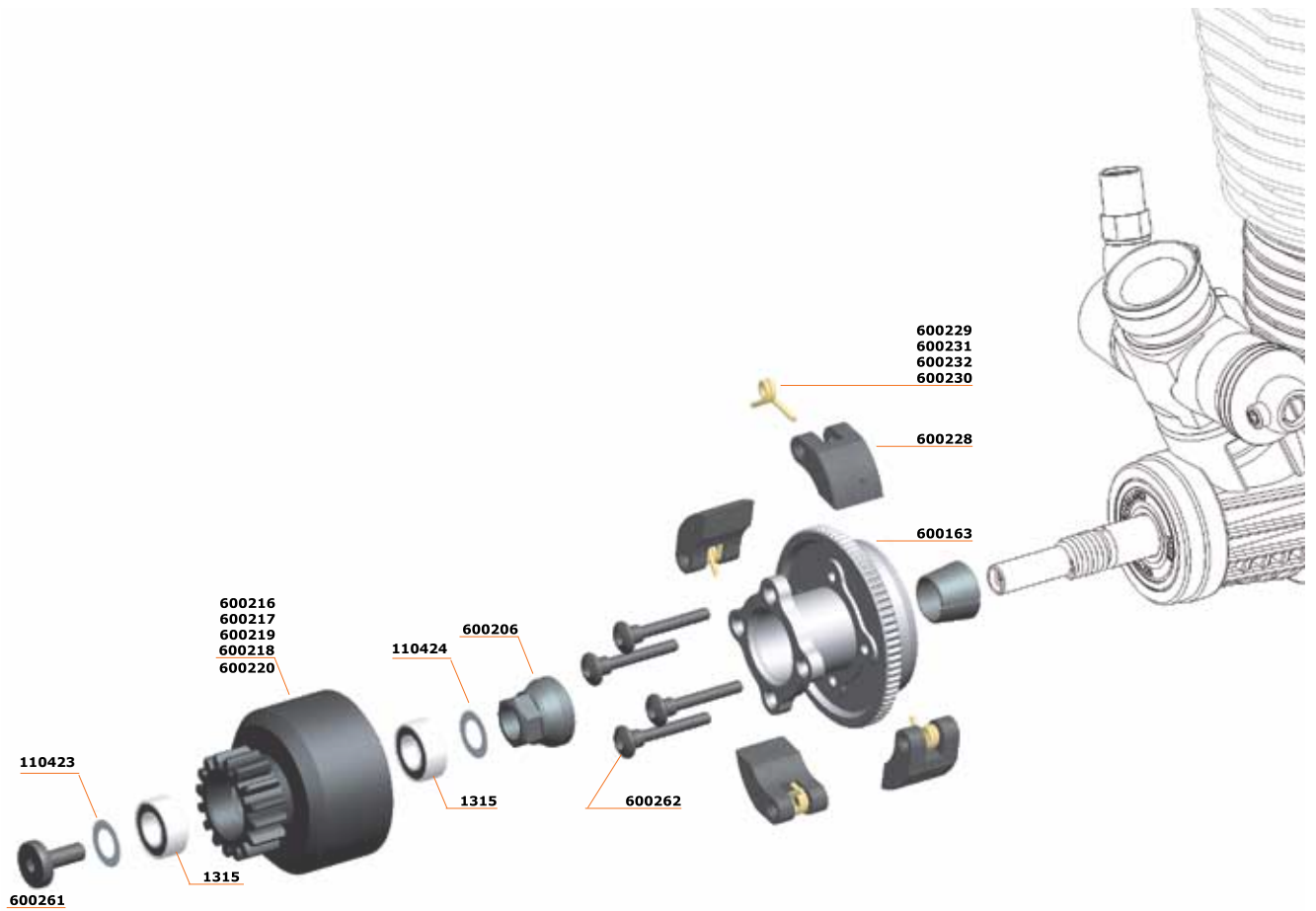
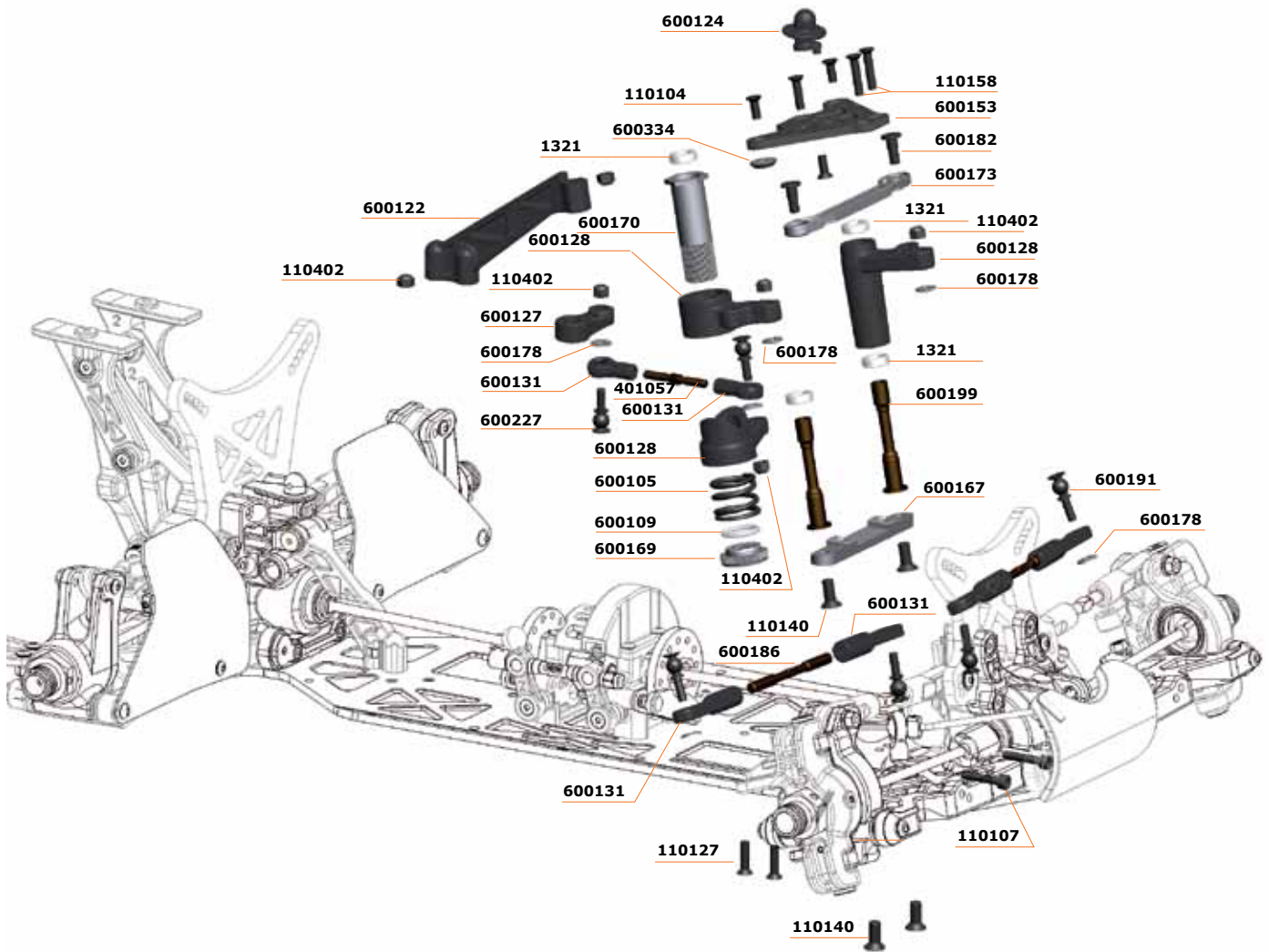





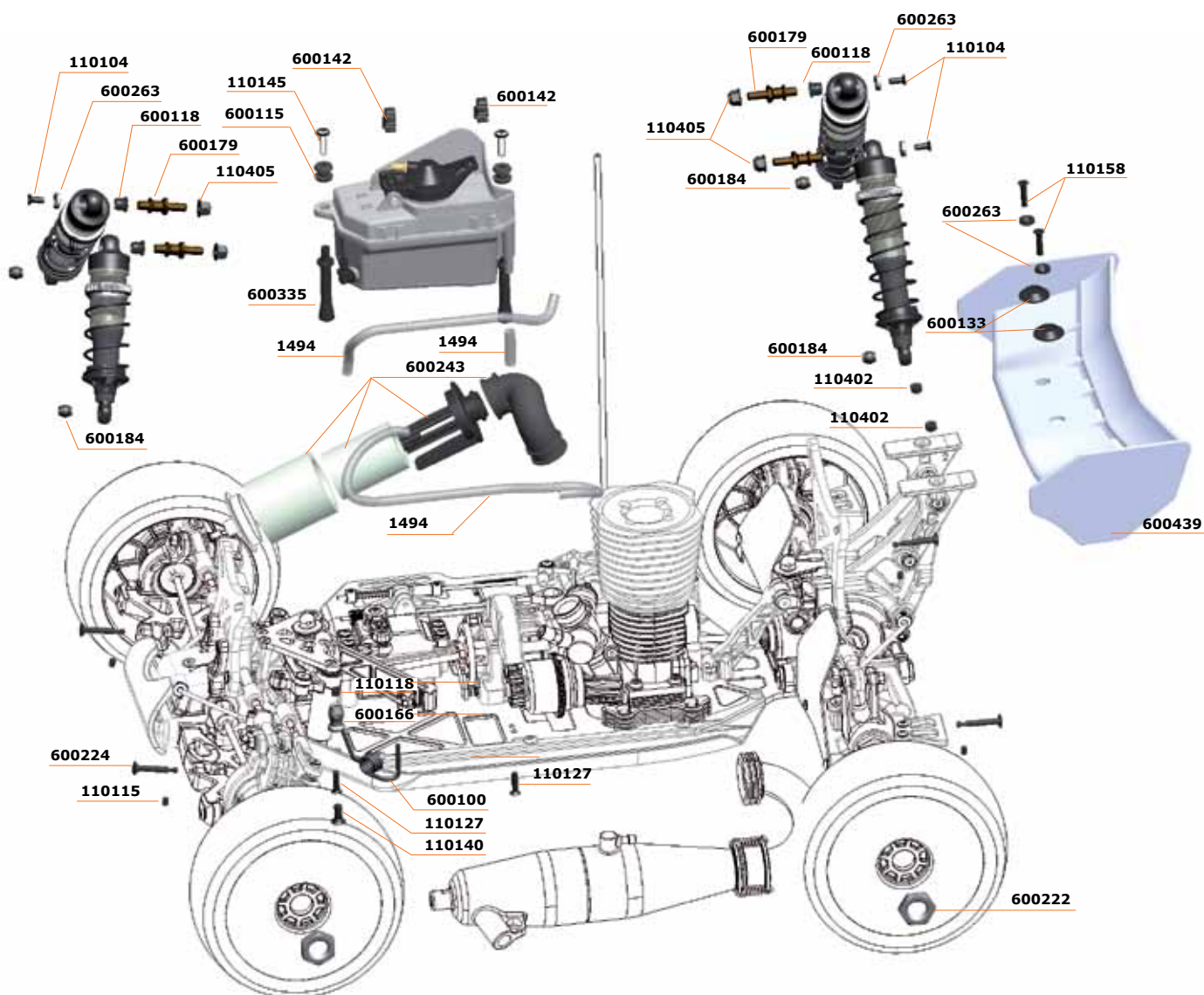
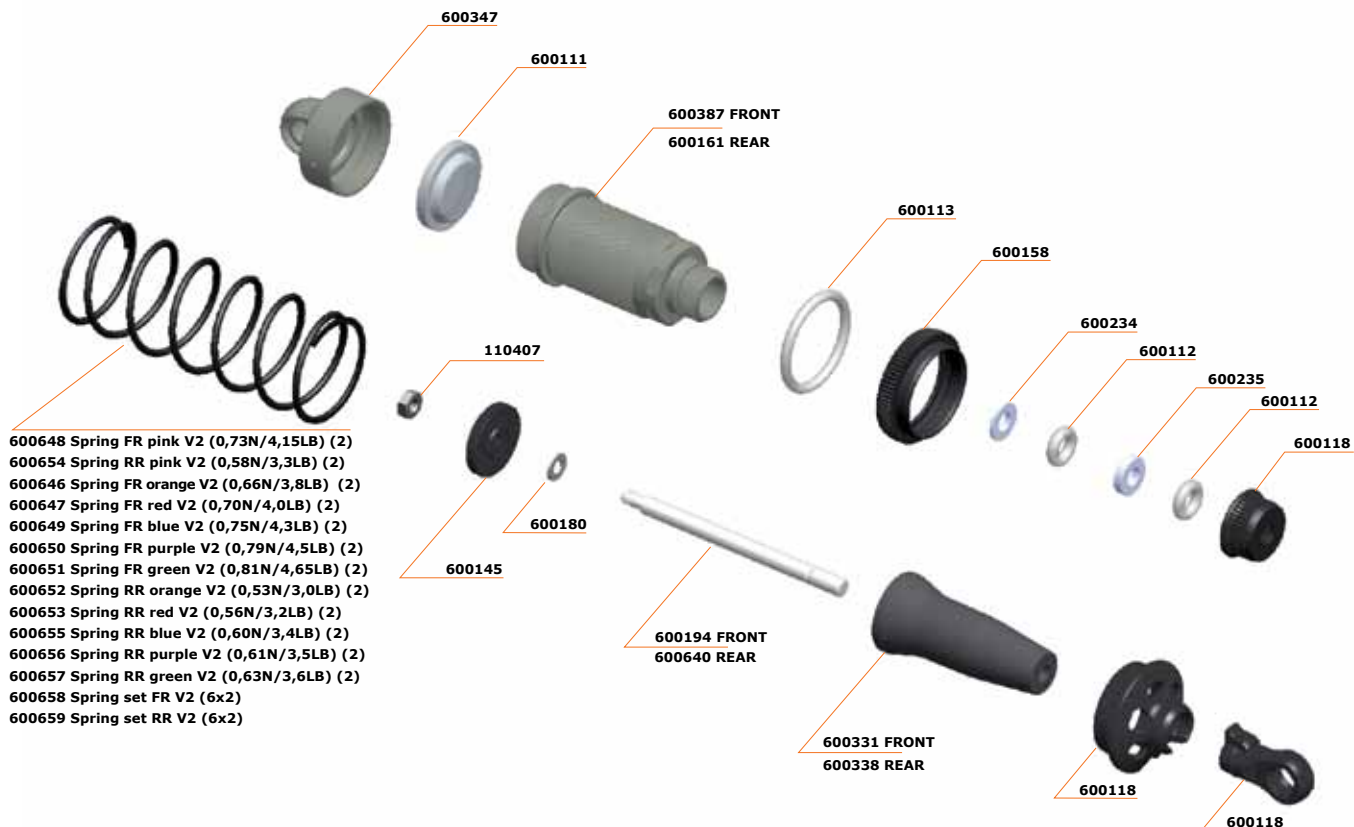

2.1  
COBBE



[www.serpent.com](http://www.serpent.com)  
[info@serpent.com](mailto:info@serpent.com)

