

STEP 1

This manual shows the assembly steps of a 3 gear upright transmission (for LMT = low-mid traction) in a Spyder SRX2 MM car.

The 3 gear upright version is a little harder to drive and more aggressive compared to the standard 4 gear upright transmission.

Which version to use depends on type of driver and traction.

Team Serpent

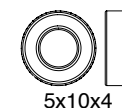

STEP 2

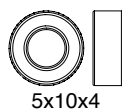
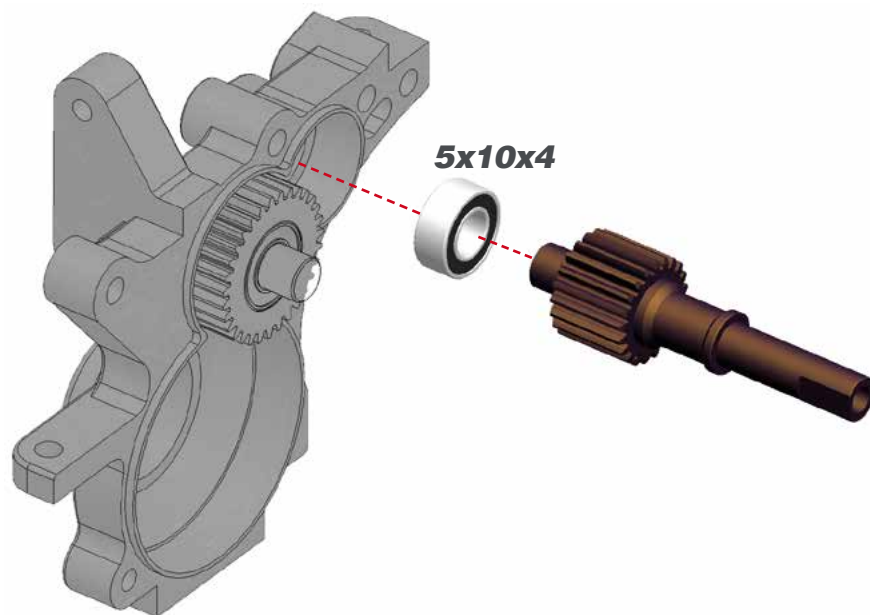

STEP 3

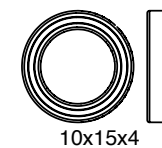
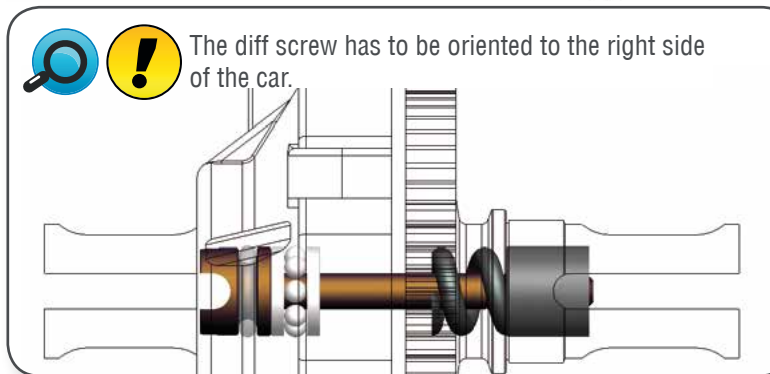
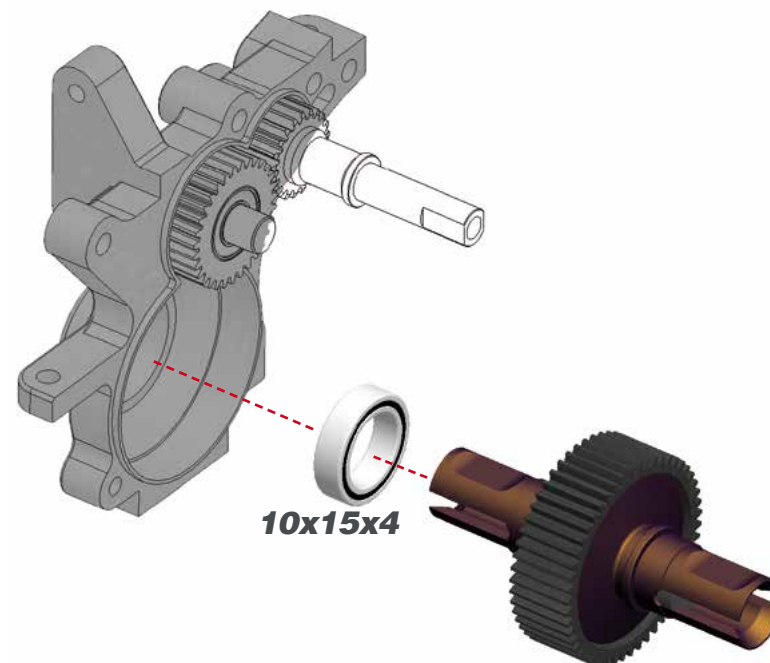

STEP 4

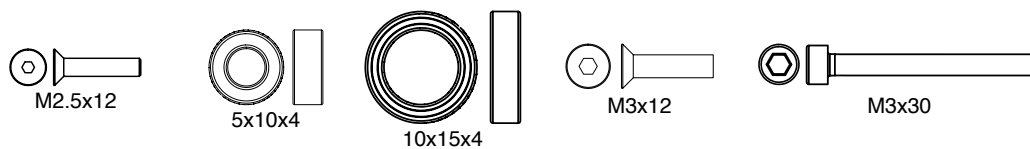
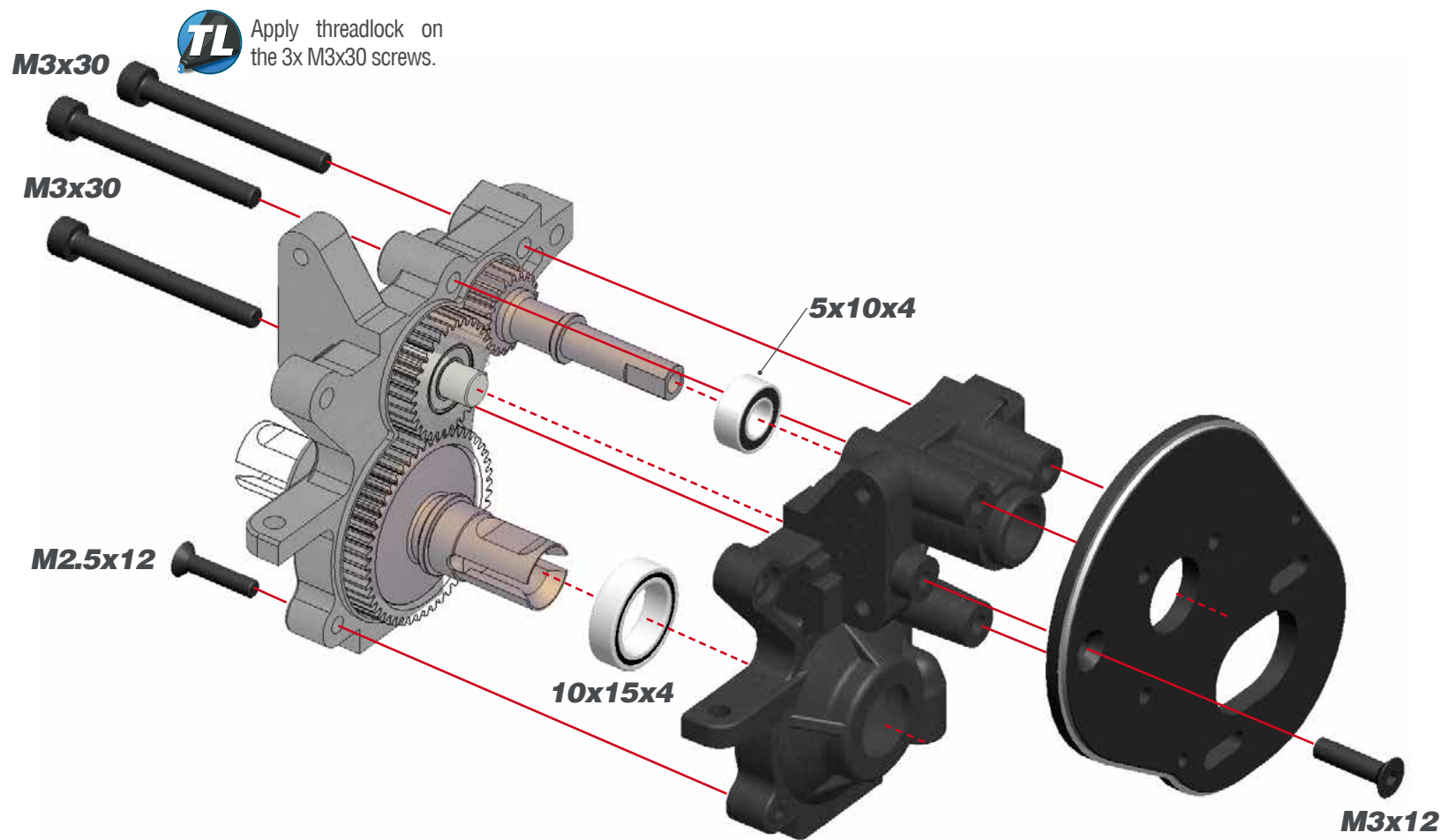

STEP 5

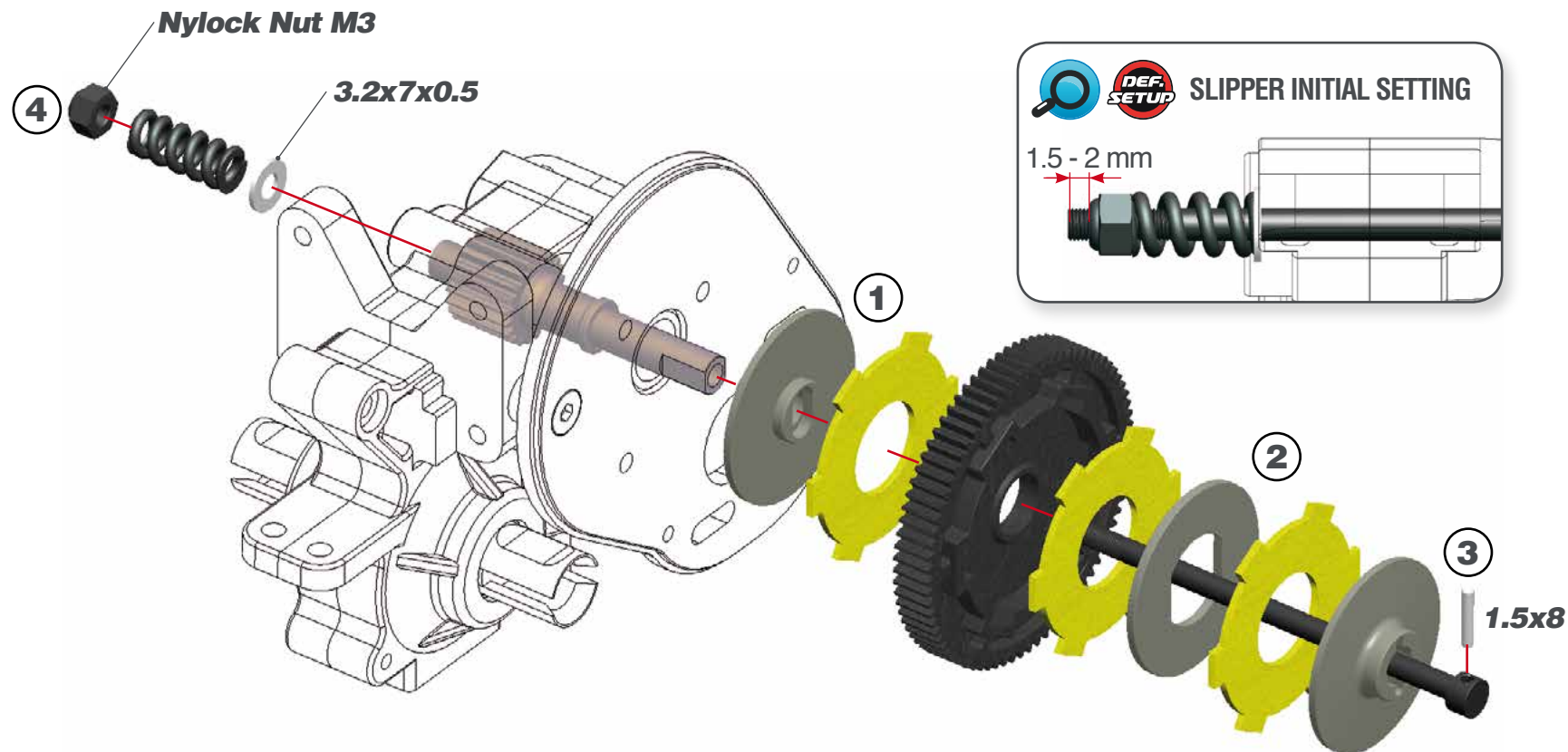

STEP 6

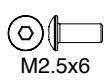
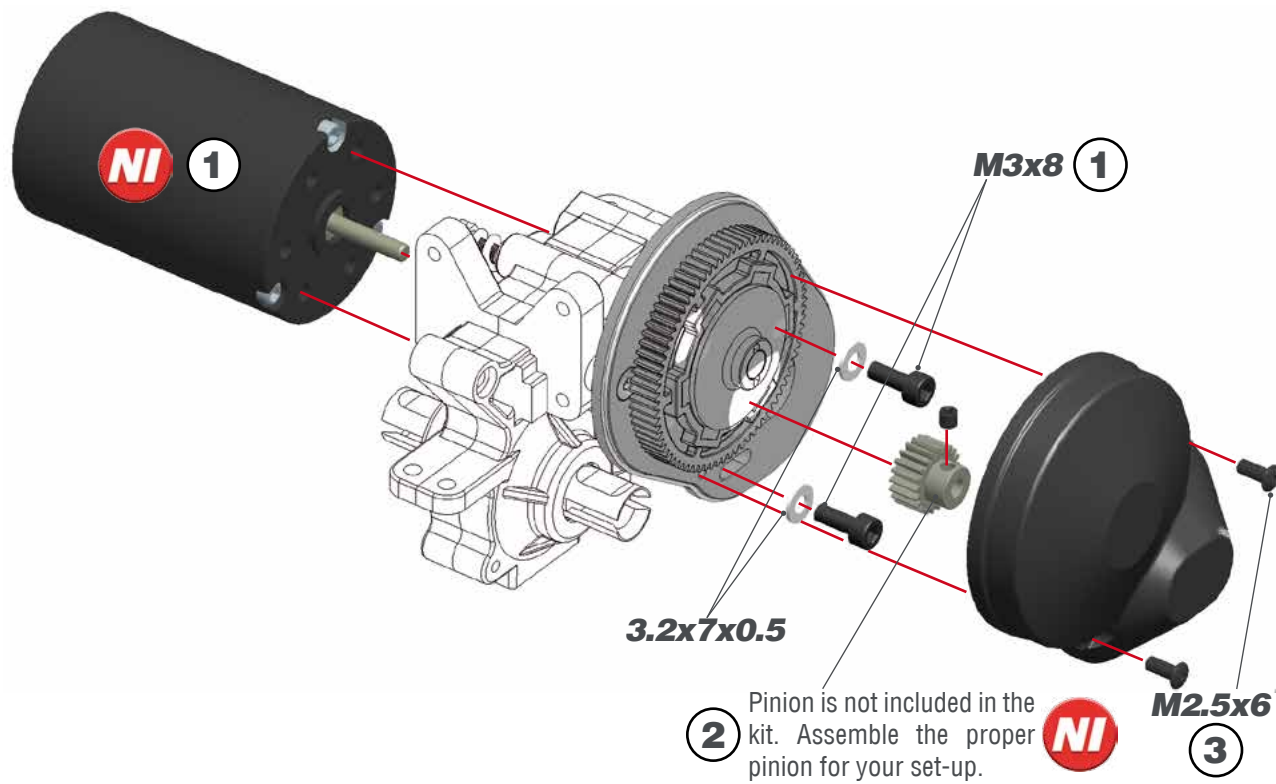

STEP 7

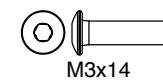
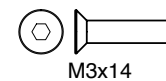
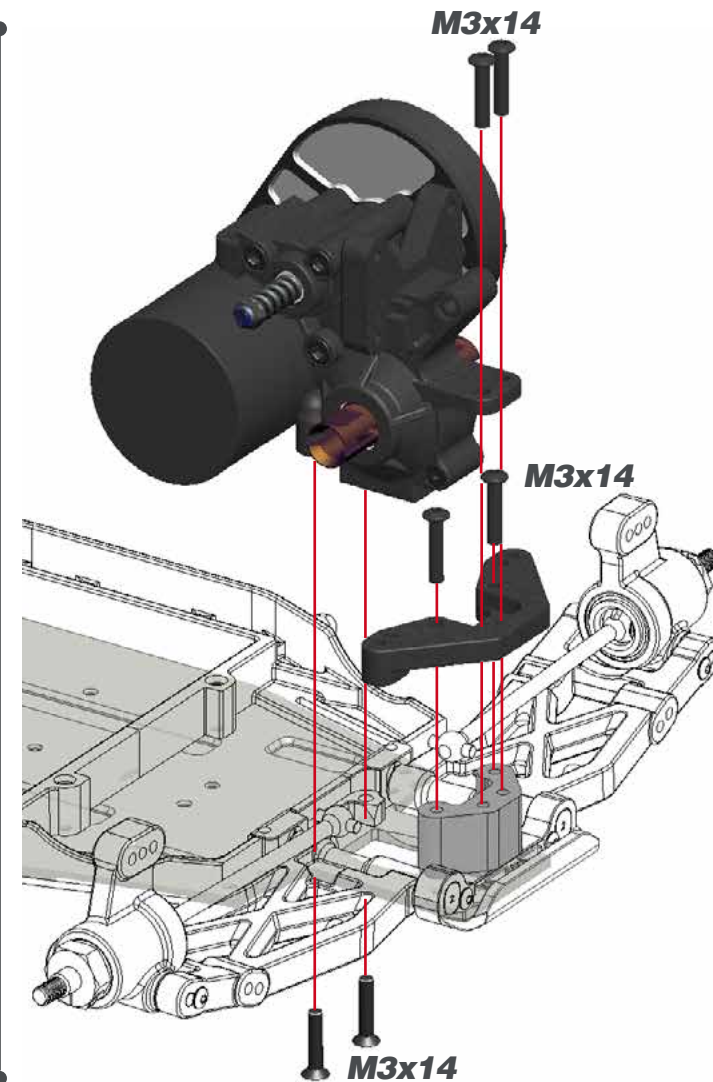

#500506 Upgrade-set 3-gear trans SRX2 MH

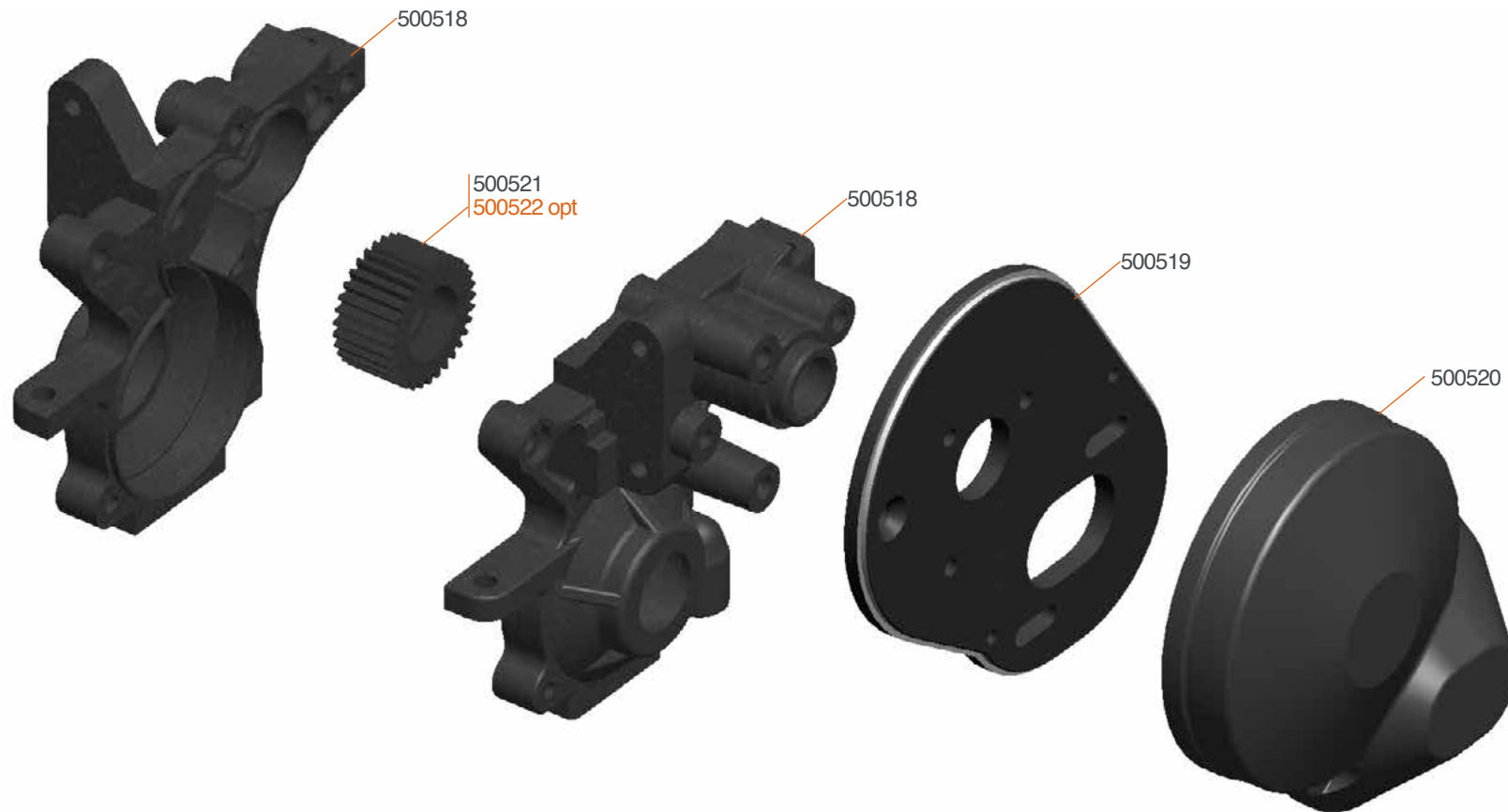

500522 Idler gear 41T alu 3 gear SRX2 MH