

## STEP 1

### 1.1

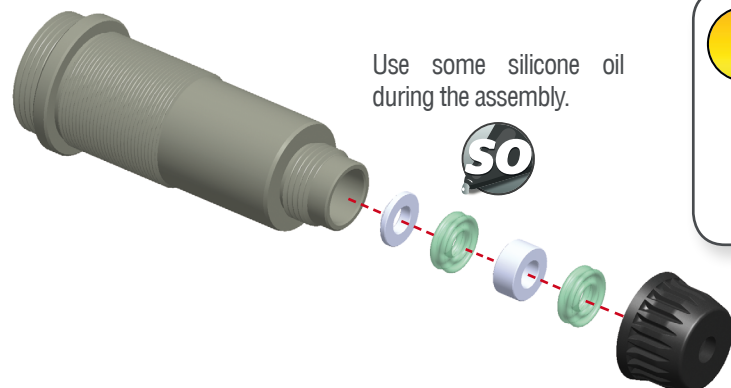

### 1.2

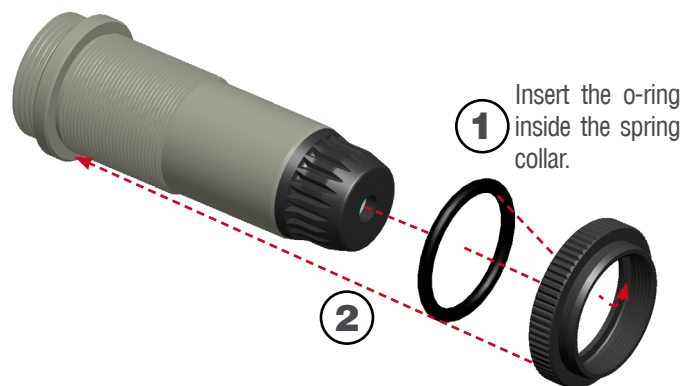

## STEP 2

### 2.1

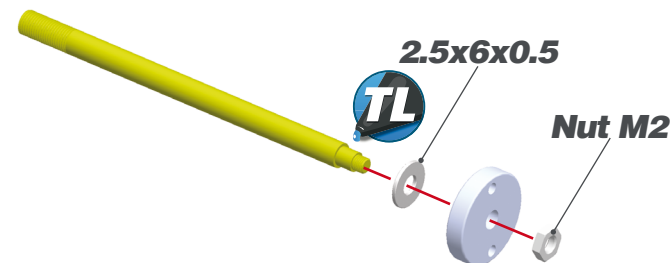

### 2.2



### SHOCKS BALLJOINTS

The SRX and SDX balljoint are different, please use the correct one for your car.

SRX

SDX

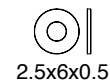

## STEP 3

### 3.1

1- Fill up with silicone oil fully using the silicone oil supplied in the kit. For the correct cst value please check the default setupsheet.

2- Extend the shockrod fully

3- Move the shockrod slowly up and down to let ALL air bubbles escape.

4- Apply the gasket and cap and close fully.



### 3.2

1-Bleed: push the shockrod all the way in slowly, to allow excessive oil to escape.

2- With shockrod fully in, mount the o-ring and screw.

M2.3x4



### SHOCKS LENGTH

Measure the shock length fully extended.

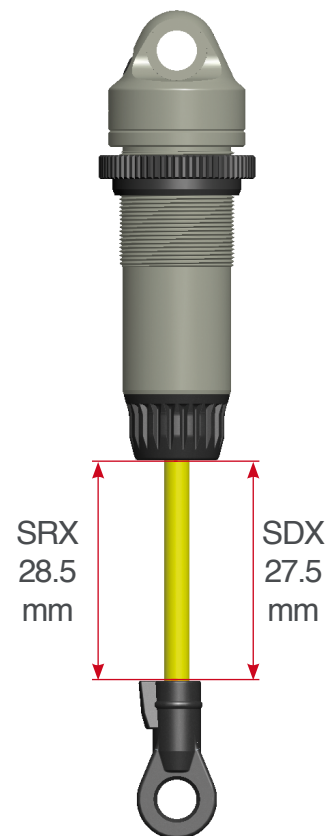

## STEP 4

Assemble the spring and spring-cup (align correctly) to complete the shock.

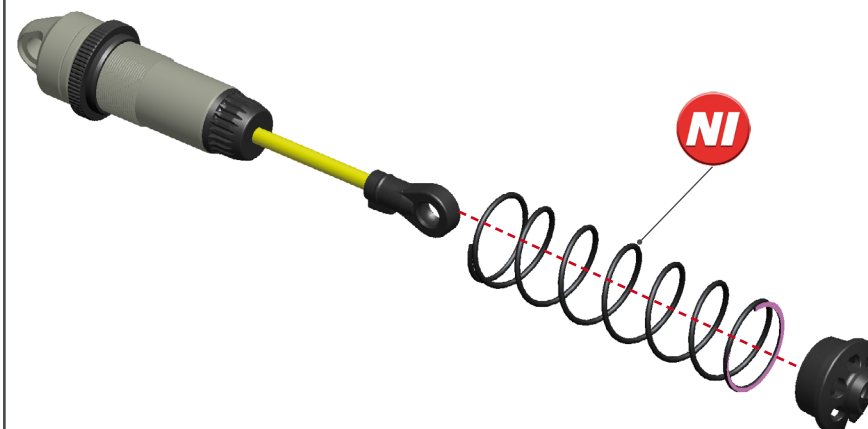

M2.3x4



- 500240 Shock piston conical 4 holes (4) SRX2  
500489 Shock piston square machined 3-hole 1.2 (4)  
500490 Shock piston square machined 4-hole 1.1 (4)  
500180 Shock membrame (4) SRX2