

STEP 26

26.1

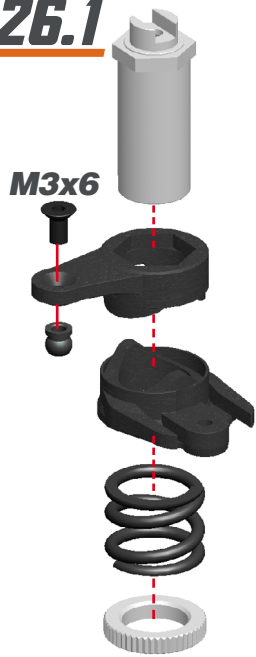

26.2

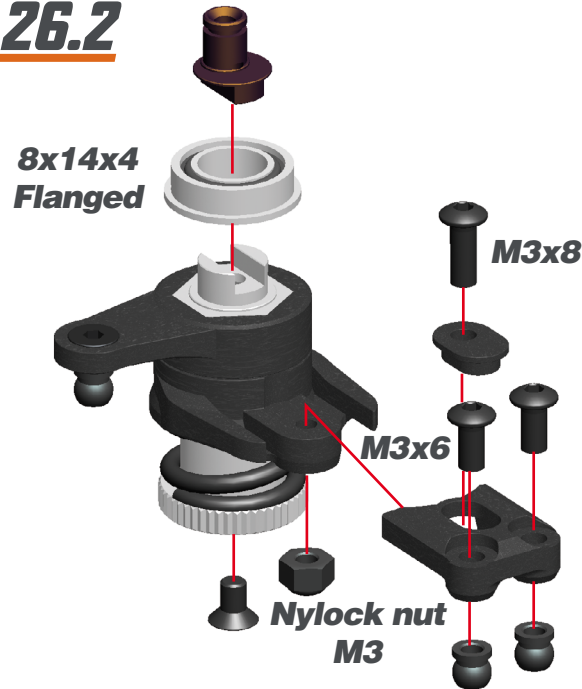

Preload the servo-saver-spring 1mm.

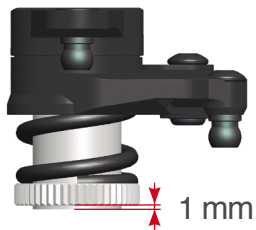

SERVO-SAVER ACKERMANN INSERTS

REARWARD MID FORWARD

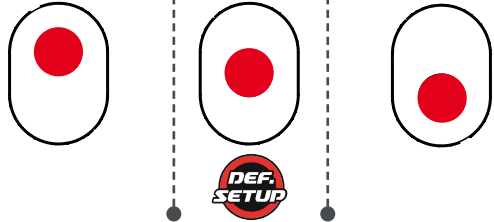

DTS SERVO-SAVER EXCENTERS

The Direct Tweak System changes the position of the front shock tower when the car is turning left or right increasing the weight of the inner wheel producing more steering. The amount the shock tower is moved can be adjusted with four excenters from "0" to "1.5". The "0" excenter has no effect, so the car will behave as with the standard configuration, and with the 1.5 it will be achieved the maximum steering which the DTS can bring to the car.

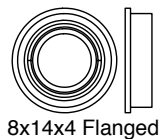
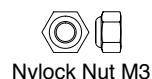
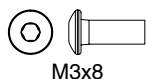
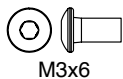
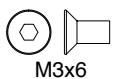
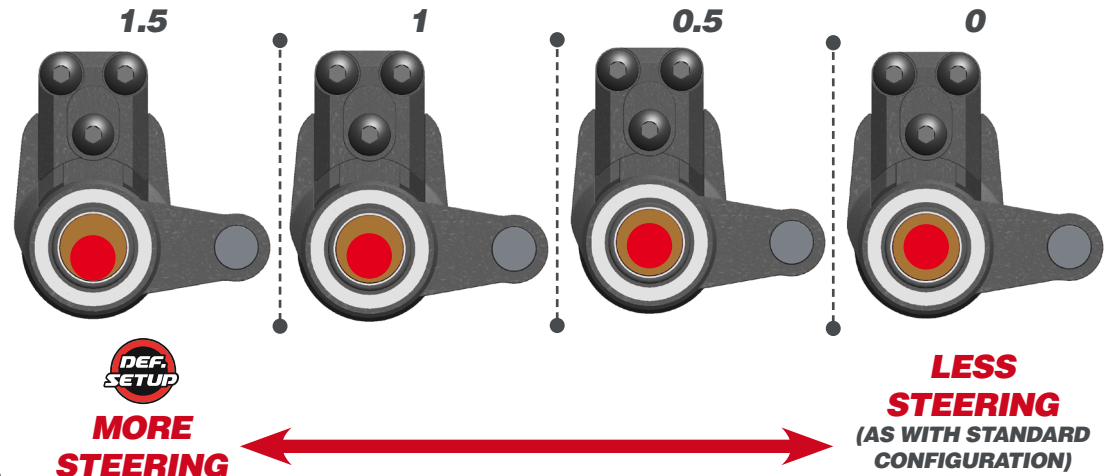

STEP 27

STEP 40

27.1

27.2

 **STEERING LINK LENGTH**

7.5 mm

6X10x3

M4X8

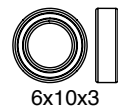
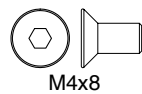

M3x12

M3x12

M3X10

M3X10

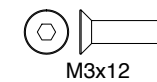
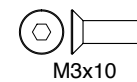

STEP 41

! Do NOT fully tighten the M3x20 screws.

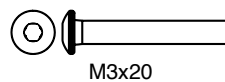
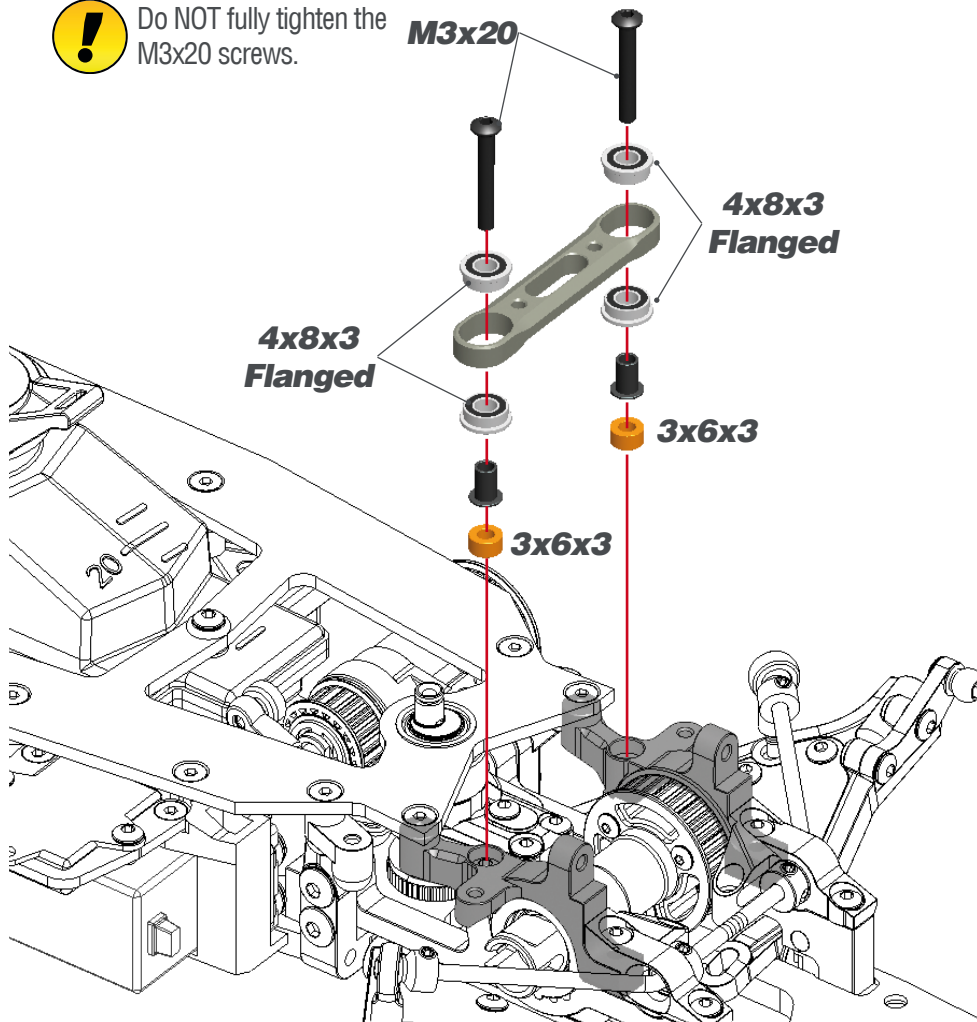

STEP 42

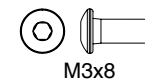
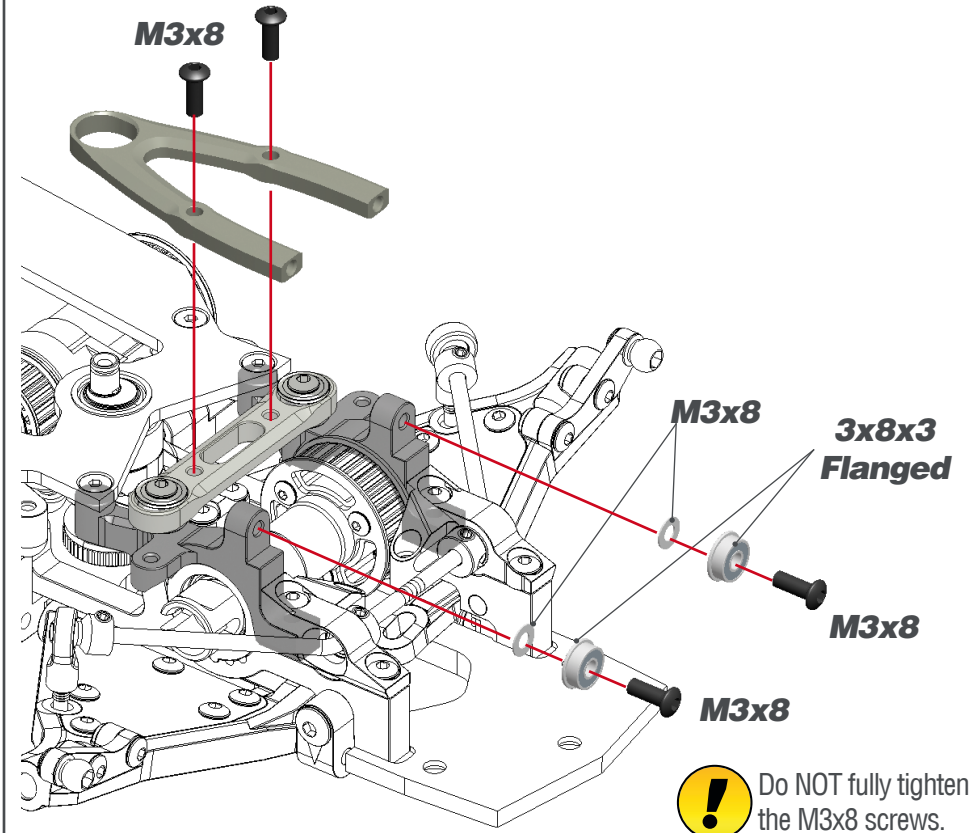

STEP 43

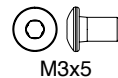
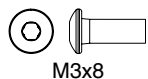
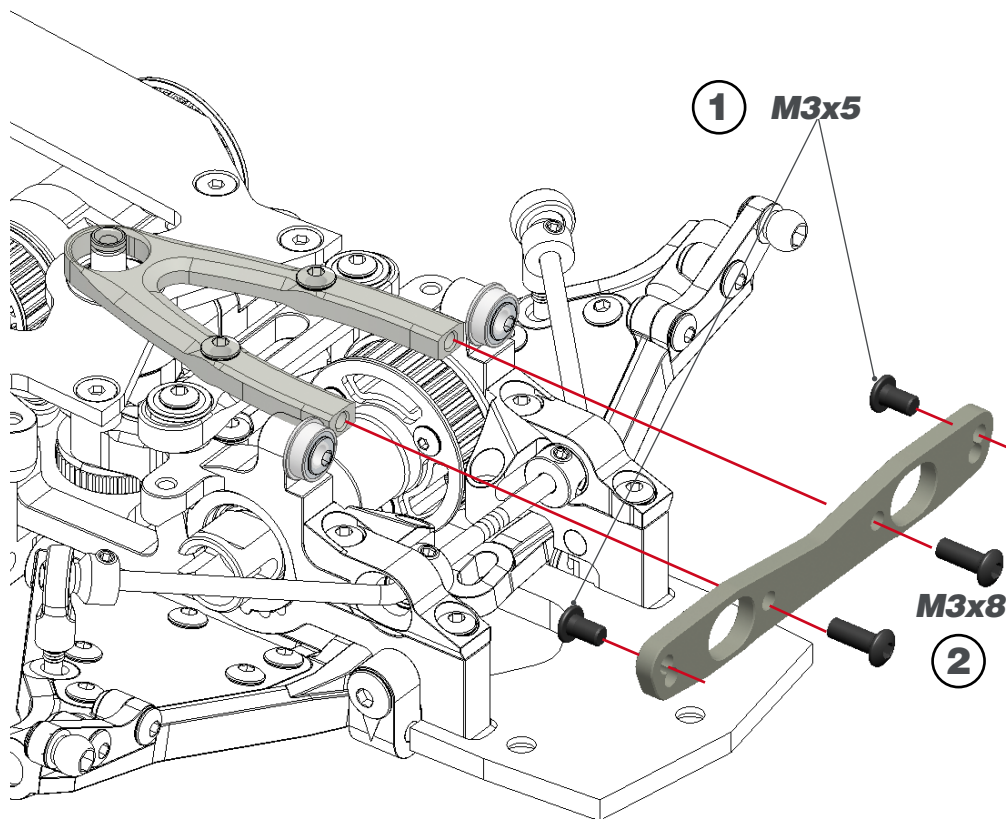

STEP 44



- 1- Fully tighten the M3x20 and M3x8 screws showed in the pictures shaded.
- 2- Make sure that the whole unit should move free without play with the screws fully tightened.

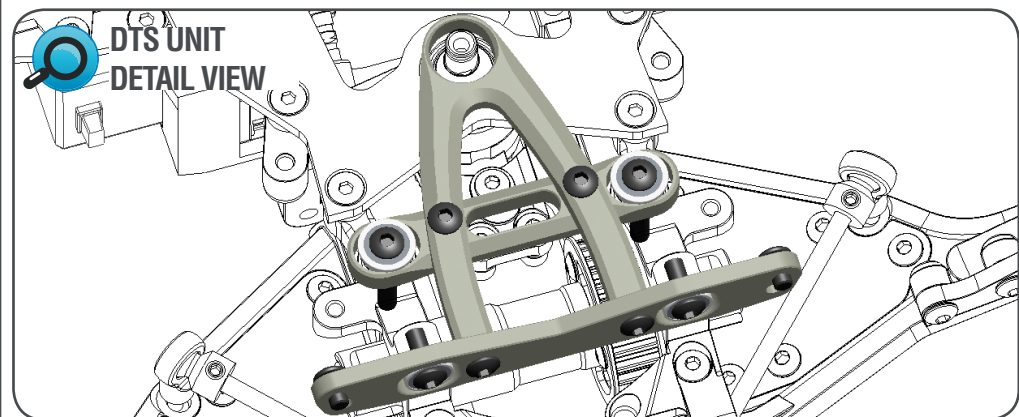
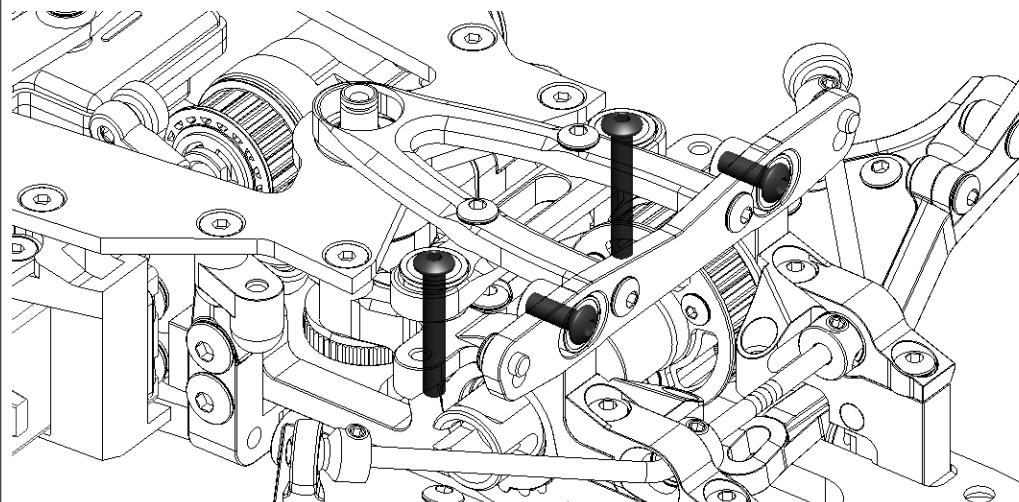

STEP 45

STEP 50

