

STEP 1

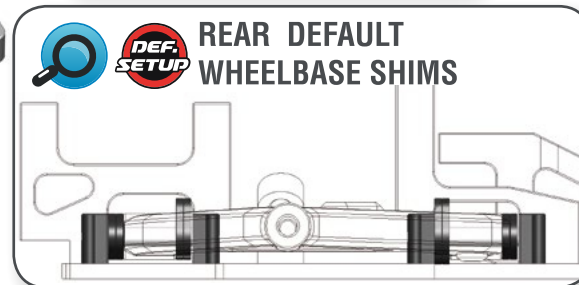

1.3

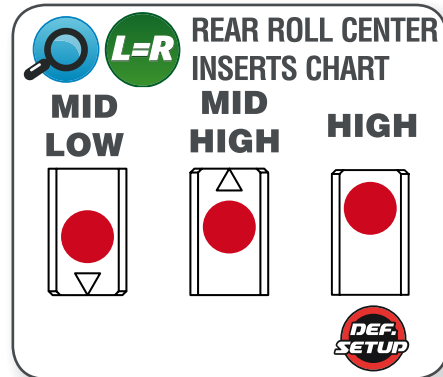
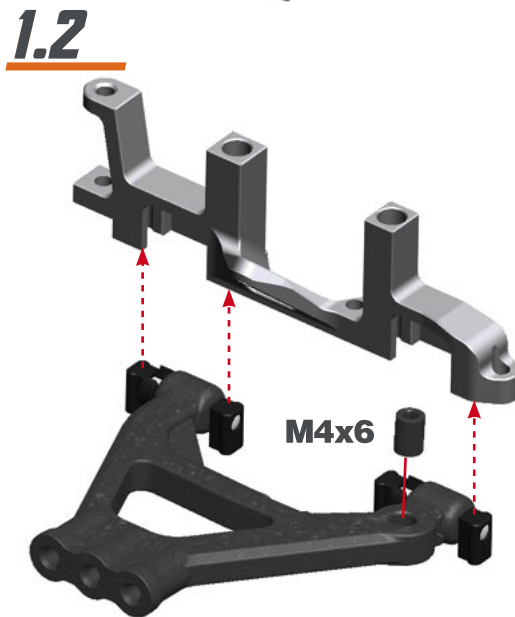
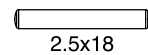
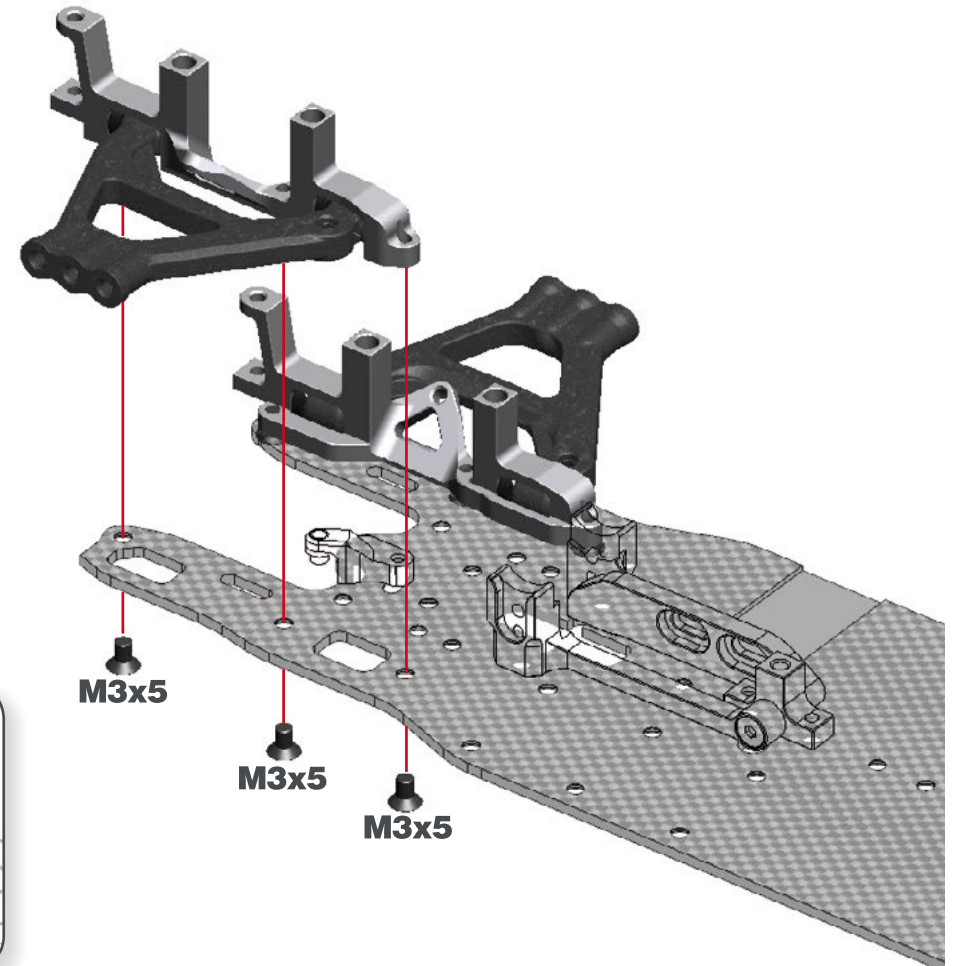

STEP 2

2.1



2.2

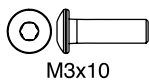
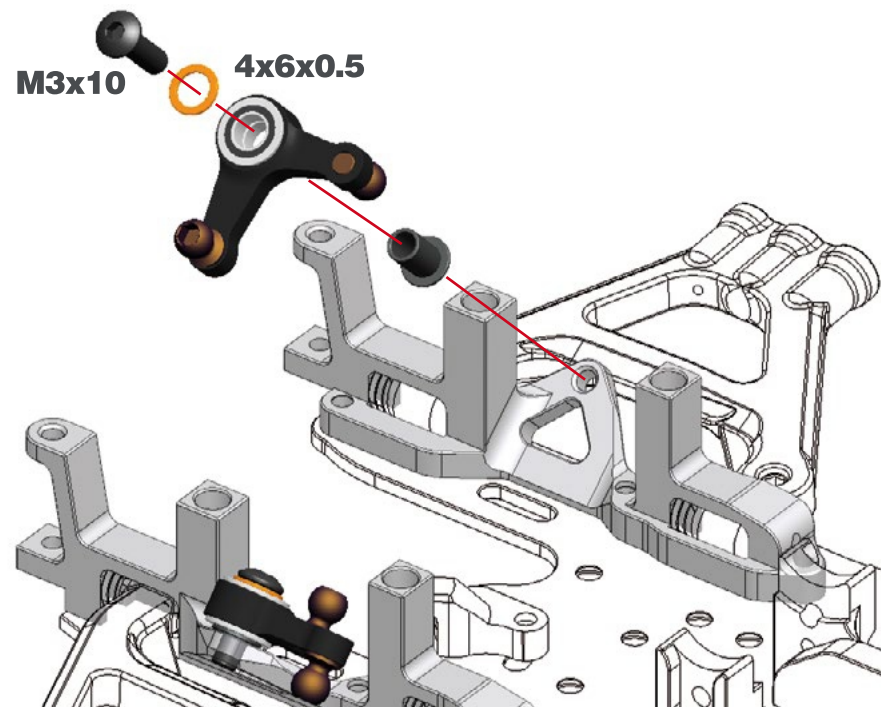

STEP 3

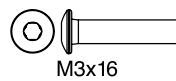
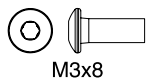
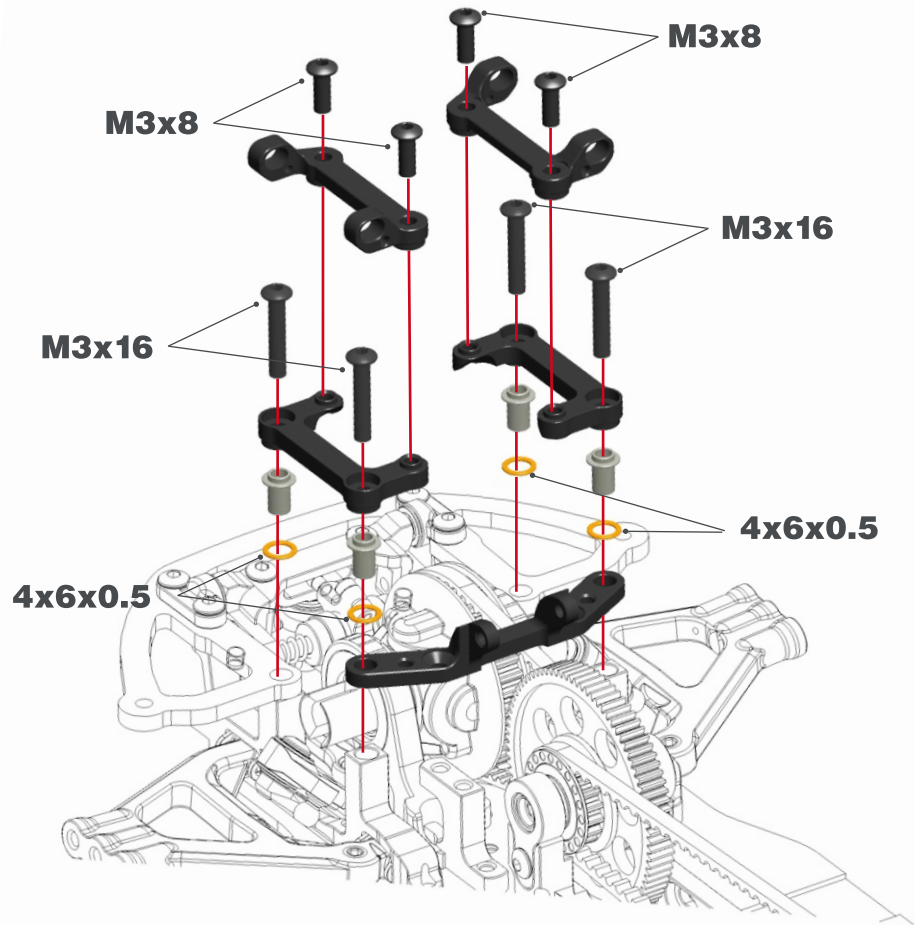

STEP 4

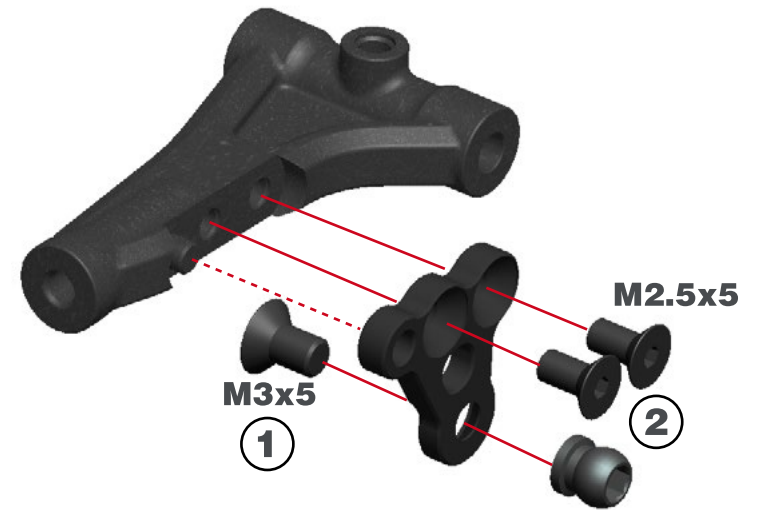

STEP 5

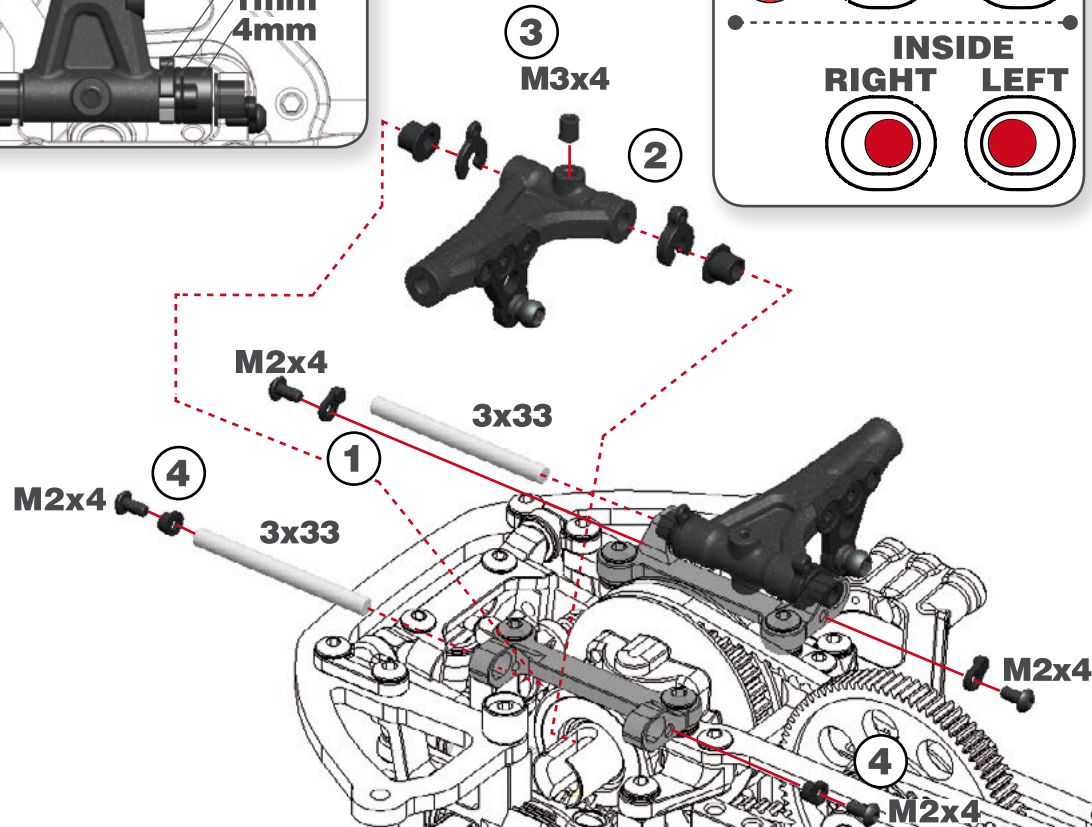
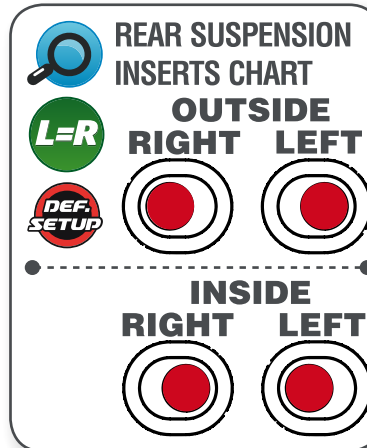

STEP 6

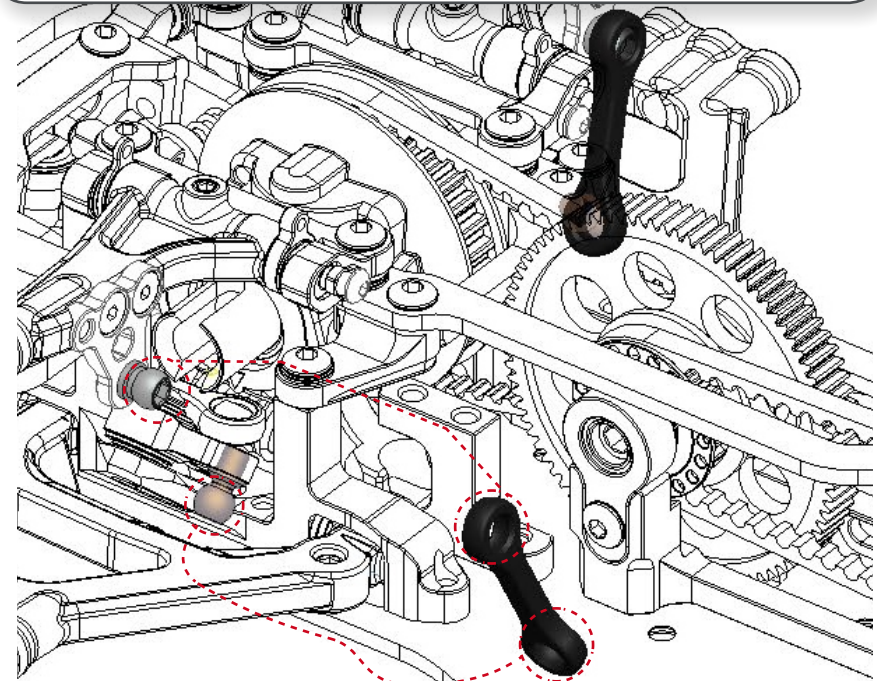
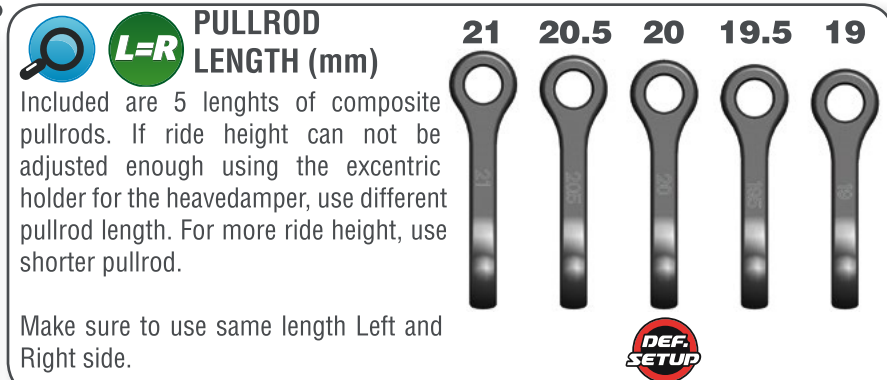

STEP 7

NO RRS (CONSTANT RR TOE IN) DEFAULT

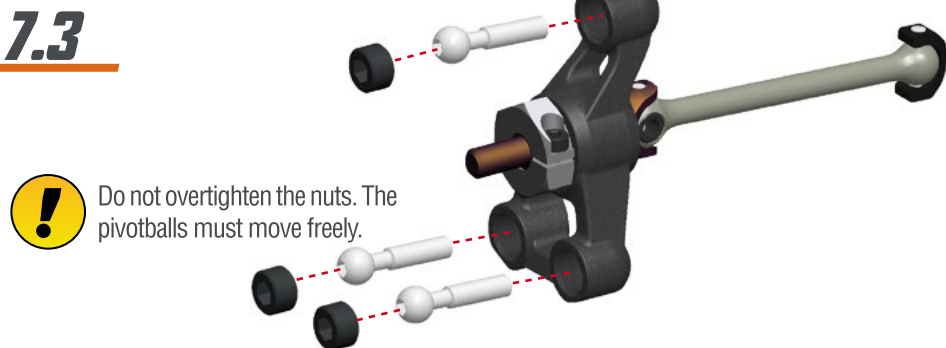
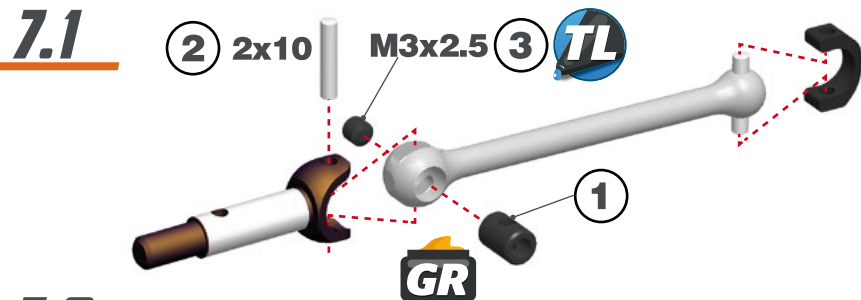

! Do not overtighten the nuts. The pivotballs must move freely.

M3x2.5

2x10

5x10x4

M2x5

RRS (ACTIVE RR TOE IN) OPTIONAL

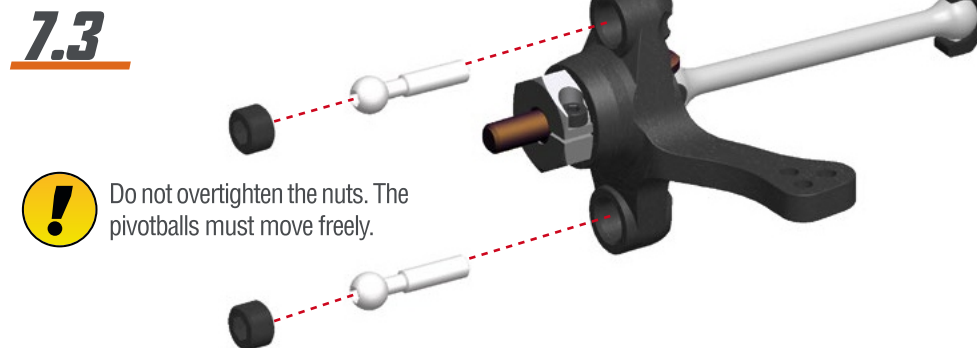
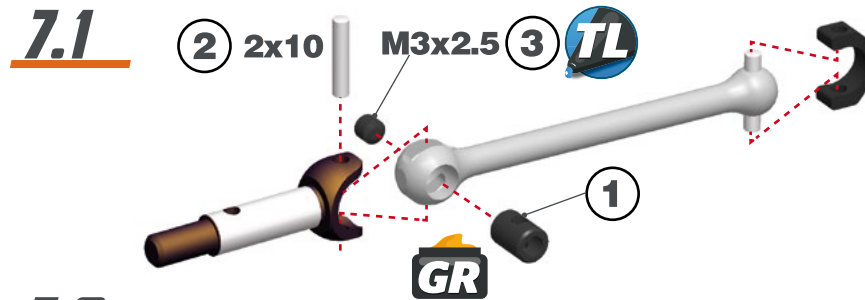

! Do not overtighten the nuts. The pivotballs must move freely.

M3x2.5

2x10

5x10x4

M2x5

STEP 8

NO RRS (CONSTANT RR TOE IN) DEFAULT

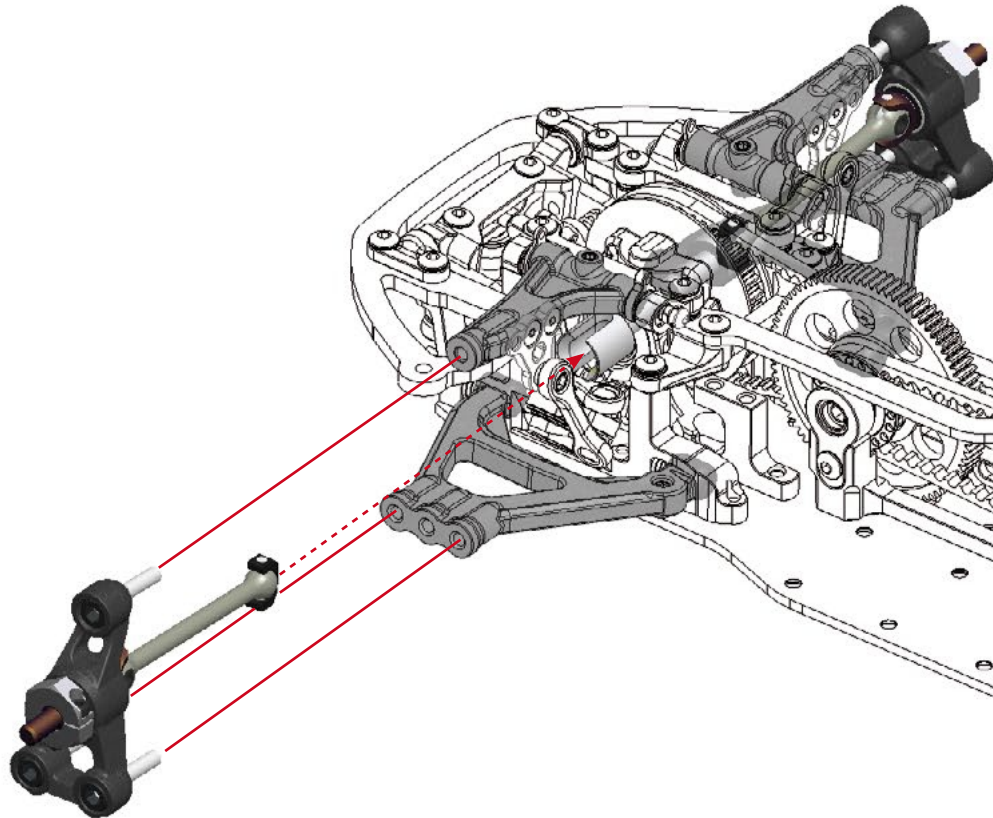

RRS (ACTIVE RR TOE IN) OPTIONAL

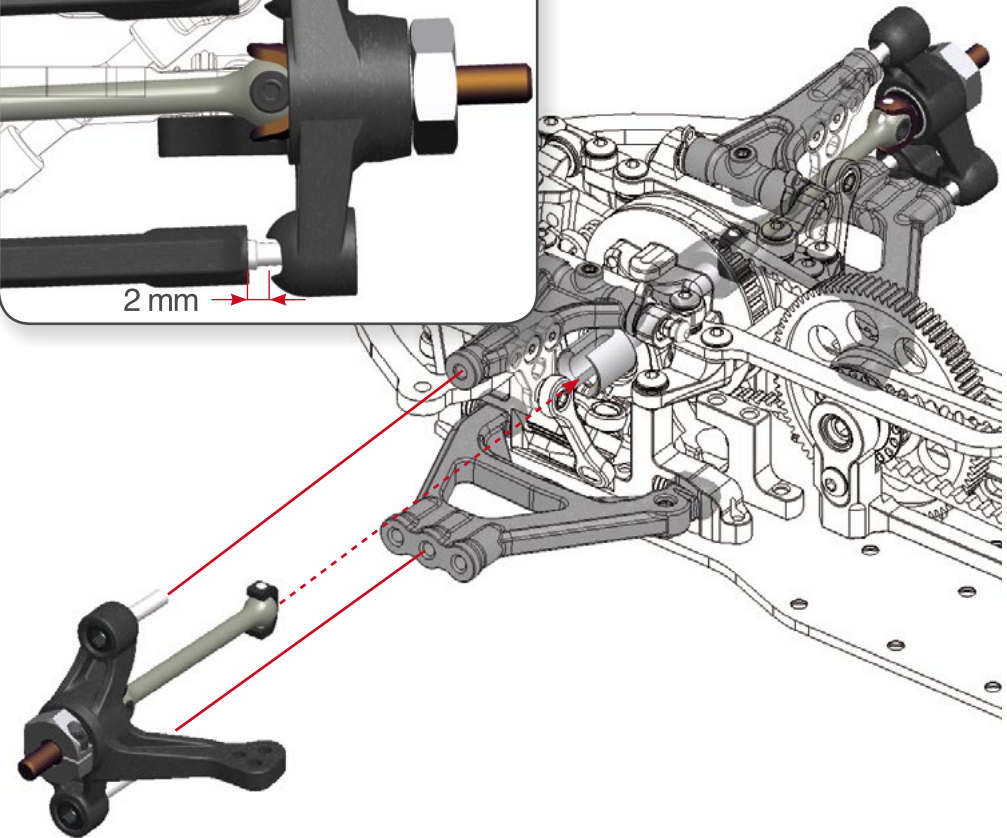
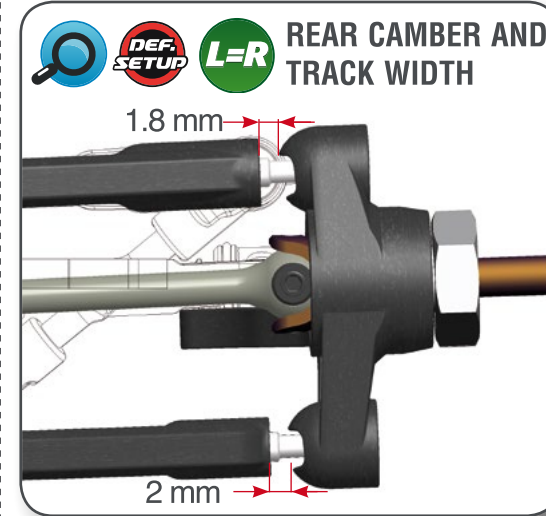

STEP 9

RRS (ACTIVE RR TOE IN) **OPTIONAL**

9.1

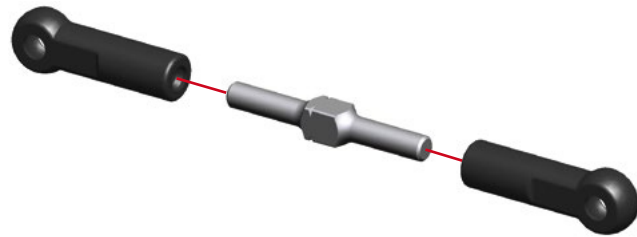
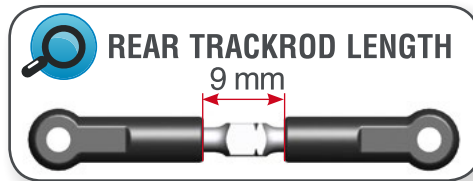

9.2

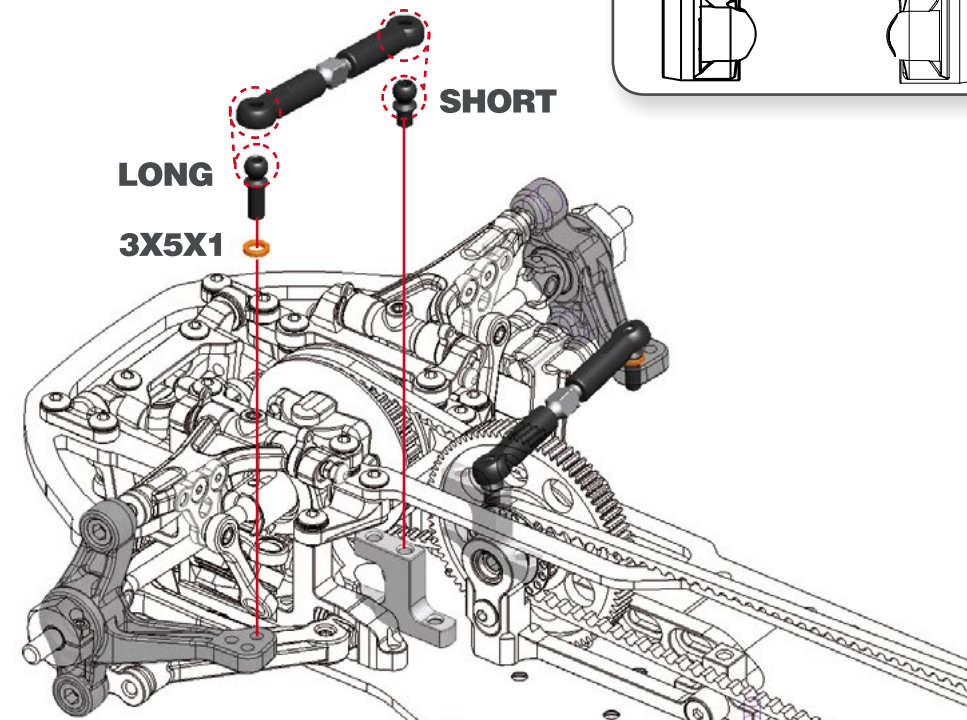
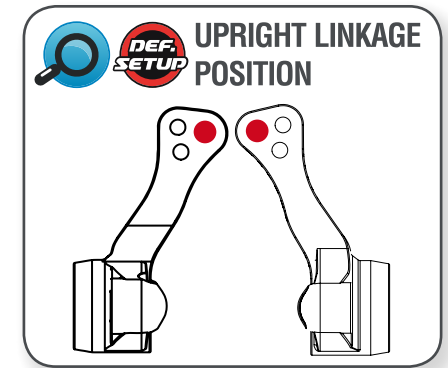

3x5x1

REAR / EXPLODED VIEW

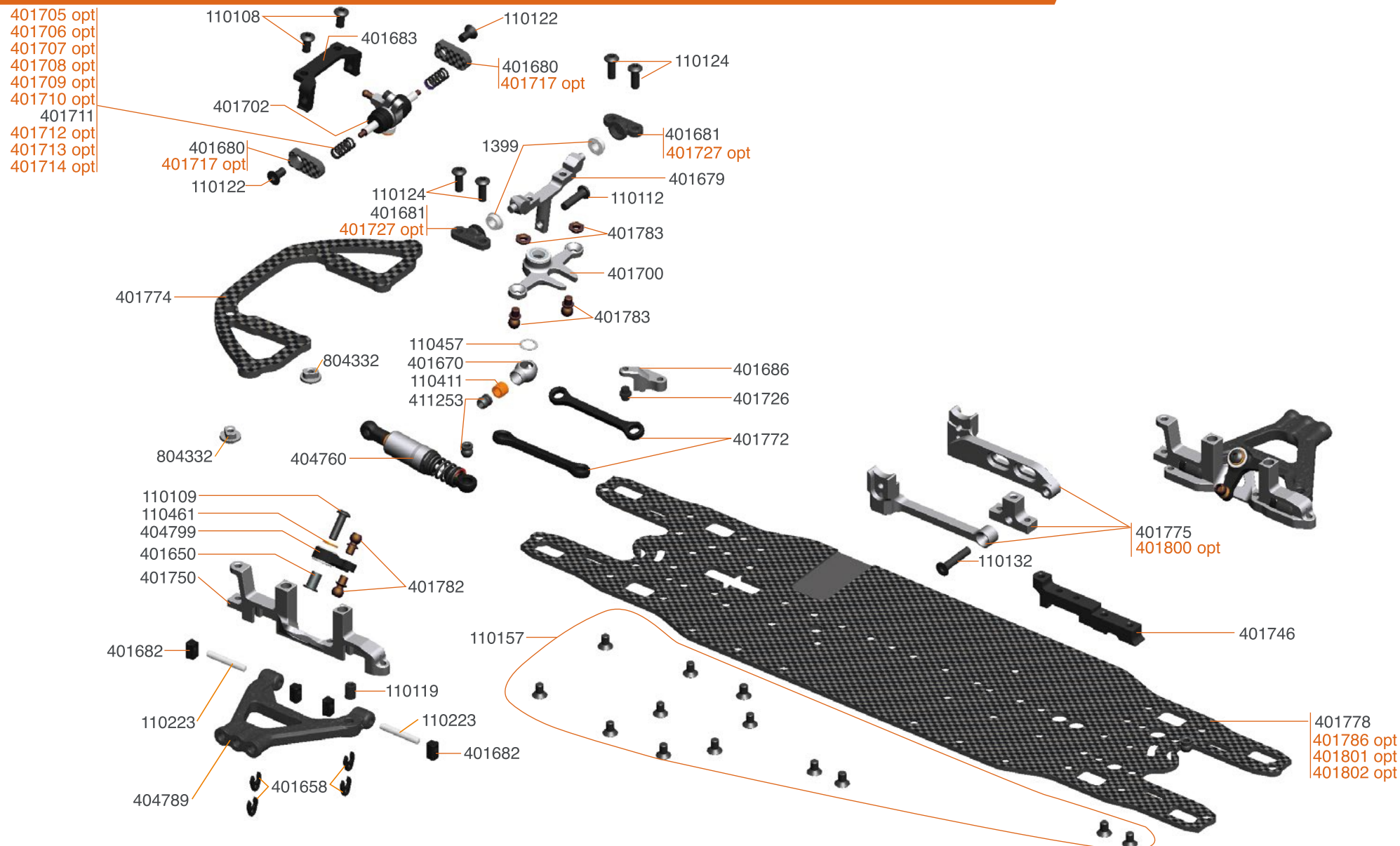

401701 Roll damper set 4-X
401705 Spring white C4.4 4-X (2)
401706 Spring yellow C4.9 4-X (2)
401707 Spring orange C5.5 4-X (2)
401708 Spring red C6.3 4-X (2)
401709 Spring pink C6.9 4-X (2)

401710 Spring blue C7.6 4-X (2)
401712 Spring green C9.5 4-X (2)
401713 Spring grey C10.9 4-X (2)
401714 Spring black C12 4-X (2)
401717 Roll damper support -7mm carbon 4-X (2)
401727 Bearing holder central rocker alu 4-X (2)

401786 Chassis alu 2mm 4X EVO
401800 Motormount set 4X PROz
401801 Chassis arrowspace magnesium stiff 4X
401802 Chassis arrowspace magnesium flex 4X

REAR II EXPLODED VIEW

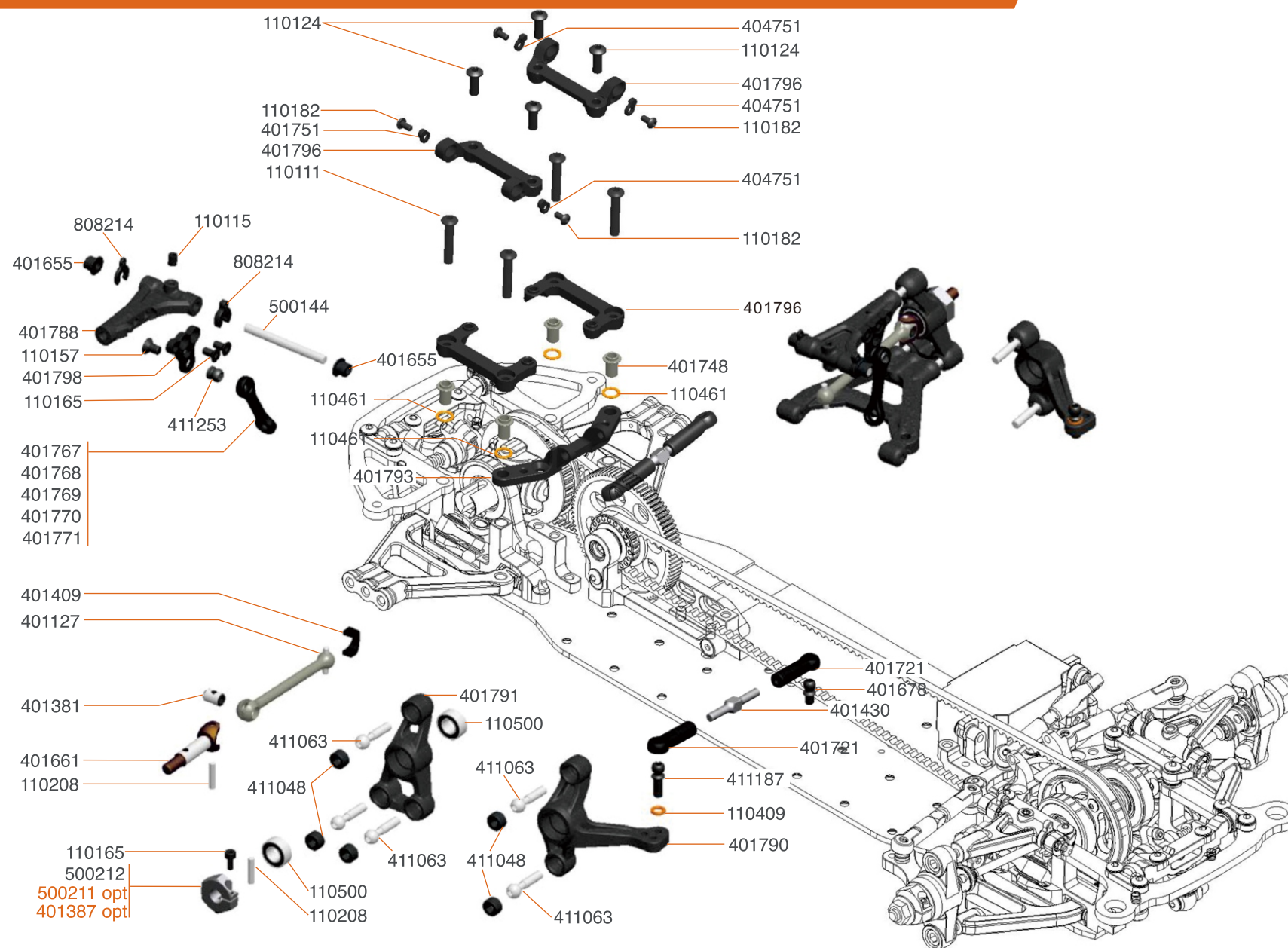

401387 Wheelhexagon 1mm offset (2)
500211 Wheelhexagon +0.75mm offset (2)