

10. CLUTCH ASSEMBLY

10.1

NOTE: the clutch assembly is designed for use with engines with a crankshaft with an extended 5mm clutch-end such as the Nova MEGA SX-12E.

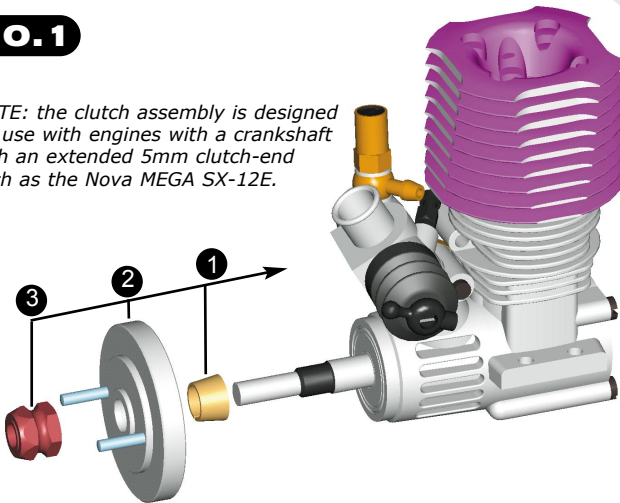

Mount the flywheel on the crankshaft. Tighten the clutch nut firmly while holding the flywheel in a vise or with large pliers.

10.2

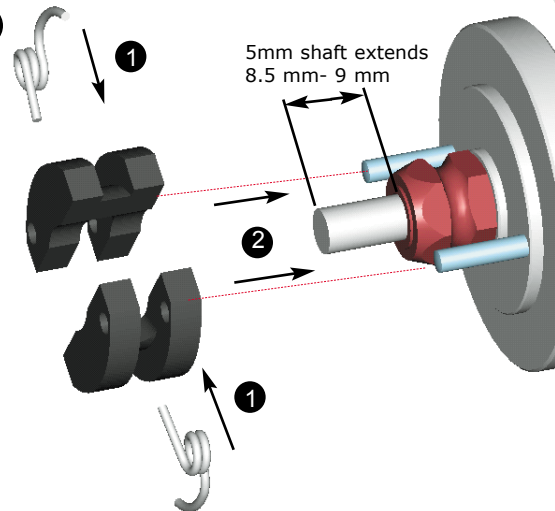

1. Place the clutch springs in the clutch shoes.
2. Press the clutch shoes atop the pins on the flywheel.

10.3

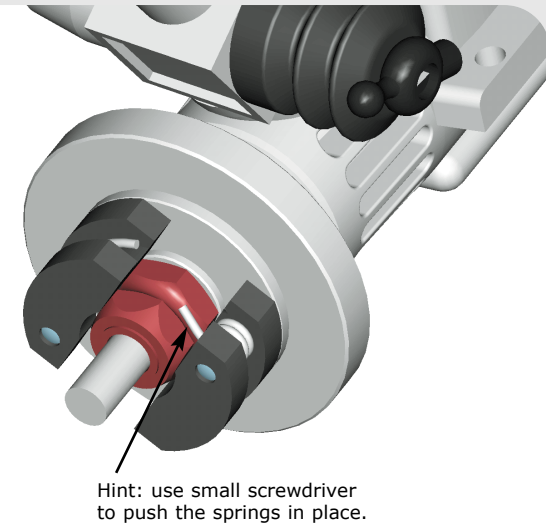

Clutchshoes in assembled position

10.4

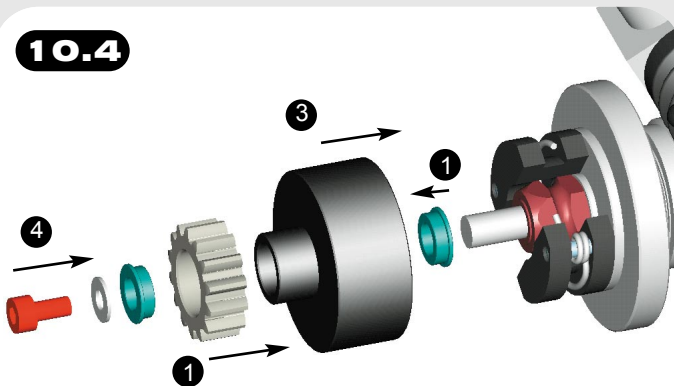

1. Thread the alum. pinion onto the clutch housing.
2. Insert ballbearings V3 into clutch housing.
3. Slide clutch housing onto crankshaft
4. Secure with screw F10 and shim N3.

10.5

NOTE: use some Locktite to prevent the screws from coming loose.

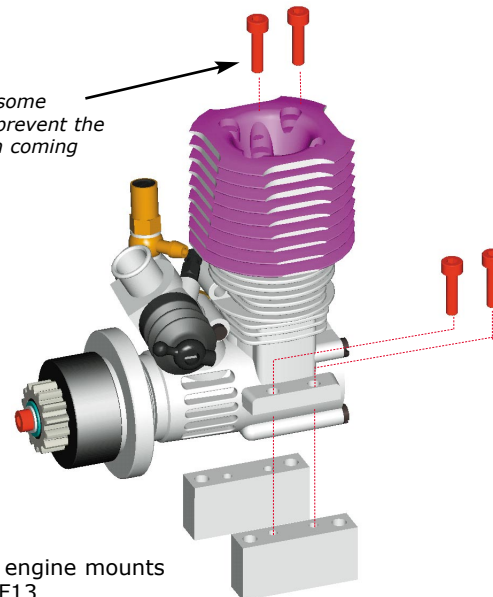

Assemble the engine mounts using screw F13.

10.6

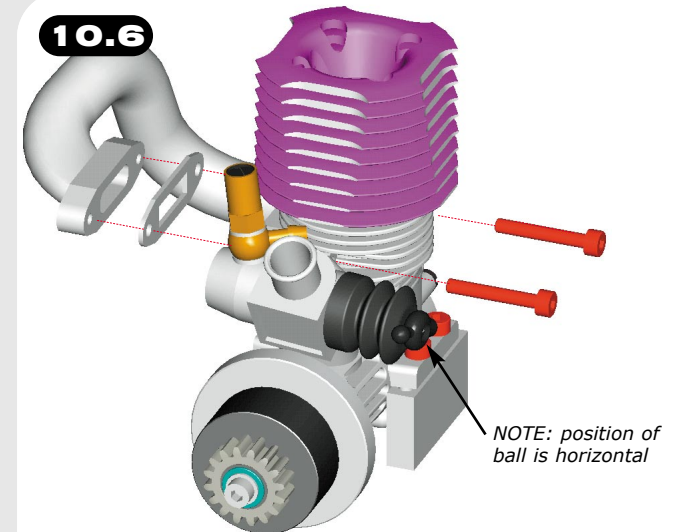

Assemble the header pipe together with the alu. gasket, using screws D16.