

X20^{1/21}

1/10 SCALE ELECTRIC TOURING CAR

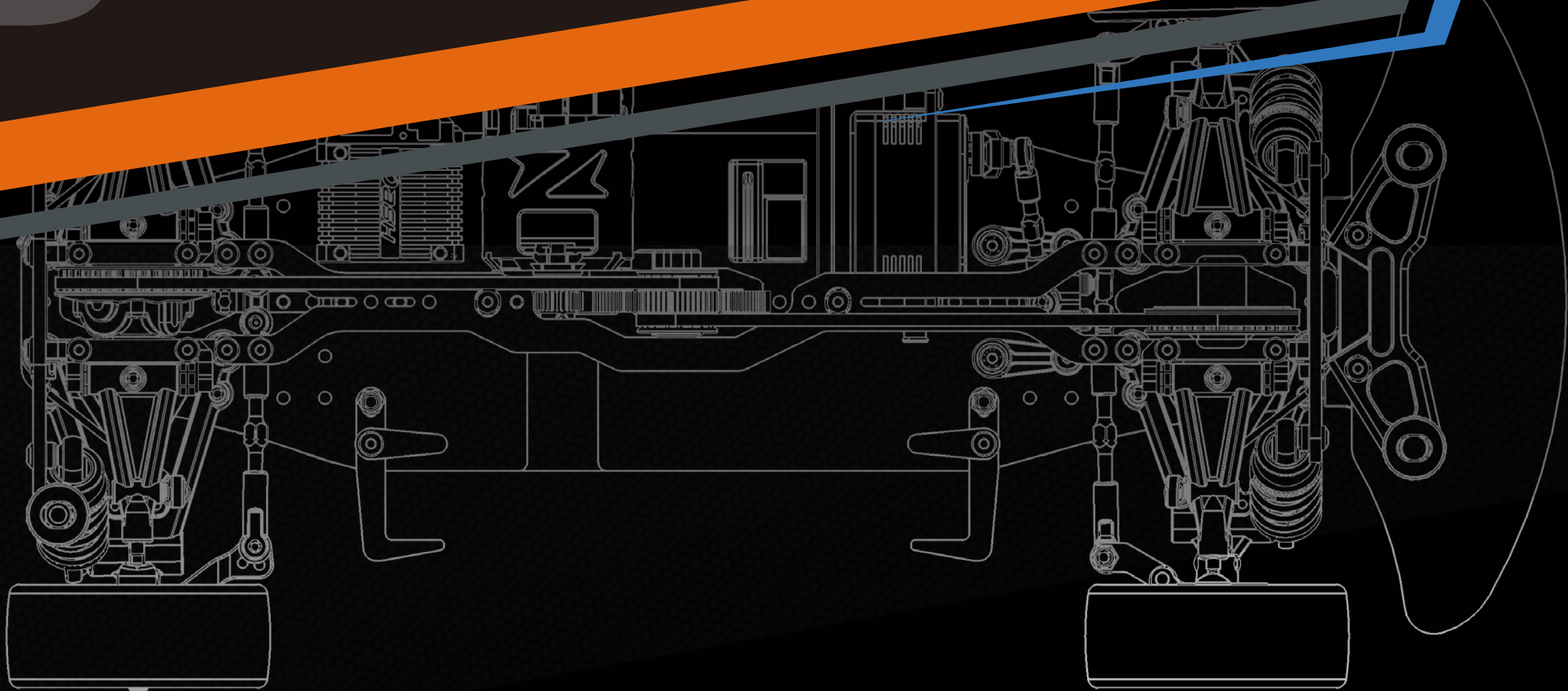

SERPENT

INTRODUCTION

Thank you very much for selecting this Serpent rc car and thus become a member of the ever growing worldwide Serpent racing family. Serpent started in 1980 and has been growing its product-line and fan-base ever since.

The Serpent X20'21 mEdius is a state of the art 1/10 scale 4WD touringcar which will give you the true Serpent racing experience. The assembly manual will guide you through all the steps to complete the car, so you can hit the track with a good base-set-up soonest. The Serpent design department succeeded to create a superbly performing car combined with eas of assembly and maintenance. The high quality standards of all parts and hardware will make racing your Serpent car a very rewarding activity!

Through our team, website and social media we will keep you up-to-date on all developments of the Serpent cars. We hope to meet you on the track and through our various media! Enjoy the drive!

Team Serpent
Multiple World Champions

INSTRUCTIONS

Serpent's long tradition of excellence extends to the instruction manuals, and this instruction manual is no exception. The easy-to-follow layout is richly illustrated with 3D-rendered full-color images to make your building experience quick and easy. Following the instructions will result in a well-built, high-performance race-car that will soon be able to unleash its full potential at the racetrack. The kit includes bags, with bagnumbers, which refer to the same step in the manual. Open only the indicated bag(s) per step and finish that part of the assembly. Remaining parts will be needed lateron in the assembly process.

PLASTIC PARTS

The Serpent moulded parts are very durable and hard. When assembling longer screws in new composite parts, make sure to use new hex bits in your (power) tools. Pre-threading also helps to avoid screw damage.

SETUP

In certain assembly steps you need to make basic adjustments, which will give you a good initial setup for your Serpent X20'21 mEdius. Fine-tuning the initial setup is an essential part of building a high-performance racecar like your Serpent

EXPLODED VIEWS AND PARTS LIST

The exploded views and parts lists for the X20'21 mEdius are presented in the Reference Guide section in the back of this manual. The exploded views show all the parts of a particular assembly step along with the Serpent part number and hotlink to the Serpent website. Partnumbers in orange indicates that this part is an optional. Optionals part names and numbers are showed below.

CUSTOMER SERVICE

Serpent has made a strong effort to make this manual as complete and clear as possible. Additional info may be published in our website: www.serpent.com or you may ask your dealer or the Serpent distributor for advice, or email Serpent direct: info@serpent.com. The Serpent Facebook, Twitter and Youtube pages give additional means of support and communications.

SAFETY

Read and take note of the 'Read this First section' before proceeding to assemble the car-kit. This car-kit is intended for persons aged 16 or older.

READ THIS FIRST!

- This is a highly technical hobby product, intended to be used in a safe racing environment. This car is capable of speeds in excess of 80 km/h or 50mph. Please follow these guidelines when building and operating this model.
- Parental guidance is required when the builder/user of this car is under 16.
- Follow the building instructions. If in doubt, contact your dealer or importer.
- Be sure to use the proper tools when assembling the car. Always exercise caution when using electric tools, knives and other sharp objects.
- Be careful when using liquids like lubrication oil, fuel or glue. Do not swallow.
- Follow the manufacturer's instruction in case you experience irritation after using the product.
- Be careful when operating the car. Stay away from any rotating parts such as wheels, gears and transmission. Stay away from motor, engine and exhaust pipe system or speedo during and immediately after use, as these parts may be very hot. We advise to use protective hand cloves.
- Only operate this car in a safe environment, like a special racing track or a closed parking lot. Avoid using this car on public roads, crowded places or near infants.
- Before operating this car, always check the mechanical status of the car. Also check that the transmitter and receiver frequencies correspond and are not used by any other racer at the same time. Check that the batteries of the transmitter and receiver- are fully charged.
- After use, always check all the mechanics of the car. We advise to clean the car immediately after use, and inspect the parts for wear or fractures. Replace when necessary. Do not use water, methanol, thinner or other solvents to clean the car.
- Empty the fuel tank (depending on model) if needed and disconnect the receiver battery.
- Store the car in a dry and heated place to avoid corrosion of metal parts.
- Avoid using this car in wet conditions as the water will cause corrosion on the metal parts and bearings and these parts will cease to function properly. If driven in the wet, ensure that all the electric equipment is waterproofed and after use, that all moving parts are dried immediately.

CONTENTS

• DIFF ASSEMBLY.....	4
• DJC ASSEMBLY.....	6
• CVD ASSEMBLY.....	7
• FRONT & REAR ASSEMBLY.....	8
• MOTORMOUNT ASSEMBLY.....	12
• REAR ASSEMBLY.....	14
• FRONT ASSEMBLY.....	17
• ANTIROLLBAR ASSEMBLY.....	21
• STEERING ASSEMBLY.....	22
• CENTRAL ASSEMBLY.....	25
• SHOCK ASSEMBLY.....	27
• BUMPER ASSEMBLY.....	29
• FINAL ASSEMBLY.....	31
• EXPLODED VIEWS.....	37
• TEAM SERPENT NETWORK.....	46

LINES DESCRIPTION

Each step contains a variety of numbers, lines, and symbols. The numbers represent the order in which the parts should be assembled. The lines are described below.



Step number; the order in which you should assemble the indicated parts



Length after assembly



Assembly path of one item into another



Group of items (within lines) should be assembled first



Direction the item should be moved



Glue one item to another



Press/Insert one item into another



Connect one item to another



Gap between two items

ICONS DESCRIPTION

Each step contains a variety of symbols described below.



Carefull, read and check very well.



Apply a small amount of cyano glue. Use wear protection for eyes and hands.



Detail view to explain assembly or order of parts better.



Default set-up: This symbol indicates the default setup.



Grease: apply a small amount of grease to the parts shown.



Left and right parts should be assembled in the same way.



Thread lock: apply a small amount on the parts shown. Before to apply the threadlock, make sure to degrease the parts very well, as otherwise the threadlock will not work.



Silicone oil: use the indicated silicone oil for the shocks and differentials.



Parts or items not included in the kit.



Optional part, not standard in the kit.

STEP 1

DIFF BAG

1.1

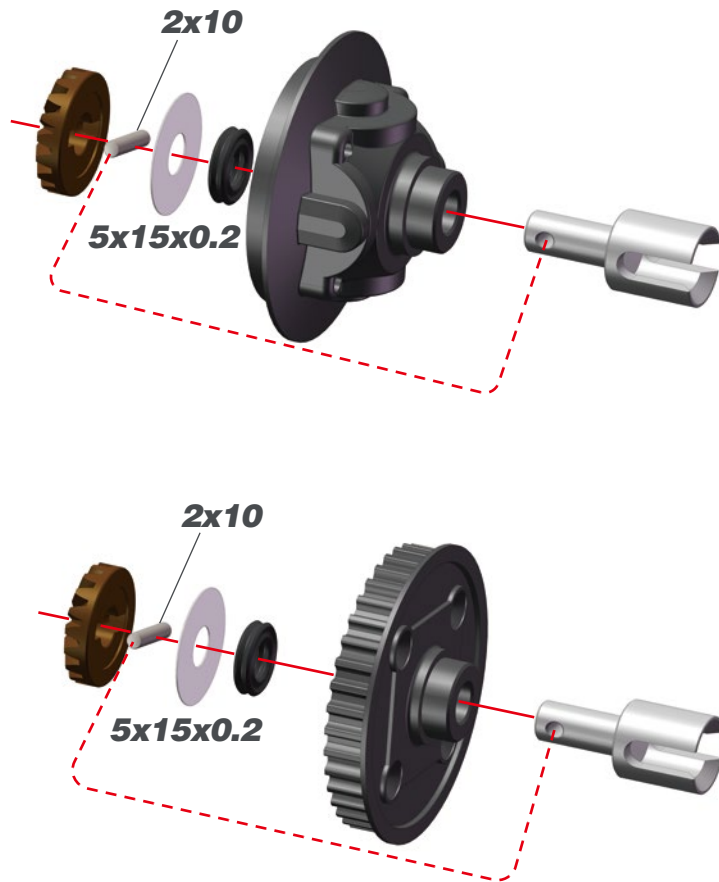

1.2

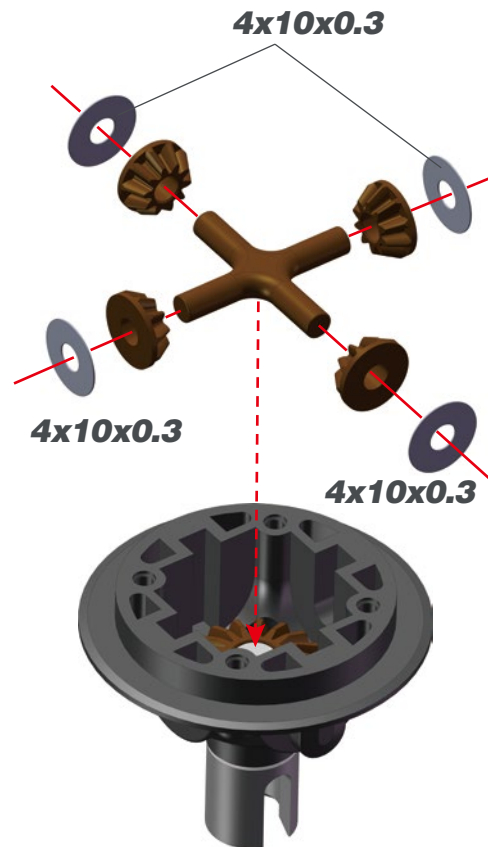

! Fill the differential with silicone oil 1 mm above the crosspin, do NOT overfill. Use the silicone oil supplied in the kit. For the correct cst value please check the default setupsheet.



AMOUNT OF OIL IN THE DIFFS

Use a digital scale to measure the exact amount of oil in the diff.

Differential weight with volume compensators = 11.5 grams

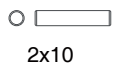

2x10



5x15x0.2



4x10x0.3

STEP 1

SOLID AXLE BAG

1.3

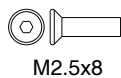

1.4

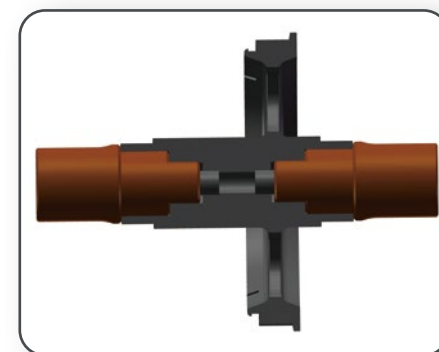

STEP 2

DJC BAG

2.1

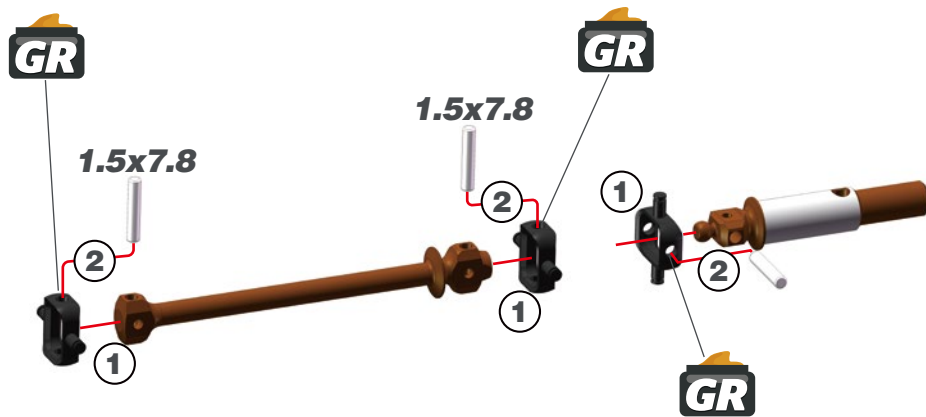

 1.5x7.8

2.2

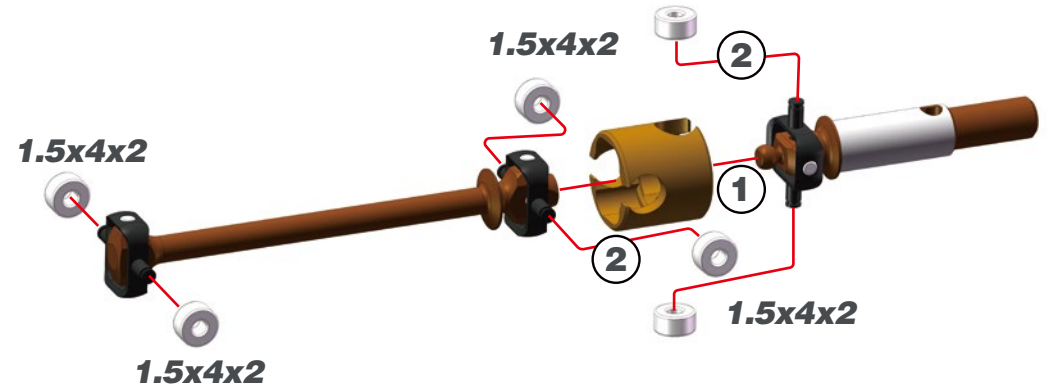

2.3

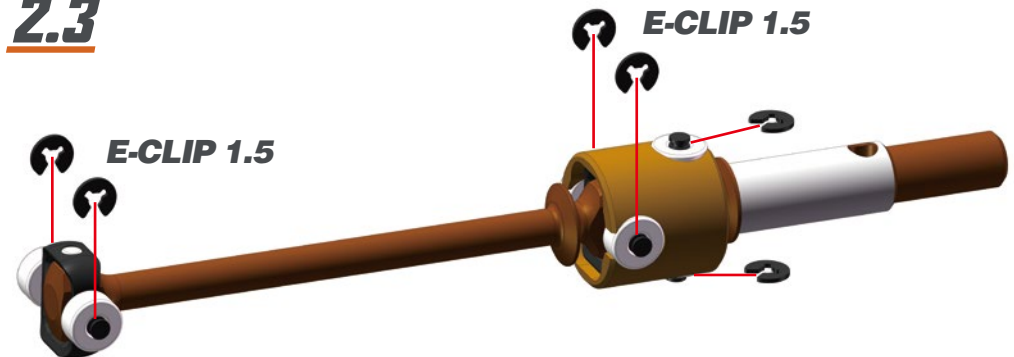

 1.5x4x2

 E-CLIP 1.5

STEP 2

CVD BAG

2.4

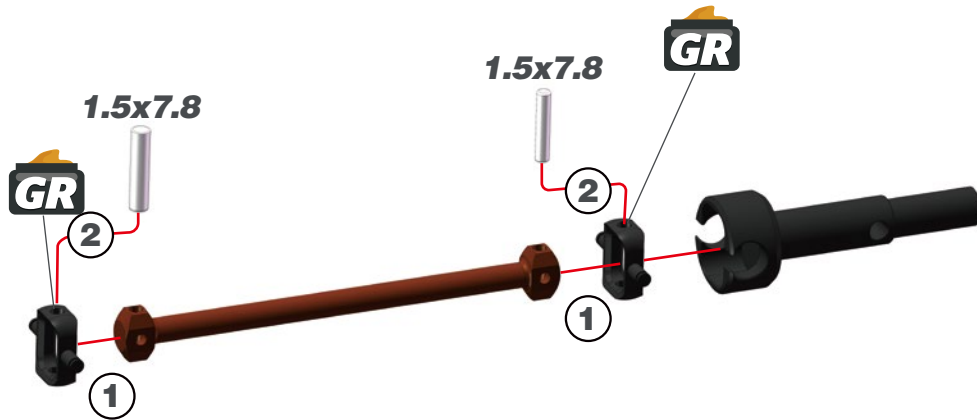

1.5x7.8

2.5

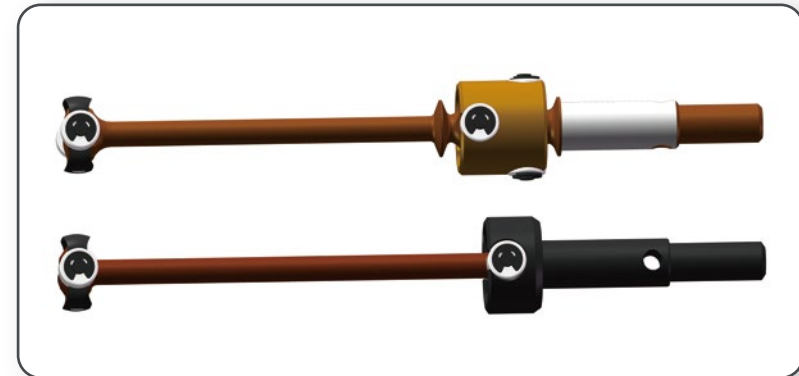
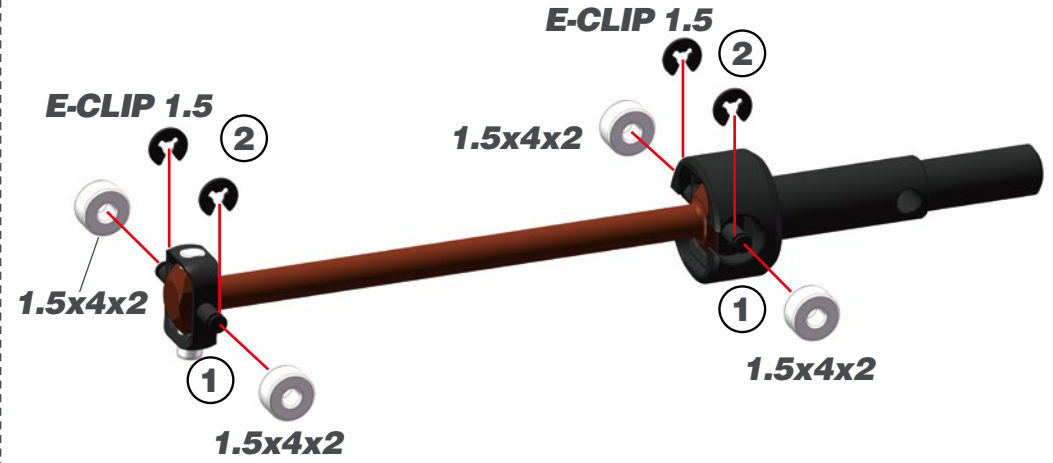

1.5x4x2

E-CLIP 1.5

STEP 3

BAG 1

3.1 FRONT

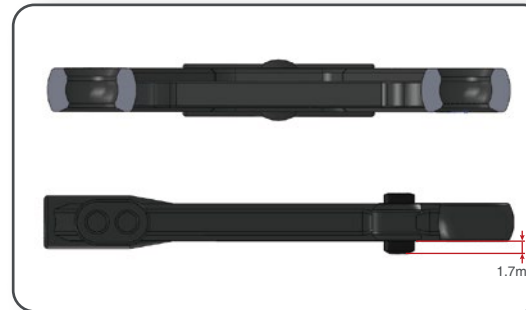
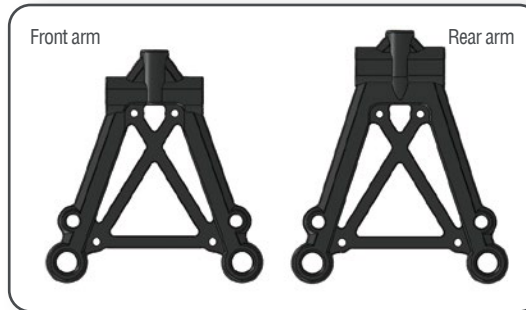
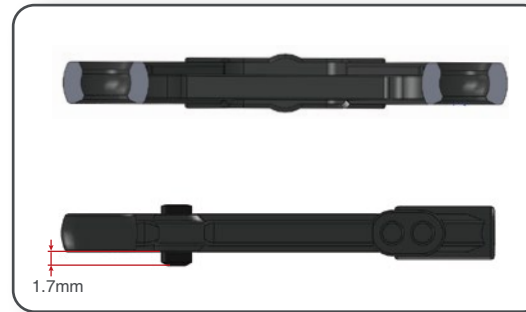
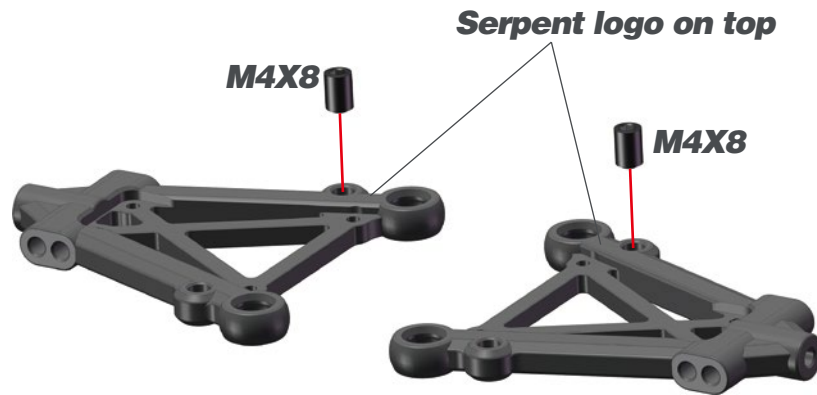

3.2 REAR

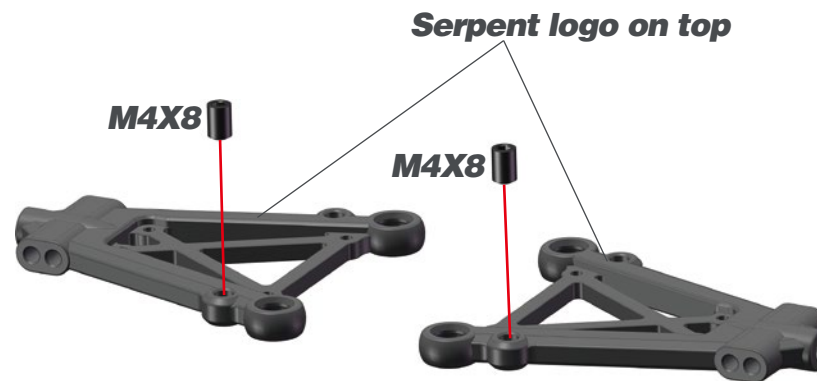

OPT

- 401831 Wishbone insert carbon (4) X20
- 401953 Wishbone insert full carbon (4) X20
- 401962 Wishbone insert brass 10gr (2) X20



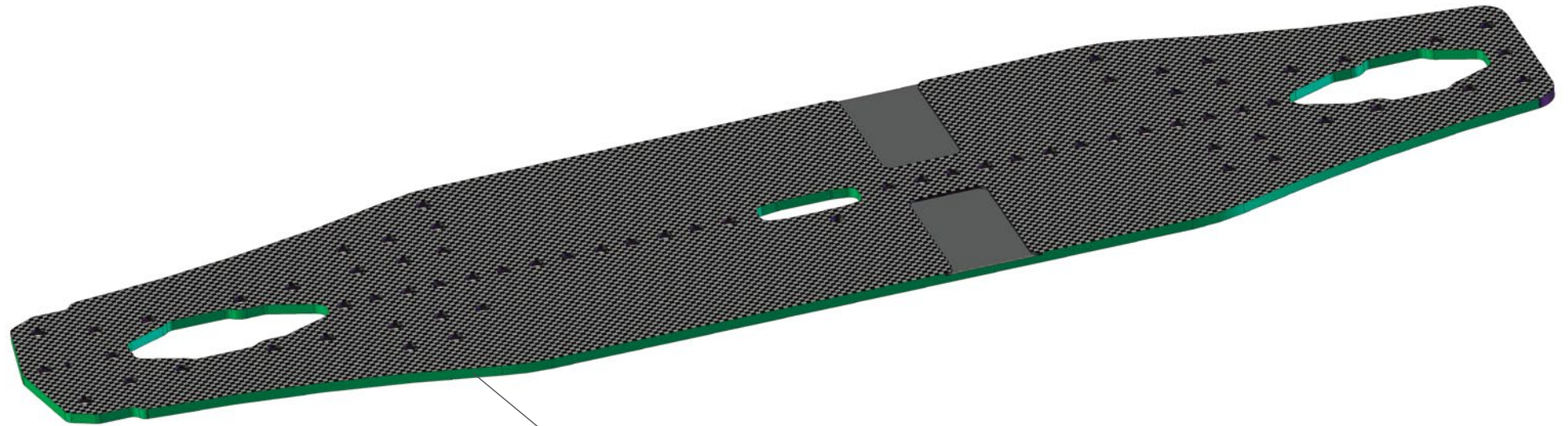

STEP 4

4.1 FRONT

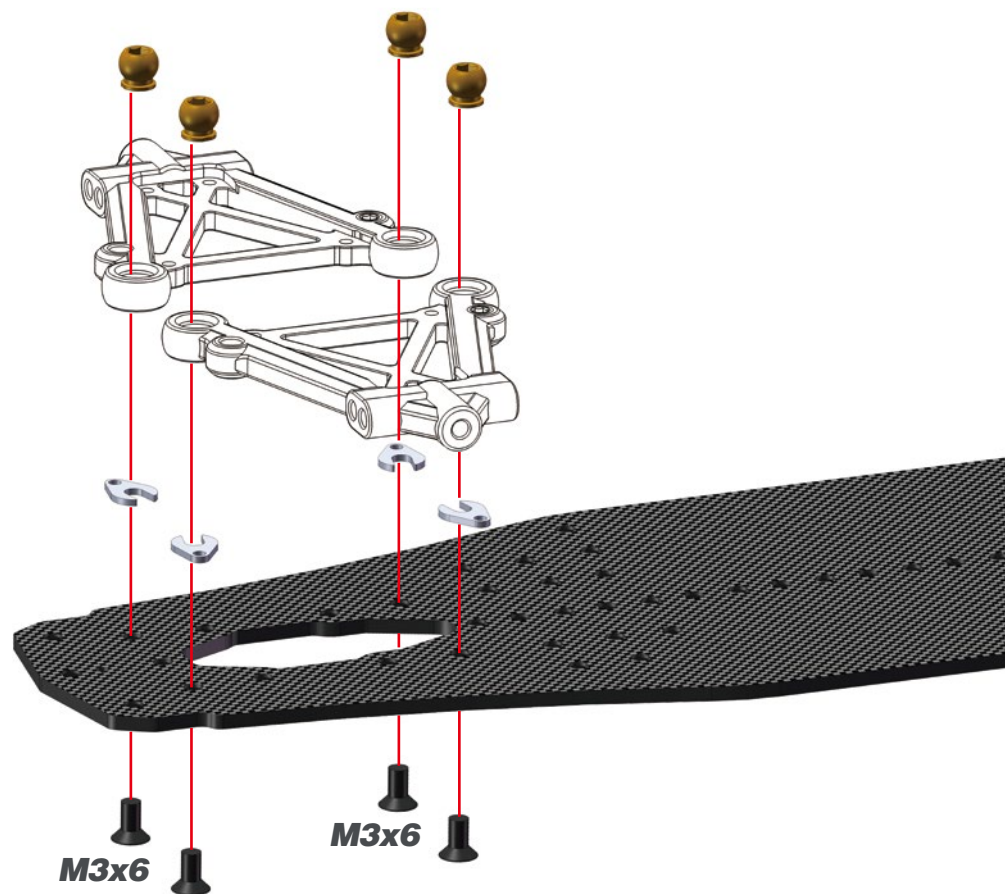

4.2 REAR

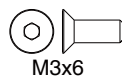
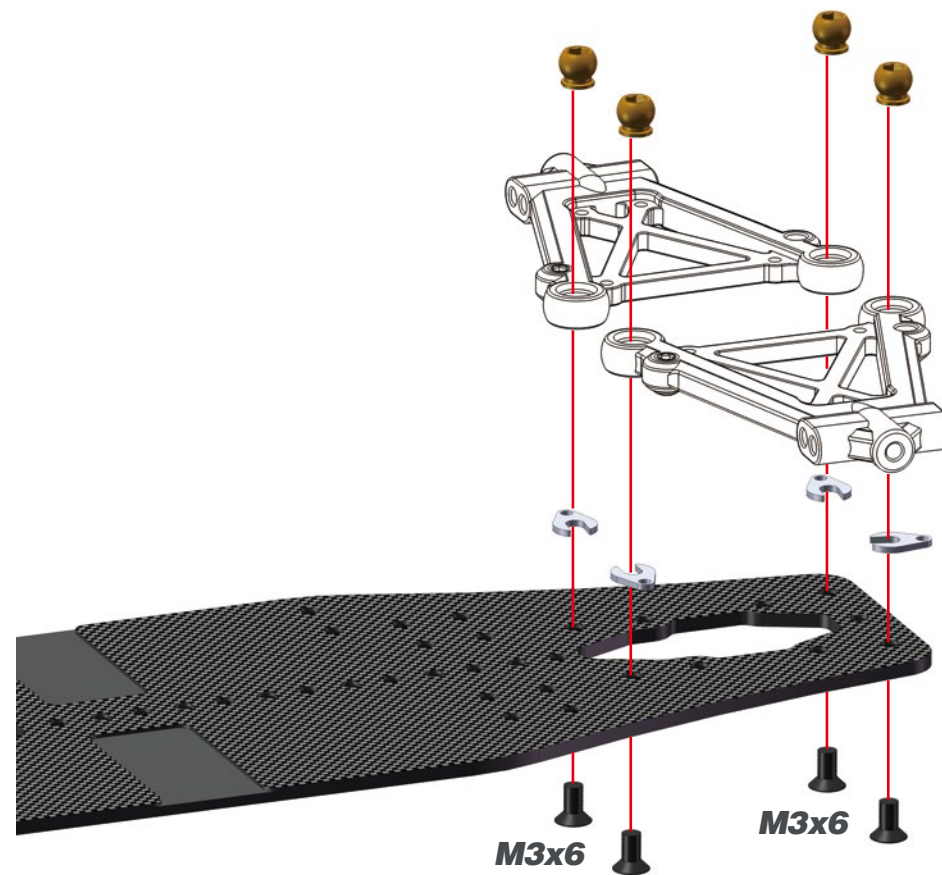

STEP 5

5.1 FRONT

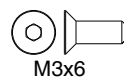
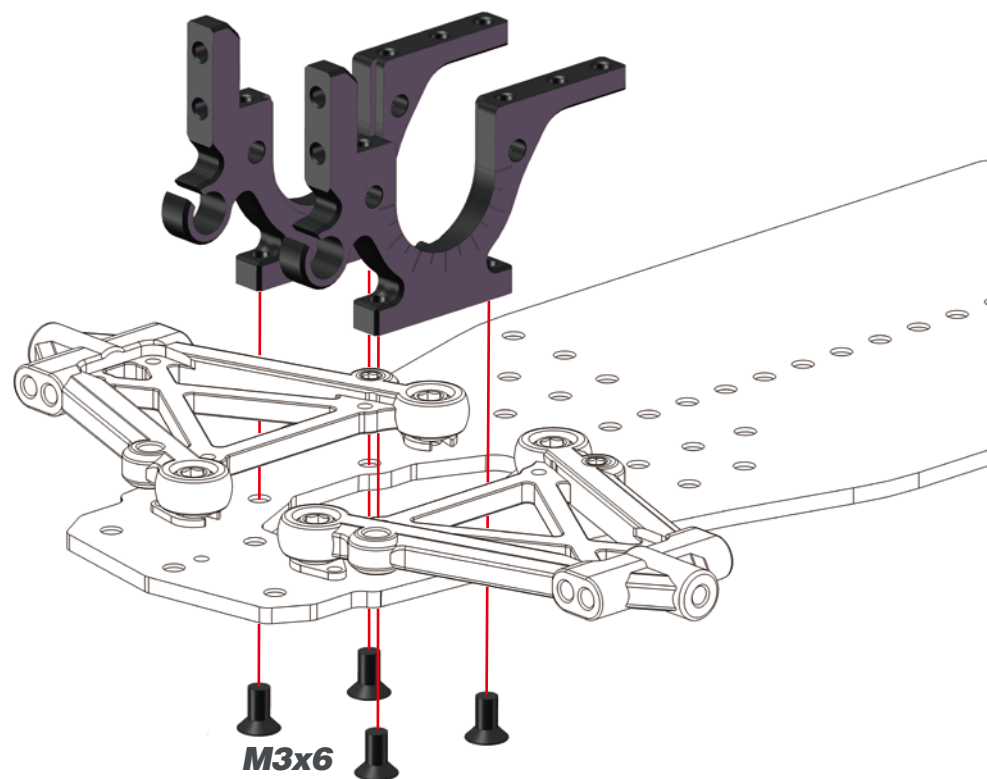

5.2 REAR

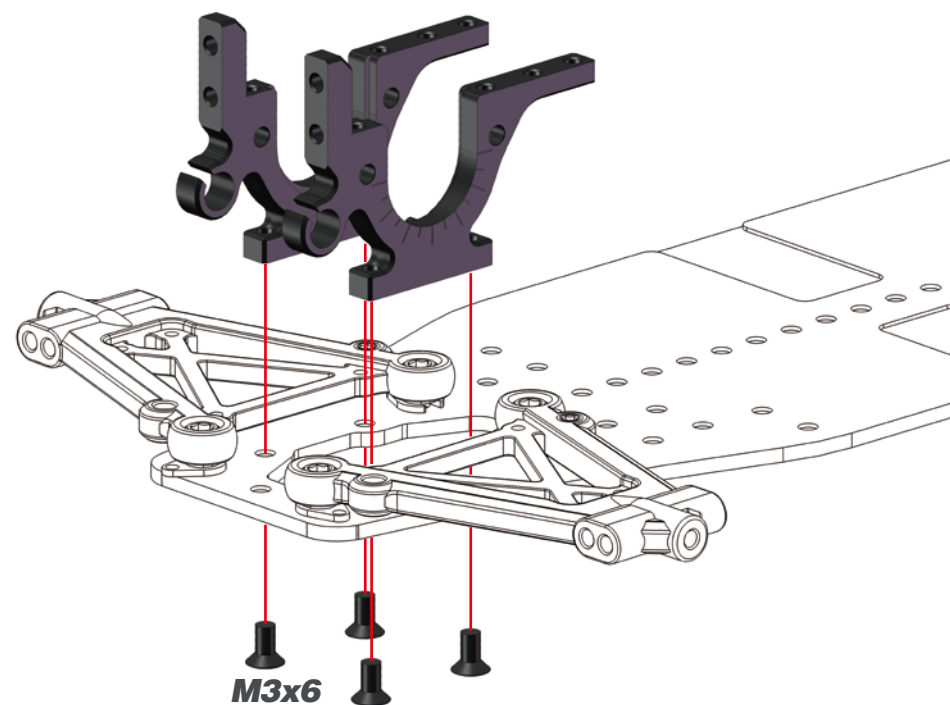

STEP 6

BAG 2

6.1

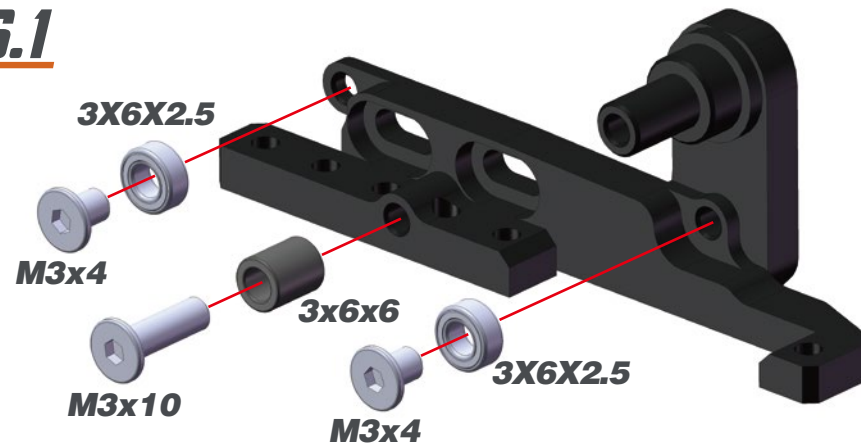

6.2

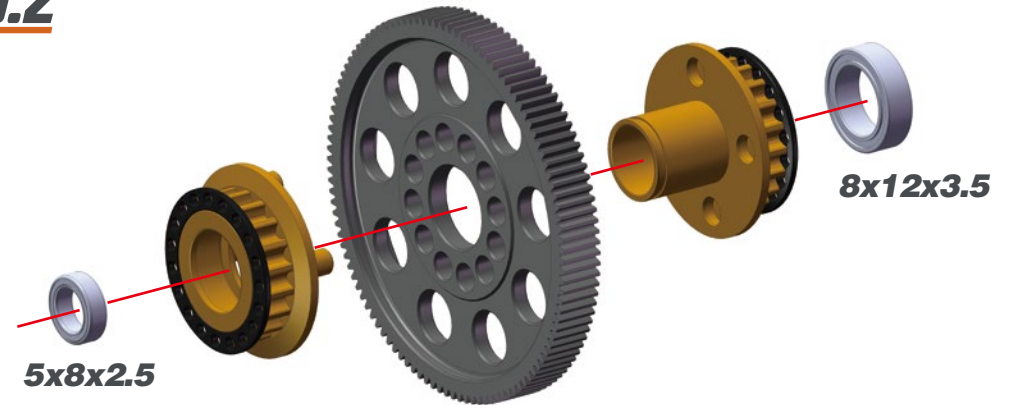

OPT

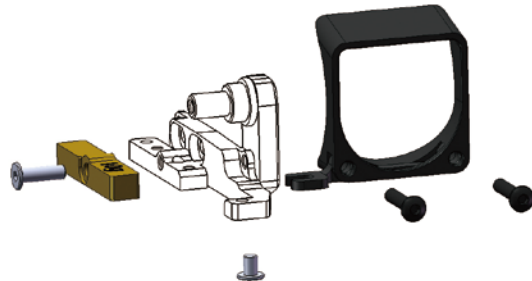

401955 Fan mount set X20 '21

10g

401959 Motormount weight 10gr X20 '21

6.3

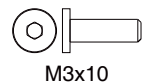
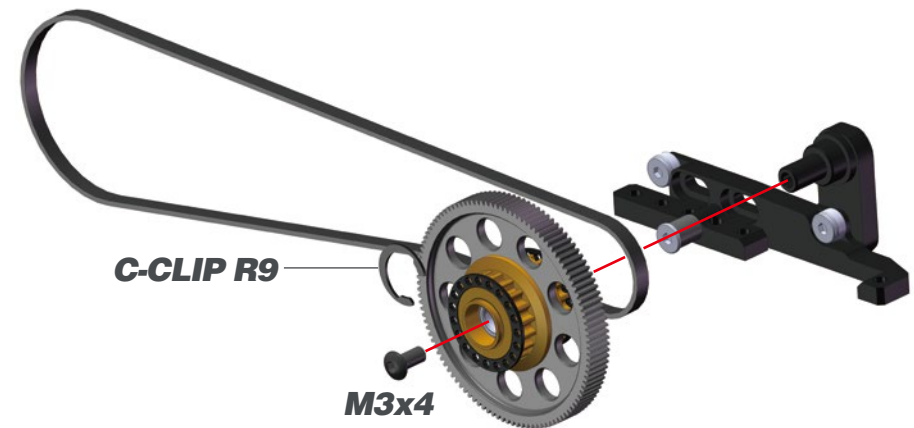

STEP 6

6.4

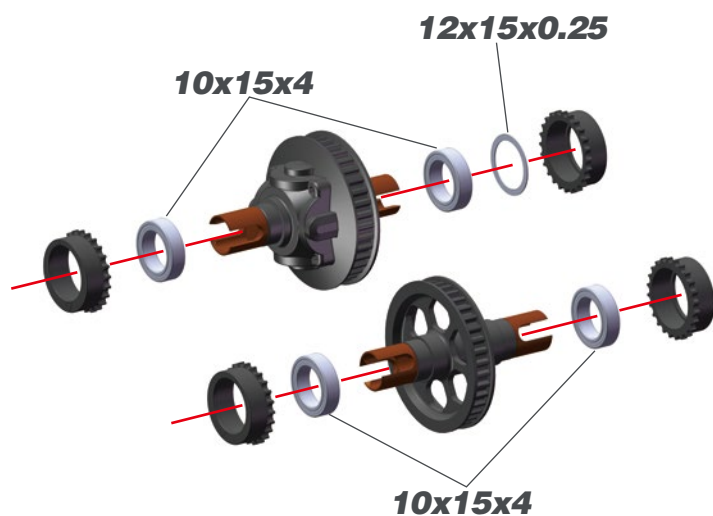

OPT



401917 Bearing exciter Alu fr/rr (4) X20

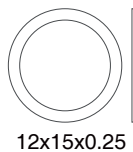
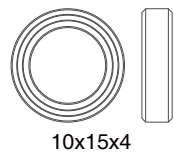

6.5

OPT

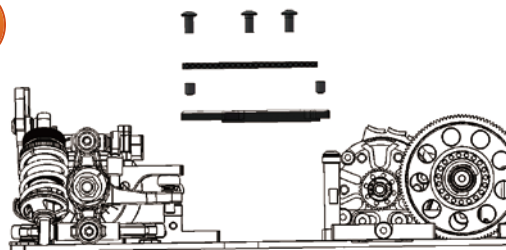

401913 Adjustable chassis brace rr X20



401866 Chassis stiffener center mount mid X20

401875 Chassis center stiffener set mid X20



401912 Belt 30S3M348 low friction X20

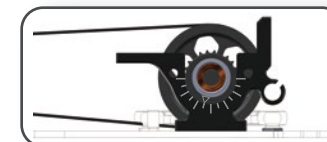
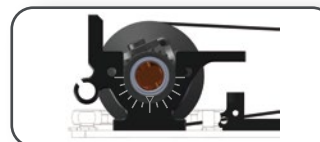
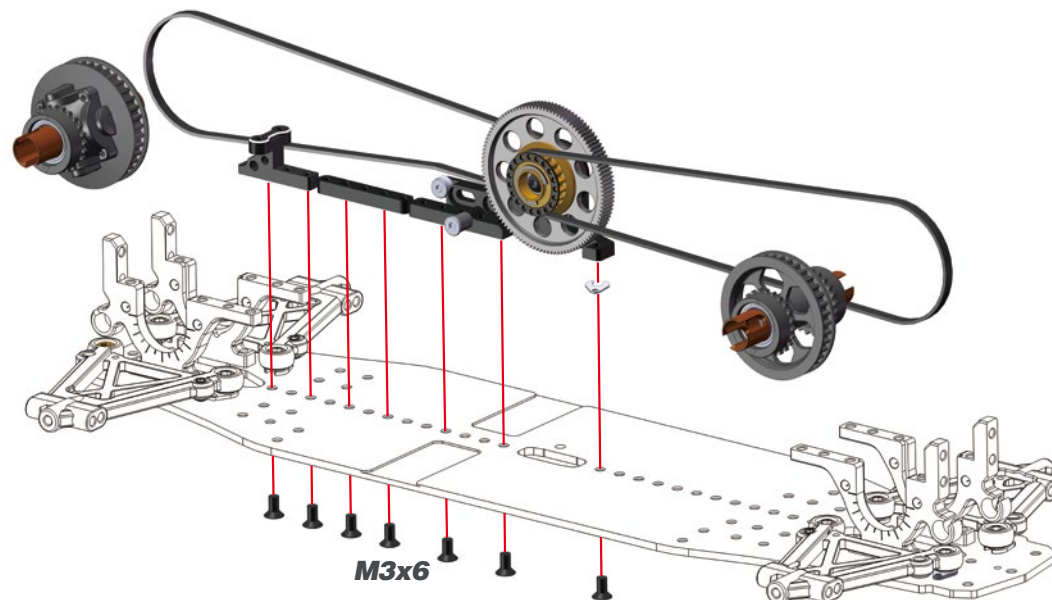

7.1 REAR

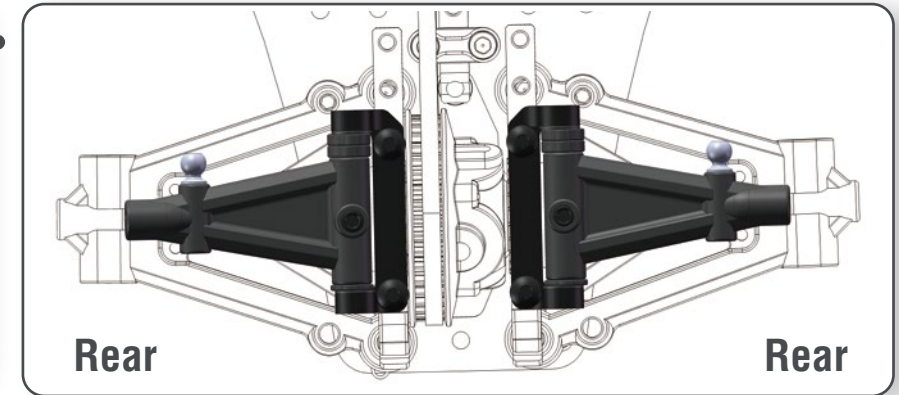
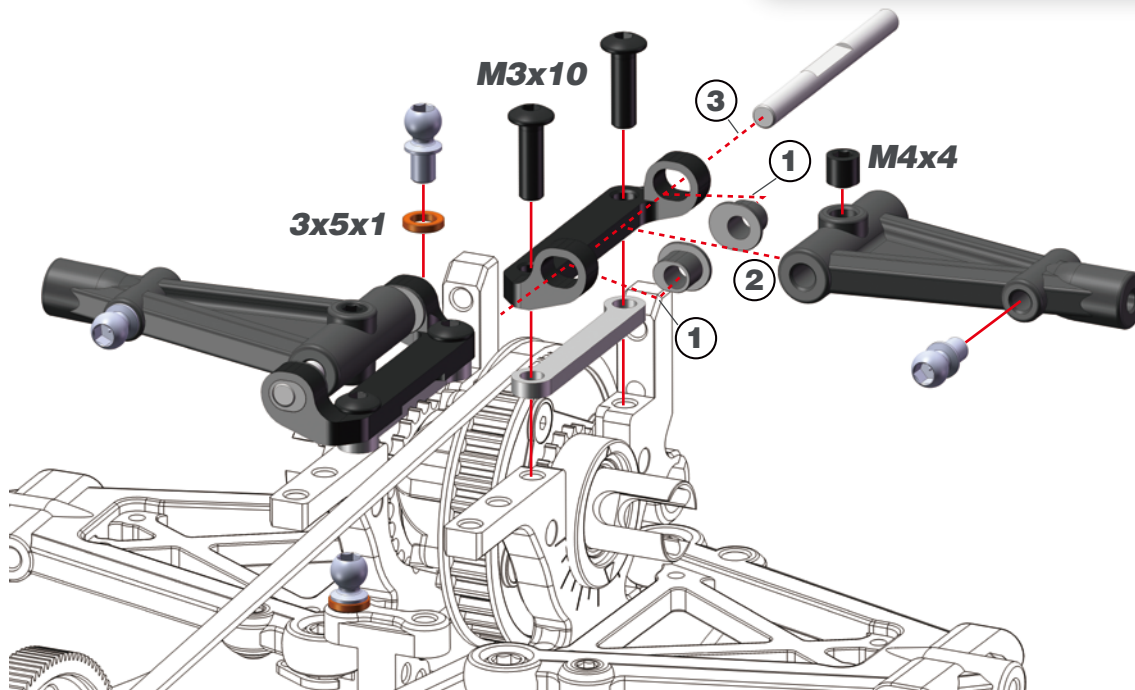
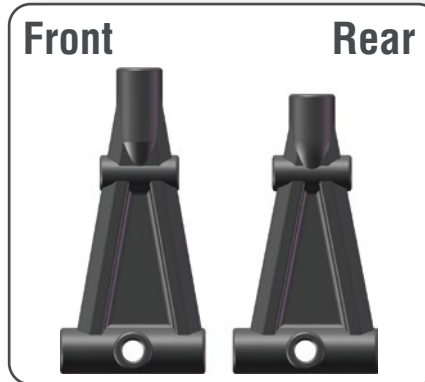

7.2

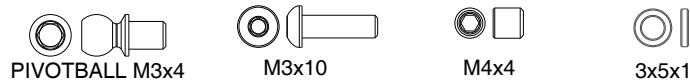
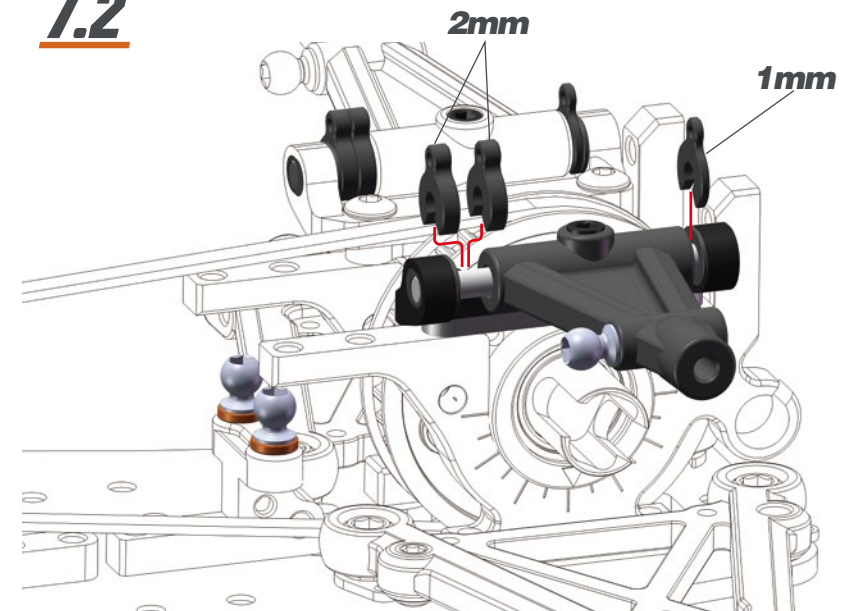

STEP 7

REAR

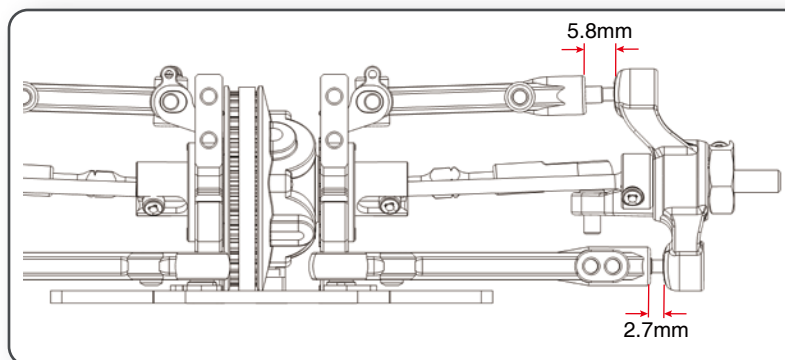

OPT



401387 Wheelhexagon 1mm offset (2)
500211 Wheelhexagon +0.75mm offset (2)

7.3

5x10x4

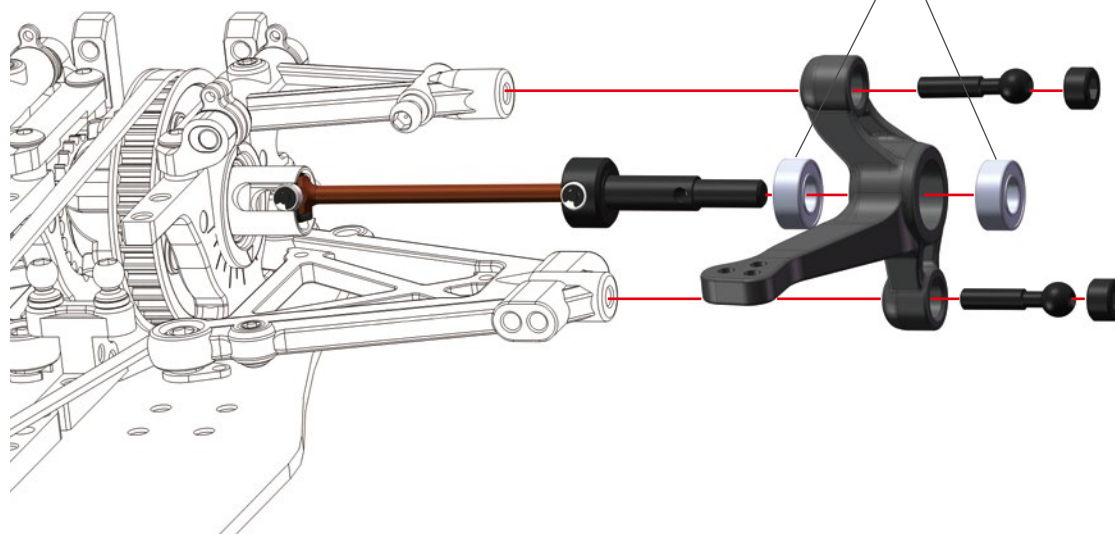

5x10x4

7.4

2x10

M2x5

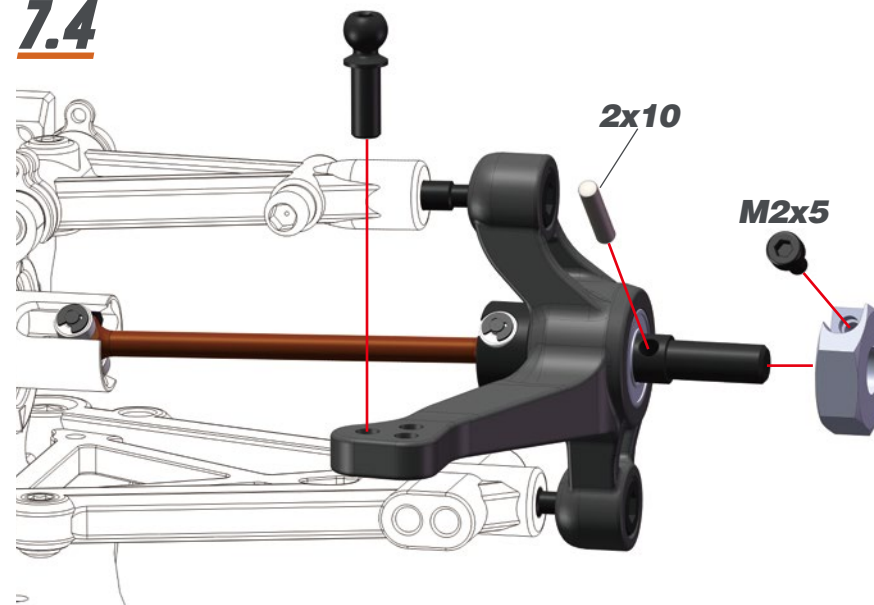

PIVOTBALL M3x7



M2x5

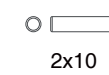

2x10

STEP 7

7.5

REAR

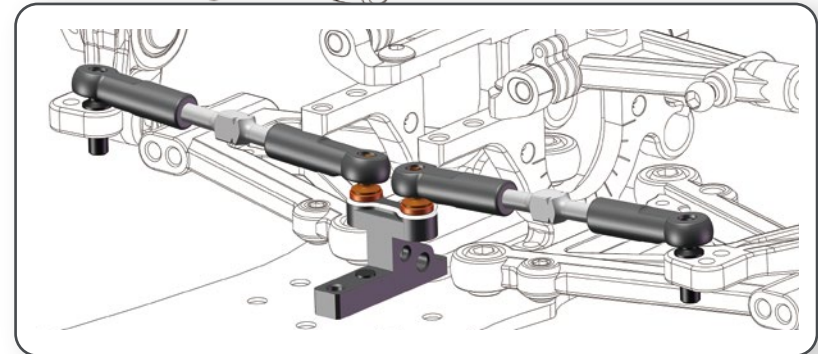
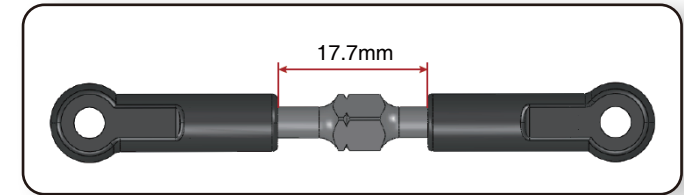
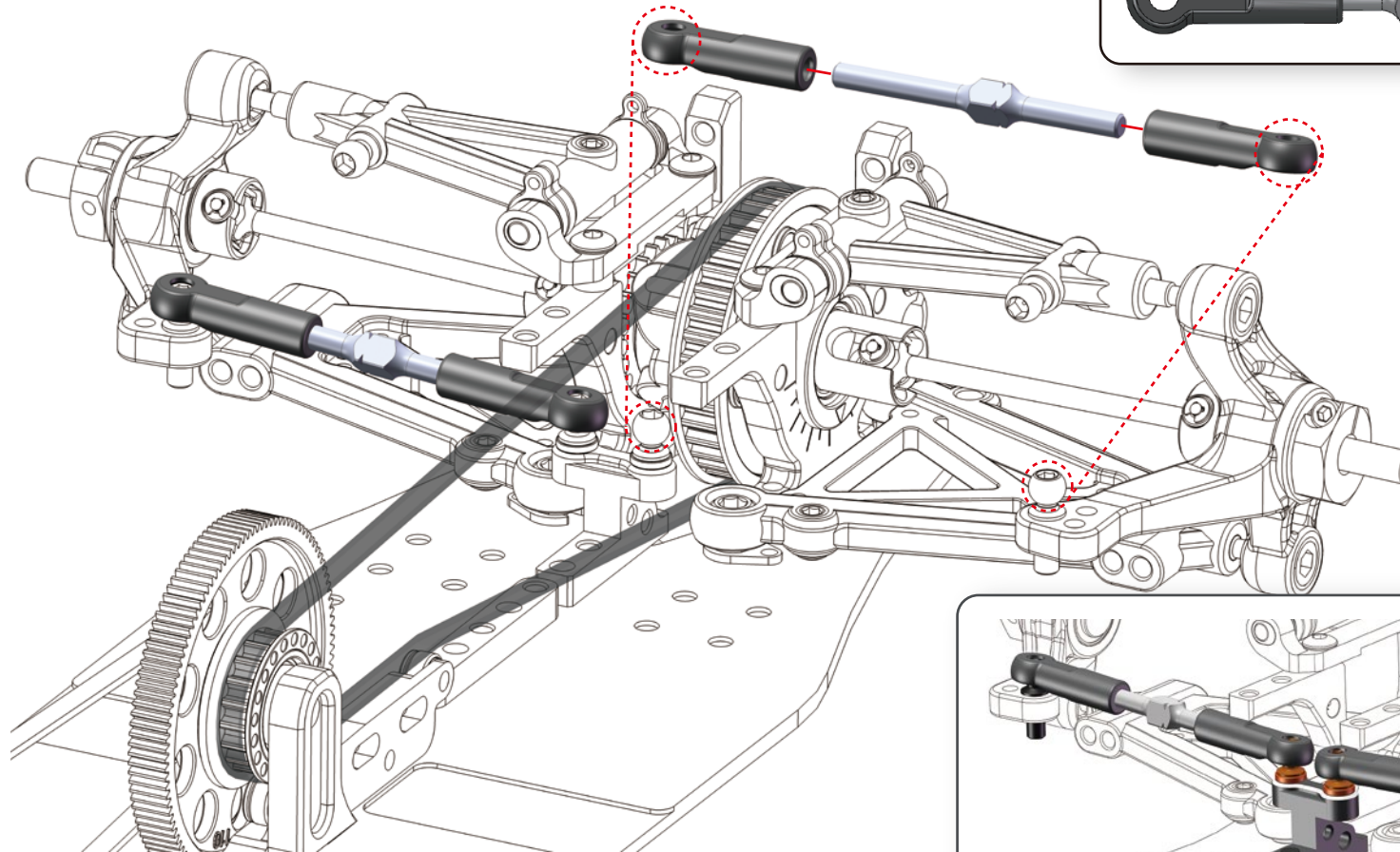

STEP 8

BAG 4

8.1 FRONT

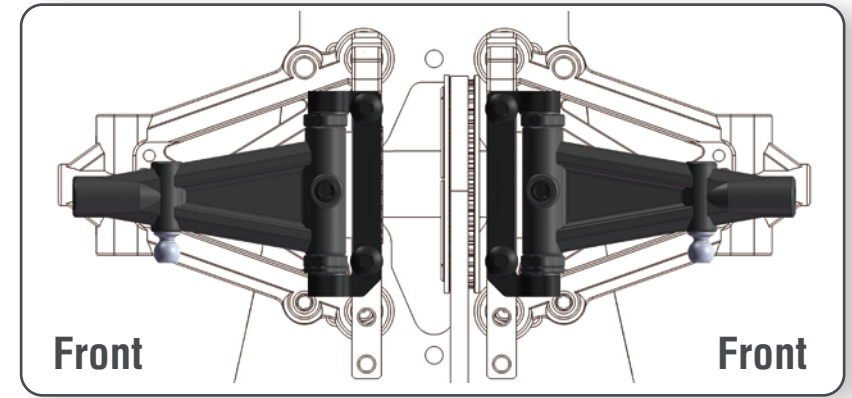
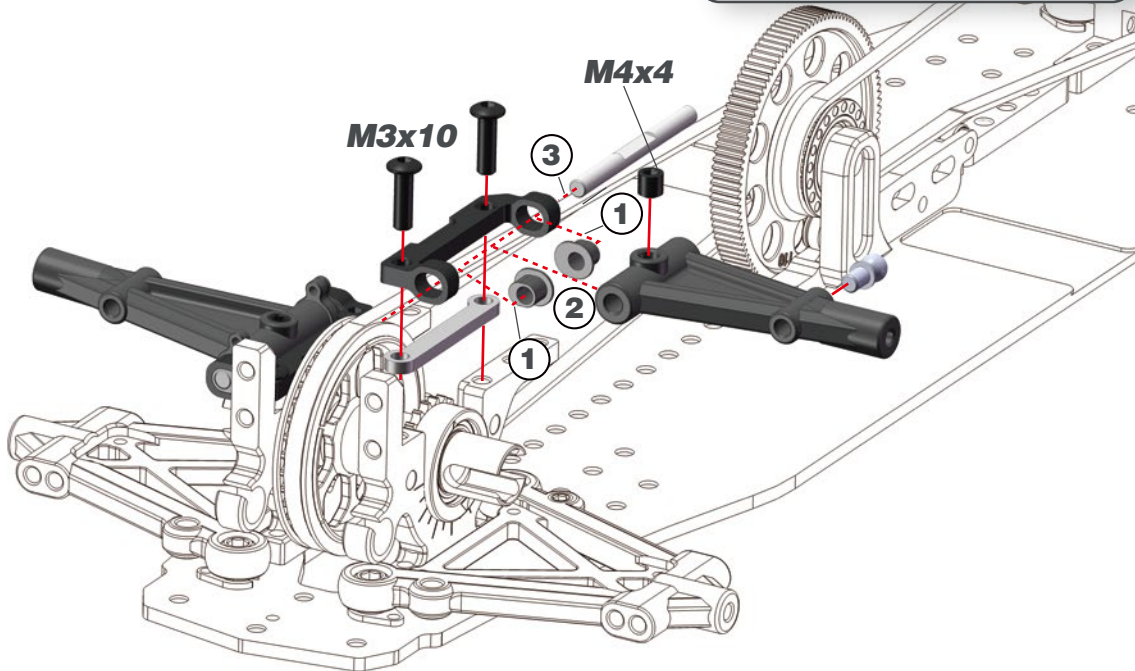
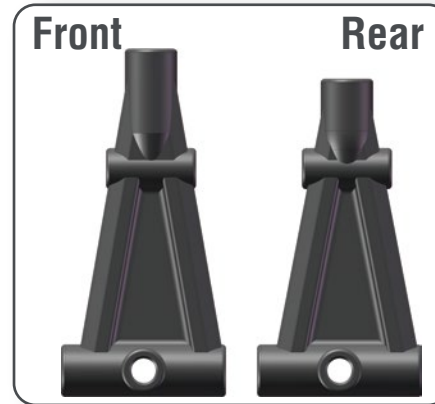

8.2

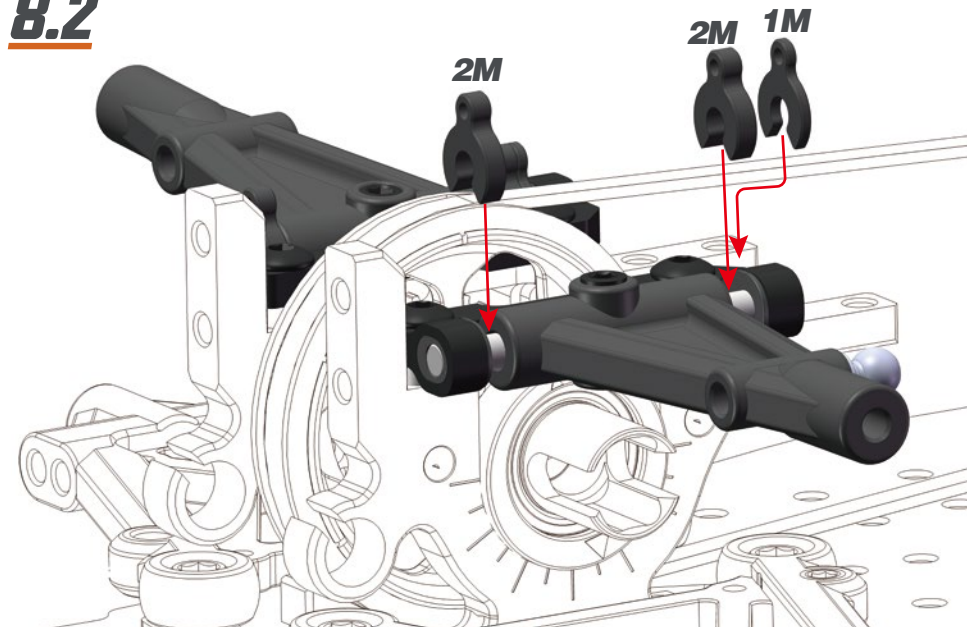

STEP 8

8.3-L

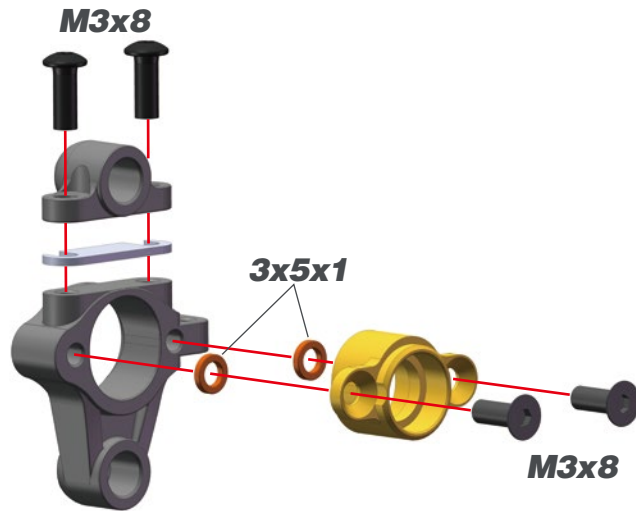

8.4-R

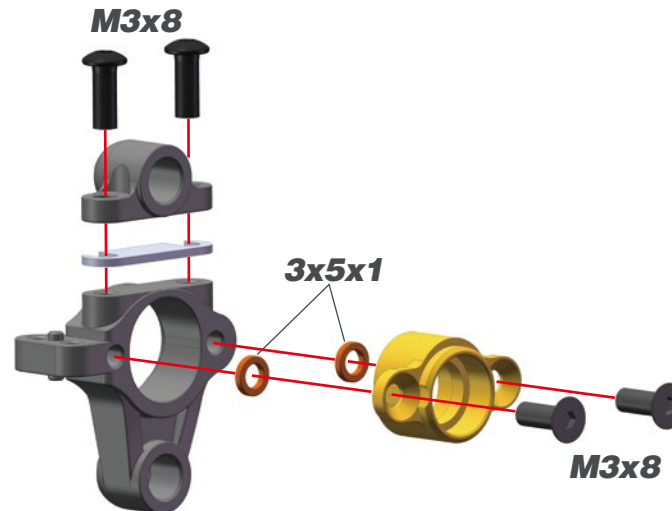

8.5

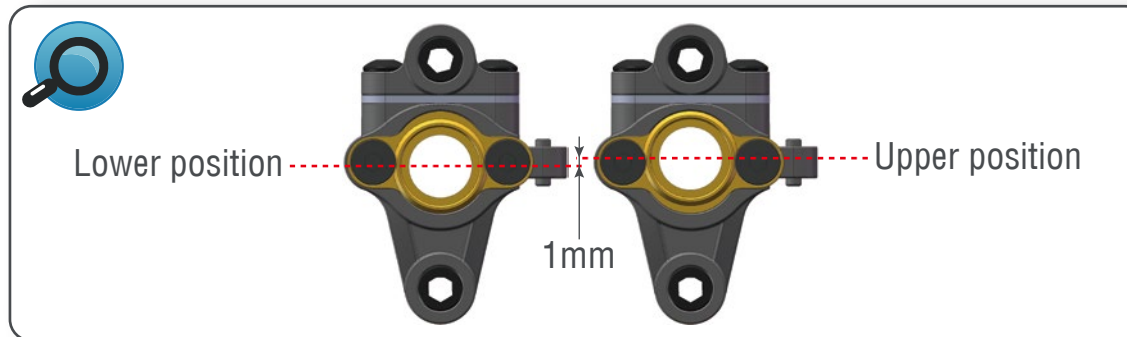
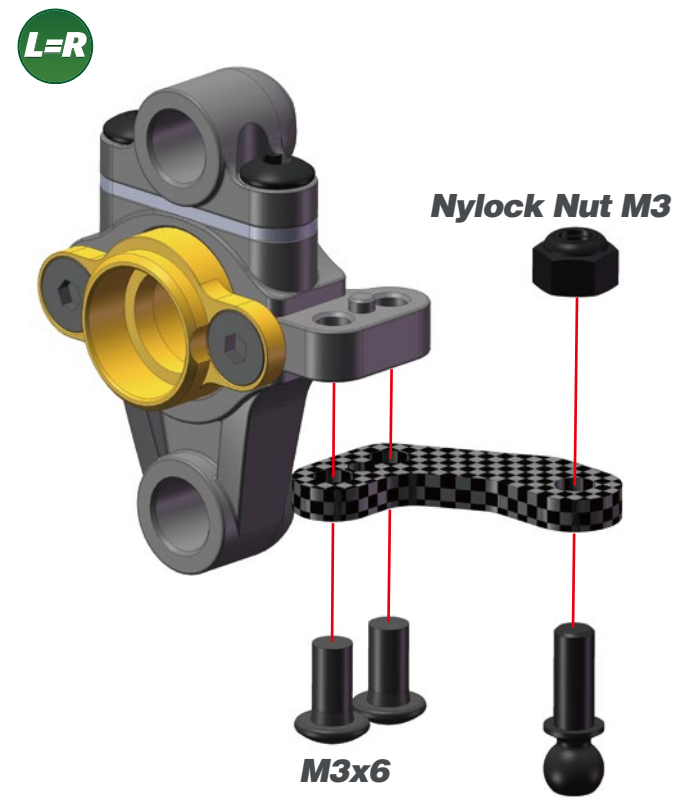

8.6

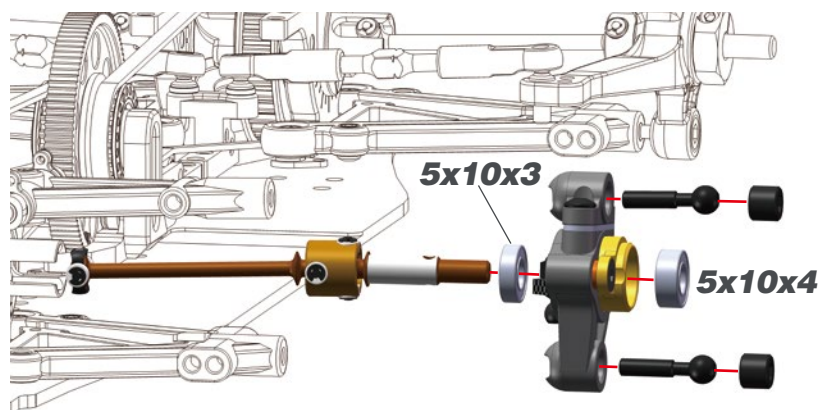

8.7

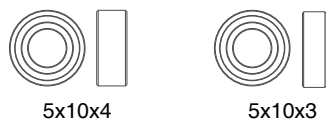
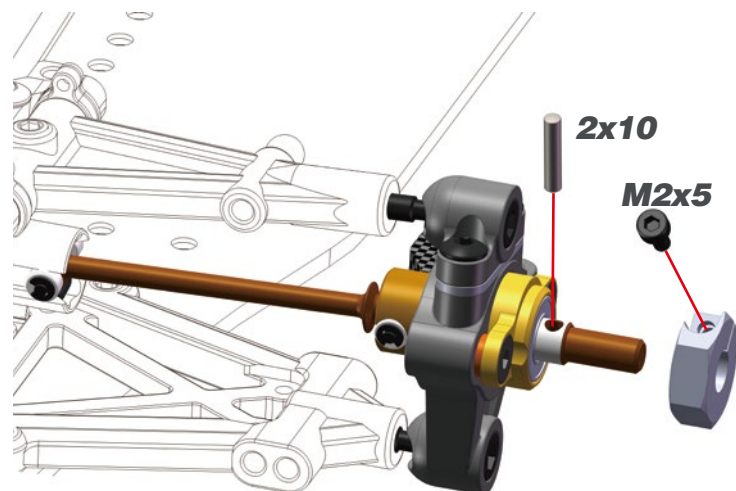

L=R

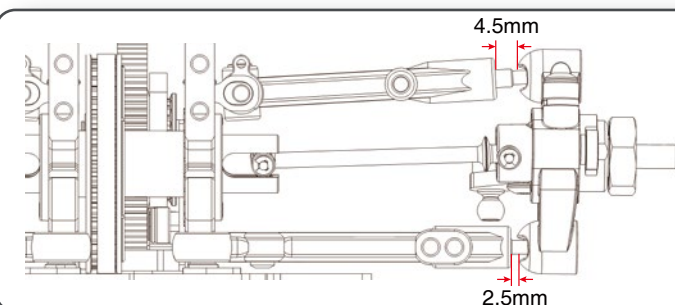
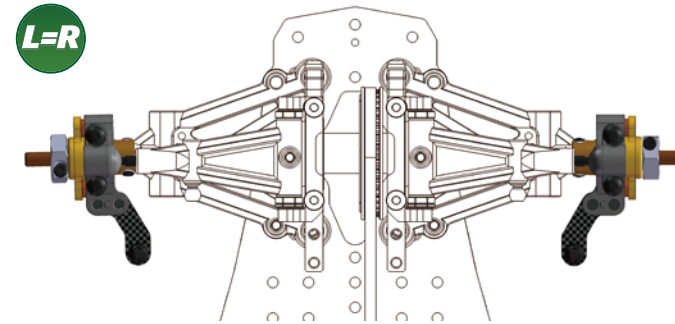

OPT

- 401387 Wheelhexagon 1mm offset (2)
- 500211 Wheelhexagon +0.75mm offset (2)

STEP 9

BAG 5

9.1 FRONT & REAR



9.2 REAR

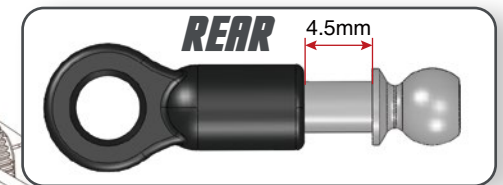
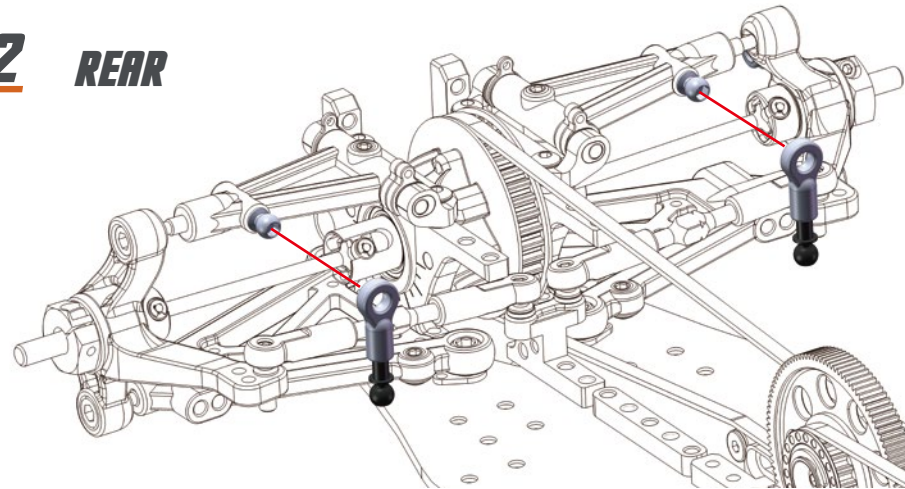

9.3 FRONT

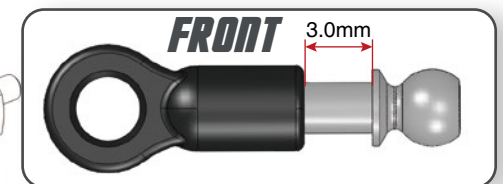
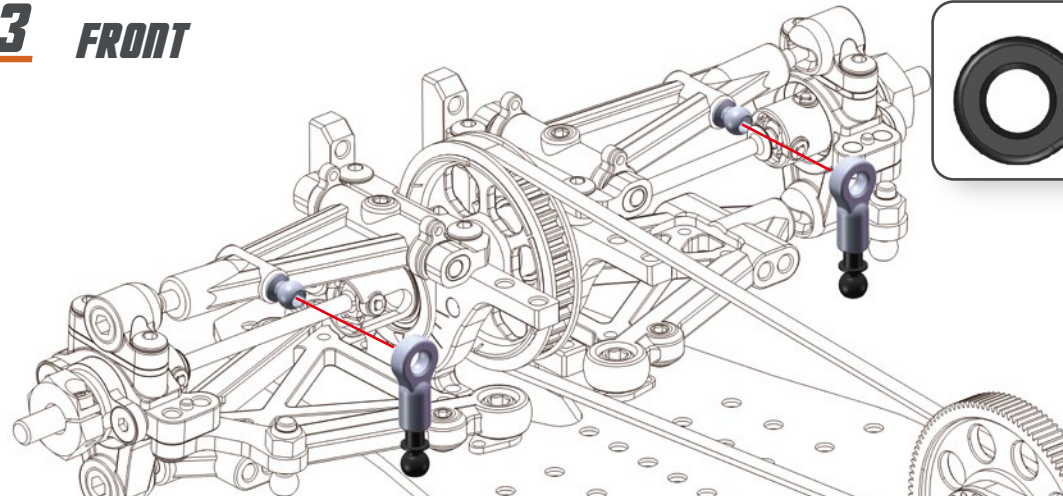

9.4 FRONT & REAR

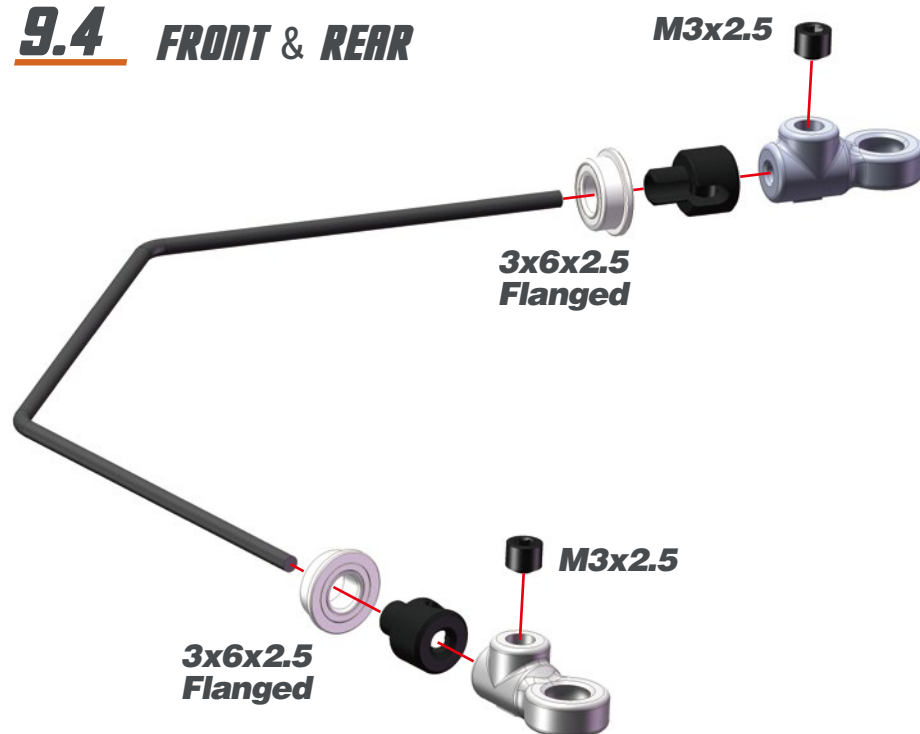

OPT

401856 Antirollbar 1,2mm X20
401857 Antirollbar 1,3mm X20
401859 Antirollbar 1,5mm X20



9.5 REAR

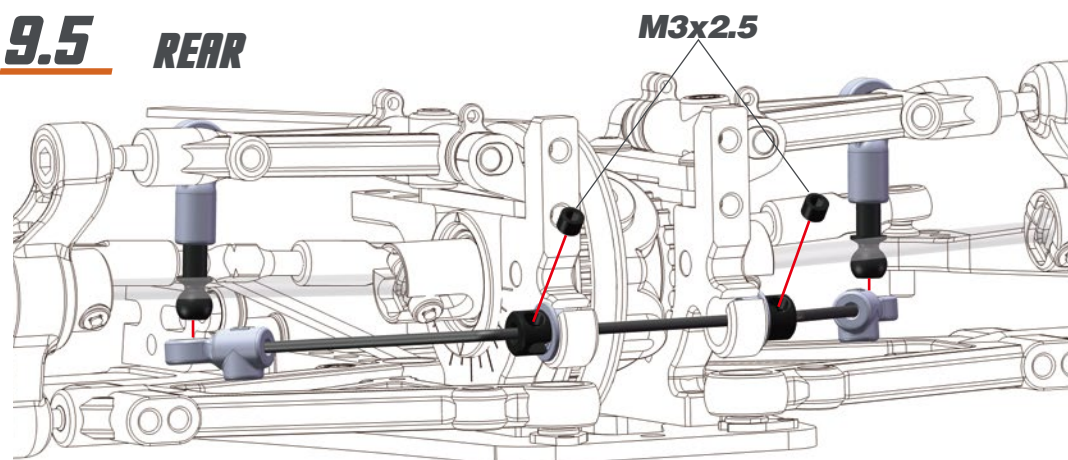

9.6 FRONT

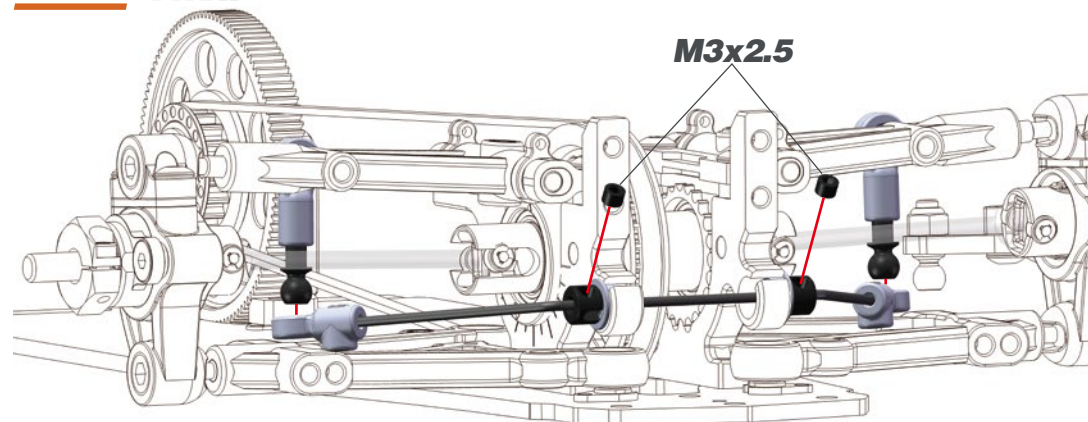

10.1

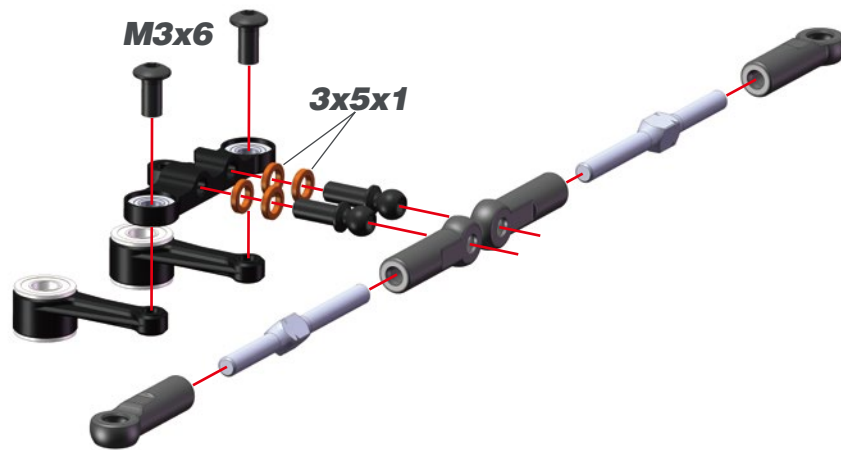
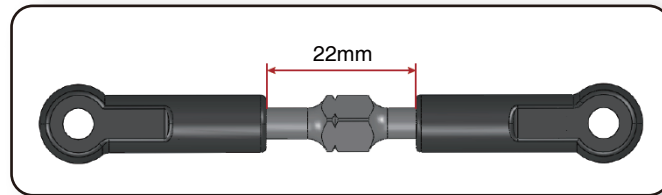

OPT



401863 Steering lever mount stiff X20

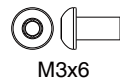

10.2

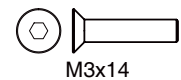
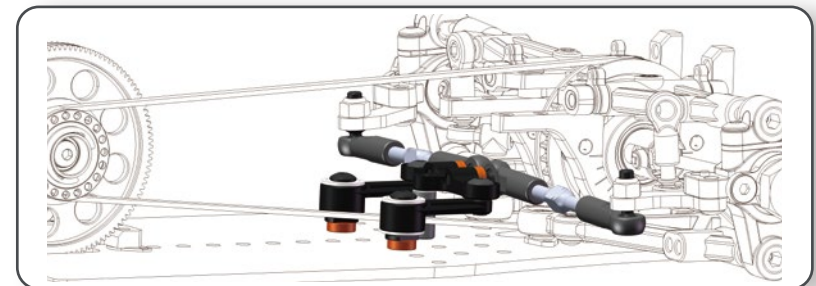
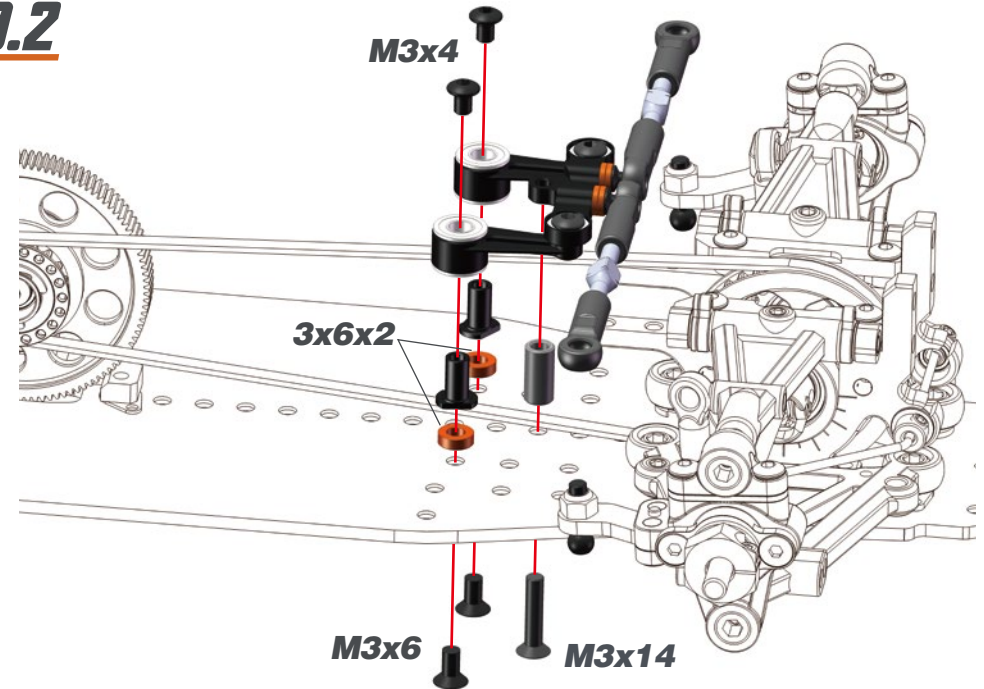

STEP 11

11.1

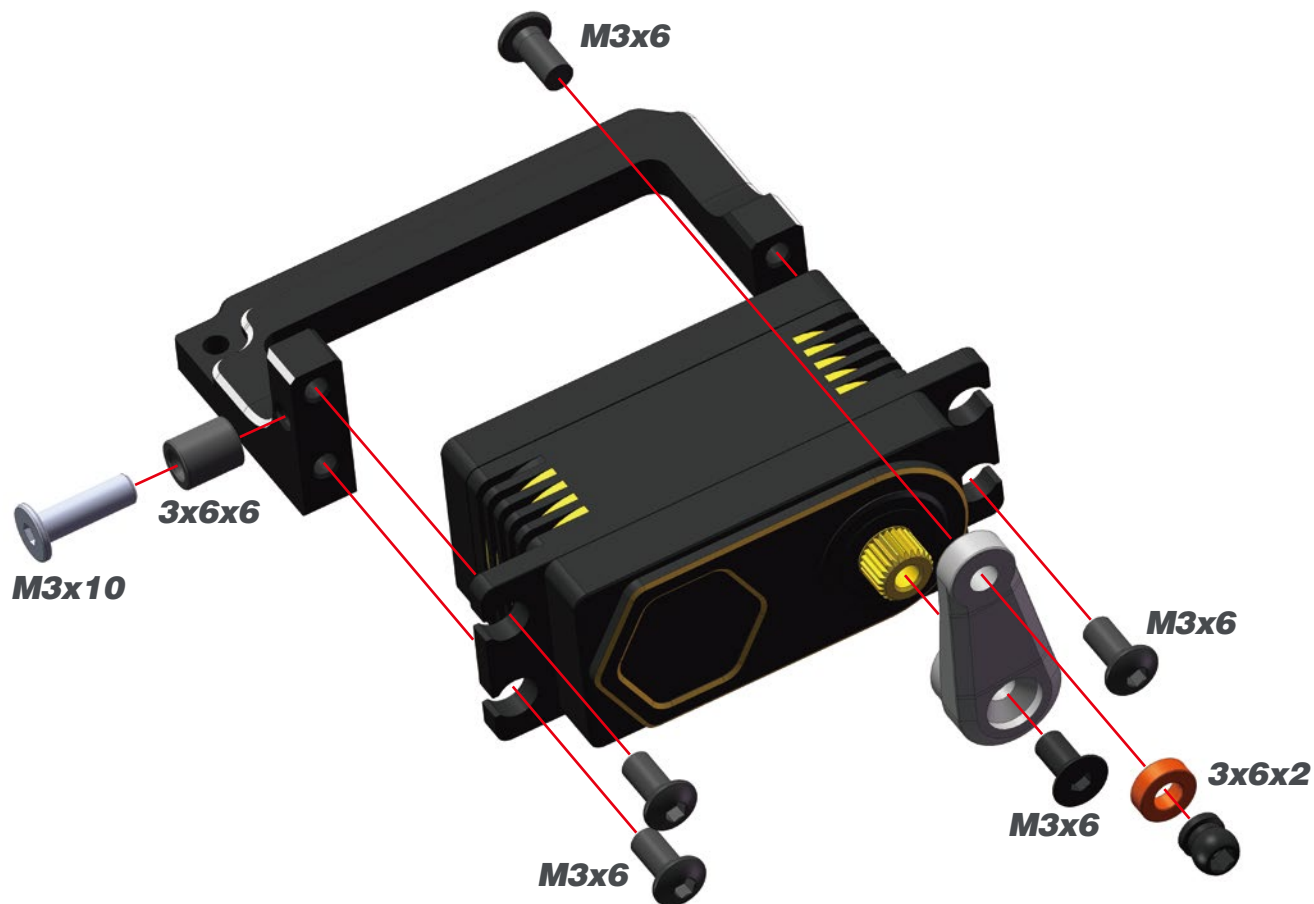

OPT



- 600290 Servo lever steering 23T alu
- 600291 Servo lever steering 24T alu
- 600292 Servo lever steering 25T alu

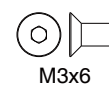
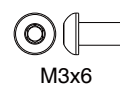
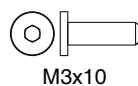
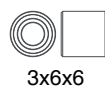
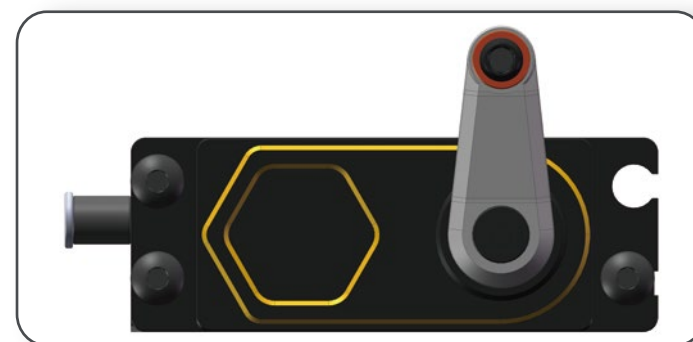

STEP 11

11.2

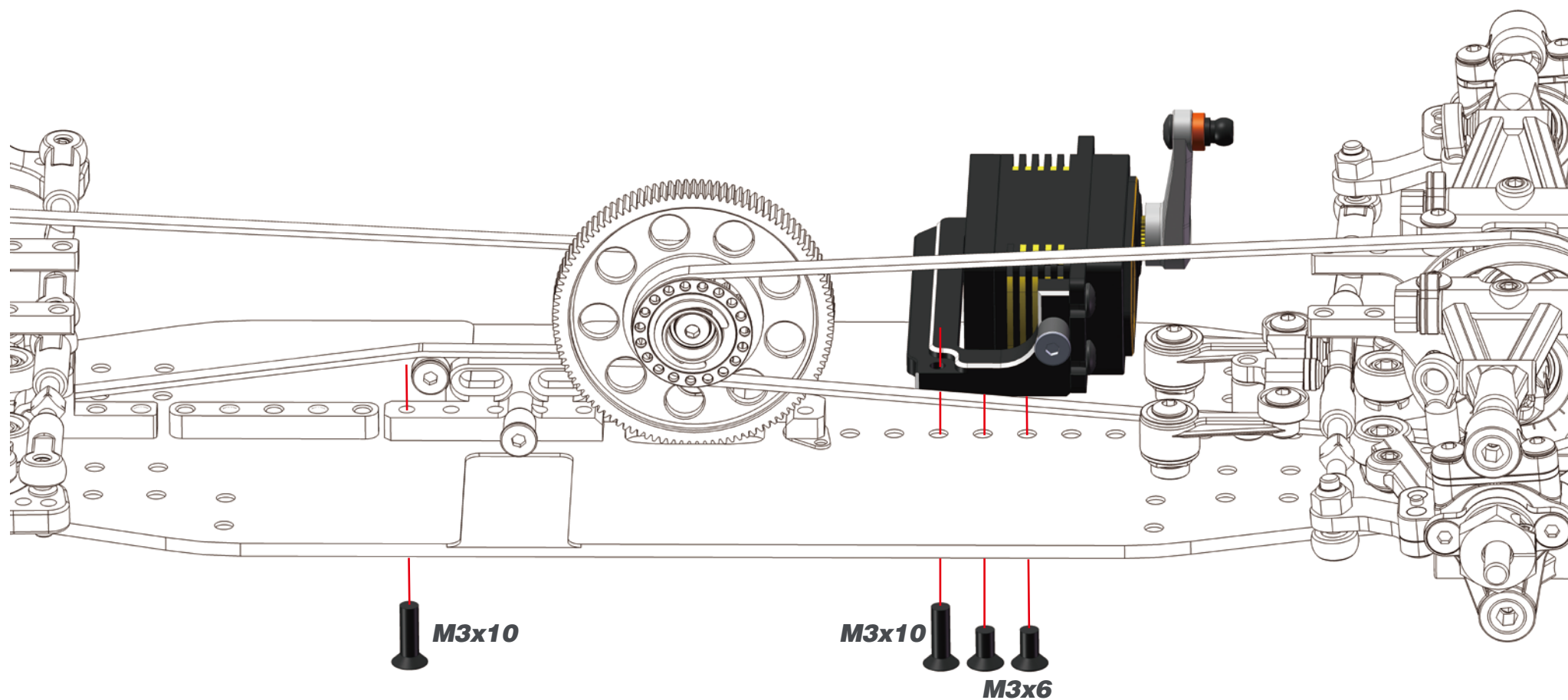

STEP 11

BAG 6

11.3

OPT



401910 Topdeck brace carbon x20(2)

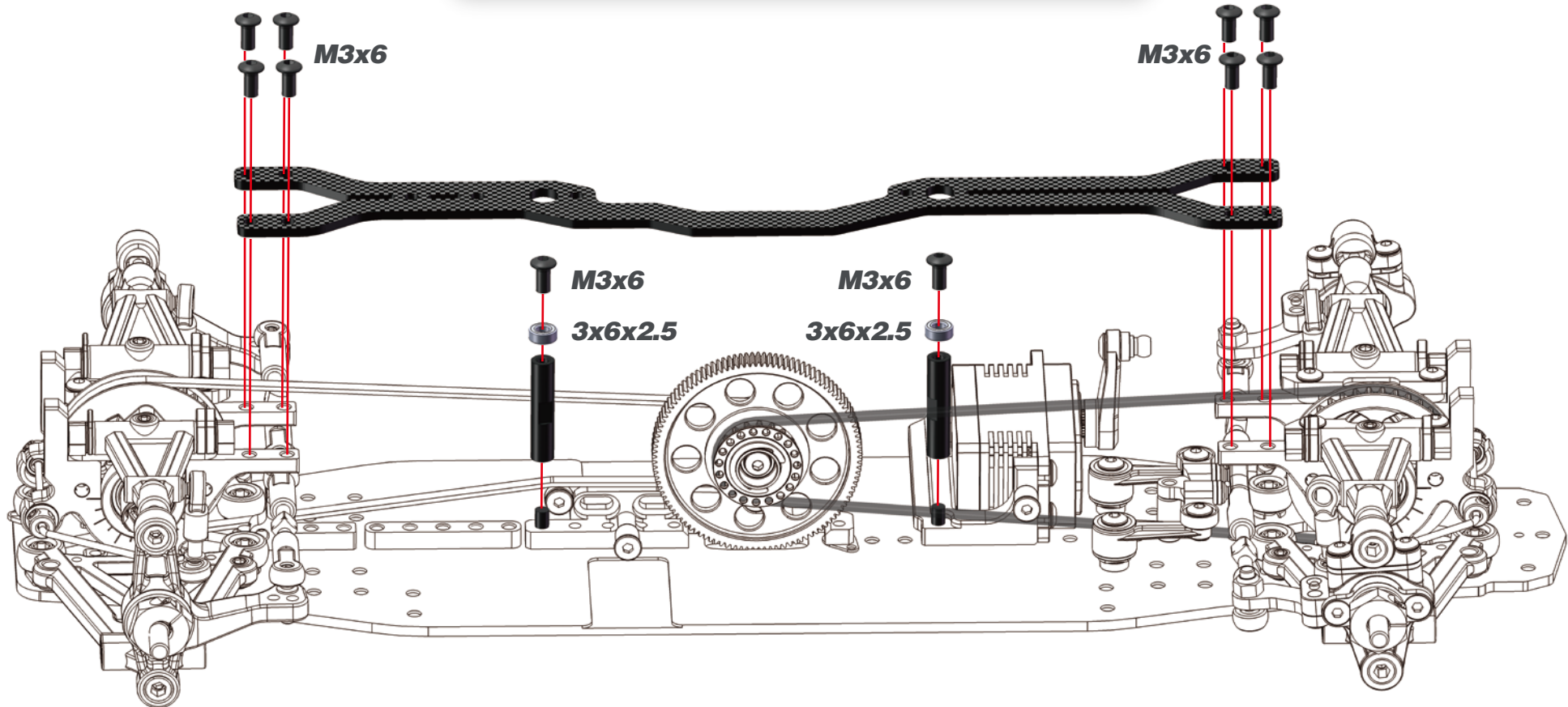

STEP 11

11.4

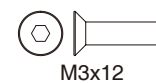
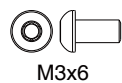
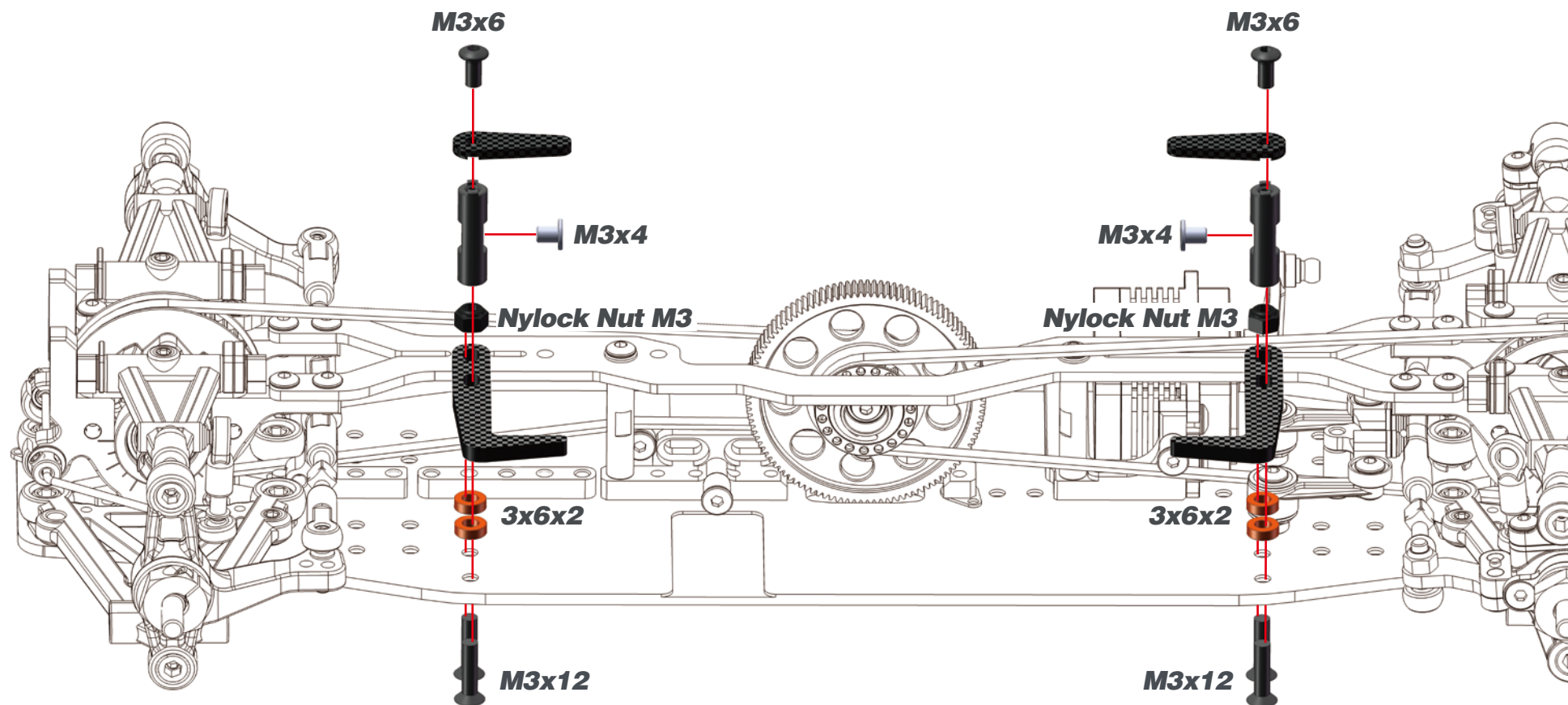

STEP 12

SHOCK BAG

12.1

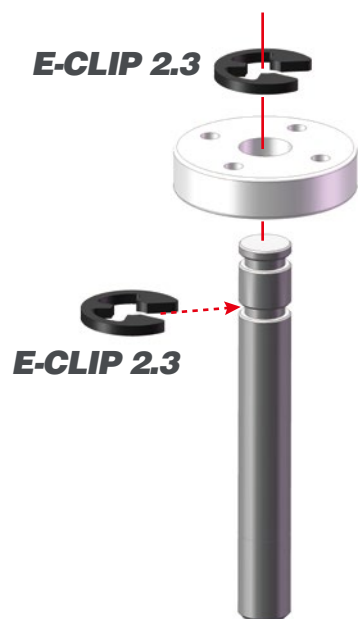

12.2



12.3



12.4



12.5



E-CLIP 2.3

STEP 13

BAG 7

13.1 FRONT

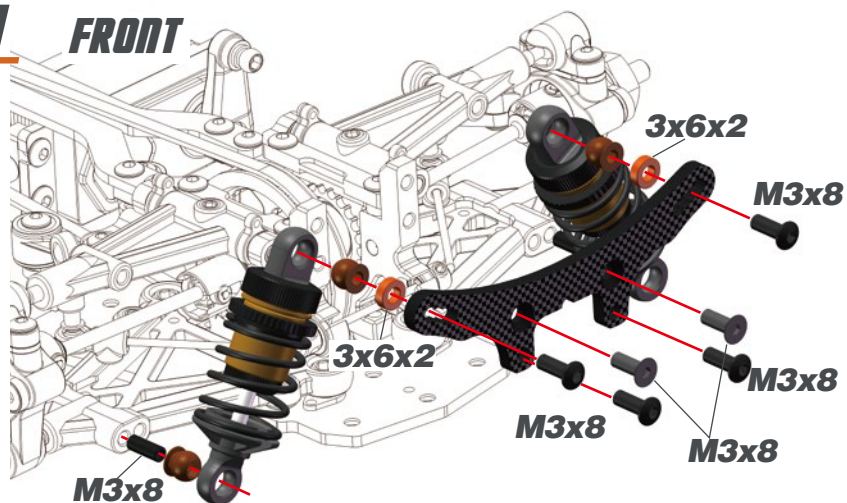

13.2 REAR

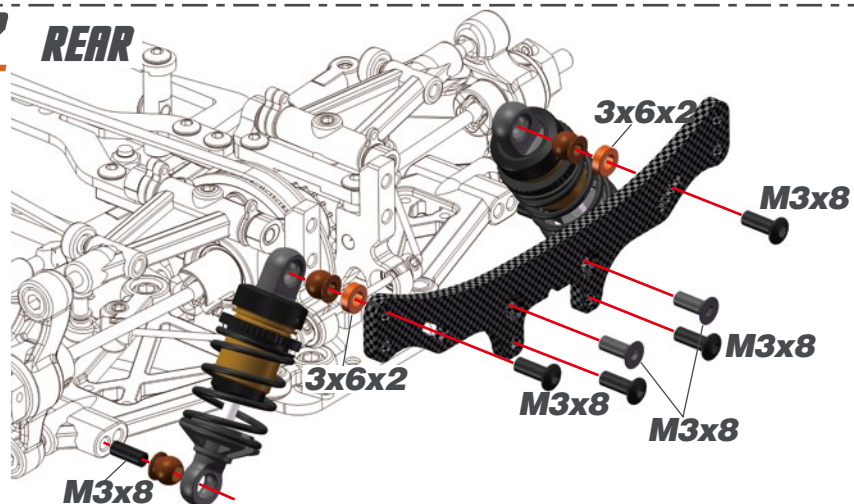

OPT

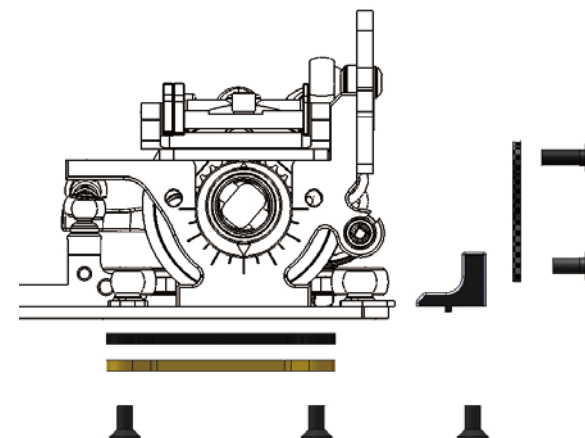

401864 Shocktower stiffner carbon fr/rr X20
401871 Shocktower stiffner set fr/rr X20
401964 Chassis brace set fr X20 '21
401965 Chassis brace set rr X20 '21
401966 Front stiffner set X20 '21
401967 Rear stiffner set X20 '21



401960 Lower chassis weight 5gr (2) X20 '21



401963 Chassis brace fr/rr alu X20



401866 Chassis stiffner center mount mid X20

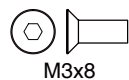

STEP 14

14.1

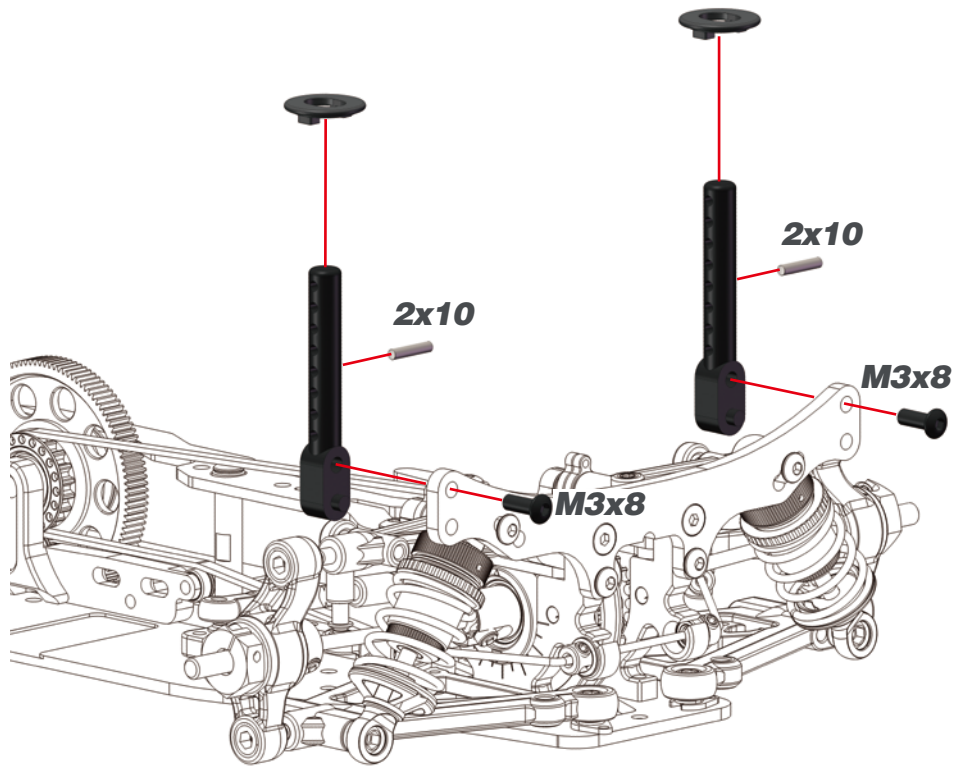

OPT



401602 Body-height fine-tuner alu (4)

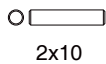

14.2

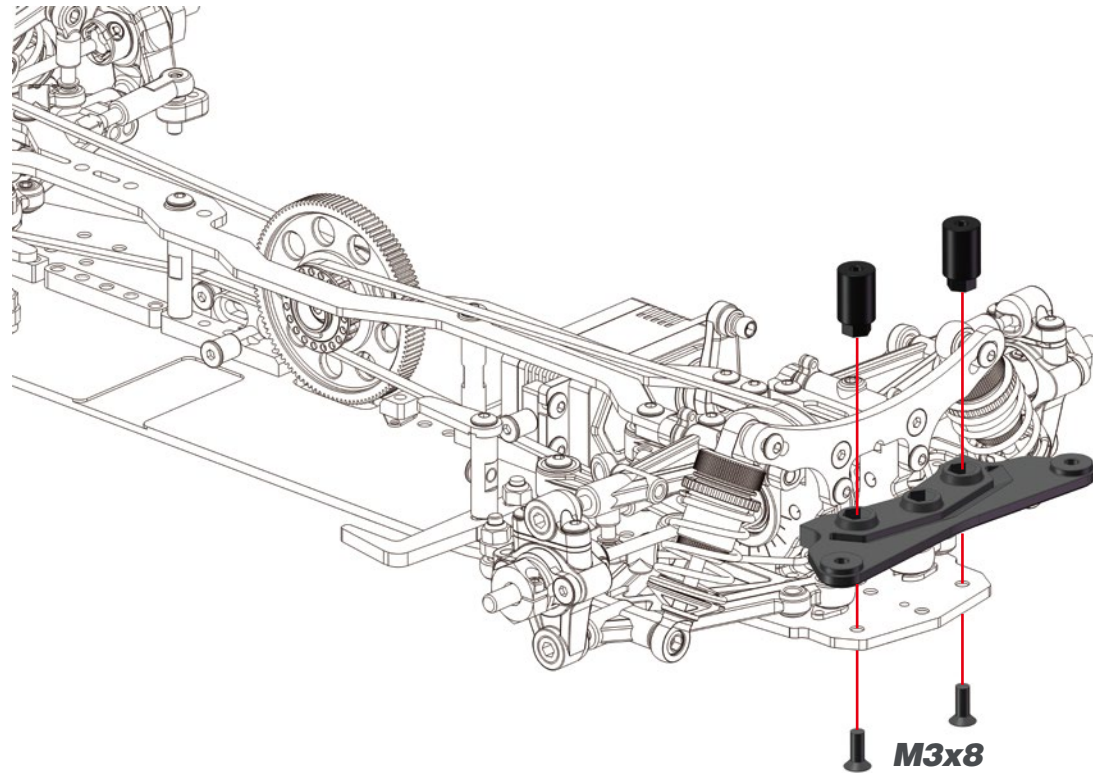

STEP 14

14.3

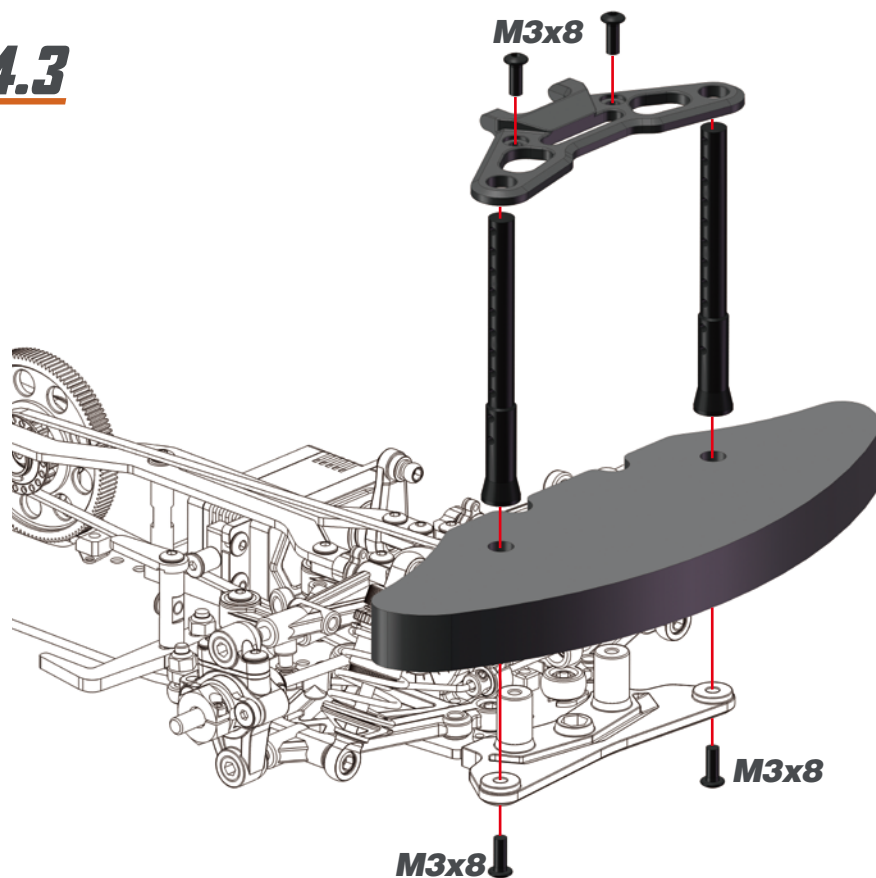

OPT



401954 Bumper top carbon X20 '21



M3x8

14.4

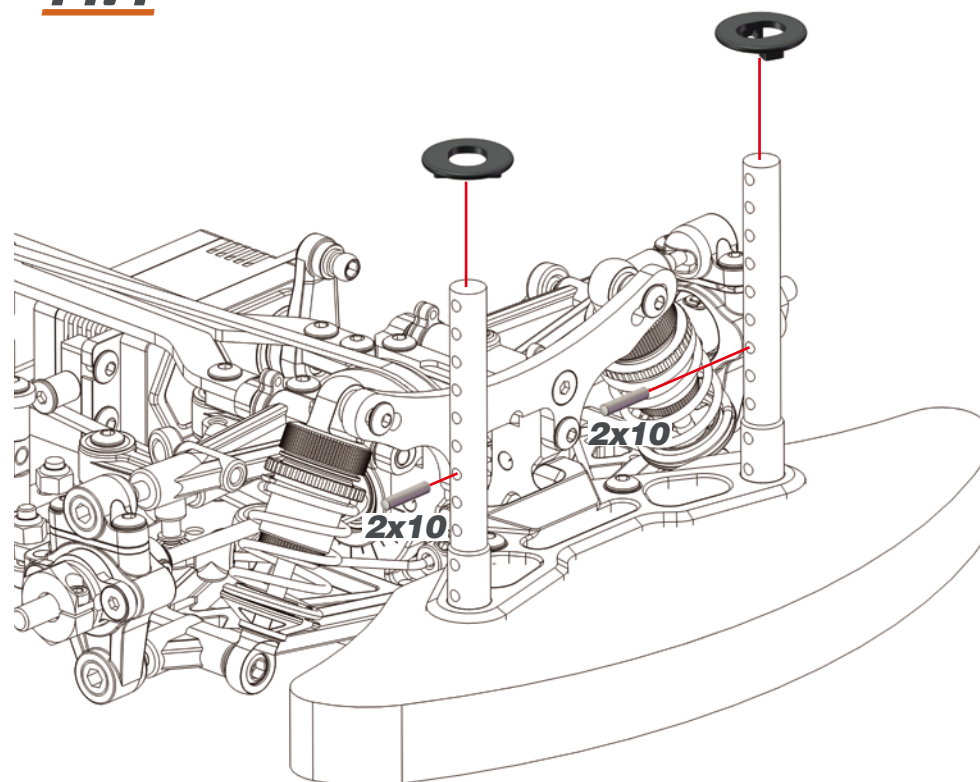

OPT



401602 Body-height fine-tuner alu (4)



2x10

STEP 15

15.1

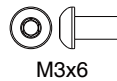
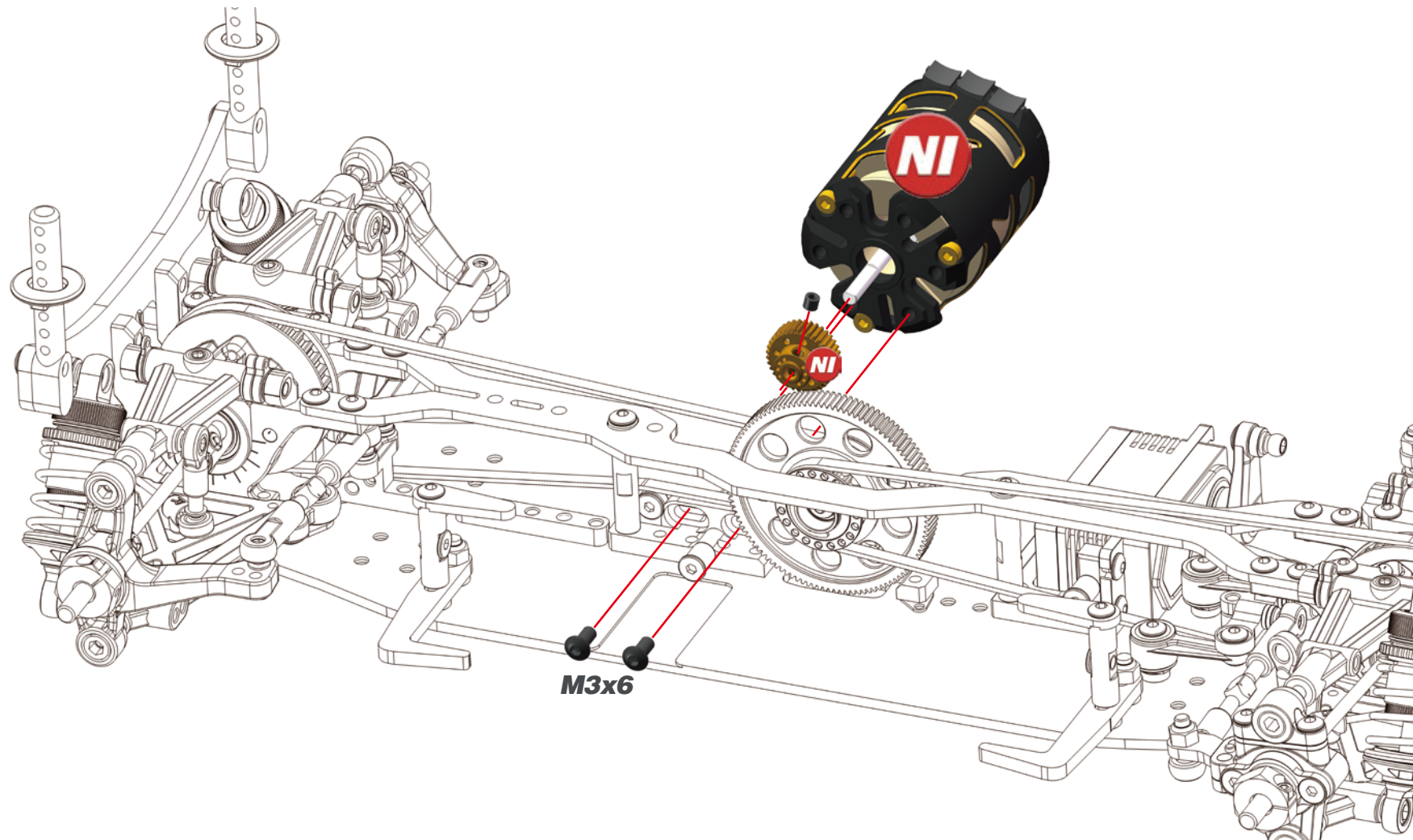

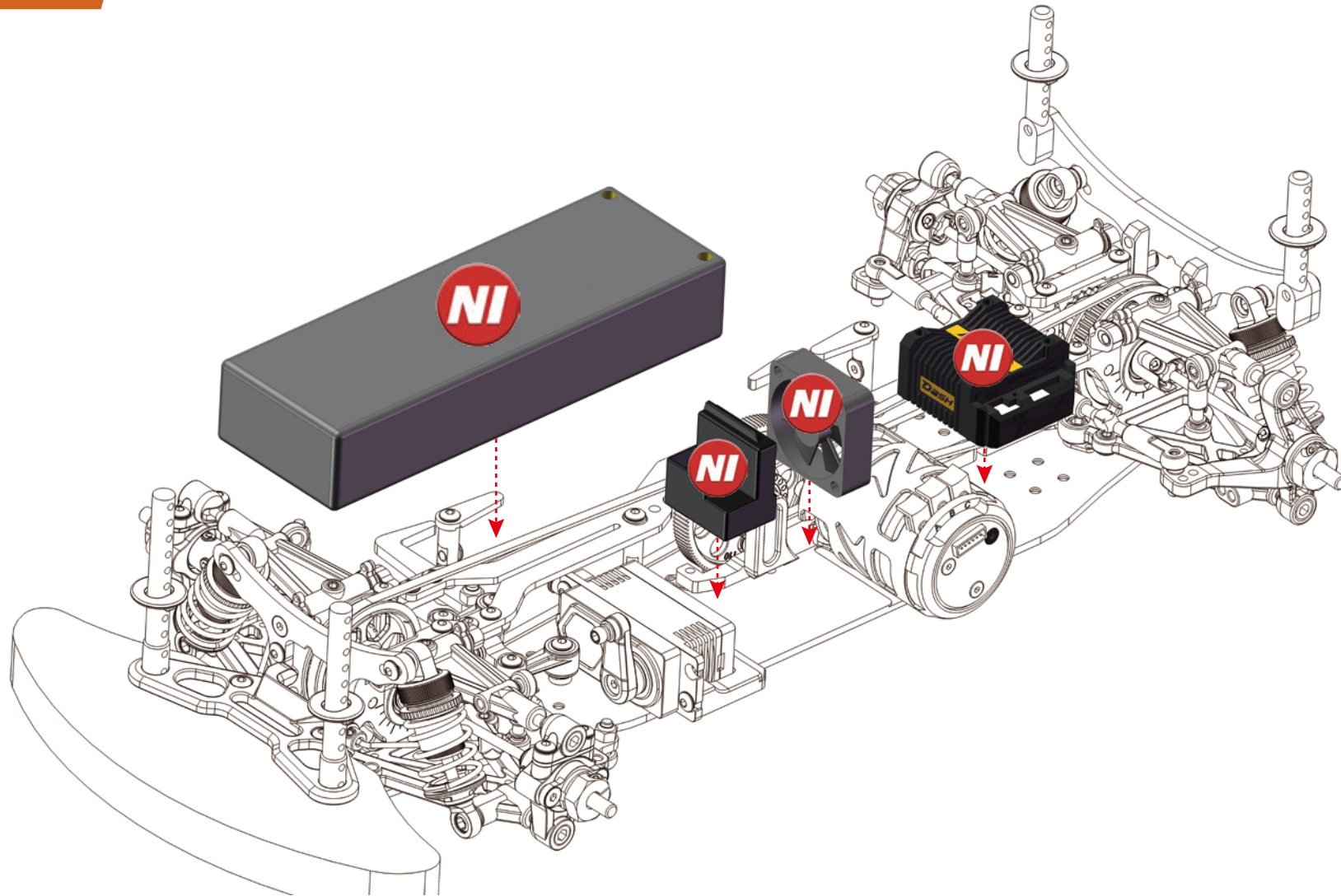
STEP 15**15.2**

STEP 15

15.3

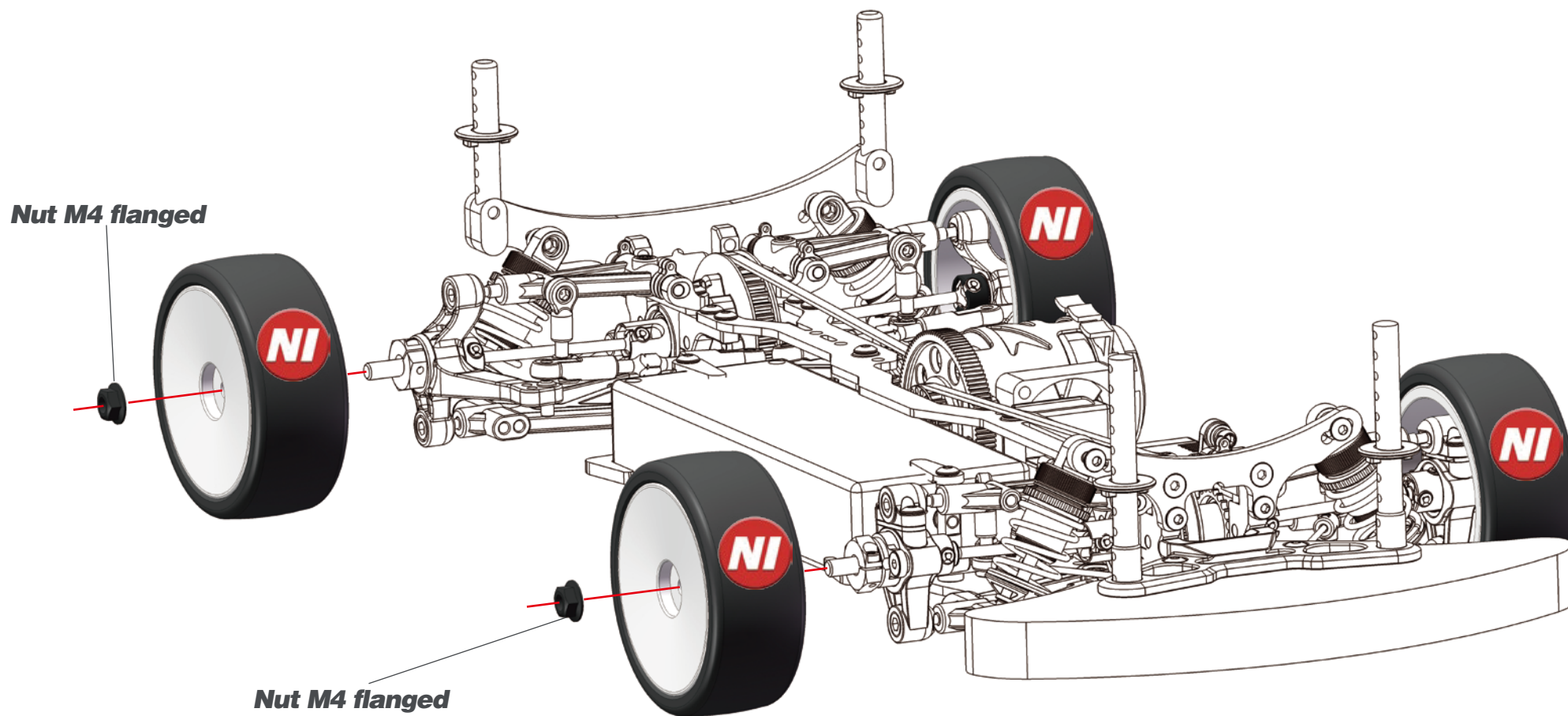

STEP 15

15.4

 Setup the X20'21

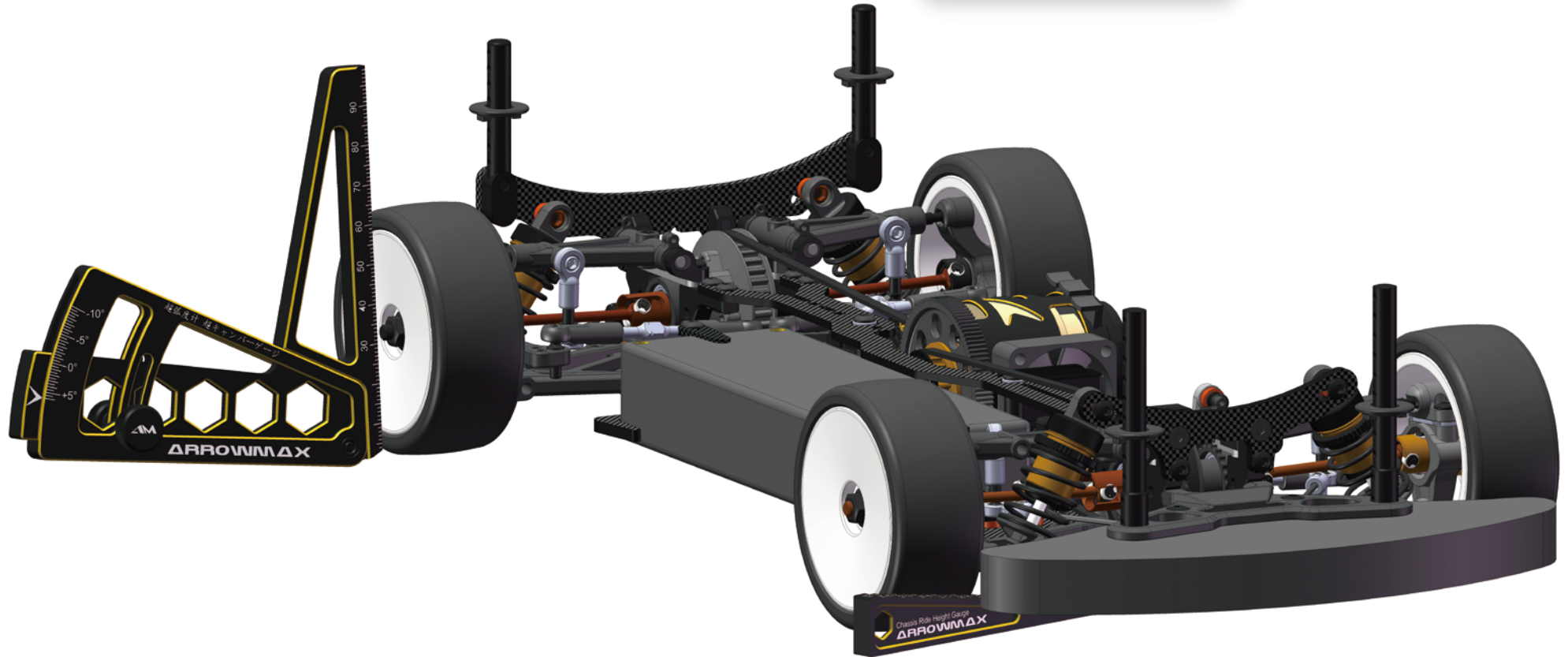

STEP 16

16.1

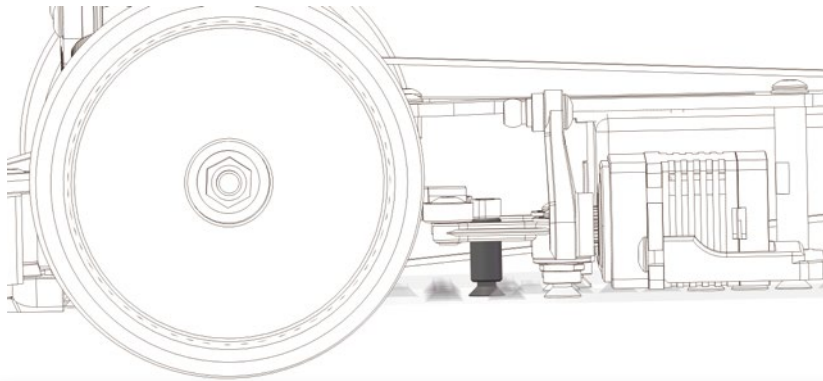

Remove the steering holder when you finish setup!

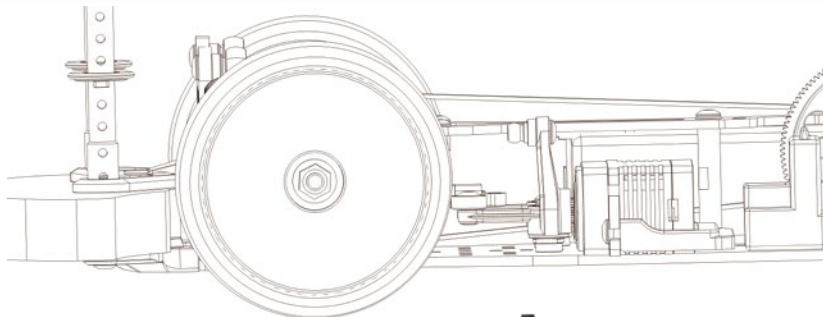

16.2

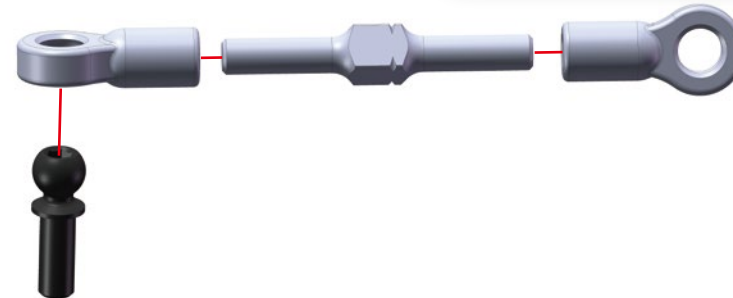
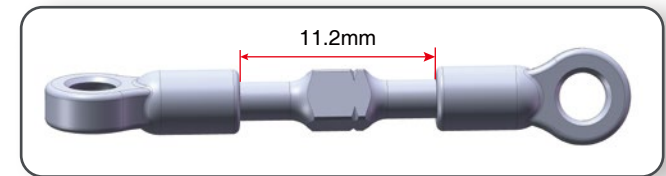

16.3

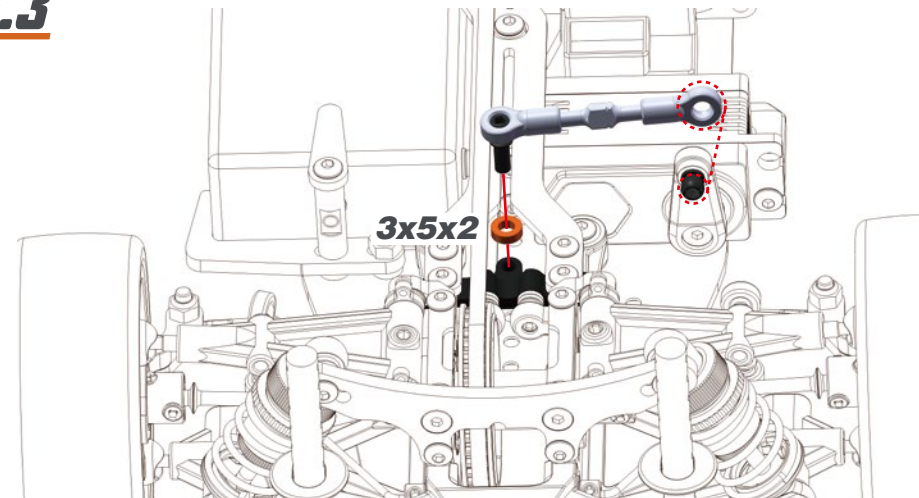

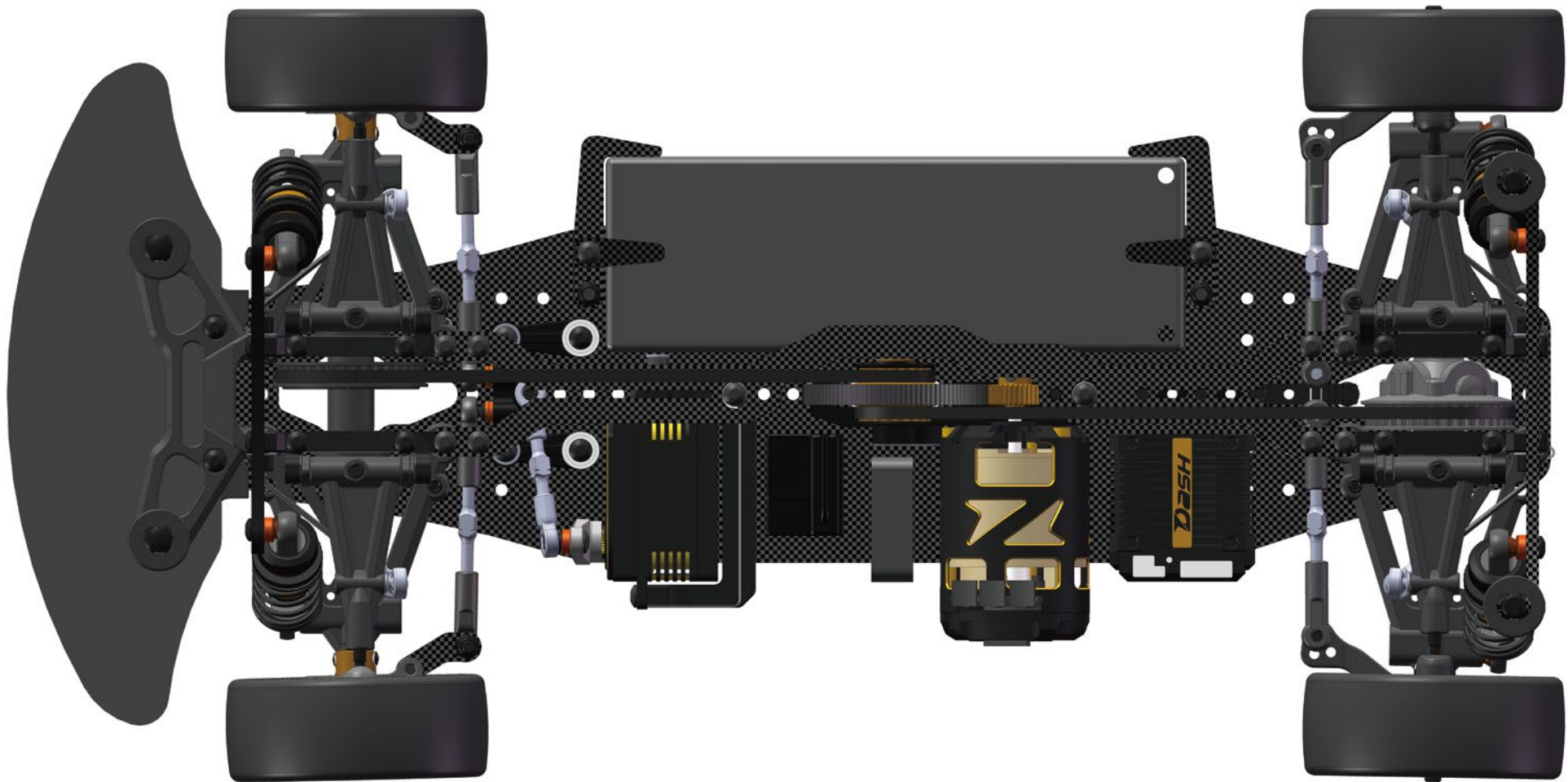

3x5x2

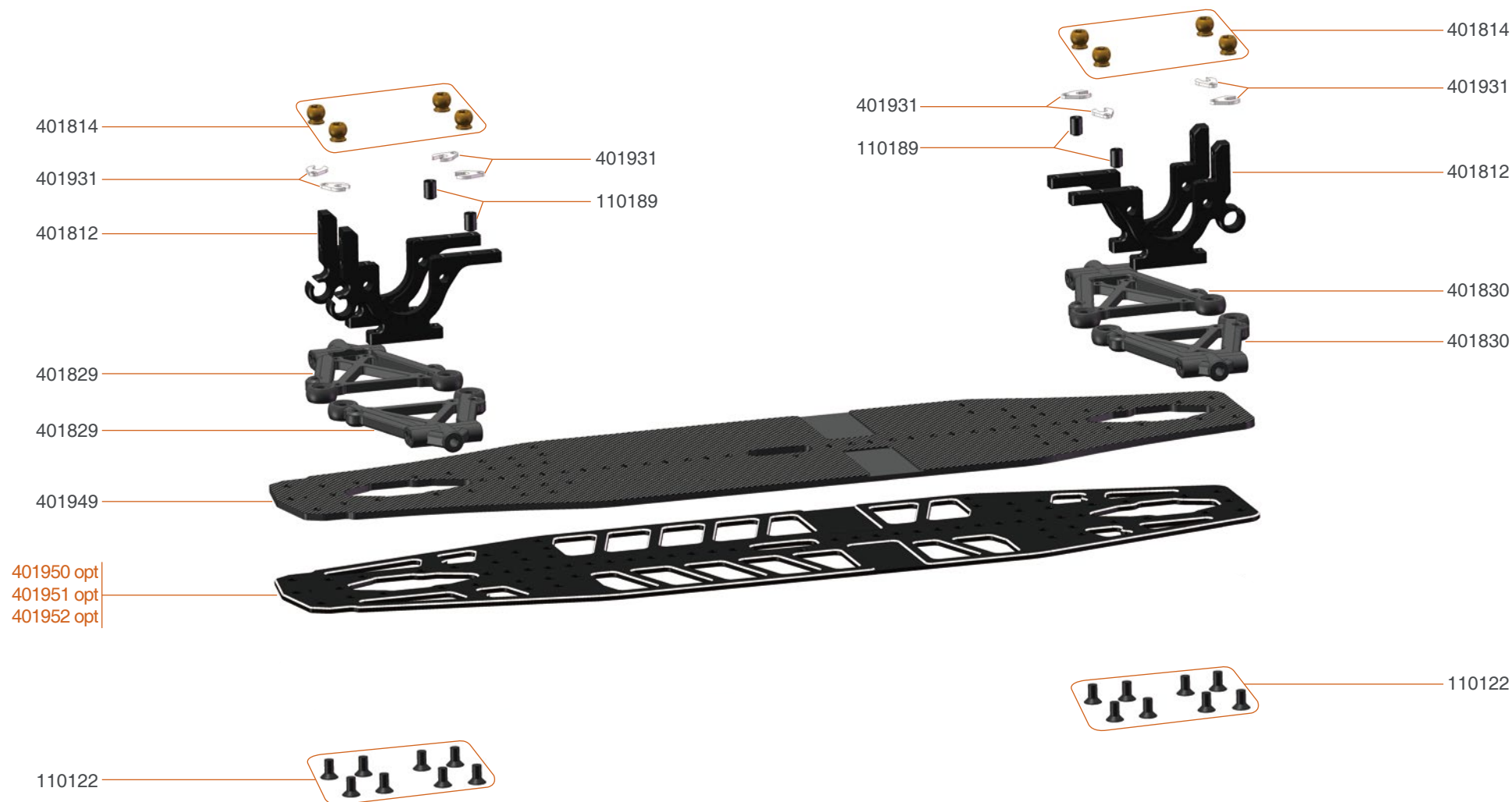

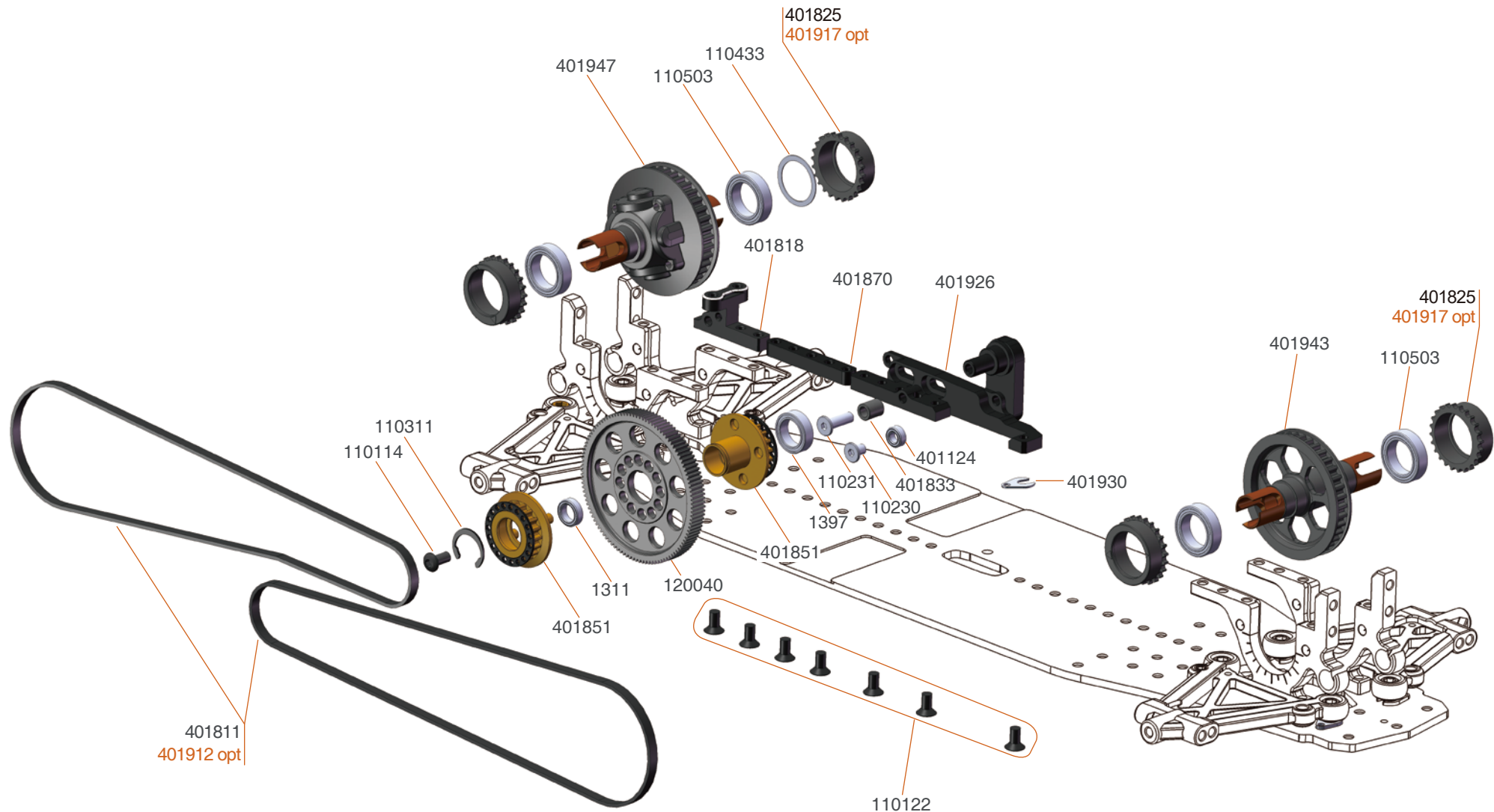

401950	Chassis 2mm 7075T6 soft X20 '21	401958	Chassis weight 10gr X20 '21	401964	Chassis brace set fr X20 '21	401953	Wishbone insert full carbon (4) X20
401951	Chassis 2mm 7075T6 medium X20 '21	401959	Motormount weight 10gr X20 '21	401965	Chassis brace set rr X20 '21	401962	Wishbone insert brass 10gr (2) X20
401952	Chassis 2mm 7075T6 hard X20 '21	401961	Chassis weight RX 5gr X20 '21	401966	Front stiffner set X20 '21		
401831	Wishbone insert carbon (4) X20	401963	Chassis brace fr/rr alu X20	401967	Rear stiffner set X20 '21		



120007 Spur gear 64P / 100T
120008 Spur gear 64P / 104T
120009 Spur gear 64P / 108T
120010 Spur gear 64P / 112T

120012 Spur gear 64P / 114T
120013 Spur gear 64P / 106T
401866 Chassis stiffner center mid carbon X20
401912 Belt 30S3M348 low friction X20

401913 Adjustable chassis brace rr X20
401917 Bearing excenter fr/rr (4) alu X20
401955 Fan mount set X20 '21
401956 Fan mount X20

401957 Fan Holder X20

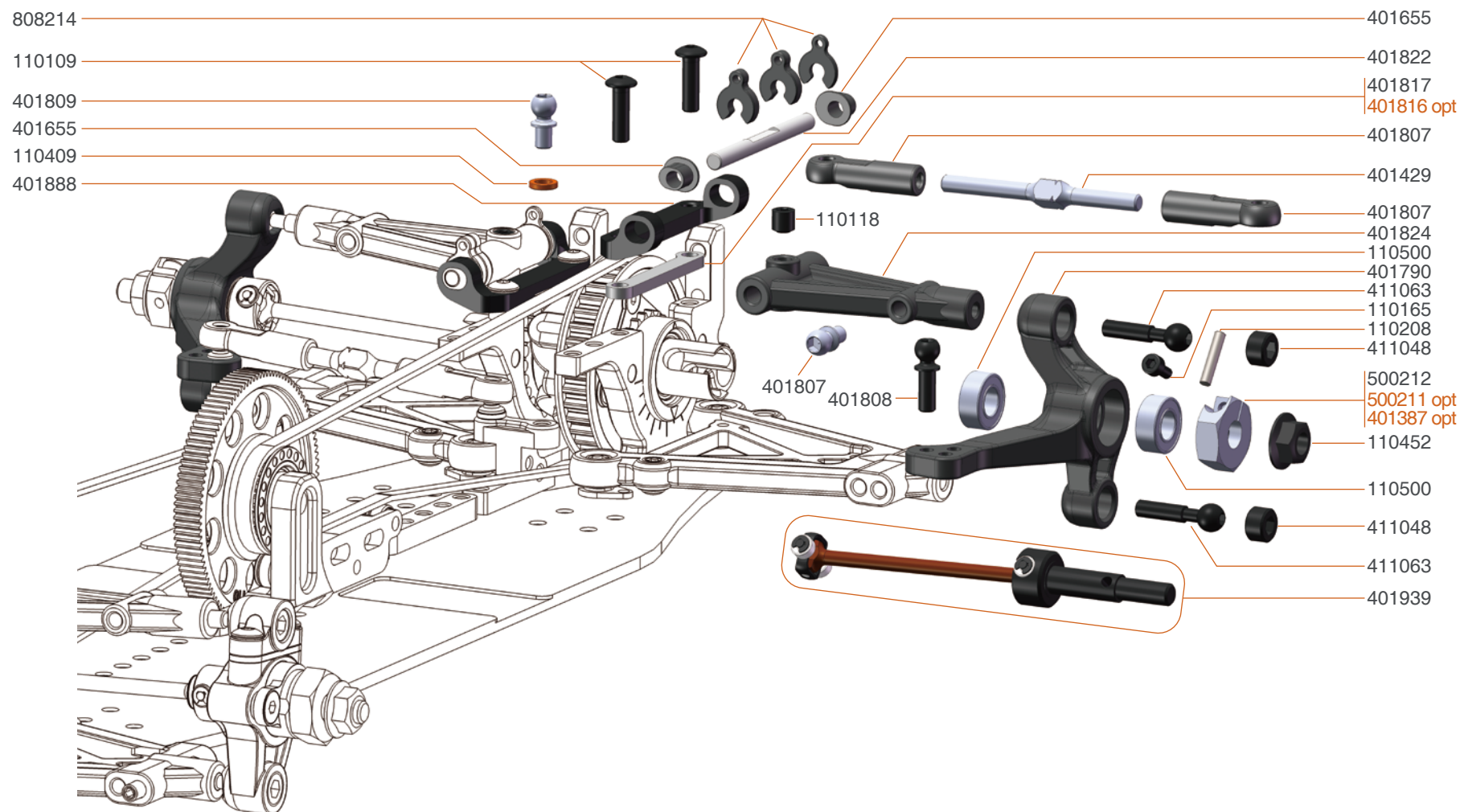

- 401387 Wheelhexagon 1mm offset (2)
- 401816 Suspension bracket spacer 1mm (4) X20
- 500211 Wheelhexagon +0.75mm offset (2)

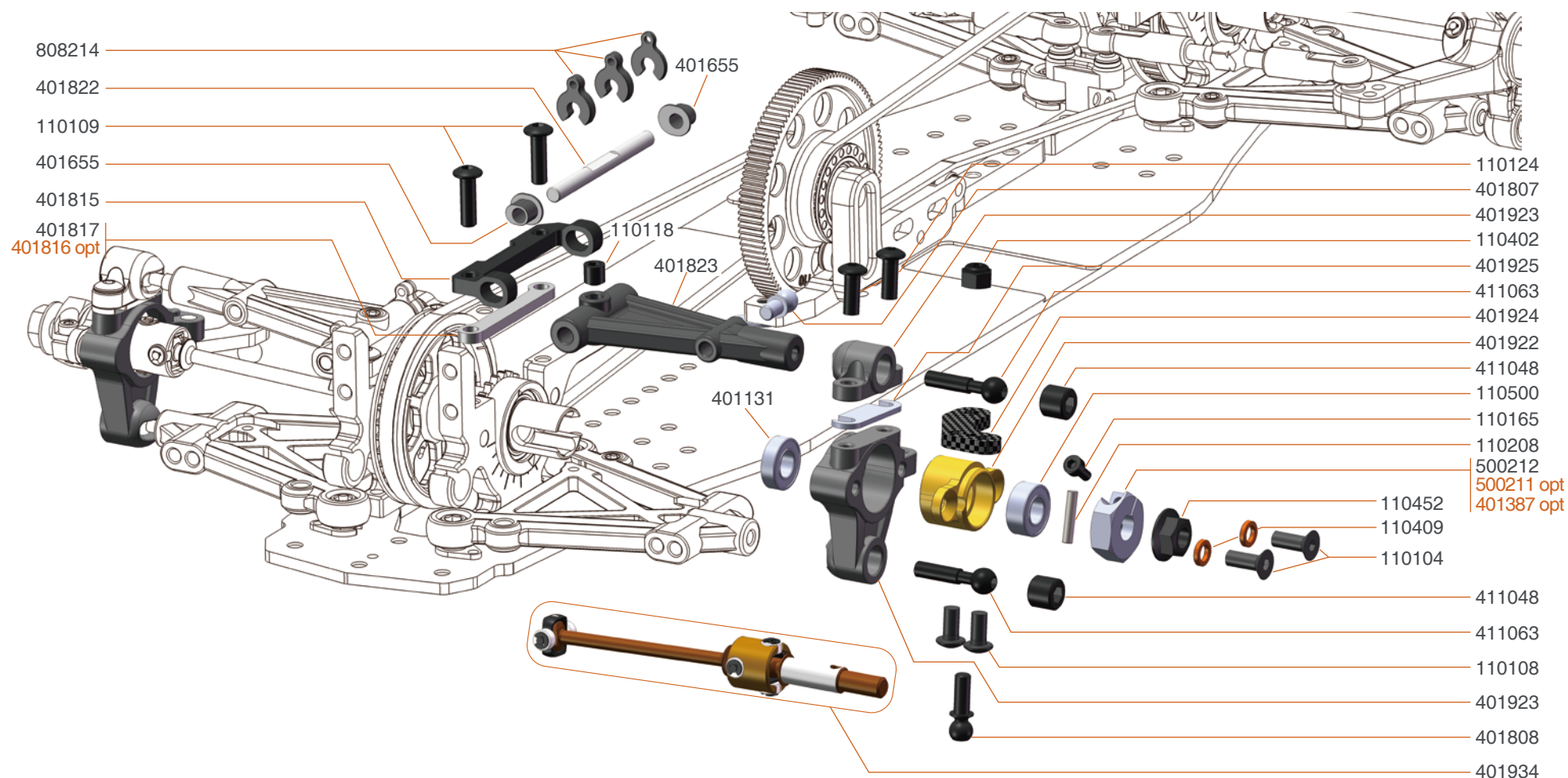

- 401387 Wheelhexagon 1mm offset (2)
- 401816 Suspension bracket spacer 1mm (4) X20
- 500211 Wheelhexagon +0.75mm offset (2)



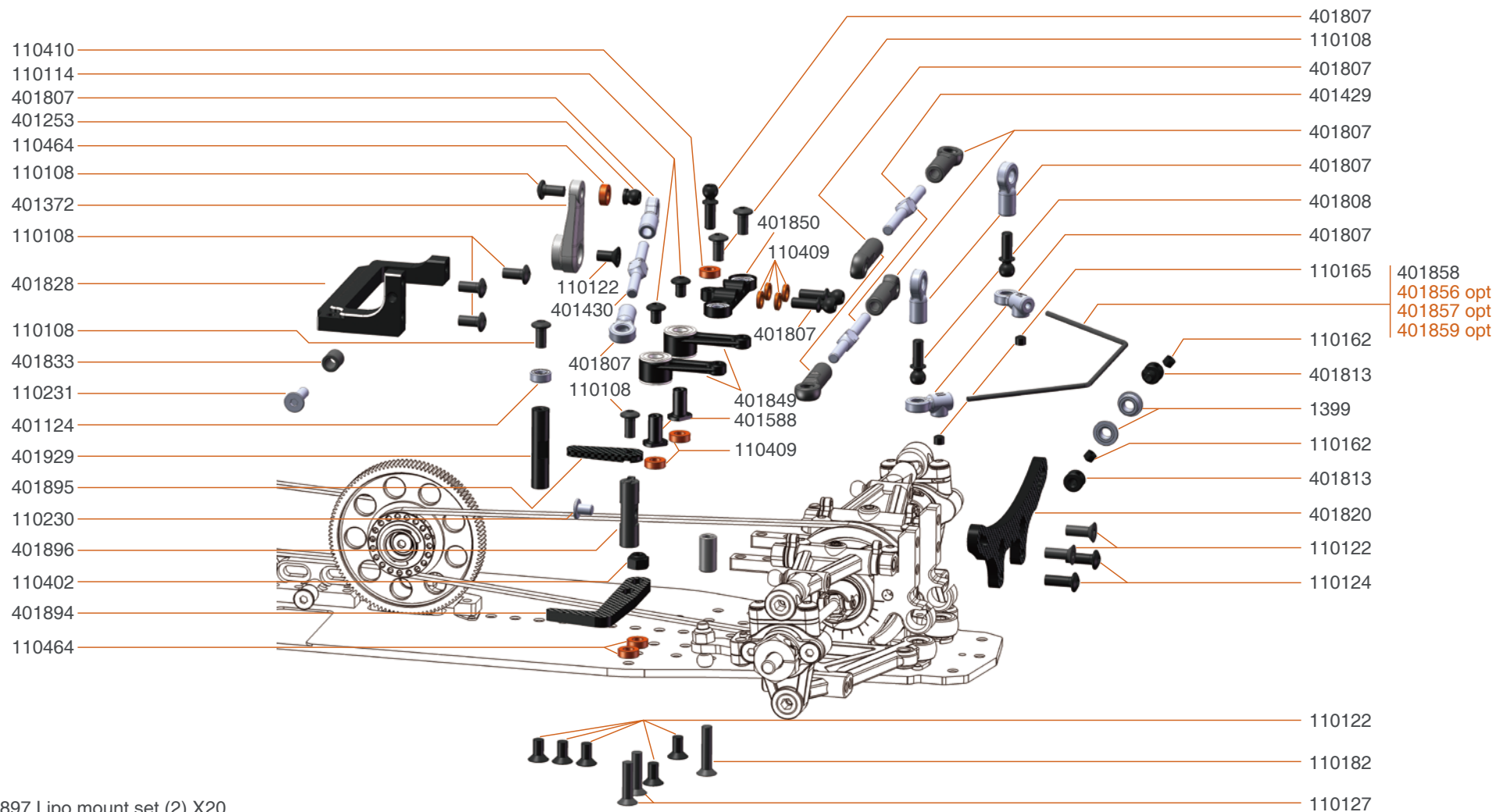

401856 Antirollbar 1,2mm X20
401857 Antirollbar 1,3mm X20
401859 Antirollbar 1,5mm X20

401863 Steering lever mount stiff X20
401864 Shocktower stiffner carbon fr/rr X20
401871 Shocktower stiffner set fr/rr X20

401865 Stiffner fr/rr mount X20
401964 Chassis brace set fr X20 '21
401966 Front stiffner set X20 '21

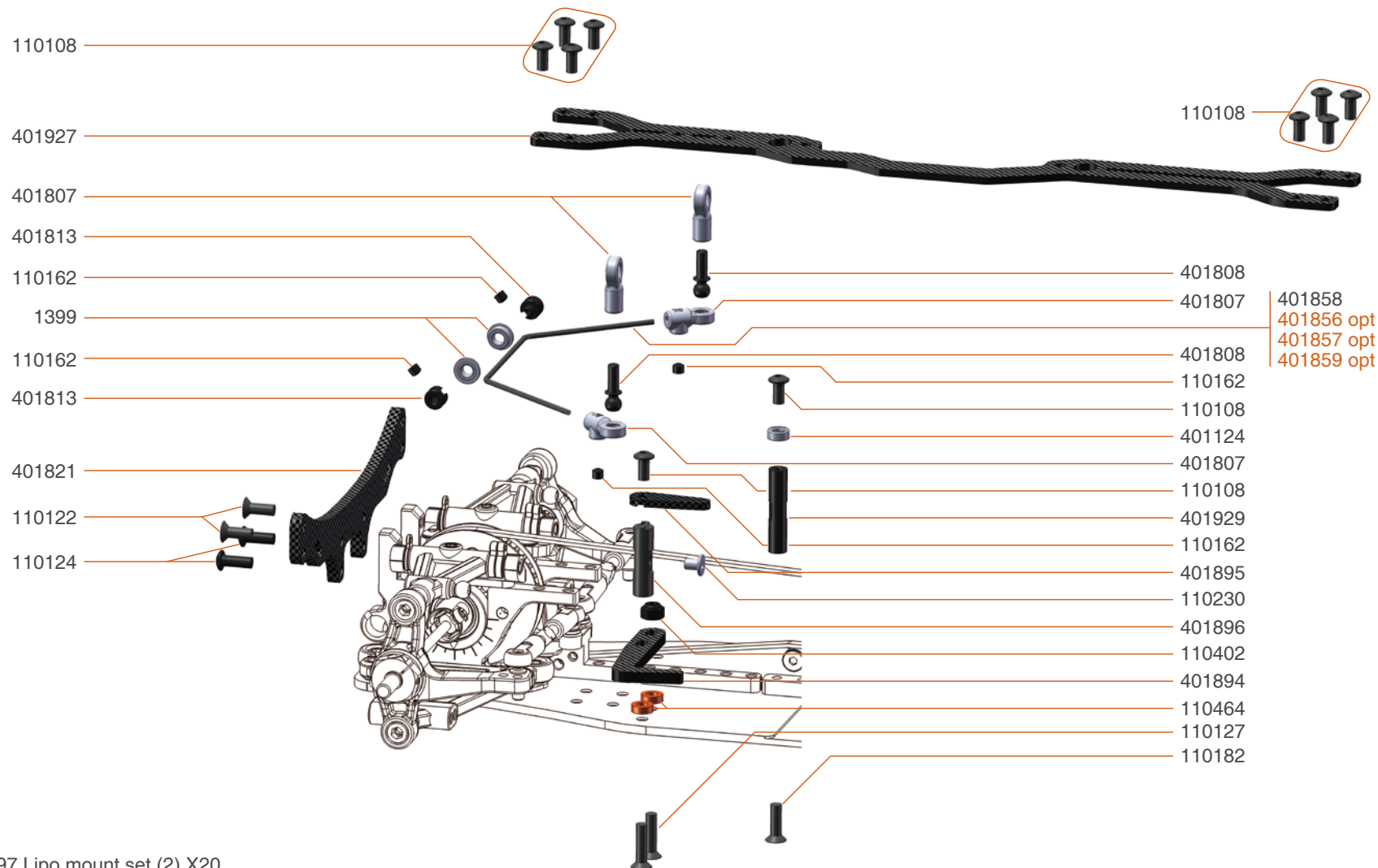

401897 Lipo mount set (2) X20



401856 Antirollbar 1,2mm X20
401857 Antirollbar 1,3mm X20
401859 Antirollbar 1,5mm X20

401864 Shocktower stiffner carbon fr/rr X20
401865 Stiffner fr/rr mount X20
401871 Shocktower stiffner set fr/rr X20

401963 Chassis brace fr/rr alu X20
401965 Chassis brace set rr X20 '21
401967 Rear stiffner set X20 '21

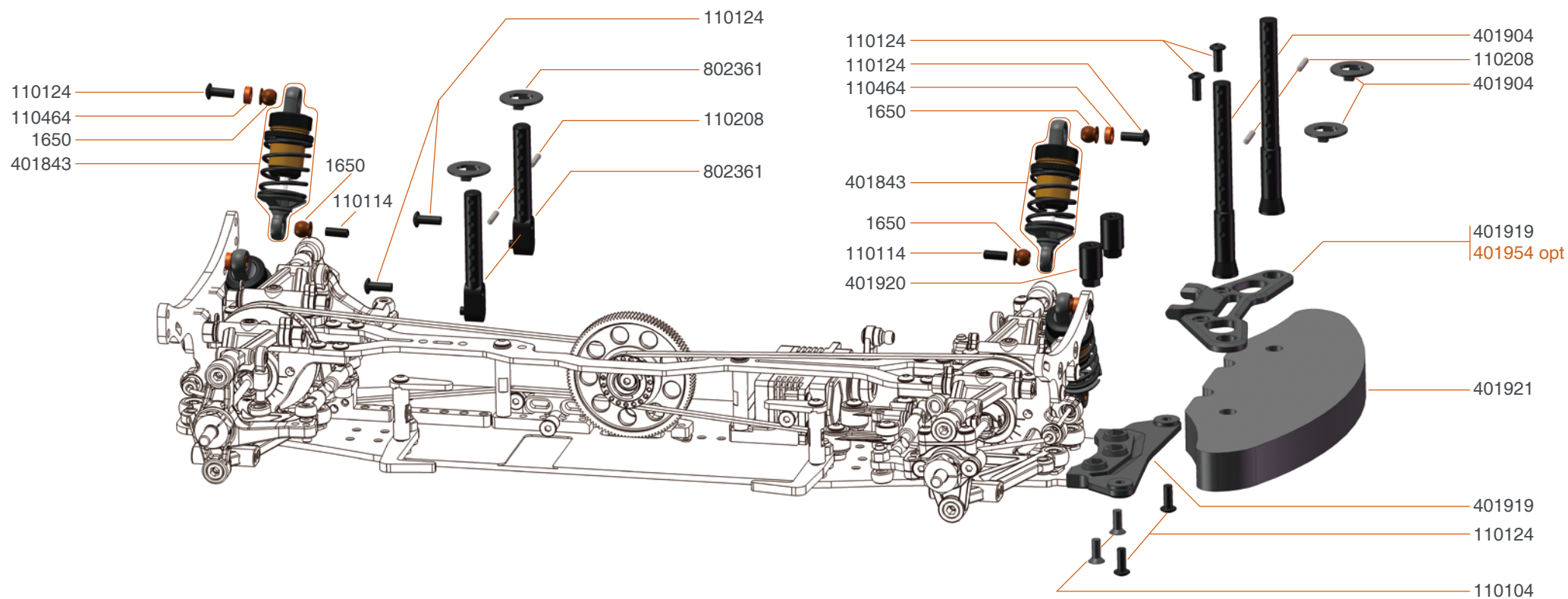

- 401954 Bumper top carbon X20 '21
- 401602 Body-height fine-tuner alu (4)
- 804293 Body support washers med + high (5+5)

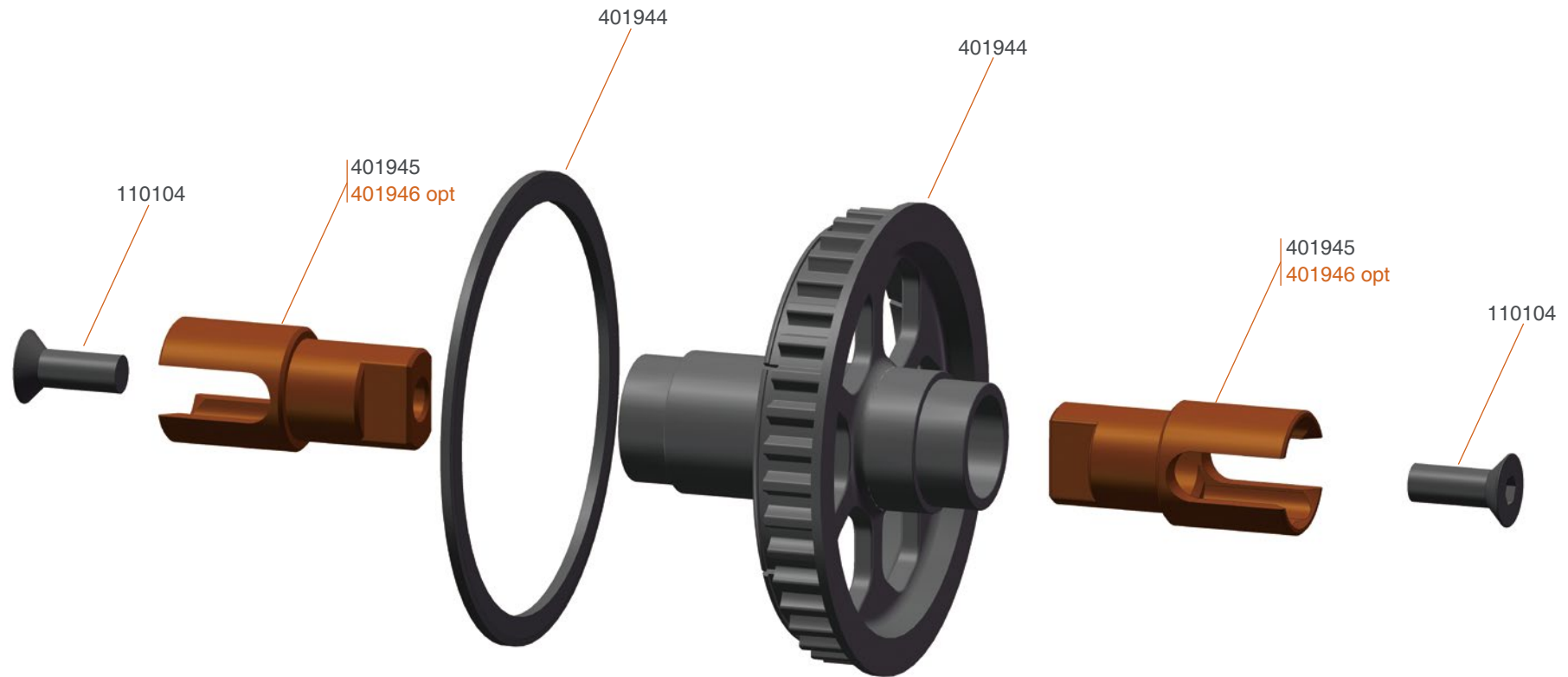

401943 Solid axle BB s et X20

401946 Outdrive solid axle (2) X20





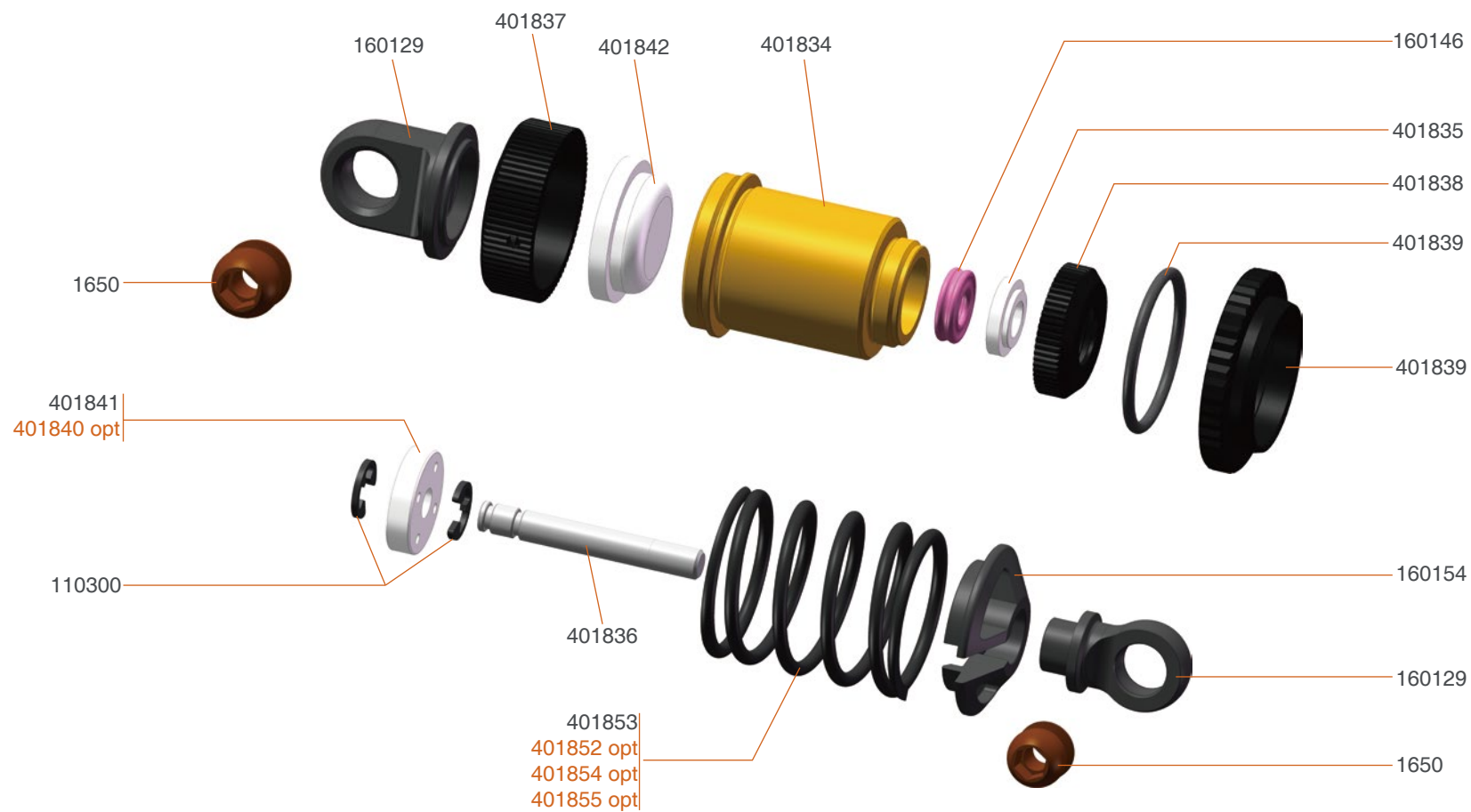

401843 Shockset (2) X20



- 401840 Shock piston 3-holes (4) X20
- 401852 Spring fr/rr 2,5 (2)
- 401854 Spring fr/rr 2,7 (2)
- 401855 Spring fr/rr 2,8 (2)

401947 Geardiff BB set

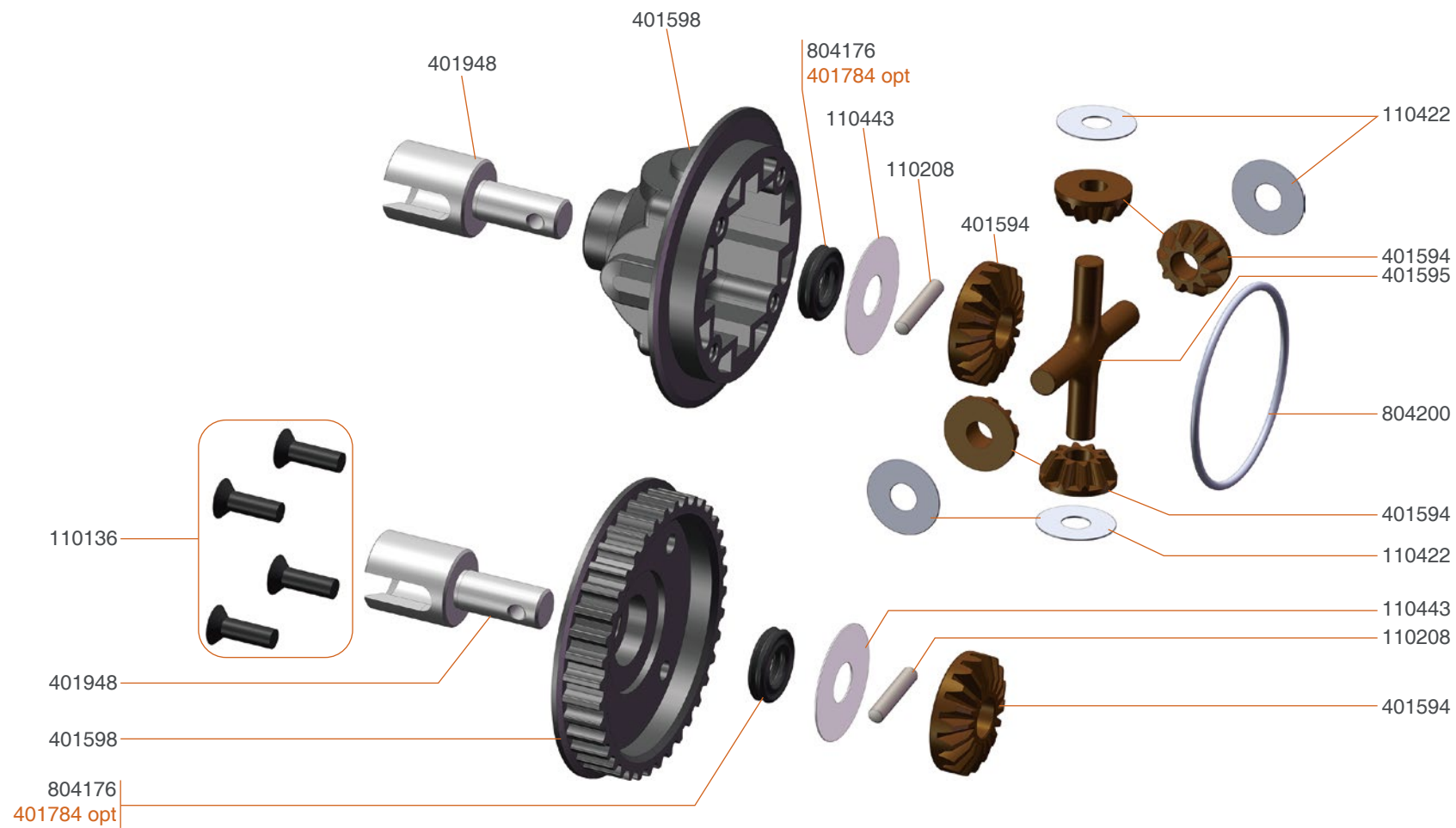

401784 Seal 5x9x2 diff (2)



TEAM SERPENT NETWORK

X20' 21 SPARE PARTS www.serpent.com/400037/spares/



X20' 21 OPTIONAL PARTS www.serpent.com/400037/Optionals/

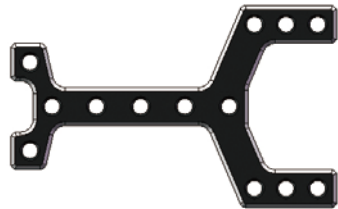

SERPENT TOOLS www.serpent.com/product/Tools/



SERPENT MERCHANDISING www.serpent.com/product/Merchandising/



SERPENT WEBSITE AND BLOG

www.serpent.com
www.teamserpent.com
www.dragon-rc.com

SERPENT PROMO PAGES <http://promo.serpent.com>

SERPENT FACEBOOK GROUPS <http://promo.serpent.com/indexfb.htm>

SERPENT ADVANCED MANUALS <http://promo.serpent.com/sam/>

SERPENT SOCIAL MEDIA



www.facebook.com/SerpentMRC



www.youtube.com/user/SerpentMRC



www.twitter.com/SerpentMRC



www.plus.google.com/+SerpentModelcars/posts



www.weibo.com/teamserpent

INSTRUCTION MANUAL



Manual Medius X20 '21 carbon #98588-1

SERPENT