

SETUP SHEET

VIPER
990
EVO

SERPENT

DRIVER & TRACK

DRIVER **M. Weigerding** DATE **Euro 24**

TRACK **Locorotondo** GRIP **medium**

1ST SPUR GEARS

☐ 61 ☒ 62 ☐ 63 ☐ 56 ☐ 57 ☒ 58

1ST PINION

☐ 18 ☒ 19 ☐ 20 ☐ 23 ☒ 24 ☐ 25

FR SHOCK ABSORBERS

OIL **700 cst**

SPRINGS **SMJ 8.0**

PISTON **2 holes**

RR

OIL **700 cst**

SPRINGS **SMJ 5.7**

PISTON **1 hole**

FR HEAVE DAMPER RR

OIL **cst**

SPRINGS

PISTON

ANTI-ROLL BARS

FRONT

REAR

FR TYRES Controlled Type RR

MAKE & TYPE **Matrix**

32

SHORE

35

mm DIAMETER mm

POWER PACK

ENGINE

BRAND & TYPE **Hasi Tuned 9R**

GLOWPLUG **7** CARB Ø **8.5mm**

EXHAUST

PIPE **OS TR03** MANIFOLD **MR03**

FUEL

BRAND **Maxima** NITRO % **16**

CLUTCH

CLUTCH ☒ ALU

CLUTCH **yellow**

BELL ☐ STEEL

SHOE

CLUTCH SPRING **Hasi Tuned**

CLUTCH BELL GAP **0,5 mm**

AERODYNAMIC CONFIGURATION

BODY BRAND

Xtreme

BODY POSITION

Precut mm

BODY TYPE

Hyper

BUMPER TYPE

990 Evo

AIR TRIM POS.

7 mm

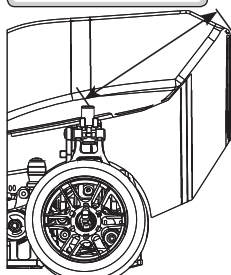

REMARKS

REAR SETUP

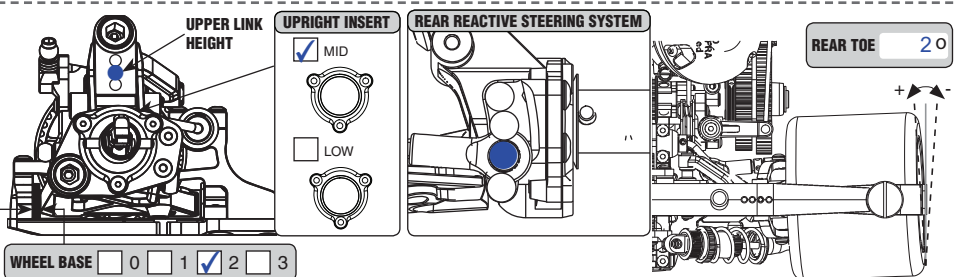
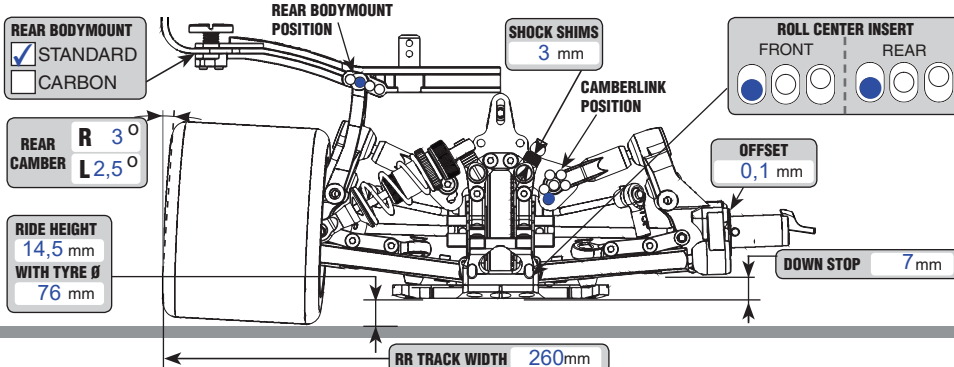

FRONT SETUP

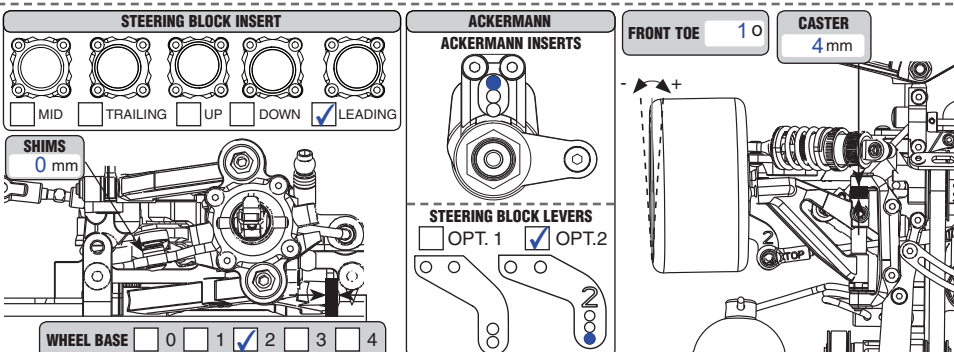
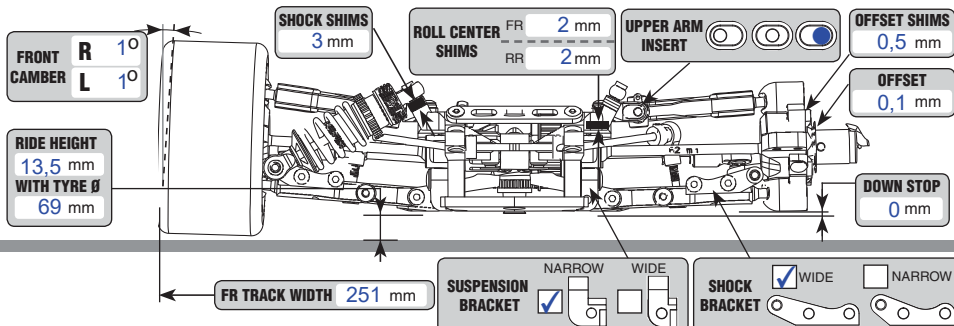

FLEX SETUP

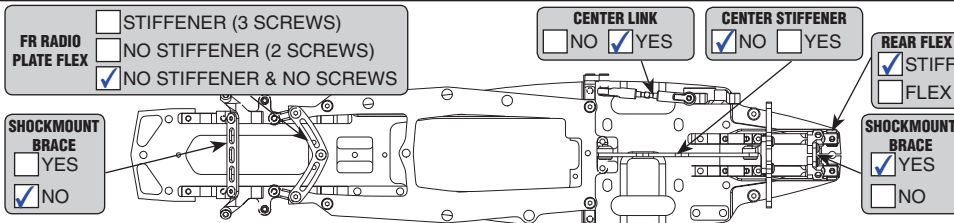

WEIGHT DISTRIBUTION

